

BANNER

**51833858
Condition
Monitoring
Gateway**



BANNER 51833858 Condition Monitoring Gateway User Guide

[Home](#) » [BANNER](#) » BANNER 51833858 Condition Monitoring Gateway User Guide 

Contents

- [1 BANNER 51833858 Condition Monitoring Gateway](#)
- [2 Selection Guide](#)
- [3 TECHNICAL SPECIFICATION](#)
- [4 Documents / Resources](#)
 - [4.1 References](#)



BANNER 51833858 Condition Monitoring Gateway



Selection Guide

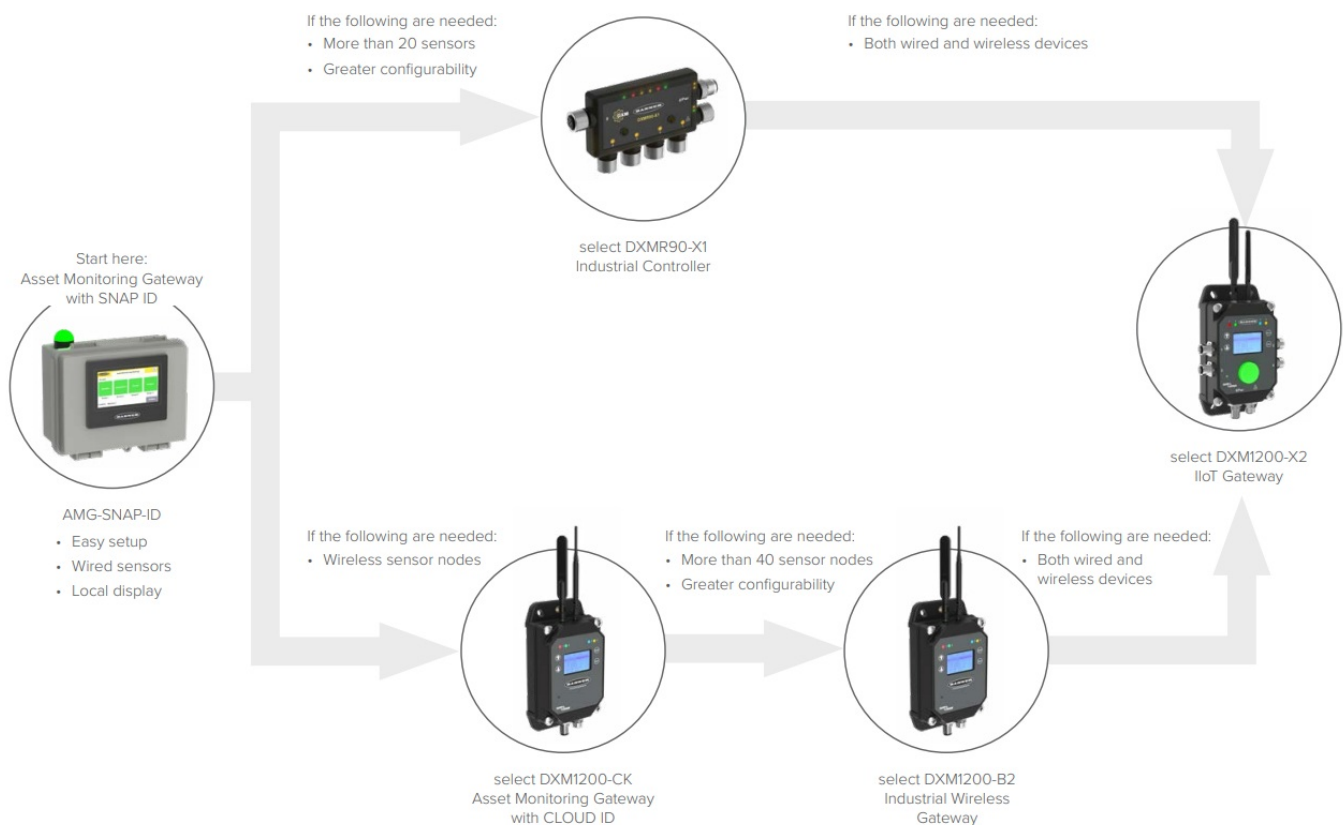

TECHNICAL SPECIFICATION



Model	AMG-SNAP-ID	DXM1200-CK	DXMR90-X1	DXM1200-B2	DXM1200-X2
Modbus RTU ports	1 male M12 client	1 male M12 client	1 male M12 client/server, 4 female M12 client, 1 female M12 client/server daisy-chainable	1 male M12 client	1 male M12 client/server, 4 female M12 client
Wireless radios		Performance radios (900 MHz or 2.4 GHz)		Performance or MultiHop radios (900 MHz or 2.4 GHz)	Performance or MultiHop radios (900 MHz or 2.4 GHz)
Ethernet port	M12 D-Code internet connection	M12 D-Code internet connection	M12 D-Code Ethernet/IP, Modbus/TCP, PROFINET	M12 D-Code Ethernet/IP, Modbus/TCP, PROFINET	M12 D-Code Ethernet/IP, Modbus/TCP, PROFINET
Cellular modem	Optional Verizon, AT&T, or Worldwide CAT M1	Optional Verizon, AT&T, or Worldwide CAT M1		Optional Verizon, AT&T, or Worldwide CAT M1	Optional Verizon, AT&T, or Worldwide CAT M1
User interface	4.1 inch touch screen	LCD screen		LCD screen	LCD screen
Indication	30 mm RGB status indicator	4 configurable LEDs	6 configurable LEDs, 9 status LEDs	4 configurable LEDs	4 configurable LEDs and 30 mm configurable RGB status indicator
Programming and configuration	Auto-configurable with SNAP ID	Auto-configurable with CLOUD ID	User configurable with action rules and scripting	User configurable with action rules and scripting	User configurable with action rules and scripting
Compatible devices	Banner devices with SNAP ID	Banner devices with CLOUD ID	Modbus RTU devices	Banner wireless nodes	Banner wireless nodes, Modbus RTU devices
Banner Cloud Data Services (CDS)	Optional (auto-configured, but user customizable)	Required (auto-configured, but user customizable)	Optional (user customizable)	Optional (user customizable)	Optional (user customizable)

Banner Engineering Corp.

1-[888-373-6767](tel:888-373-6767) • www.bannerengineering.com

© 2024 Banner Engineering Corp. Minneapolis, MN USA

Documents / Resources

	<p>BANNER 51833858 Condition Monitoring Gateway [pdf] User Guide</p> <p>51833858 Condition Monitoring Gateway, 51833858, Condition Monitoring Gateway, Monitoring Gateway, 51833858 Gateway</p>
--	--

References

- [Banner Engineering | Smarter Automation. Better Solutions.](#)
- [User Manual](#)

[Manuals+](#), [Privacy Policy](#)

This website is an independent publication and is neither affiliated with nor endorsed by any of the trademark owners. The "Bluetooth®" word mark and logos are registered trademarks owned by Bluetooth SIG, Inc. The "Wi-Fi®" word mark and logos are registered trademarks owned by the Wi-Fi Alliance. Any use of these marks on this website does not imply any affiliation with or endorsement.