

 **Bambu
Lab**
**K016 Endless
Loop Express
Kit**



Bambu Lab K016 Endless Loop Express Kit Installation Guide

[Home](#) » [Bambu Lab](#) » Bambu Lab K016 Endless Loop Express Kit Installation Guide 

Contents

- [1 Bambu Lab K016 Endless Loop Express Kit](#)
- [2 Specifications](#)
- [3 Product Usage Instructions](#)
- [4 Assembly Instruction](#)
- [5 Frequently Asked Questions](#)
- [6 Documents / Resources](#)
 - [6.1 References](#)



Bambu Lab K016 Endless Loop Express Kit



Specifications

- **Product Name:** Endless Loop Express
- **Components:** Motor, screws, glue, switch, battery, geared wheel, cockpit cover, pulley, tracks
- **Assembly Required:** Yes

Product Usage Instructions

Motor Installation

- Pay attention to the direction of the motor's wires. Ensure the orange arrow indicates the correct direction.

Bottom Screws Adjustment

- Adjust the depth of the bottom screws until they can be inserted into the mating part securely.

Glue Application

- Apply glue on the red surface to assemble the mating part. Fold down the battery terminals after inserting the mating part.

Switch Connection

- Connect the switch wires mentioned in step 5 during the switch and wiring installation.

Cockpit Cover Installation

- Lower the cockpit cover vertically, then slide it forward horizontally and tighten the screws.

Engine Activation

- Press down on the train's smokestack to activate the engine.
- Ensure smooth rotation of wheels.

Pulley Assembly

- Assemble the pulley and bond the magnet with glue. Ensure the glue is fully dry before use.

Track Installation

- Insert two tracks into the bracket, place the pulley into the track slot, and glue the tracks together. Confirm installation height using positioning points.

Loop Operation

- Once the pulley is installed, check its smooth movement along the track slot. Attach the toy train securely and press start to begin the loop.

Assembly Instruction

Endless Loop Express

- Install the motor, paying attention to the direction of the motor's wires. Incorrect wire direction will cause the train to be unable to move forward normally. The orange arrow indicates the correct direction for the motor's wires.

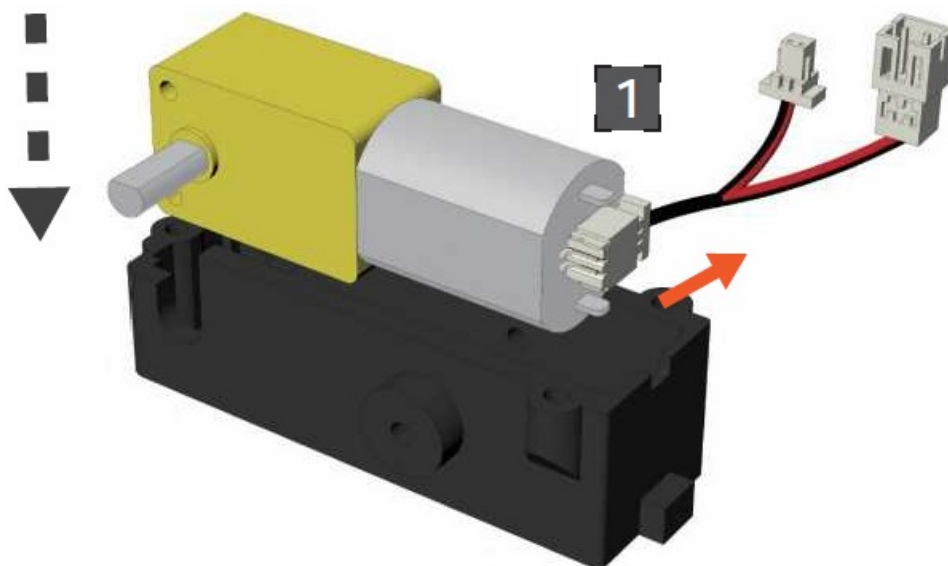

- Adjust the depth of the bottom screws until they can be inserted into the mating part.

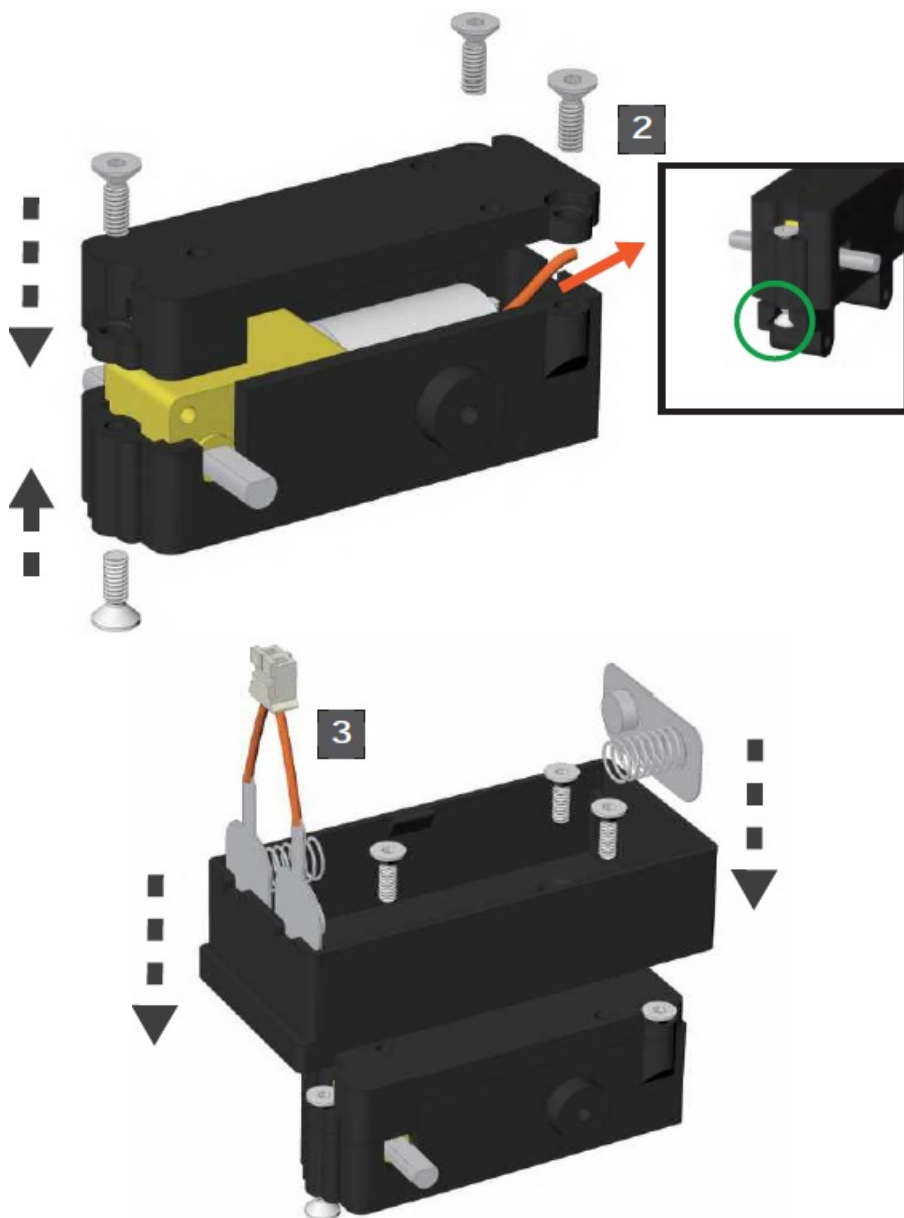

- Apply glue on the “red” surface to assemble the mating part.



- After inserting the mating part, fold down the battery terminals.

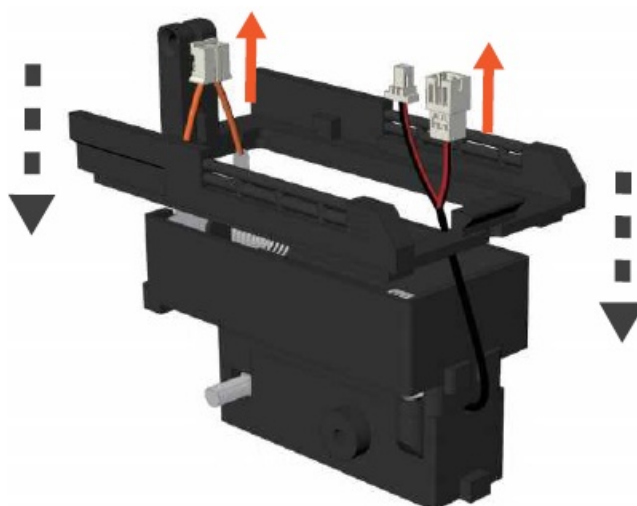

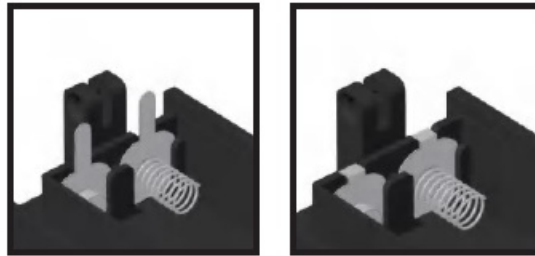

- The other end of the wire is used to connect the switch. In this step, do not connect the switch yet. The switch will be connected in a later step.

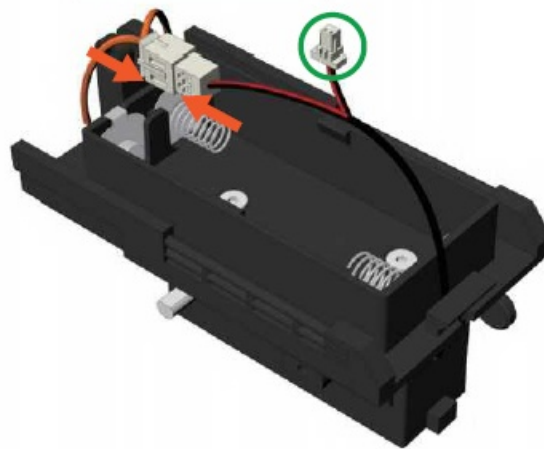

- When installing the geared wheel, align the D-shaped shaft of the motor with the D-shaped hole of the geared wheel.
- To facilitate observation, the wires assembled in the previous steps have been temporarily concealed.

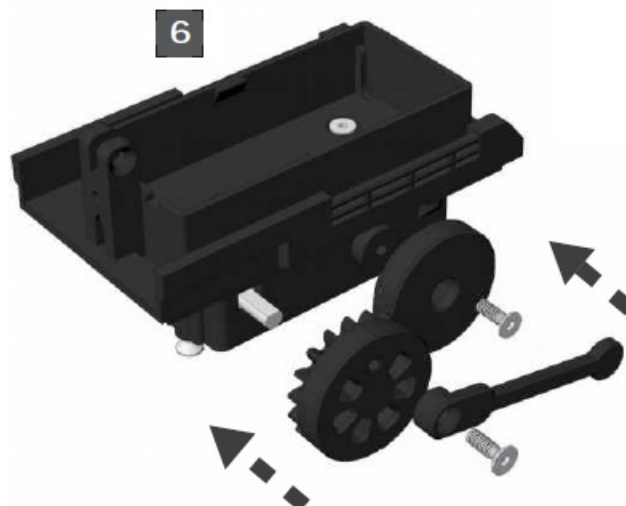

- Apply glue on the “red” surface to assemble the mating part.

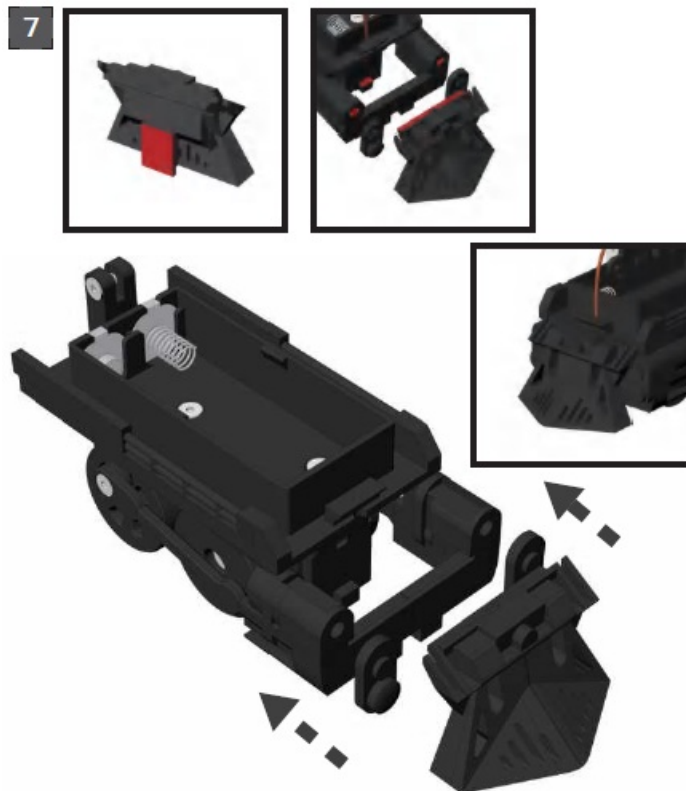

- For reference: Appearance after assembly
- Apply glue on the “red” surface to assemble the mating part.

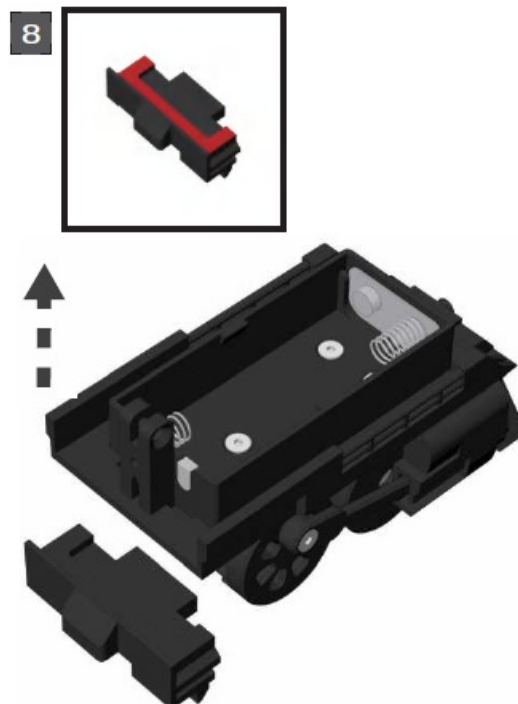

- Install the switch and wiring. Connect the switch wires mentioned in step 5 in this step.



- Install the battery



- **Note** that there are two notches on the assembly structure inside the chimney (switch cap).
- When assembling, align these two notches with the left and right sides of the switch.

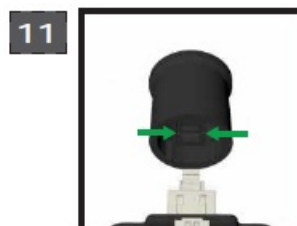

1. Lower the cockpit cover vertically.

2. Slide the cockpit cover forward horizontally and tighten the screws.

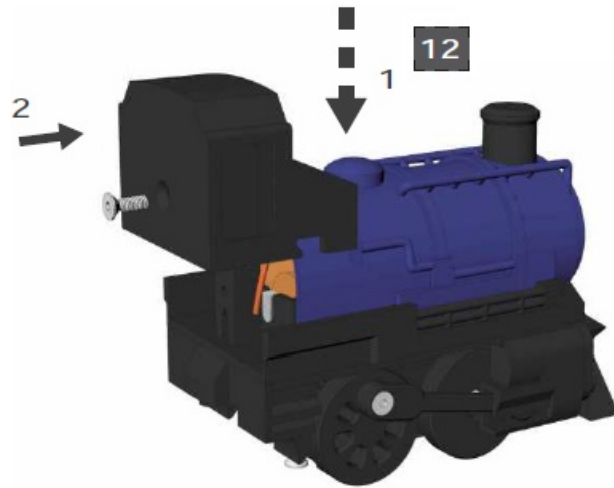

- Press down on the train's smokestack to activate the engine.
- Observe the wheels to ensure they are rotating smoothly



- Assemble the pulley.
- Apply glue to the red surface to bond the magnet.
- **(Note:** Wait for the glue to fully dry, otherwise the magnet may fall off)
- Do not screw too deep, as shown in the figure.

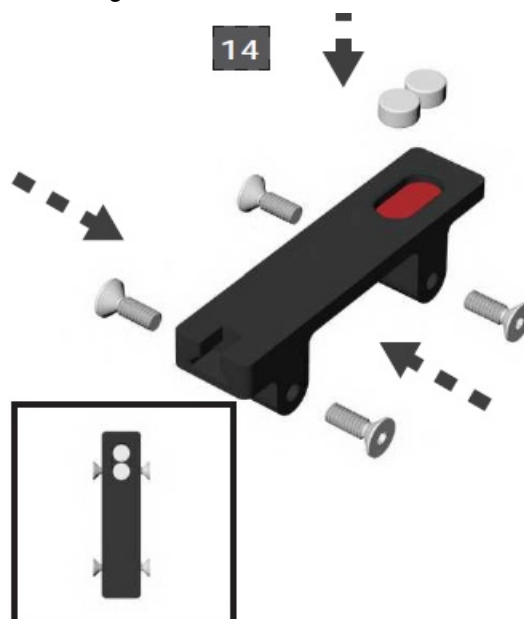

- Apply glue on the "red" surface to assemble the mating part.



- Apply glue on the “red” surface to assemble the mating part.

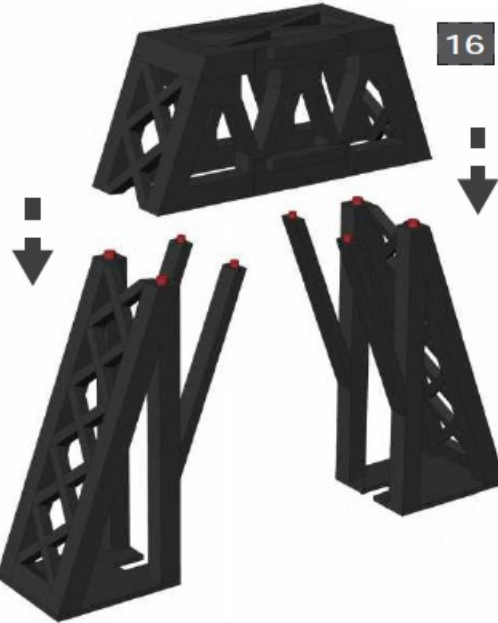

- Apply glue on the “red” surface to assemble the mating part.



- Apply glue on the “red” surface to assemble the mating part.

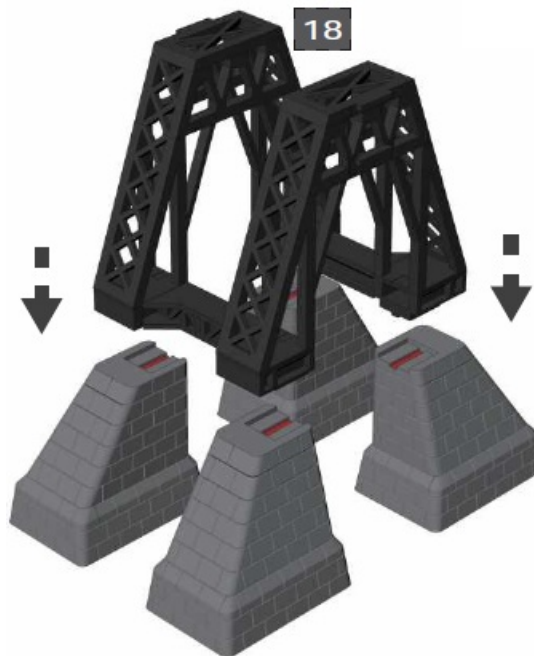

- Use the four positioning points on the track to confirm the installation height of the track relative to the bracket.
- Insert the two tracks into the bracket, then place the pulley into the track slot, and finally, glue the two tracks together.
- Once the pulley is installed on the track, check if it can move smoothly along the track slot.

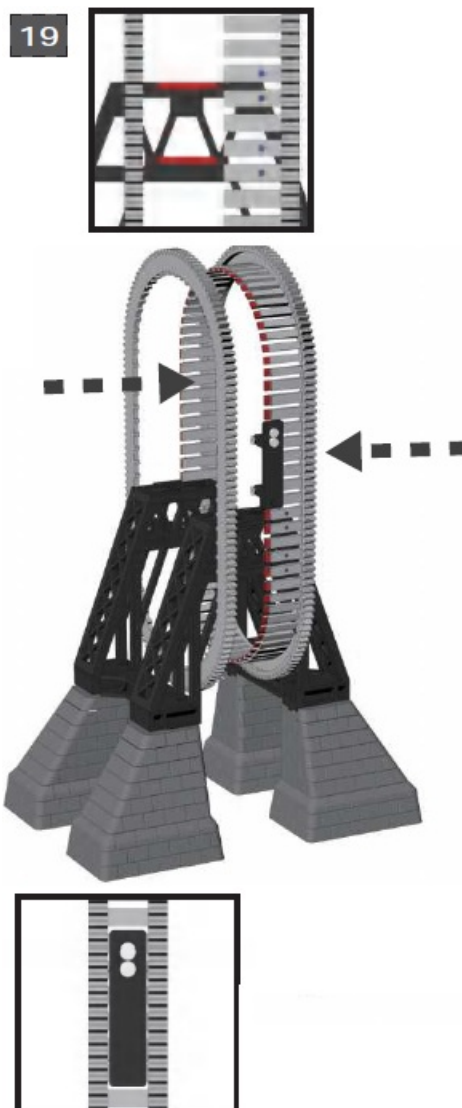

- Attach the toy train to the pulley, and confirm that it is securely installed.

20

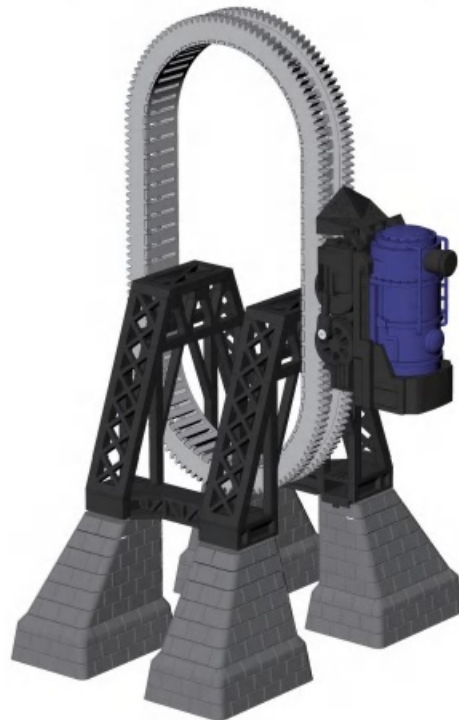
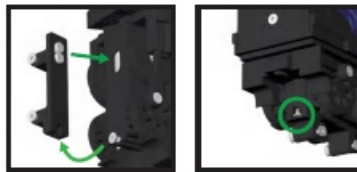

- Press start, start the loop!

Frequently Asked Questions

- **Q: What should I do if the train does not move forward normally?**
 - **A:** Check the direction of the motor's wires and ensure they are correctly aligned as per the orange arrow indicator.
- **Q: How can I ensure the pulley moves smoothly along the track?**
 - **A:** Confirm proper installation by checking that the pulley moves freely along the track slot without any obstructions.

Documents / Resources

--	--

[Bambu Lab K016 Endless Loop Express Kit](#) [pdf] Installation Guide
016, K016 Endless Loop Express Kit, Endless Loop Express Kit, Loop Express Kit, Express Kit

--	--

References

- [User Manual](#)

[Manuals+](#), [Privacy Policy](#)

This website is an independent publication and is neither affiliated with nor endorsed by any of the trademark owners. The "Bluetooth®" word mark and logos are registered trademarks owned by Bluetooth SIG, Inc. The "Wi-Fi®" word mark and logos are registered trademarks owned by the Wi-Fi Alliance. Any use of these marks on this website does not imply any affiliation with or endorsement.