



Bambu Lab AMS AMS automatic Material System User Guide

[Home](#) » [Bambu Lab AMS](#) » Bambu Lab AMS AMS automatic Material System User Guide 

Contents

- [1 Bambu Lab AMS AMS automatic Material System](#)
- [2 Product Information](#)
- [3 Product Usage Instructions](#)
- [4 Instruction Warning](#)
- [5 Component Introduction](#)
- [6 Accessory Specification](#)
- [7 AMS Assembly](#)
- [8 Filament Pre-Loading](#)
- [9 Documents / Resources](#)
- [10 Related Posts](#)



Bambu Lab AMS AMS automatic Material System



Product Information

- **Product Name:** [Product Name]
- **Model Number:** [Model Number]
- **Manufacturer:** [Manufacturer]
- **Product Dimensions:** [Product Dimensions]

Product Usage Instructions

1. Unboxing and Setup:

- Remove the product from its packaging.
- Ensure all included accessories are present.
- Place the product on a stable surface.
- Connect the necessary cables and power adapter.
- Plug in the power adapter and switch on the product.

2. Basic Functionality:

- Familiarize yourself with the product's control buttons and interface.
- Refer to the user manual for specific instructions on using different features.
- Use the power button to turn the product on and off.
- Adjust settings such as volume, brightness, and language preferences as needed.

3. Advanced Features:

- To access advanced features, navigate through the product's menu using the provided controls.
- Explore different modes and settings to customize your experience.
- Refer to the user manual for detailed instructions on using advanced features.

4. Maintenance and Cleaning:

- Regularly clean the product's surface using a soft, lint-free cloth.
- Avoid using liquid or abrasive cleaners that may damage the product.

- Keep the product away from excessive heat, moisture, and direct sunlight.
- Refer to the user manual for specific maintenance guidelines.

5. Troubleshooting:

- If you encounter any issues with the product, refer to the troubleshooting section in the user manual.
- Contact our customer support for further assistance if necessary.

Please review the entire guide before operating the AMS

- **Safety Notice:** Do not connect to power until the assembly is complete.

Instruction Warning

- When operating the AMS, we recommend using Bambu Filament, which has been thoroughly tested to work with the AMS.
- Please make sure to avoid using soft materials like TPU or damp PVA, as they can get stuck in the AMS.
- AMS supports a spool width of 50 mm – 68 mm. We highly recommend using filament with plastic spools that fit correctly inside the AMS. If you prefer to use cardboard spools, we strongly advise using a spool adapter to reduce the risk of slippage and debris getting left behind in the AMS.
- If you run into any issues with specific filaments, please let us know so that we can provide better advice to our community.



Component Introduction

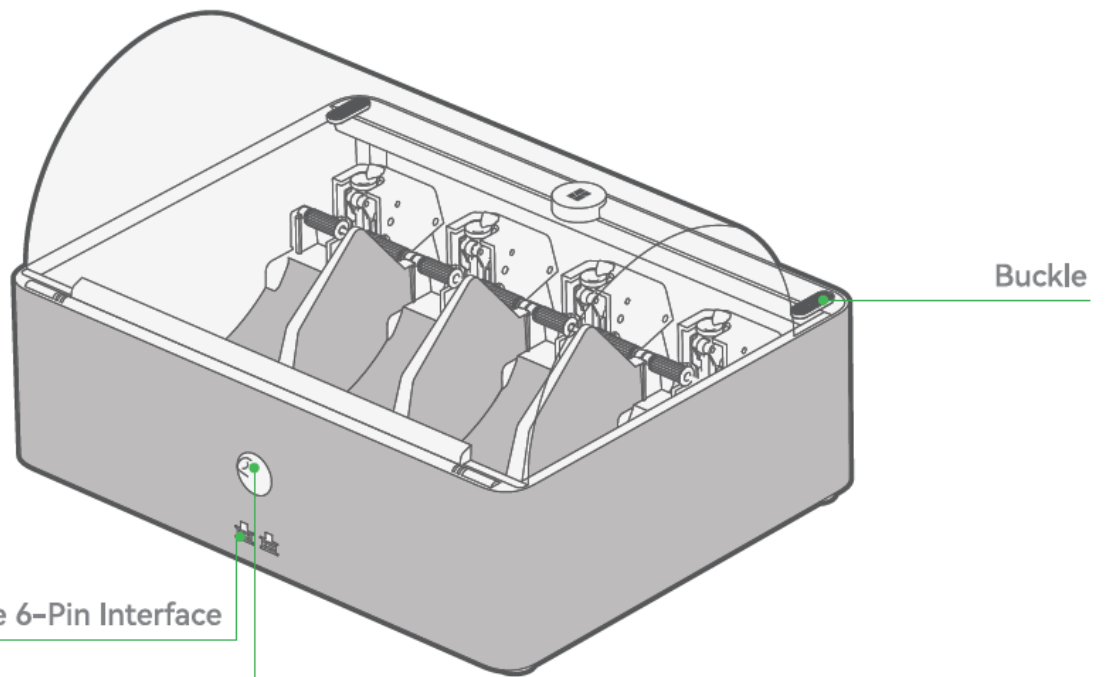

Filament Outlet

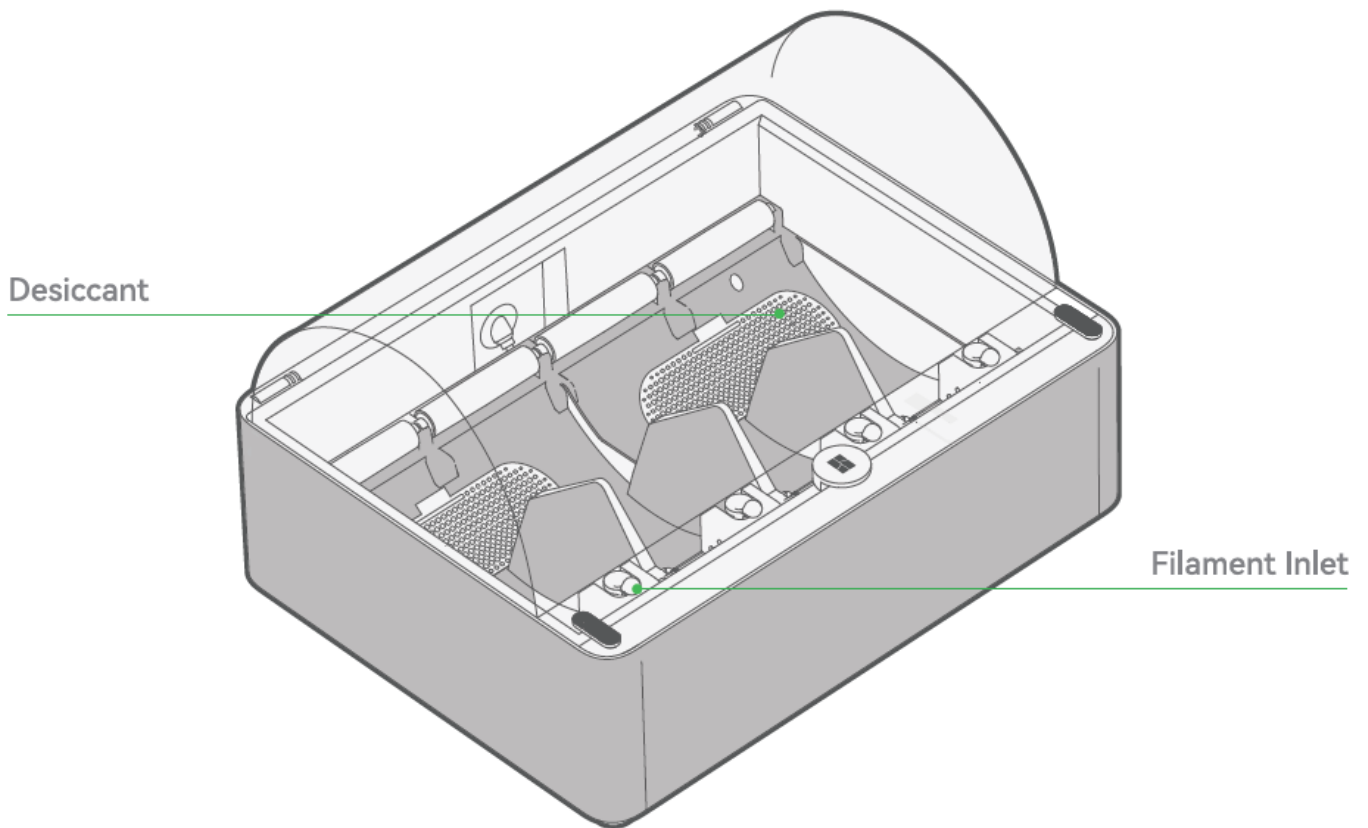

Accessory Specification

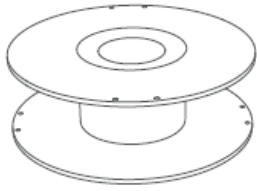

Bambu Reusable Spool (x4)

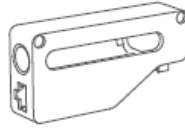

Filament Buffer

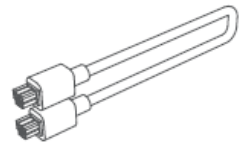

Bambu Bus Cable-4Pin

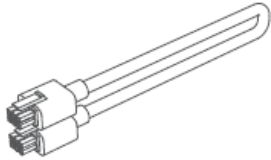

Bambu Bus Cable-6Pin

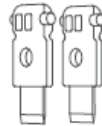

Spare Filament Cutter(x2)



PTFE Tube



PTFE Tube Connector

AMS Assembly

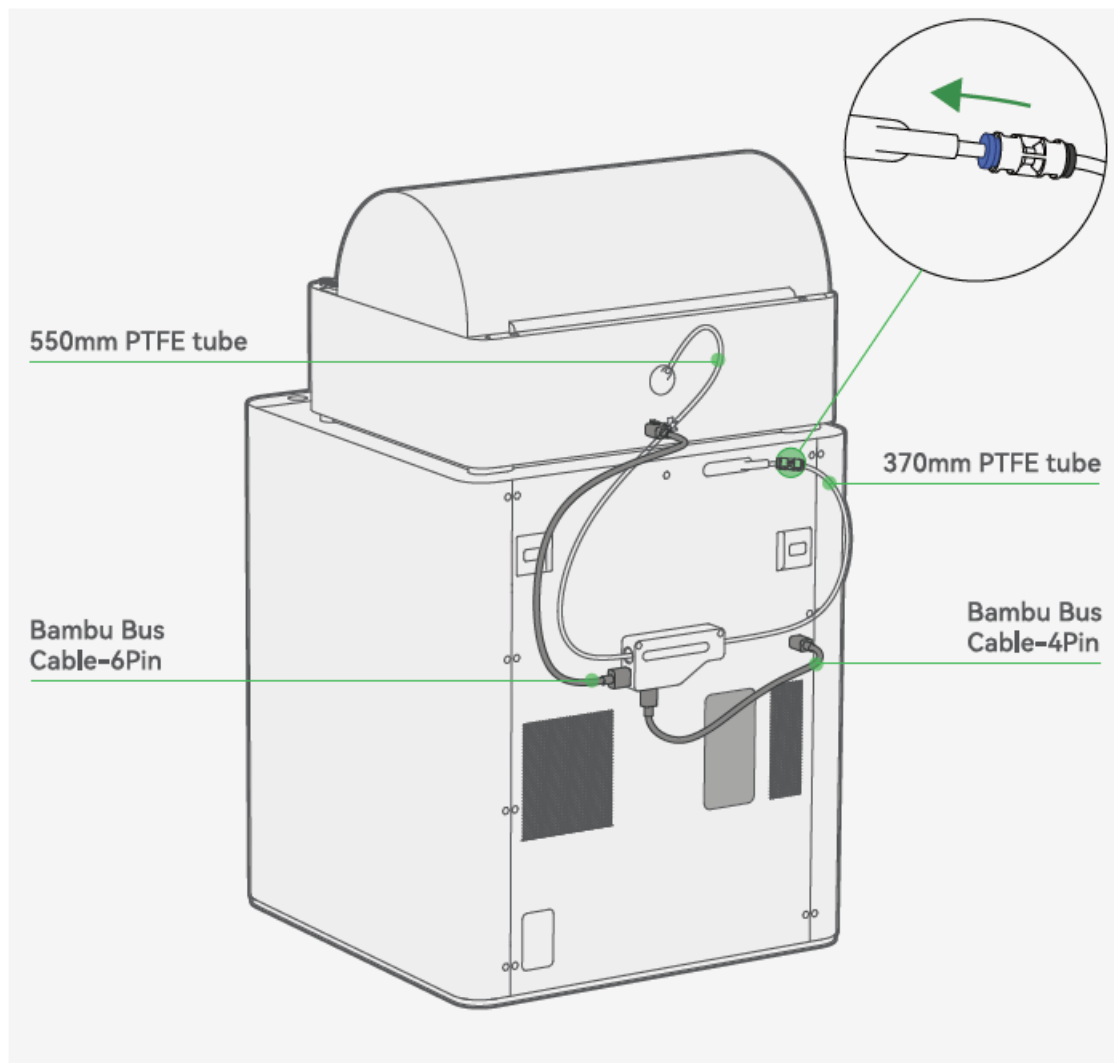

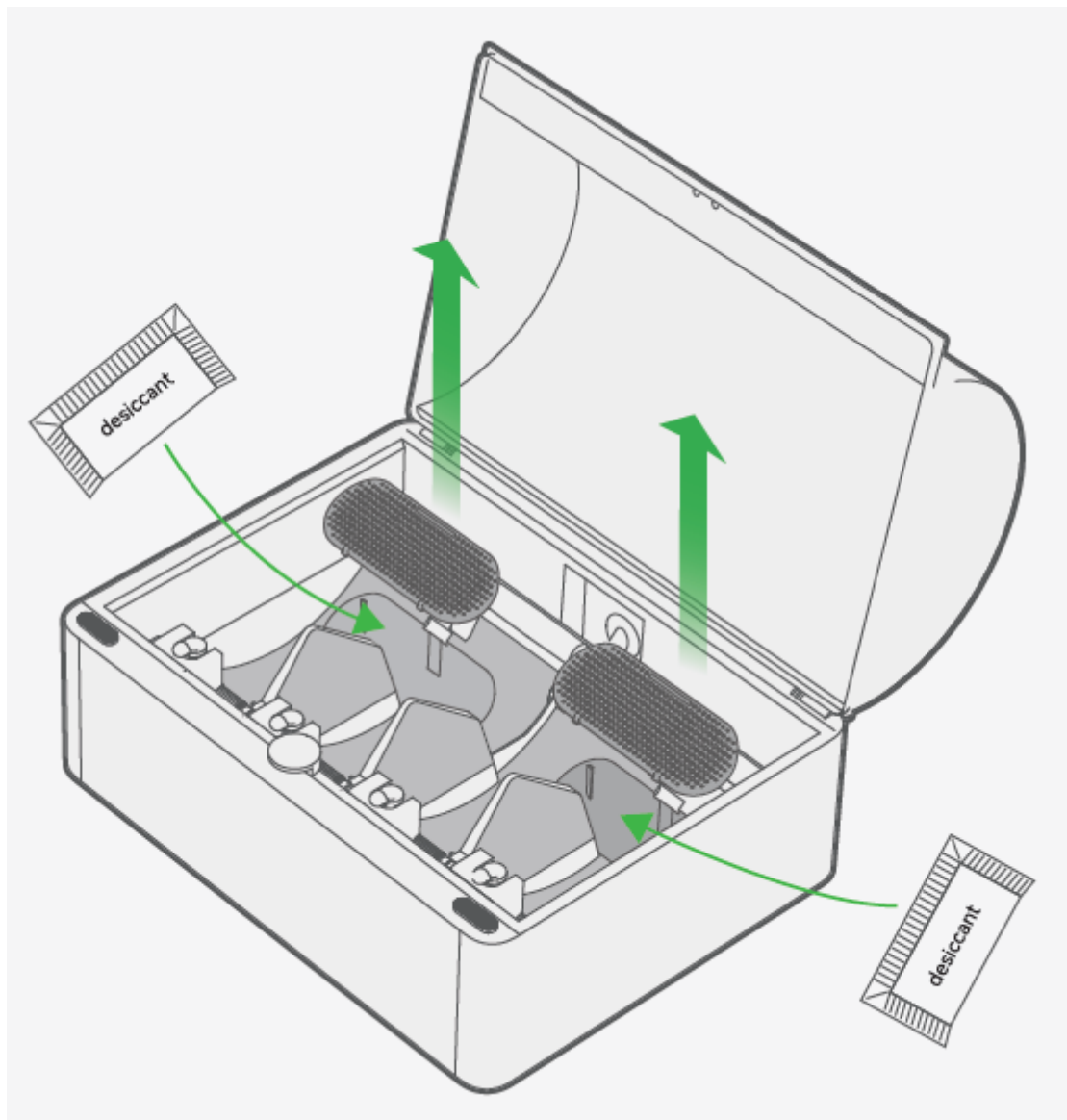

Filament Pre-Loading

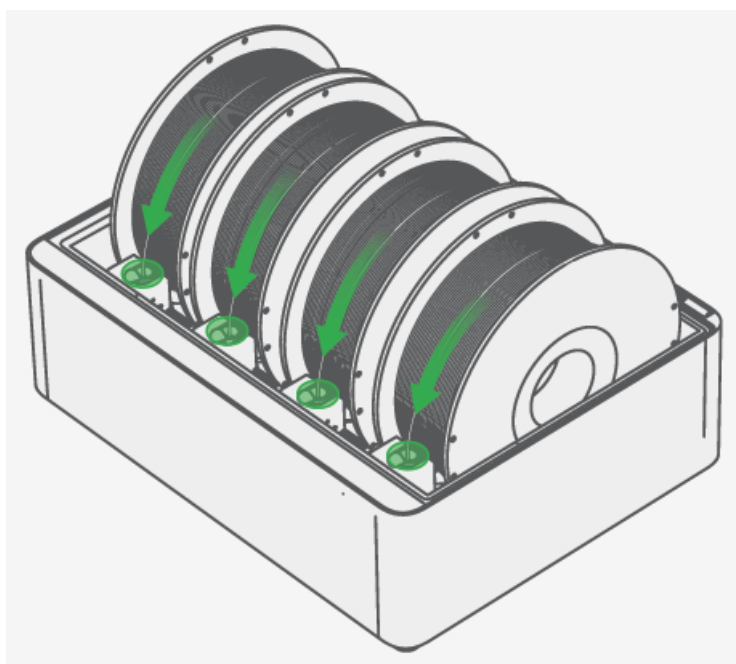

Place at least one spool of Bambu Filament into the AMS. Turn on the power to start the printer and the AMS. Insert the filament into the filament inlet. The filament will be automatically pre-loaded when detected.

If you run into any issues during the guided setup, we are here to help. support@service.bambulab.com.

www.bambulab.com.

Documents / Resources

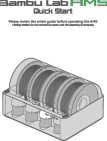
	<p>Bambli Lab AMS AMS utomatic Material System [pdf] User Guide AMS Automatic Material System, AMS, Automatic Material System, Material System, System</p>
---	--

Manuals+.