



Baechler DS20U Series Shuttle Barebone PC User Guide

[Home](#) » [Baechler](#) » Baechler DS20U Series Shuttle Barebone PC User Guide 



More information on this product can be found at: <http://bit.ly/DS20U>

Contents

- [1 Product Overview](#)
- [2 Hardware Installation](#)
- [3 Safety Information](#)
- [4 Motherboard Illustration](#)
- [5 Jumper Settings](#)
- [6 Documents / Resources](#)
 - [6.1 References](#)
- [7 Related Posts](#)

Product Overview

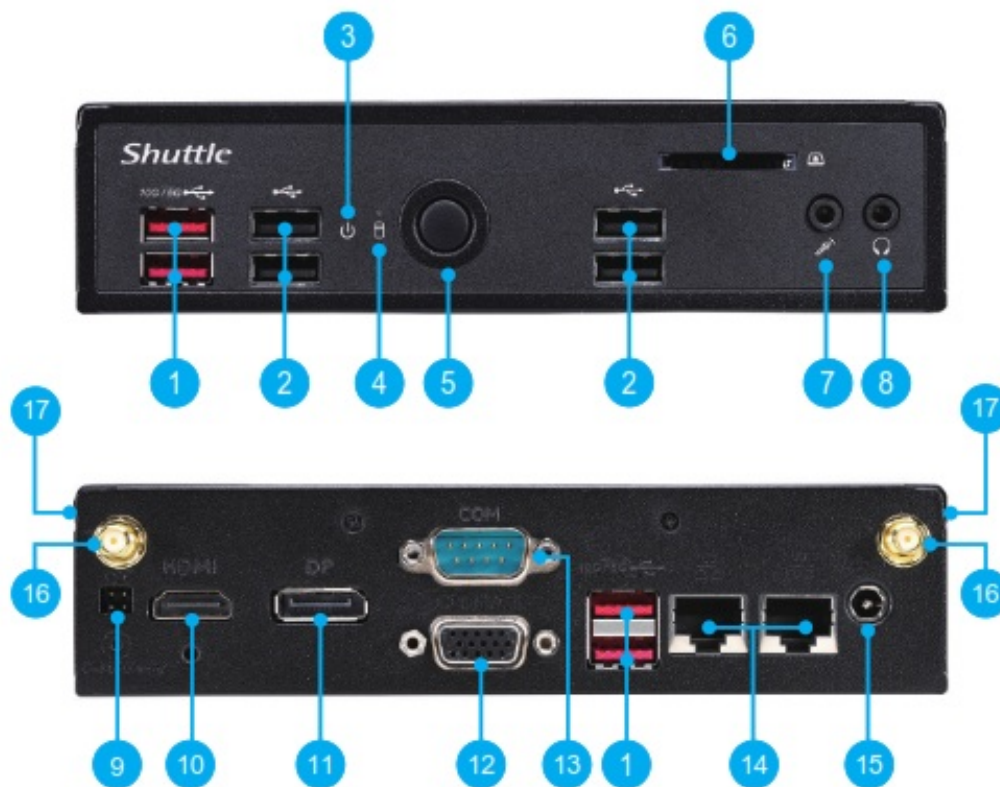

1. USB 3.2 Ports (Celeron → Gen 1, Core I → Gen 2)
2. USB 2.0 Ports
3. Power LED
4. Hard Disk Drive LED
5. Power Button
6. SD Card Reader
7. MIC-in
8. Headphones

9. External Power SW & Clear
10. HDMI Port
11. DisplayPort
12. COM/VGA Port (RS232 or
13. COM Port (RS232/RS422
14. LAN Ports (Gigabit LAN)
15. Power Jack (DC IN)
16. Connector for WLAN ante
17. Kensington® Lock Hole

Hardware Installation

A. Begin Installation



For safety reasons, please ensure that the power cord is disconnected before opening the case.

1. Unscrew the two screws of the chassis cover. Slide the cover backward and upwards.

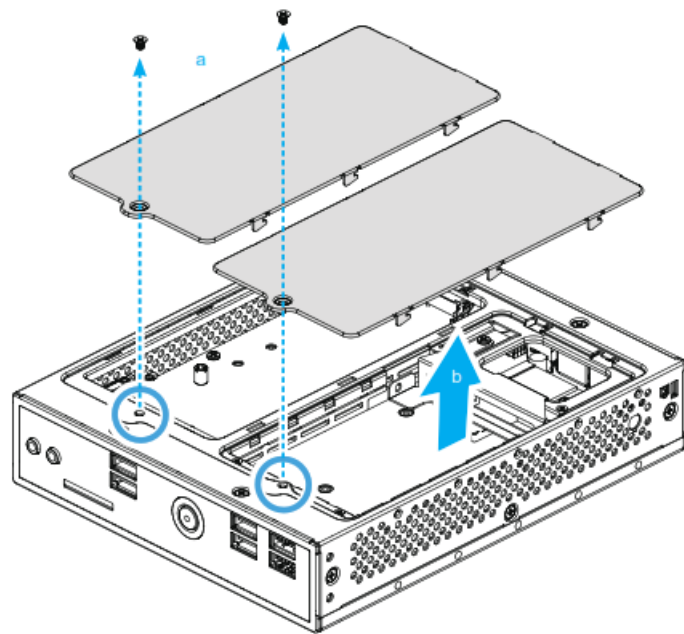

The product's color and specifications may vary from the actual shipping product.

B. HDD or SSD Installation

1. Unfasten the rack mount screw and remove the rack.

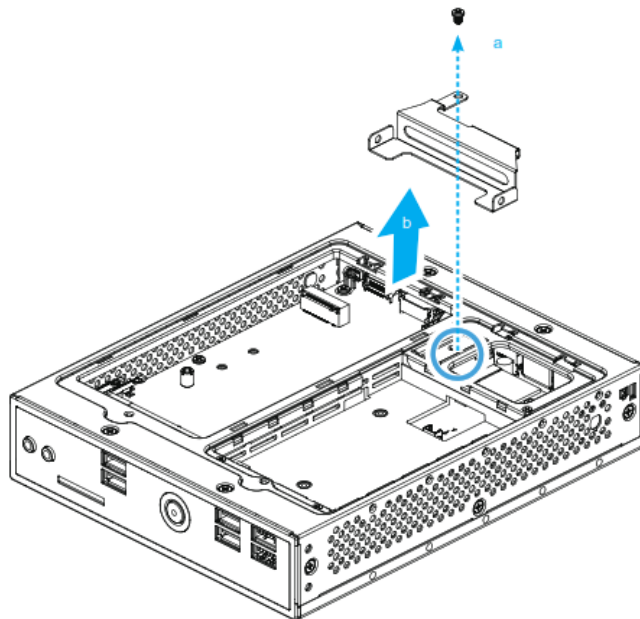

2. Place an HDD or SSD in the rack and secure it with two screws from each side.

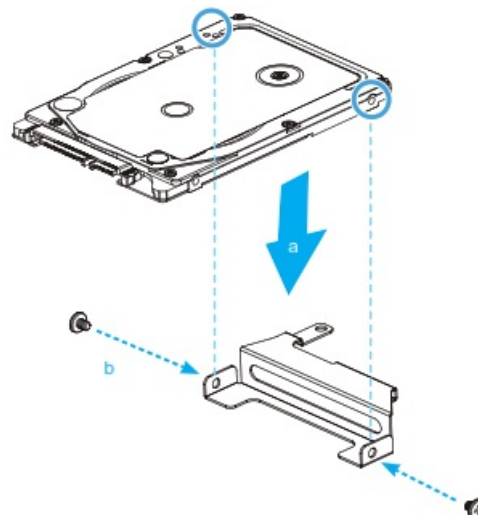

3. Lay the HDD or SSD into its drive bay and push it gently to the right until it clicks into place. Refasten screws.

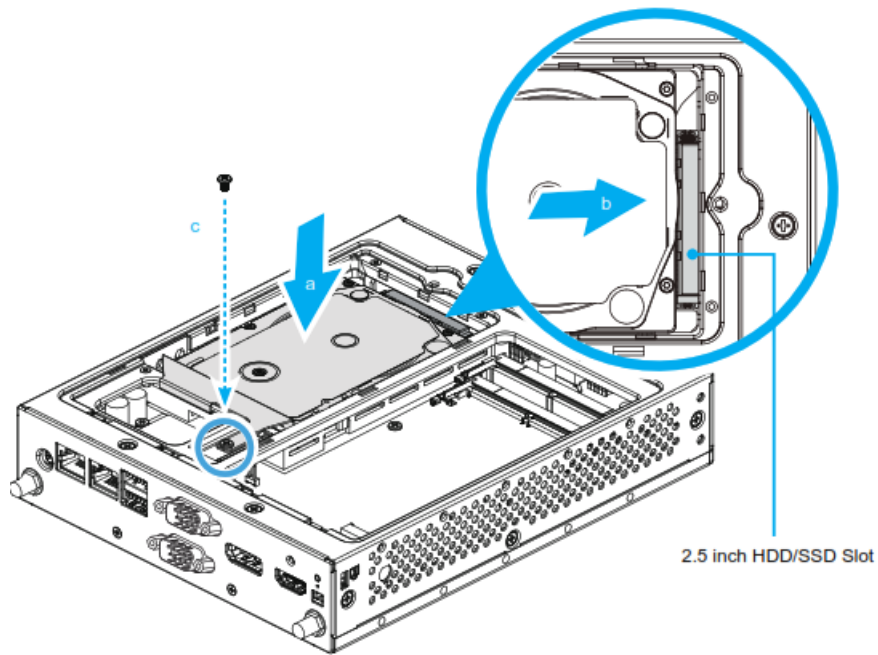

C. Memory Module Installation



This motherboard does only support 1.2 V DDR4 SO-DIMM memory modules.

1. Locate the SO-DIMM slots on the motherboard.
2. Align the notch of the memory module with one of the relevant memory slots.
3. Gently insert the module into the slot at a 45-degree angle.
4. Carefully push down the memory module until it snaps into the locking mechanism.

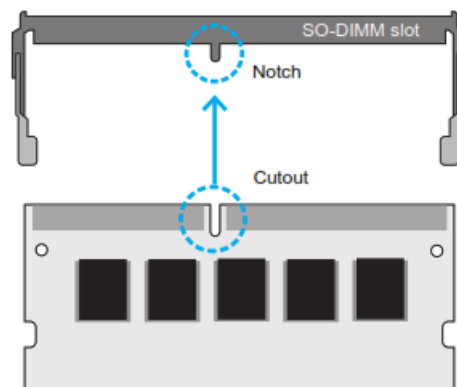

5. Repeat the above steps to install an additional memory module, if required.

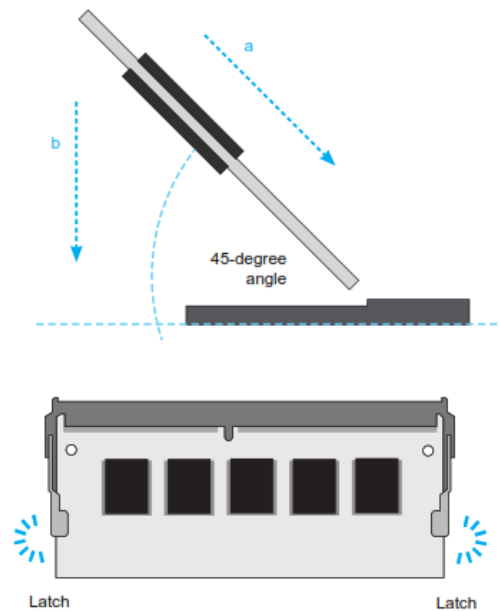

D. M.2 Device Installation

1. Locate the M.2 key slots on the motherboard.
2. Install the M.2 device into the M.2 slot and secure it with the screw.

M.2 2242/2260/2280 M key slot

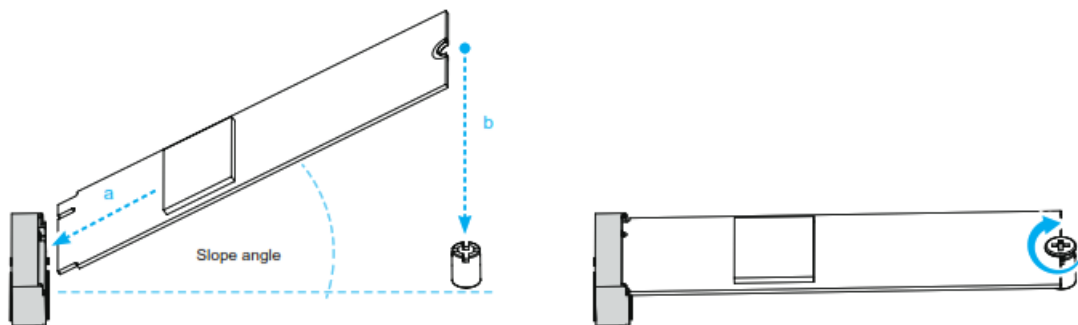

E. Complete

1. Please replace and affix the case cover with two screws. Turn your DS20U upside down.
2. Connect the power cord.
3. Complete.

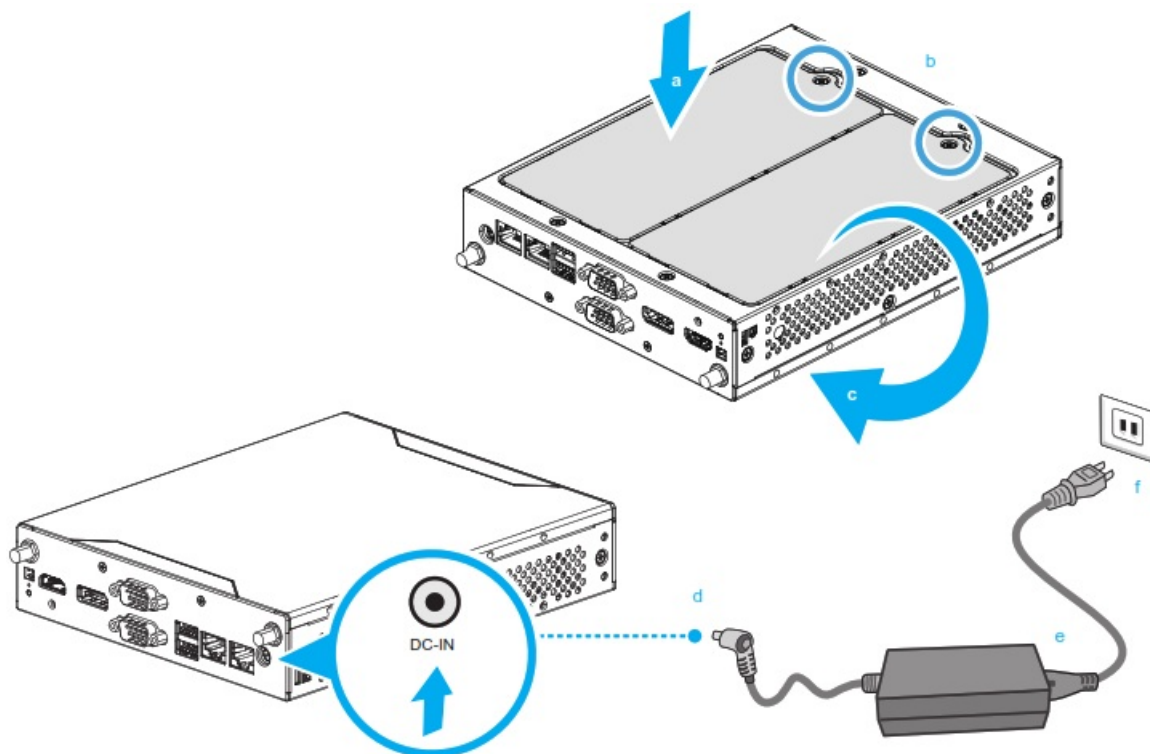

Please press the “Del” key while booting to enter BIOS. Here, please load the optimized BIOS settings.
Operation Position: Please make sure to use either the supplied feet or the VESA mount.

Safety Information



Incorrectly replacing the battery may damage this computer. Replace only with the same or equivalent as recommended by Shuttle. Dispose of used batteries according to the manufacturer’s instructions.

All bundled parts, power cord included, shall not be used without this product.

This device complies with Part 15 of the FCC Rules. Operation is subject to the following two conditions:

1. this device may not cause harmful interference, and
2. this device must accept any interference received, including interference that may cause undesired operation.



This device meets the requirements for EU conformity in accordance with the currently valid EU directives.

Product Overview

1. USB 3.2 Ports
2. USB 2.0 Ports
3. Power LED
4. Hard Disk Drive LED
5. Power Button
6. SD Card Reader
7. MIC-in
8. Headphones

9. External Power SW & Clear CM
10. HDMI Port
11. DisplayPort
12. COM/VGA Port (RS232 only)
13. COM Port (RS232/RS422/RS485)
14. LAN Ports (Gigabit LAN)
15. Power Jack (DC IN)
16. Connector for WLAN antenna
17. Kensington® Lock Hole

Hardware Installation

A. Begin Installation



For safety reasons, please ensure that the power cord is disconnected before opening the case.

1. Unscrew the two screws of the chassis cover. Slide the cover backward and upwards.

B. HDD or SSD Installation

1. Unfasten the rack mount screw and remove the rack.
2. Place the HDD or SSD in the rack and secure it with two screws from each side.
3. Lay the HDD or SSD into its drive bay and push it gently to the right until it clicks into place. Refasten screws.

The product's color and specifications may vary from the actually

C. Memory Module Installation



This motherboard does only support 1.2 V DDR4 SO-DIMM memory modules.

1. Locate the SO-DIMM slots on the motherboard.
2. Align the notch of the memory module with one of the relevant memory slots.
3. Gently insert the module into the slot at a 45-degree angle.
4. Carefully push down the memory module until it snaps into the locking mechanism.
5. Repeat the above steps to install an additional memory module, if required.

D. M.2 Device Installation

1. Locate the M.2 key slots on the motherboard.
2. Install the M.2 device into the M.2 slot and secure it with the screw.

E. Complete

1. Please replace and affix the case cover with two screws. Turn your DS20U upside down.
2. Connect the power cord.
3. Complete.



Please press the “Del” key while booting to enter BIOS. Here, please load the optimized BIOS settings.
Operation Position: Please make sure to use either the supplied feet or the VESA mount.

Motherboard Illustration

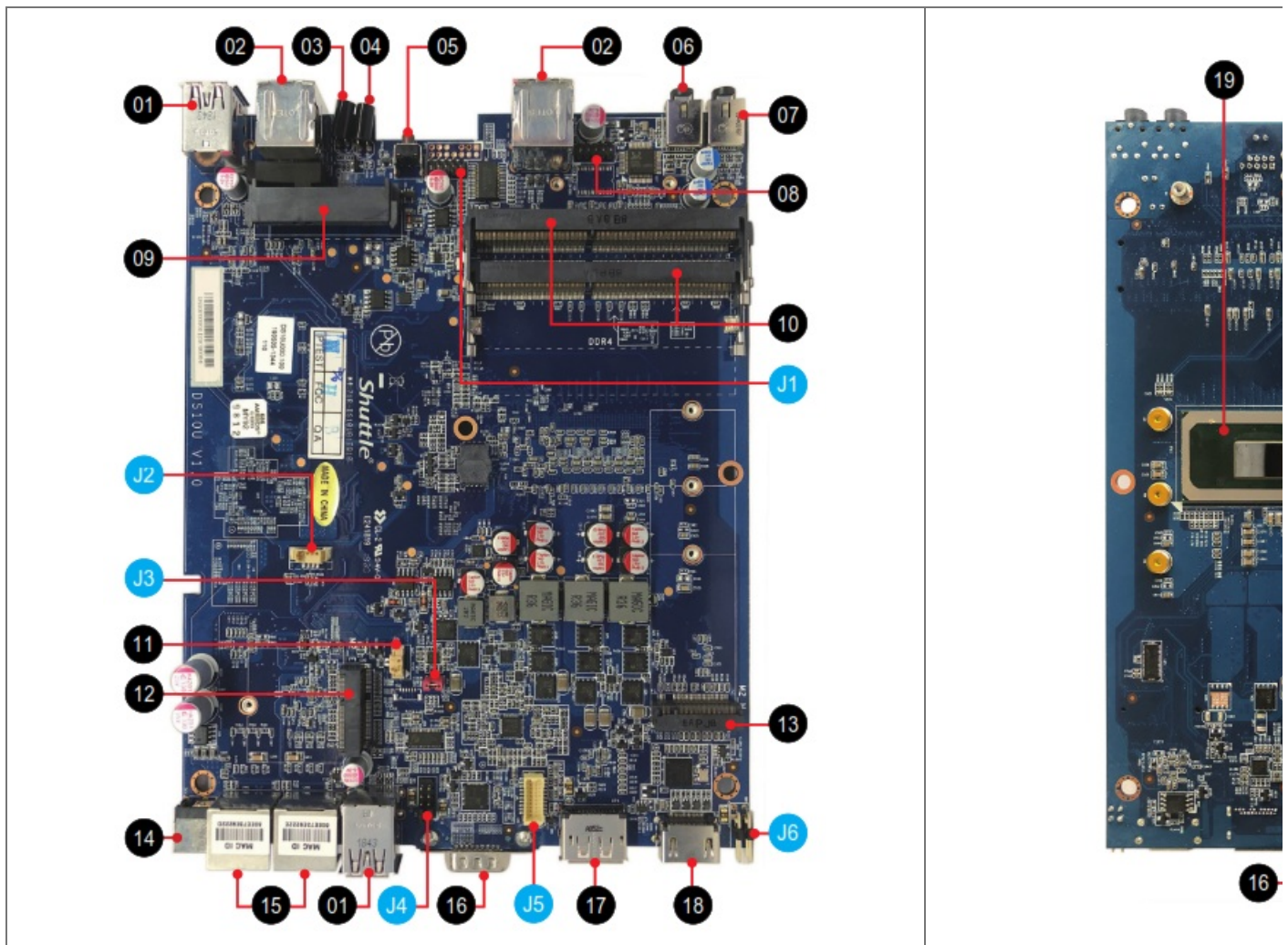

- 01. USB 3.2 Ports (Celeron → Gen 1, Core I → Gen 2)
- 02. USB 2.0 Ports
- 03. Power LED
- 04. Hard Disk Drive LED
- 05. Power Button
- 06. MIC-in
- 07. Headphones
- 08. Debug Header
- 09. 2.5-inch HDD/SSD Slot
- 10. DDR4 SO-DIMM Slots

- 11. Battery Connector
- 12. M.2 2230 E Key Slot
- 13. M.2 2242/2260/2280 M key
- 14. Power jack (DC IN)
- 15. LAN Ports (Gigabit LAN)
- 16. COM Port
- 17. DisplayPort
- 18. HDMI Ports
- 19. Intel® Celeron® / Pentium®
- 20. SD Card Reader FFC Conn

Jumper Settings

J1: COM 2 Port

COM2 (RS232)			
Pin	Signal Name	Pin	Signal Name
1	DCD	2	RDX
3	TXD	4	DR
5	GND	6	DSR
7	RTS	8	CTS
9	RI		

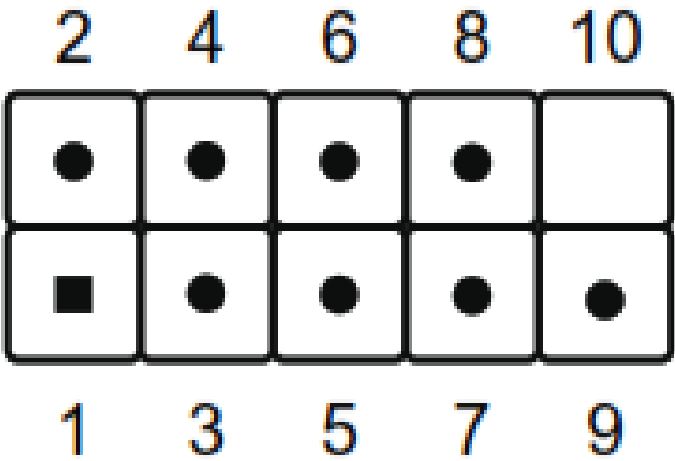

J2: USB 2.0 Connector

USB5	
Pin	Signal Name
1	GND
2	USB_D+
3	USB_D-
4	+5V

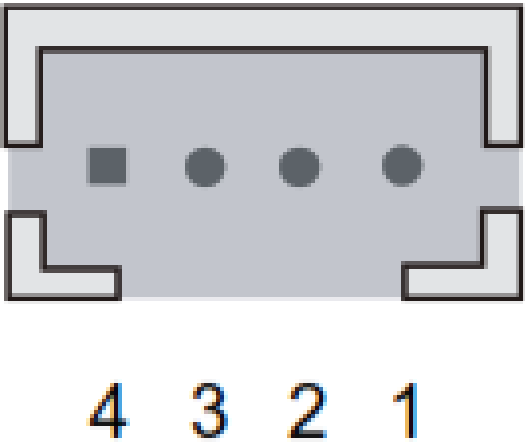

J3: AC Back Auto Power ON

JP9	
Pin	Signal Name
	AM+
	GND

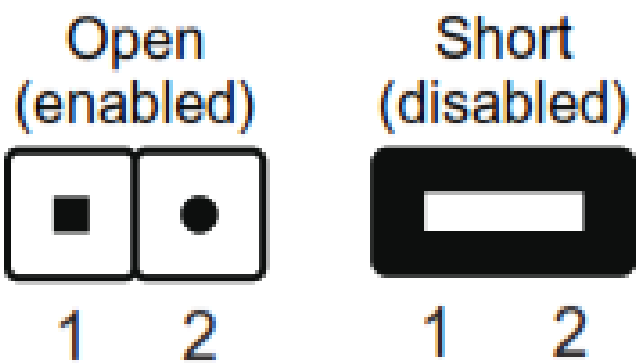

CN6					
Pin	Signal Name	Pin	Signal Name	Pin	Signal Name
1	GND	2	GND	3	SCL
4	GND	5	SDA	6	GND
7	GND	8	GND	9	VSYNC
10	GND	11	HSYNC	12	GND
13	GND	14	GND	15	BOUT
16	+5V	17-Jan	GOUT	18	+5V
19-Jan	ROUT	20-Jan	+5V		

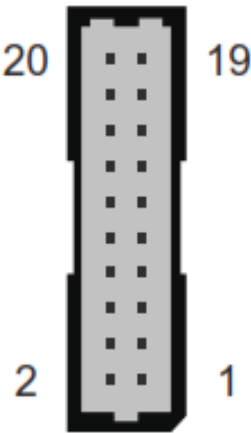

J6: External Power SW & Clear CMOS

SW2			
Pin	Signal Name	Pin	Signal Name
		2	+5V
		4	RACIST-

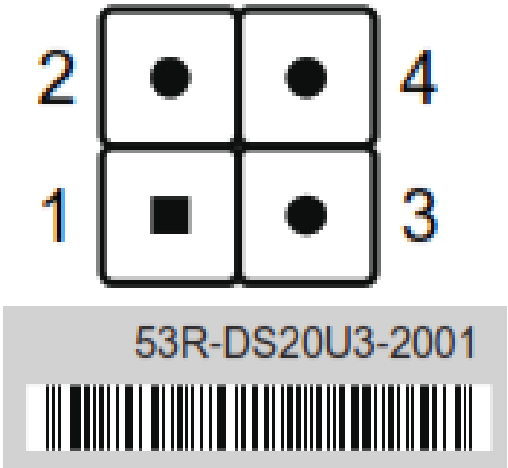

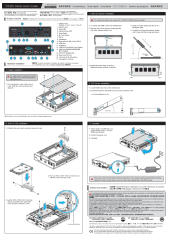

[Baechler DS20U Series Shuttle Barebone PC](#) [pdf] User Guide
DS20U Series Shuttle Barebone PC, DS20U Series, Shuttle Barebone PC, Barebone PC, PC

References

- [Shuttle Global - DS20U SERIES](#)

Manuals+.