



## BACHMANN 702.5000 Series E Power Unit User Manual

[Home](#) » [BACHMANN](#) » BACHMANN 702.5000 Series E Power Unit User Manual 



**MOV:E Power Unit  
Manual**

**Item number:** 702.5000, 702.5001, 702.5100, 702.5101, 702.5090, 702.5091, 702.5190. 702.5191

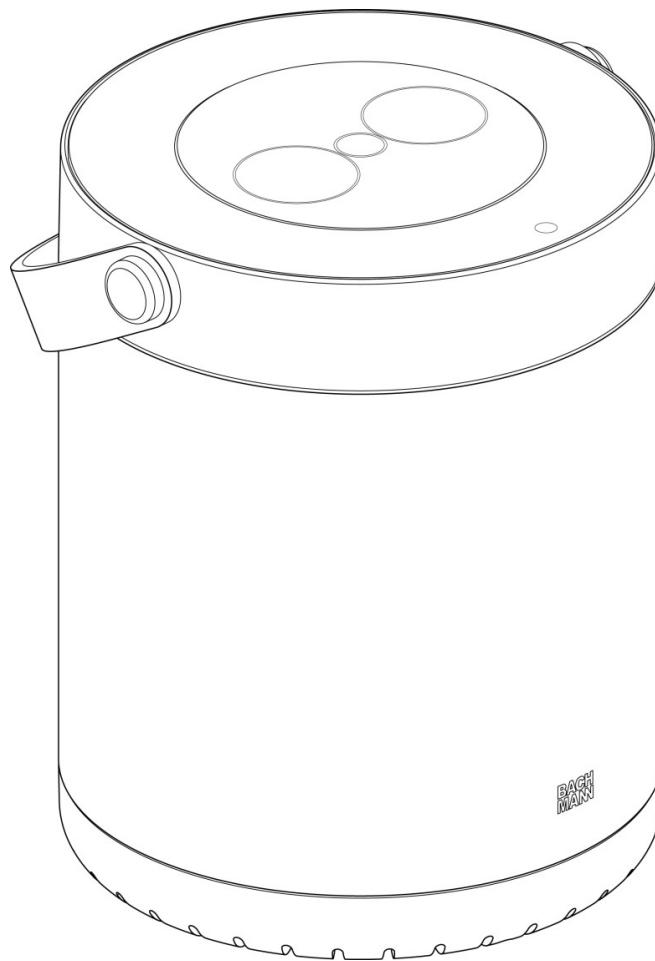

## Contents

- 1 Preamble
- 2 Applicable standards
- 3 Product description
  - 3.1 Scope of delivery
  - 3.2 Product overview
  - 3.3 Technical data
- 4 Operation
  - 4.1 Charging
  - 4.2 Operation
- 5 Transport
- 6 Fault description
- 7 Product description for optional accessories
- 8 Cleaning
- 9 Maintenance and repairs
- 10 Return/disposal
- 11 Customer service
- 12 Documents / Resources
  - 12.1 References
- 13 Related Posts

## Preamble

Before starting to use this product, please read the entire manual and observe all operational and safety information to ensure safe operation.

If you have any problems, questions or suggestions regarding the manual, please contact our customer service department.

## General information

This manual enables safe and proper operation of the MOV:E energy store (item no.: 702.5000, 702.5001, 702.5002, 702.5003). Hereinafter called the "MOV:E power unit". This manual is part of the MOV:E power unit and must therefore be kept. If the MOV:E Power Unit is passed on to third parties, this manual must also be included.

## Copyright

© 2021 by Bachmann GmbH

All rights reserved. The contents of this manual are protected by copyright. They may be used within the scope of operating the MOVE:E power unit. Any other use or reproduction is not permitted without the written consent of Bachmann GmbH. Bachmann GmbH reserves the right to make changes to this manual even without prior communication.



## Safety symbols

Safety instructions are marked with a symbol in this manual. The safety instructions are introduced by signal words that explain the extent of the hazard.

## Liability

The product was developed according to the current state of the art and complies with the currently valid health and safety regulations. However, dangers and risks can arise from incorrect operation or misuse. In particular, Bachmann GmbH shall not be liable for damage to property or personal injury resulting from the following:

- Not using the product as intended
- Disregarding the manual
- Changes to the product made by persons with insufficient qualifications
- Changes to the product that have been made without the express written permission of Bachmann GmbH
- Improper use
- Using the product despite the product being damaged or contaminated
- Wear
- Catastrophic events, effects from extraneous elements and force majeure

Bachmann GmbH is not liable for any damage directly or indirectly attributable to the delivery, performance or use of this manual. All information without guarantee.



## Attention | Warning!

1. Read the entire manual before using the product.
2. Store the product in a cool and dry place.
3. Do not store the product in a hot place (above 45 °C) or in humid environments (above 60% relative humidity).
4. Only use the product in an upright position so that the connection panels are only accessible from above.
5. Using a power supply unit or charging station not recommended or sold by the product manufacturer may result in a risk of fire or injury.
6. The ambient temperature should be between 0 °C and 40 °C.
7. Do not dismantle the product. The product safety, guarantee and warranty expire if the product has been dismantled.

8. It is not allowed to bring the product in contact with chemicals or detergents.
9. Possible damage resulting from misuse, dropping or excessive force.
10. To dispose of secondary batteries or rechargeable batteries of different electrochemical systems, keep them separate from each other.
11. Do not expose the product to mechanical shock, crushing or cutting hazards.
12. Do not short-circuit the product or expose it to short-circuiting by other metal objects.
13. It is not allowed to connect multiple sockets.
14. To reduce the risk of injury, constant supervision is required when using the product around children or keep the product away from children.
15. Do not put fingers or hands into the product.
16. Do not exceed the output power when using the product. Possible risk of fire or injury due to loads above the output power.
17. Do not use the product if it is damaged or altered. Damage or modification to batteries may cause unpredictable behaviour resulting in fire, explosion or injury hazards.
18. Switch off the energy store when it is not in use.
19. Do not dispose of the product via heat or fire.
20. At the end of its service life, dispose of the product in an environmentally friendly manner and in accordance with the applicable regulations for disposal and recycling. Furthermore, the product is subject to regulations for shipping by land, air and sea.

## Applicable standards

1. IEC 62368-1:2018
  2. IEC 63000:2018
  3. UN38.3
  4. IEC 62133-2: 2017
  5. EN IEC 62368 -1 and (-3)
  6. Low Voltage Directive 2014/35/EU
- Made in Germany

## Product description

### Scope of delivery

Bachmann item no.	Component	Description/Functionality
702.50xx	MOV:E Power Unit MOV:E power supply unit Manual	Enables an independent power supply

### Product overview

### MOV:E power unit

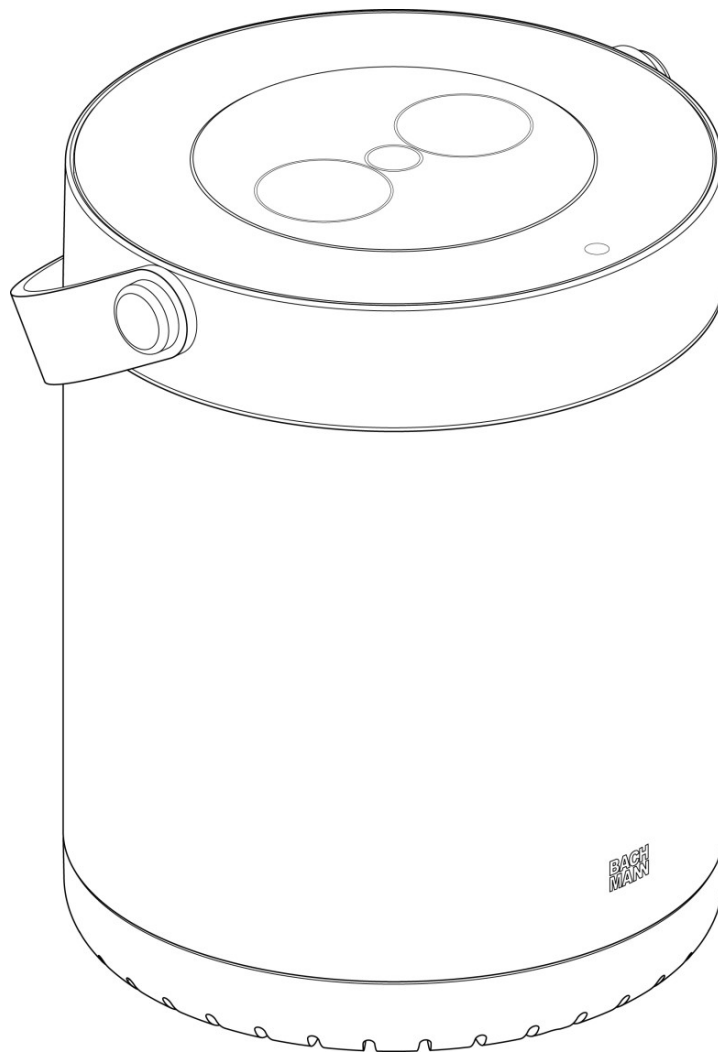

MOV:E power supply unit

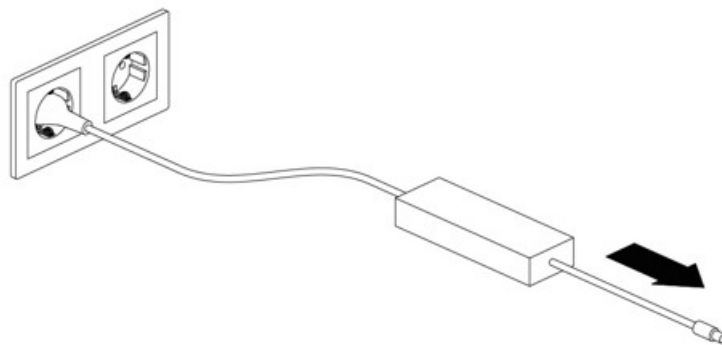

**Technical data**

Item number 702.5000, 702.5001

<b>MOV:E power unit*</b>	Input	24 V DC; 5 A
	AC /CEE7/3 output	
	Voltage	230 V AC, 50 Hz, 150 W
	USB-C output	
	Voltage (V DC)	5 / 9 / 15 / 20
	Current (A)	3
	max. output (W)	15 / 27 / 45 / 60
	USB-A output	
	Voltage (V DC)	5
	Current (A)	3
	max. output (W)	15
	Energy output (max.)	230 W/h
	Dimensions	19x23cm
	Weight	3.1 kg
<b>Power supply unit</b>	Input	100-240 V – 50/60 Hz
	Output	24 V DC; 5 A
	Dimensions Power supply unit: DC cable Supply cable	152×62.5×35.5 cm 1.5 m 1 m
	Weight	640 g

\*Integrated power and thermal management

Item number 702.5100, 702.5101

MOVIE power unit*	Input	24 V DC; 5 A
	USB-C output	
	Voltage (V DC)	5 / 9 / 15 / 20
	Current (A)	3
	max. output (W)	15 / 27 / 45 / 60
	USB-A output	
	Voltage (V DC)	5
	Current (A)	3
	max. output (W)	15
	Energy output (max.)	230 W/h
	Dimensions	19x23cm
	Weight	2.9kg
Power supply unit	Input	100-240 V – 50/60 Hz
	Output	24 V DC; 5 A
	Dimensions Power supply unit: DC cable Supply cable	152×62.5×35.5 cm 1.5 m 1 m
	Weight	640 g

\*Integrated power and thermal management

## Operation

### Charging

Please ensure that the MOV:E power unit is fully charged before using it for the first time.  
When the charge level is low, the first LED in the control panel flashes.



Charge the MOV:E power unit using the power supply unit supplied.



During the charging process, the LED indicator lights up blue.

**Please note: During the charging process, the energy store must stand vertically on a solid and dry surface.**

Charging time: up to 100% approx. 2-3 hours We also recommend using the optional MOV:E charging station (item no. 702.5200)

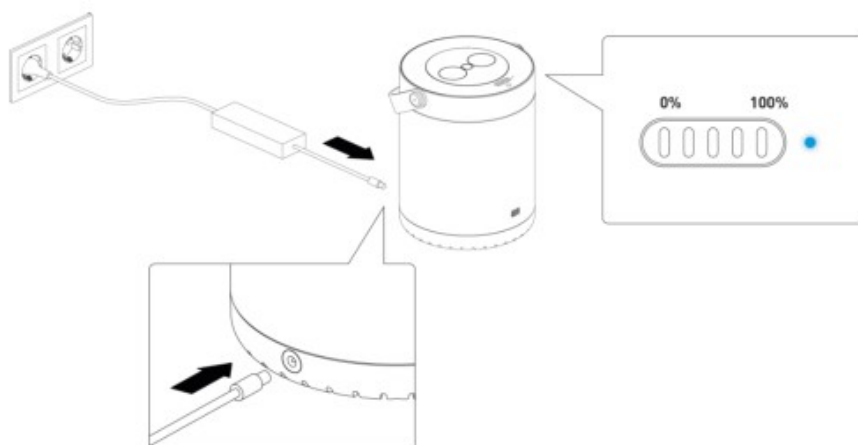

Charging option with optional charging station (Art.№ 702.5200) (not included in the scope of delivery)

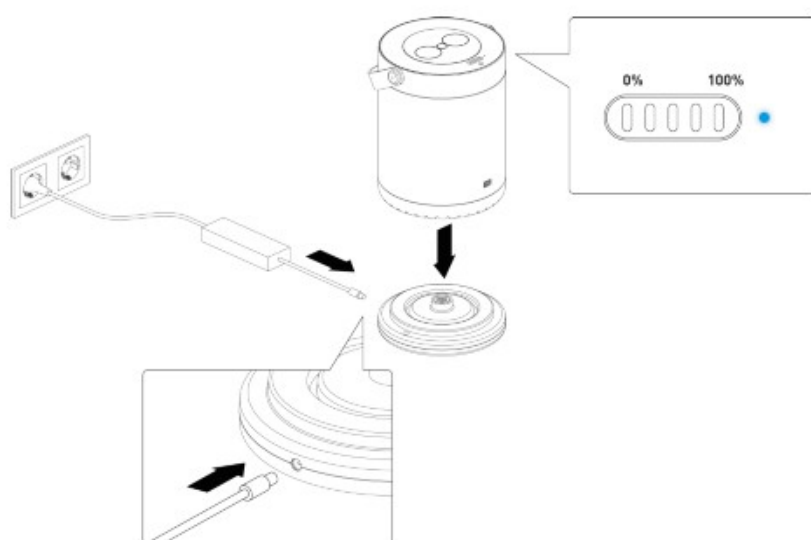

**Note:** Charge the MOV:E Power Unit only with the power supply unit supplied. 16

## Operation

ON / OFF “Switch on/off sensor” for approx. 3-5 seconds by pressing the button. The battery status LEDs flash until the current charge level is determined.



The battery status LEDs indicate the available energy





After approx. 15 minutes without a plug (device), the MOV:E Power Unit switches off automatically.  
As soon as a plug (device) is plugged in, the connected device is supplied with power.  
Open the connection panel by pressing and turning the cover.

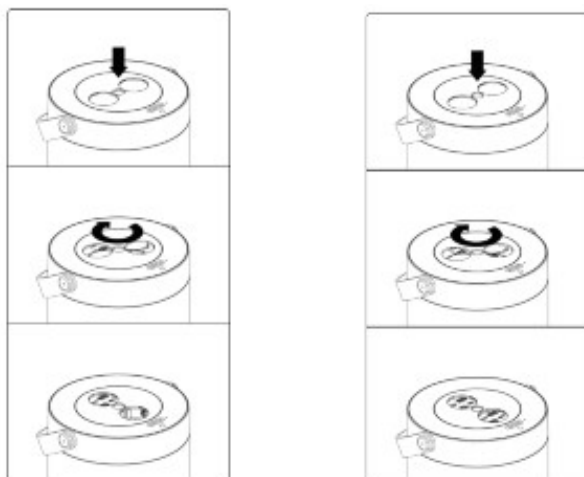

**Connection options item no. 702.5000, 702.5001**

- 1x CEE7/3; 230 VAC 150 watt
- 2x USB-A each 15 watt
- 2x USB-C each 60 watt

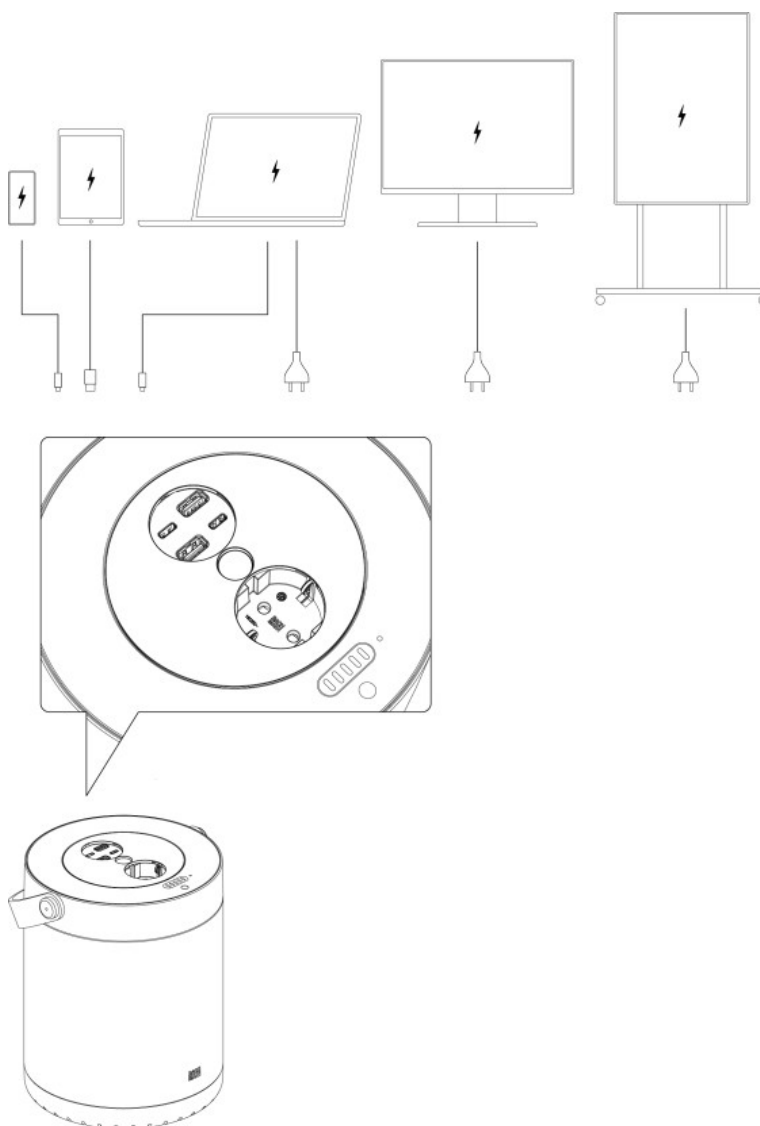

**Connection options item no. 702.5100, 702.5101**

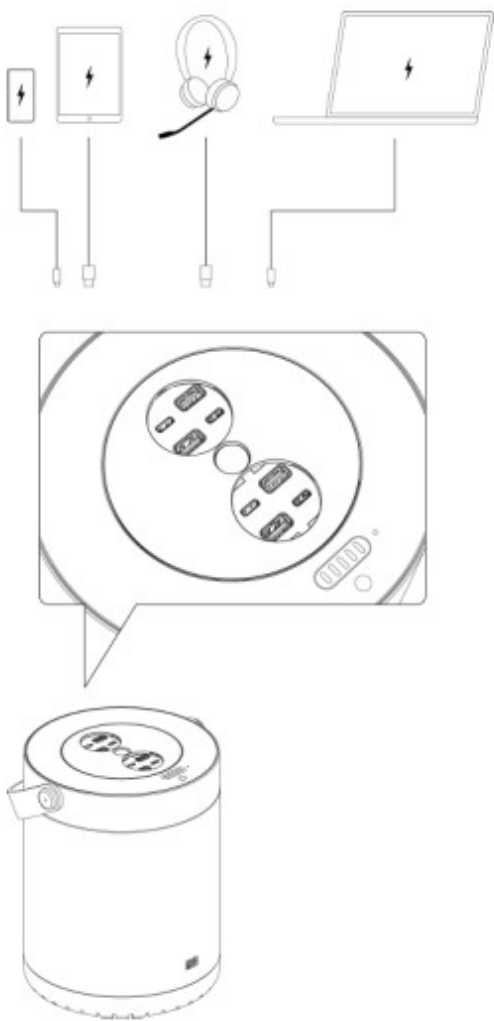

4x USB-A each 15 watt  
4x USB-C each 60 Watt



Transport

ZVEI regulation UN 3481

Fault description

LED battery status	LED status	Solution
flashing		Switch off MOV:E energy store and allow to cool if overheated (fig. 1)
off		Contact BACHMANN customer service (fig. 2)

(fig.1)



(fig.2)



Product description for optional accessories

Bachmann item no.	Component	Description/Functionality
702.52	MOV:E charging station MOV:E Safety Lock Adapter	Charges the MOV:E power unit to attach a security lock

## 7.1 Product overview 702.5200 MOV:E charging station

MOV:E charging station

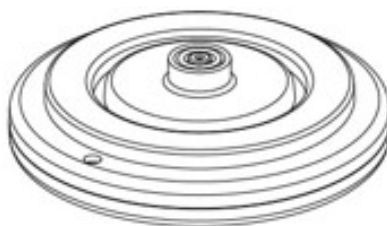

### 7.1.1 Technical data

Item number 702.5200

MOV:E charging station(optional available)	Input	100-240 V – 50/60 Hz
	Output	24 V DC 5 A
	Dimensions	19×23 cm
	Weight	220 g

### 7.1.2 Operation

#### 7.1.2.1 Charging

Please note: During the charging process, the MOV:E power unit and the MOV:E charging station must stand vertically on a solid and dry surface.

Charging time: up to 100% approx. 2-3 hours

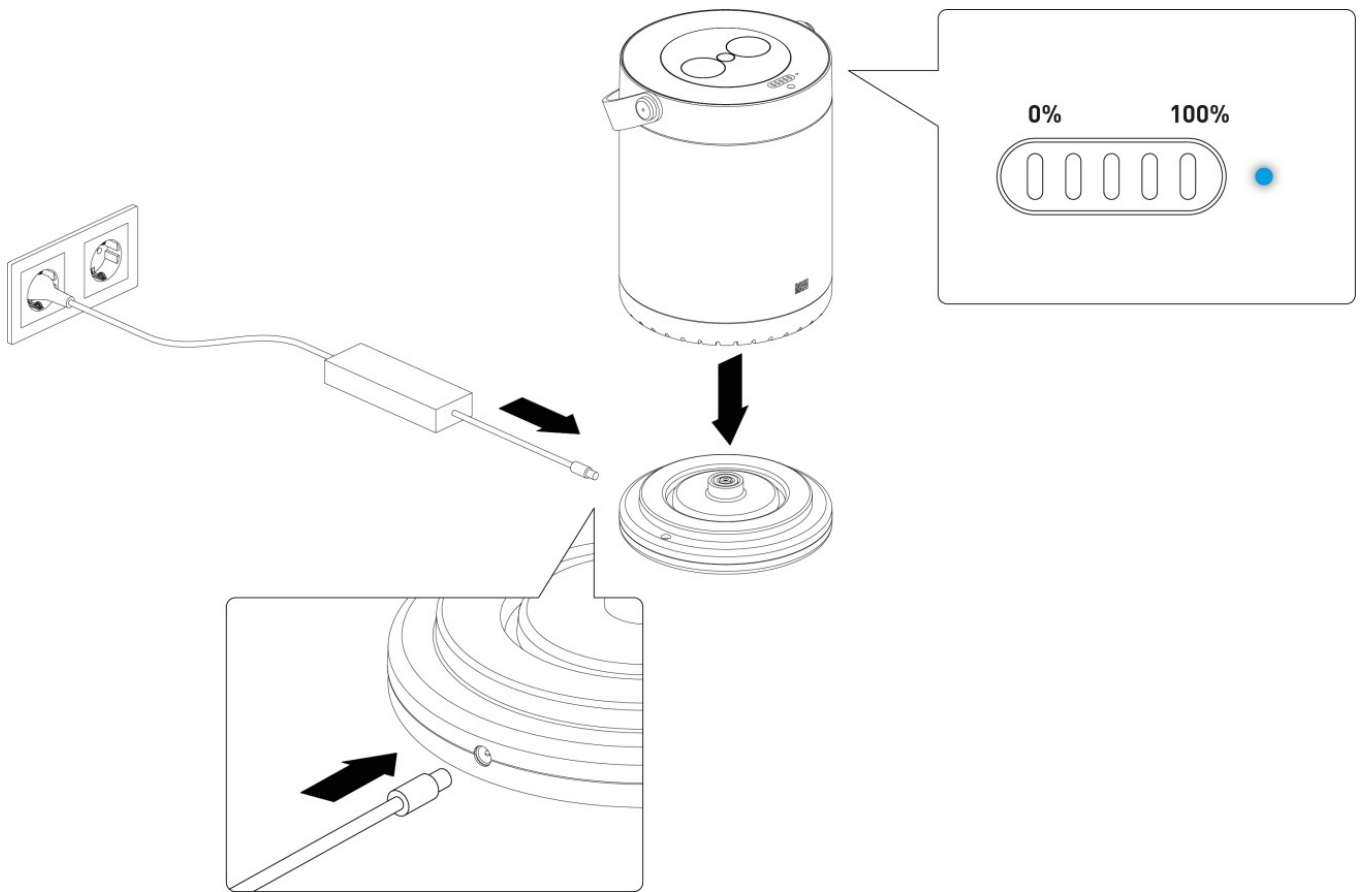

### 7.1 MOV:E Safety Lock Adapter

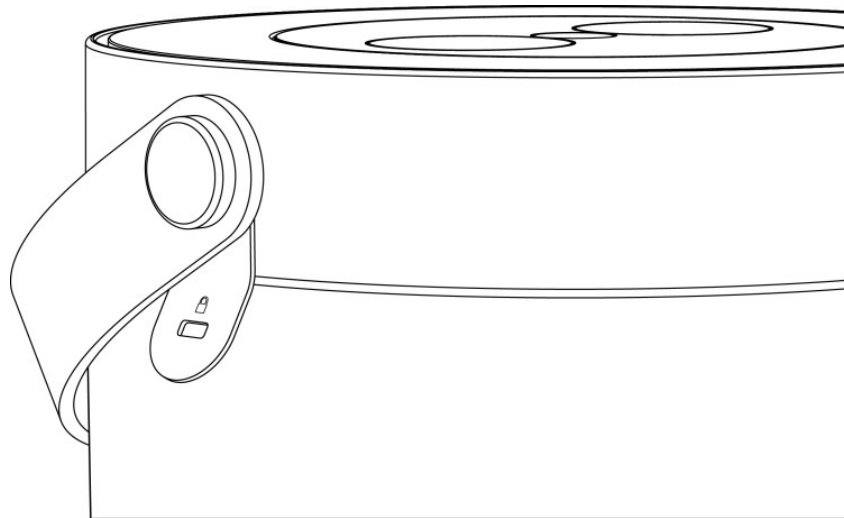

MOV: E adapter for security lock to attach a security lock e.g. Kensington lock (702.5090, 702.5091, 702.5190, 702.5191).

### Cleaning

The MOV:E power unit and MOV:E charging station (optional available) should only be cleaned with a dry, soft cloth.

### Maintenance and repairs

The MOV:E charging station must always be serviced or repaired by BACHMANN customer service.

- Do not service or repair the MOV:E power unit or MOV:E charging station (optional available) yourself
- If the MOV:E power unit and MOV:E charging station (optional available) needs to be serviced or repaired:  
contact Bachmann GmbH customer service

## Return/disposal

The defective MOV:E power unit is subject to WEEE guidelines and must not be disposed of alongside normal household waste. Return the MOV:E power unit to Bachmann GmbH for correct disposal or hand it in free of charge as electrical waste at municipal collection points.

- Contact BACHMANN customer service and request a return
- Make sure that the MOV:E power unit is switched off before shipping

## Customer service

**In case of troubleshooting or technical problems, please contact our customer service team:**

### Contact information:

Bachmann customer service  
Bachmann GmbH  
Ernstthalenstraße 33 70565 Stuttgart  
**Deutschland**

**Phone: +49 711 86602-888**

**Fax: +49 711 86602-34**

**Email: [service@bachmann.com](mailto:service@bachmann.com)**

**Website: [www.bachmann.com](http://www.bachmann.com)**

For other languages – scan QR code.



<https://www.bachmann.com/en/products/independent-systems/move>

## Documents / Resources

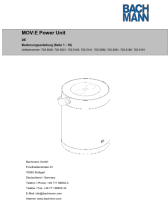
	<p><b><a href="#">BACHMANN 702.5000 Series E Power Unit</a></b> [pdf] User Manual 702.5000 Series E Power Unit, E Power Unit, Power Unit, 702.5000, 702.5001, 702.5100, 702.5101, 702.5090, 702.5091, 702.5190, 702.5191</p>
---	--

## References

- [BACHMANN Willkommen bei BACHMANN - Bachmann](#)
- [bachmann.com](http://bachmann.com)

