



B-TECH BT9921 Soft Open Full Service Wall Mount Installation Guide

[Home](#) » [B-TECH](#) » B-TECH BT9921 Soft Open Full Service Wall Mount Installation Guide 

Contents

- 1 B-TECH BT9921 Soft Open Full Service Wall Mount
- 2 INSTALLATION SAFETY INSTRUCTIONS
- 3 BT9921 PARTS LIST
- 4 INSTALLATION TOOLS REQUIRED INSTALLATION INSTRUCTIONS
 - 4.1 INSTALL THE WALL MOUNTS
- 5 ATTACH MOUNTING RAILS TO WALL ARMS
- 6 HOOK RAILS ONTO WALL BRACKETS
- 7 ATTACH INTERFACE ARMS TO SCREEN
- 8 HOOK SCREEN ONTO RAILS
- 9 SCREEN ALIGNMENT USING MICRO-ADJUSTMENT
- 10 LEVEL SCREEN & SECURE MOUNT
- 11 SERVICING THE SCREEN
- 12 LOCKING SCREW INSTALLATION
- 13 RECESS MOUNTING
 - 13.1 FRONT VIEW
 - 13.2 SIDE VIEW
 - 13.3 REARVIEW
 - 13.4 TOP VIEW
- 14 Documents / Resources
- 15 Related Posts



B-TECH BT9921 Soft Open Full Service Wall Mount



INSTALLATION SAFETY INSTRUCTIONS

CAUTION: This mount is intended for use only with the maximum weights indicated. Use with equipment heavier than the maximum indicated may result in instability causing possible injury.

Do not attempt to install this product until all instructions and warnings have been read and properly understood. Please keep these instructions for future reference.

Please check carefully to make sure there are no missing or defective parts – defective parts must never be used. B-Tech AV Mounts, its distributors and dealers are not liable or responsible for damage or injury caused by improper installation, improper use or failure to observe these safety instructions. In such cases, all guarantees will expire.

General

8-Tech AV Mounts recommends that a professional AV installer or other suitably qualified person install this product.

Great care must always be taken during installation as most AV equipment is of a fragile nature, possibly heavy and easily damaged if dropped.

If you do not fully understand the instructions or are not sure how to install this product safely, then please consult a professional for advice and/or to install this product for you. Failure to mount this product correctly may cause serious injury or death both during installation and at any time thereafter.

Do not mount any AV equipment that exceeds the specified weight limit of the product you are installing.

This weight limit will be clearly stated on each product and its packaging and will vary from product to product.

Product location

Please pay careful attention to where this product is located. Check load capacity of the wall prior to installation as

some surfaces are not suitable for installation. Designed for indoor use, this mount is suitable for public or home installation. If located in a public or frequently populated area ensure that the product is out of the immediate reach of people.

If any AV equipment is to be suspended over the likely path or location of people then great care should be taken to secure all parts of the installation from falling.

When drilling holes it is essential to avoid contact with electrical cables and water or gas pipes contained within. Use of a good quality live wire detector and hidden object locator is therefore recommended.

Only drill into structures when you are sure it is safe to do so.

Fixing hardware

It is highly recommended that all fixing screws be used where supplied and that the purpose of all other fixing hardware

is fully understood. In some cases more AV equipment fixing hardware will be supplied to accommodate different models of equipment and set up configurations. The installer must be satisfied that any supplied fixing hardware is suitable for each specific installation. The fixing kit supplied with the product may not be suitable for all walls. If any fixing screws or included hardware are deemed not sufficient for a safe installation then please consult a professional or your local hardware store.

Hazard limitation

When routing cables take advantage of any built in cable management features that the product might provide and ensure that all cables are tidy and secure. Check to see that any moving aspect of the product can do so unhindered by any cabling. Some products have moving parts and the potential to cause injury through the crushing or trapping of fingers or other

body parts. Particular attention to the nature of moving parts is required especially when assembling installing and adjusting during set up. Immediately after installation double-check that the work done is safe and secure.

Double-check all necessary fixings are present and are of ample tightness.

It is recommended that periodic inspections of the product and its fixing points are made as frequently as possible (no more than 6 months apart) to ensure that safety is maintained.

If in doubt consult a professional AV installer or another suitably qualified person.

8-Tech AV Mounts empfiehlt, dass dieses Produkt durch einen qualifizierten AV-Techniker oder eine andere Person mit geeigneter Qualifikation installiert wird. 8-Tech AV Mounts, ihre Distributoren und Handler können nicht für durch fehlerhafte Montage verursachte Beschädigung oder Verletzung haftbar bzw. verantwortlich gemacht werden. Dieses Produkt muss auf einem geeigneten Untergrund montiert werden und darf nur bis zum angegebenen Höchstgewicht verwendet werden.

BT9921 PARTS LIST

PLEASE KEEP THIS FDR FUTURE REFERENCE

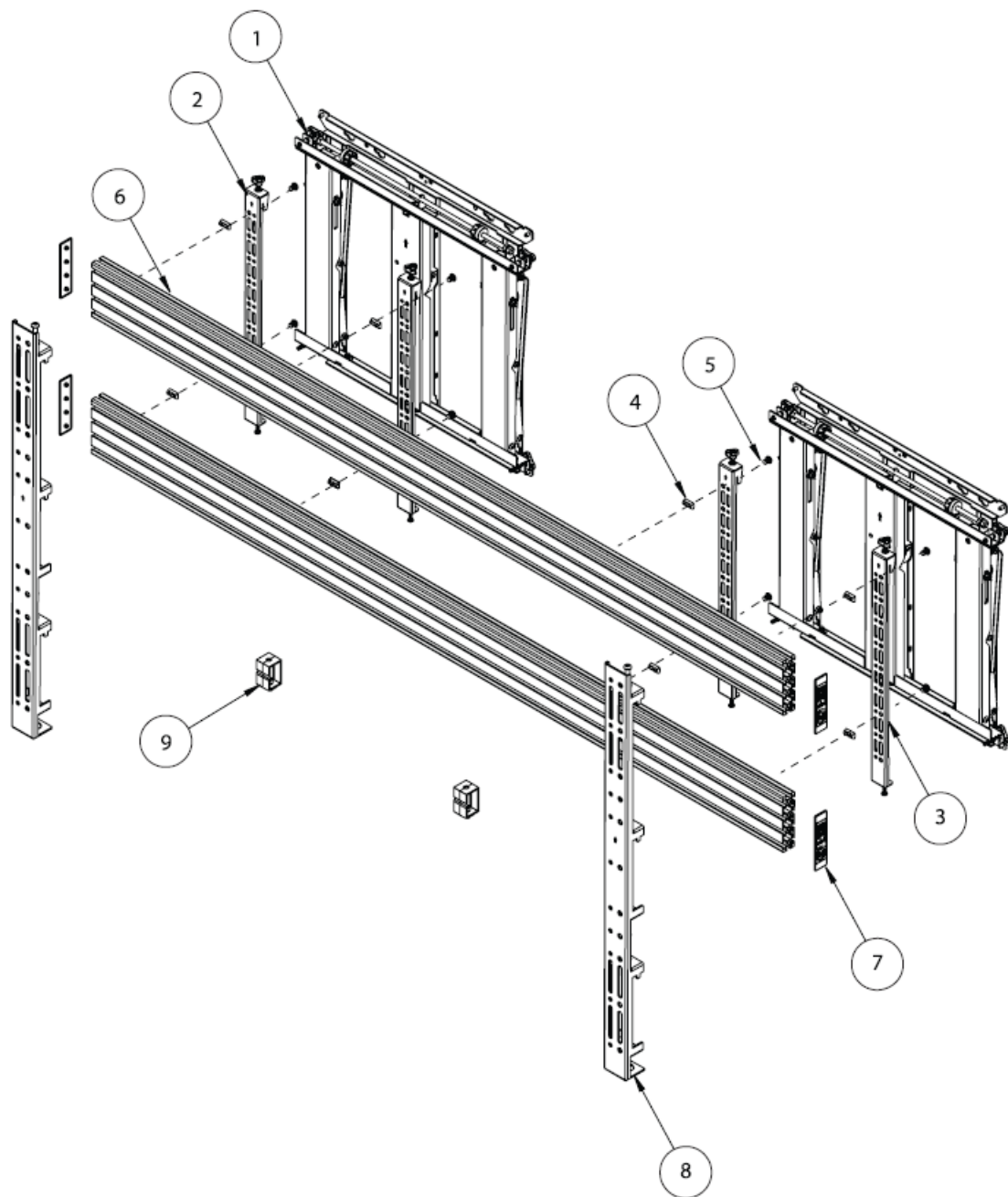

ITEM	DESCRIPTION	QTY
1	POP-OUT WALL MOUNT	2
2	WALL MOUNT ARM – LEFT	2
3	WALL MOUNT ARM – RIGHT	2
4	MB SLIDING INSERT	B

5	MB x 12mm CSK SCREW	8
6	MOUNTING RAIL	2
7	RAIL END CAP	4
B	INTERFACE ARM	2
9 10	CABLE MANAGEMENT CLIP	2
	MB x 10mm HEX SCREW	— 2
11	M6 x 20mm SCREW	2
12	SAF HEX KEY	1
13	SAF LONG HEX KEY	1
14	4AF LONG HEX KEY	1 —
SCREEN FIXING KIT		
A	M6 x 16mm CROSS SCREW	4
B	M6 x 25mm CROSS SCREW	4
C	M6 x 40mm CROSS SCREW	4

D	MB x 16mm CROSS SCREW	4
E	MB x 25mm CROSS SCREW	4
F	MB x 40mm CROSS SCREW	4
G	M 10 x 16mm CROSS SCREW	4
H	M10 x 25mm CROSS SCREW	4
I	M10 x40mm CROSS SCREW	4
J	IDB.1 TSmm SPACER	4
K	IDB.1 T13mm SPACER	4
L	IDB.1 T24mm SPACER	4
M	ID10.3 T7mm SPACER	4
N	MULTIWASHER	4
WALL FIXINGS KIT		
AI	StB x 63mm COACH SCREW	B
A2	MB WASHER	B
	N°.10 WALL PLUG	B

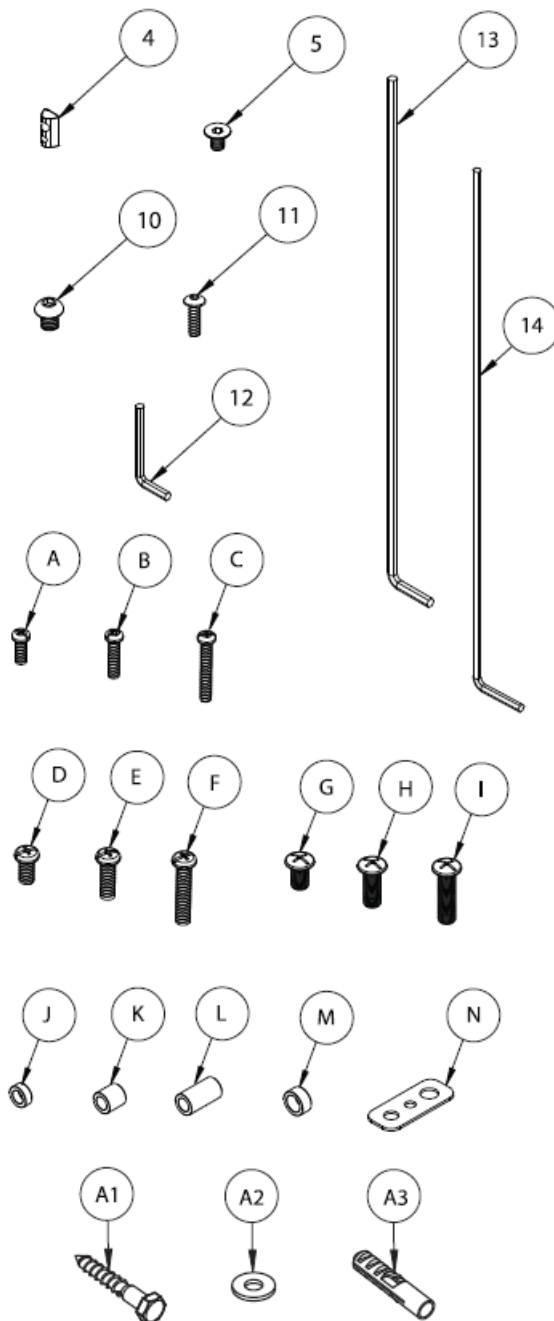

INSTALLATION TOOLS REQUIRED



INSTALLATION INSTRUCTIONS

INSTALLATION EXAMPLE: MOUNTING A LG 110UM5J DISPLAY

INSTALL THE WALL MOUNTS

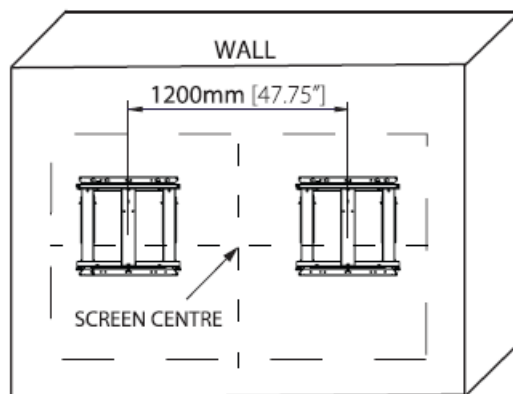

1. Determine the centre of the screen on the wall and mark 395mm (15.5") above the center line for the top fixings on item 1.
2. Using the top centre holes, space items 11200mm (47.25") apart.
3. Use item 7 as a template to mark and then drill the fixing holes on the wall.

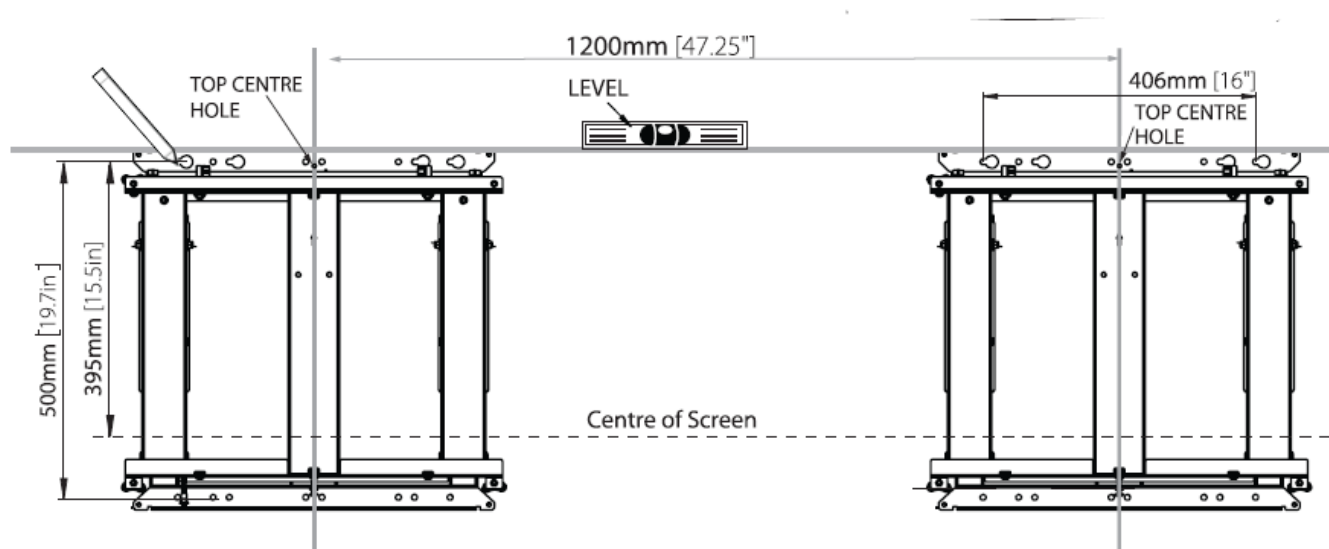

4. Insert item A3 into all fixing holes* and 4 x item A 1 into the top holes. Leave a gap of approx. 10mm (0.4") to hook on item 1.
5. Once item 7 has been hooked on, tighten all fixings.

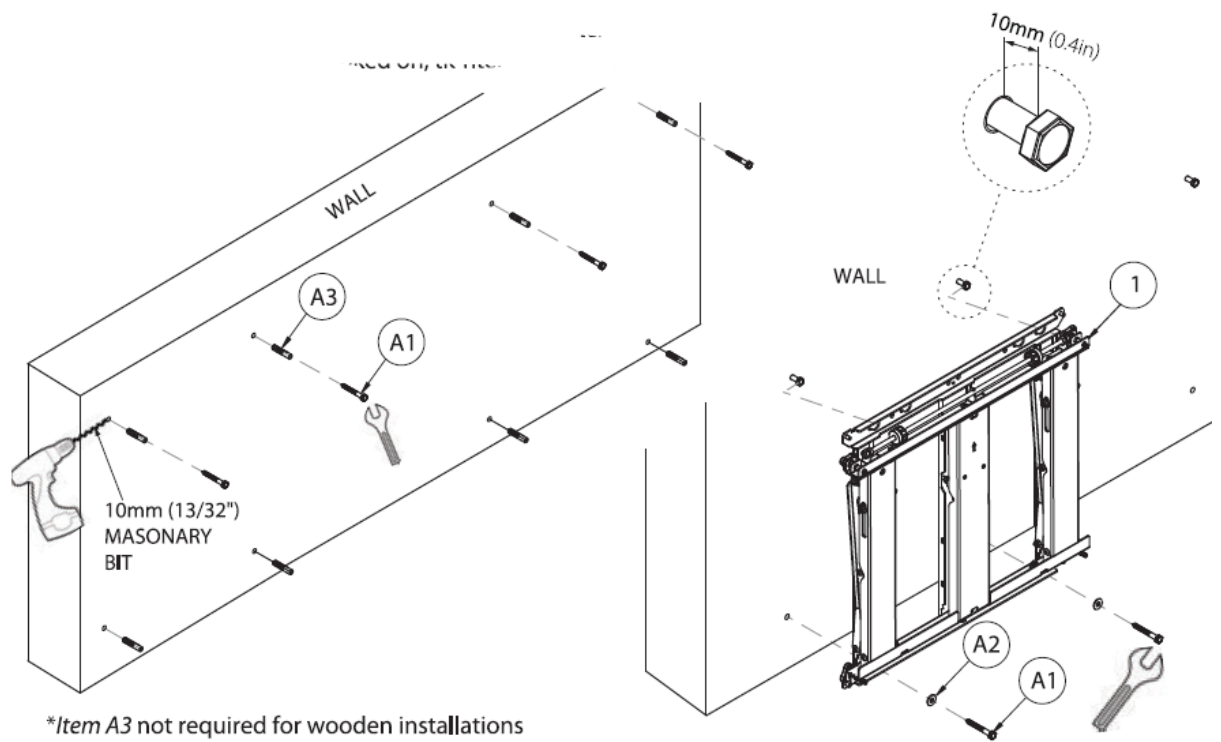

ATTACH MOUNTING RAILS TO WALL ARMS

1. On both rails, insert 4x item 3 in the top channel of item 6.

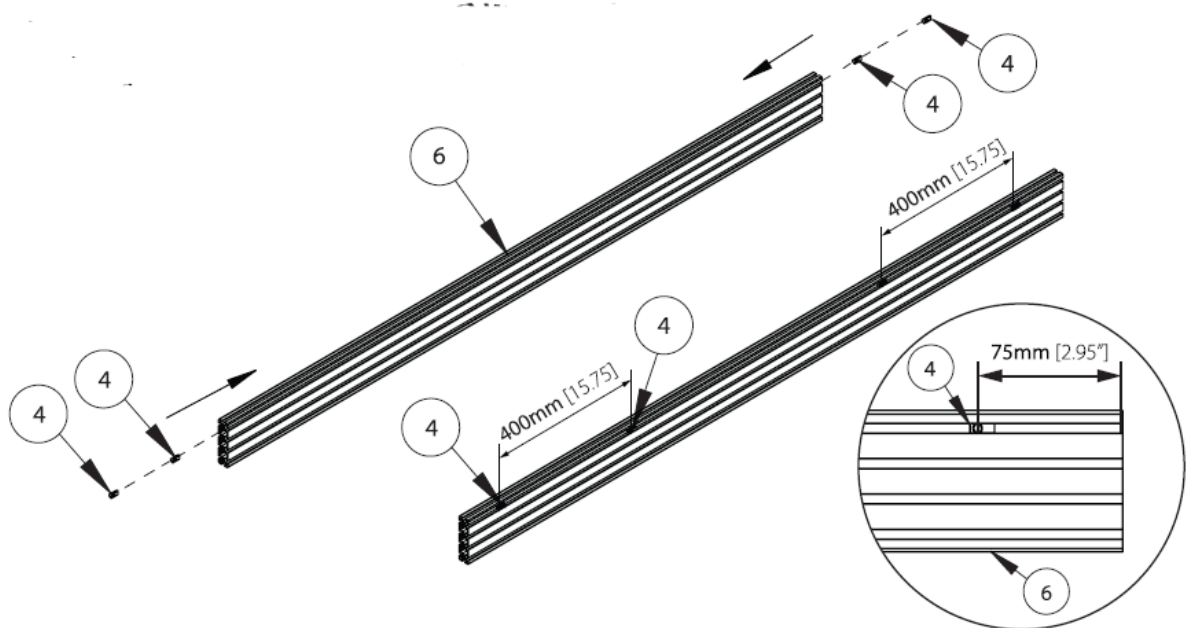

2. Using the top holes, fix items 2 & 3 to item 6 by fastening item 5 into item 4 (use 300mm fixings on the arms).

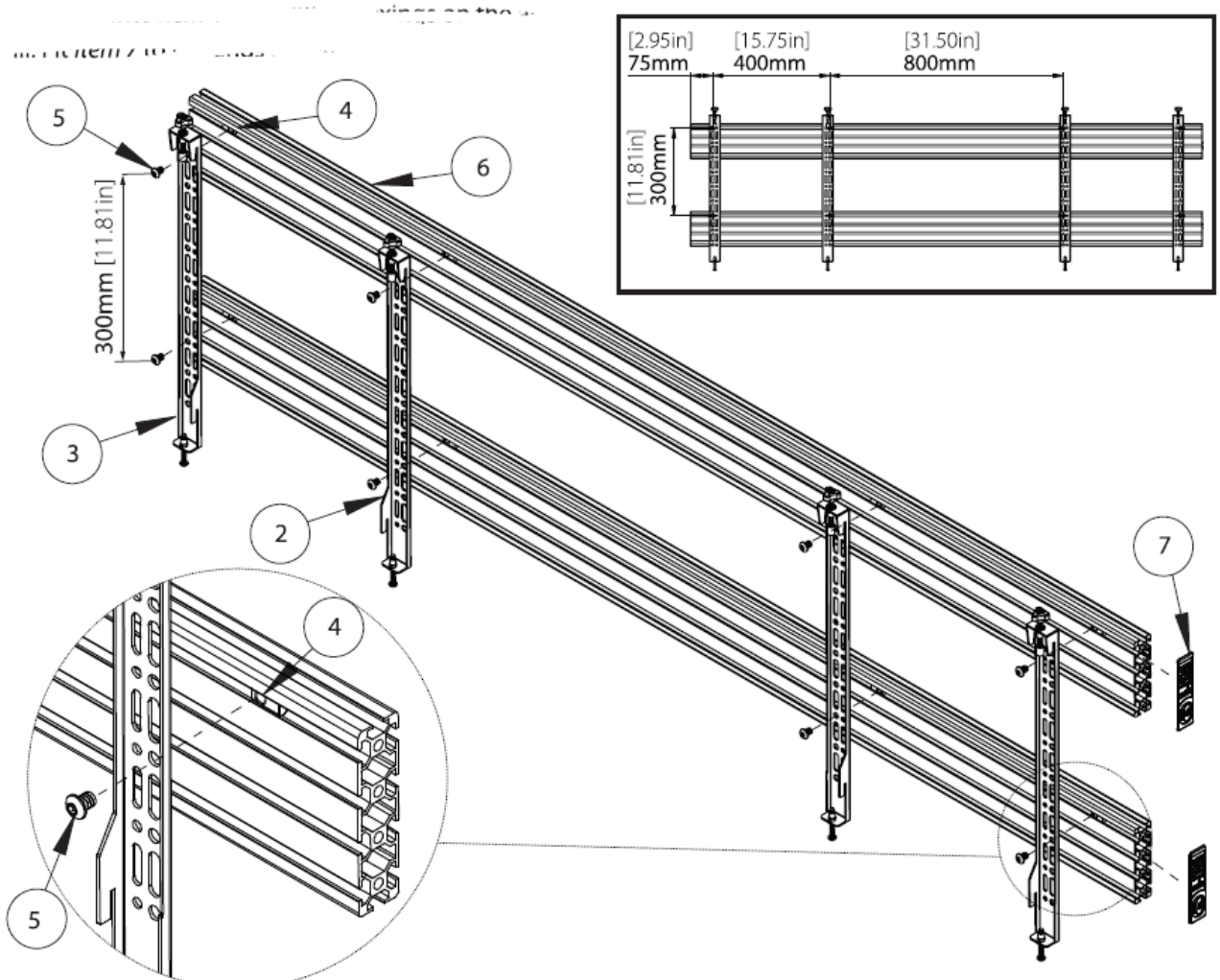

3. Fit item 1 to the ends of item 6.

HOOK RAILS ONTO WALL BRACKETS

1. Using items 2 & 3, hook item 6 onto item 7.

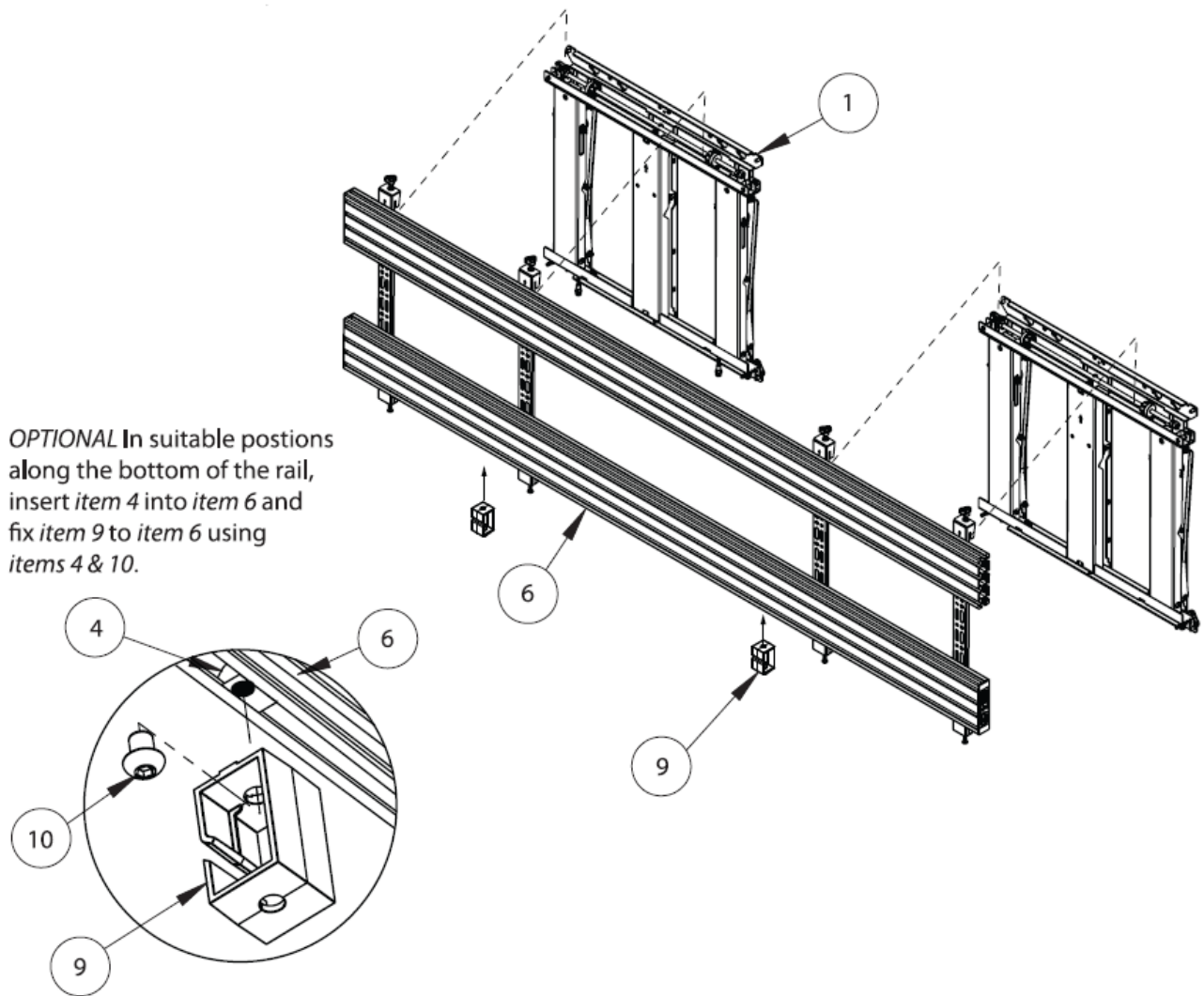

2. Tighten the safety screws on the bottom of items 2 & 3 to secure item 6 to item 1.

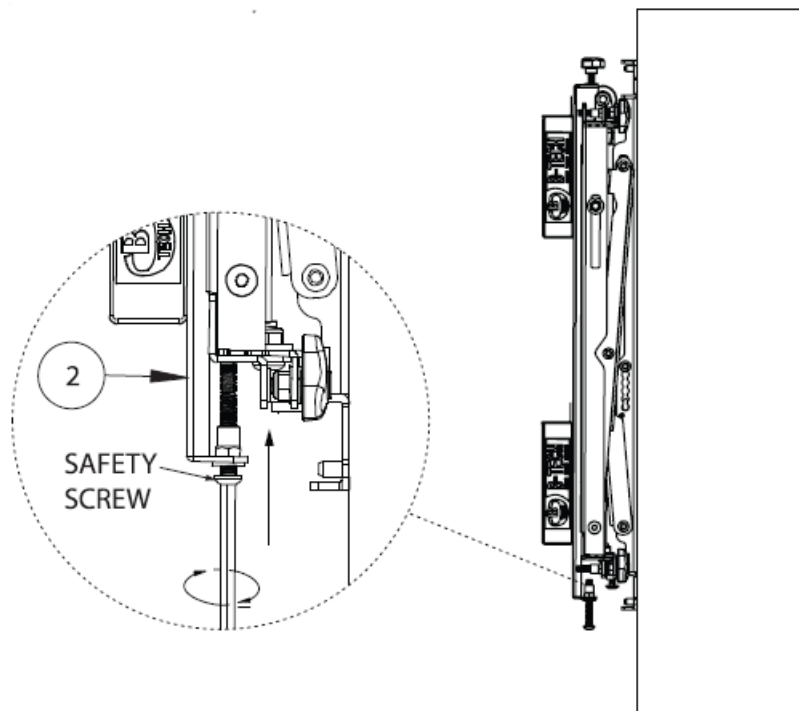

ATTACH INTERFACE ARMS TO SCREEN

Fix item 8 to the rear of the screen using the interface kit provided (items A – NJ).

Note: Ensure interface arms are positioned the correct way round and the same holes are used on both arms.

Fix *item 8* to the rear of the screen using the interface kit provided (*items A - N*).

Note: Ensure interface arms are positioned the correct way round and the same holes are used on both arms.

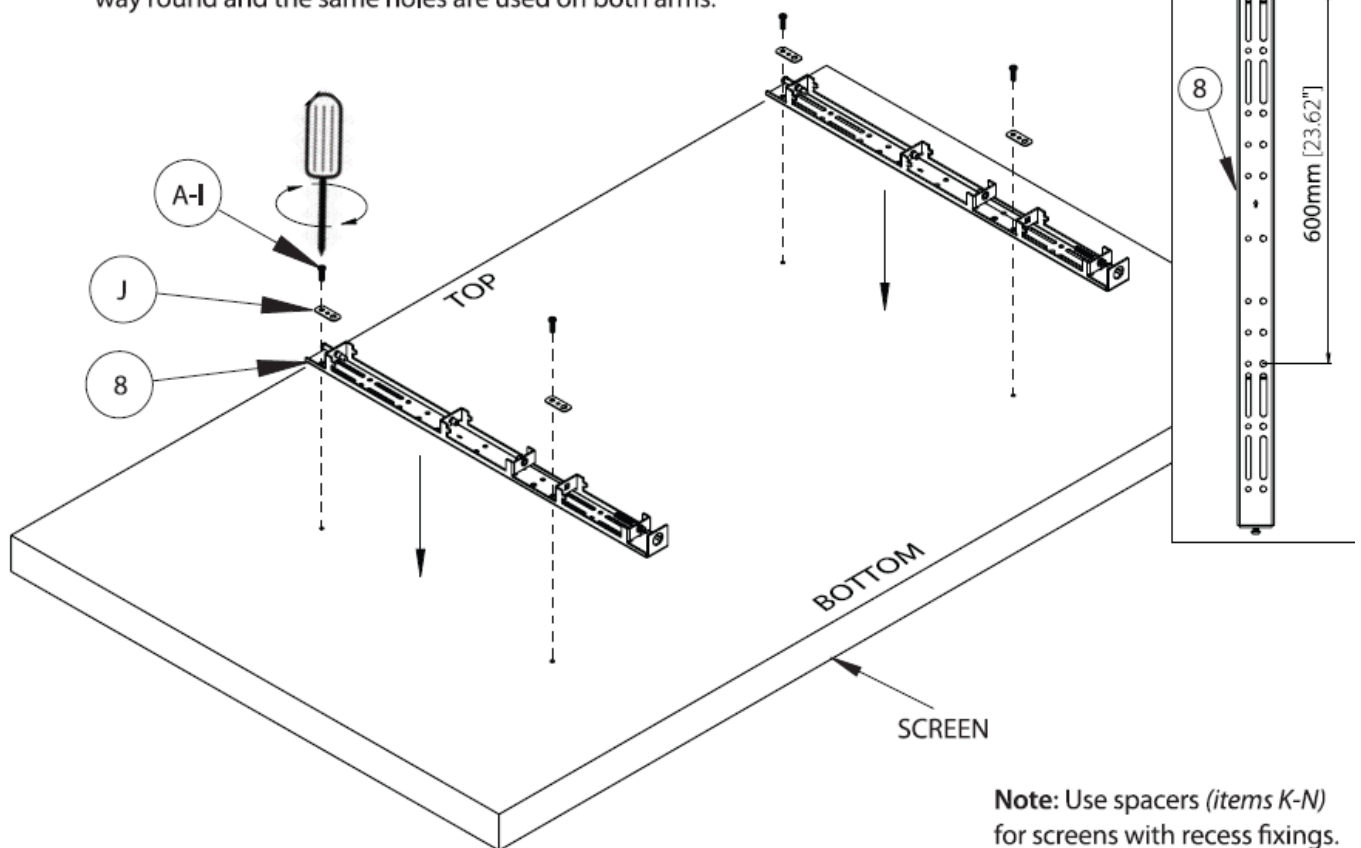

HOOK SCREEN ONTO RAILS

Using the top and middle hooks on item 8, mount the screen onto both rails (item 6).

Note: This procedure may require two people.

Using the top and middle hooks on *item 8*, mount the screen onto both rails (*item 6*).

Note: This procedure may require two people.

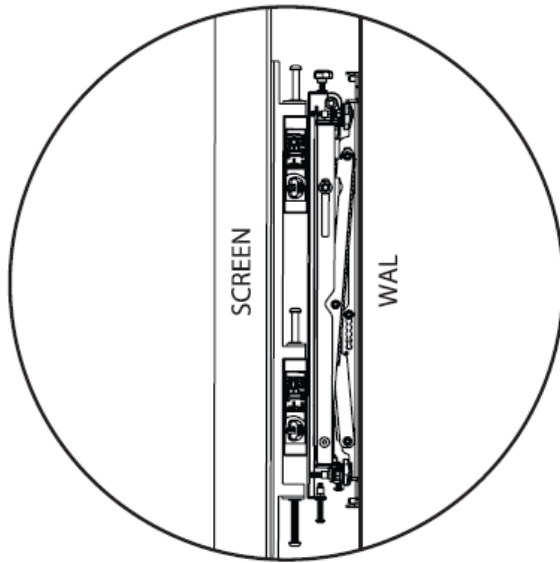

Note: Ensure interface arms (*item 8*) hook onto both rails (*item 6*).

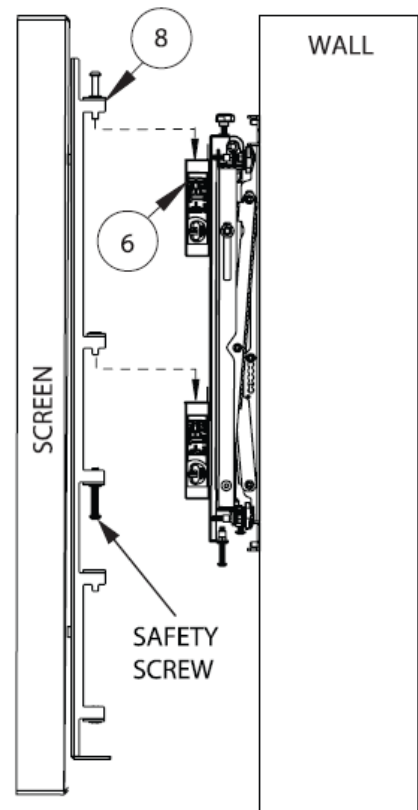

Note: Ensure interface arms (item BJ) hook onto both rails (item 6J).

SCREEN ALIGNMENT USING MICRO-ADJUSTMENT

1. Check the horizontal centre of the screen is aligned with the horizontal centre of the wall mount.
2. Using a level, align the screen parallel to the floor using the Y axis adjustment screws.
3. Use the Z axis knob to ensure that each corner of the screen is equidistant from the wall.
4. when the screen is positioned correctly, tighten the safety screws on items 2 & 3.

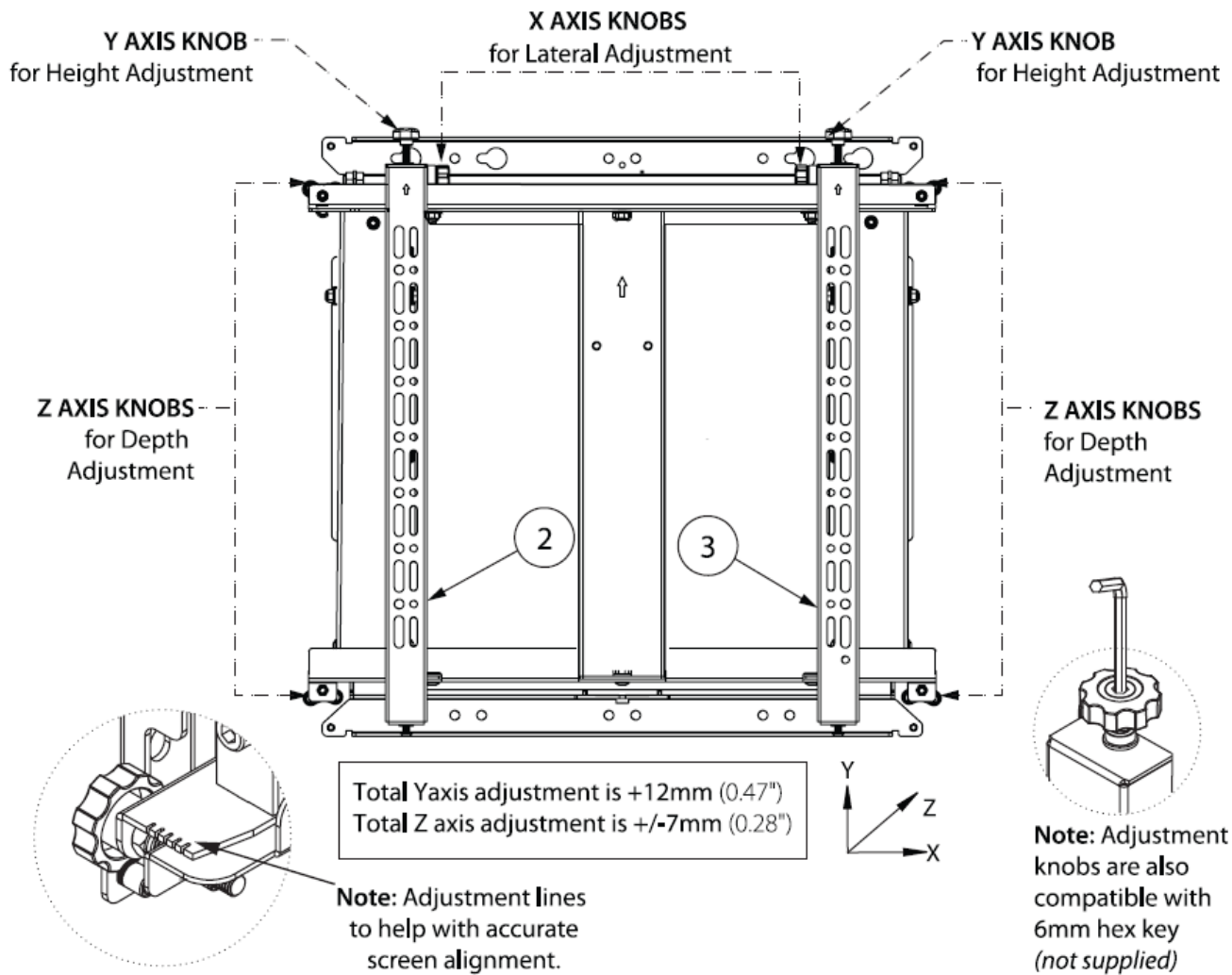

OPTIONAL:

Adjustment can be made to ensure these parts move freely.

If overtightened it will negatively affect the pop-out/in the function of the product. If too loose, it will create lateral wobble.

Note: If the pop-out function of the bracket is not operating, check that the locking screw (item 11) has not been engaged – see page 13.

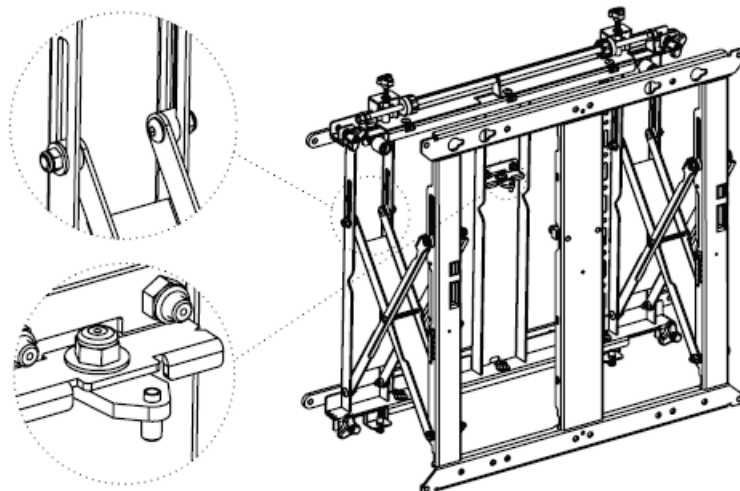

LEVEL SCREEN & SECURE MOUNT

1. height adjustment screws on top of item 6.

2. Secure mount by tightening the safety screws on the bottom item 8.
3. Tidy any screen cables to the mount using item 9.

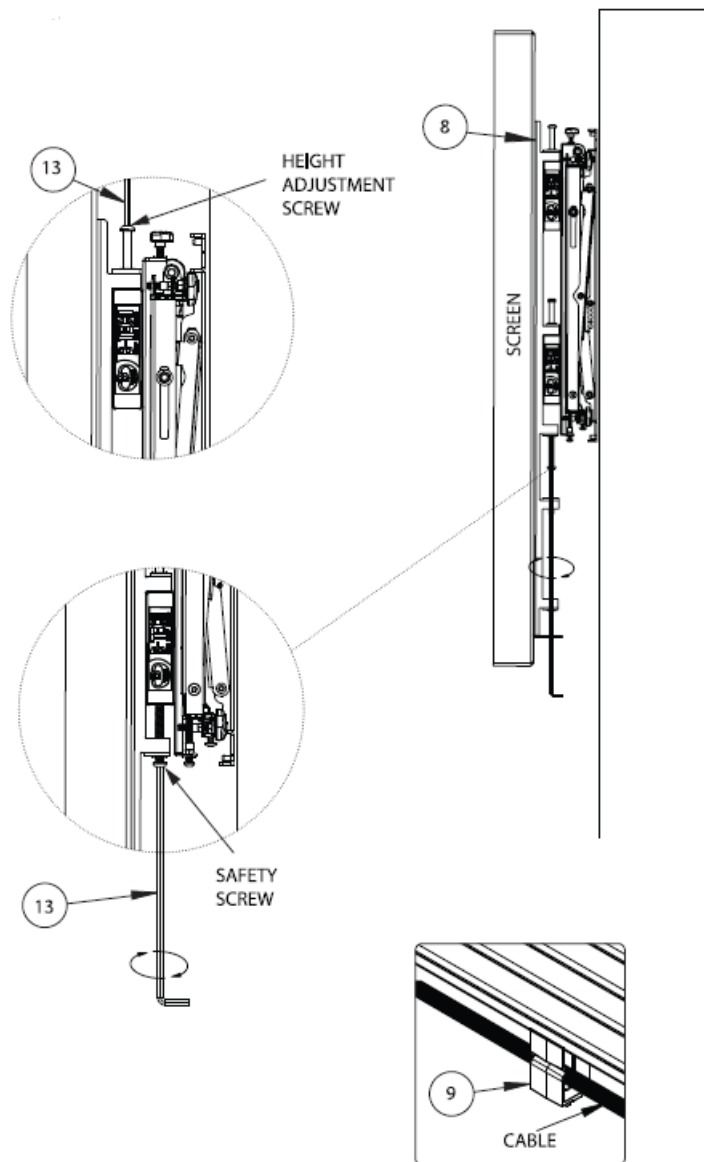

Note: Ensure there is enough slack in the cable for the movement of the bracket.

SERVICING THE SCREEN

To service the screen, push the screen and the mount will release and move out from the wall. Note: Be careful not to damage the screen when pushing. Keep hold of the screen as it moves outwards.

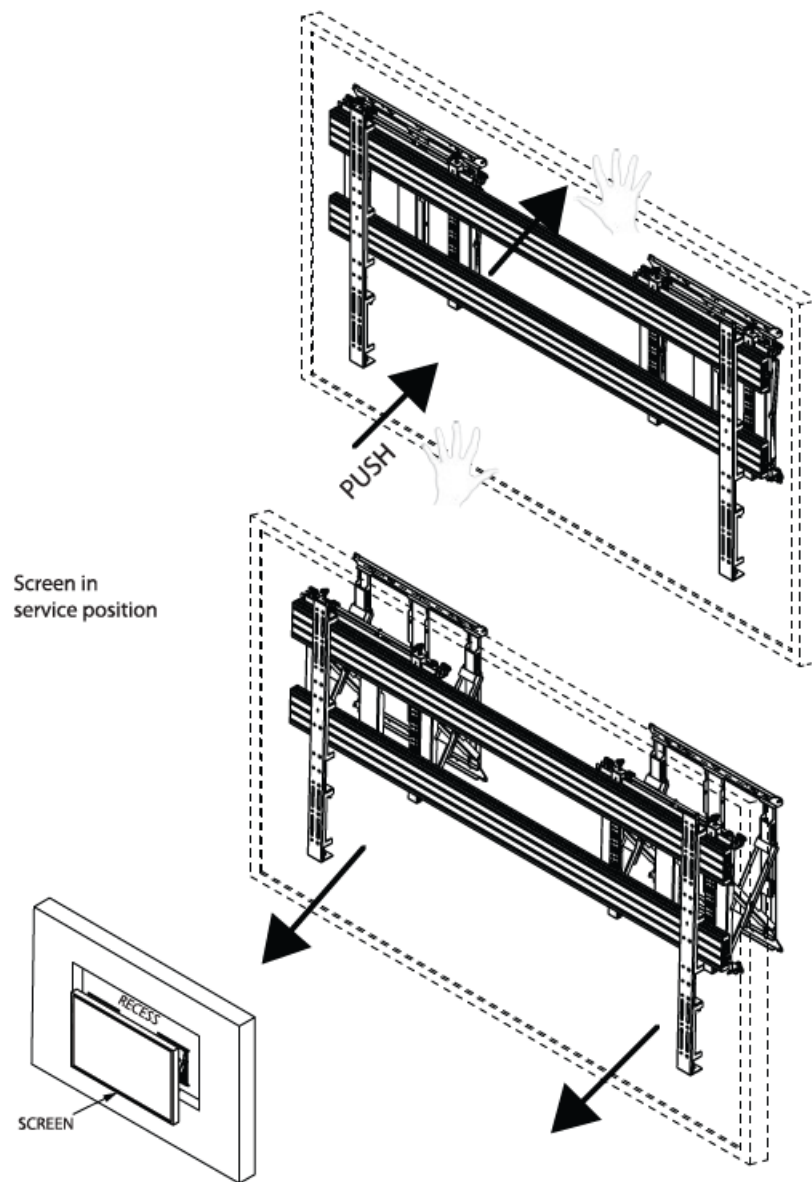

LOCKING SCREW INSTALLATION

If this mount is used in public areas, a locking screw (item 11) is available to prevent the mount from popping out accidentally.

Note: Ensure item 1 is in the closed position before inserting item 11.

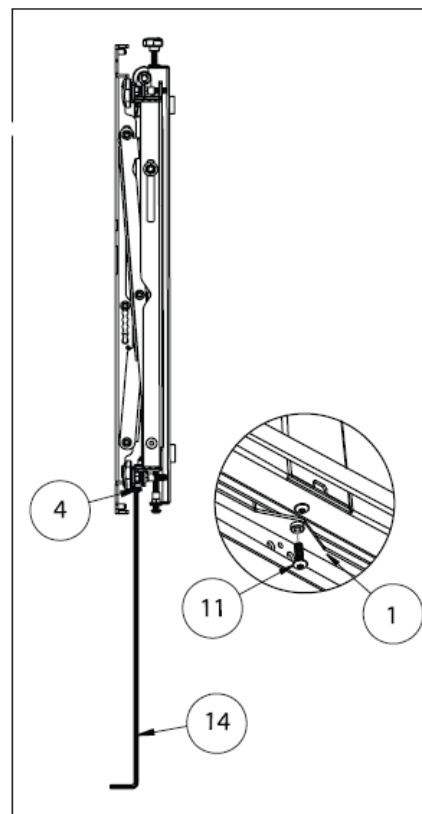
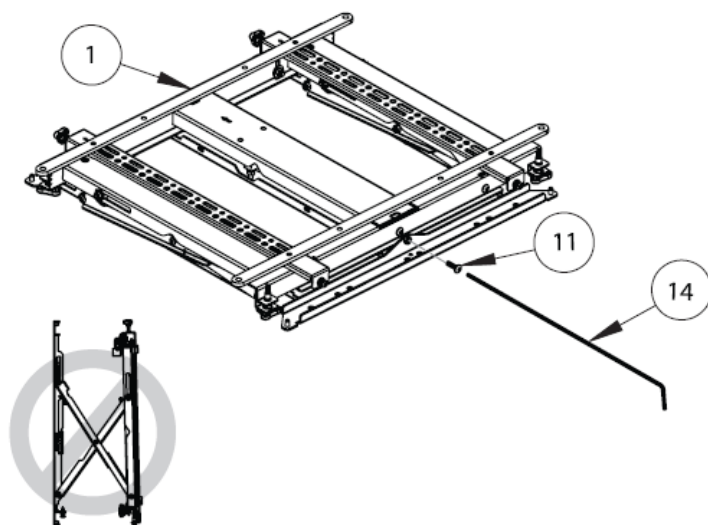

RECESS MOUNTING

Depth of recess:

115mm (4.53")* + Depth of screen

Depth of recess:

115mm (4.53")* + Depth of screen

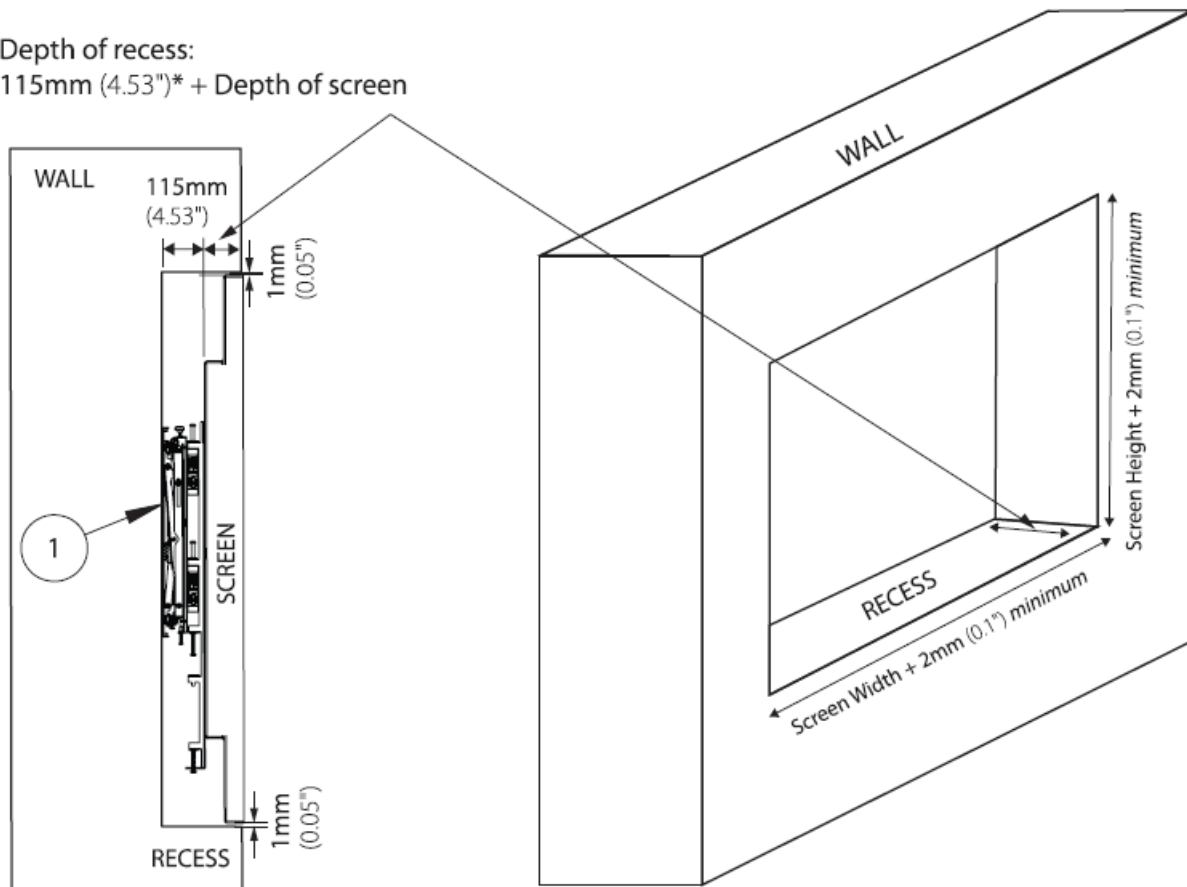

FRONT VIEW

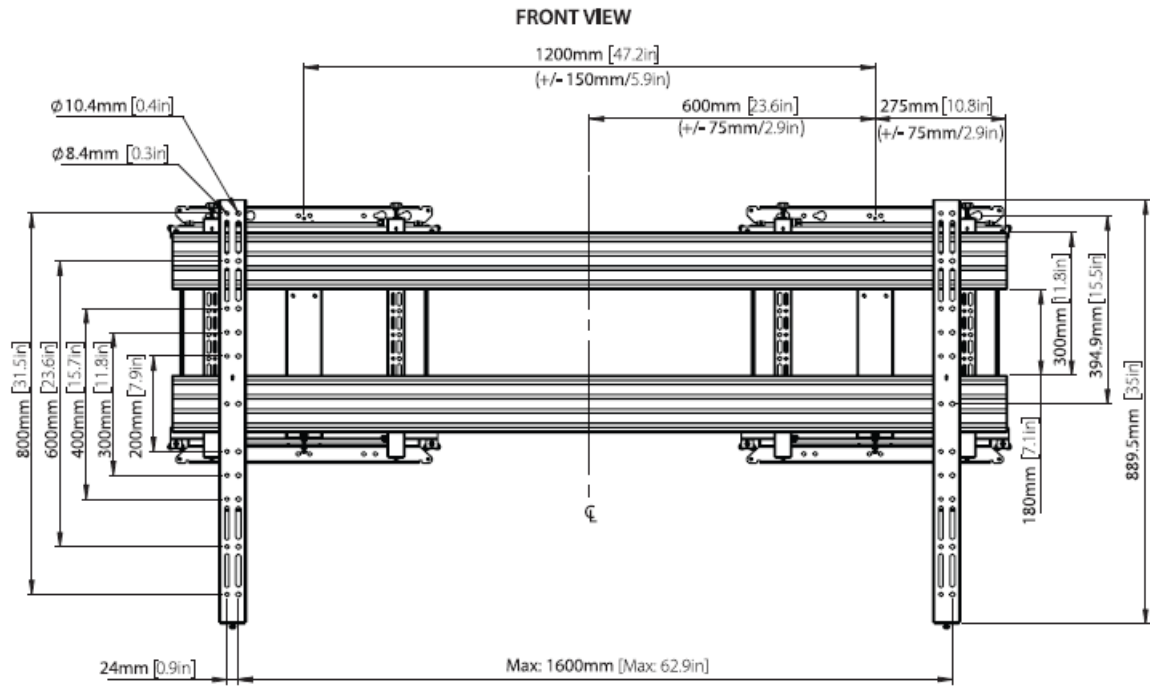

SIDE VIEW

SIDE VIEW

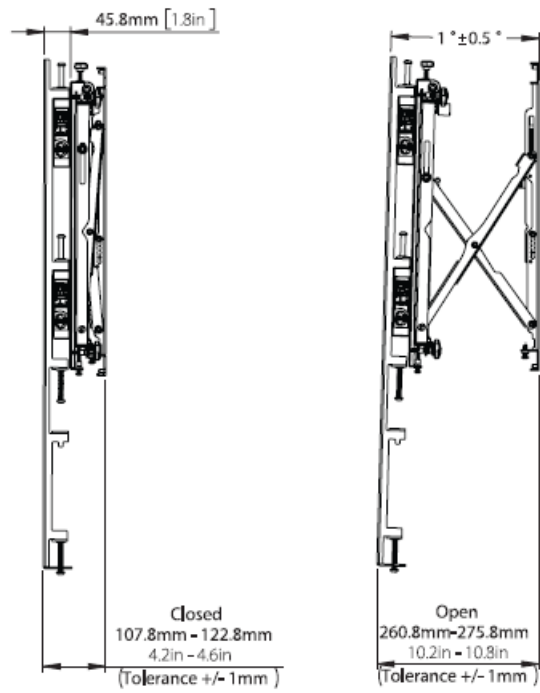

REARVIEW

REAR VIEW

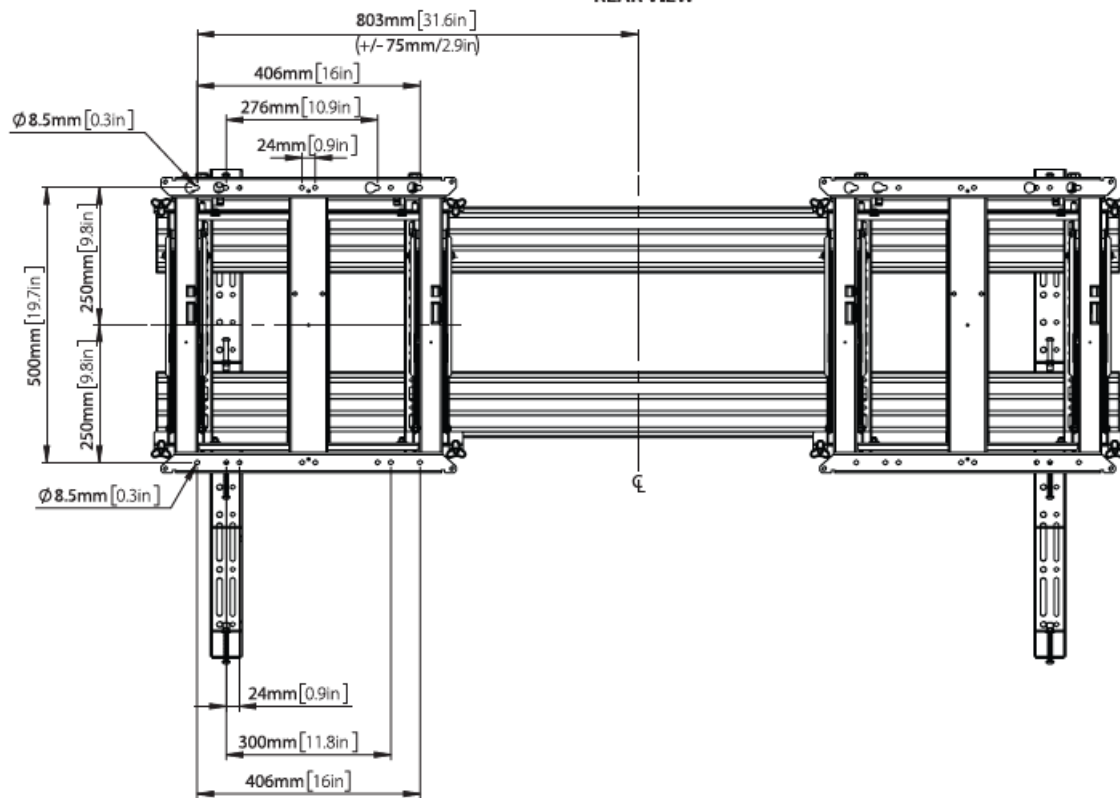

TOP VIEW

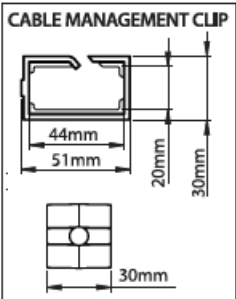
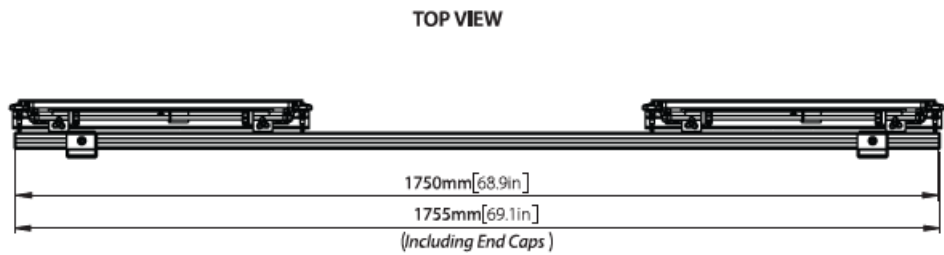

Documents / Resources

	<p>B-TECH BT9921 Soft Open Full Service Wall Mount [pdf] Installation Guide</p> <p>BT9921, Soft Open Full Service Wall Mount, BT9921 Soft Open Full Service Wall Mount, Full Service Wall Mount, Service Wall Mount, Wall Mount, Mount</p>
--	--