



B TECH BT8566 Flat Screen Display Trolley Installation Guide

[Home](#) » [B-TECH](#) » B TECH BT8566 Flat Screen Display Trolley Installation Guide 



B-TECH AV MOUNTS®

BT8566

FLAT SCREEN DISPLAY TROLLEY WITH FLIP ROTATION
INSTALLATION GUIDE



B-TECH AV MOUNTS



Contents

- [1 SPECIFICATIONS](#)
- [2 INSTALLATION SAFETY INSTRUCTIONS](#)
- [3 BT8566 PARTS LIST](#)
- [4 INSTALLATION INSTRUCTIONS](#)
- [5 Documents / Resources](#)
- [6 Related Posts](#)

SPECIFICATIONS

- Recommended for screens up to 70" (177cm)
- Max load: 70kg (154lbs)
- Suitable for displays with VESA fixings up to 600 x 400mm
- Allows mounted screens to rotate from landscape to portrait orientation (or vice versa)
- Features a negative tilt of 4.5° for easier use of interactive touch screens
- Non-marking locking / braked castors included
- Integrated cable management
- Dimensions: H.1905 W.1075mm D.863mm

INSTALLATION SAFETY INSTRUCTIONS



CAUTION: This mount is intended for use only with the maximum weights indicated. Use with screens

heavier than the maximum indicated may result in instability causing possible injury.

Do not attempt to install this product until all instructions and warnings have been read and properly understood. Please keep these instructions for future reference. Please check carefully to make sure there are no missing or defective parts – defective parts must never be used. B-Tech AV Mounts, its distributors, and dealers are not liable or responsible for damage or injury caused by improper installation, improper use, or failure to observe these safety instructions. In such cases, all guarantees will expire.

General

B-Tech AV Mounts recommends that a professional AV installer or other suitably qualified person install this product. Great care must always be taken during installation as most AV equipment is of a fragile nature, possibly heavy and easily damaged if dropped. If you do not fully understand the instructions or are not sure how to install this product safely, then please consult a professional for advice and/or to install this product for you. Failure to mount this product correctly may cause serious injury or death both during installation and at any time thereafter. Do not mount any AV equipment that exceeds the specified weight limit of the product you are installing. This weight limit will be clearly stated on each product and its packaging and will vary from product to product.

Trolley operation

Warning: The trolley can tip over which may lead to serious injury. Only adults should push this trolley, do not allow children under 16 to move the trolley. Push the trolley on the narrow side, never pull the trolley. Do not push at the top of the trolley, push near the middle. Move the trolley slowly. Always park on level ground, and never leave the trolley on an incline. Apply the brakes when the trolley is stationary, and release the brakes when pushing the trolley.

Product location

Please pay careful attention to where this product is located, some locations are not suitable for installation. For indoor use only. Install stand on level ground. When verifying the stability of the structure, consider the following external factors: The strength of the floor, exposure to sudden and severe wind, and danger arising from contact with people and/or objects (eg installations in passageways, emergency exits), if located in a public or frequently populated area ensure that the product is out of the immediate reach of people.

Fixing hardware

It is highly recommended that all fixing screws be used where supplied and that the purpose of all other fixing hardware is fully understood. In some cases, more AV equipment fixing hardware will be supplied to accommodate different models of equipment and set up configurations. The installer must be satisfied that any supplied fixing hardware is suitable for each specific installation. If any fixing screws or included hardware are deemed not sufficient for a safe installation then please consult a professional or your local hardware store.

Hazard limitation

When routing cables take advantage of any built-in cable management features that the product might provide and ensure that all cables are tidy and secure. Check to see that any moving aspect of the product can do so unhindered by any cabling. Some products have moving parts and the potential to cause injury through the crushing or trapping of fingers or other body parts. Particular attention to the nature of moving parts is required especially when assembling installing and adjusting during setup. Immediately after installation double-check that the work done is safe and secure. Double-check that all necessary fixings are present and are of ample tightness. It is recommended that periodic inspections of the product and its fixing points are made as frequently as possible to ensure that safety is maintained. If in doubt consult a professional AV installer or another suitably qualified person.

BT8566 PARTS LIST

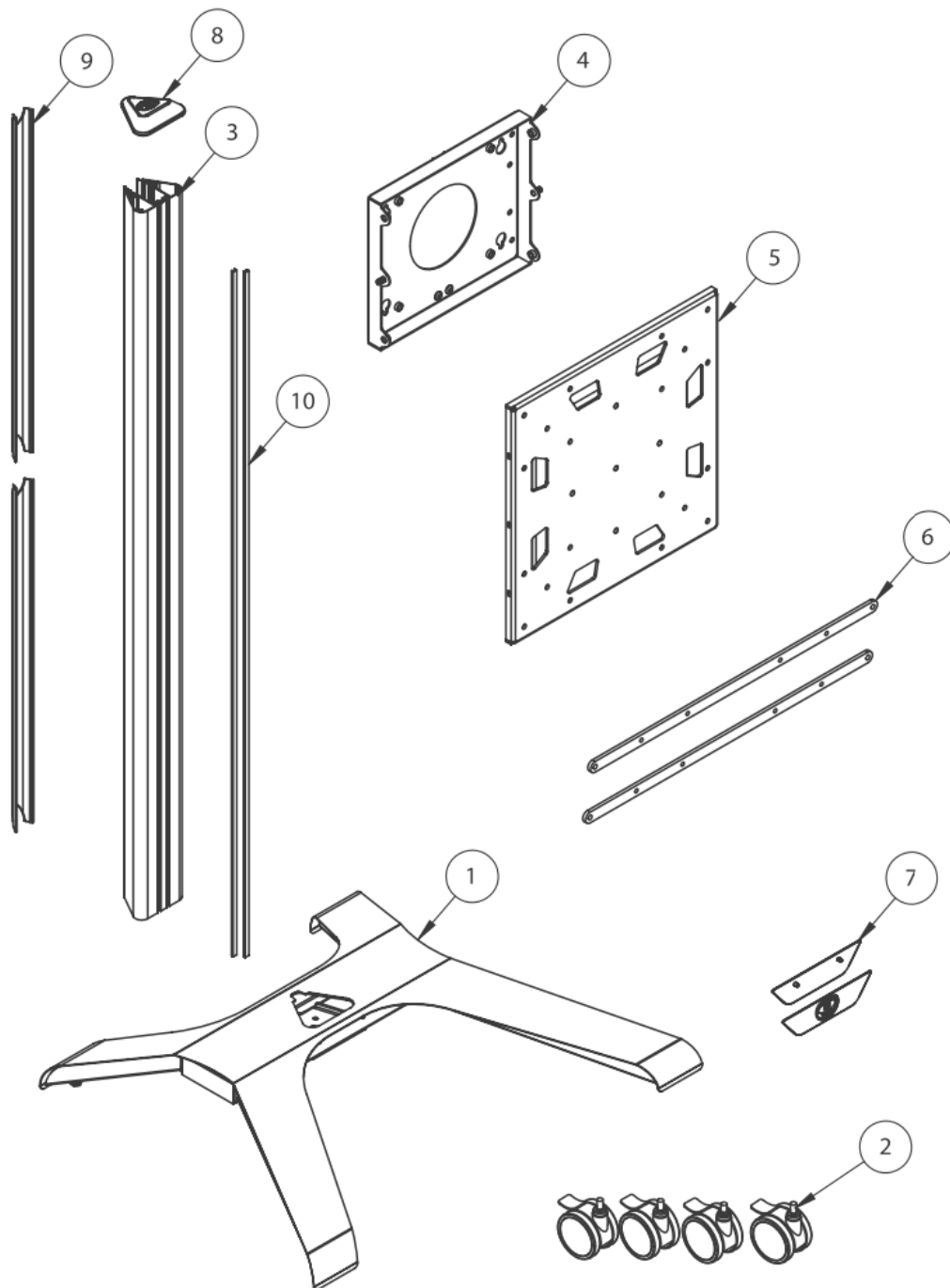

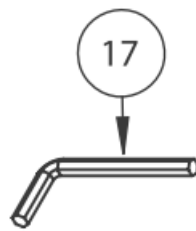
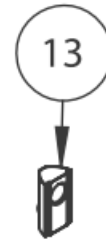
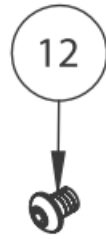
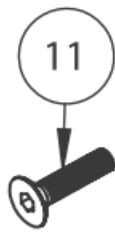

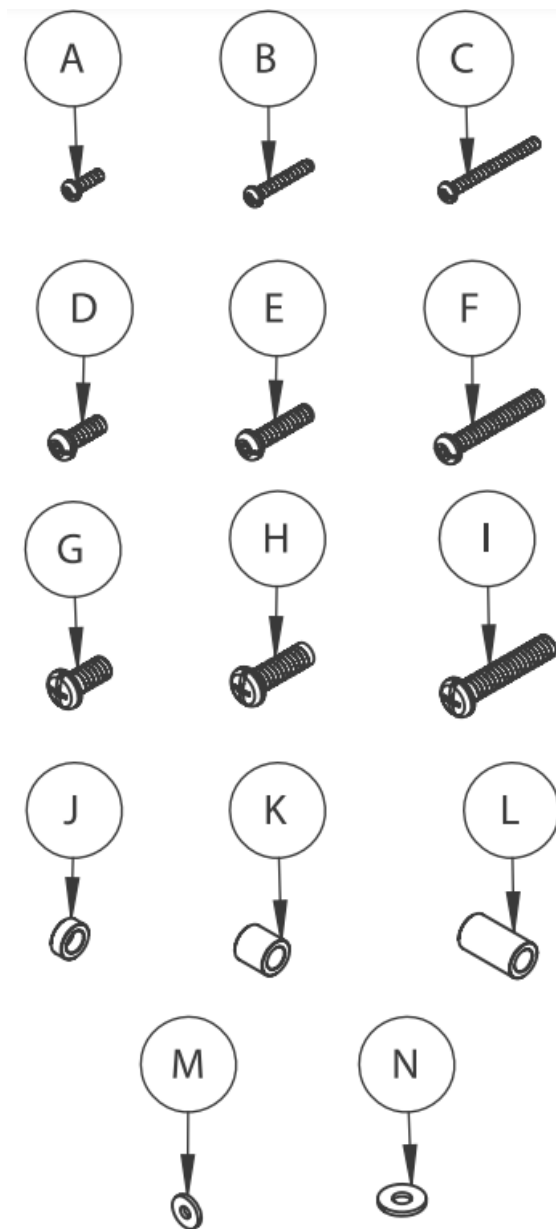

REF	PART NAME	QTY
1	BASE	1
2	CASTOR	4
3	COLUMN	1
4	MOUNTING PLATE	1
5	INTERFACE PLATE	1
6	600mm ADAPTOR ARMS	2
7	TRIM	2
8	COLUMN END CAP	1
9	COLUMN REAR COVER	2
10	COLUMN STRIP	2
ti	M8 x 35mm CSK SCREW	4

12	M8 x 10mm SCREW	
13	SLIDING NUT	
14	M8 x 16mm SCREW	4
15	PLASTIC WASHER	4
16	M8 x 12mm CSK SCREW	4
17	5AF HEX KEY	1
INTERFACE KIT		
A	M4 x 12mm SCREW	4
B	M4 x 25mm SCREW	4
C	M4 x 40mm SCREW	4
D	M6 x 16mm SCREW	4
E	M6 x 25mm SCREW	4
F	M6 x 40mm SCREW	4
G	M8 x 16mm SCREW	4
H	M8 x 25mm SCREW	4
I	M8 x 40mm SCREW	4
J	5mm SPACER	4
K	13mm SPACER	4
L	24mm SPACER	4
M	M4 METAL WASHER	4
N	M6 METAL WASHER	4

*2pcs included mounting AV accessories such as shelves to the column

INSTALLATION TOOLS REQUIRED

Crosshead
screwdriver



Pliers/Cutter

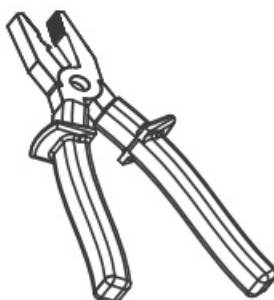

13mm Spanner
(optional)



INSTALLATION INSTRUCTIONS

1. FIX CASTORS TO BASE

Screw 4 x item 2 into item 1 and apply the brakes.

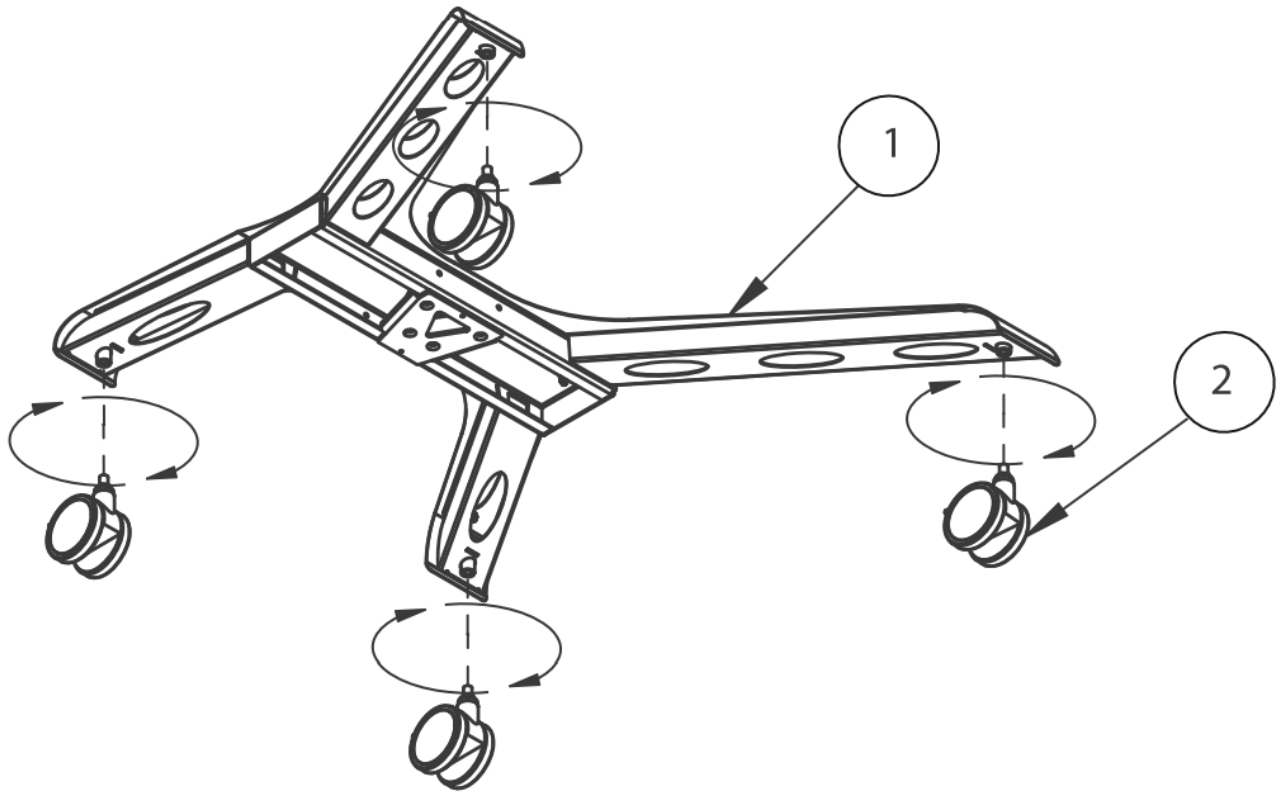

2. ATTACH COLUMN TO BASE

Stand item 1 in its upright position. Insert item 3 into the cut-out in item 1. Screw 4 x item 11 through the underside of item 1 into item 3.

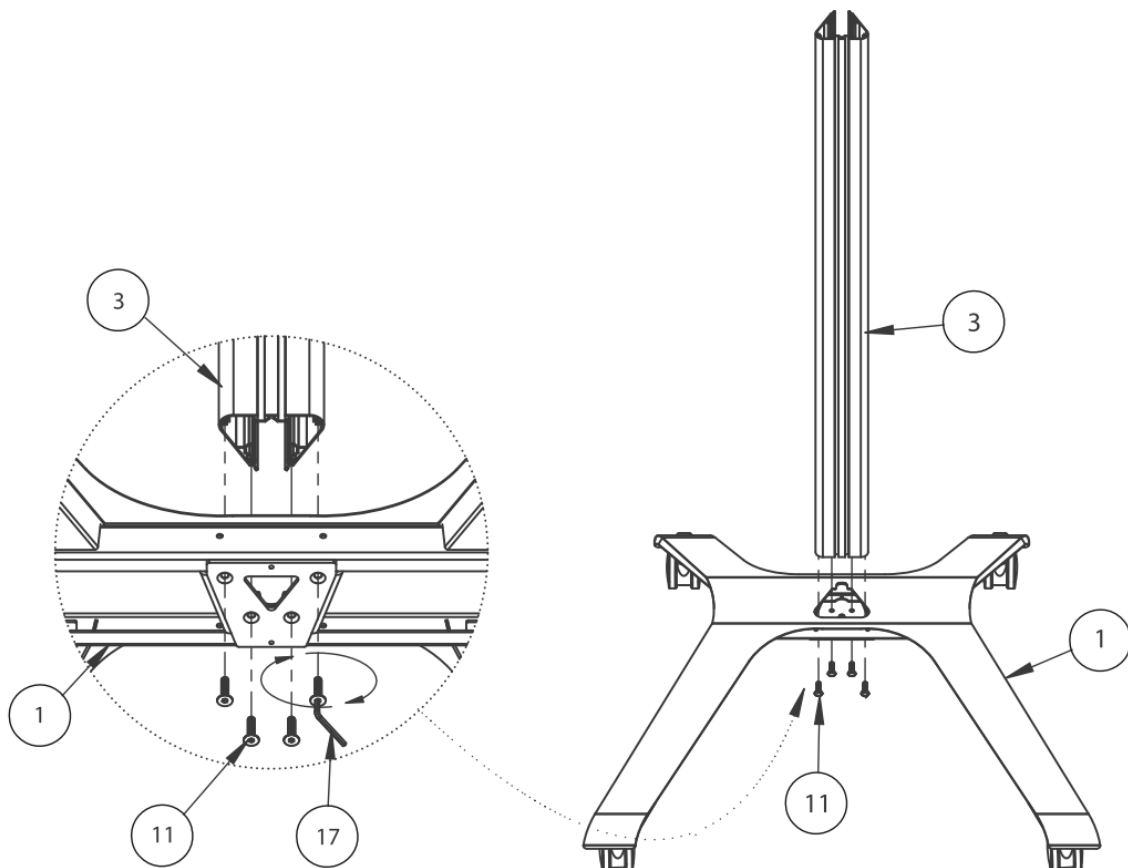

3. ATTACH MOUNTING PLATE TO COLUMN

Slide 4 x item 13 into front slots in item 3. Screw 4 x item 12 through holes in item 4 into item 13.

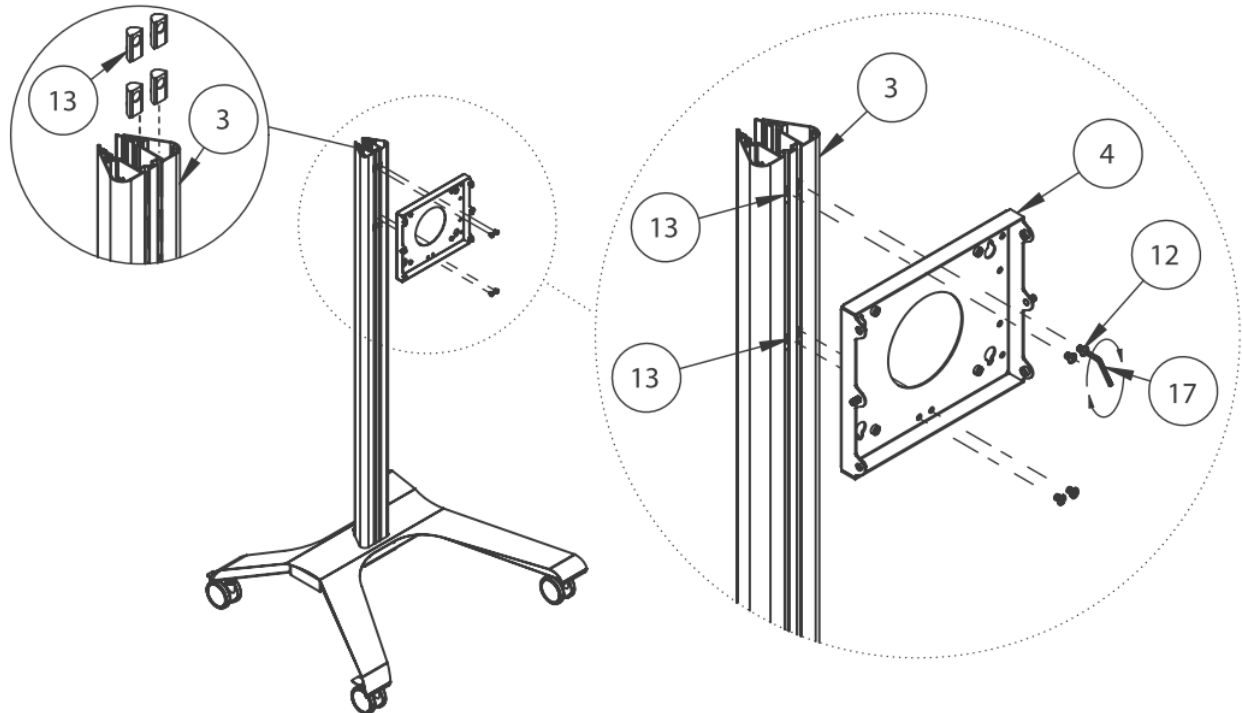

4. A. FIX INTERFACE PLATE TO SCREEN

Fix item 5 to the back of the screen using the interface kit. See Step 4c if the installation requires the screen to be locked in position.

Note: If the screen needs to rotate in an anti-clockwise direction, set the angle to 90° before attaching the plate to the screen.

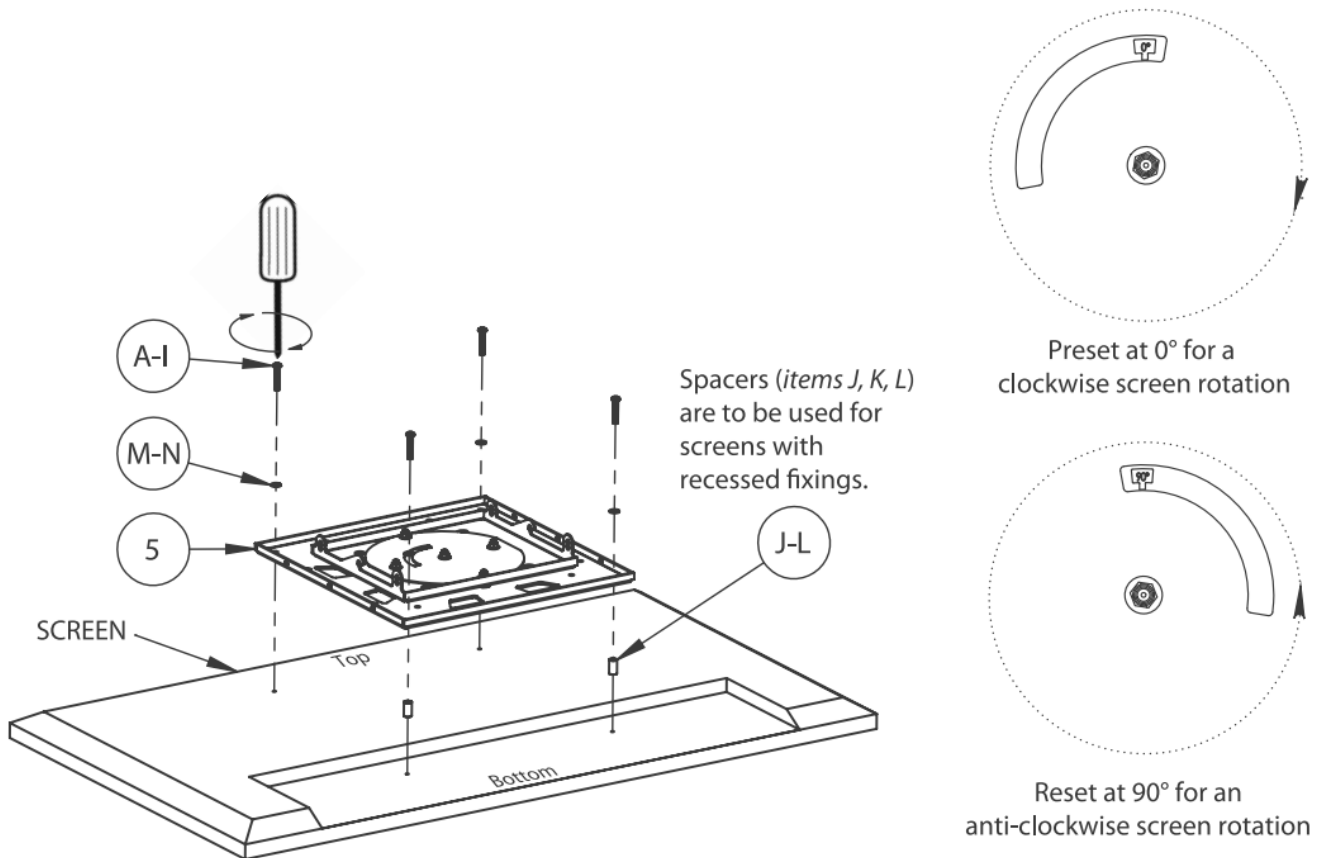

4B. USING 600MM ADAPTOR ARMS

i) Attach item 5 to item 6 using item 16.

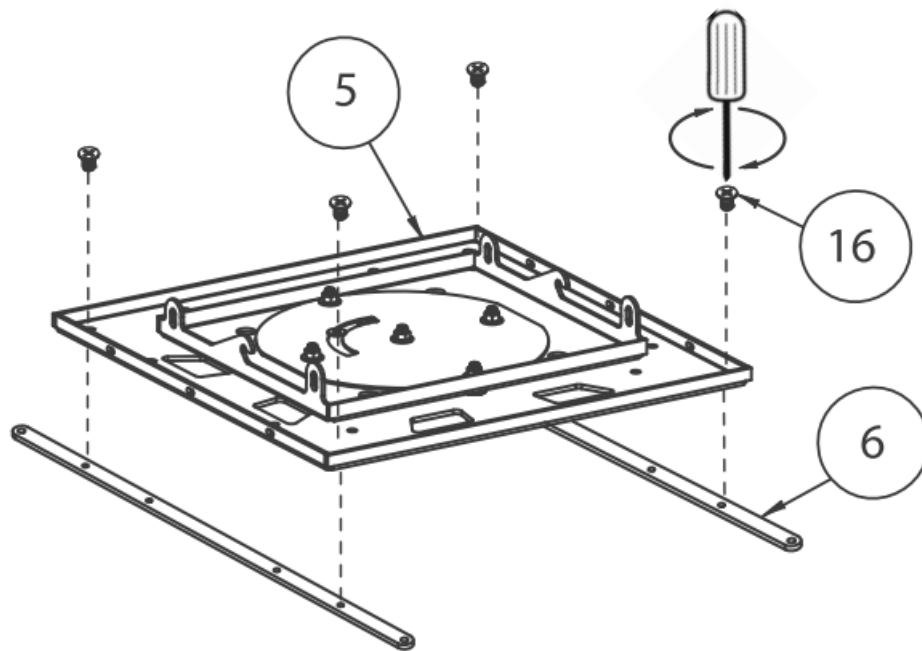

ii) Attach item 6 to rear of screen using the interface kit (items A-1).

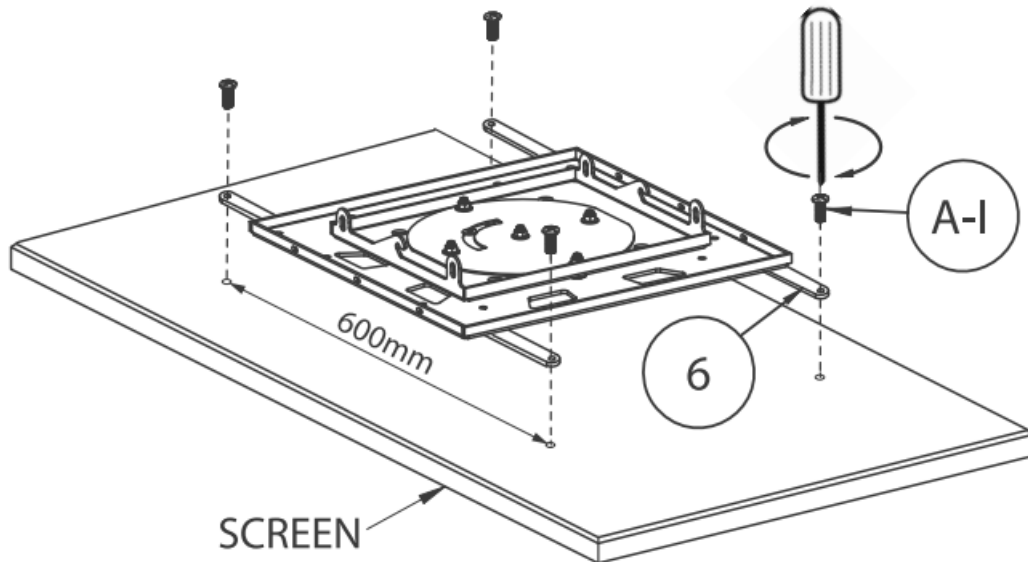

4c. LOCK ANGLE (OPTIONAL)

If the installation requires the screen to be locked in position, set the angle on the rotation plate before attaching item 5 to the screen. Use a 13mm spanner to fully tighten all the M8 Nuts on item 5, preventing any further rotation.

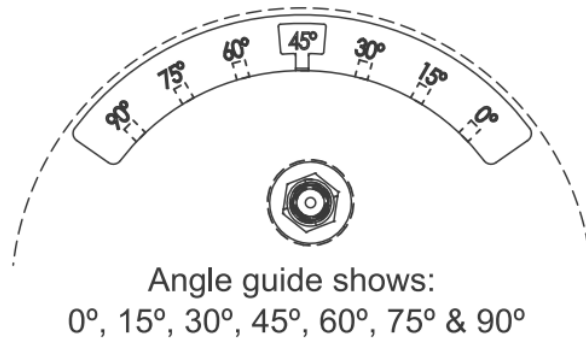
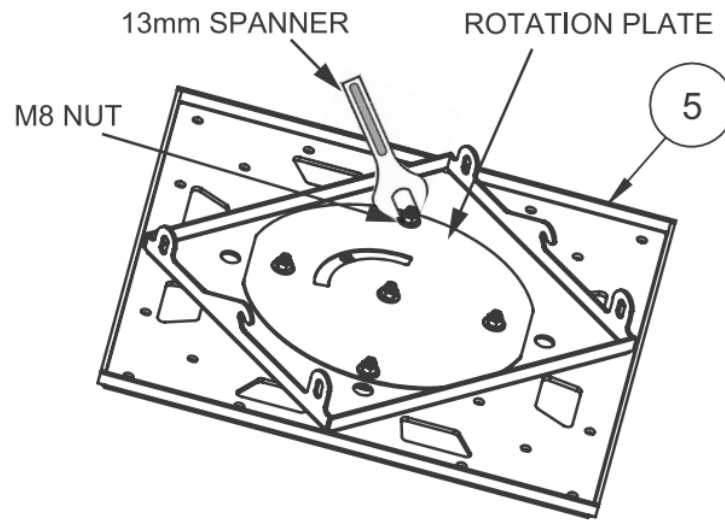

5. HOOK ON SCREEN

Hook screen onto *item 4*.

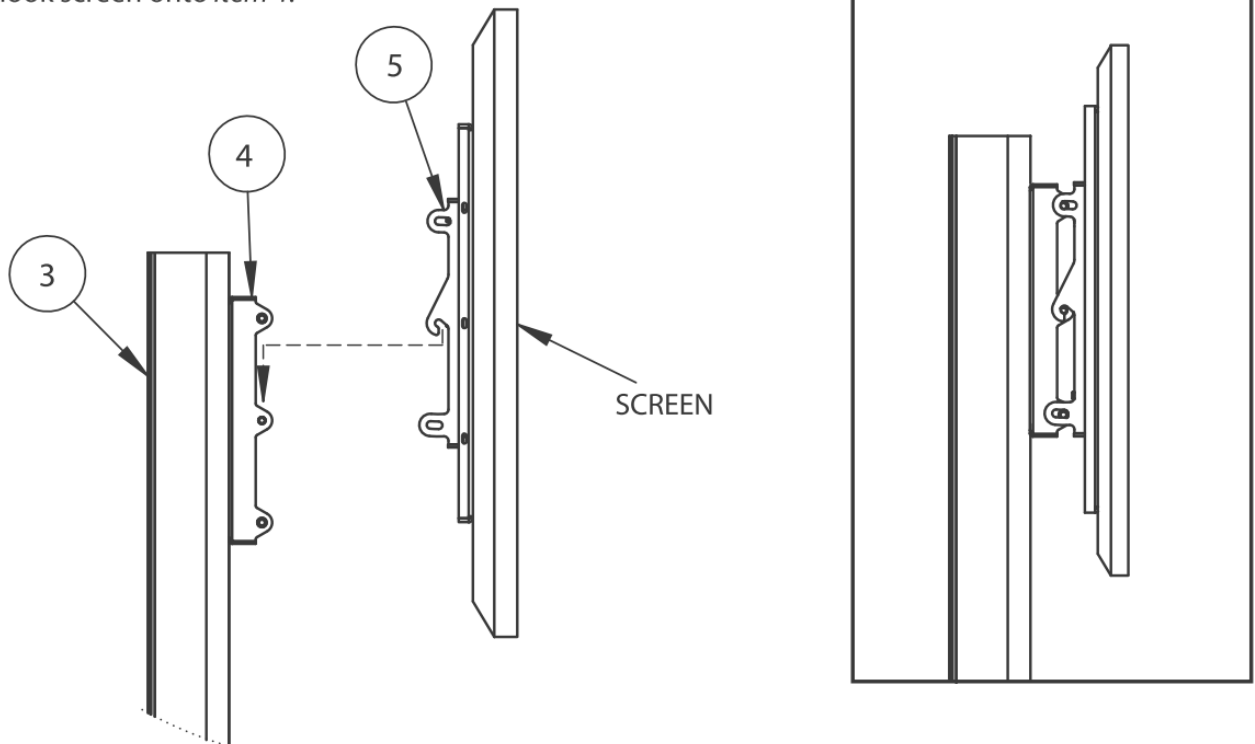

6. SECURE INTERFACE PLATE ON MOUNTING PLATE AND SET TILT (IF REQUIRED)

Insert items 14 & 15 into items 4 & 5. Do not fully tighten until the tilt has been set.

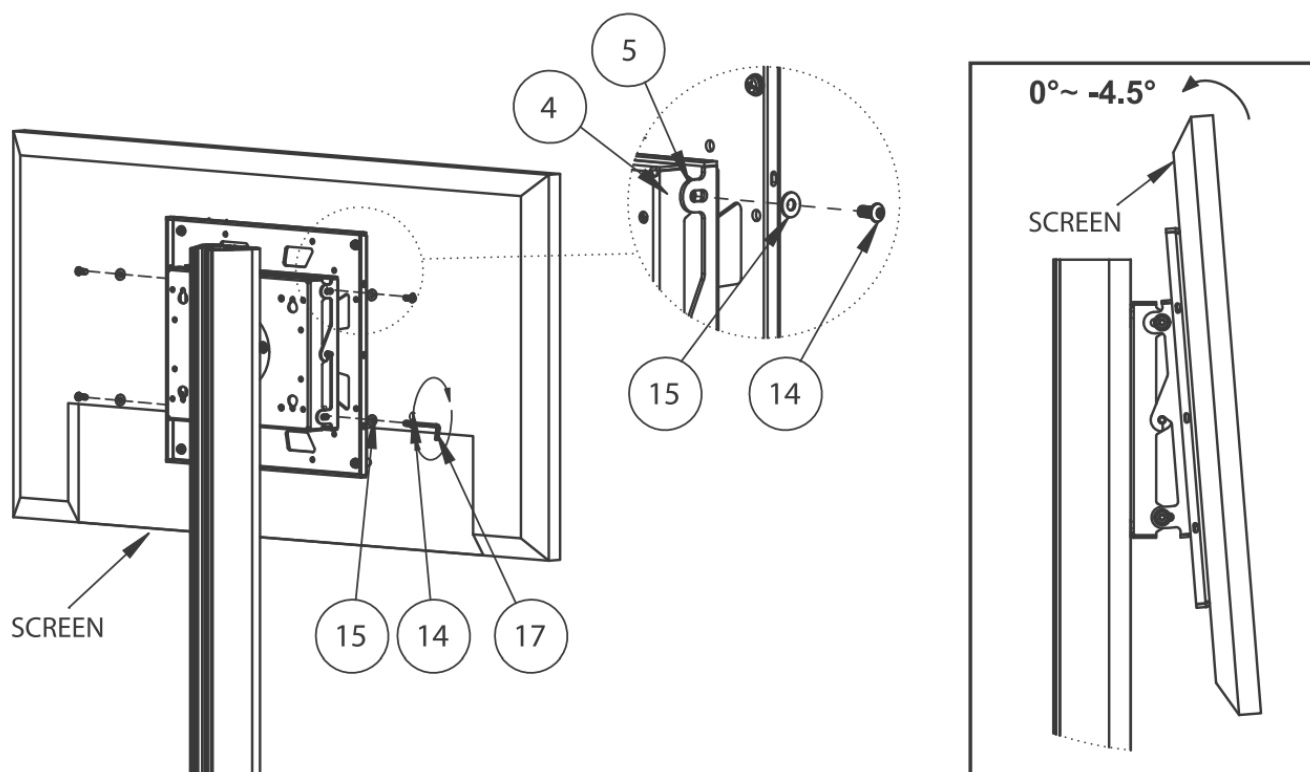

7. ATTACH PLASTIC COVERS

- i. Attach item 9 to the rear of item 3.
- ii. Fit item 8 to the top of item 3.
- iii. Fit item 7 into the front and rear of item 1.

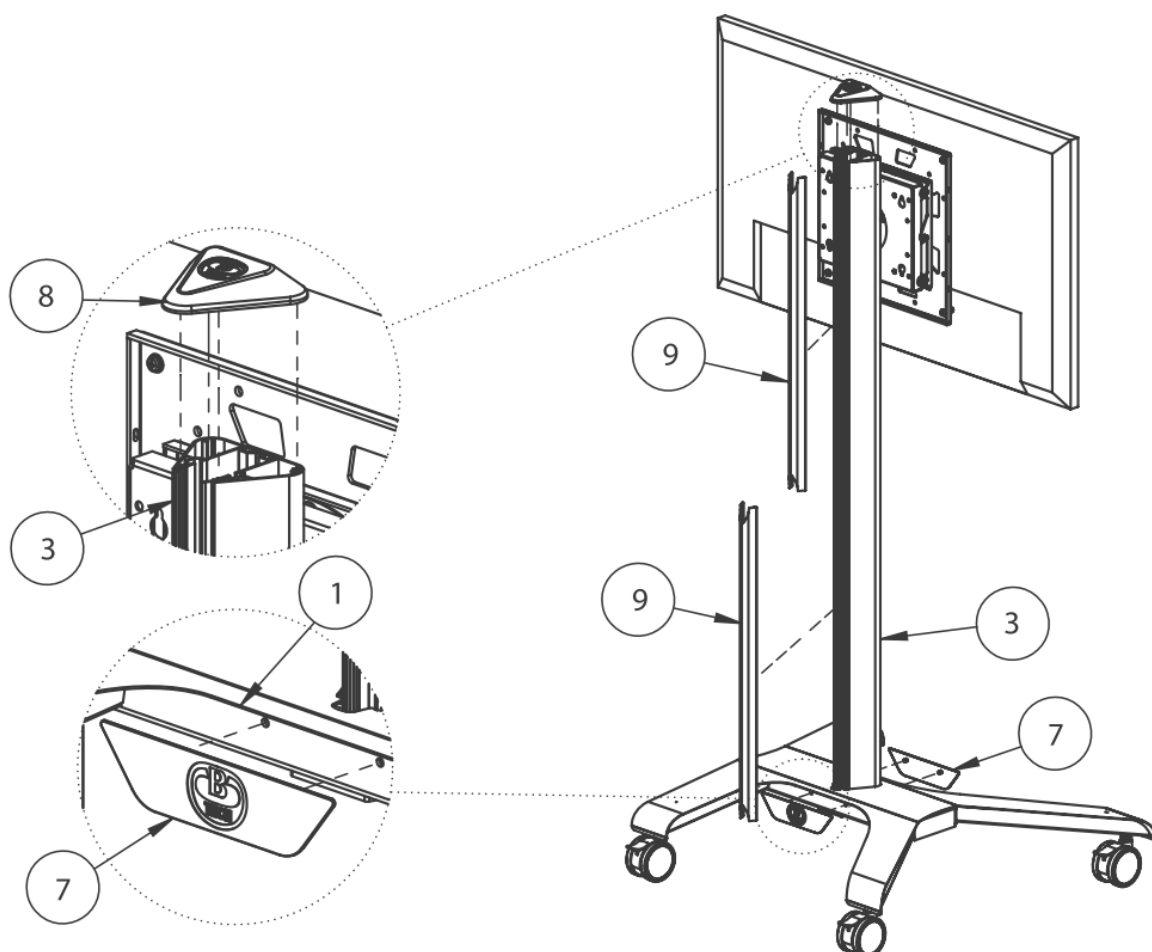

8. INSERT COLUMN STRIPS

Insert item 10 into the front slots on item 3.

Note: Item 10 will need to be cut to size.

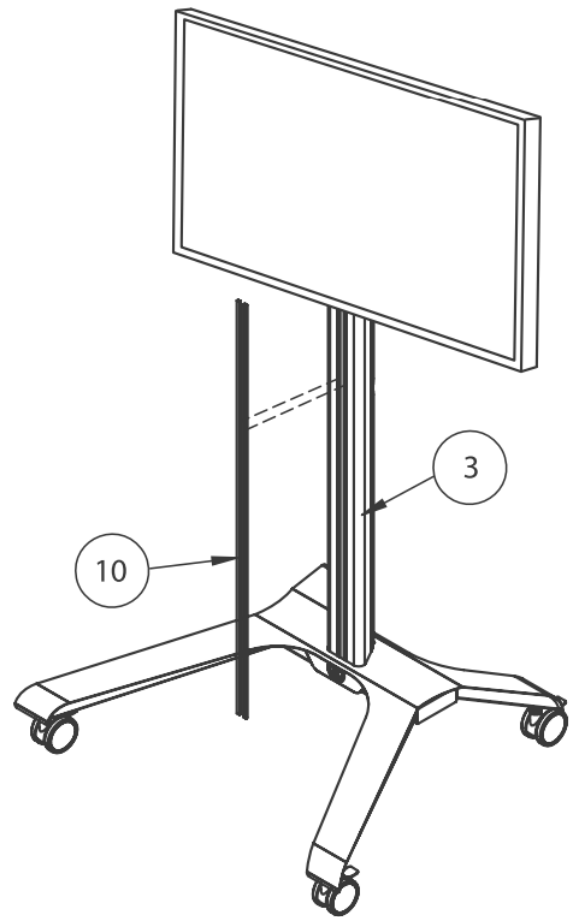
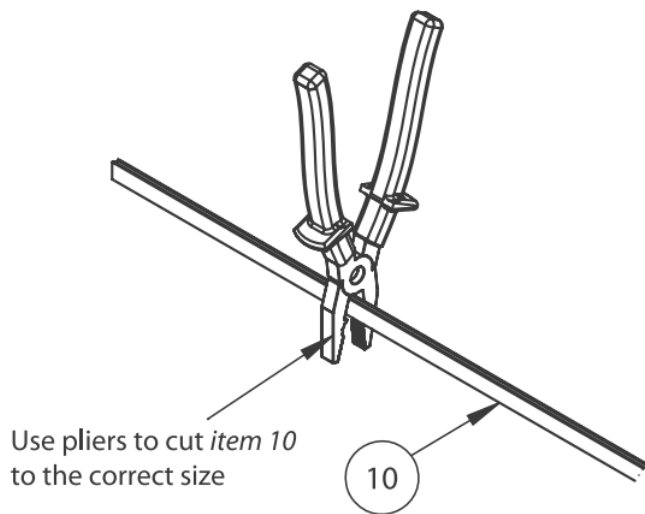

9. CABLE MANAGEMENT

Route cables through bottom of item 1.

Cut-outs in item 1 can be used for cable management.

Note: Allow enough slack in the cable for screen rotation.

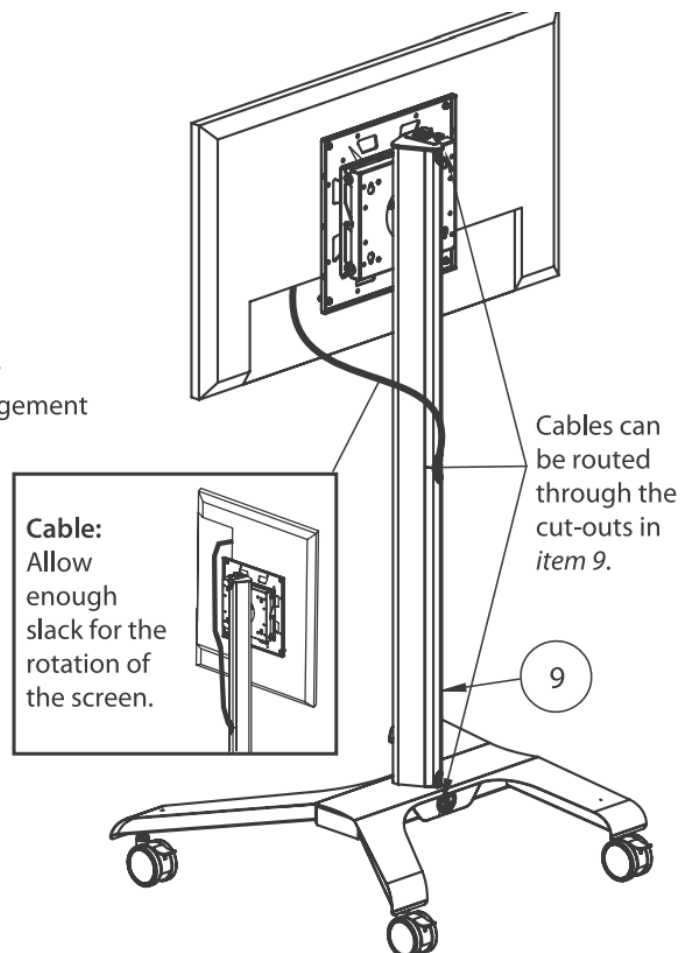
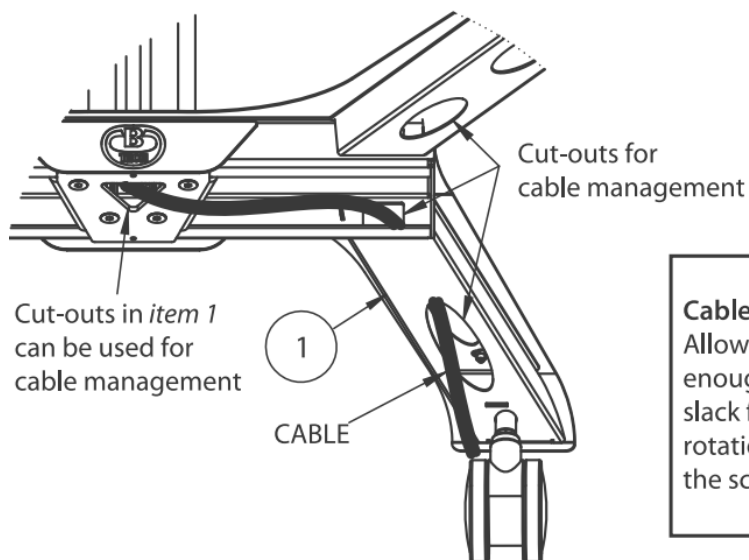

Warning!

Push the trolley on the narrow side, never pull the trolley. Do not push at the top of the trolley, push near the middle.

BT8566 PRODUCT DIMENSIONS

PLEASE KEEP THIS FOR FUTURE REFERENCE

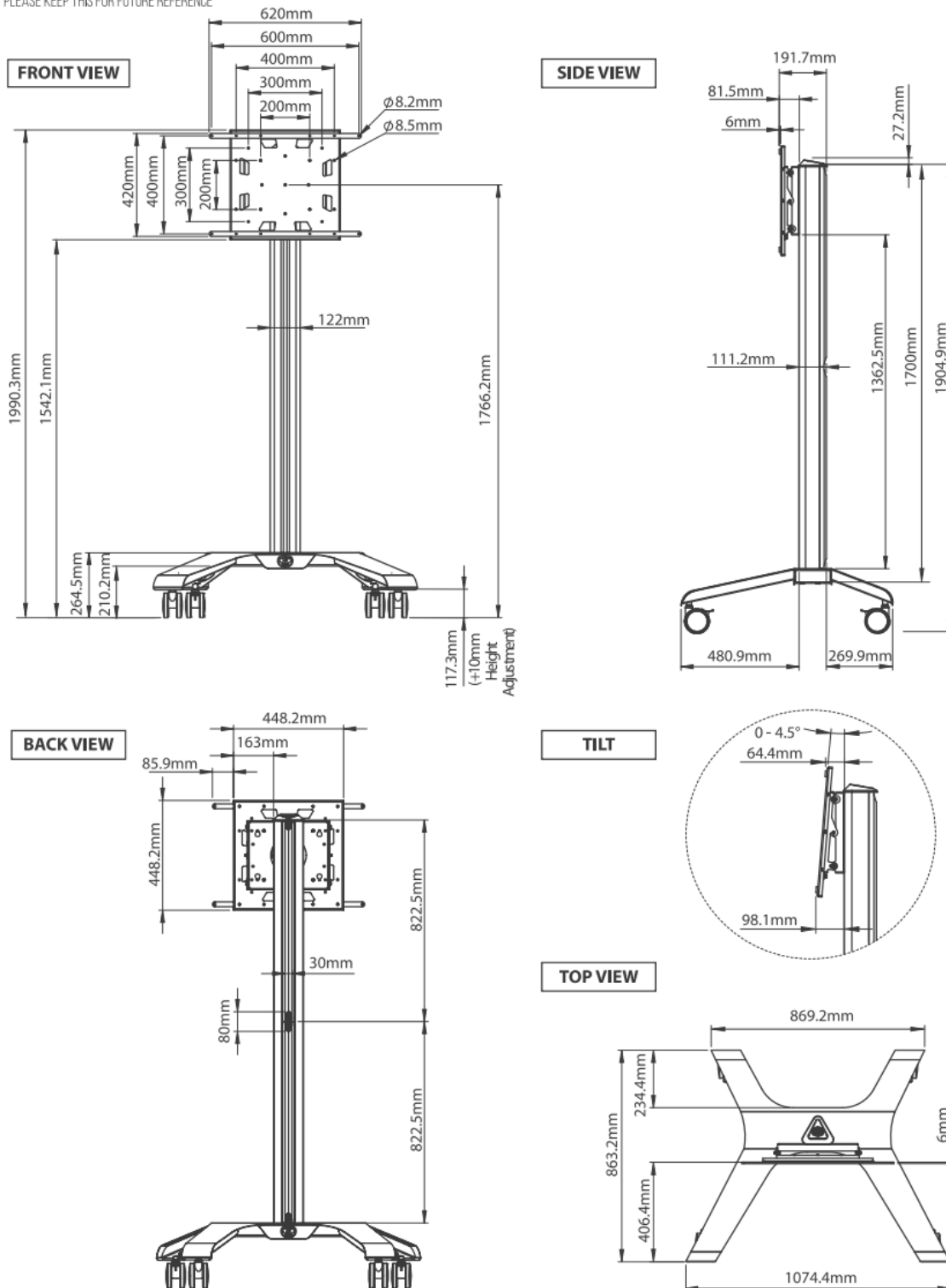

THESE INSTRUCTIONS ARE INTENDED AS A GUIDE ONLY AND B-TECH ACCEPTS NO LIABILITY FOR THE ACCURACY OF THE INFORMATION CONTAINED IN THIS DOCUMENT.



CONTACT:

info@btechavmounts.com

©2019 B-Tech International Design & Manufacturing Ltd. All rights reserved. B-Tech AV Mounts is a division of B-Tech International Design & Manufacturing Ltd. B-Tech AV Mounts and the B-Tech logo are registered trademarks. All other brands and product names are trademarks of their respective owners. Photographs are for illustrative

purposes only. E&OE.
AMA-BT8566-V1-0719-110
MADE IN VIETNAM



<http://btechavmounts.com/bt8566>



For More Information Visit www.btechavmounts.com



B-TECH AV MOUNTS®



Documents / Resources

	<p>B TECH BT8566 Flat Screen Display Trolley [pdf] Installation Guide</p> <p>BT8566, Flat Screen Display Trolley, BT8566 Flat Screen Display Trolley, Screen Display Trolley, Display Trolley, Trolley</p>
---	--