

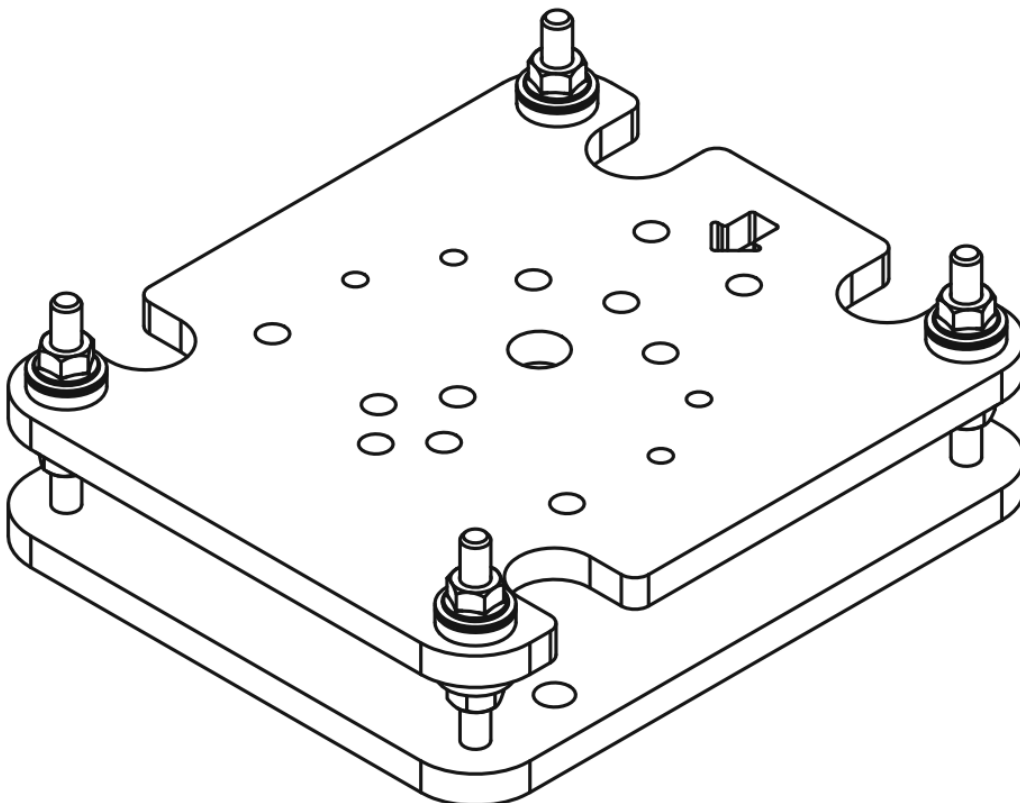

B TECH BT8380-AFB Fixed Floor Base with Level Adjustment Installation Guide

[Home](#) » [B-TECH](#) » B TECH BT8380-AFB Fixed Floor Base with Level Adjustment Installation Guide 

B TECH BT8380-AFB Fixed Floor Base with Level Adjustment



Contents

1 INSTALLATION SAFETY INSTRUCTIONS

2 SPECIFICATIONS

3 PARTS LIST

4 DIMENSIONS

5 INSTALLATION INSTRUCTIONS

5.1 BOLT BASE ONTO FLOOR

5.2 ATTACH COLUMN/POLE/RAIL TO PLATE

5.3 FIX PLATE & COLUMN ONTO BASE

5.4 LEVEL BASE

6 Customer Support

7 Documents / Resources

7.1 References

8 Related Posts

INSTALLATION SAFETY INSTRUCTIONS



CAUTION This mount is intended for use only with the maximum weights indicated. Use with equipment heavier than the maximum indicated may result in instability causing possible injury.

Do not attempt to install this product until all instructions and warnings have been read and properly understood. Please keep these instructions for future reference.

Please check carefully to make sure there are no missing or defective parts – defective parts must never be used. B-Tech AV Mounts, its distributors and dealers are not liable or responsible for damage or injury caused by improper installation, improper use or failure to observe these safety instructions. In such cases, all guarantees will expire.

General

B-Tech AV Mounts recommends that a professional AV installer or other suitably qualified person install this product.

Great care must always be taken during installation as most AV equipment is of a fragile nature, possibly heavy and easily damaged if dropped.

If you do not fully understand the instructions or are not sure how to install this product safely, then please consult a professional for advice and/or to install this product for you. Failure to mount this product correctly may cause serious injury or death, both during installation and at any time thereafter.

Do not mount any AV equipment that exceeds the specific weight limit of the product you are installing.

This weight limit will be clearly stated on each product and its packaging and will vary from product to product.

Product location

Please pay careful attention to where this product is located. Designed for indoor use, this mount is suitable for public or home installation. Check load capacity of the floor prior to installation as some surfaces are not suitable for installation.

When verifying the stability of the structure, consider the following external factors: The strength of the floor, exposure to sudden and severe wind and danger arising from contact with people and / or objects (eg installations in passageways, emergency exits), if located in a public or frequently populated area ensure that the product is out of the immediate reach of people. When drilling holes it is essential to avoid contact with electrical cables and water or gas pipes contained within.

Use of a good quality live wire detector and hidden object locator is therefore recommended. Only drill into structures when you are sure it is safe to do so.

Fixing hardware

It is highly recommended that all fixing screws be used where supplied and that the purpose of all other fixing hardware is fully understood. In some cases more AV equipment fixing hardware will be supplied to accommodate

different models of equipment and set up configurations. The installer must be satisfied that any supplied fixing hardware is suitable for each specific installation.

If any fixing screws or included hardware are deemed not sufficient for a safe installation then please consult a professional or your local hardware store.

Hazard limitation

When routing cables take advantage of any built in cable management features that the product might provide and ensure that all cables are tidy and secure. Check to see that any moving aspect of the product can do so unhindered by any cabling.

Some products have moving parts and the potential to cause injury through the crushing or trapping of fingers or other body parts. Particular attention to the nature of moving parts is required especially when assembling installing and adjusting during set up. Immediately after installation double-check that the work done is safe and secure. Double-check all necessary fixings are present and are of ample tightness.

It is recommended that periodic inspections of the product and its fixing points are made as frequently as possible (no more than 6 months apart) to ensure that safety is maintained.

If in doubt consult a professional AV installer or other suitably qualified person.

SPECIFICATIONS

- Heavy duty floor base with level adjustment suitable for use on uneven floors
- Compatible with a variety of B-Tech columns (BT8380 / BT8381 / BT8385), poles (BT4116 / BT4118) and rails (BT8390)
- Max load per base: 150kg (330lbs)
- Adjustment: +/- 13.5mm (0.5") in each corner

PARTS LIST

ITEM	PART NAME	QTY
1	BASE PLATE	1
2	LEVELLING PLATE	1
3	M8 NUT	8
4	CUP WASHER	8
5	DOME WASHER	8
6	M6 x 40mm CAP HEAD SCREW	4
7	M8 x 40mm BUTTON HEAD SCREW	4
8	5AF HEX KEY	1

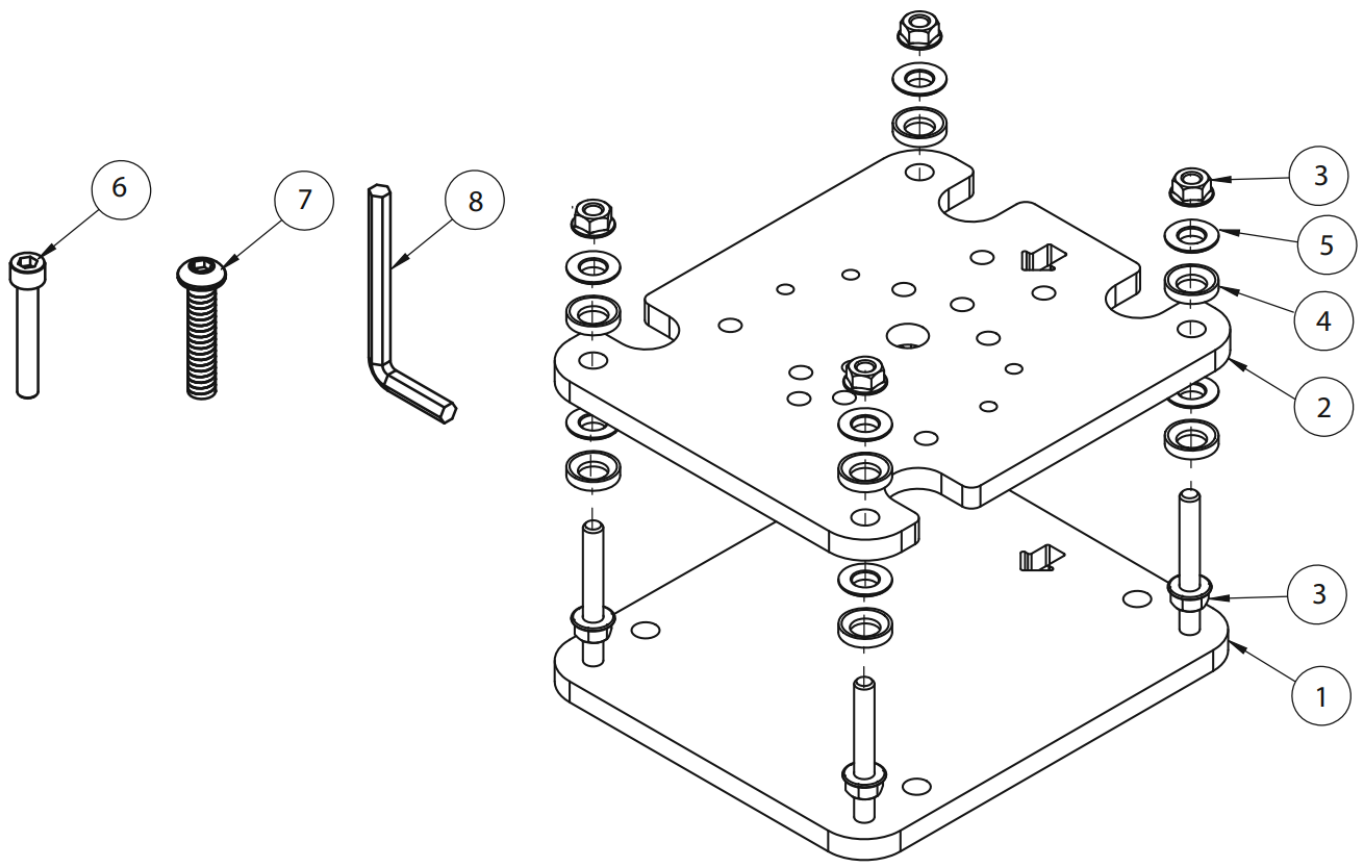

DIMENSIONS

THESE INSTRUCTIONS ARE INTENDED AS A GUIDE ONLY AND B-TECH ACCEPTS NO LIABILITY FOR THE ACCURACY OF THE INFORMATION CONTAINED IN THIS DOCUMENT.

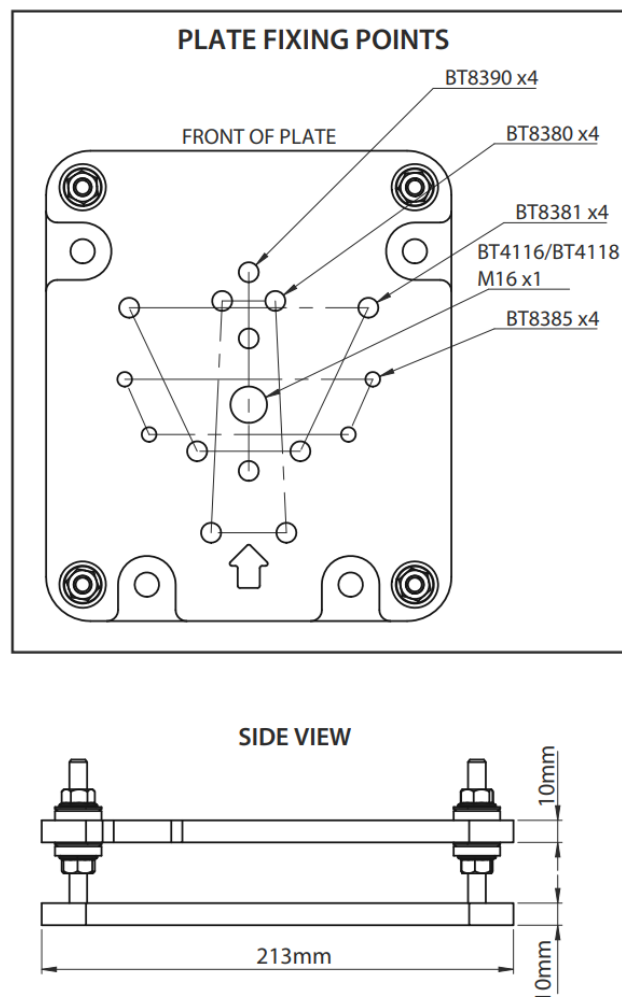
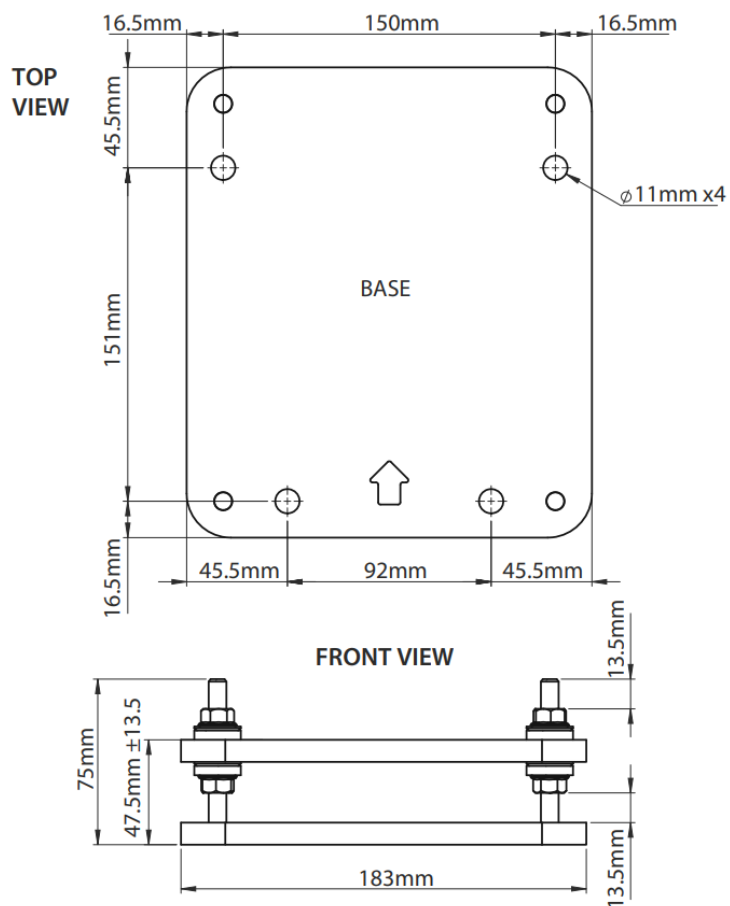

INSTALLATION INSTRUCTIONS

BOLT BASE ONTO FLOOR

1. Pre-drill holes in floor and using suitable ground anchor fixings (not supplied), fix item 1 to the floor.

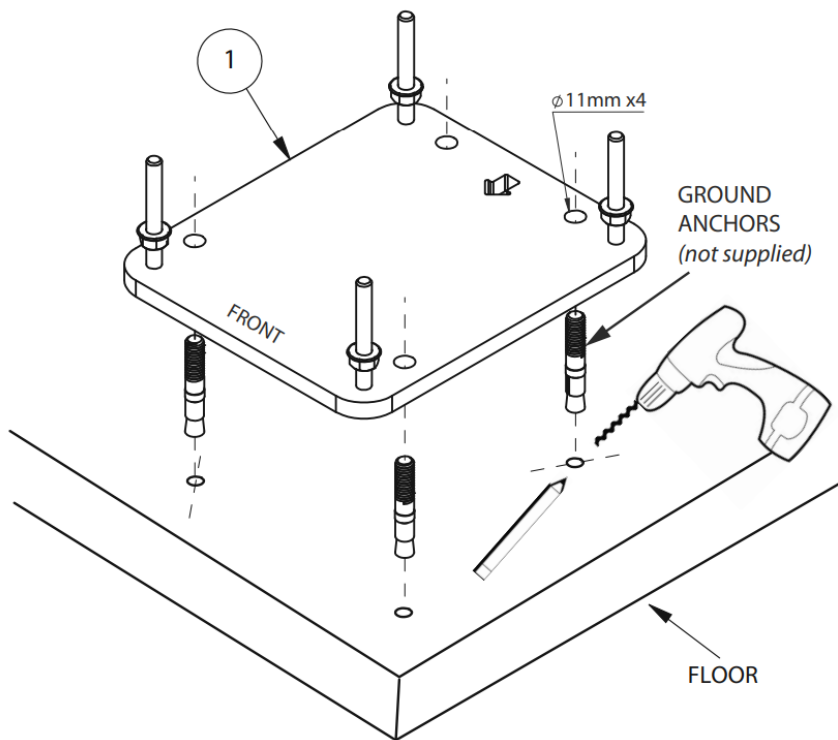

INSTALLATION TOOLS REQUIRED

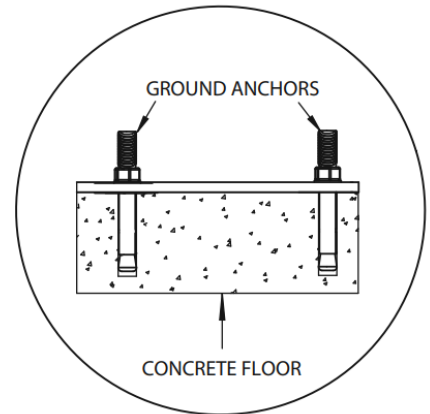
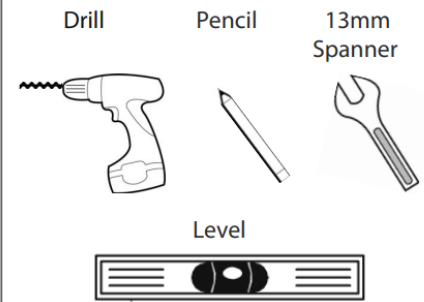

2. Add items 4 & 5 onto the stems of item 1.

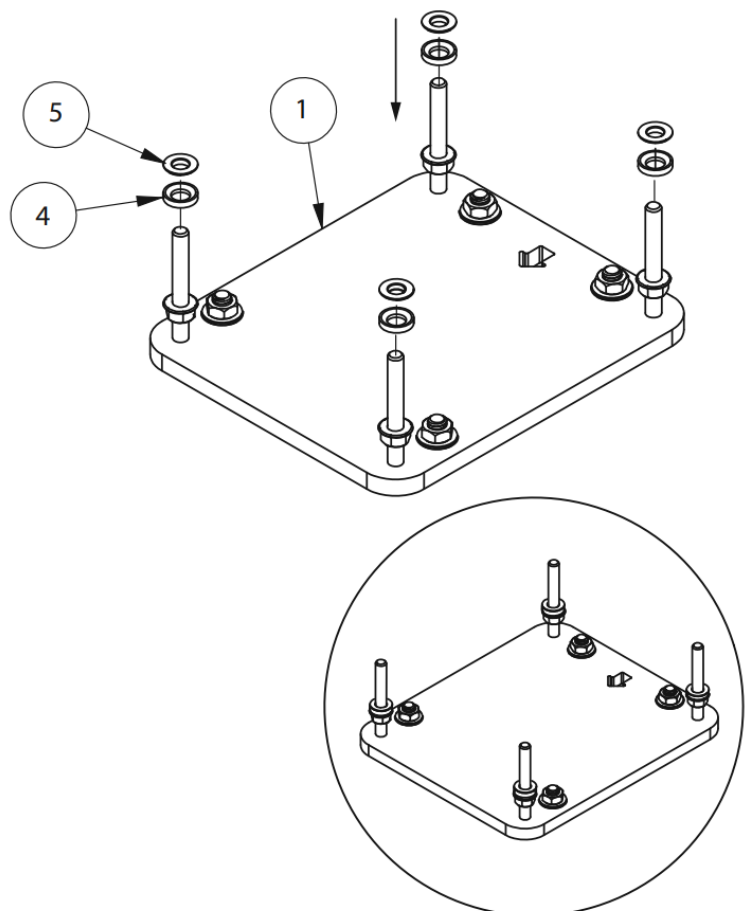
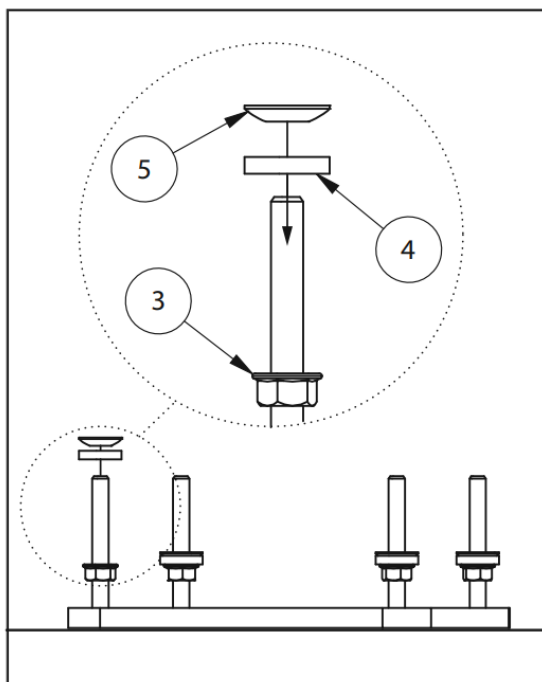

ATTACH COLUMN/POLE/RAIL TO PLATE

- A. BT8380 COLUMN

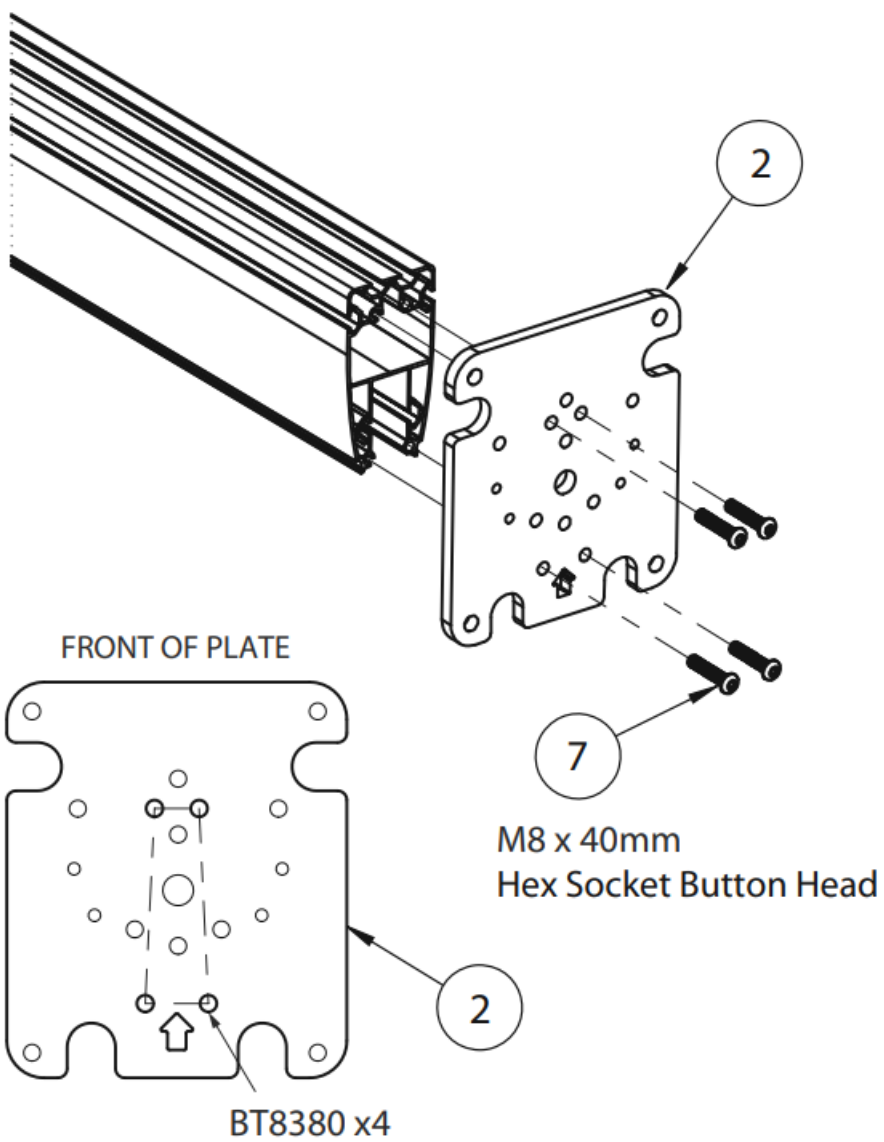

- B. BT8385 COLUMN

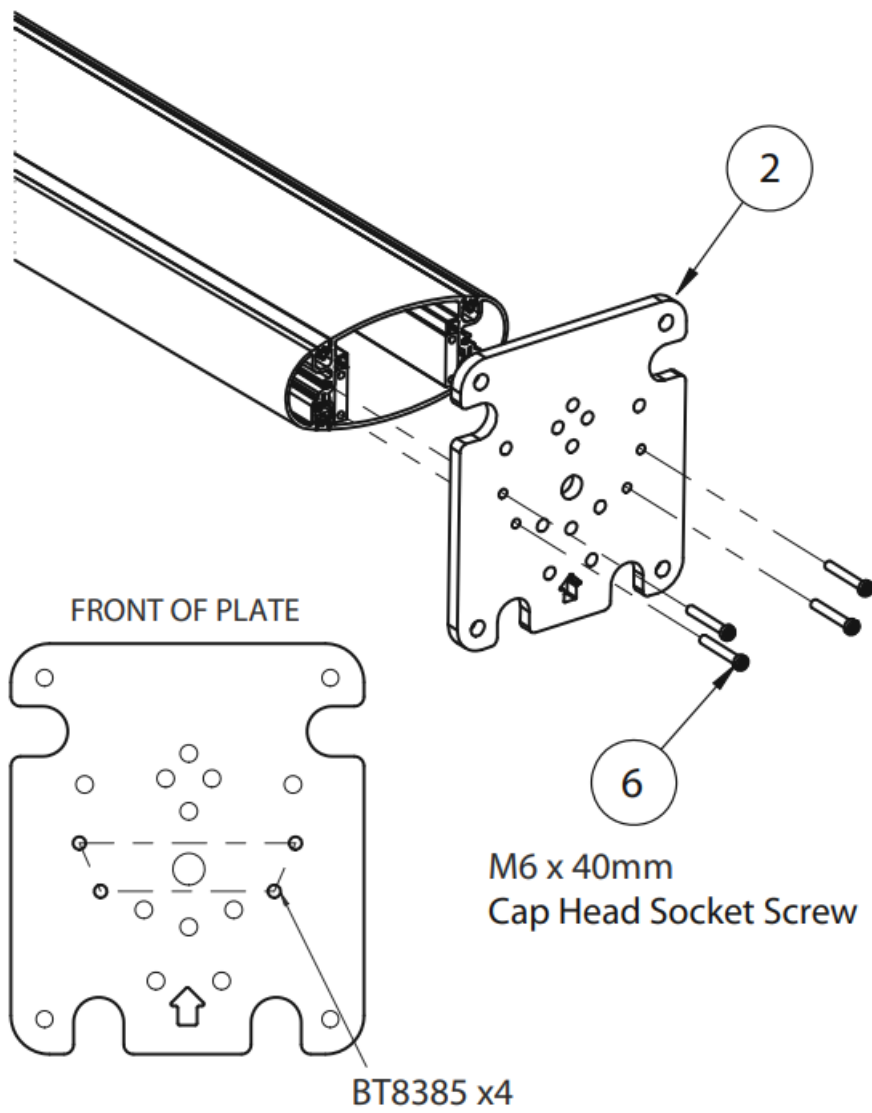

- C. BT8381 COLUMN

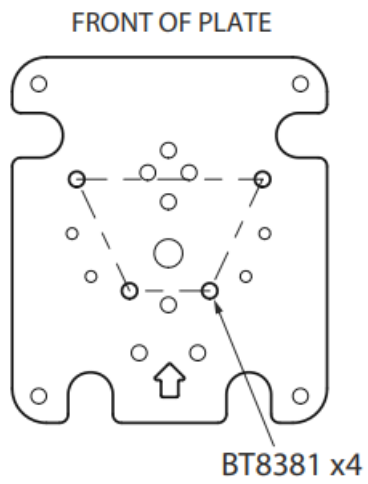
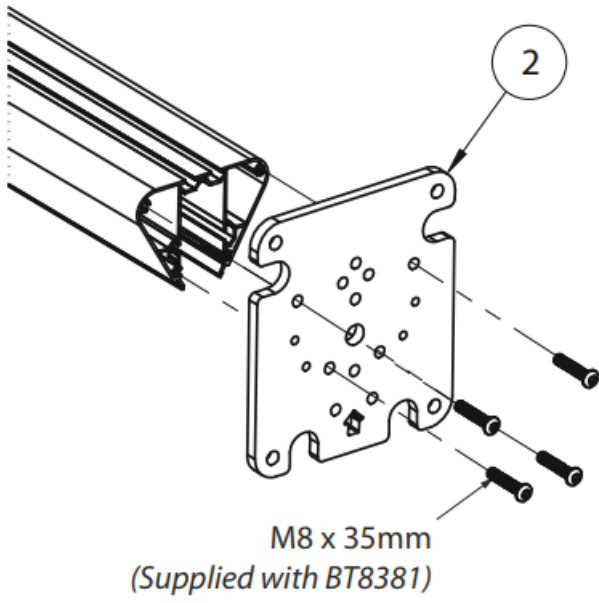

- **D. BT4116/BT4118 POLE**

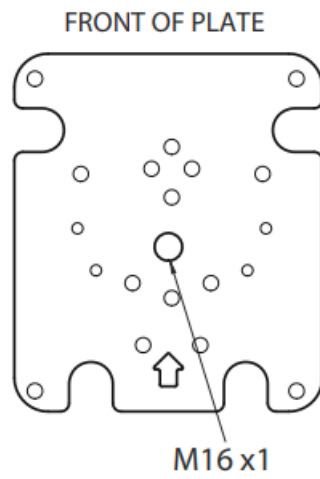
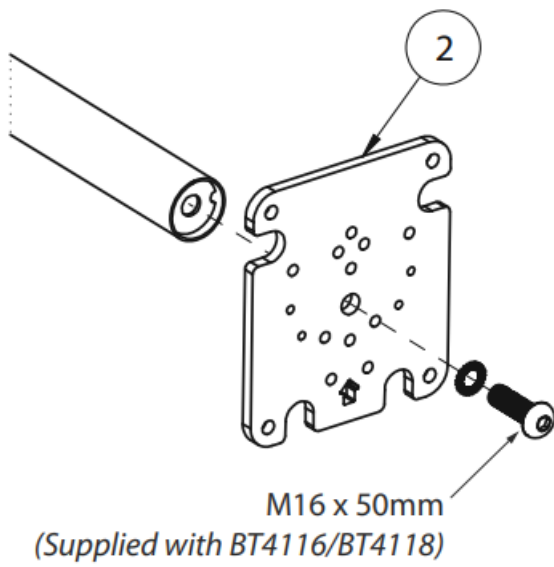

- **E. BT8390 RAIL**

Note: Holes must be threaded on rail

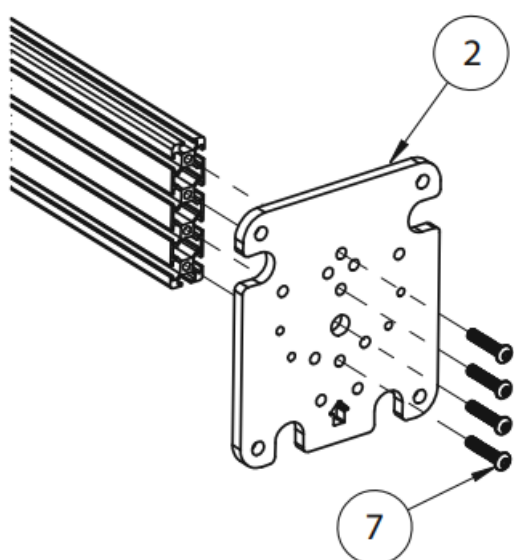

FRONT OF PLATE

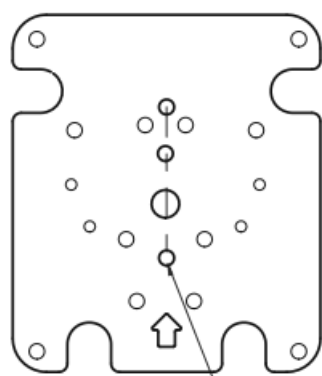

BT8390 x 4

FIX PLATE & COLUMN ONTO BASE

1. Mount item 2 onto item 1.
2. Fix items 3, 4 & 5 to item 1.

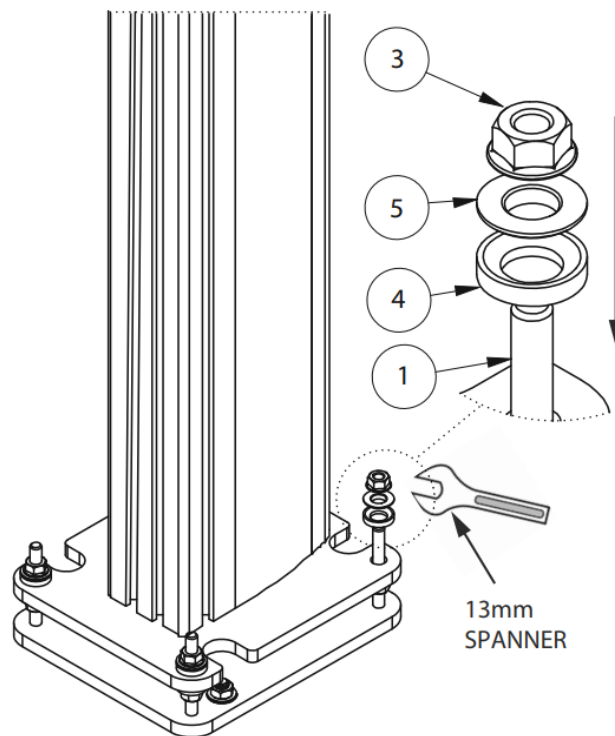
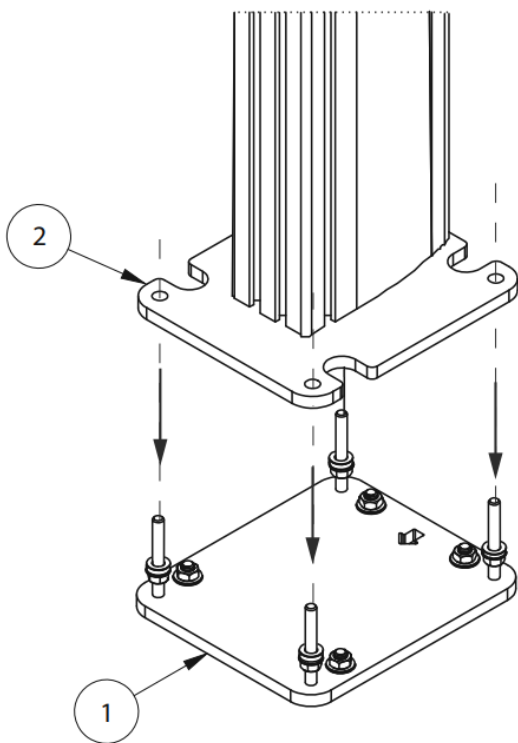

LEVEL BASE

Using a 13mm spanner, loosen the top nut (item 3) and adjust the bottom nut (item 3) up or down to level item 2. Once level, fully tighten the top nut.

Note: +/-13.5mm adjustment available in each corner.

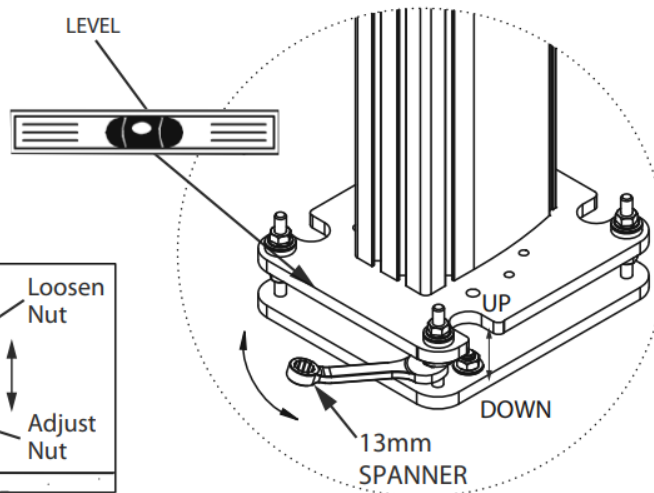
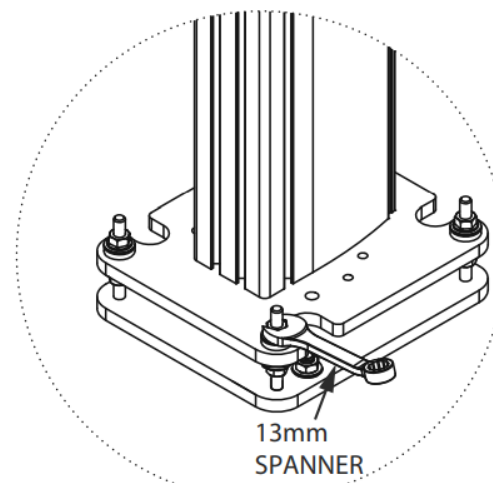
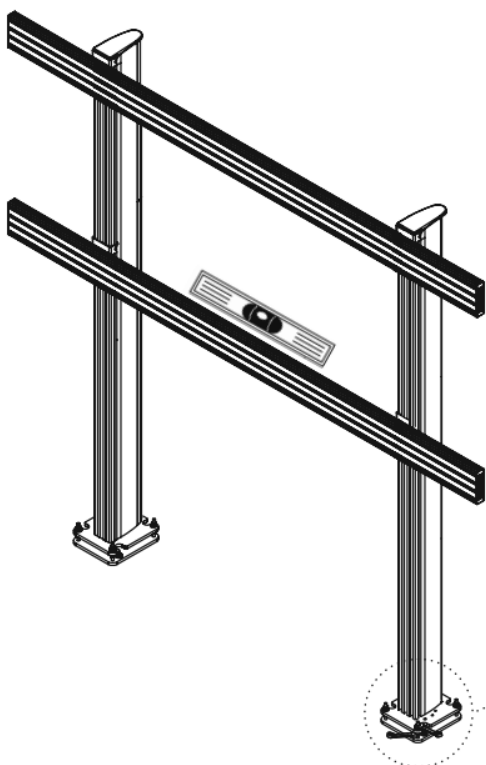

Customer Support

CONTACT:

info@btechavmounts.com

©2021 B-Tech International Design and Manufacturing Ltd. All rights reserved.

B-Tech AV Mounts is a division of B-Tech International Design and Manufacturing Ltd.

B-Tech AV Mounts and the B-Tech logo are registered trade marks.

All other brands and product names are trademarks of their respective owners.

Photographs are for illustrative purposes only. E&OE.

AMA-BT8380-AFB-V1-1121-50 MADE IN THE UK

For More Information Visit www.btechavmounts.com

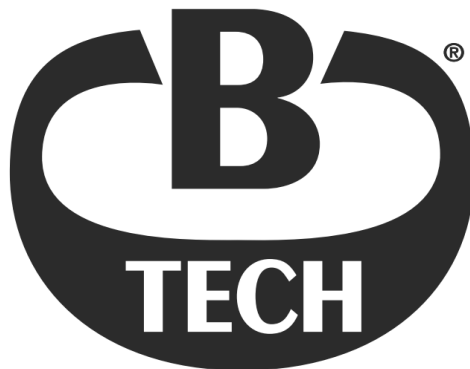

Documents / Resources

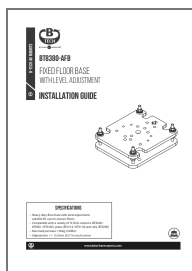

[B TECH BT8380-AFB Fixed Floor Base with Level Adjustment](#) [pdf] Installation Guide
BT8380-AFB, Fixed Floor Base with Level Adjustment, Fixed Floor Base, Floor Base with Level Adjustment, Floor Base, Base

References

-  [B-Tech AV Mounts - B-Tech International](#)

Manuals+.