



# B-TECH BT7781 Security Mount Instruction Manual

[Home](#) » [B-TECH](#) » B-TECH BT7781 Security Mount Instruction Manual 



**BT7781**  
**Security Mount**  
**For Chromecast With Google TV**

Contents

1

Parts List

2

Dimensions

3

Documents / Resources

3.1

References

Parts List

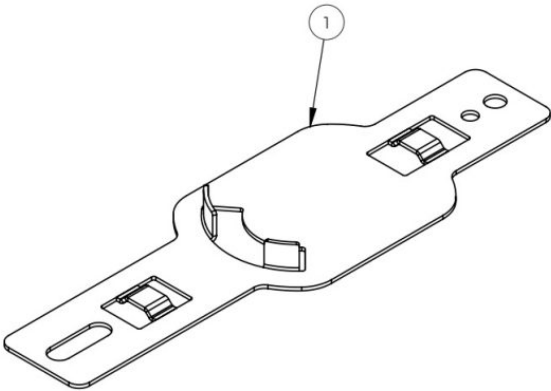

Item	Description	Qty
1	Mounting Plate	1

## Dimensions

Do not attempt to Install this product until all instructions and warnings have been read and properly understood. Please keep these instructions for future reference.

Please check carefully to make sure there are no missing or defective parts – defective parts must never be used. B-Tech AV Mounts, its distributors and dealers are not liable or responsible for damage or injury caused by improper installation, improper use or failure to observe these safety Instructions. In such cases, all guarantees will expire.

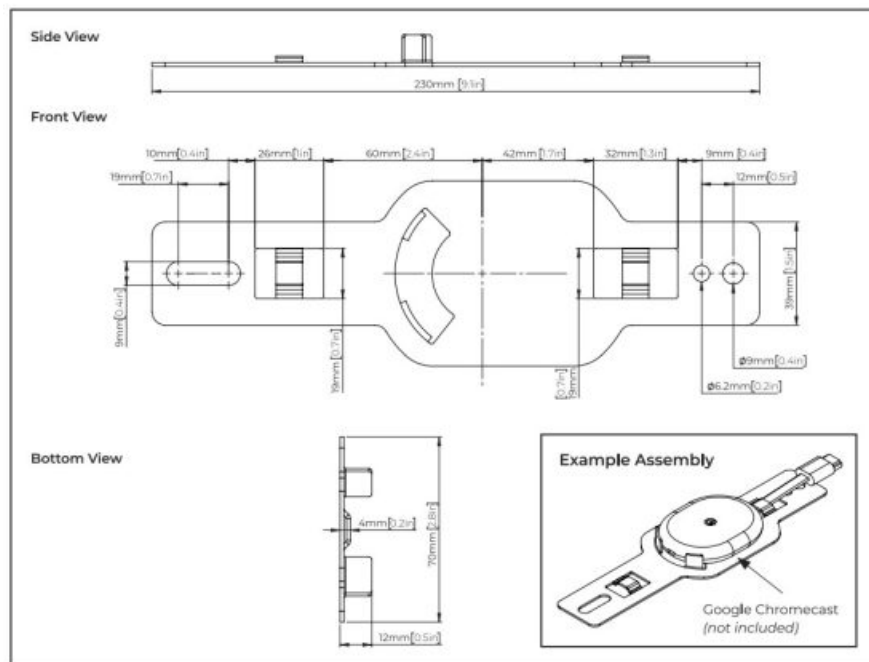

Contact: [info@btechavmounts.com](mailto:info@btechavmounts.com)

©2024 B-Tech AV Mounts Corporation Ltd. All rights reserved.

B-Tech AV Mounts is a division of B-Tech AV Mounts Corporation Ltd.

B-Tech AV Mounts and the B-Tech logo are registered trademarks.

All B-Tech images and symbols are exclusive property of B-Tech AV Mounts Corporation Ltd.

All other brands and product names are trademarks of their respective owners.

Any reproduction, retransmission or republication of any part of this manual is strictly prohibited, unless prior written permission has been granted by B-Tech AV Mounts Corporation Ltd.

Photographs are for illustrative purposes only. E&OE

AMA-BT7781-V1-0424-110 Made in Vietnam

**BTech**<sup>®</sup>  
AV Mounts



<https://www.btechavmounts.com/product-range/products/bt7781>

## Documents / Resources

	<p><a href="#">B-TECH BT7781 Security Mount</a> [pdf] Instruction Manual BT7781-W, BT7781, BT7781 Security Mount, Security Mount, Mount</p>
--	---

References

- [User Manual](#)

Manuals+, Privacy Policy

This website is an independent publication and is neither affiliated with nor endorsed by any of the trademark owners. The "Bluetooth®" word mark and logos are registered trademarks owned by Bluetooth SIG, Inc. The "Wi-Fi®" word mark and logos are registered trademarks owned by the Wi-Fi Alliance. Any use of these marks on this website does not imply any affiliation with or endorsement.