

B Tech BT7352-B Monitor Mount Stand Installation Guide

[Home](#) » [B-TECH](#) » B Tech BT7352-B Monitor Mount Stand Installation Guide 

B Tech BT7352-B Monitor Mount Stand

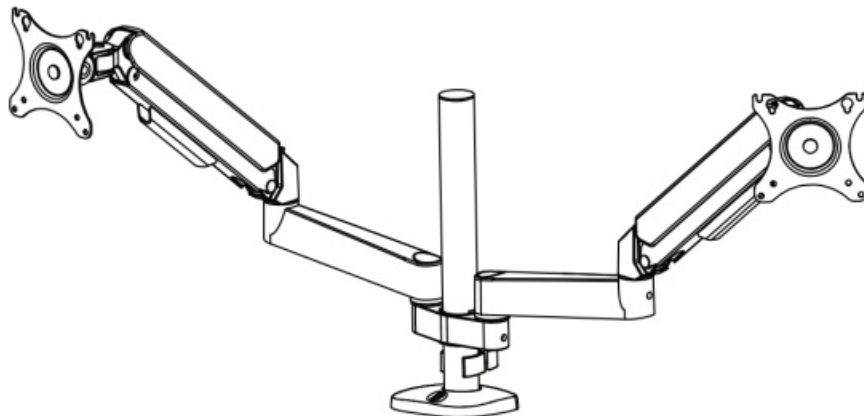





Contents

- [1 Important Information](#)
- [2 Installation Safety Instructions](#)
- [3 Parts List](#)
- [4 Installation Instructions](#)
- [5 Dimensions](#)
- [6 CUSTOMER SUPPORT](#)
- [7 Documents / Resources](#)
 - [7.1 References](#)
- [8 Related Posts](#)

Important Information

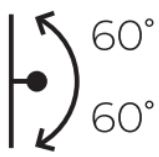
- Designed to mount 2 screens side-by-side
- Recommended screen size: up to 32"
- Max load: 2kg-9kg (4.5lbs – 20lbs) – per screen
- Fits screens with VESA mounting patterns: 75 x 75mm and 100 x 100mm
- Supplied with a desk clamp and a grommet clamp
- Easy tilt, swivel and height adjustment
- Simple installation with all mounting hardware included

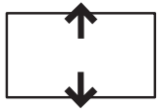
Recommended Max Screen	Max Load Per Screen	Max VESA	Tilt	Swivel	Rotation	Height Adjustment
						

Installation Safety Instructions

⚠ Caution: This mount is intended for use only with the maximum weights indicated. Use with equipment heavier than the maximum indicated may result in instability causing possible injury.

Do not attempt to install this product until all instructions and warnings have been read and properly understood. Please keep these instructions for future reference.

Please check carefully to make sure there are no missing or defective parts – defective parts must never be used. B-Tech AV Mounts, its distributors and dealers are not liable or responsible for damage or injury caused by improper installation, improper use or failure to observe these safety instructions. In such cases, all guarantees will expire.

General

B-Tech AV Mounts recommends that a professional AV installer or other suitably qualified person install this product.

Great care must always be taken during installation as most AV equipment is of a fragile nature, possibly heavy and easily damaged if dropped. If you do not fully understand the instructions or are not sure how to install this product safely, then please consult a professional for advice and/or to install this product for you. Failure to mount this product correctly may cause serious injury or death both during installation and at any time thereafter. Do not mount any AV equipment that exceeds the specific weight limit of the product you are installing. This weight limit will be clearly stated on each product and its packaging and will vary from product to product.

Product location

Please pay careful attention to where this product is located. Check load capacity of the structure prior to installation as some surfaces are not suitable for installation. Designed for indoor use, this mount is suitable for public or home installation. If located in a public or frequently populated area ensure that the product is out of the immediate reach of people. If any AV equipment is to be suspended over the likely path or location of people then great care should be taken to secure all parts of the installation from falling. When drilling holes it is essential to avoid contact with electrical cables and water or gas pipes contained within. Use of a good quality live wire detector and hidden object locator is therefore recommended. Only drill into structures when you are sure it is safe to do so.

Fixing hardware

It is highly recommended that all fixing screws be used where supplied and that the purpose of all other fixing hardware is fully understood. In some cases more AV equipment fixing hardware will be supplied to accommodate different models of equipment and set up configurations. The installer must be satisfied that any supplied fixing hardware is suitable for each specific installation. The fixing kit supplied with the product may not be suitable for all walls. If any fixing screws or included hardware are deemed not sufficient for a safe installation then please consult a professional or your local hardware store.

Hazard limitation

When routing cables take advantage of any built in cable management features that the product might provide and ensure that all cables are tidy and secure. Check to see that any moving aspect of the product can do so unhindered by any cabling. Some products have moving parts and the potential to cause injury through the crushing or trapping of fingers or other body parts. Particular attention to the nature of moving parts is required especially when assembling installing and adjusting during set up. Immediately after installation double-check that the work done is safe and secure. Double-check all necessary fixings are present and are of ample tightness. It is recommended that periodic inspections of the product and its fixing points are made as frequently as possible (no more than 6 months apart) to ensure that safety is maintained. If in doubt consult a professional AV installer or other suitably qualified person.

B-Tech AV Mounts recommends that this product be installed by a qualified AV technician or other suitably qualified person. B-Tech AV Mounts, its distributors and dealers are not liable or responsible for damage or injury caused by im-proper installation, improper use or failure to observe these safety instructions. In such cases, all guarantees will expire. This product must be mounted on a suitable surface and may only be used up to the specified maximum weight.

Parts List

Item	Description	Qty
1	Pole Stand	1
2	Arm Connector	1
3	Swivel Arm	2
4	Interface Arm	2
5	Clamp Connection Plate	1
6	Desk Clamp	1
7	Cable Clip	1
8	M6 x 10mm Screw	2
9	M6x9mm CSK Screw	3
10	Grommet Clamp Screw	1
11	Grommet Clamp	1
12	Foam Pads	1
13	4AF Hex Key	1
14	SAF Hex Key	1
Screen Fixings		
A	M4 x 70mm Screw	8
B	M5 x 70mm Screw	8
C	Washer	8

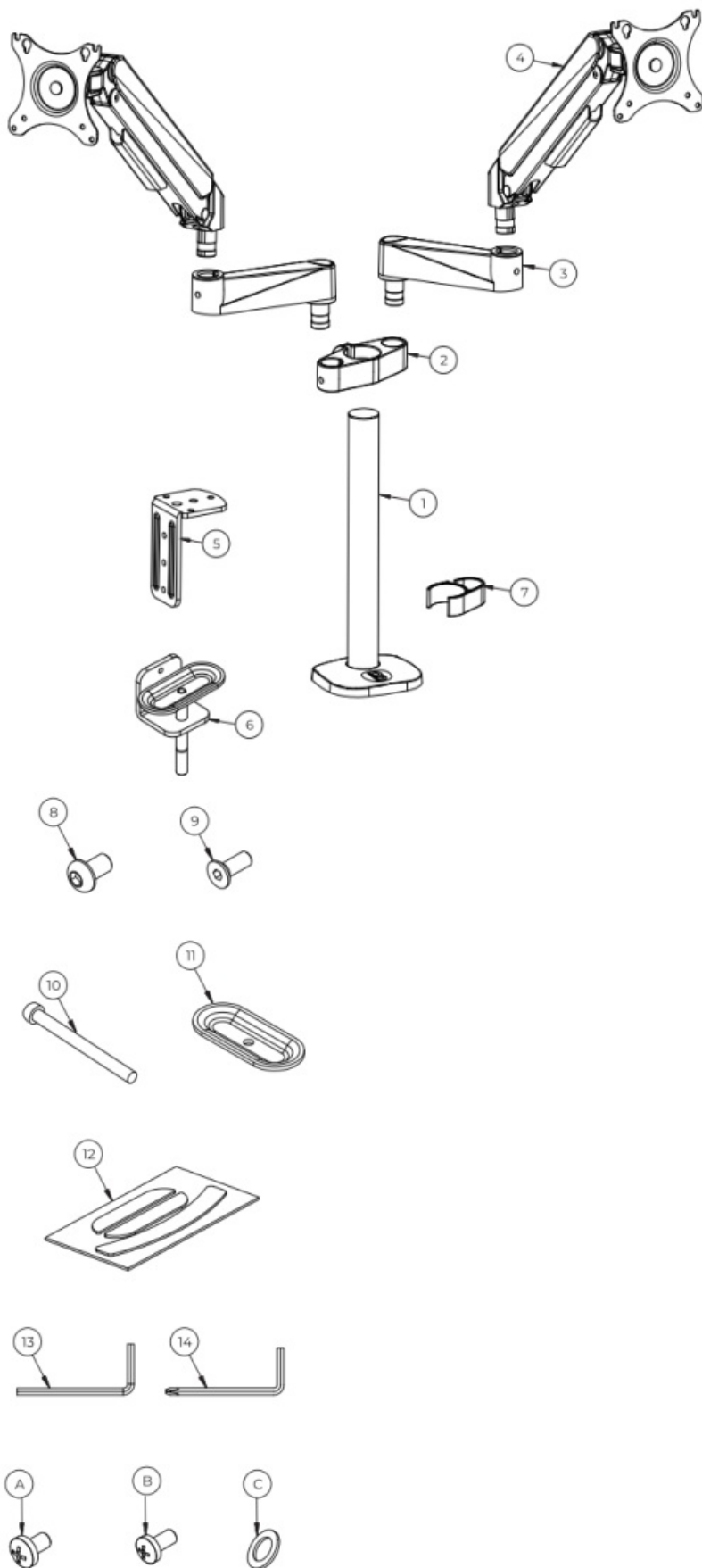

Suitable for loads up to 9kg (20lbs) per screen

Installation Instructions

1. Fix Mount To Desktop

A. Desk Clamp

- i. Connect item 5 to the bottom of item 7.
- ii. Stick item 72tothe underside of item 7.

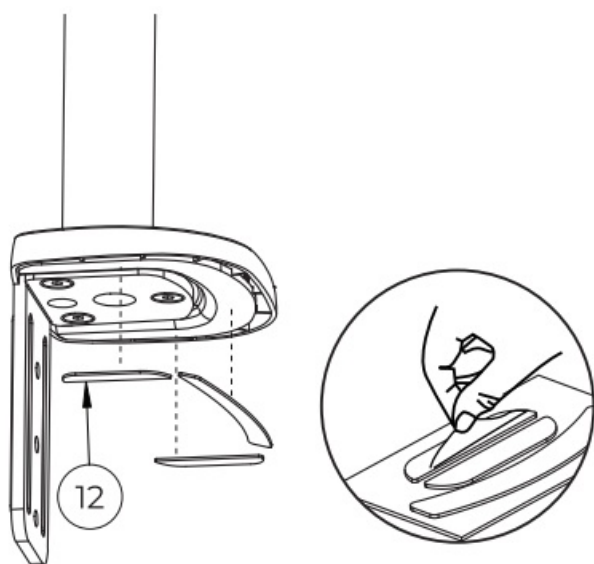
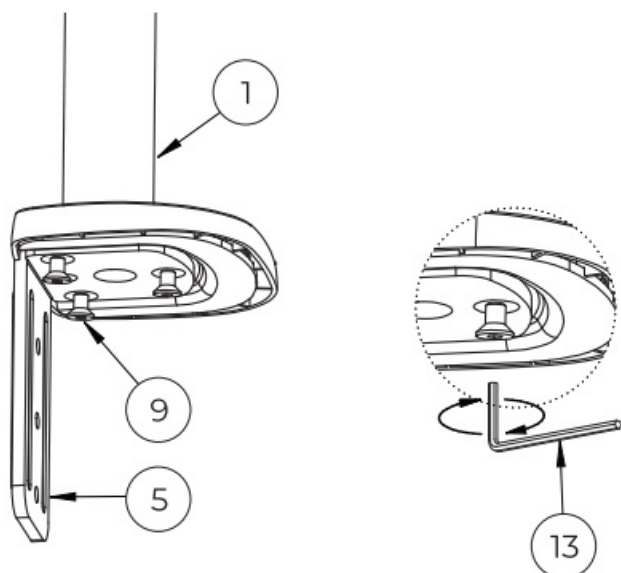

- iii. Attach item 6 to item 5 using item 8.

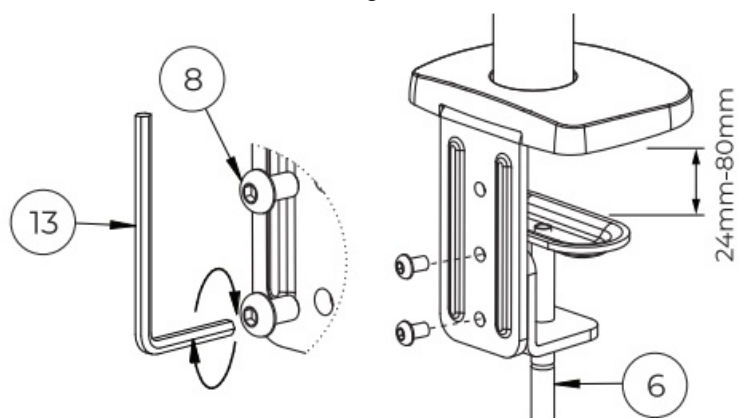

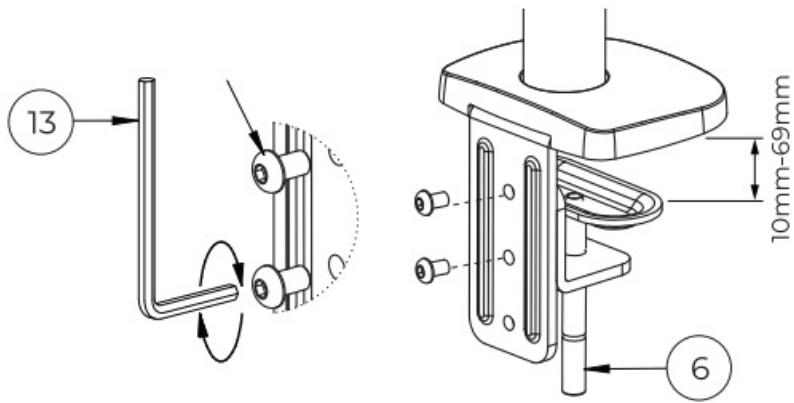

iv. Tighten the screw on item 6 clamping the stand to the desktop.

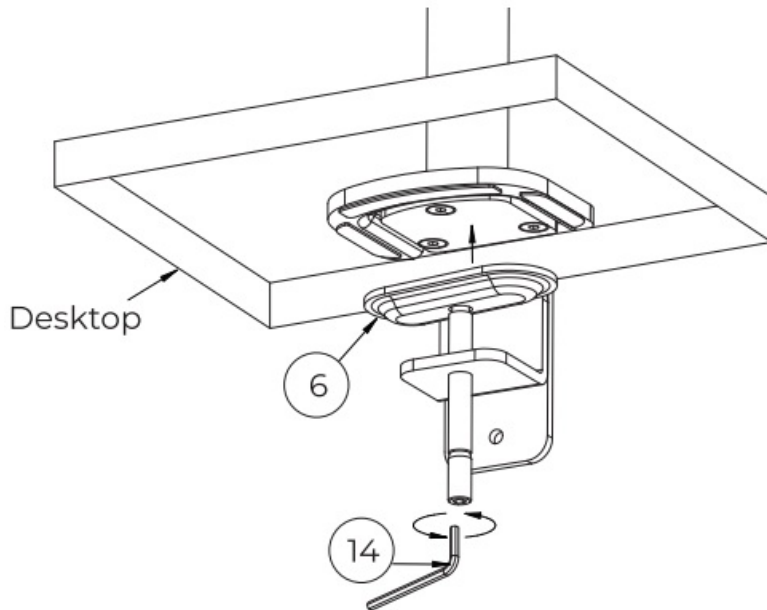

B. Grommet Clamp

i. Stick item 72 to the underside of item 7.

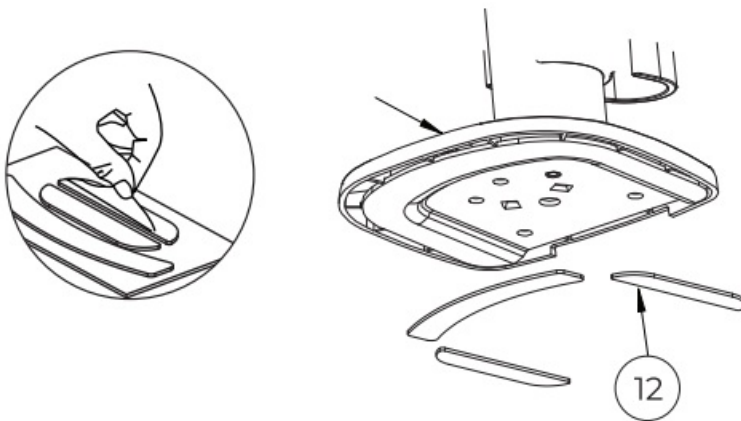

ii. Place item 7 over grommet hole on desktop.

iii. Fix item 77 under desktop using item 70 to connect to item 7.

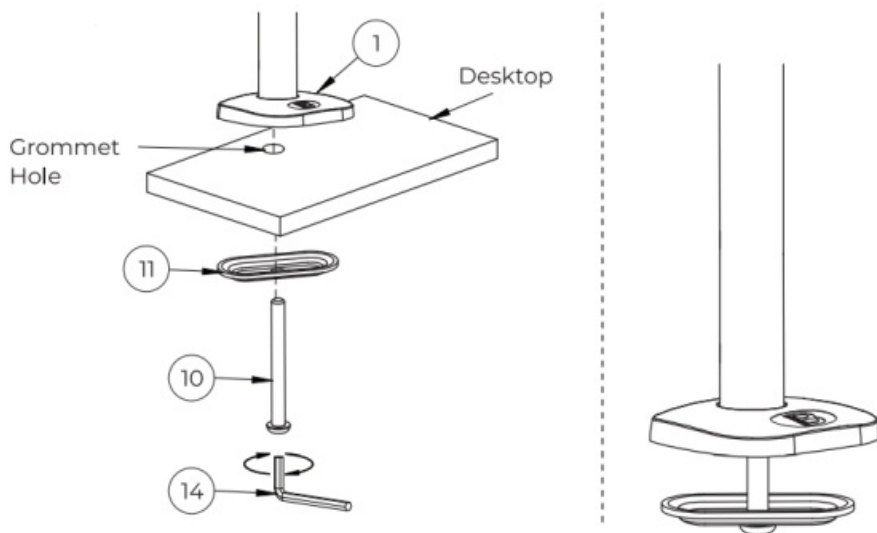

2. Assemble Arms Onto Pole

- i. Slide item 2 onto item 7 and secure in place.
- ii. Mount items 3 & 4 onto item 2 and tighten grub screws securing the arms to pole. Repeat for both sets of arms

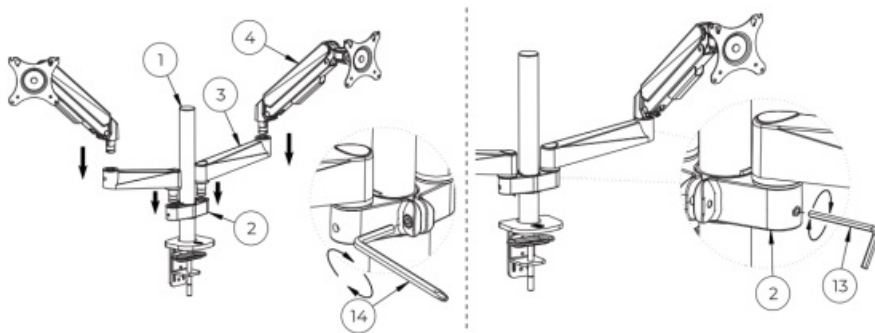

3. Mount Monitor To Interface Plate

- i. Insert halfway, 2 screws from the screen fixing kit (items A or BJ into the top fixing holes of the monitor.
- ii. Hook monitor onto item 4.

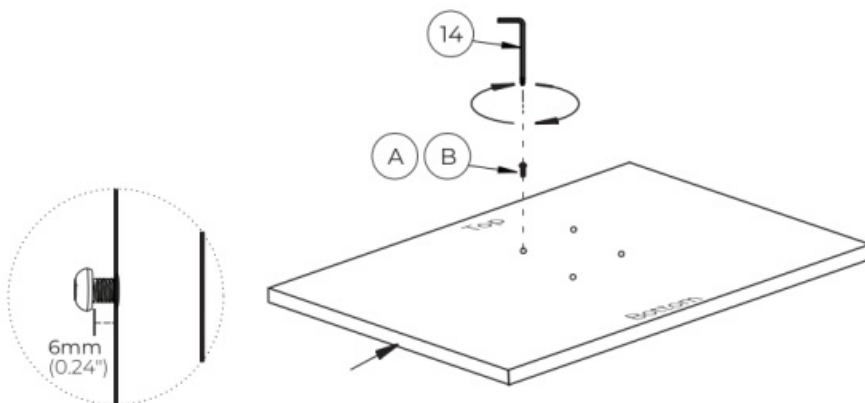

For screens with VESA 75 x 75mm fixings

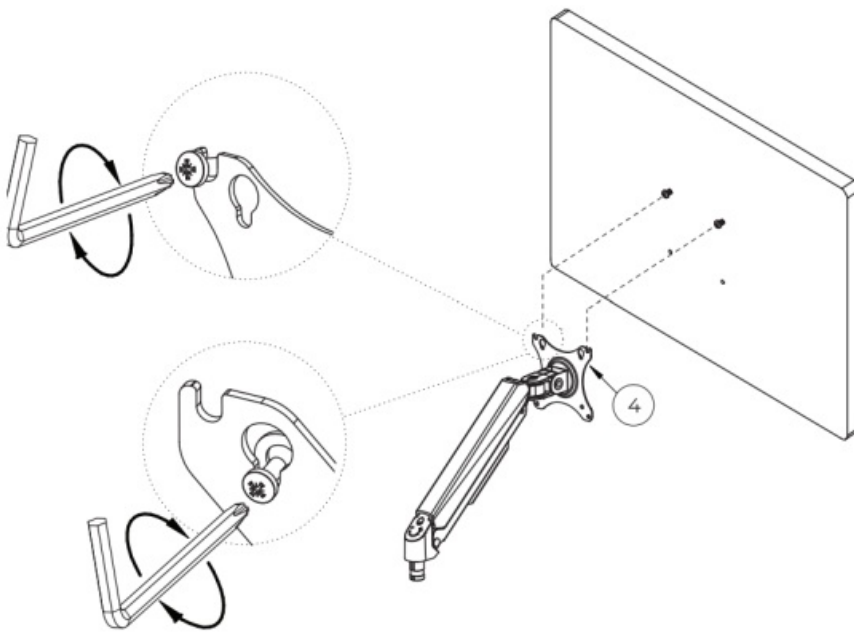

For screens with VESA

75 x 75mm fixings

iii. Add the bottom 2 screen fixing screws and tighten all screws.

Repeat for both screens

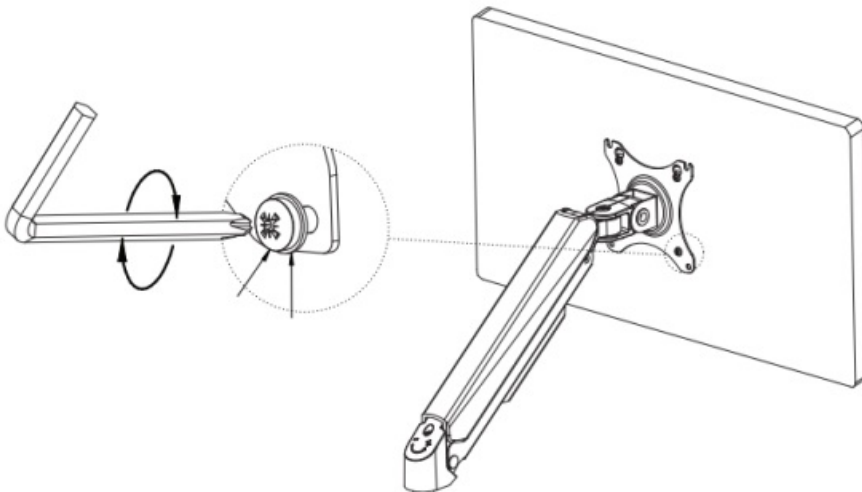

4. Optional Adjust Arm Tension

If the Monitor/ Arm drops down after the screen has been installed, hold the arm in a horizontal position and adjust the tension screw on the arm.

Turn the screw in a anti-clockwise(“+”) direction to increase the tension until the arm can hold the monitor in position.

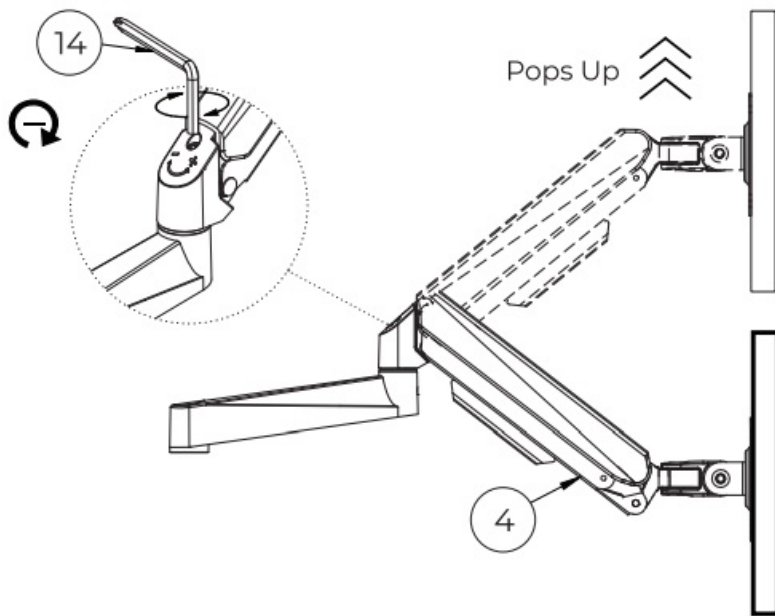

If the Monitor/ Arm pops up after the screen has been installed, hold the arm in a horizontal position and use the Hex Key to adjust the tension screw on the arm. Turn clockwise(“-”) direction to reduce tension until the arm can stay at the required position.

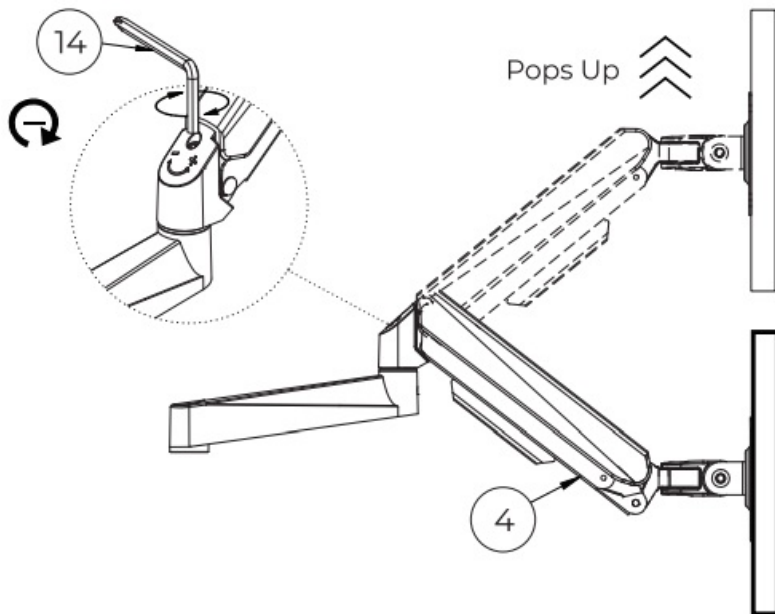

Set Tilt Tension

If the screen tilt is too tight or too loose, adjust the screw on the side of item 4.

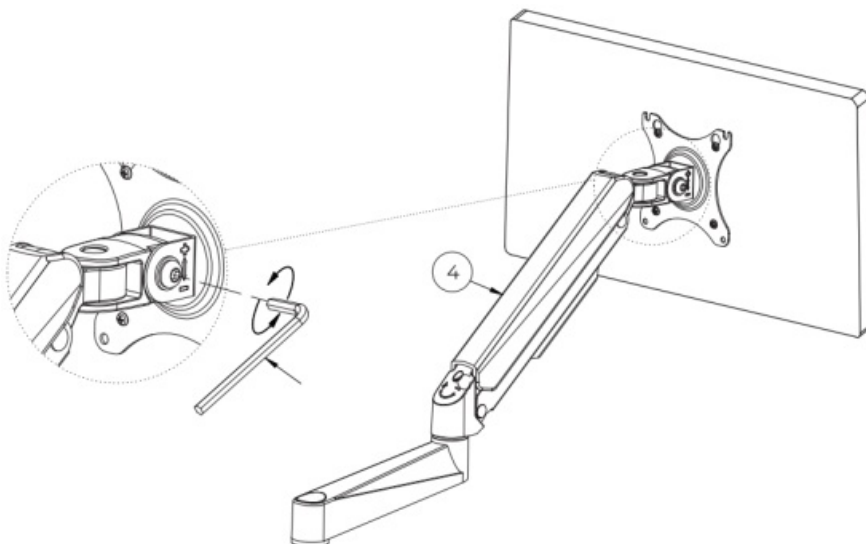

- (+) Turn clockwise to tighten
- (-) Turn counterclockwise to loosen

5. Cable Management

Use item 7 and the cable tray attached to item 4 to manage cables.

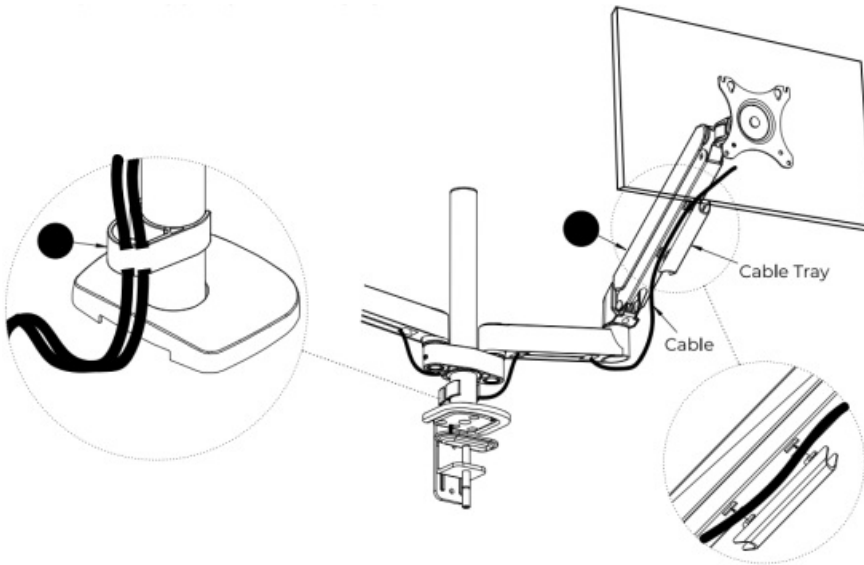

Note: Fully extend arms before connecting cables.

⚠ Caution: Ensure there is adequate cable slack for movement of the screen and that the cables will not be pinched when the mount is closed.

6. Screen Adjustments

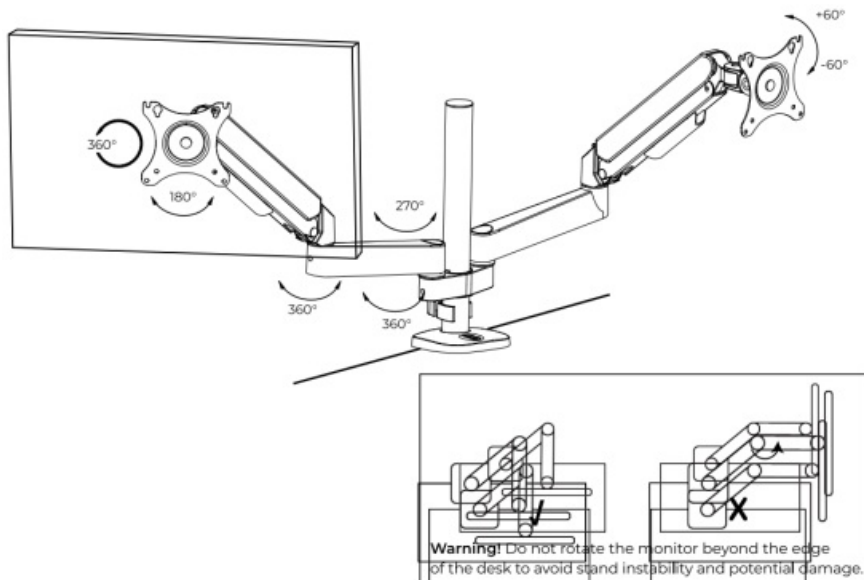

Dimensions

Top View

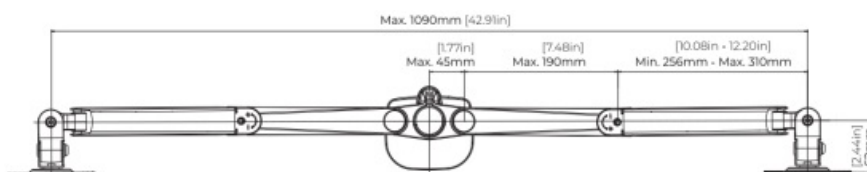

Side View

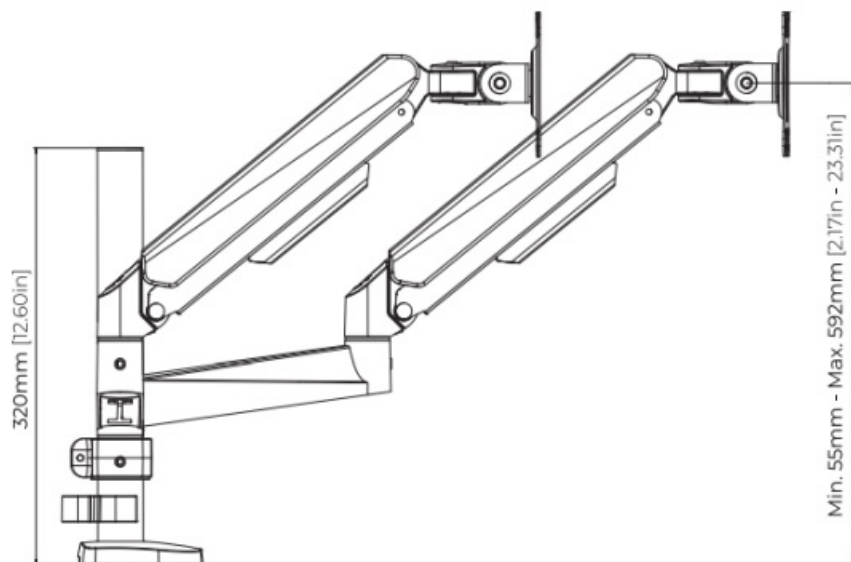

Desk Clamp

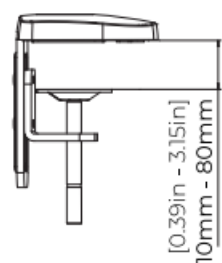

Grommet Clamp

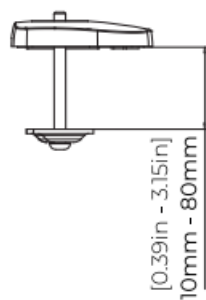

Front View

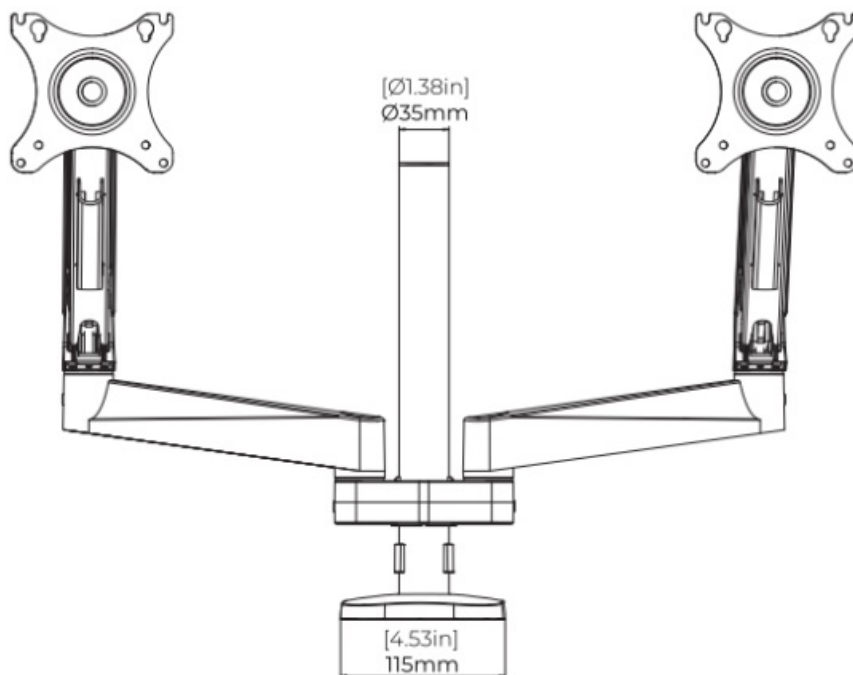

Interface Plate

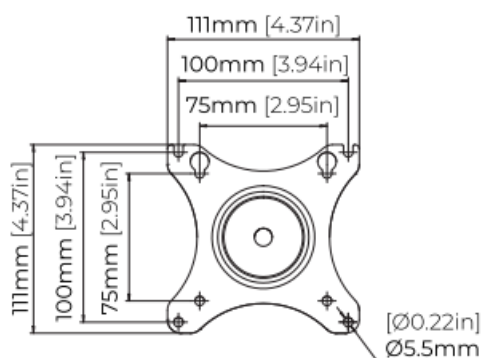

These instructions are intended as a guide only and B-Tech accepts no liability for the accuracy of the information contained in this document.

CUSTOMER SUPPORT



Contact: info@btechavmounts.com

©2024 B-Tech AV Mounts Corporation Ltd. All rights reserved.

B-Tech AV Mounts is a division of B-Tech AV Mounts Corporation Ltd.

B-Tech AV Mounts and the B-Tech logo are registered trademarks.

All B-Tech images and symbols are exclusive property of B-Tech AV Mounts Corporation Ltd.

All other brands and product names are trademarks of their respective owners.

Any reproduction, retransmission or republication of any part of this manual is strictly prohibited, unless prior written permission has been granted by B-Tech AV Mounts Corporation Ltd.

Photographs are for illustrative purposes only. E&OE

AMA-BT7352-V1.1-1224-138 Made in the P.R.C.



Documents / Resources

 A thumbnail image of the installation guide PDF. It shows the B Tech logo, the product name 'flex • duo', and a diagram of the twin-screen desk mount.	<p>B Tech BT7352-B Monitor Mount Stand [pdf] Installation Guide</p> <p>BT7352-B, BT7352-B Monitor Mount Stand, BT7352-B, Monitor Mount Stand, Mount Stand, St and</p>
--	---

References

- [User Manual](#)

[Manuals+](#), [Privacy Policy](#)

This website is an independent publication and is neither affiliated with nor endorsed by any of the trademark owners. The "Bluetooth®" word mark and logos are registered trademarks owned by Bluetooth SIG, Inc. The "Wi-Fi®" word mark and logos are registered trademarks owned by the Wi-Fi Alliance. Any use of these marks on this website does not imply any affiliation with or endorsement.