

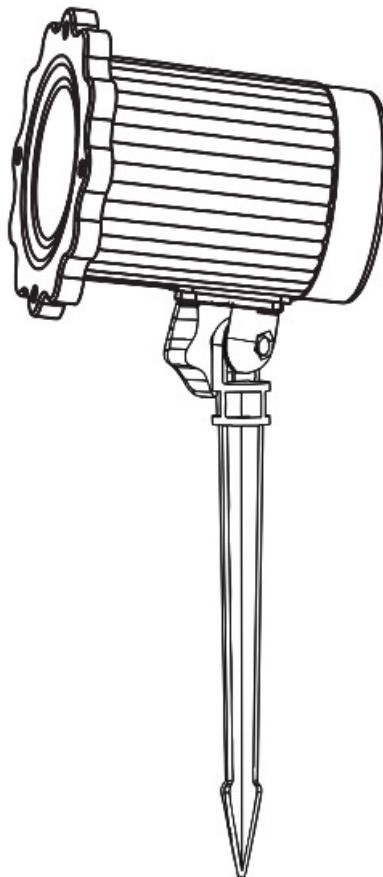

B-right KWD10 Snowflake Projection Light User Guide

[Home](#) » [B-right](#) » B-right KWD10 Snowflake Projection Light User Guide 

Snowflake Projection Light User Guide



Contents

- [1 Snowflake Projection Light User Guide](#)
- [2 Parameter](#)
- [3 Remote control description](#)
- [4 Components and Structure](#)
- [5 Installation/Dimension](#)
- [6 After-sale service](#)
- [7 Documents / Resources](#)
- [8 Related Posts](#)

Snowflake Projection Light User Guide

THANK YOU for purchasing our products. For offering you a better experience, please read the instruction carefully before using them. Any problems occur during use, please feel free to contact us, we will help you out within 24 hours.



Warnings:

1. Please carefully check the completeness of the product to ensure that all product accessories have received good results before installation.
2. Please be careful with the barbed light nail holder during installation to avoid any accidental injury.
3. Pls, tighten the cap of the product connection line to avoid damage to the product caused by water.
4. The waterproof grade of this product is IP65, it can be used when it rains but cannot be directly immersed in water. And the Power Supply is waterproof IP44 so pls add a waterproof insulation box to cover it.
5. Please do not disassemble the product to avoid damage product.
6. Please do not modify the product during the warranty period.
7. If there is any problem with our product, please do not repair it without authorization, you can contact our customer service or professional staff to get help.
8. The working temperature will form a temperature difference at night/winter, causing water droplets on the lens which is a normal phenomenon. The water droplets will disappear after the temperature is constant, pls don't worry.

Parameter

SKU	Snowflake Projection Light
Input Voltage	100-240V
Working Voltage	DC 14V
Light Source	LED
LED Amount	4 LEDs
Lights Power	4.2W
LED Power	4*3W
Color	White
Waterproof	IP65
Temperature	-25°C~40°C

Remote control description

Note: The LED Snowflake Projection light with 6 hours automatic shutdown function, means working 6 hours and shut down for 18 hours automatically. You also can use the remote control to set the "TIMER", you can choose 2 hours, 4 hours, 6 hours.

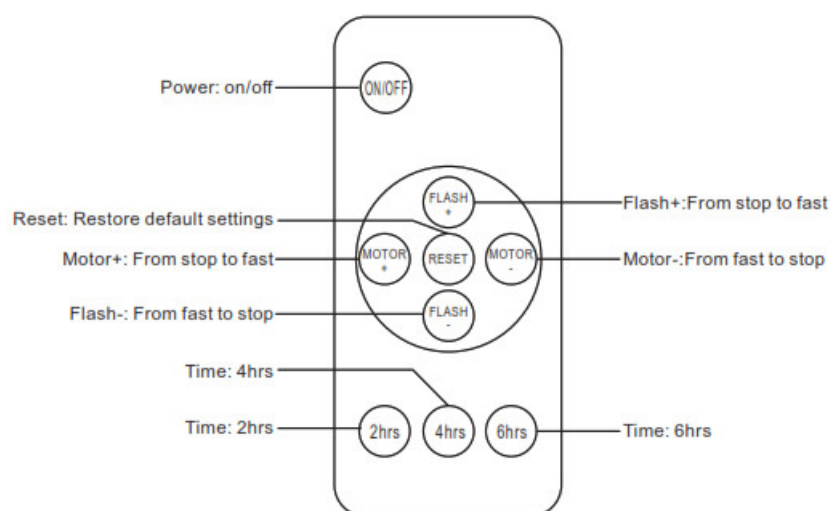

Components and Structure

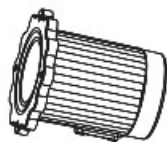

Snowflake Light*1



Remote control*1



Ground Stake*1

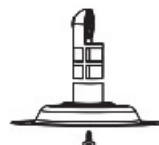

Mounting Plate*1



Power Supply*1

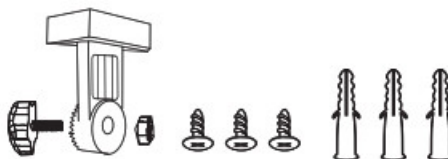

Installation package*1
(Support frame*1、Knobs*1、Screw*3、Screw Anchor*3)

Installation/Dimension



17cm/6.7in

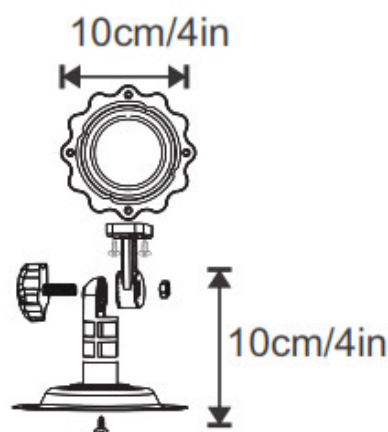

10cm/4in

10cm/4in

Note: There may be a ± 1 mm discrepancy in the length of the Snowfall Light.

After-sale service

Thank you again for purchasing our product. If you have any questions about our product, please feel free to contact our customer service team.

We will reply to you within 24 hours, and promise to offer a 100% satisfied solution. Finally, we wish you a happy life!

Documents / Resources

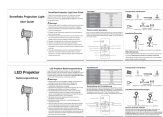

[B-right KWD10 Snowflake Projection Light](#) [pdf] User Guide

KWD10, Snowflake Projection Light, KWD10 Snowflake Projection Light, Projection Light