

AXXESS
AXTC-PO1 Porsche
Steering Wheel
Control and Data
Interface



AXXESS AXTC-PO1 Porsche Steering Wheel Control and Data Interface Installation Guide

[Home](#) » [AXXESS](#) » AXXESS AXTC-PO1 Porsche Steering Wheel Control and Data Interface Installation Guide 

Contents

- [1 AXTC-PO1 Porsche Steering Wheel Control and Data Interface Specifications](#)
- [2 Usage Instructions](#)
- [3 TOOLS REQUIRED](#)
- [4 TROUBLESHOOTING](#)
- [5 FAQs](#)
- [6 Documents / Resources](#)
 - [6.1 References](#)



AXTC-PO1 Porsche Steering Wheel Control and Data Interface



Specifications

- Compatible with: Porsche 911 (2011-2016), Cayenne (2011-2016), Macan (958) (2015-2016), Panamera (2010-2016)
- Interface Features: Steering Wheel Control (SWC) and Data Interface
- Connector: LD-SWCX-PO1

ATTENTION

Before installing the product, disconnect the negative battery terminal with the key out of the ignition. Ensure all connections are properly plugged in before reconnecting the battery.

NOTE

Refer to the aftermarket accessory instructions before installing this device.

Connections LD-SWCX-PO1 HARNESS

Vehicle Connector Interface Reset Button 20-Pin LD-SWCX-PO1 LED Light 3.5mm Adapter (for vehicles with Steering wheel controls or aftermarket radios with a wire for SWC)

Usage Instructions

Connections for Vehicles with Steering Wheel Controls

1. Tie the Brown and Brown/White wires together from the 3.5mm adapter.
2. Connect the 3.5mm adapter to the AXTC-PO1 Harness.
3. Program the AXTC-PO1 following the instructions on page 3 (Disregard steps 4 & 5).

TOOLS REQUIRED

- Crimping tool and connectors, or solder gun, solder, and heat shrink
- Tape
- Wire cutter
- Zip-ties
- Visit AxxessInterfaces.com for more detailed information about the product and up-to-date vehicle specific applications.

Radio Connections

- Black – Ground wire
- Yellow – Battery wire
- Red – Accessory power

Programming



Open the driver's door and keep it open during programming.



Cycle the ignition on.



Connect the AXTC-PO1 harness to the interface and then to the vehicle's wiring harness.

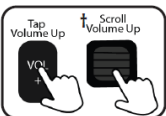

Locate the Volume Up button on the steering wheel.* Program the interface by tapping/scrolling the Volume Up button at a heartbeat pace/or scrolling up continuously until the LED light stops flashing.

- Only applicable if vehicle came with steering wheel controls † Vehicles with scroll wheel button

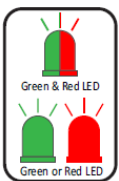

The LED light will flash Green & Red while the interface programs the radio to the steering wheel controls. Once programmed, the LED light will go out, then produce a pattern which will identify the radio type installed. Refer to the Radio LED Feedback section under Troubleshooting for radio types.

- Only applicable if vehicle came with steering wheel controls

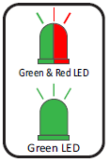

The LED light will go out, then once again quickly flash Green & Red while the interface programs itself to the vehicle. Once programmed, the LED light will go out again, then turn solid Green.

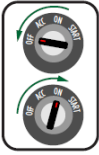

Cycle the ignition off, then back on.



Test all functions of the installation for proper operation.

Note

Audio Mode must be selected in the MFI menu to allow track up and down to function. Refer to the vehicle owner's manual for more information.

INTERFACE FEATURES

- Designed for non-amplified models only
- Provides accessory power (12-volt 10-amp)
- Provides wires for multimedia radios (park brake, reverse, speed sense)
- Retains audio controls on the steering wheel
- Designed to be compatible with all major radio brands
- Auto detects vehicle type, radio connection, and preset controls
- Ability to dual assign steering wheel control buttons
- Retains memory settings even after battery disconnection or interface removal (non volatile memory)
- Provides illumination output
- Retains the factory backup camera
- Micro-B USB updatable

APPLICATIONS

Porsche

911.....2011-2016
Cayenne.....2011-2016
Macan (958)..... 2015-2016
Panamera2010-2016



Product Info

ATTENTION

With the key out of the ignition, disconnect the negative battery terminal before installing this product. Ensure that all installation connections, especially the air bag indicator lights, are plugged in before reconnecting the battery or cycling the ignition to test this product.

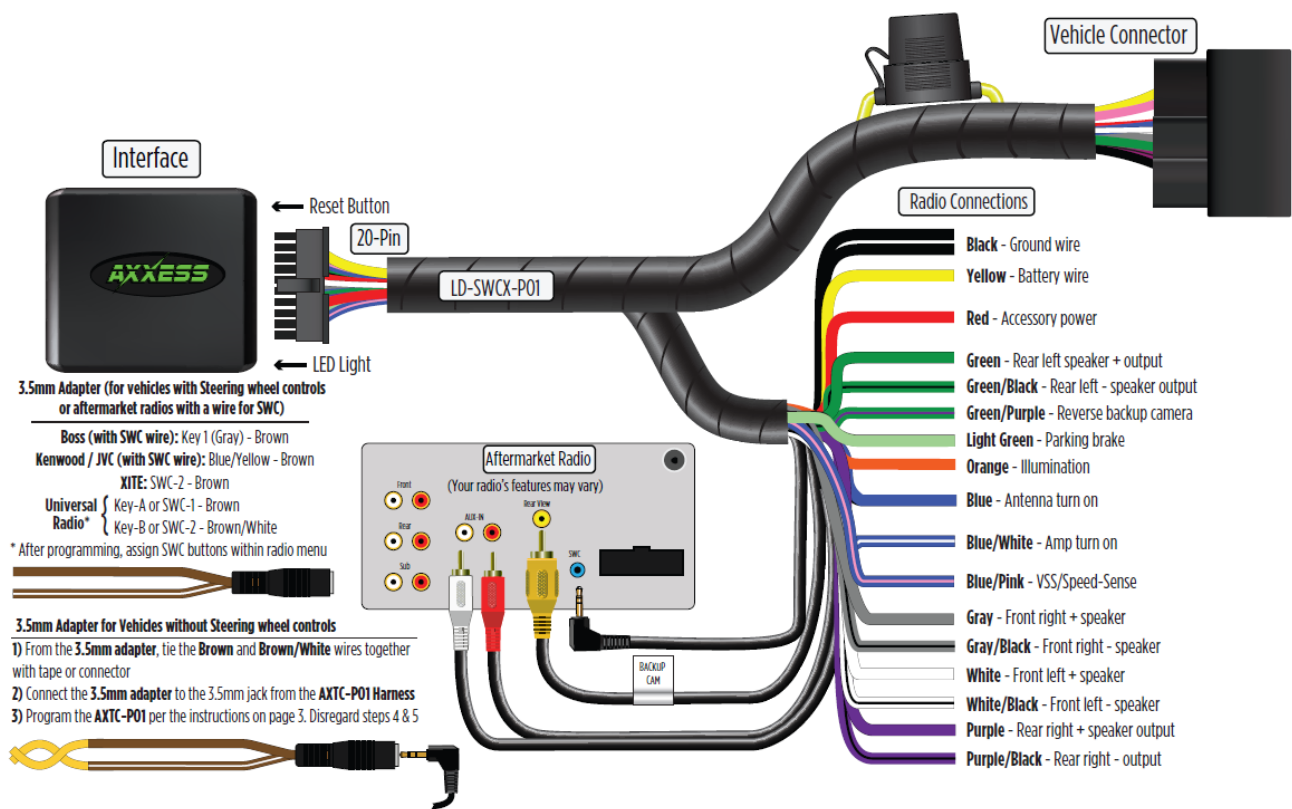

TROUBLESHOOTING

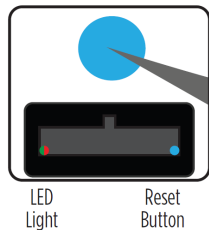

If the interface fails to function, press and release the reset button, then repeat the programming process from step 4 to try again.

At the end of programming the LED light will turn Solid Green which indicates programming was successful. If the LED light didn't turn Solid Green, reference the list below to understand which programming section the problem may stem from.

LED Light	Radio Programming Section	Vehicle Programming Section
Solid Green	Pass	Pass
Slow Red Flash	Fail	Pass
Slow Green Flash	Pass	Fail
Solid Red	Fail	Fail

Note

If the LED light shows Solid Green for Pass (indicating everything programmed correctly), yet the steering wheel controls don't work, check to ensure that the 3.5mm jack is plugged in, and also plugged into the correct jack on the radio. Once corrected, press the reset button, then program again.

Having difficulties? We're here to help.

Contact our Tech Support line at:



[386-257-1187](tel:386-257-1187)

Or via email at:



techsupport@metra-autosound.com

FAQs

Q: What should I do if the LED light does not respond as described during programming?

If the LED light does not respond as expected, ensure all connections are secure and follow the programming steps again.

Q: Can this interface be used with other car models not listed in the manual?

This interface is specifically designed for Porsche models listed in the manual. It is recommended to use it only with compatible vehicles.

Documents / Resources

	<p>AXXESS AXTC-PO1 Porsche Steering Wheel Control and Data Interface [pdf] Installation Guide</p> <p>AXTC-PO1, AXTC-PO1 Porsche Steering Wheel Control and Data Interface, Porsche Steering Wheel Control and Data Interface, Steering Wheel Control and Data Interface, Wheel Control and Data Interface, Data Interface</p>
---	---

References

- [AXXESS Integrate - Comprehensive Interface Products for Vehicle Upgrades](#)
- [User Manual](#)

[Manuals+](#), [Privacy Policy](#)

This website is an independent publication and is neither affiliated with nor endorsed by any of the trademark owners. The "Bluetooth®" word mark and logos are registered trademarks owned by Bluetooth SIG, Inc. The "Wi-Fi®" word mark and logos are registered trademarks owned by the Wi-Fi Alliance. Any use of these marks on this website does not imply any affiliation with or endorsement.