



AXIS TQ1602-E Conduit Back Box Installation Guide

[Home](#) » [AXIS](#) » [AXIS TQ1602-E Conduit Back Box Installation Guide](#) 



AXIS TQ1602-E Conduit Back Box

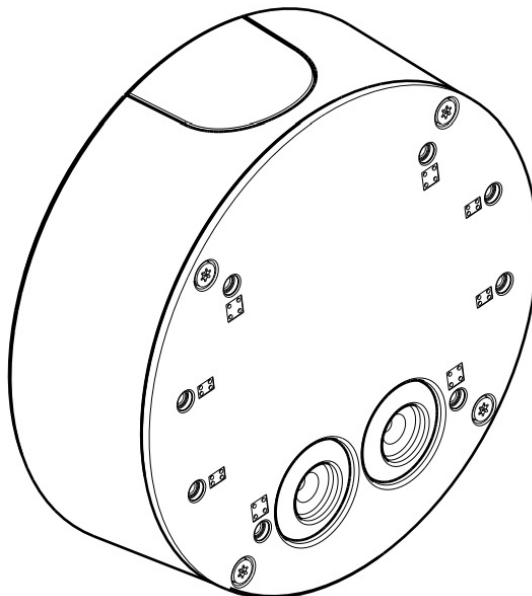

Installation Guide

Contents

- [1 TQ1602-E Conduit Back Box](#)
- [2 Intellectual property rights](#)
- [3 Equipment modifications](#)
- [4 Warranty information](#)
- [5 Safety instructions](#)
- [6 Documents / Resources](#)
 - [6.1 References](#)
- [7 Related Posts](#)

TQ1602-E Conduit Back Box

Read this first

Read through this Installation Guide carefully before installing the product. Keep the Installation Guide for future reference.

Legal considerations

Video and audio surveillance can be regulated by laws that vary from country to country. Check the laws in your local region before using this product for surveillance purposes.

Liability

Every care has been taken in the preparation of this document. Please inform your local Axis office of any inaccuracies or omissions. Axis Communications AB cannot be held responsible for any technical or typographical errors and reserves the right to make changes to the product and manuals without prior notice. Axis Communications AB makes no warranty of any kind with regard to the material contained within this document, including, but not limited to, the implied warranties of merchantability and fitness for a particular purpose. Axis Communications AB shall not be liable nor responsible for incidental or consequential damages in connection with the furnishing, performance or use of this material. This product is only to be used for its intended purpose.

Intellectual property rights

Axis AB has intellectual property rights relating to technology embodied in the product described in this document. In particular, and without limitation, these intellectual property rights may include one or more of the patents listed at axis.com/patent and one or more additional patents or pending patent applications in the US and other countries.

Equipment modifications

This equipment must be installed and used in strict accordance with the instructions given in the user documentation. This equipment contains no user-serviceable components. Unauthorized equipment changes or modifications will invalidate all applicable regulatory certifications and approvals.

Trademark acknowledgments

AXIS COMMUNICATIONS, AXIS, ARTPEC, and VAPIX are registered trademarks of Axis AB in various jurisdictions. All other trademarks are the property of their respective owners.

Contact information

Axis Communications AB
Gränden 1
223 69 Lund Sweden
Tel: +46 46 272 18 00
Fax: +46 46 13 61 30
axis.com

Warranty information

For information about Axis' product warranty and thereto related information, go to axis.com/warranty.

Support

Should you require any technical assistance, please contact your Axis reseller. If your questions cannot be answered immediately, your reseller will forward your queries through the appropriate channels to ensure a rapid response. If you are connected to the Internet, you can:

- find answers to resolved problems in the FAQ database, search by product, category, or phrase
- report problems to Axis support staff by logging in to your private support area
- chat with Axis support staff
- visit Axis Support at axis.com/support

Learn more!

Visit Axis learning center axis.com/learning for useful training, webinars, tutorials and guides.

--	--

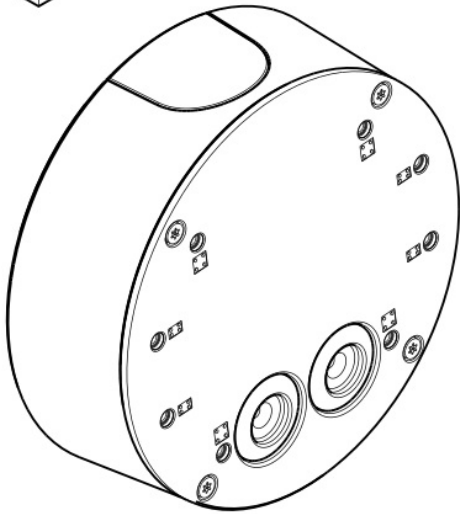
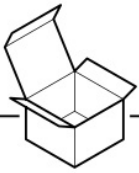

1x



4x



4x

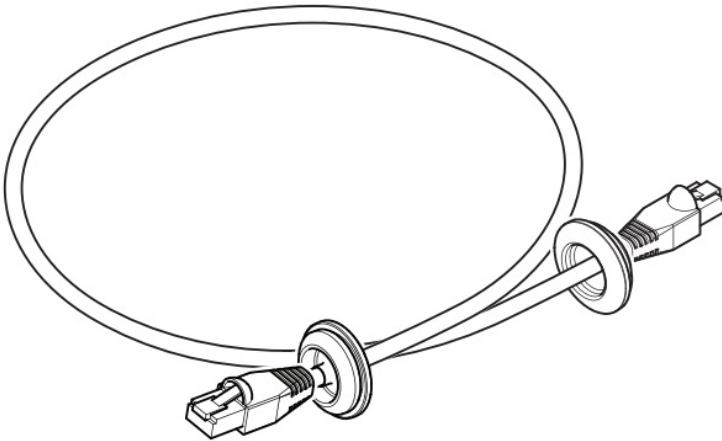

1x



3x



1x

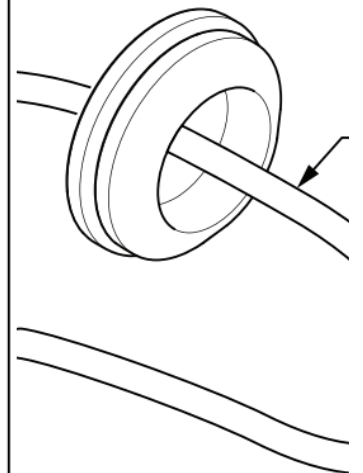
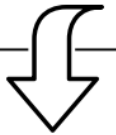
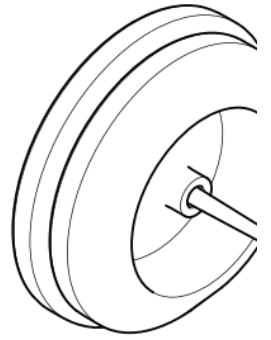

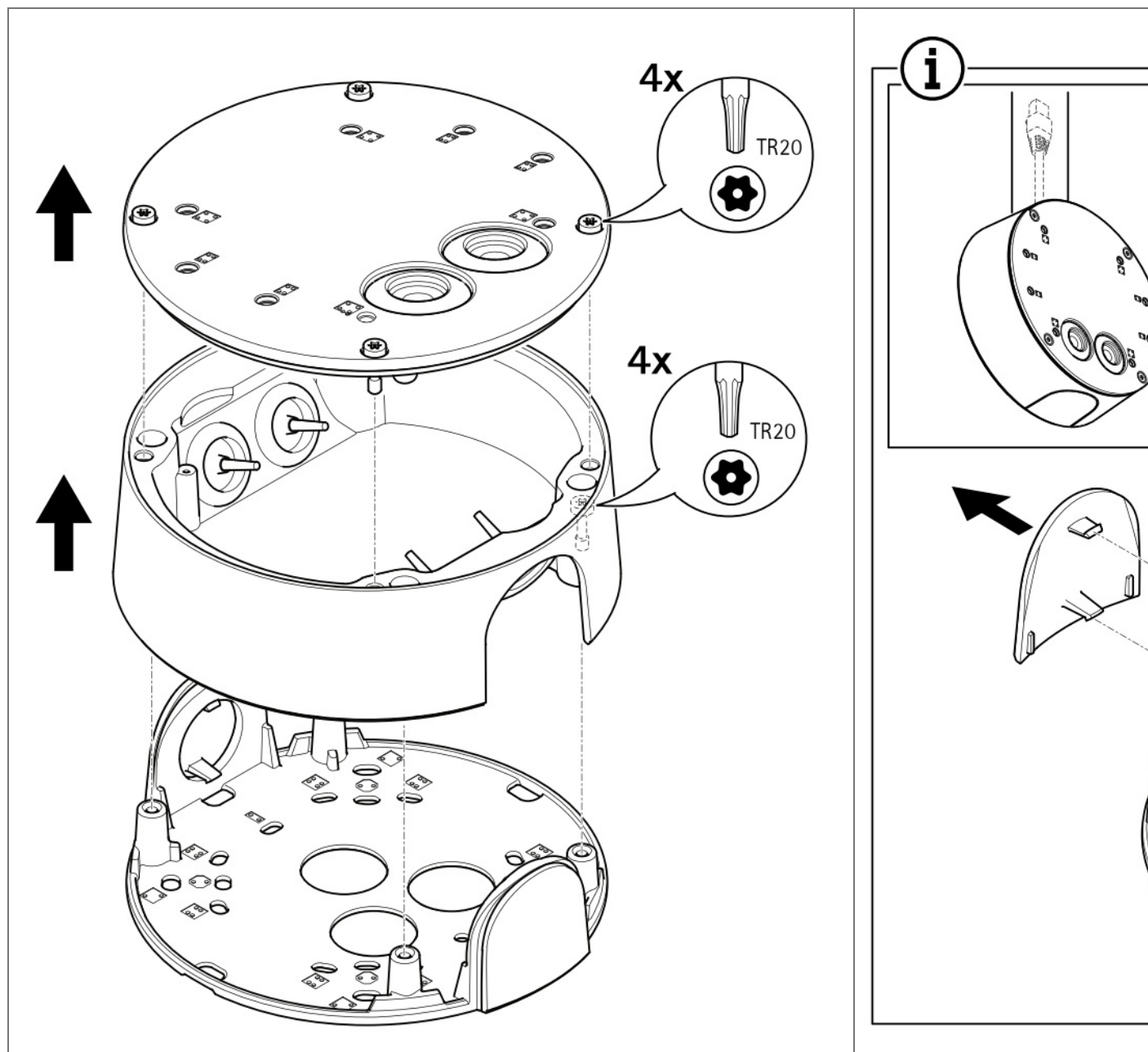

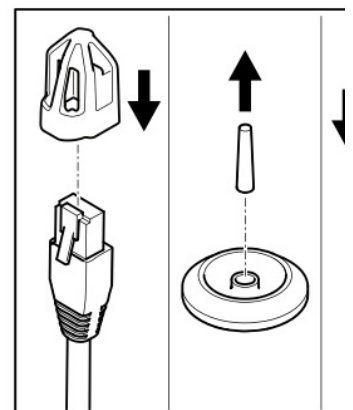
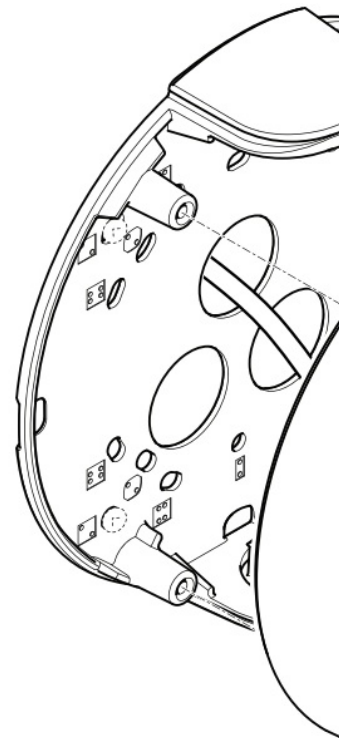
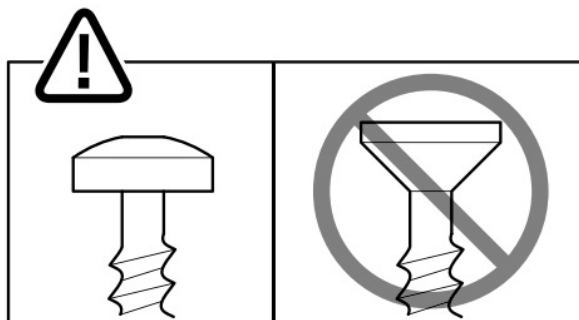
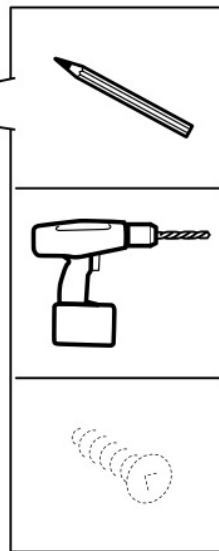
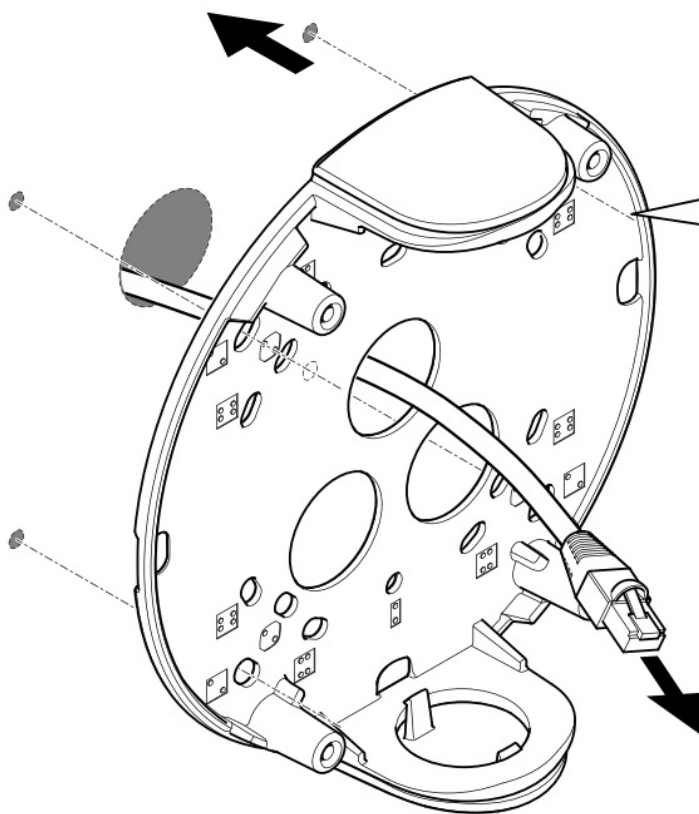



AXIS Q17

AXIS Q19

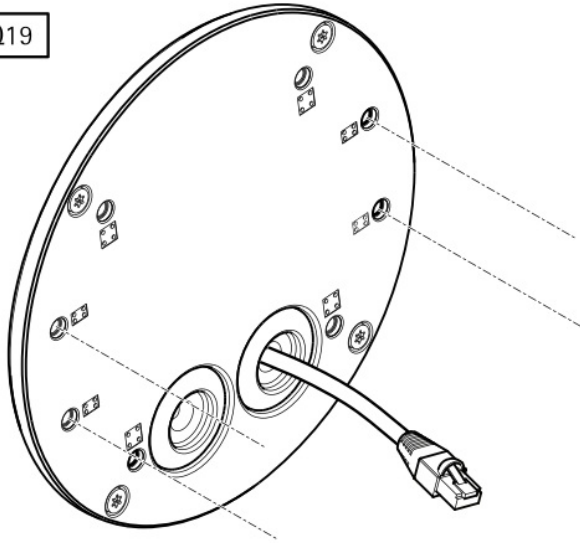

AXIS P14

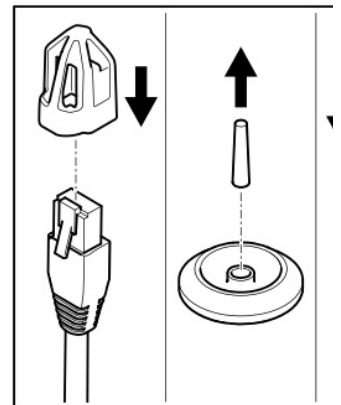
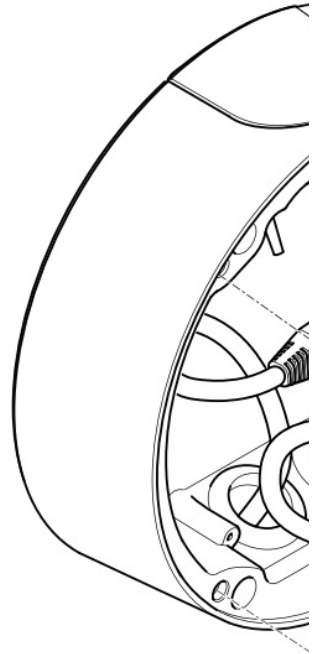
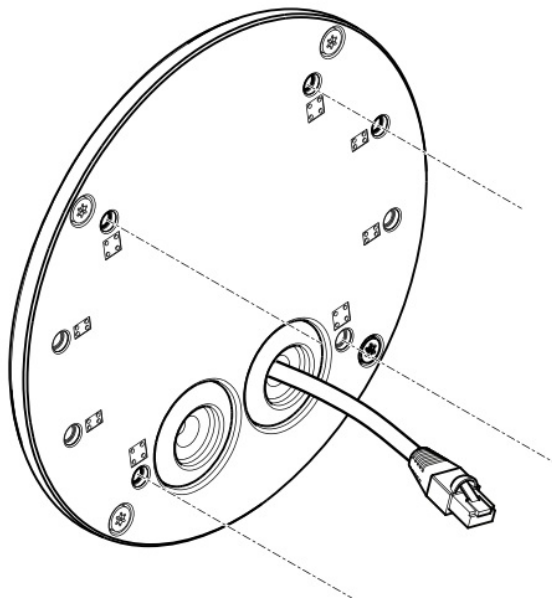

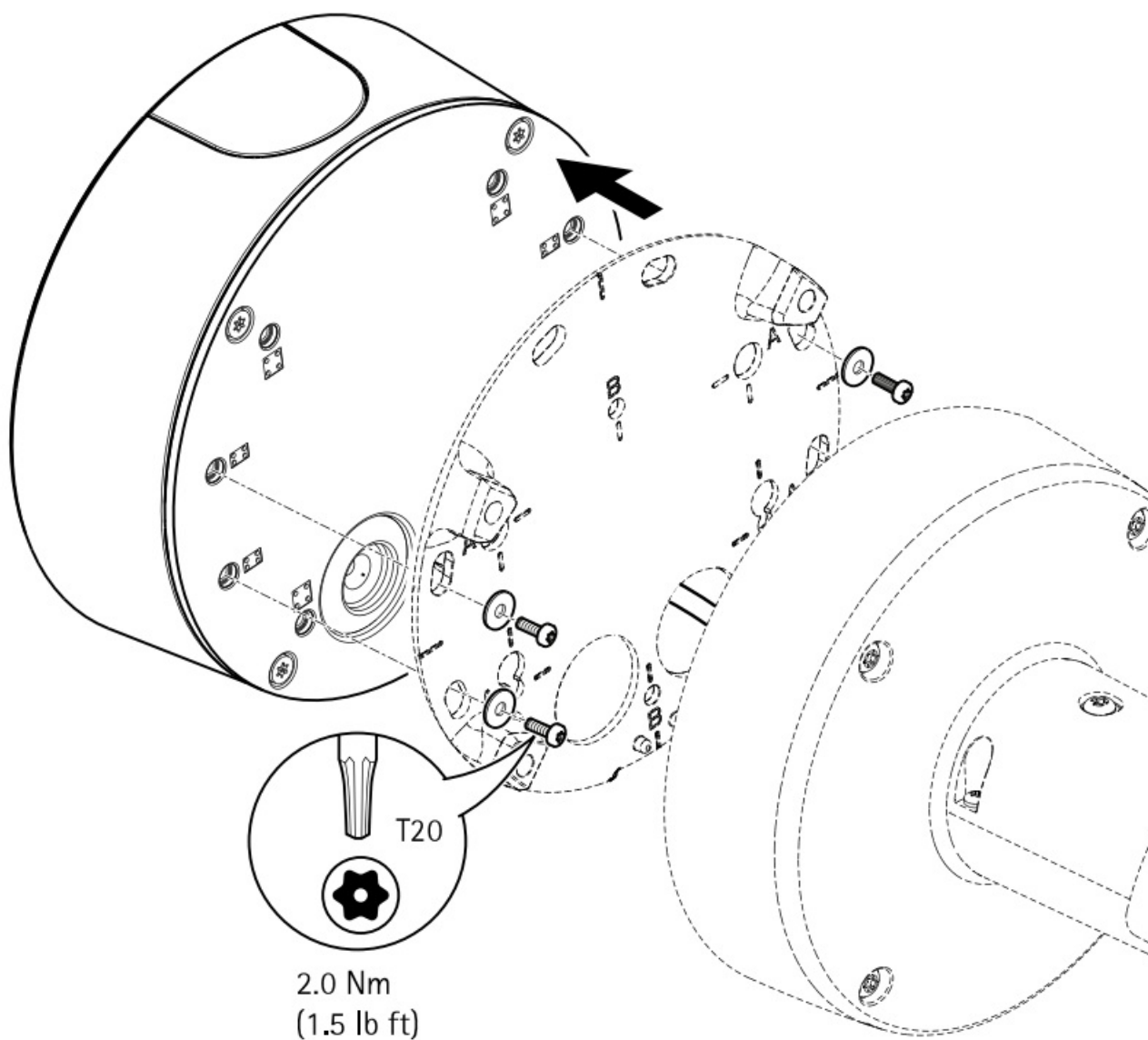

Safety instructions

NOTICE

- The Axis product shall be used in compliance with local laws and regulations.
- Store the Axis product in a dry and ventilated environment.

- Use only applicable tools when installing the Axis product. Using excessive force with power tools could cause damage to the product.
- Do not use chemicals, caustic agents, or aerosol cleaners.
- Use a clean cloth dampened with pure water for cleaning.
- Use only accessories that comply with the technical specification of your product. These can be provided by Axis or a third party. Axis recommends using Axis power source equipment compatible with your product.
- Use only spare parts provided by or recommended by Axis.
- Do not attempt to repair the product yourself. Contact Axis support or your Axis reseller for service matters.

Transportation

NOTICE

- When transporting the Axis product, use the original packaging or equivalent to prevent damage to the product.

Installation Guide
 AXIS TQ1602-E Conduit Back Box
 © 2021 Axis Communications AB
 Ver. M2.3
 Date: September 2021
 Part No. 2404145

Documents / Resources

	<p>AXIS TQ1602-E Conduit Back Box [pdf] Installation Guide TQ1602-E, Conduit Back Box, TQ1602-E Conduit Back Box, Back Box, Box</p>
-------------------------------------------------------------------------------------	------------------------------------------------------------------------------------------------------------------------------------------------------------------

References

- [Axis Communications - Leader in network cameras and other IP networking solutions | Axis Communications](#)
- [Sharing knowledge | Axis Communications](#)
- [Patent Statement | Axis Communications](#)
- [Welcome to Axis support | Axis Communications](#)
- [RMA | Axis Communications](#)