



# AXIS PTZ Network Camera User Manual

[Home](#) » [AXIS](#) » **AXIS PTZ Network Camera User Manual**

**AXIS PTZ Network Camera**



## AXIS M5525-E PTZ Network Camera

### Contents

- [1 Product overview](#)
- [2 Setup](#)
- [3 Troubleshooting](#)
- [4 Specifications](#)
- [5 Documents / Resources](#)
  - [5.1 References](#)
- [6 Related Posts](#)

### Product overview

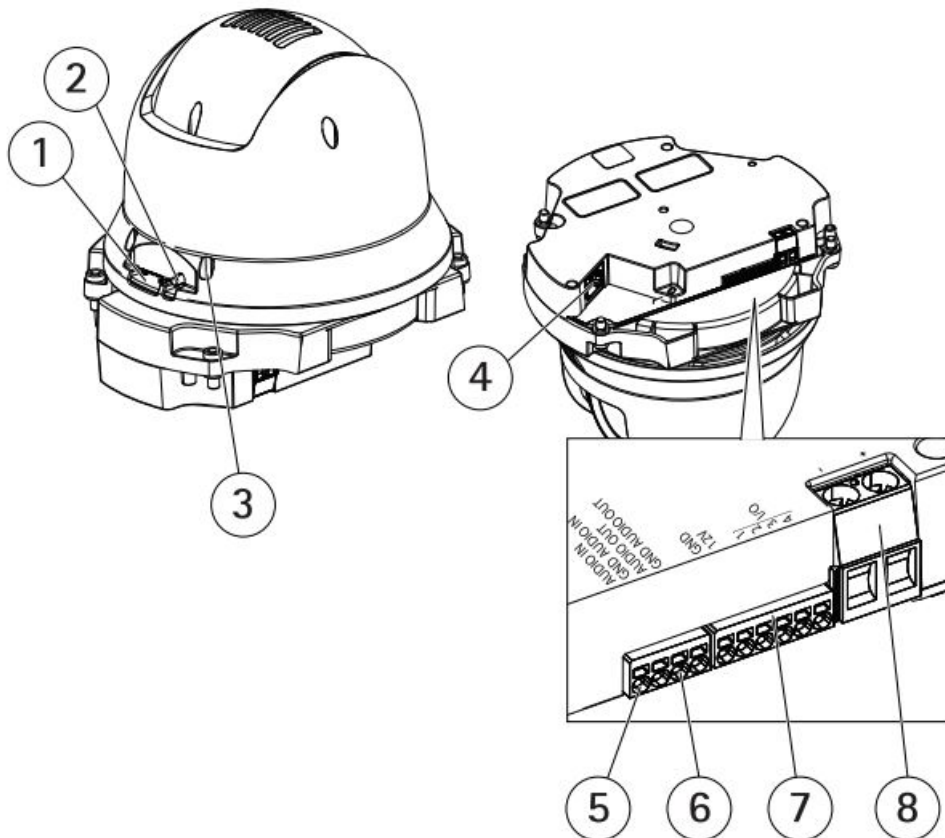

1. SD card slot (microSD)
2. Control button
3. Status LED
4. RJ45 connector
5. Audio in
6. Audio out
7. I/O connector
8. Power connector

### How to connect a microphone to the camera

This example explains how to connect a microphone to the camera using an audio extension cable.  
Required hardware

- AXIS T8351 Microphone 3.5 mm
- AXIS Audio Extension Cable A, 5 m (16 ft)

#### Note

- To avoid noise, don't run the cable close to or in parallel with other cables.
- To avoid noise, cut the cable as short as possible.
- To maintain an IP66 rating, make sure you keep the jack inside the housing.

### Connect the cables

1. Keep the 3.5 mm jack and cut the audio extension cable.
2. Strip the outer cable insulation.

3. Strip the inner wire insulation.
4. Twist the audio wires (with insulation) together.
5. Twist the grounding wires (without insulation) together.
6. Connect the audio wires to the AUDIO IN pin on the camera. See Product overview on page 3.
7. Connect the grounding wires to the GND AUDIO IN pin on the camera.
8. Connect the microphone to the jack of the audio extension cable.
9. Turn on audio and adjust other audio settings in the camera's webpage.

### How to access the product

AXIS IP Utility and AXIS Camera Management are recommended methods for finding Axis products on the network and assigning them IP addresses in Windows®. Both applications are free and can be downloaded from [axis.com/support](https://axis.com/support) The product can be used with the following browsers:

- Chrome™ (recommended), Firefox®, Edge®, or Opera® with Windows®
- Chrome™ (recommended) or Safari® with OS X®
- Chrome™ or Firefox® with other operating systems.

If you need more information about recommended browsers, go to [axis.com/browser-support](https://axis.com/browser-support)

### How to access the product from a browser

1. Start a web browser.
2. Enter the IP address or hostname of the Axis product in the browser's address field.

To access the product from a Mac computer (OS X), go to Safari, click on Bonjour and select the product from the drop-down list. To add Bonjour as a browser bookmark, go to **Safari > Preferences**. If you do not know the IP address, use AXIS IP Utility to locate the product on the network. For information about how to discover and assign an IP address, see the document Assign an IP Address and Access the Video Stream on Axis Support web at [axis.com/support](https://axis.com/support)
3. Enter your username and password. If this is the first time the product is accessed, the root password must first be configured.
4. The product's live view page opens in your browser.

### About secure passwords

#### Important

Axis devices send the initially set password in clear text over the network. To protect your device after the first login, set up a secure and encrypted HTTPS connection and then change the password.

The device password is the primary protection for the data and services. Axis devices do not impose a password policy as they may be used in various types of installations. To protect your data we recommend that you:

- Change the default password that comes with the devices.
- Use a password with at least 8 characters, preferably created by a password generator.
- Don't expose the password.
- Change password at a recurring interval, at least once a year.

### Set a secure password for the root account

## Important

The default administrator user name root cannot be deleted. If the password for root is lost, the device must be reset to the factory default settings.

1. Make sure to follow the instructions about secure passwords. See About secure passwords on page 5.
2. Type a password and then retype it to confirm the spelling.
3. Click Create a login. The password has now been configured.

## Setup

### About the product's built-in help

You can access the built-in help through your product's webpage. The help provides more detailed information on the product's features and their settings.

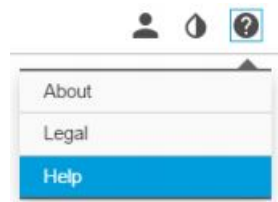

## Image quality

### How to select the exposure mode

There are different exposure mode options in the camera that adjusts aperture, shutter speed, and gain to improve image quality for specific surveillance scenes. Go to Settings > Image > Exposure and select between the following exposure modes:

- For most use cases, select Automatic exposure.
- For environments with certain artificial lighting, for example, fluorescent lighting, select Flicker-free. Select the same frequency as the power line frequency.
- For environments with certain artificial light and bright light, for example, outdoors with fluorescent lighting at night and sun during daytime, select Flicker-reduced. Select the same frequency as the power line frequency.
- To lock the current exposure settings, select Hold current.

### How to benefit from IR light in low-light conditions using night mode

Your camera uses visible light to deliver color images during the day. As light diminishes, you can set the camera to automatically shift to night mode. In night mode the camera uses both visible light and near-infrared light to deliver black-and-white images. Since the camera uses more of the available light it can deliver brighter, more detailed, images.

1. Go to Settings > Image > Day and night, and make sure that the IR cut filter is set to Auto.

### How to handle scenes with strong backlight

To make both dark and bright areas of the image visible, turn on WDR.

1. Go to Settings > Image.
2. Turn on WDR under a Wide dynamic range.



*Image without WDR.*



*Image with WDR.*

### Note

If you use WDR, you may experience some WDR artifacts in the image. Find out more about WDR and how to use it at [axis.com/web-articles/wdr](https://axis.com/web-articles/wdr)

### How to enhance facial recognition

To better recognize the face of a person passing by the camera, you can set the optimal pixel resolution with the camera's pixel counter.

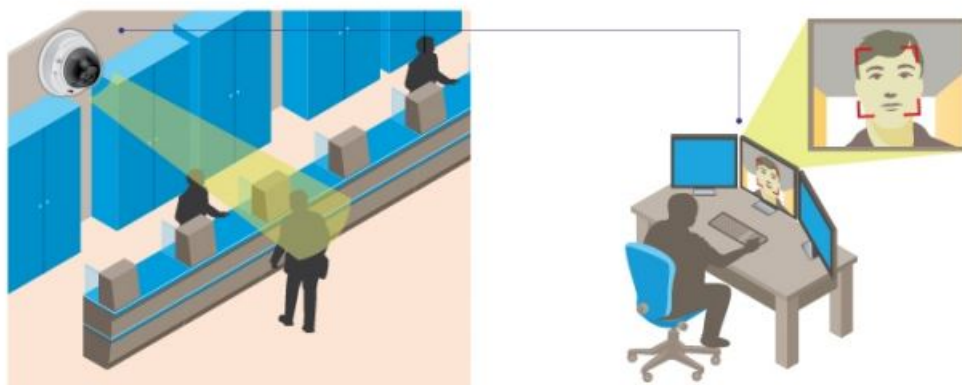

1. Go to Settings > System > Orientation and click .

2. Adjust the size and placement of the rectangle in the camera's live view around the area of interest, for example where the faces of passing persons are expected to appear. You can then see the number of pixels represented by the sides of the rectangle.

### Note

You can use an object of a known size in the view as a reference to decide how much resolution is needed for recognition.

### Privacy masks

#### How to hide parts of the image with privacy masks

#### What is a privacy mask?

A privacy mask is a user-defined area that prevents users from viewing a part of the monitored area. In the video stream, privacy masks appear as blocks of solid color.

The privacy mask is relative to the pan, tilt, and zoom coordinates, so regardless of where you point the camera, the privacy mask covers the same place or object.

You'll see the privacy mask on all snapshots, recorded videos, and live streams. You can use the VAPIX® application programming interface (API) to turn off the privacy masks.

### **Important**

Using multiple privacy masks may affect the product's performance.

### **How to create a privacy mask**

To create a privacy mask, go to Settings > Privacy mask.

## **Overlays**

### **About overlays**

Overlays are superimposed over the video stream. They are used to provide extra information during recordings, such as a timestamp, or during product installation and configuration.

### **How to show a text overlay when the camera detects motion**

This example explains how to display the text "Motion detected" when the camera detects motion: Make sure the AXIS Video Motion Detection application is running:

1. Go to Settings > Apps > AXIS Video Motion Detection.
2. Start the application if it is not already running.
3. Make sure you have set up the application according to your needs.  
Add the overlay text:
4. Go to Settings > Overlay.
5. Enter #D in the text field.
6. Choose alignment, text size, and appearance.
7. Include the text overlay. Create an action rule:
8. Go to System > Events > Action rules.
9. Create an action rule with AXIS Video Motion Detection as a trigger.
10. From the list of actions, select Overlay text.
11. Type "Motion detected". 12. Set the duration.

### **Note**

If you update the overlay text it will be automatically updated on all video streams dynamically.

## **PTZ (Pan Tilt Zoom)**

### **How to limit pan, tilt, and zoom movements**

In this example, the camera is surveilling a parking lot with nearby apartment buildings. Set pan, tilt, and zoom limits to ensure privacy for residents. To limit pan, tilt, and zoom movements, go to Settings > PTZ > Limits.

## **Streaming and storage**

### **How to choose the video compression format**

Decide which compression method to use based on your viewing requirements, and on the properties of your network. The available options are:

### **Motion JPEG**

Motion JPEG or MJPEG is a digital video sequence that is made up of a series of individual JPEG images. These images are then displayed and updated at a rate sufficient to create a stream that shows constantly updated motion. For the viewer to perceive motion video the rate must be at least 16 image frames per second.

Full motion video is perceived at 30 (NTSC) or 25 (PAL) frames per second. The Motion JPEG stream uses considerable amounts of bandwidth but provides excellent image quality and access to every image contained in the stream.

## **H.264 or MPEG-4 Part 10/AVC**

### **Note**

H.264 is licensed technology. The Axis product includes one H.264 viewing client license. Installing additional unlicensed copies of the client is prohibited. To purchase additional licenses, contact your Axis reseller.

H.264 can, without compromising image quality, reduce the size of a digital video file by more than 80% compared to the Motion JPEG format and by as much as 50% compared to the MPEG-4 standard. This means that less network bandwidth and storage space are required for a video file. Or seen another way, higher video quality can be achieved for a given bitrate.

## **How to reduce bandwidth and storage**

### **Important**

If you reduce the bandwidth it can result in a loss of details in the picture.

1. Go to live view and select H.264.
2. Go to Settings > Stream.
3. Do one or more of the following:
  - Turn on the Ziptream functionality and select the desired level.
  - Turn on dynamic GOP and set a high GOP length value.
  - Increase the compression.
  - Turn on dynamic FPS.

## **How to set up network storage**

To store recordings on the network, you need to set up network storage:

1. Go to Settings > System > Storage.
2. Click Setup under Network storage.
3. Enter the IP address of the host server.
4. Enter the name of the shared location on the host server.
5. Move the switch if the share requires a login, and enter the username and password.
6. Click Connect.

## **How to add audio to your recording**

Edit the stream profile which is used for the recording:

1. Go to Settings > System > Stream profiles.
2. Select the stream profile and click Modify.
3. In the Audio tab, select the Audio stream checkbox and select On from the drop-down list.
4. Click Ok.

## **Events**

### **About events**

The event pages allow you to configure your product to perform actions when different events occur. For example, the product can start a recording or send an email notification when a motion is detected. The set of conditions that defines how and when the action is triggered is called an action rule.

## **How to direct the camera to a preset position when the camera detects motion**

This example explains how to set up the camera to go to a preset position when it detects motion in the image. Make sure the AXIS Video Motion Detection application is running:

1. Go to Settings > Apps > AXIS Video Motion Detection.
2. Start the application if it is not already running.
3. Make sure you have set up the application according to your needs. Add a preset position:
4. Go to Settings > PTZ and set where you want the camera to be directed by creating a preset position. Create an action rule:
5. Go to Settings > System > Events > Action rules and add an action rule.
6. Type a name for the action rule.
7. From the list of triggers, select Applications and then select AXIS Video Motion Detection (VMD).
8. From the list of actions, select PTZ Control and then select Preset Position.
9. Select the preset position you want the camera to go to.
10. Click Ok.

### How to record video when a PIR detector senses motion

This example explains how to connect an Axis PIR detector to the camera, and set up the camera to start recording when the detector senses motion. Required hardware

- 3wire cable (ground, power, I/O)
- Axis PIR detector

### NOTICE

Disconnect the camera from power before connecting the wires. Reconnect to power after all connections are done.

### Connect the wires to the camera's I/O connector

#### Note

For information on the I/O connector, see Connectors on page 19

1. Connect the ground wire to pin 1 (GND/-).
2. Connect the power wire to pin 2 (12V DC output).
3. Connect the I/O wire to pin 3 (I/O input).

### Connect the wires to the PIR detector's I/O connector

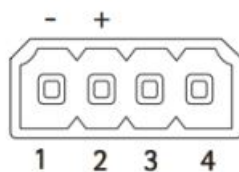

1. Connect the other end of the ground wire to pin 1 (GND/-).
2. Connect the other end of the power wire to pin 2 (DC input/+).
3. Connect the other end of the I/O wire to pin 3 (I/O output).

### Configure the I/O port in the camera's web page

1. Go to Settings > System > I/O ports.
2. Select Input in the Port 1 drop-down list.
3. Give the input module a descriptive name.
4. To make the PIR detector send a signal to the camera when it senses motion, select Closed-circuit in the drop-



down list.

To trigger the camera to start recording when it receives a signal from the PIR detector, you need to create an action rule on the camera's web page.

### **Use audio to deter intruders**

This example explains how to connect a speaker to the camera and set it up to play a warning message when the camera detects motion in a restricted area.

#### **Required hardware**

- Active speaker with built-in amplifier and connecting wires

#### **NOTICE**

Make sure the camera is disconnected from power before making the connections. Reconnect to power after connecting the wires.

#### **Physical connection**

1. Connect the audio wire from the speaker to the AUDIO OUT pin on the camera. See Product overview on page 3.
2. Connect the grounding wire from the speaker to the GND AUDIO OUT pin on the camera. See Product overview on page 3.

### **Add the audio clip to the camera**

1. Go to Settings > Audio > Output and click  to add your audio clip.
2. Click Add.
3. Select Upload under Add Audio Clip Options.
4. Browse to locate the audio clip and click Upload.

To trigger the camera to play the audio clip when it detects motion, create an action rule in the camera's webpage.

### **How to direct the camera and open the lock to a gate when someone is nearby**

This example explains how to direct the camera and open a gate when someone wants to enter during the daytime. This is done by connecting a PIR detector to the product's input port and a switch relay to the product's output port.

#### **Required hardware**

- Mounted PIR detector
- Switch relay connected to the gate lock, in this case, the switch is normally closed (NC)
- Connecting wires

#### **Physical connection**

1. Connect the wires from the PIR detector to the input pin, see I/O connector on page 20.
2. Connect the wires from the switch to the output pin, see I/O connector on page 20

### **Configure I/O ports**

You need to connect the switch relay to the camera in the camera's webpage. First, configure the I/O ports: Set the PIR detector to an input port

1. Go to System > I/O ports.

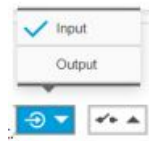

2. Select Input in the Port 1 drop-down list.
3. Give the input module a descriptive name, for example, "PIR detector".
4. To trigger an event whenever the PIR detector senses motion, select Open circuit in the drop-down list.

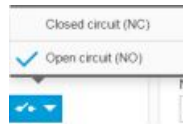

### Set the switch relay to an output port

1. Go to System > I/O ports.



2. Select Output in the Port 2 drop-down list.
3. Give the output module a descriptive name, for example, "Gate switch".
- 4.



5. To open the gate whenever an event is triggered, select Closed-circuit in the drop-down list.

### Create action rules

For the camera to open the gate when the PIR detector senses someone nearby, you need to create an action rule in the camera:

1. Go to System > Events > Action rules.
2. Click Add.
3. Give the action rule a name, for example, "Open the gate".
4. From the Trigger drop-down list, select the Input signal.
5. Select Digital input signal.
6. Select "PIR detector", in this example connected to port 1.
7. Under Actions, select Output port from the Type drop-down list.
8. From the Port drop-down list, select "Gate switch".
9. Click Ok.
10. Create another action rule with the name "Direct the camera to the gate"
11. Select the same input signal as before, but as action select the previously created "Gate entrance" preset position.
12. Click Ok.

## Applications

### About applications

AXIS Camera Application Platform (ACAP) is an open platform that enables third parties to develop analytics and other applications for Axis products.

To find out more about available applications, downloads, trials, and licenses, go to [axis.com/applications](https://axis.com/applications)

To find the user manuals for Axis applications, go to [axis.com](https://axis.com)

### Note

- Several applications can run at the same time but some applications might not be compatible with each other. Certain combinations of applications might require too much processing power or memory resources when run in parallel. Verify that the applications work together before deployment.

## Troubleshooting

### How to reset to factory default settings

#### Important

Reset to factory default should be used with caution. A reset to factory default resets all settings, including the IP address, to the factory default values.

To reset the product to the factory default settings:

1. Disconnect power from the product.
2. Press and hold the control button while reconnecting power. See Product overview on page
3. Keep the control button pressed for 1530 seconds until the status LED indicator flashes amber.
4. Release the control button. The process is complete when the status LED indicator turns green. The product has been reset to the factory default settings. If no DHCP server is available on the network, the default IP address is 192.168.0.90
5. Use the installation and management software tools to assign an IP address, set the password, and access the video stream. The installation and management software tools are available from the support pages on [axis.com/support](https://axis.com/support)

It is also possible to reset parameters to factory default via the web interface. Go to **Settings > System > Maintenance** and click Default.

### Check the current firmware

Firmware is the software that determines the functionality of network devices. One of your first actions when troubleshooting a problem should be to check the current firmware version. The latest version may contain a correction that fixes your particular problem. To check the current firmware:

1. Go to the product's webpage.
2. Click on the help menu?.
3. Click About.

### Upgrade the firmware

#### Important

Preconfigured and customized settings are saved when the firmware is upgraded (provided that the features are available in the new firmware) although this is not guaranteed by Axis Communications AB.

#### Important

Make sure the product remains connected to the power source throughout the upgrade process.

#### Note

When you upgrade the product with the latest firmware in the active track, the product receives the latest

functionality available. Always read the upgrade instructions and release notes available with each new release before upgrading the firmware. To find the latest firmware and the release notes, go to

[axis.com/support/firmware](https://axis.com/support/firmware).

1. Download the firmware file to your computer, available free of charge at [axis.com/support/firmware](https://axis.com/support/firmware).
2. Log in to the product as an administrator.
3. Go to Settings > System > Maintenance. Follow the instructions on the page. When the upgrade has finished, the product restarts automatically.

AXIS Device Manager can be used for multiple upgrades. Find out more at [axis.com/products/axis-device-manager](https://axis.com/products/axis-device-manager).

### **Technical issues, clues, and solutions**

If you can't find what you're looking for here, try the troubleshooting section at [axis.com/support](https://axis.com/support)

#### **Problems upgrading the firmware**

Firmware upgrade failure

If the firmware upgrade fails, the product reloads the previous firmware. The most common reason is that the wrong firmware file has been uploaded. Check that the name of the firmware file corresponds to your product and try again.

#### **Problems setting the IP address**

The product is located on a different subnet

If the IP address intended for the product and the IP address of the computer used to access the product are located on different subnets, you cannot set the IP address. Contact your network administrator to obtain an IP address.

The IP address is being used by another device

Disconnect the Axis product from the network. Run the ping command (in a Command/DOS window, type ping and the IP address of the product):

- If you receive: Reply from <IP address>: bytes=32; time=10... this means that the IP address may already be in use by another device on the network. Obtain a new IP address from the network administrator and reinstall the product.

- If you receive: Request timed out, this means that the IP address is available for use with the Axis product.

Check all cabling and reinstall the product.

Possible IP address conflict with another device on the same subnet

The static IP address in the Axis product is used before the DHCP server sets a dynamic address. This means that if the same default static IP address is also used by another device, there may be problems accessing the product.

#### **The product cannot be accessed from a browser**

Cannot log in

When HTTPS is enabled, ensure that the correct protocol (HTTP or HTTPS) is used when attempting to log in. You may need to manually type HTTP or HTTPS in the browser's address field.

If the password for the user root is lost, the product must be reset to the factory default settings. See How to reset to factory default settings on page 16.

The IP address has been changed by DHCP

IP addresses obtained from a DHCP server are dynamic and may change. If the IP address has been changed, use AXIS IP Utility or AXIS Camera Management to locate the product on the network. Identify the product using its model or serial number, or by the DNS name (if the name has been configured).

If required, a static IP address can be assigned manually. For instructions, go to [axis.com/support](https://axis.com/support)

Certificate error when using IEEE 802.1X

For authentication to work properly, the date and time settings in the Axis product must be synchronized with an NTP server. Go to Settings > System > Date and time

### **The product is accessible locally but not externally**

Router configuration

Check that your router allows incoming data traffic to the Axis product. The router must support UPnP®.

Firewall protection

Check the Internet firewall with your network administrator.

### **Problems with streaming**

Multicast H.264 only accessible by local clients

Check if your router supports multicasting, or if the router settings between the client and the product need to be configured. The TTL (Time To Live) value may need to be increased.

No multicast H.264 displayed in the client

Check with your network administrator that the multicast addresses used by the Axis product are valid for your network.

Check with your network administrator to see if there is a firewall preventing viewing.

Poor rendering of H.264 images

Ensure that your graphics card is using the latest driver. The latest drivers can usually be downloaded from the manufacturer's website.

Color saturation is different in H.264 and Motion JPEG

Modify the settings for your graphics adapter. Go to the adapter's documentation for more information.

Lower frame rate than expected

- See Performance considerations on page 18.
- Reduce the number of applications running on the client computer.
- Limit the number of simultaneous viewers.
- Check with the network administrator that there is enough bandwidth available.
- Lower the image resolution.
- In the product's webpage set a capture mode that prioritizes frame rate. Changing the capture mode to prioritize frame rate might lower the maximum resolution depending on the product used and capture modes available.

### **Performance considerations**

When setting up your system, it is important to consider how various settings and situations affect the performance. Some factors affect the amount of bandwidth (the bitrate) required, others can affect the frame rate, and some affect both. If the load on the CPU reaches its maximum, this also affects the frame rate.

The following factors are the most important to consider:

- High image resolution or lower compression levels result in images containing more data which in turn affects the bandwidth.
- Access by large numbers of Motion JPEG or unicast H.264 clients affects the bandwidth.
- Simultaneous viewing of different streams (resolution, compression) by different clients affects both frame rate and bandwidth.

Use identical streams wherever possible to maintain a high frame rate. Stream profiles can be used to ensure that streams are identical.

- Accessing Motion JPEG and H.264 video streams simultaneously affect both frame rate and bandwidth.
- Heavy usage of event settings affects the product's CPU load which in turn affects the frame rate.
- Using HTTPS may reduce the frame rate, in particular, if streaming Motion JPEG.
- Heavy network utilization due to poor infrastructure affects the bandwidth.
- Viewing on poorly performing client computers lowers perceived performance and affects frame rate.
- Running multiple AXIS Camera Application Platform (ACAP) applications simultaneously may affect the frame rate and the general performance.

## Specifications

To find the latest version of the product's datasheet, go to the product page on [axis.com](https://axis.com) and locate Support & Documentation.

### LED indicators

Status LED	Indication
Unlit	Connection and normal operation.
Green	Shows steady green for 10 seconds for normal operation after startup completed.
Amber	Steady during startup. Flashes during firmware upgrade or reset to factory default.
Amber/Red	Flashes amber/red if network connection is unavailable or lost.

### SD card slot

#### NOTICE

- Risk of damage to SD card. Do not use sharp tools, metal objects, or excessive force when inserting or removing the SD card. Use your fingers to insert and remove the card.
- Risk of data loss and corrupted recordings. Do not remove the SD card while the product is running. Unmount the SD card from the product's webpage before removal.

This product supports microSD/microSDHC/microSDXC cards.  
For SD card recommendations, see [axis.com](https://axis.com)

### Buttons

#### Control button

The control button is used for:

- Resetting the product to factory default settings. See How to reset to factory default settings on page 16.
- Connecting to an AXIS Video Hosting System service. To connect, press and hold the button for about 3 seconds until the status LED flashes green.

### Connectors

#### Network connector

RJ45 Ethernet connector with Power over Ethernet (PoE).

### Audio connector

4-pin terminal block for audio input and output. See Product overview on page 3. For audio, the left channel is used from a stereo signal.

Pin	Notes
AUDIO IN	Microphone or line in (mono)
GND AUDIO IN	Ground audio in
AUDIO OUT	Line audio out
GND AUDIO OUT	Ground audio out

### I/O connector

Use the I/O connector with external devices in combination with, for example, motion detection, event triggering, and alarm notifications. In addition to the 0 V DC reference point and power (DC output), the I/O connector provides the interface to:

**Digital input** – For connecting devices that can toggle between an open and closed circuit, for example, PIR sensors, door/window contacts, and glass break detectors.

**Digital output** – For connecting external devices such as relays and LEDs. Connected devices can be activated by the VAPIX® Application Programming Interface or on the product's webpage.

6pin terminal block. See Product overview on page 3.

Function	Pin	Notes	Specifications
0 V DC (-)	GND	DC ground	0 V DC
DC output	12 V	Can be used to power auxiliary equipment. Note: This pin can only be used as power out.	12 V DC Max load = 50 mA
Configurable (Input or Output)	I/O 1–4	Digital input – Connect to pin GND to activate, or leave floating (unconnected) to deactivate.	0 to max 30 V DC
		Digital output – Internally connected to pin 1 (DC ground) when active, and floating (unconnected) when inactive. If used with an inductive load, e.g. a relay, a diode must be connected in parallel with the load, for protection against voltage transients.	0 to max 30 V DC, open drain, 100 mA

### Power connector

2-pin terminal block for DC power input. Use a Safety Extra Low Voltage (SELV) compliant limited power source (LPS) with either a rated output power limited to 100 W or a rated output current limited to 5 A.

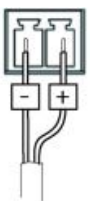

User Manual

AXIS M5525-E PTZ Network Camera

© Axis Communications AB, 2017 – 2020

Ver. M4.2

Date: March 2020

Part No. T10111798

### Documents / Resources

