



# AXIS COMMUNICATIONS AXIS TP6901-E Adapter Bracket Installation Guide

[Home](#) » [AXIS COMMUNICATIONS](#) » **AXIS COMMUNICATIONS AXIS TP6901-E Adapter Bracket Installation Guide**

## Contents [ [hide](#) ]

- [1 AXIS TP6901-E Adapter Bracket](#)
- [2 Product Information AXIS TP6901-E Adapter Bracket P56](#)
- [3 Regulatory Information](#)
- [4 Warranty Information](#)
- [5 Product Usage Instructions AXIS TP6901-E Adapter Bracket P56](#)
- [6 Safety instructions](#)
  - [6.1 Transportation](#)
- [7 WHATS IN THE BOX](#)
- [8 INSTALLATION INSTRUCTIONS](#)
- [9 Documents / Resources](#)
  - [9.1 References](#)
- [10 Related Posts](#)



**AXIS TP6901-E Adapter Bracket**

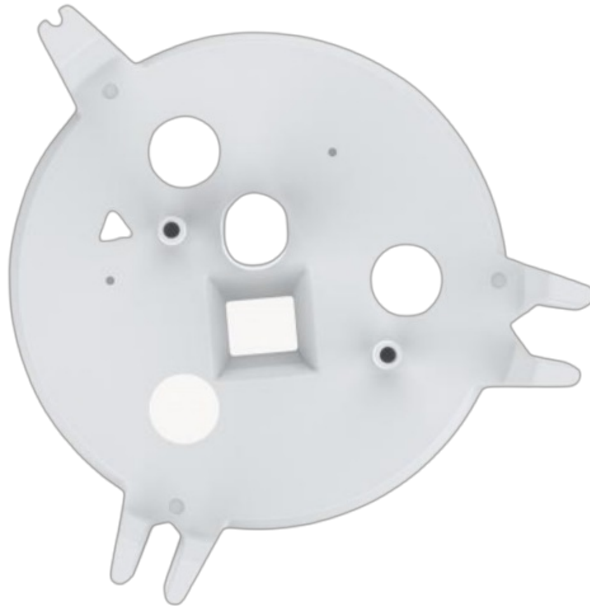

## **Product Information AXIS TP6901-E Adapter Bracket P56**

The AXIS TP6901-E Adapter Bracket P56 is a mounting bracket designed to securely attach an Axis Q60-E camera to a P56 electrical installation box. The bracket is made of durable aluminum and is suitable for outdoor use.

### **Legal Considerations**

Before using this product for video and audio surveillance purposes, it is essential to check the laws and regulations in your local region as they may vary from country to country. Video and audio surveillance can be regulated by laws that vary from country to country. Check the laws in your local region before using this product for surveillance purposes

### **Intellectual Property Rights**

The AXIS TP6901-E Adapter Bracket P56 is an Axis AB product, and Axis AB has intellectual property rights relating to technology embodied in the product. Unauthorized use of such technology may constitute an infringement of Axis AB's intellectual property rights. Axis AB has intellectual property rights relating to technology embodied in the product described in this document. In particular, and without limitation, these intellectual property rights may include one or more of the patents listed at [axis.com/patent](http://axis.com/patent) and one or more additional patents or pending patent applications in the US and other countries.

### **Equipment Modifications**

It is crucial to install and use this equipment strictly in accordance with the instructions given in the user documentation. This equipment contains no user-serviceable parts, and any unauthorized equipment changes or modifications will invalidate all applicable regulatory certifications and approvals. This equipment must be installed and used in strict accordance with the instructions given in the user documentation. This equipment contains no user-serviceable components. Unauthorized equipment changes or modifications will invalidate all applicable regulatory certifications and approvals

### **Trademark Acknowledgements**

AXIS COMMUNICATIONS, AXIS, ARTPEC, and VAPIX are registered trademarks of Axis AB in various jurisdictions. All other trademarks are the property of their respective owners. AXIS COMMUNICATIONS, AXIS, ARTPEC and VAPIX are registered trademarks of Axis AB in various jurisdictions. All other trademarks are the property of their respective owners.

## **Regulatory Information**

The AXIS TP6901-E Adapter Bracket P56 complies with the applicable CE marking directives and harmonized

standards. For more information regarding regulatory compliance, please refer to Contact Information on page 2 of the user manual. This product complies with the applicable CE marking directives and harmonized standards: Restriction of Hazardous Substances (RoHS) Directive 2011/65/EU and 2015/863, including any amendments, updates or replacements. See Disposal and recycling on page 2 . A copy of the original declaration of conformity may be obtained from Axis Communications AB. See Contact information on page 2 .

### **Disposal and Recycling**

When this product has reached the end of its useful life, dispose of it according to local laws and regulations. For more information regarding disposal and recycling procedures, please contact your local authority responsible for waste disposal. Penalties may apply for incorrect disposal of this waste. When this product has reached the end of its useful life, dispose of it according to local laws and regulations. For information about your nearest designated collection point, contact your local authority responsible for waste disposal. In accordance with local legislation, penalties may be applicable for incorrect disposal of this waste.

Europe This symbol means that the product shall not be disposed of together with household or commercial waste. Directive 2012/19/EU on waste electrical and electronic equipment (WEEE) is applicable in the European Union member states. To prevent potential harm to human health and the environment, the product must be disposed of in an approved and environmentally safe recycling process. For information about your nearest designated collection point, contact your local authority responsible for waste disposal. Businesses should contact the product supplier for information about how to dispose of this product correctly. This product complies with the requirements of Directive 2011/65/EU and 2015/863 on the restriction of the use of certain hazardous substances in electrical and electronic equipment (RoHS).

### **Warranty Information**

For information about Axis' product warranty and related information, please visit [axis.com/warranty](https://axis.com/warranty).

### **Support**

If you require any technical assistance, contact your Axis reseller. If they cannot answer your questions, they will forward your queries through the appropriate channels to ensure a rapid response. Visit Axis learning center at [axis.com/learning](https://axis.com/learning) for useful training, webinars, tutorials, and guides. Should you require any technical assistance, please

contact your Axis reseller. If your questions cannot be answered immediately, your reseller will forward your queries through the appropriate channels to ensure a rapid response. If you are connected to the Internet, you can

- find answers to resolved problems in the FAQ database, search by product, category, or phrase
- report problems to Axis support staff by logging in to your private support area
- chat with Axis support staff
- visit Axis Support at [axis.com/support](https://axis.com/support)

### **Learn more!**

Visit Axis learning center [axis.com/learning](https://axis.com/learning) for useful trainings, webinars, tutorials and guides.

### **Product Usage Instructions AXIS TP6901-E Adapter Bracket P56**

Before installing the AXIS TP6901-E Adapter Bracket P56, carefully read through the Installation Guide provided with the product. Keep the Installation Guide for future reference. Follow these instructions to install the AXIS TP6901-E Adapter Bracket P56:

1. Locate a suitable location for the P56 electrical installation box.
2. Attach the P56 electrical installation box to a suitable mounting surface using screws and anchors that are

appropriate for the mounting surface. Ensure that the mounting surface is strong enough to support the weight of the P56 electrical installation box and any equipment that may be mounted on it.

3. Attach the AXIS TP6901-E Adapter Bracket P56 to the P56 electrical installation box using screws and washers provided with the product. Tighten the screws securely.
4. Attach an Axis Q60-E camera to the AXIS TP6901-E Adapter Bracket P56 using screws provided with the camera. Tighten the screws securely.
5. Connect the camera to a suitable power source and network using cables appropriate for the installation. Refer to the camera's user manual for more information.
6. Adjust the camera's position and angle as desired.

For more information regarding product usage, refer to the user manual provided with the product.

### **Read this first**

Read through this Installation Guide carefully before installing the product. Keep the Installation Guide for future reference.\

### **Liability**

Every care has been taken in the preparation of this document. Please inform your local Axis office of any inaccuracies or omissions. Axis Communications AB cannot be held responsible for any technical or typographical errors and reserves the right to make changes to the product and manuals without prior notice. Axis Communications AB makes no warranty of any kind with regard to the material contained within this document, including, but not limited to, the implied warranties of merchantability and fitness for a particular purpose. Axis Communications AB shall not be liable nor responsible for incidental or consequential damages in connection with the furnishing, performance or use of this material. This product is only to be used for its intended purpose.

### **Contact information**

Axis Communications AB Gränden 1 223 69 Lund Sweden

- **Tel:** +46 46 272 18 00
- **Fax:** +46 46 13 61 30
- [axis.com](http://axis.com)

### **Safety instructions**

#### **NOTICE**

- The Axis product shall be used in compliance with local laws and regulations.
- Store the Axis product in a dry and ventilated environment.
- Use only applicable tools when installing the Axis product. Using excessive force with power tools could cause damage to the product.
- Do not use chemicals, caustic agents, or aerosol cleaners.
- Use a clean cloth dampened with pure water for cleaning.
- Use only accessories that comply with the technical specification of your product. These can be provided by Axis or a third party. Axis recommends using Axis power source equipment compatible with your product.
- Use only spare parts provided by or recommended by Axis.
- Do not attempt to repair the product yourself. Contact Axis support or your Axis reseller for service matters.

## Transportation

### NOTICE

When transporting the Axis product, use the original packaging or equivalent to prevent damage to the product.

### WHATS IN THE BOX

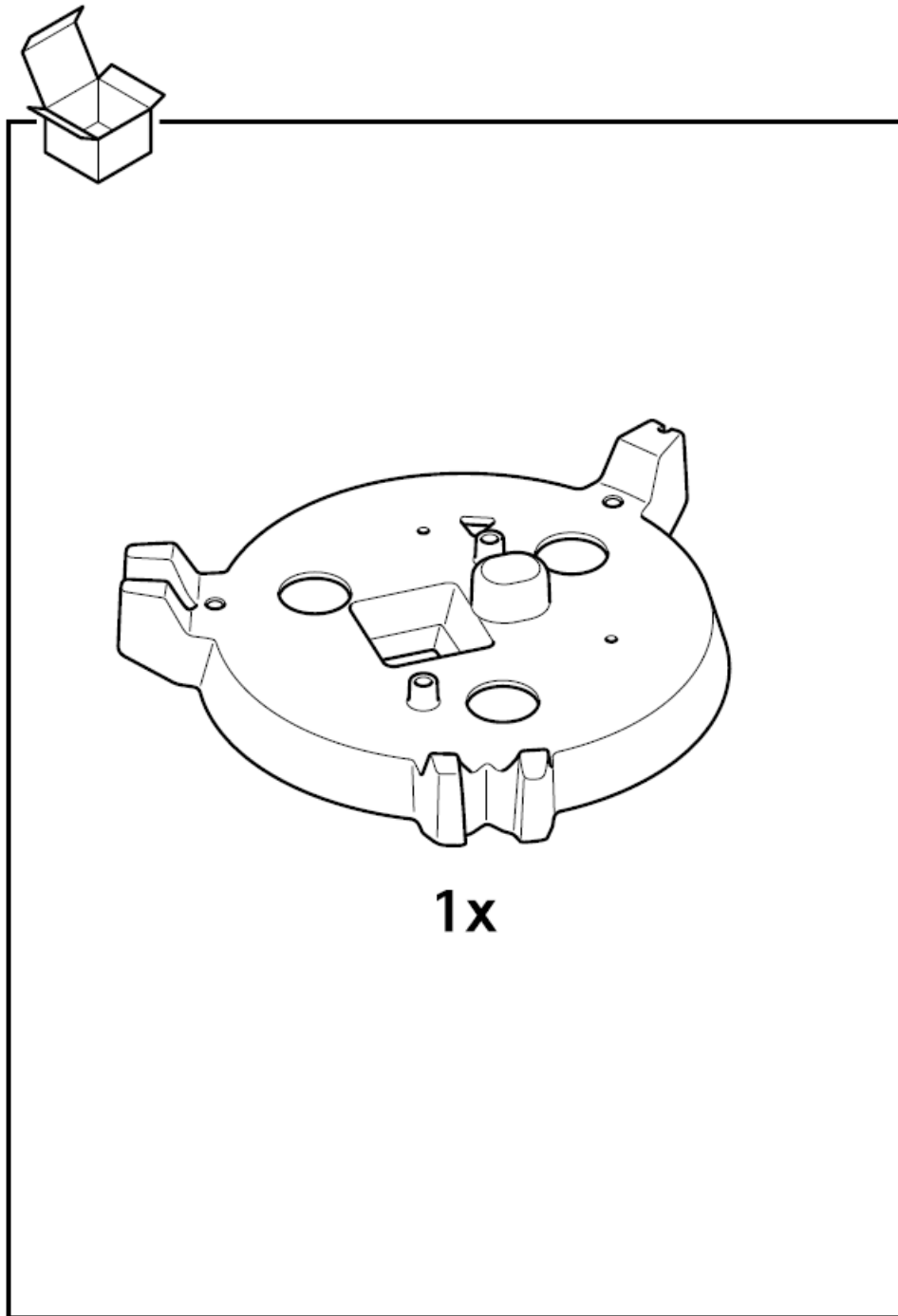

### INSTALLATION INSTRUCTIONS



## AXIS High PoE Midspan 60 W

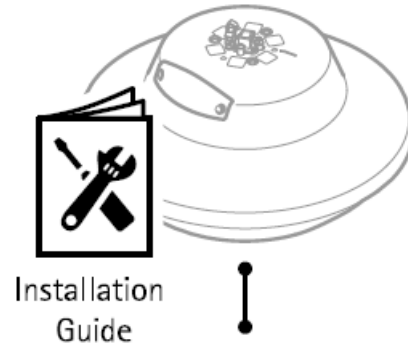
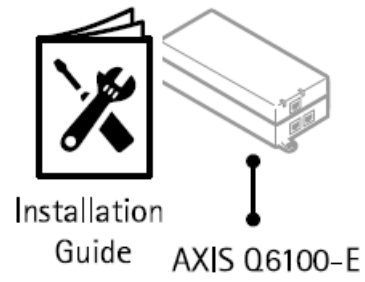

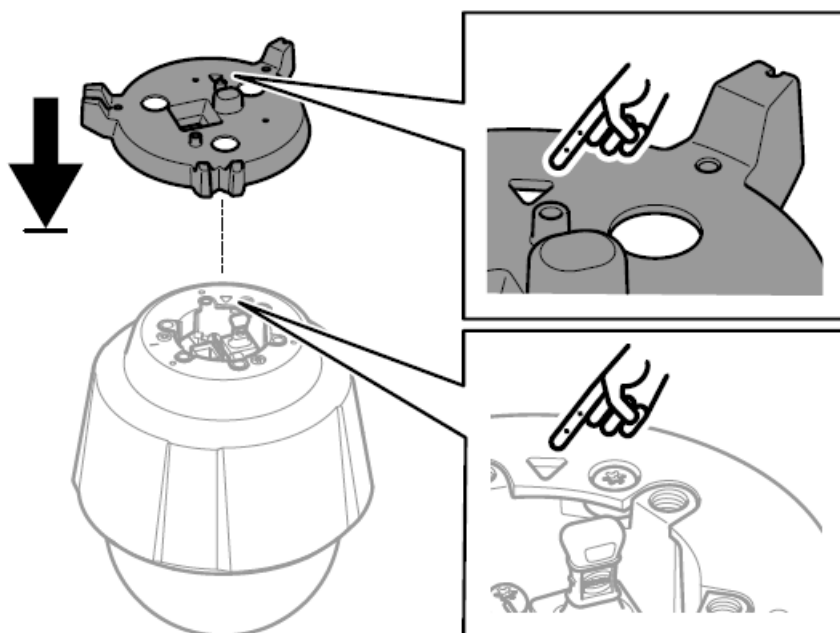
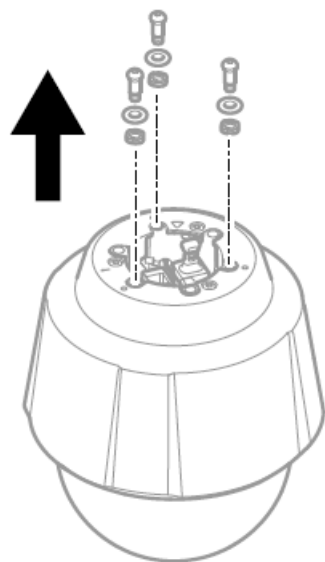

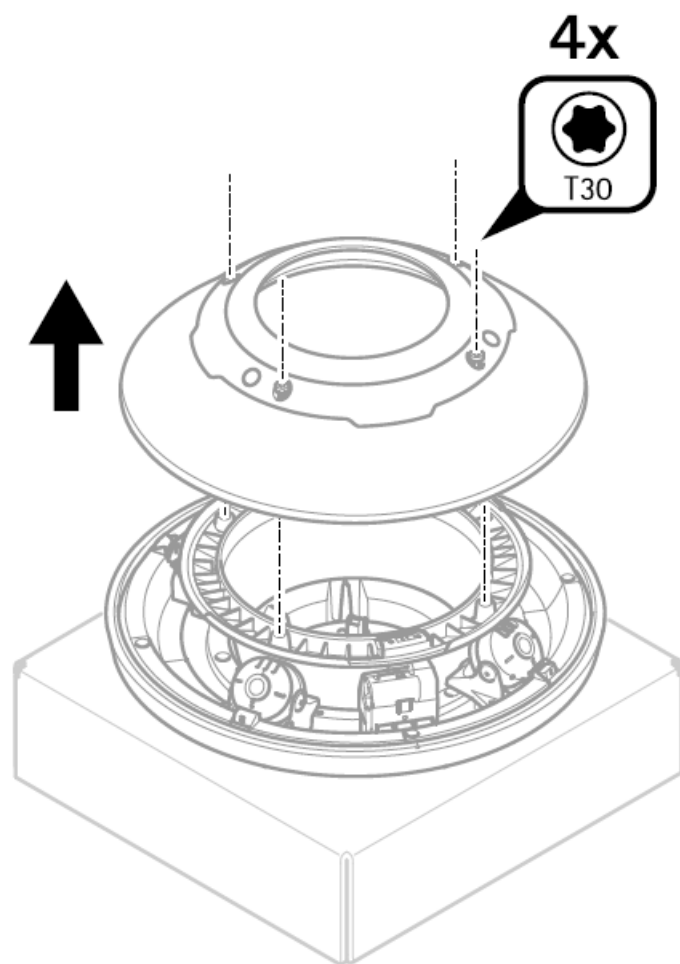



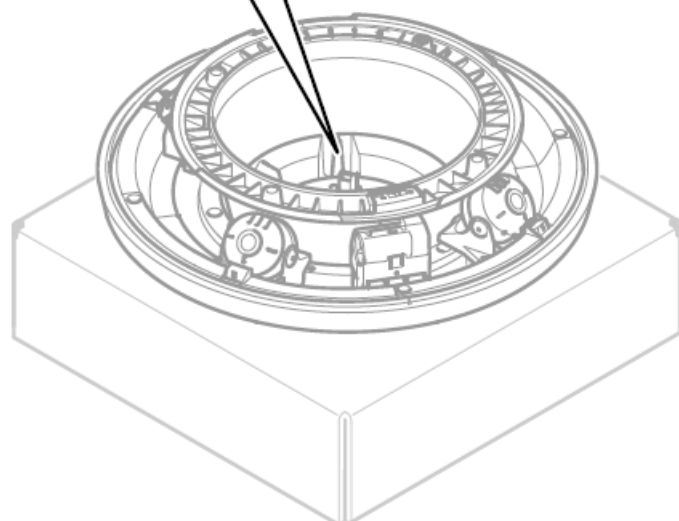
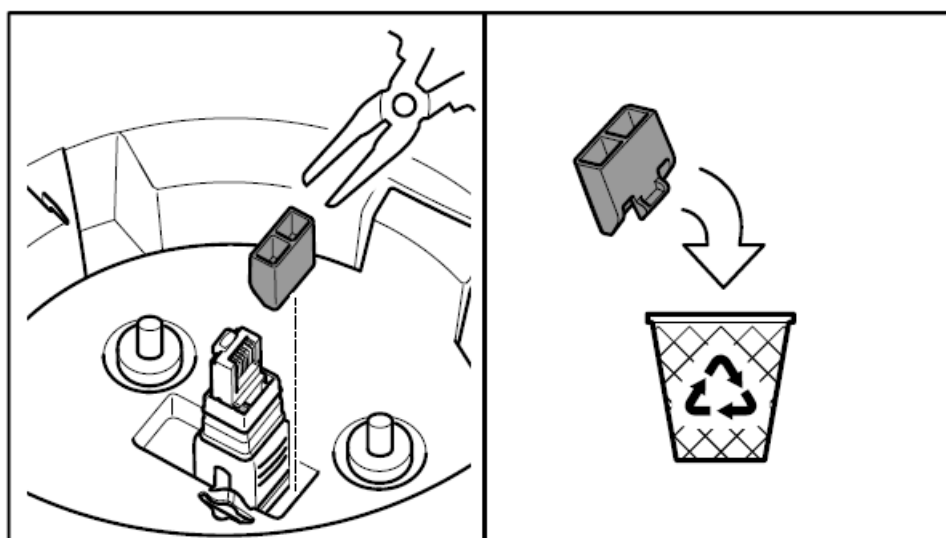

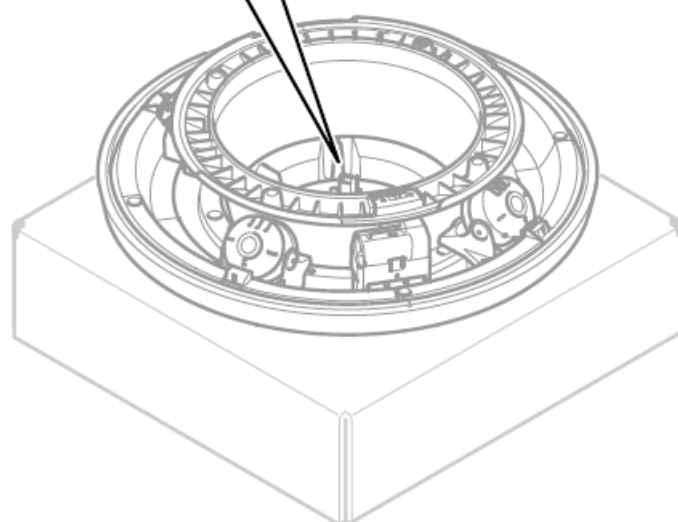
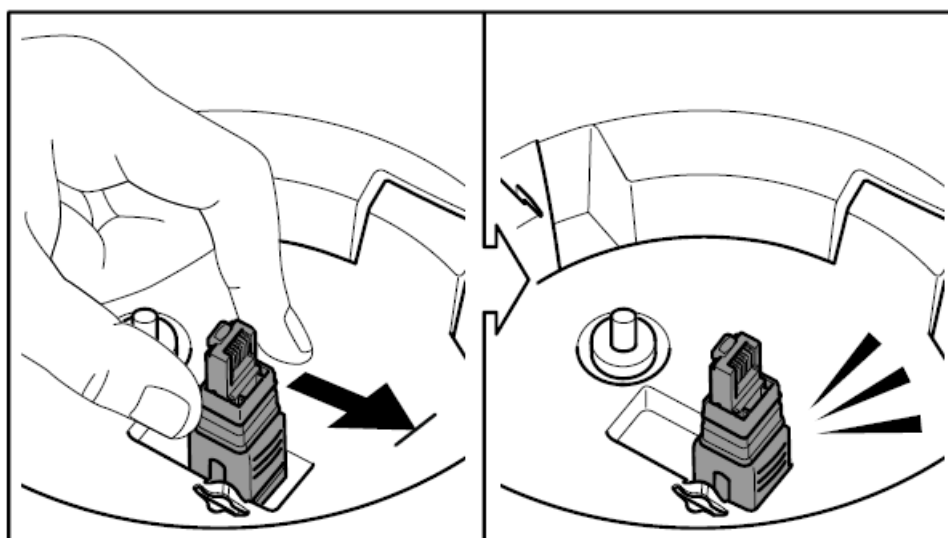

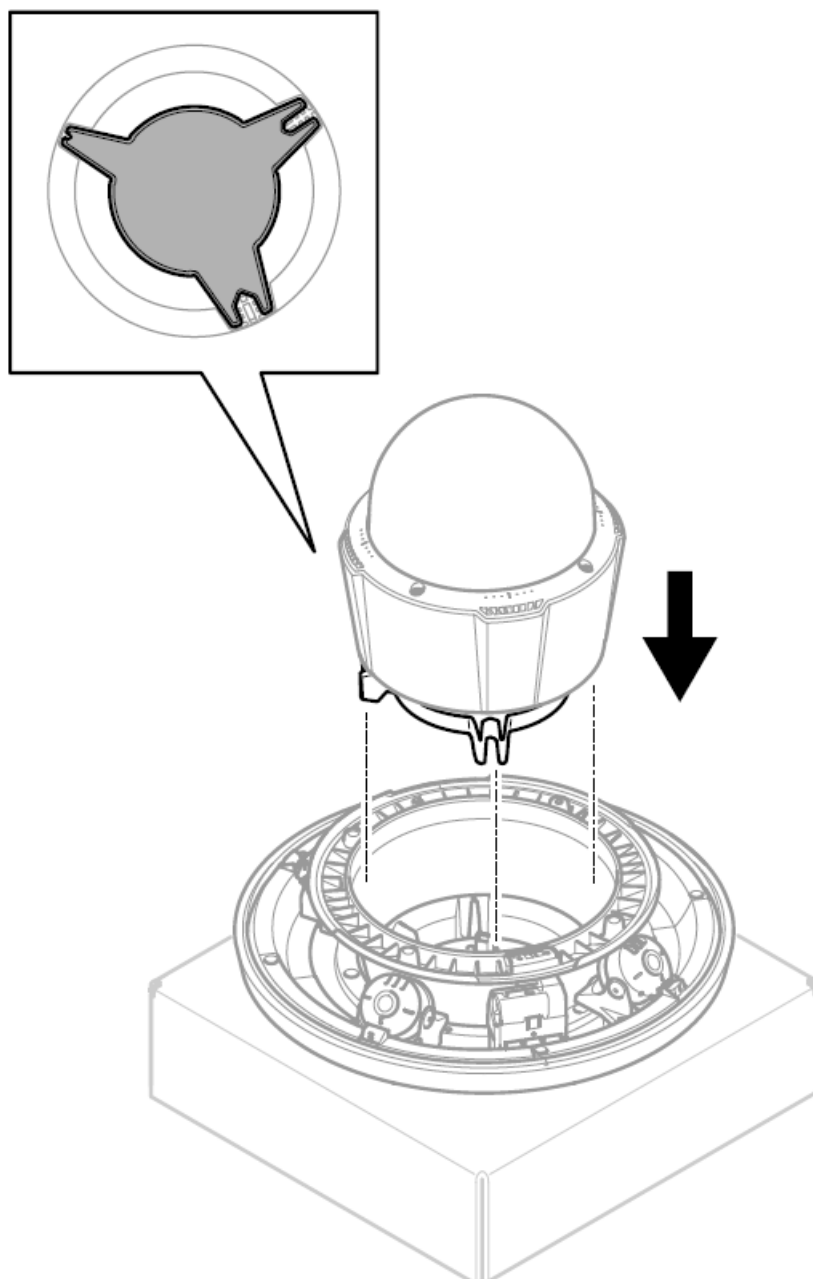

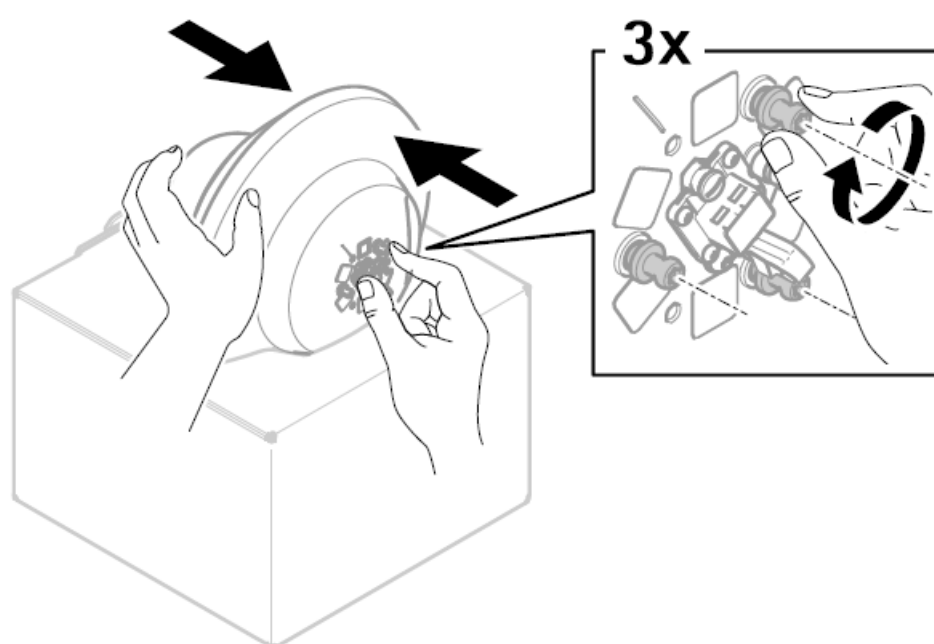
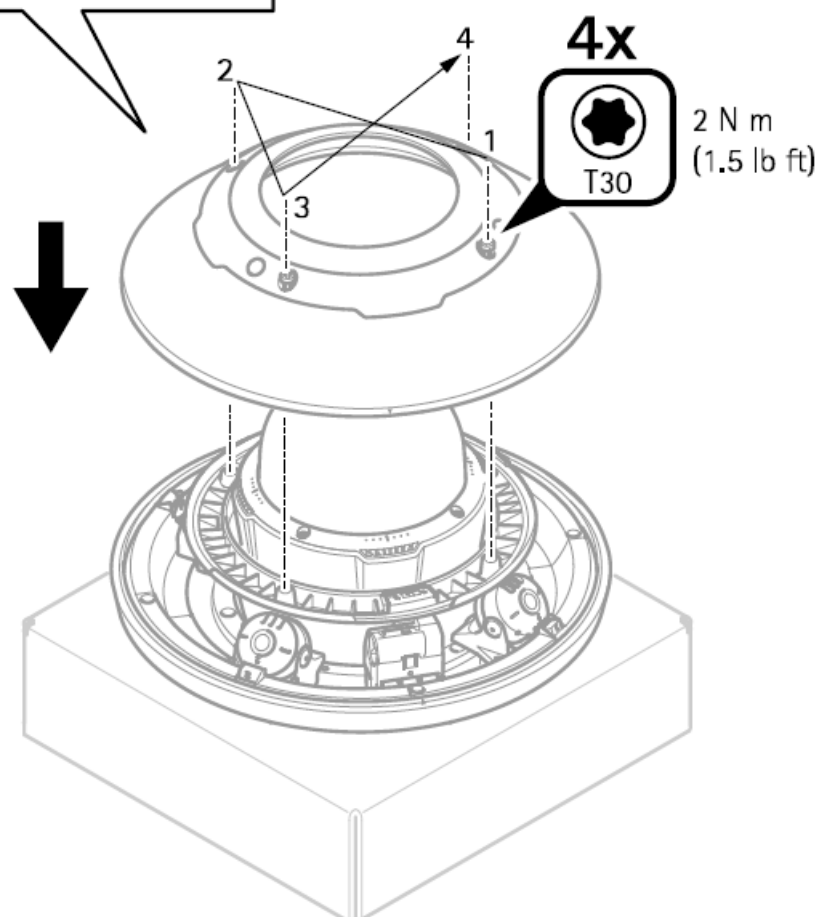
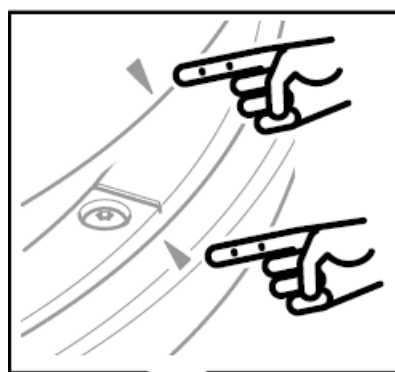

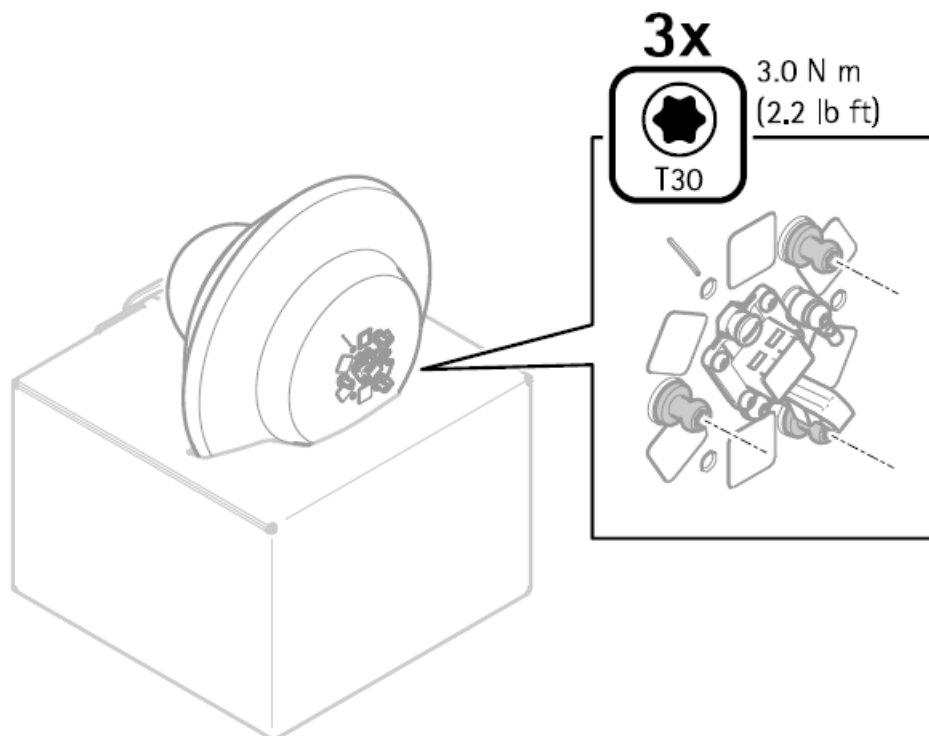

Installation Guide Ver. M1.5 AXIS TP6901-E Adapter Bracket P56 Date: September 2021 © 2021 Axis Communications AB Part No. 2412133

## Documents / Resources

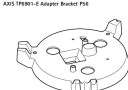
 <p>AXIS TP6901-E Adapter Bracket P56</p> <p>Installation Guide</p>	<p><b><a href="#">AXIS COMMUNICATIONS AXIS TP6901-E Adapter Bracket</a></b> [pdf] Installation Guide  AXIS TP6901-E Adapter Bracket, AXIS, TP6901-E Adapter Bracket, Adapter Bracket, Bracket</p>
--	---

## References

- [Axis Communications - Leader in network cameras and other IP networking solutions | Axis Communications](#)
- [Sharing knowledge | Axis Communications](#)
- [Patent Statement | Axis Communications](#)
- [Welcome to Axis support | Axis Communications](#)
- [RMA | Axis Communications](#)