



AXIOM AX16CL Floor and Front Fill Installation with foam Stand Instruction Manual

[Home](#) » [AXiom](#) » AXIOM AX16CL Floor and Front Fill Installation with foam Stand Instruction Manual 

Contents

- 1 AXIOM AX16CL Floor and Front Fill Installation with foam Stand
- 2 AX16CL/AX8CL FLOOR AND FRONT FILL INSTALLATION WITH FOAM STAND
- 3 Assembly Instructions
 - 3.1 SUPPLIED MATERIALS
 - 3.2 TYPICAL APPLICATIONS
- 4 Documents / Resources
 - 4.1 References
- 5 Related Posts



AXIOM AX16CL Floor and Front Fill Installation with foam Stand



AX16CL/AX8CL FLOOR AND FRONT FILL INSTALLATION WITH FOAM STAND

CODE: KPTFAXCL

Assembly Instructions

SUPPLIED MATERIALS

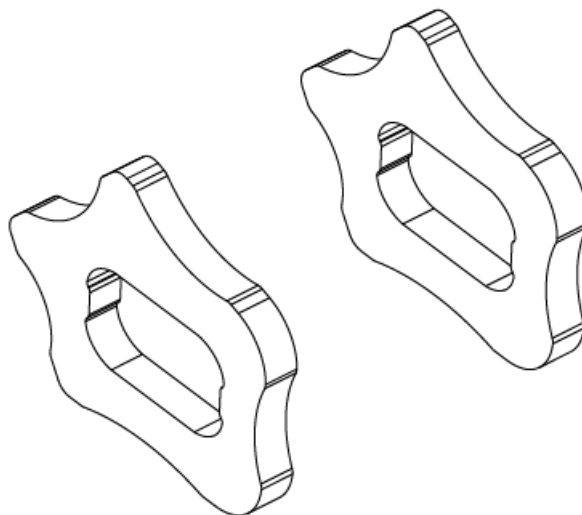

TYPICAL APPLICATIONS

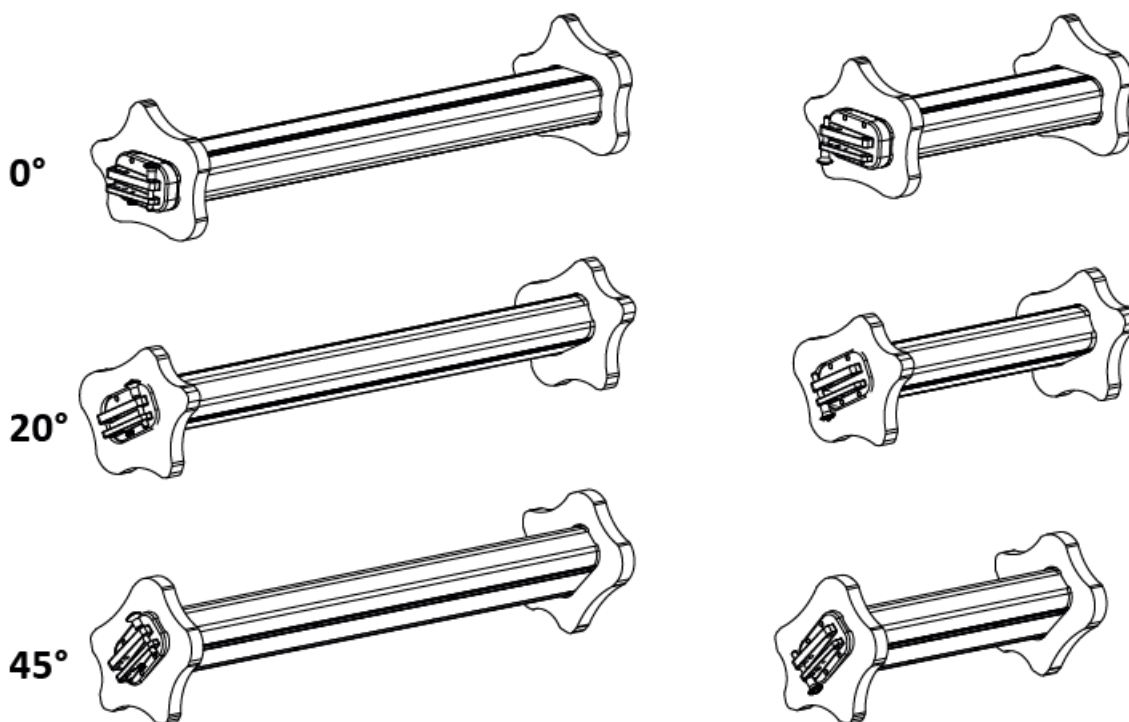

CONDITIONS OF USE

Proel do not accept any liability for damage caused to third parties due to improper installation, use of non-original spare parts, lack of maintenance, tampering or improper use of this product, including disregard of acceptable and applicable safety standards. Proel strongly recommends that this loudspeaker cabinet be suspended taking into consideration all current National, Federal, State and Local regulations. The product must be installed by qualified personnel only. Please contact the manufacturer for further information.

WARNINGS:

- KPTFAX8CL can be used in front-fill or monitor applications on stage.
- The ground where the KPTFAXCL foam stand is placed needs to be stable and compact.
- When using this support for front fill application, place it on a stable surface. If it is placed on a front line subwoofer, it must be secured to it using a strap, because the subwoofer vibrations could cause it to fall to ground.

PROEL S.p.A. – Via alla Ruenia 37/43 – 64027 Sant’Omero (Te) – ITALY Tel: +39 0861 81241
www.axiomproaudio.com

Documents / Resources

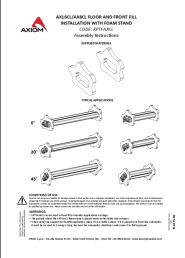
	<p>AXIOM AX16CL Floor and Front Fill Installation with foam Stand [pdf] Instruction Manual AX16CL Floor and Front Fill Installation with foam Stand, AX16CL, Floor and Front Fill Installati on with foam Stand, Fill Installation with foam Stand, foam Stand</p>
---	--

References

-  [Axiom Pro Audio](http://www.axiomproaudio.com)