

**AVIGILON
SYS-8ENT-
DVE2 Core
Series Smart
Hub**



AVIGILON SYS-8ENT-DVE2 Core Series Smart Hub User Guide

[Home](#) » [aVIGILON](#) » AVIGILON SYS-8ENT-DVE2 Core Series Smart Hub User Guide 

Contents

- [1 AVIGILON SYS-8ENT-DVE2 Core Series Smart Hub](#)
- [2 Product Usage Instructions](#)
- [3 FAQ](#)
- [4 What's Included](#)
- [5 Overview](#)
- [6 Mounting](#)
- [7 Installing](#)
- [8 Wiring](#)
- [9 Connecting Locks or Strikes](#)
- [10 Powering](#)
- [11 Provisioning](#)
- [12 FCC Statement](#)
- [13 Documents / Resources](#)
 - [13.1 References](#)

AVIGILON

AVIGILON SYS-8ENT-DVE2 Core Series Smart Hub



Specifications:

- Model: SYS-8ENT-DVE2
- Certifications: CE, IC, FCC, NOM, UL294

Product Usage Instructions

1. Mounting:

1. Open the enclosure.
2. Hang the enclosure onto the two fasteners and tighten them to the wall. Use additional fasteners to secure the middle and bottom of the enclosure.

2. Installing:

1. Install the expansion board into the enclosure using the included standoffs.
2. Install the Access Control Core below the expansion board using the included bracket. Secure the bracket directly to the enclosure.

3. Wiring:

Warning: Do not apply power during wiring. Ensure the Smart Hub is unplugged until all wiring is complete.

1. Connect the Access Control Core to the Expansion Board with the included USB cable.
2. Connect the Access Control Core to an Ethernet cable with Internet access.

3. Connect the Access Control Core and the Expansion Board to the power supply using the included power cables.

4. Connecting Avigilon or Wiegand Readers:

*LED and BZR connections are not supported.

5. Connecting Locks or Strikes:

Wiring a fail-safe lock or strike will unlock when power is out. Fail-secure will remain locked when power is out.

6. Powering:

Warning: Do not attempt to wire connections within the Smart Hub while power is enabled.

1. For installations in Europe or that require a 220VAC power source, cut the jumper on the power supply module.
2. Plug the power cord into a 110VAC or 220VAC power source.

7. Provisioning:

1. Ensure you have an Avigilon Alta Control Center user account.
2. Follow the steps in Alta Control Center to create an organization and add devices.
3. Use the Avigilon Alta Access app to connect devices to an organization.

FAQ

Q: Can I use LED and BZR connections with this product?

A: No, LED and BZR connections are not supported for this product.

What's Included

8-Door Smart Hub enclosure



Access Control Core



Standoffs



Mounting template



Bracket and push-in fasteners



Power cable



Spade lugs (optional)



8-Port Expansion Board



USB cable



Overview

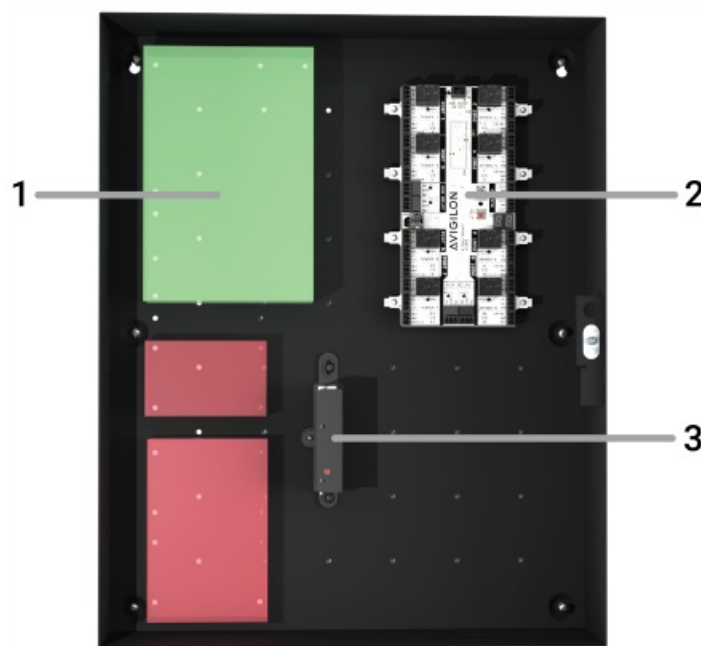

1. Power Supply
2. Expansion Board
3. Access Control Core

Mounting

1. Use the included paper template to mark and pre-drill the location for the enclosure. Install 2 fasteners (not

included) leaving the heads ¼ inch out from the wall.

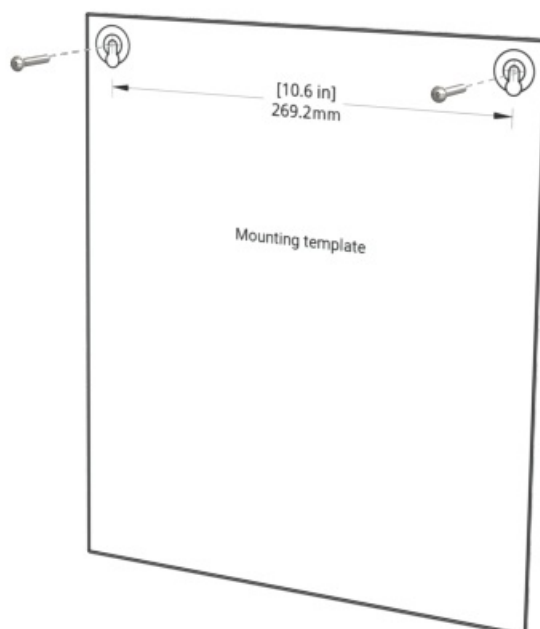

2. Hang the enclosure onto the two fasteners and tighten the fasteners to the wall. Use four additional fasteners (not included) to secure the middle and bottom of the enclosure to the wall.

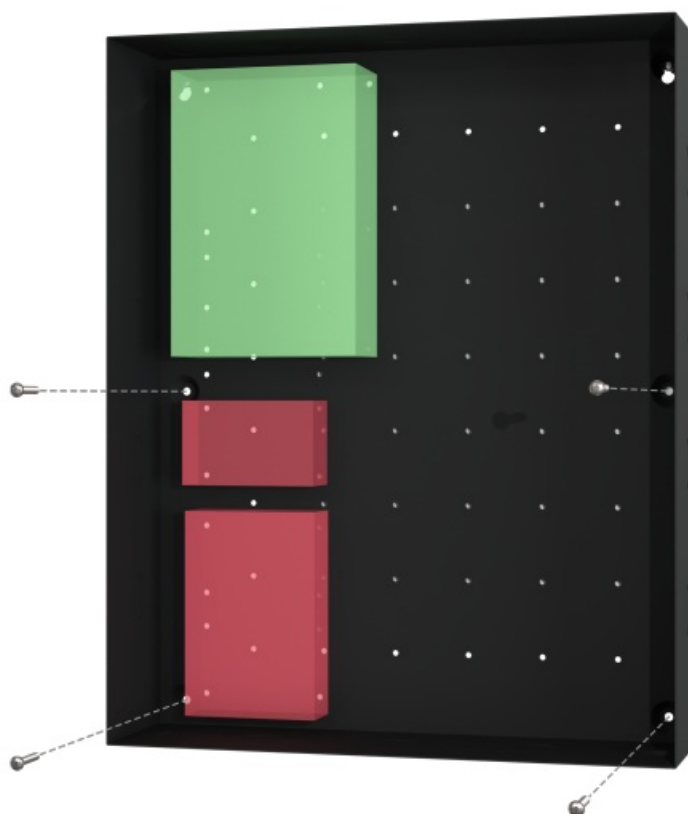

Installing

1. Open the enclosure.



2. Install the expansion board into the enclosure using the included standoffs (Quantity: 8).

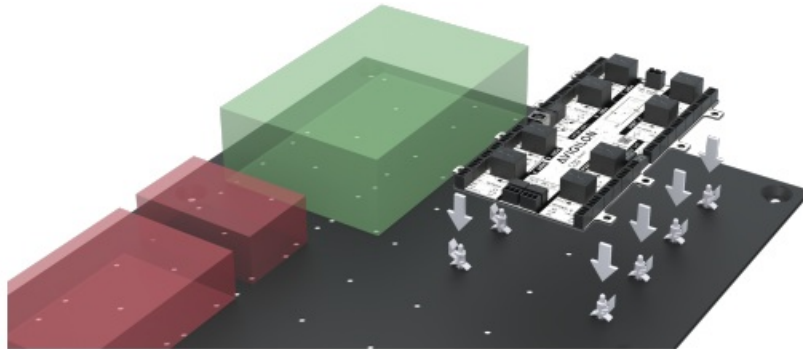

3. Install the Access Control Core below the expansion board using the included bracket. Unscrew the retaining screw (a), slide the Access Control Core into the bracket, and then tighten (a) to the bracket. Use the included washers (b) and fasteners (c) to secure the bracket directly to the enclosure.

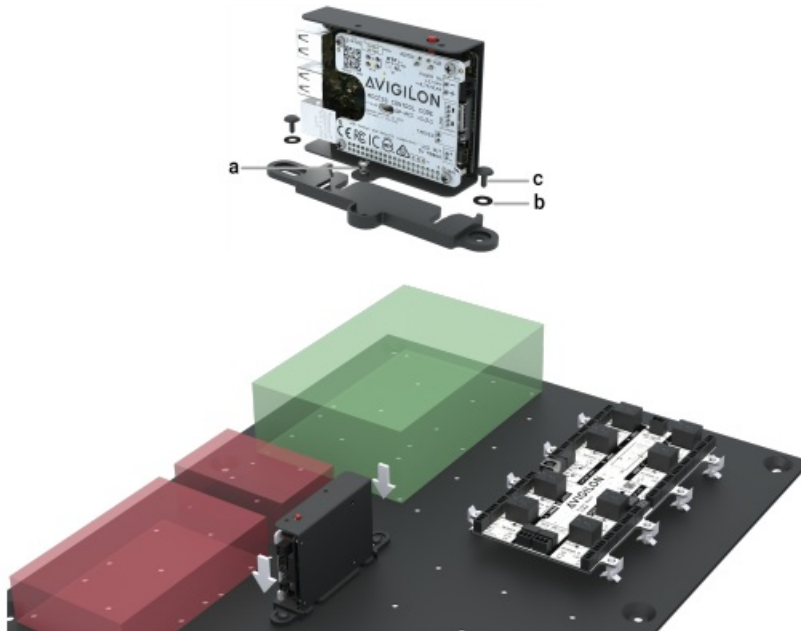

Wiring

Warning: Do not apply power during wiring. Ensure the Smart Hub is unplugged until all wiring is complete.

1. Connect the Access Control Core to the Expansion Board with the included USB cable (see 1 below).
2. Connect the Access Control Core to an Ethernet cable with Internet access (see 2 below).
3. Connect the Access Control Core and the Expansion Board to the power supply using the included power

cables (see 3 below).

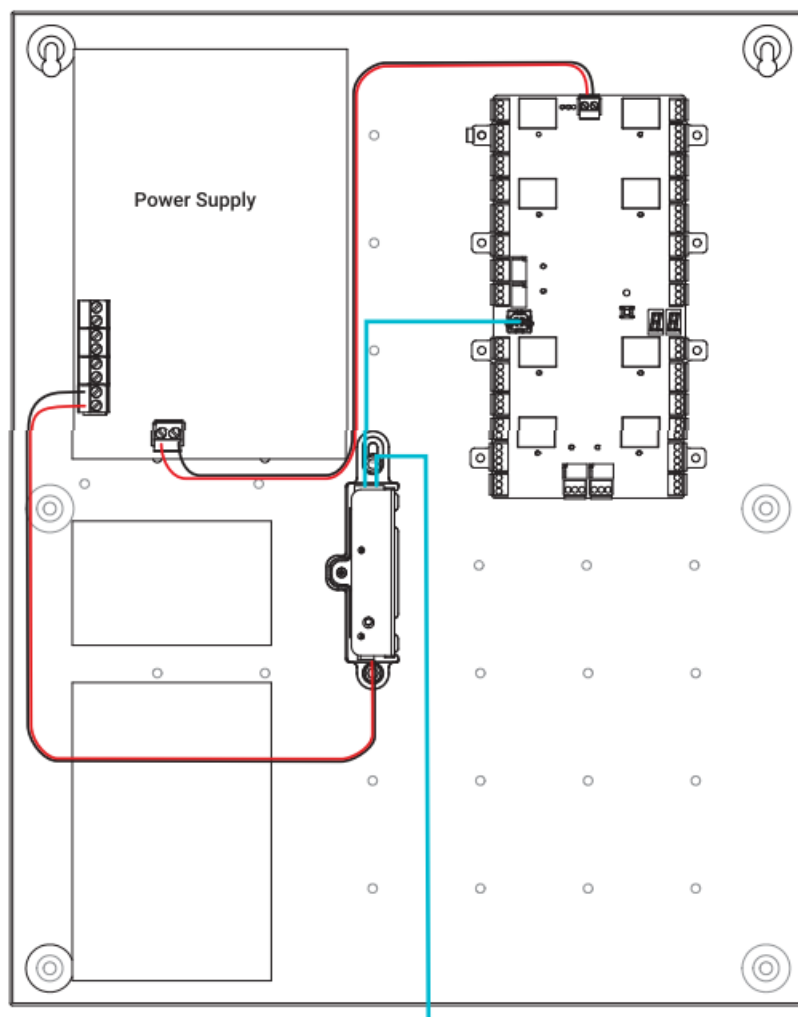

Connecting Avigilon or Wiegand Readers

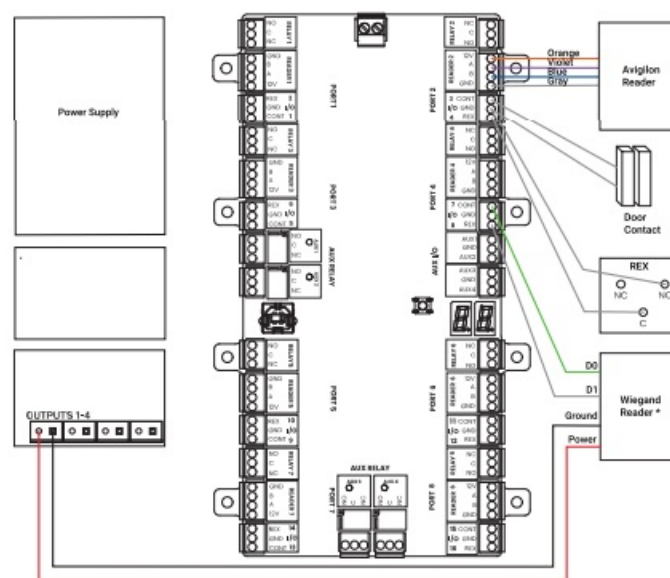

Connecting Locks or Strikes

Wiring a fail-safe lock or strike will unlock when power is out. Fail-secure will remain locked when power is out

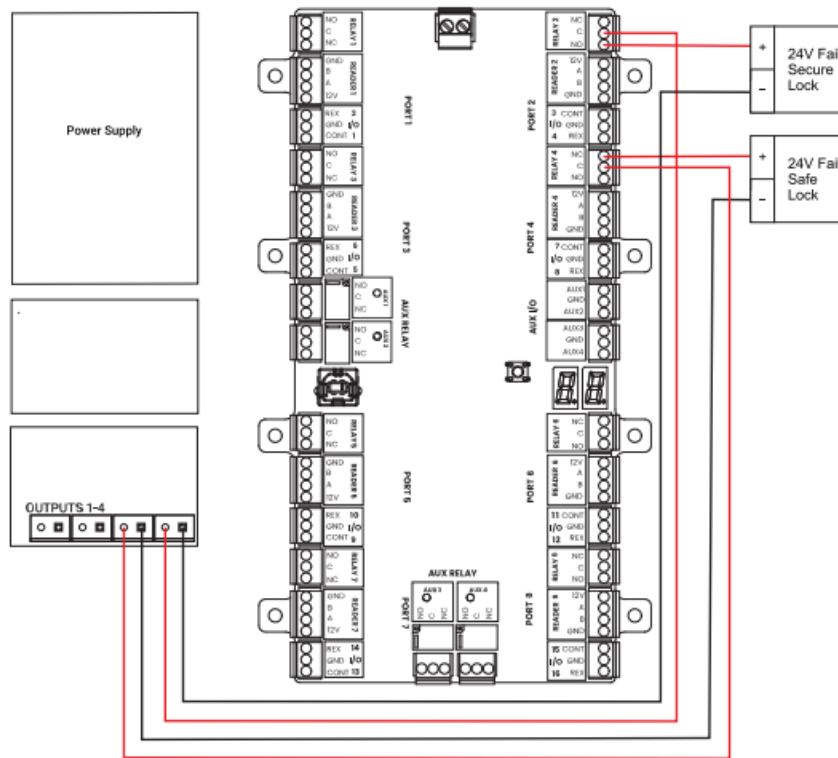

Powering

Warning: Do not attempt to wire connections within the Smart Hub while power is enabled.

1. For installations in Europe or that require a 220VAC power source, cut the jumper on the power supply module.

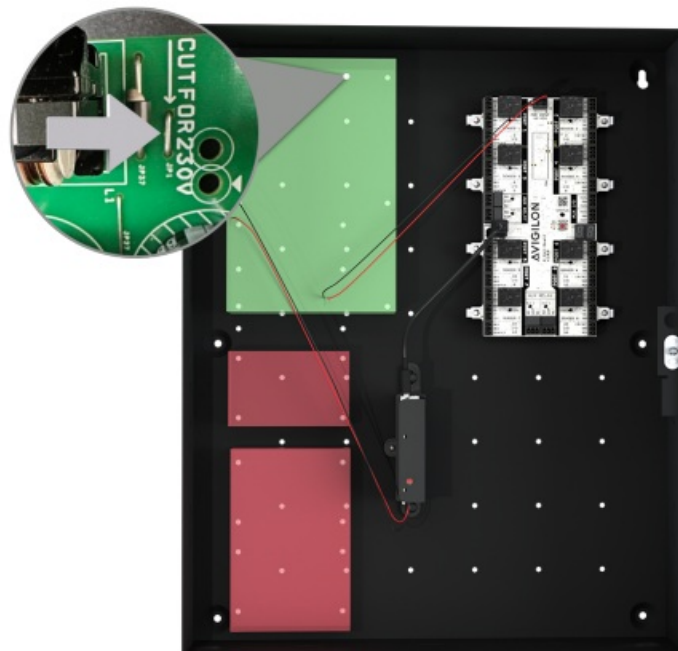

2. Plug the power cord into a 110VAC or 220VAC power source.



Example: North American power cord and outlet

Provisioning

1. Before you start, you'll need an Avigilon Alta Control Center user account. To create and register for an account, visit: control.openpath.com/login control.eu.openpath.com/login
2. Follow the steps in Alta Control Center to create an organization and add devices.
3. To connect devices to an organization, use the Avigilon Alta Access app.



4. In the app, tap Devices at the bottom.
5. Tap Scan for Devices or + the button, and follow the instructions.

App Store® and the Apple logo® are trademarks of Apple Inc. Google Play and the Google Play logo are trademarks of Google LLC.

Certifications

CE, IC, FCC, NOM, UL294

	BE	BG	CZ	DK	DE	EE	IE	EL	ES	FR	HR	IT	CY	LV
	LT	LU	HU	MT	NL	AT	PL	PT	RO	SI	SK	FI	SE	

FCC Statement

Any changes or modifications not expressly approved by the party responsible for compliance could void your authority to operate the equipment.

This device complies with Part 15 of the FCC Rules. Operation is subject to the following two conditions:

1. This device may not cause interference; and
2. This device must accept any interference, including interference that may cause undesired operation of the device.

Note: This equipment has been tested and found to comply with the limits for a Class A digital device, pursuant to Part 15 of the FCC Rules. These limits are designed to provide reasonable protection against harmful interference when the equipment is operated in a commercial environment. This equipment generates, uses, and can radiate radio frequency energy, and if it is not installed and used in accordance with the instruction manual, it may cause harmful interference to radio communications. Operation of this equipment in a residential area is likely to cause harmful interference, in which case the user will be required to correct the interference at his own expense. This equipment complies with FCC RF radiation exposure limits set forth for an uncontrolled environment. This equipment should be installed and operated with minimum distance of 20 centimeters between the radiator and your body. Industry Canada Notice and Marking This device complies with the ICSED radiation exposure limit set forth for an uncontrolled environment. This device should be installed and operated with a minimum distance 20cm between the radiator & your body. This transmitter must not be co-located or operating in conjunction with any other antenna or transmitter.

This device contains license-exempt transmitter(s) that comply with Innovation, Science and Economic Development Canada's license-exempt

RSS(s). Operation is subject to the following two conditions:

- 1. this device may not cause interference, and
- 2. this device must accept any interference, including interference that may cause undesired operation of the device.

For More Information

Scan the following QR codes

SYS-8ENT-DVE2



Video Library



QuickStartGuidesSys8EntDve2-Rev3

© 2024, Avigilon Corporation. All rights reserved. AVIGILON, the AVIGILON logos and AVIGILON ALTA are trademarks or registered trademarks of Avigilon Corporation. All other trademarks are the property of their respective owners. Unless stated explicitly and in writing, no license is granted with respect to any copyright, industrial design, trademark, patent or other intellectual property rights of Avigilon Corporation or its licensors

Documents / Resources

	AVIGILON SYS-8ENT-DVE2 Core Series Smart Hub [pdf] User Guide SYS-8ENT-DVE2 Core Series Smart Hub, SYS-8ENT-DVE2, Core Series Smart Hub, Series Smart Hub, Smart Hub, Hub
--	--

References

- [▲ Avigilon Alta Control Center](#)
- [▲ Avigilon Alta Control Center](#)
- [User Manual](#)

[Manuals+](#), [Privacy Policy](#)

This website is an independent publication and is neither affiliated with nor endorsed by any of the trademark owners. The "Bluetooth®" word mark and logos are registered trademarks owned by Bluetooth SIG, Inc. The "Wi-Fi®" word mark and logos are registered trademarks owned by the Wi-Fi Alliance. Any use of these marks on this website does not imply any affiliation with or endorsement.