



AVIDE ATHENS POST LAMP SERIES User Manual

[Home](#) » [Avide](#) » AVIDE ATHENS POST LAMP SERIES User Manual 

AVIDE ATHENS POST LAMP SERIES
User Manual

ATHEN POST LAMP SERIES

avide 

USER MANUAL

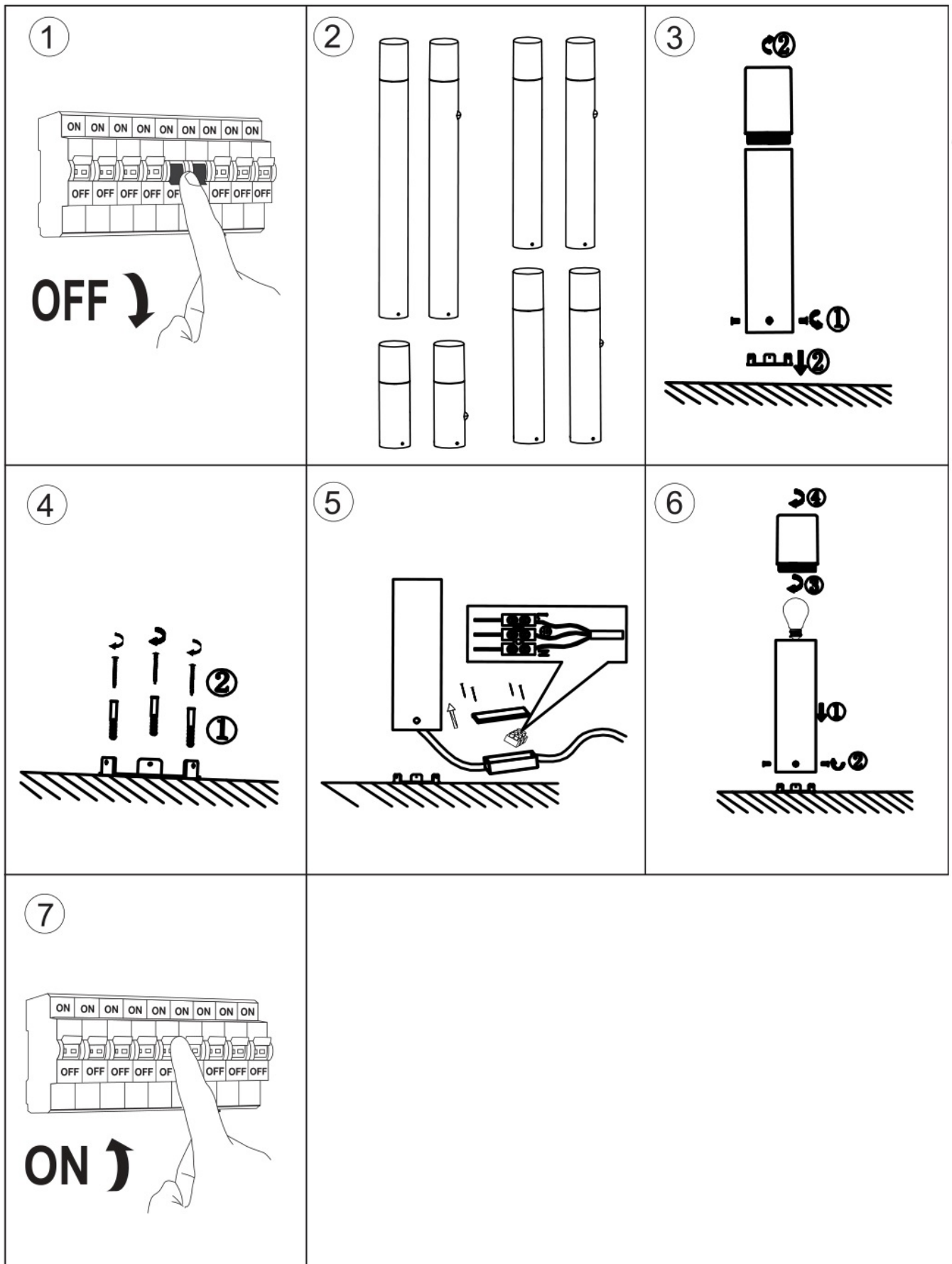

Safety instructions

- Before starting installation work, make sure to disconnect the power, or the power cable from the main.
- The assembly, installation and maintenance of electrical installations may only be performed by qualified person.

- When drilling the holes for the installation, make sure the pipes and wires in the wall are not damaged.
- Damaged products are not allowed to put into operation! There is a risk of electric shock!
- In case of any damage, disconnect the product from the main – immediately.
- Maintenance and repairs must be performed by a qualified person, otherwise the warranty expires.
- The lamp is only approved for its intended use. Technical changes are not allowed.
- Lamps may not be covered! RISK OF FIRE!
- The minimum distance of the lamp to the illuminated surface is $\geq 0.5\text{m}$
- The lamps and accessories contain small parts. Keep them away from children.
- The manufacturer assumes no liability for damages incurred as a result of improper use.
- Power off the luminaire before cleaning! Use a slightly moistened cloth to clean the outer surface of the luminaire.

Do not use any aggressive cleaners. Avoid getting water inside the product and on the electric components!



Class I:

All devices with ground connection must be connected to the protective conductor. (yellow-green wire)



Waste equipment must not be collected separately or disposed of with household waste because it may contain components hazardous to the environment or health. Used or waste equipment may be dropped off free of charge at the point of sale, or at any distributor which sells equipment of identical nature and function. Dispose of product at a facility specializing in the collection of electronic waste. By doing so, you will protect the environment as well as the health of others and yourself. If you have any questions, contact the local waste management organization. We shall undertake the tasks pertinent to the manufacturer as prescribed in the relevant regulations and shall bear any associated costs arising.

For technical or warranty support, please contact the authorised representative:

Bramcke GmbH
 52353 Düren
 An Gut Nazareth 18A
 Germany
www.bramcke.de



Contents

- 1 Documents / Resources
 - 1.1 References
- 2 Related Posts

Documents / Resources

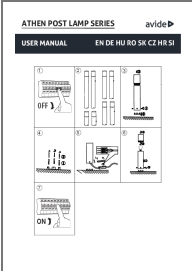
	<p>AVIDE ATHENS POST LAMP SERIES [pdf] User Manual</p> <p>ATHENS POST LAMP SERIES, ATHENS POST LAMP, POST LAMP, LAMP</p>
-----------------------------------------------------------------------------------	------------------------------------------------------------------------------------------------------------------------------------------

References

- [B Bramcke](#)