

Avid Power ACAP115D-O 20-V AUTOMATIC CORDLESS INFLATOR



Avid Power ACAP115D-O 20-V AUTOMATIC CORDLESS INFLATOR User Manual

[Home](#) » [Avid Power](#) » Avid Power ACAP115D-O 20-V AUTOMATIC CORDLESS INFLATOR User Manual 

Contents

- [1 Avid Power ACAP115D-O 20-V AUTOMATIC CORDLESS INFLATOR](#)
- [2 IMPORTANT SAFETY INSTRUCTIONS](#)
- [3 SAFETY PRECAUTIONS FOR INFLATOR](#)
- [4 SPECIFICATIONS](#)
- [5 INCLUDE](#)
- [6 FUNCTION](#)
- [7 OPERATION](#)
- [8 HOW TO USE](#)
- [9 MAINTENANCE](#)
- [10 PARTS LIST AND SCHEMATIC DRAWING](#)
- [11 FAQs](#)
- [12 Video-Avid Power ACAP115D-O 20-V AUTOMATIC CORDLESS INFLATOR](#)
- [13 References](#)
- [14 Related Posts](#)



Avid Power ACAP115D-O 20-V AUTOMATIC CORDLESS INFLATOR



IMPORTANT SAFETY INSTRUCTIONS

READ AND UNDERSTAND ALL INSTRUCTIONS. Failure to follow all instructions listed below may result in electric shock, fire, and/or serious personal injury.

When using electric appliances, basic precautions should always be followed, including the following.

WORK AREA

1. Keep your work area clean and well-lit. Cluttered benches and dark areas invite accidents. Keep bystanders, children, and visitors away while operating an inflator. Distractions can cause you to lose control.
2. Operate the inflator in an open area at least 18 in. away from any wall or object that could restrict the flow of fresh air to ventilation openings.

ELECTRICAL SAFETY

1. To reduce the risk of electrical shock, do not put the inflator in water or other liquid. Do not place or store appliances where it can fall or be pulled into a tub or sink.
2. Use this product only with batteries and chargers.

PERSONAL SAFETY

1. Stay alert, watch what you are doing and use common sense when operating an inflator. Do not use inflator while tired or under the influence of drugs, alcohol, or medication. A moment of inattention while operating inflator may result in serious personal injury.
2. Dress properly. Do not wear loose clothing or jewelry. Contain long hair. Keep your hair, clothing, and gloves away from moving parts. Loose clothes, jewelry, or long hair can be caught in moving parts.
3. Do not overreach. Keep proper footing and balance at all times. Proper footing and balance enable better control of the inflator in unexpected situations.
4. Use safety equipment. Always wear eye protection. Dust mask, non-skid safety shoes, hard hat, or hearing protection must be used for appropriate conditions.
5. Eye protection is required to guard against flying fasteners and debris which could cause severe eye injury.
6. Do not wear loose clothing or jewelry. Contain long hair. Loose clothes, jewelry, or long hair can be drawn into air vents.
7. Do not use on a ladder or unstable support. Stable footing on a solid surface enables better control of the inflator in unexpected situations.
8. Do not disassemble the inflator.
9. Do not operate inflator near flammable liquids or in gaseous or explosive atmospheres. Internal sparks may ignite fumes.
10. Do not store your inflator in a damp or wet location. Do not store in locations where the temperature is less than 50°F or more than 100°F.

INFLATOR USE AND CARE

1. Check hoses for weak or worn condition before each use, making certain all connections are secure. Do not use if defect is found.
2. Release all pressures within the system slowly. Dust and debris may be harmful.
3. Do not use inflator if switch does not turn it on or off. An inflator that cannot be controlled with the switch is dangerous and must be repaired.
4. Turn off the machine before making any adjustments, changing accessories, or storing the inflator. Such preventive safety measures reduce the risk of starting the inflator accidentally.
5. Store idle inflators out of reach of children and other untrained persons. Inflators are dangerous in the hands of untrained users.
6. Check for misalignment or binding of moving parts, breakage of parts, and any other condition that may affect the inflator's operation. If damaged, have the inflator serviced before using. Many accidents are caused by poorly maintained tools.
7. Use only accessories that are recommended by the manufacturer for your model. Accessories that may be suitable for one inflator may create a risk of injury when used on another inflator.
8. Keep the inflator and its handle dry, clean and free from oil and grease. Always use a clean cloth when cleaning. Never use brake fluids, gasoline, petroleum-based products, or any strong solvents to clean your inflator. Following this rule will reduce the risk of loss of control and deterioration of the enclosure plastic.
9. Never point any inflator toward yourself or others.
10. Keep the exterior of the inflator dry, clean, and free from oil and grease. Always use a clean cloth when cleaning. Never use brake fluids, gasoline, petroleum-based products, or any strong solvents to clean the unit.

Following this rule will reduce the risk of deterioration of the enclosure plastic.

11. Do not exceed the pressure rating of any component in the system.
12. Protect material lines and air lines from damage or puncture. Keep hose and power cord away from sharp objects, chemical spills, oil, solvents, and wet floors.

SERVICE

1. Inflator service must be performed only by qualified repair personnel. Service or maintenance performed by unqualified personnel may result in a risk of injury.
2. When servicing an inflator, use only identical replacement parts. Follow instructions in the Maintenance section of this manual. Use of unauthorized parts or failure to follow Maintenance instructions may create a risk of shock or injury.

SAFETY PRECAUTIONS FOR INFLATOR

1. Know your inflator. Read operator's manual carefully. Learn its applications and limitations, as well as the specific potential hazards related to this tool. Following this rule will reduce the risk of electric shock, fire, or serious injury.
2. Risk of bursting. Do not operate inflator to result in output pressure greater than marked maximum pressure of item to be inflated. Do not use at pressure greater than 6.8 Bar.
3. To reduce the risk of electric shock, do not expose to rain. Store indoors.
4. Inspect unit for cracks, pin holes, or other imperfections that could cause inflator to become unsafe. Never cut or drill holes in the inflator.
5. Make sure the hose is free of obstructions or snags. Entangled or snarled hoses can cause loss of balance or footing and may become damaged.
6. Use the inflator only for its intended use. Do not alter or modify the unit from the original design or function.
7. Always be aware that misuse and improper handling of this inflator can cause injury to yourself and others.
8. Never leave an inflator unattended with the air hose attached to the item being inflated.
9. Do not continue to use an inflator or hose that leaks air or does not function properly.
10. Always disconnect the air supply and power supply before making adjustments, servicing an inflator, or when an inflator is not in use.
11. Do not attempt to pull or carry the inflator by the hoses.
12. Always follow all safety rules recommended by the manufacturer of your inflator, in addition to all safety rules for the inflator. Following those rules will reduce the risk of serious personal injury.
13. Household use only.
14. Do not use inflator as a breathing device.
15. Never direct a jet of compressed air toward people or animals. Take care not to blow dust and dirt towards yourself or others. Following this rule will reduce the risk of serious injury.
16. Protect your lungs. Wear a face or dust mask if the operation is dusty.
Following this rule will reduce the risk of serious personal injury.
17. Do not use this inflator to spray chemicals. Your lungs can be damaged by inhaling toxic fumes.
18. Check damaged parts. Before further use of the inflator or air tool, a guard or other part that is damaged should be carefully checked to determine that it will operate properly and perform its intended function. Check for alignment of moving parts, binding of moving parts, breakage of parts, mounting, and any other conditions that

may affect its operation. A guard or other part that is damaged should be properly repaired or replaced by an authorized service center. Following this rule will reduce the risk of shock, fire, or serious injury.

19. Inspect tool cords periodically and, if damaged, have repaired at your nearest Authorized Service Center.

Constantly stay aware of cord location. Following this rule will reduce the risk of electric shock or fire.

20. Risk of bursting. Carefully monitor objects during inflation.

21. To reduce the risk of over inflation, use a reliable pressure gauge periodically during inflation.

22. Never leave the inflator unattended during inflation.

23. Allow pump to cool for five (5) minutes after each five (5) minutes of continuous use. Never block the inflating or deflating outlets while operating.

24. Save these instructions. Refer to them frequently and use them to instruct others who may use this inflator. If you loan someone this inflator, loan them these instructions also.

SPECIFICATIONS

- Great for Car/RV/SUV Tires and small inflatables
- Digital pressure gauge automatically shuts off at desired pressure
- Cordless design for convenience
- Comes with nozzle accessories
- Operate from 20V Battery (included) or 12V Power Adapter
- Built in battery indicator

INCLUDE

- 1-Ball Nozzle, 1-Tire Valve Nozzle, 1-Air Bed Nozzle
- 1 – 12V Car Plug-in Power Base
- 1-20V Li-ion Battery
- 1-Charger
- 1-Tool Bag

FUNCTION

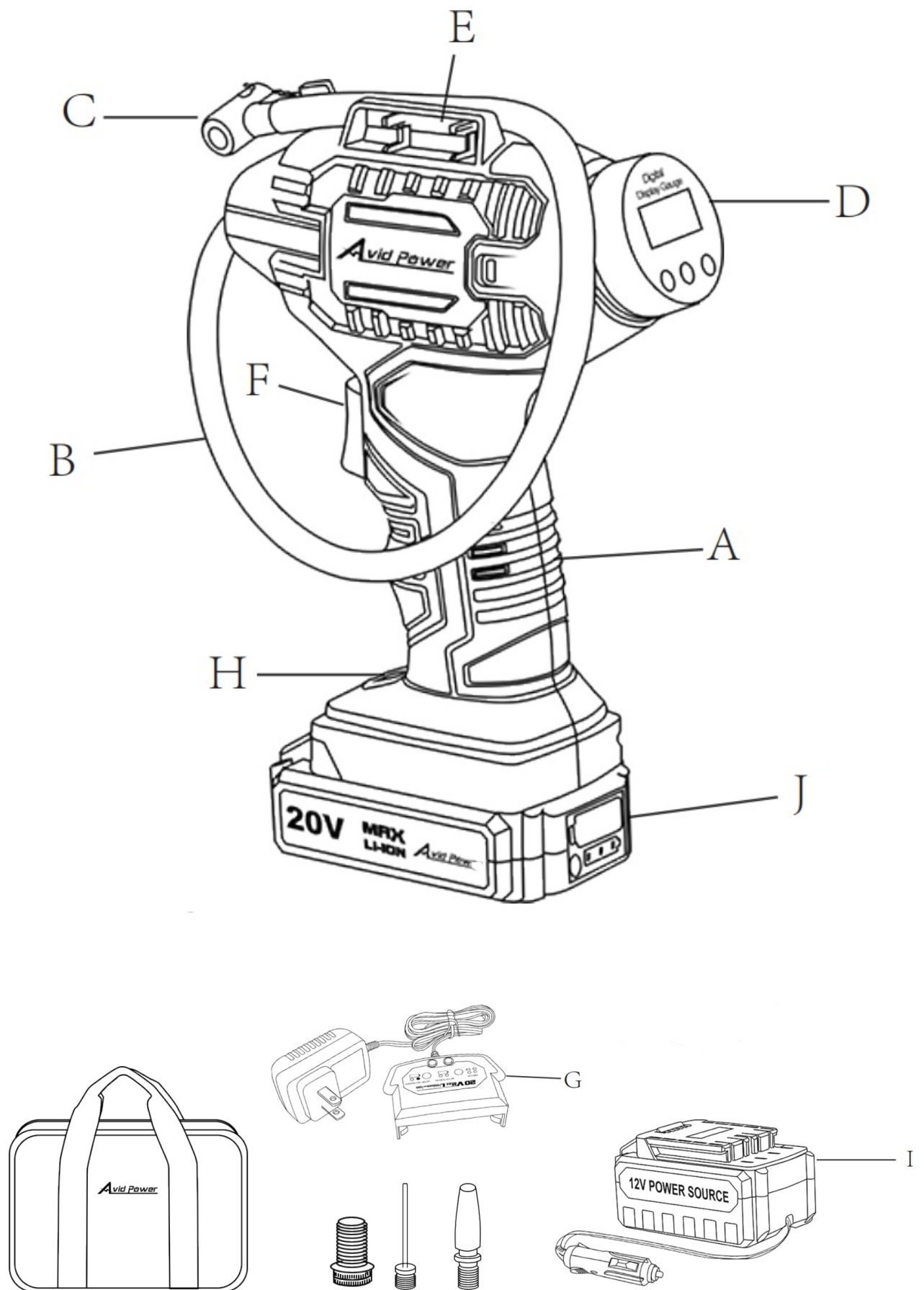

- A. Rubber-covered handle
- B. Air hose
- C. Air chuck
- D. Digital pressure gauge
- E. Hose storage area

- F. Start switch
- G. Charger
- H. LED-light
- I. 12V Power adapter
- J. USB Output Port

OPERATION

Battery Pack

1. The battery is not fully charged. You'd better let it charge for 3-5 hours before the first use. Normal charging time is 3-5 hours when the battery is completely dead.

WARNING

2. Replace a new battery when tool performance begins to diminish; Severe heat is most destructive to a battery; The more heat it generates, the faster the battery loses power. A battery that gets too hot can have a shortened life.
3. Never over-discharge a battery when using the tool even after tool performance has decreased. When tool performance begins to diminish, please stop letting the tool work and recharge the battery for optimal performance.

How to charge the battery pack?

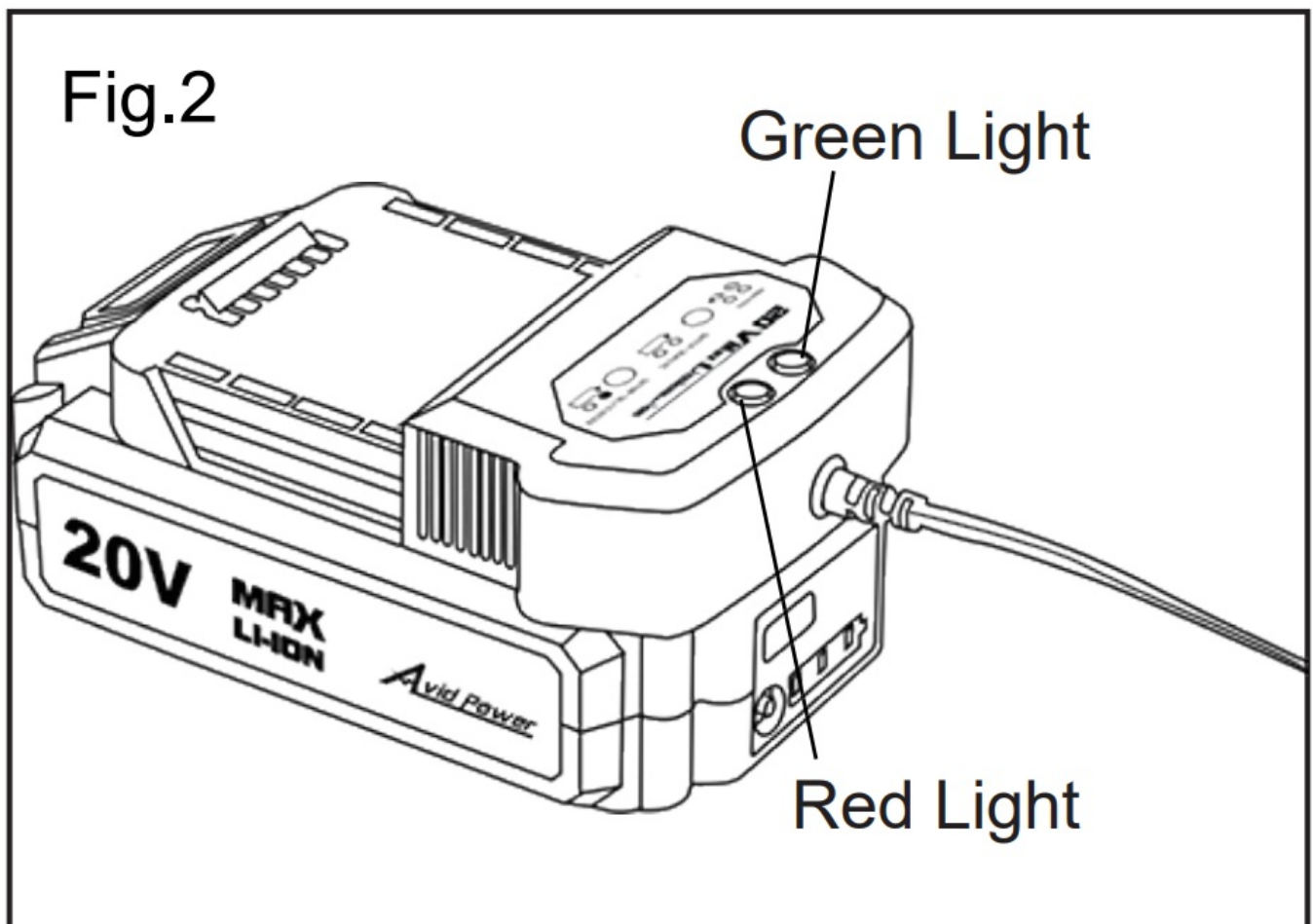

- **Green light:** power indicator. When the charger is connected to AC household current, the green light is on.

- **Red light:** charging indicator. When the battery is properly inserted into the charger and charging, the red light is on.
- **How do you know if the battery is fully charged ?**
Normal charging time is 3 to 5 hours when the battery is completely dead. The red light will turn off and the green light remains lit once the battery is fully charged.
- After the charging is completed, remove the battery pack from the charging stand immediately. When charging more than one battery pack, allow 15 minutes between charges.
- After many charge/discharge cycles, your battery may lose its ability to hold a charge. If so, please replace it. Dispose of batteries at an appropriate waste disposal facility. Do not throw batteries away in common trash receptacles.

USB OUTPUT FOR OTHER DEVICES CHARGING

1. Plug the USB cable into the USB Output Port (A) on the battery pack (Fig.3)
2. Press the button (B) for charging (Fig.4)

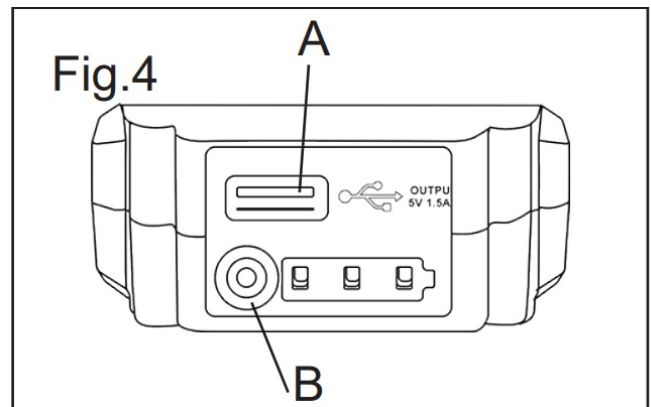
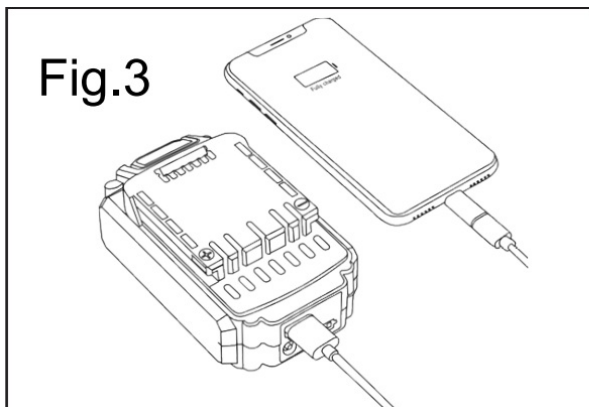

3. Press the button (B) to display the battery level.(Fig.4). Three lights on the battery indicate a full charge. Two lights show 50% of the power while one light shows 25%.

NOTE: please remove the charger from the battery before checking the battery level.

HOW TO USE

Step 1: Install Battery Pack or 12 Car Power Adapter

Install or remove battery pack(Fig.5)

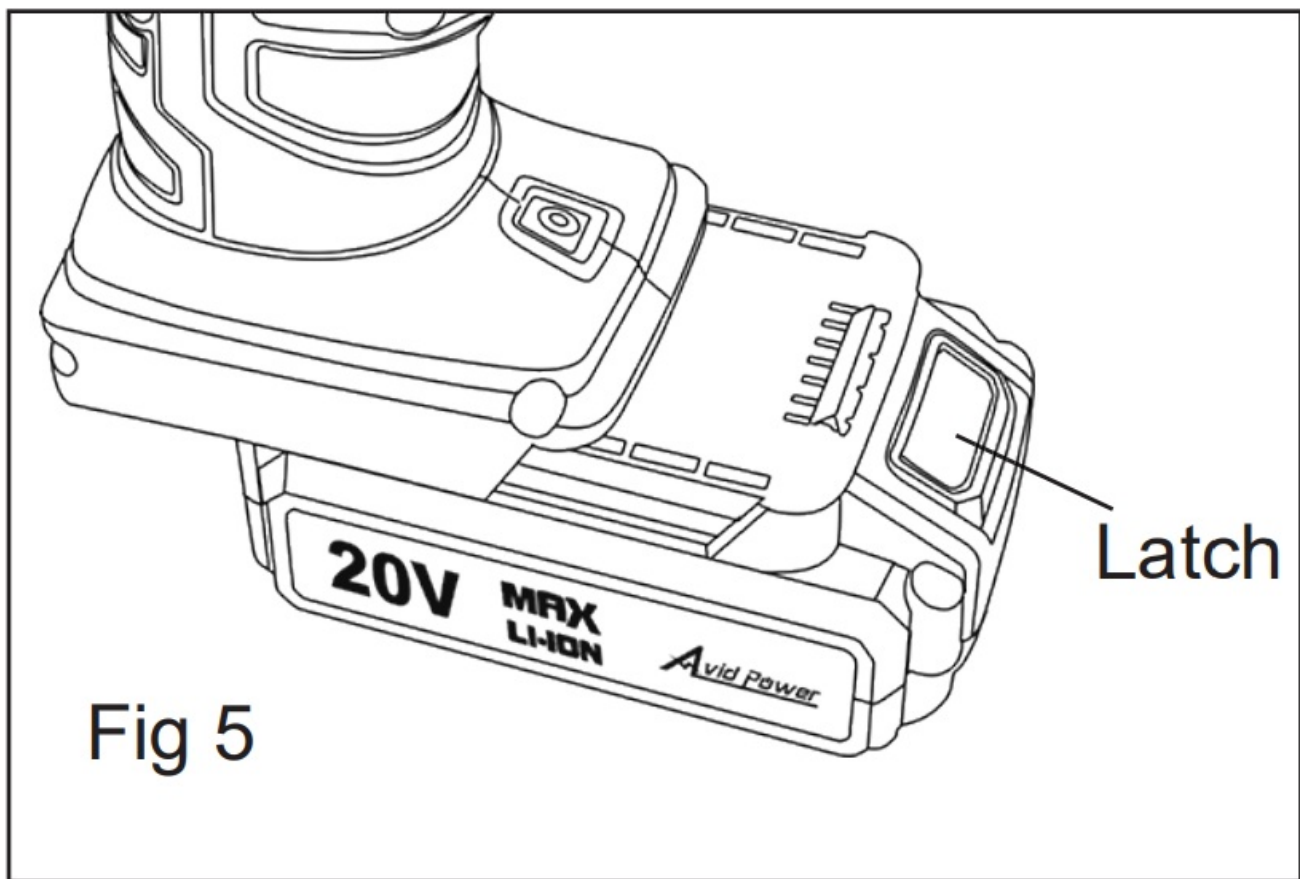

- **To install:** slide the battery pack into the bottom of the tool until you hear a click. Make sure that the latch is in place and battery is secure before operation.
- **To remove:** Press the battery release latch and pull the battery pack out at the same time.

Install or remove 12V car power adapter (Fig.6)

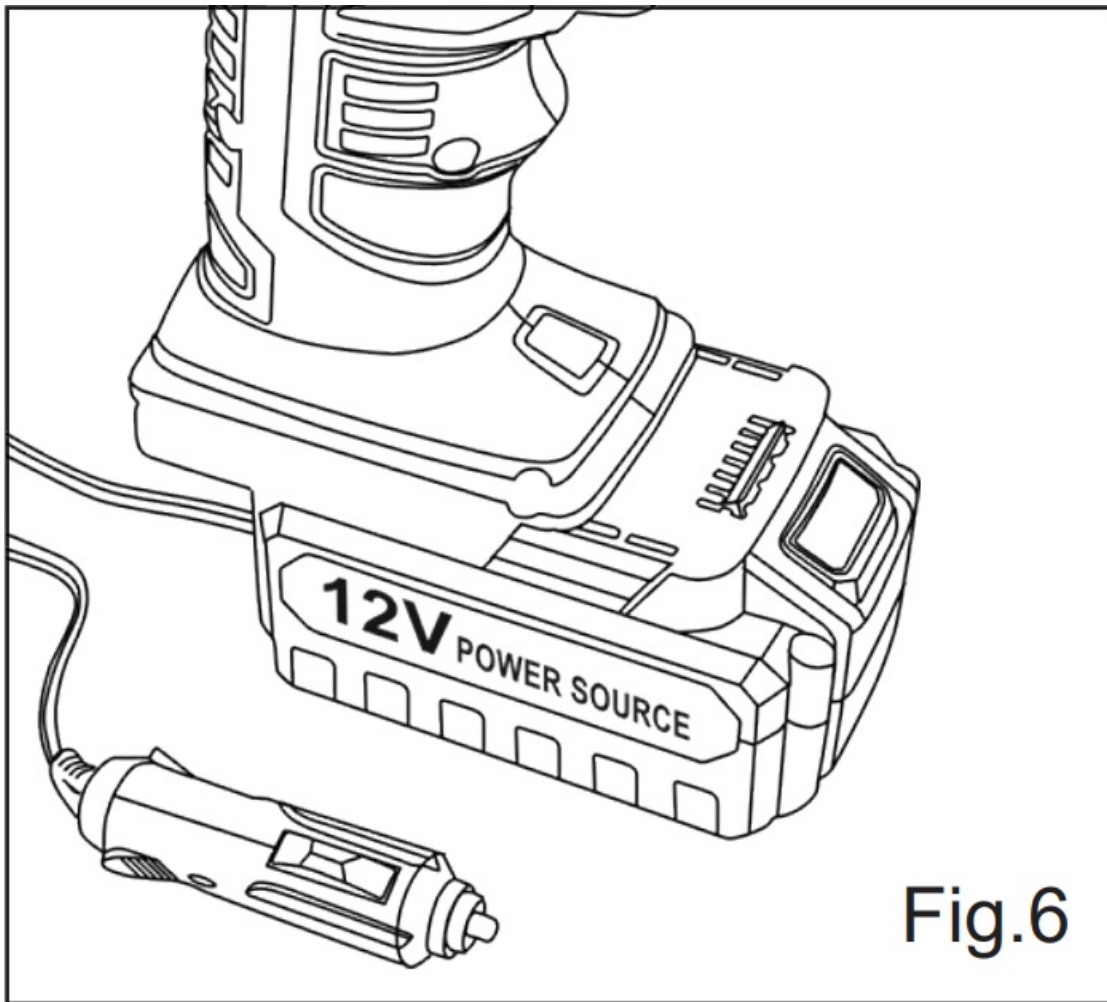
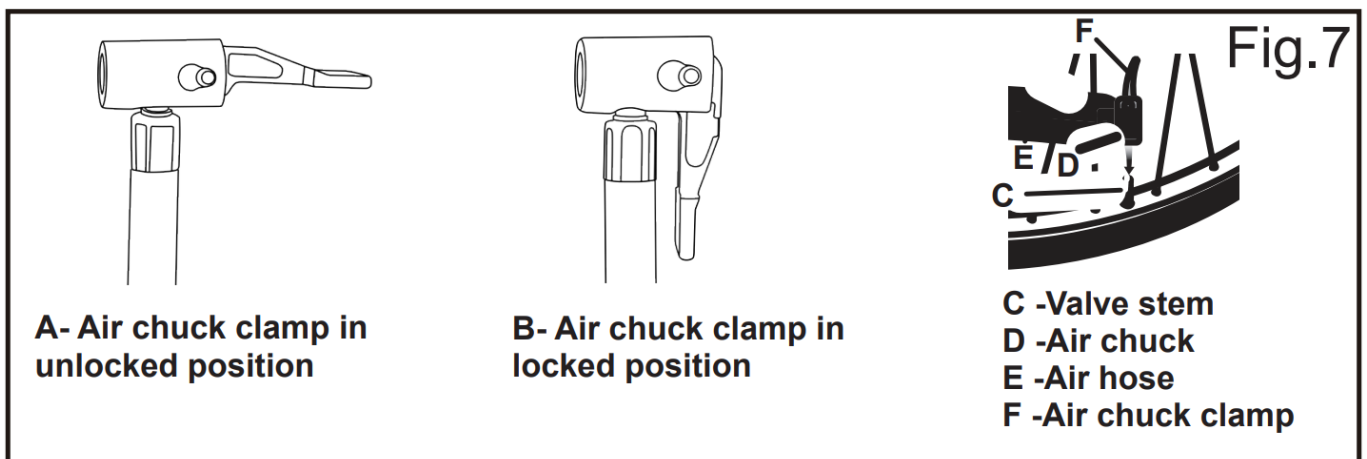

Fig.6

1. Unravel cord before use. If the battery is installed, remove it from the machine first by pressing battery release button and pulling out.
2. Slide the 12V Car Power Adapter into the machine until you hear a click.
3. Connect the adapter into the car socket. When ready to use, power car on. Always operate vehicle outdoors.

NOTE: Be sure the cord runs through the hole at the base of the pack.

Step 2: Connect the Air Chuck to the Valve Stem (Fig.7)



1. Push the air chuck clamp up so that it is in the unlock position.
2. Then place the air chuck on the valve stem and make sure the threaded section of the valve stem is inside the air chuck.

- Pressing air chuck clamp down until it stops or is parallel with the air hose.

NOTICE:

Improperly attached hoses or accessories can become detached under pressure and cause serious injury.
Possible air leaks can cause faulty pressure readings. Make sure all connections are tightly secured.

NOTE: Always leave the hose free of obstructions when the tool is not in use. Overheating could occur if the hose is blocked.

Step 3: Set the Pressure Value (Fig.8)

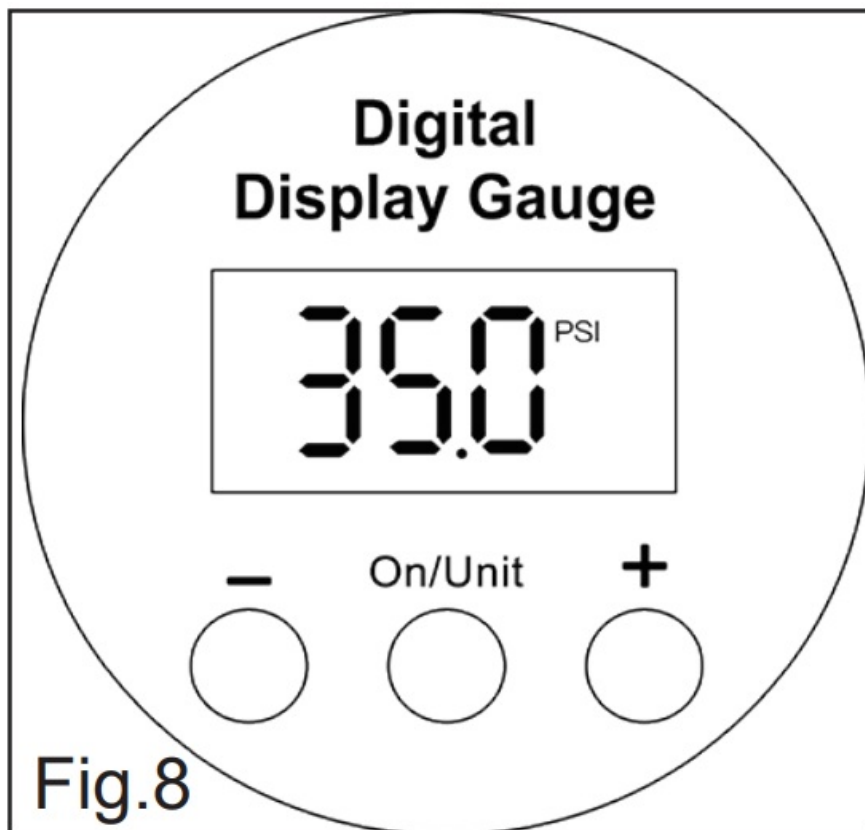

- Press "On/Unit" button to read the current tire pressure on the gauge.
- Press "On/Unit" button again to select tire pressure measurement unit from PSI, BAR, KPA, KG/CM.
- Press "+" or "-" button to adjust preset tire pressure.
 - Long press "+" or "-" button to adjust working pressure quickly.
 - Short press "+" or "-" button to adjust preset working pressure.

Note: increment by 0.05BAR & KG/ CM, 1 PSI, 5KPA

- Preset pressure value will be set after three seconds.
- Press Start switch to inflate. When it reaches the preset pressure value, the device will stop working.

Note: The inflator has a tolerance of + or – 2 PSI. For every 10 minutes of continuous use, 3 minutes of cool down time are required.

NOTE:

- To reset the tire pressure measurement unit, press "On/Unit" to reselect after setting preset pressure value.
- Digital gauge records the preset measurement unit and value of last time operation
- After the air pump reaches the preset pressure value, the digital gauge will go off after 60 seconds, and the

device will shut down automatically.

4. Maximum PSI for this unit is 100 PSI.

NOTE

1. Since the pressure gauge is not calibrated and not binding for exact values, tire pressure must be checked by using a reliable measuring device after inflating tires with this pump. Driving a vehicle with improperly inflated tires could result in serious injury.
2. Do not leave items that being pumped up unattended while using the inflator. These items can burst and could cause serious injury.
3. The inflator is capable of inflating up to 6.8 Bar. To avoid over inflation, carefully follow instructions on items to be inflated. To avoid product damage, never exceed recommended pressures.
4. The inflator is not designed for commercial applications.

AIR HOSE AND ACCESSORIES STORAGE

When the inflator is not in use, put the hose into the storage area on top of the tool. The adaptors and needles provided with the inflator can also be placed in the storage area of the tool.

LED WORKING LIGHT

When working, the LED light on the base of the tool is on, which is good for nightwork.

START SWITCH

Press the start switch to start the inflator. Press the start switch again to shut off the inflator.

ACCESSORIES

The supplied accessories perform a variety of functions. The tapered adaptor can be used on smaller pinch valves to inflate small items like children's toys, which usually require the user to inflate them by blowing air into them. The sport ball needle can be used to inflate any type of sports ball or any other item that requires an inflation sport ball needle.

NOTE: When inflating items of 10 PSI or less, inflate in short bursts and check after each burst by feel or with a calibrated measuring device to determine accurate pressure.

Sport Balls Needle

How to Install Ball Needle?

For inflating sport balls like basketball, football, etc, the following pictures shows how to hoop up the nozzle to air chuck.

Note: Do not fully insert the ball needle into the air chuck to prevent the vent hole of needle from being completely blocked.

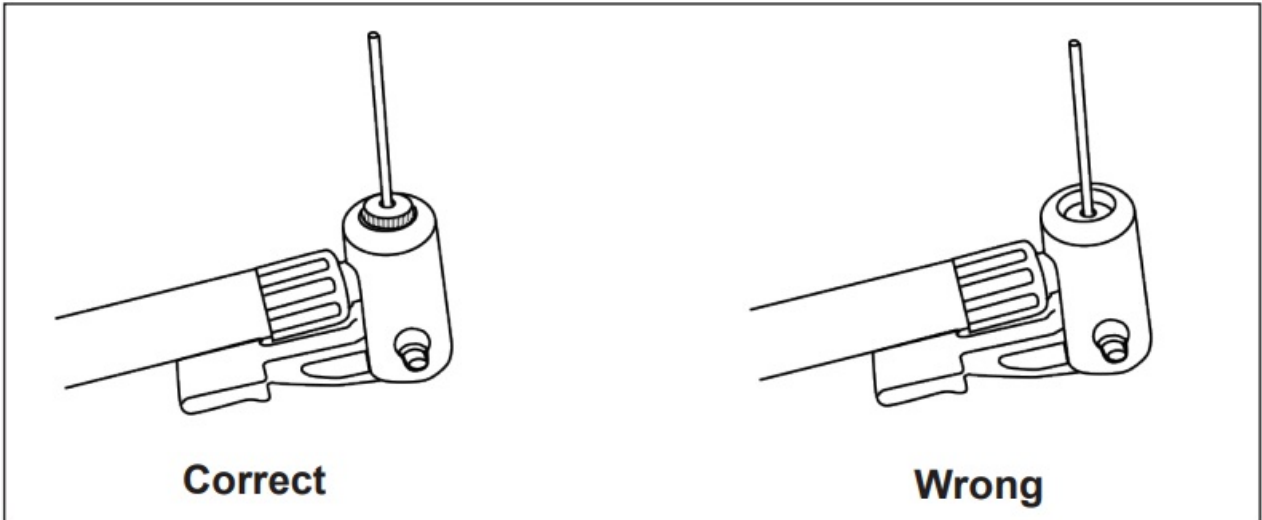
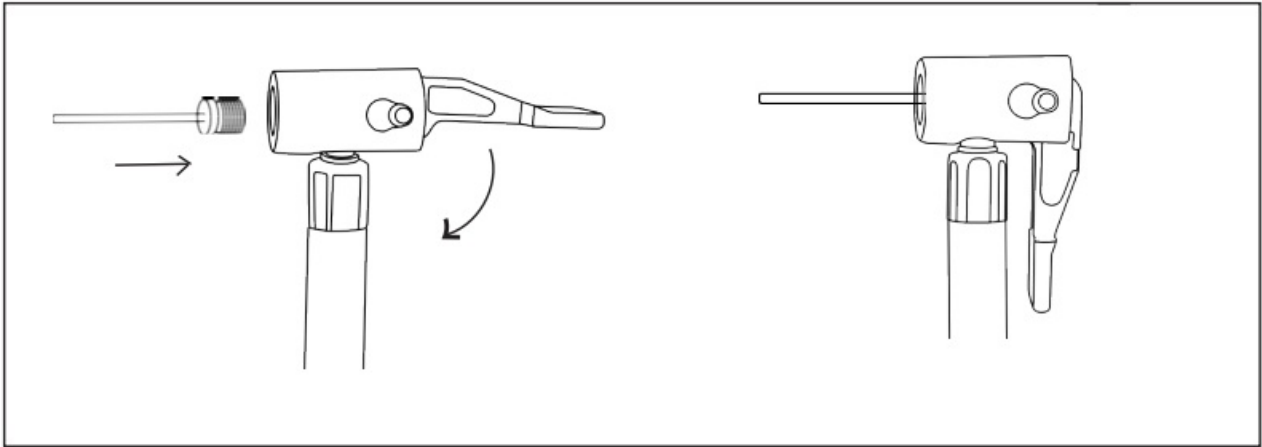

MAINTENANCE

1. Do not let brake fluids, gasoline, petroleum based products, penetrating oils, etc., come in contact with plastic parts. Chemicals can damage, weaken or destroy plastic which can result in serious personal injury.
2. Keep the tool clean by using a soft damp (not wet) cloth. Do not use solvents on the plastic parts.
3. Avoid using solvents when cleaning plastic parts. Most plastics are susceptible to damage from various types of commercial solvents and may be damaged by their use. Use clean cloths to remove dirt, dust, oil, grease, etc.
4. To maintain the best performance of your rechargeable battery, protect it from overheating, both from overcharging and during storage. Occasionally charge the battery for 7 hours.

PARTS LIST AND SCHEMATIC DRAWING

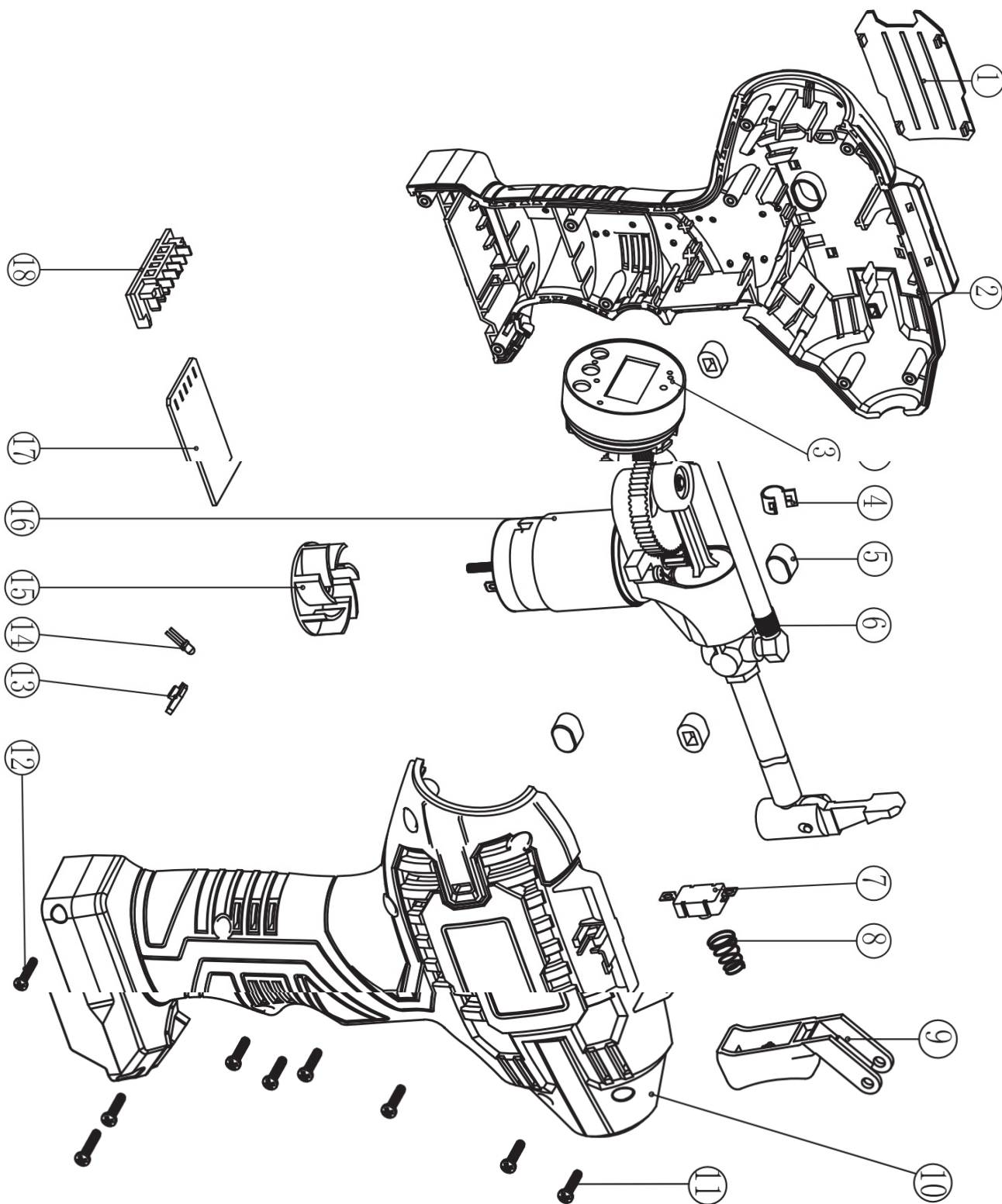

1. Absorber
2. Left Housing
3. Digital Gauge
4. Buckle
5. Absorber
6. Air Pump Assembly
7. Self-locked Switch
8. Torsional Spring
9. Trigger
10. Right Housing

11. Screw
12. Screw
13. Led Cover
14. Cylindrical Lamp
15. Fan
16. Motor
17. Control Board
18. Battery Clip Assembly

Any product/ return issues, please feel free to contact us directly via

E-mail: service@avidpowertool.com

(Mon. to Sun. Any time)

FAQs

What is the voltage of the Avid Power ACAP115D-O cordless inflator?

The Avid Power ACAP115D-O cordless inflator has a voltage of 20V.

What is the maximum air flow capacity of the Avid Power ACAP115D-O?

The Avid Power ACAP115D-O has an air flow capacity of 30 LPM (liters per minute).

What is the noise level of the Avid Power ACAP115D-O cordless inflator?

The Avid Power ACAP115D-O has a noise level of 65 dB (decibels).

What type of battery does the Avid Power ACAP115D-O use?

The Avid Power ACAP115D-O uses a rechargeable lithium-ion battery.

What is the weight of the Avid Power ACAP115D-O cordless inflator?

The Avid Power ACAP115D-O weighs 4 pounds.

What is the maximum pressure the Avid Power ACAP115D-O can reach?

The Avid Power ACAP115D-O can reach a maximum pressure of 150 PSI (pounds per square inch).

What type of power source does the Avid Power ACAP115D-O use?

The Avid Power ACAP115D-O is battery powered.

What type of power source does the Avid Power ACAP115D-O use?

The Avid Power ACAP115D-O is battery powered.

What accessories are included with the Avid Power ACAP115D-O?

The Avid Power ACAP115D-O includes a battery pack, DC adapter, battery charger, 3 nozzles, a user manual, and a tool bag.

What is the model number of the Avid Power ACAP115D-O cordless inflator?

The model number of the Avid Power cordless inflator is ACAP115D-O.

What is the maximum power output of the Avid Power ACAP115D-O?

The Avid Power ACAP115D-O has a maximum power output of 200 watts.

What is the hose length of the Avid Power ACAP115D-O cordless inflator?

The Avid Power ACAP115D-O has a hose length of 25 inches.

What type of display does the Avid Power ACAP115D-O have?

The Avid Power ACAP115D-O has a digital LCD display.

What is the recommended use for the Avid Power ACAP115D-O?

The Avid Power ACAP115D-O is recommended for tire inflation.

What special features does the Avid Power ACAP115D-O have?

The Avid Power ACAP115D-O has a handheld design and an automatic shut-off feature.

Video-Avid Power ACAP115D-O 20-V AUTOMATIC CORDLESS INFLATOR

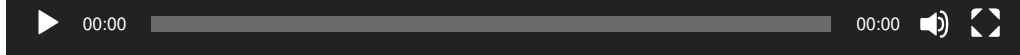

[Download this Manual: Avid Power ACAP115D-O 20-V AUTOMATIC CORDLESS INFLATOR User Manual V-AUTOMATIC-CORDLESS-INFLATOR.mp4](#)

References

- [User Manual](#)

[Manuals+](#), [Privacy Policy](#)

This website is an independent publication and is neither affiliated with nor endorsed by any of the trademark owners. The "Bluetooth®" word mark and logos are registered trademarks owned by Bluetooth SIG, Inc. The "Wi-Fi®" word mark and logos are registered trademarks owned by the Wi-Fi Alliance. Any use of these marks on this website does not imply any affiliation with or endorsement.