



## AVFI Audio BKT-CCPL Codec Plus Mount Instruction Manual

[Home](#) » [AVFI Audio](#) » AVFI Audio BKT-CCPL Codec Plus Mount Instruction Manual 



**BKT-CCPL Codec Plus Mount  
Instruction Manual**



## Contents

- 1 BKT-CCPL Codec Plus Mount
- 2 Assembly Instructions
- 3 Documents / Resources
  - 3.1 References

## BKT-CCPL Codec Plus Mount

### BKT-CCPL Codec Plus mount

Thank you for purchasing AVFI's BKT-CCPL Bracket.

This product is designed to have many mounting options.

Confirm all hardware is included before you begin assembly.

Read these instructions start to finish before beginning installation.

**Note:** If you cannot understand these instructions or are concerned about safety of the installation contact a qualified contractor or contact AVFI at 1-866-405-0655.

## Assembly Instructions

### Supplied Parts

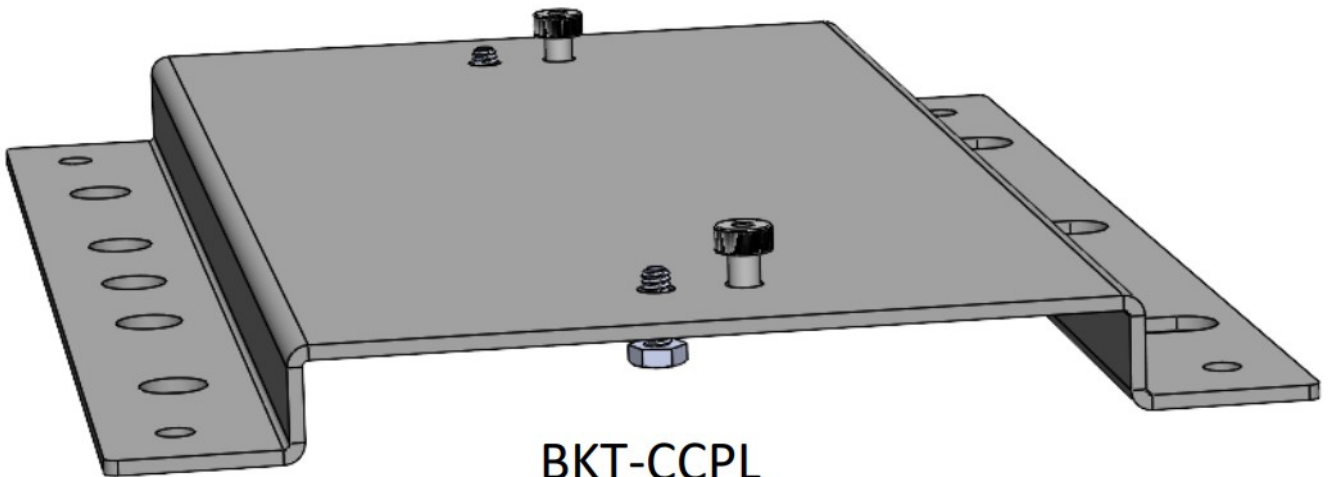

Supplied Hardware (Installed on bracket)



M8 Nut  
(4)



M8-20mm Bolt  
(4)

**Slide Codec onto bracket to check fit and orientation (mounting direction)**

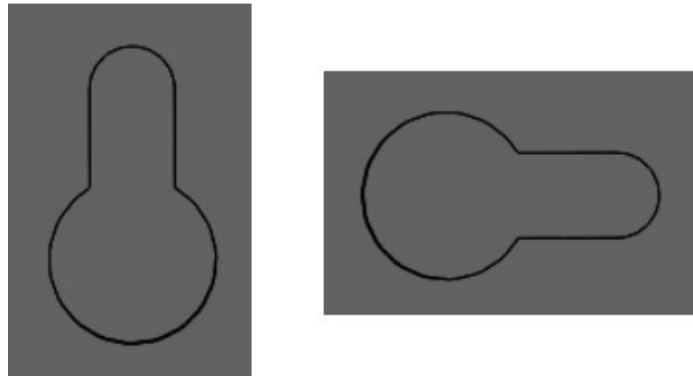

Key on back of codec should point upwards or sideways in mounted position.

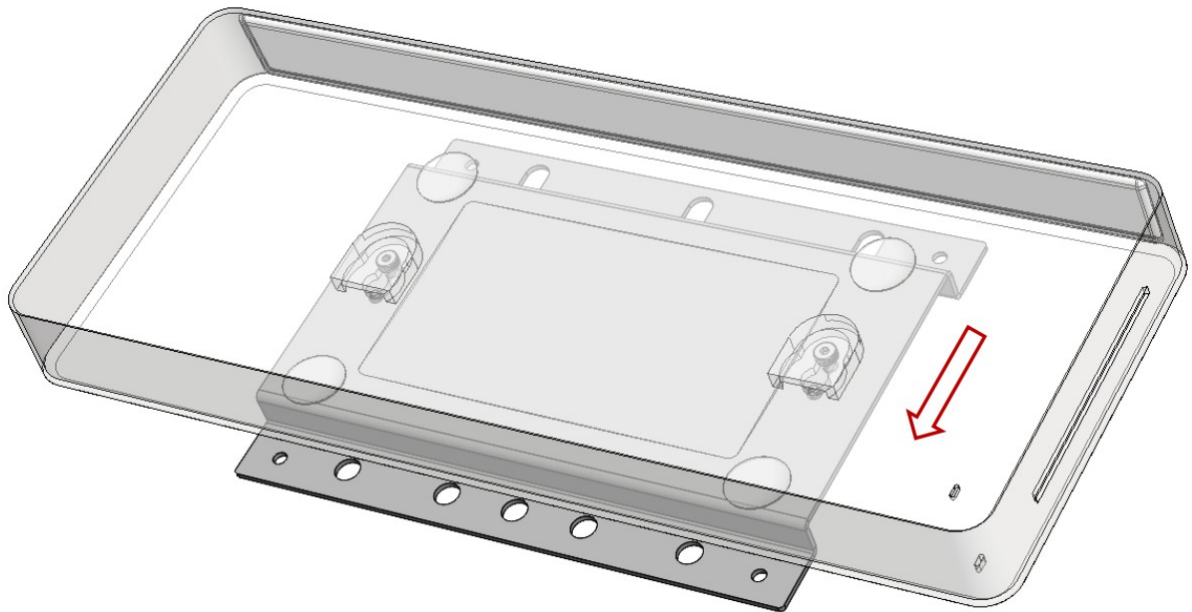

**Choose from many mounting methods. ( Some hardware not included)**

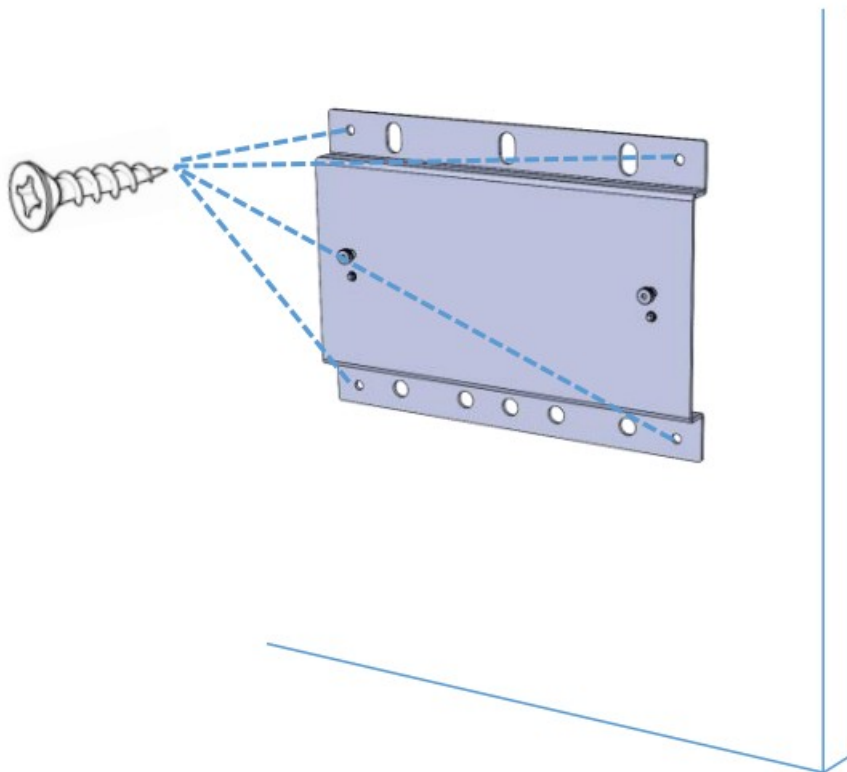

**Furniture Wall mount.**

Attach to wall using 4 wood screws. (screws not included)

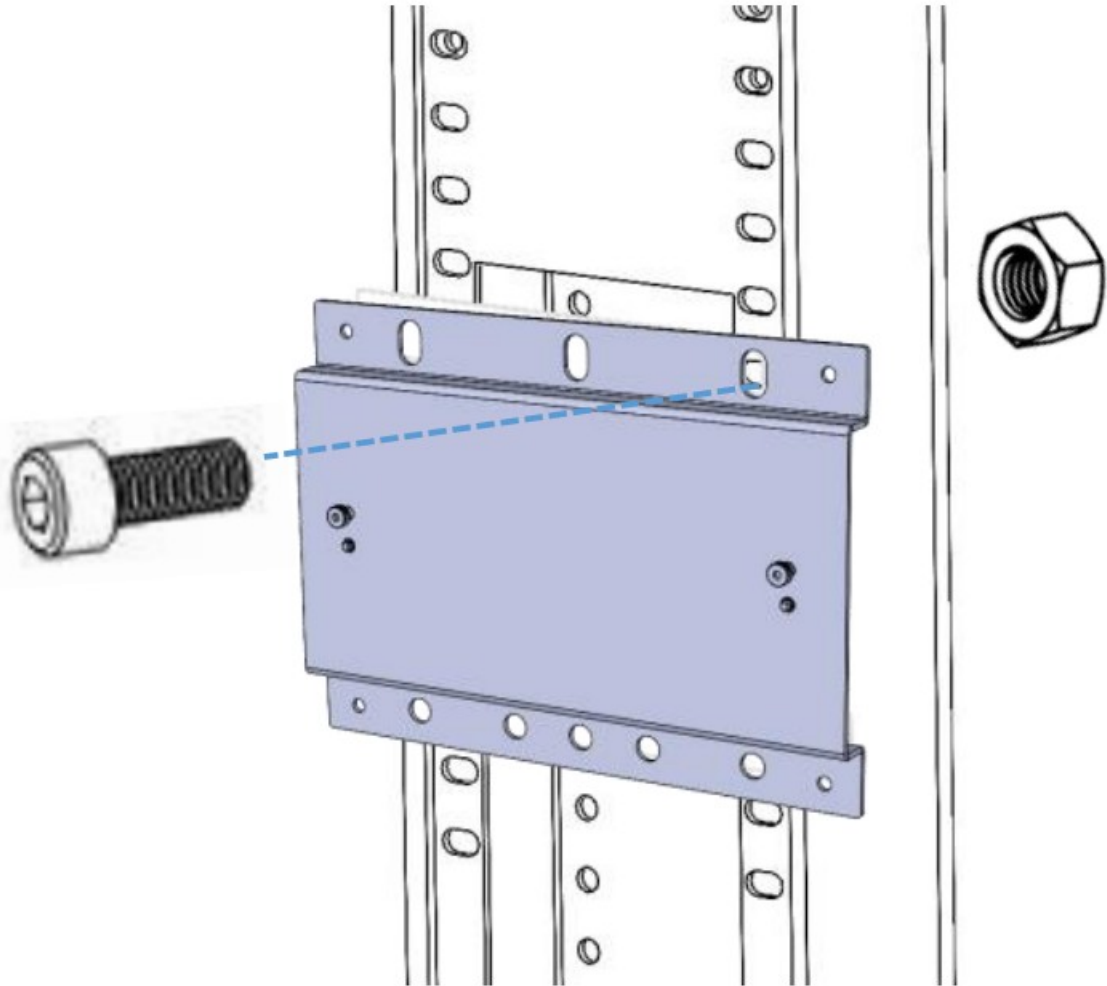

**Cart/Stand mount.**

8mm Machine screws w nuts x4.

Attach to front or rear of Rolling stand.

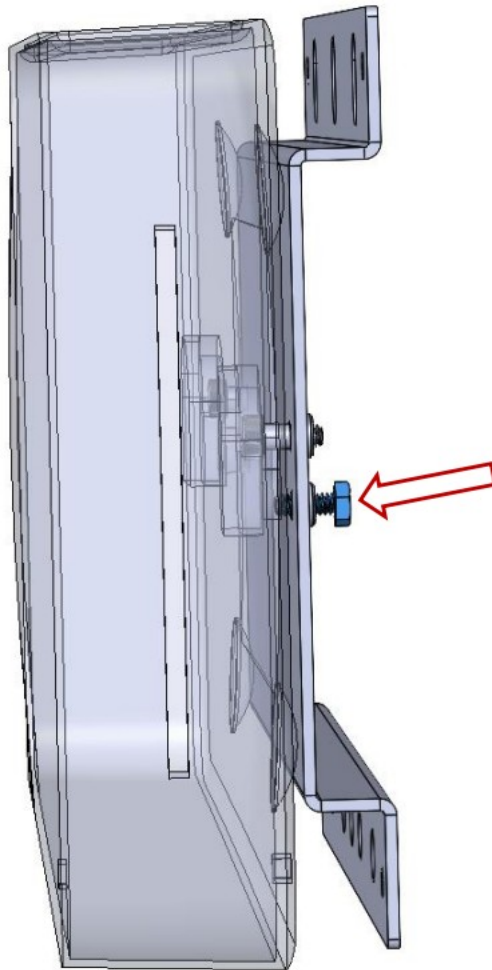

#### After mounting the Bracket.

Slide Codec onto bracket and tighten screws on back with small wrench to lock codec from sliding. Done.



[www.video-furn.com](http://www.video-furn.com)

190 Don Hillock Drive  
Aurora |Ontario|L4G 0G9  
1.866.405.0655

#### Documents / Resources

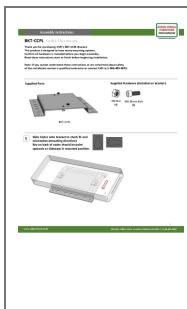

[AVFI Audio BKT-CCPL Codec Plus Mount](#) [pdf] Instruction Manual  
BKT-CCPL, BKT-CCPL Codec Plus Mount, Codec Plus Mount

#### References

-  [AV Furniture, Podiums, Lecterns, Stands, Tables, Racks, & More | AVFI](#)

Manuals+.