



avenli FP13-21-CZ Frame Rectangular Pool Set User Manual

[Home](#) » [avenli](#) » [avenli FP13-21-CZ Frame Rectangular Pool Set User Manual](#) 

Contents

- [1 avenli FP13-21-CZ Frame Rectangular Pool Set](#)
- [2 Instructions](#)
- [3 Safety instructions](#)
- [4 Description](#)
- [5 Installation instructions](#)
- [6 Instructions for use](#)
- [7 Cleaning and replacement](#)
- [8 Troubleshooting](#)
- [9 Warranty conditions](#)
- [10 Documents / Resources](#)
 - [10.1 References](#)
- [11 Related Posts](#)

avenli

avenli FP13-21-CZ Frame Rectangular Pool Set



- The product user manual contains the product functions, instructions for use and operating procedure. Read the user manual carefully to get the best experience and avoid unnecessary damage. Keep this manual for future reference. If you have any questions or comments about the equipment, please contact the customer service line.
- ✉ www.alza.co.uk/kontakt
- ☎ +44 (0)203 514 4411
- Importer Alza.cz a.s. , Jankovcova 1522/53, Holešovice, 170 00 Prague 7, www.alza.cz

Instructions

- Thank you for purchasing our filter pump. Its installation is very simple and the pump is very efficient.
- This filter pump has been manufactured to the highest quality standards. It will provide crystal clear water for many seasons in your new Prompt-Set pool or round/oval/rectangular pool with metal frame. This Jilong filter pump is of high quality. Its performance is due to its excellent filtration and the following features:
- It is designed for above ground pools
- High flow through the filter
- Easy installation and maintenance
- Low maintenance and operating costs
- Quiet operation and high-quality performance
- Certified quality construction
- Reliable anti-corrosion and reinforced material
- Elegant and beautiful design
- Smaller size and compact shape for easy winterization
- Filter pump with UL and GS certification
- Safer for swimming and the environment
- This Filter Pump User Manual provides you with clear instructions for the commissioning and efficient use of this high-end pump.

- In addition to the instructions for commissioning and use, we have also included a few very important warnings and cautions to ensure safe and worry-free use and this new filter pump. Read all the instructions and share them with all users of your pool.
- Read and understand the information in this manual before using it for the first time.

Safety instructions

Please read and understand the following important points before use:

- **WARNING:** Avoid possible electric shock – do not attempt to connect the power cord with wet hands or when standing in water.
- Avoid possible electric shock – connect the power cord to a grounded electrical outlet that is protected by a ground fault circuit interrupter (RCD).
- Avoid possible electric shock – never use a damaged or frayed power cord.
- This filter is not intended for use by children. Installation and operation should only be performed by an adult.
- Do not insert the power cord into the ground. Position the power cord so that it cannot be damaged by lawn mowers, lawn trimmers or other equipment.
- Do not connect extension power cords to this product.
- Before each use of the pump, check that all clamps are tightened and all hoses are properly connected.
- Do not use this filter pump to vacuum the pool.
- This filter pump is intended for use with seasonal pools only. It must not be used with permanently installed pools. Improper use will result in overheating, motor burn and damage.
- To prevent the filter pump motor from overheating, ensure that water flows through the pump. When this equipment is in operation, never leave it without water.
- Remaining air will cause overdriving and damage to the filter pump.
- Carefully turn the bleeder valve 1-2 turns to bleed any remaining air from the filter pump and filter housing.
- This device may be used by children 8 years of age and older and persons with limited physical, emotional, mental or other skills and knowledge if they are supervised or trained to use the device safely and understand the potential hazards of its use. Children must not play with this appliance. Cleaning and user maintenance must not be carried out by unsupervised children.
- If the power cord is damaged, it cannot be replaced and the equipment must be disposed of.
- It is forbidden to use the pump when persons are in the water.
- **WARNING:** This pump must be powered by a current protector with a rated residual operating current not exceeding 30 mA.
- Maximum total immersion of 0.9 m (for pumps with a power input exceeding 50 W)
- The pump must be installed at least 2 m from the pool and the plug must be located 3.5 m from the pool. (French market only)
- The pump must be secured to the ground or base with two 1/5 bolts or screws to prevent accidental dropping (see following figure).

Description

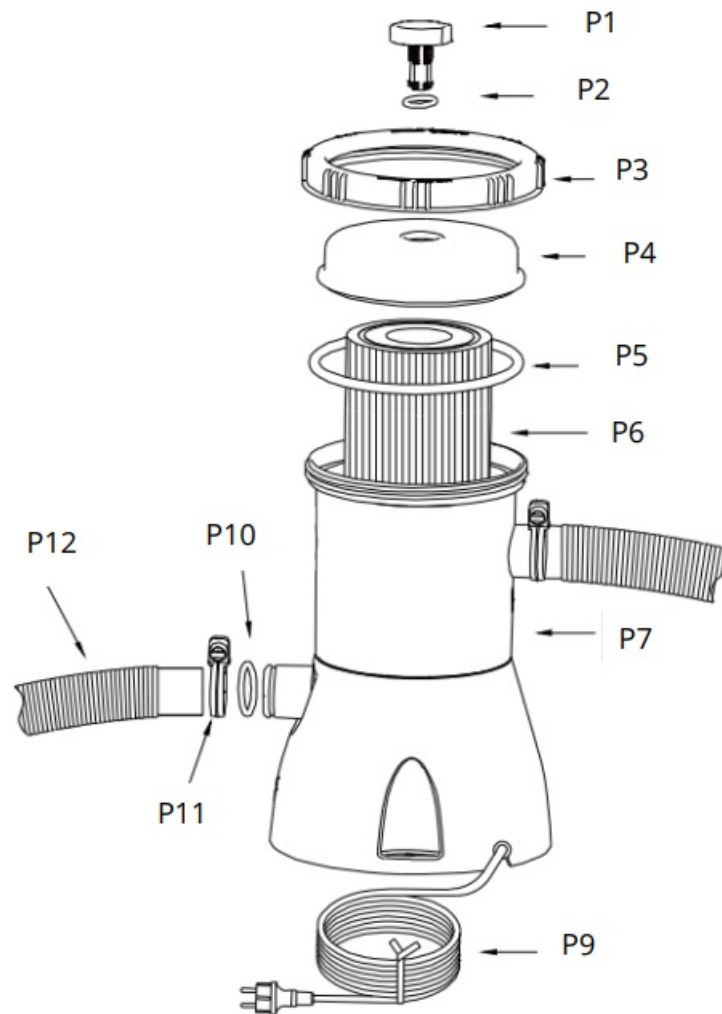

Item no.	Description	Quantity
P1	Vent cover	1
P2	Vent cover gasket	1
P3	Filter chamber cover nut	1
P4	Filter chamber cover	1
P5	Rubber seal of the filter chamber	1
P6	Filter cartridges	1
P7	Filtration chamber	1
P9	Power cable	1
P10	O-ring	2
P11	Hose clamp	4
P12	Connecting hose	2
P13	Filter sieve	2
P14	Connector	2

Installation instructions

1. Before installing the filter pump, first build the pool and fill it with water according to the detailed pool installation instructions. Start the filter pump only after the pool water has reached its maximum level. Low water pressure in the pump can cause noisy motor operation.
2. Remove the filter pump and hoses from the packaging.
3. Place the filter pump at least 0.2 m and no more than 1.0 m below the pool water level.
4. **Note:** This filter pump must be mounted on a solid and level surface. There are mounting holes at the bottom of the pump for attaching the pump with screws.
5. Insert the filter cartridge (P6) into the filter chamber (P7) so that the filter cartridge (P6) is inside the filter chamber (P7).
6. Fit the filter housing O-ring (P5) onto the filter chamber (P7).
7. Fit the filter housing cover (P3) onto the filter chamber (P7).
8. Then hand tighten the filter chamber cover nut (P3) clockwise.
9. Connect one filter hose (P12) to the inlet port of the filter pump (above) and to the bottom connection of the pool hose. Secure the hose with hose clamps (P11).
10. Carefully turn the vent valve (P1) 1-2 turns counterclockwise.
11. Connect the second filter hose (P12) to the upper pool hose connection and to the outlet port (bottom) of the filter pump (see page 7). Secure the hose with hose clamps.
12. The sound pressure level is less than 82 dB (A).

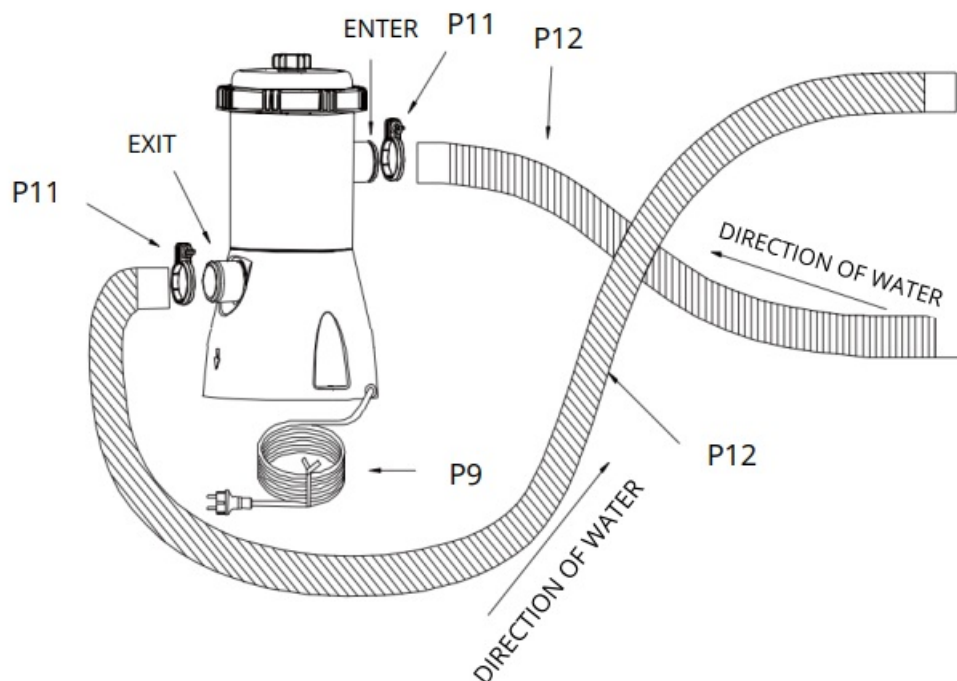

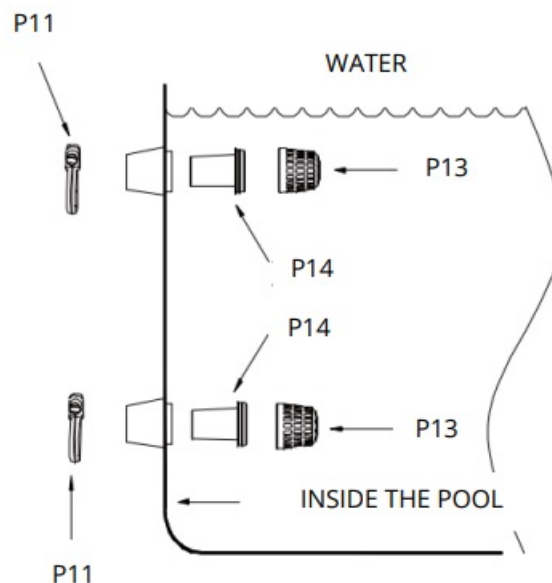

THE ILLUSTRATION DOES NOT CORRESPOND TO THE SCALE

Instructions for use

1. Check that the pool is already filled with water and place the filter pump in a suitable location.
2. When water flows into the filter pump, its pressure pushes the sucked air through the air vent valve (P1).
3. Then carefully tighten the vent valve (P1) clockwise.
4. Connect the power cord of the adapter to a 230 V AC mains socket and leave the filter pump running until the water has cleared.

Cleaning and replacement

1. Disconnect the power cable of the 230 V adapter from the power socket.
2. Loosen the nut of the filter chamber cover (P3) by turning it counterclockwise. Place in a safe place.
3. Clean the used filter cartridge (P6) or replace if necessary.
4. Check the inside of the filter chamber (P7).
5. If there is dirt or sediment in the bottom of the cabinet, rinse it out with a bucket of water or a garden hose.
6. Put the filter chamber cover nut (P3) in place and tighten clockwise on the filter housing.
7. Connect the power cord to the adapter.

Troubleshooting

THE PUMP IS NOT WORKING:

- **A.** Check for blown fuses, disconnected circuit breakers or interrupted wiring.
- **B.** Check the engine. If the engine is overheating or overloaded, switch it off. Allow the engine to cool down.
- **C.** Consult an expert.

THE MOTOR IS RUNNING BUT THE PUMP IS NOT PUMPING WATER OR THE FLOW IS TOO SLOW:

- **A.** Check that the suction or drain hose in the pool wall is not blocked.

- **B.** Tighten the hose clamps, check for damaged hoses, check the water level in the pool.
- **C.** Clean the filter cartridge more often. The filter cartridge can be easily cleaned, for example with a garden hose.
- **D.** Replace the filter cartridge.
- **E.** Consult an expert.

THE PUMP IS LEAKING WATER

- **A.** When the pump is switched off, check that the pool water level is at least 5 cm above the lower edge of the skimmer mouth.
- **B.** Check that no water is leaking from the suction hose.
- **C.** Check that the filter cartridge is not dirty and that it does not need to be cleaned. The filter cartridge can be easily cleaned, for example with a garden hose.
- **D.** Consult an expert. The filter pump is not cleaning the pool A) Adjust the chlorine content and pH level. B) Clean or replace the filter cartridge. The filter cartridge can be easily cleaned, for example with a garden hose. C) Check the cartridge for leaks. Replace a damaged cartridge. D) Leave the pump running longer.
- **E.** Remove debris from the screen in the pool wall.
- **F.** Consult an expert.







Warranty conditions

- A new product purchased from Alza.cz is covered by a 2-year warranty.
- In case of need for repair or other service within the warranty period, please contact the seller of the product directly, it is necessary to present the original proof of purchase with the date of purchase.
- The following shall be deemed to be a breach of warranty for which the claim cannot be accepted:
- Using the product for a purpose other than that for which the product is intended or failing to follow the instructions for maintenance, operation and servicing of the product.
- Damage to the product due to natural disaster, unauthorized person or mechanical fault of the buyer (e.g. during transportation, cleaning by improper means, etc.).
- natural wear and aging of consumables or components during use (e.g. batteries, etc.).
- The action of adverse external influences such as solar and other radiation or electromagnetic fields, liquid ingress, object ingress, mains surges, electrostatic discharge (including lightning), faulty supply or input voltage and the improper polarity of this voltage, chemical processes, e.g. used power supplies, etc.
- If anyone has made alterations, modifications, design changes or adaptations to change or extend the product's functions from the design purchased or use non-original parts.

Documents / Resources

 <p>FP13-21-CZ</p> <p><small>User Manual - návody k použití - příručka k použití Návodní literatura - Benutzerhandbuch</small></p>	<p>avenli FP13-21-CZ Frame Rectangular Pool Set [pdf] User Manual</p> <p>FP13-21-CZ, Frame Rectangular Pool Set, Rectangular Pool Set, Frame Pool Set, Pool Set</p>
---	---

References

-  [Alza.sk – rýchly a pohodlný nákup odkiaľkoľvek | alza.sk](#)
-  [alza.at](#)
-  [alza.co.uk](#)
-  [alza.de](#)
-  [alza.hu](#)
-  [alza.sk](#)