



Avatto WHS20S Wi-Fi Temperature & Humidity Sensor User Manual

[Home](#) » [AVATTO](#) » Avatto WHS20S Wi-Fi Temperature & Humidity Sensor User Manual 



WHS20S Wi-Fi Temperature & Humidity Sensor User Manual



WIFI Temperature & Humidity Sensor

Contents

- [1 Specification](#)
- [2 Product Description](#)
- [3 Pair The Network](#)
- [4 Countdown Timer Setting](#)
- [5 IR Remote Setting](#)
- [6 Documents / Resources](#)
 - [6.1 References](#)

Specification

Model Number:	WHS20S
Input:	5V 1V
WIFI frequency:	2.4GHz IEEE 802.11 b/g/n
Temperature Measure Range:	0°C 60°C
Humidity Measure Range:	0% RH 99%RH
Temperature Measure Accuracy:	± 1°C
Humidity Measure Accuracy:	±5%RH
Dimensions:	80 x 86 x 105 mm
Net Weight:	130g

Product Description

WHS20S is not just an excellent humidity and temperature sensor with screen and special value adjustment method.

It have also enabled many revolutionary function like temperature &humidity calibration function, brightness adjustable function, alarm clock function, stop watch function etc.

All work together to serve for a wonderful smart home life.

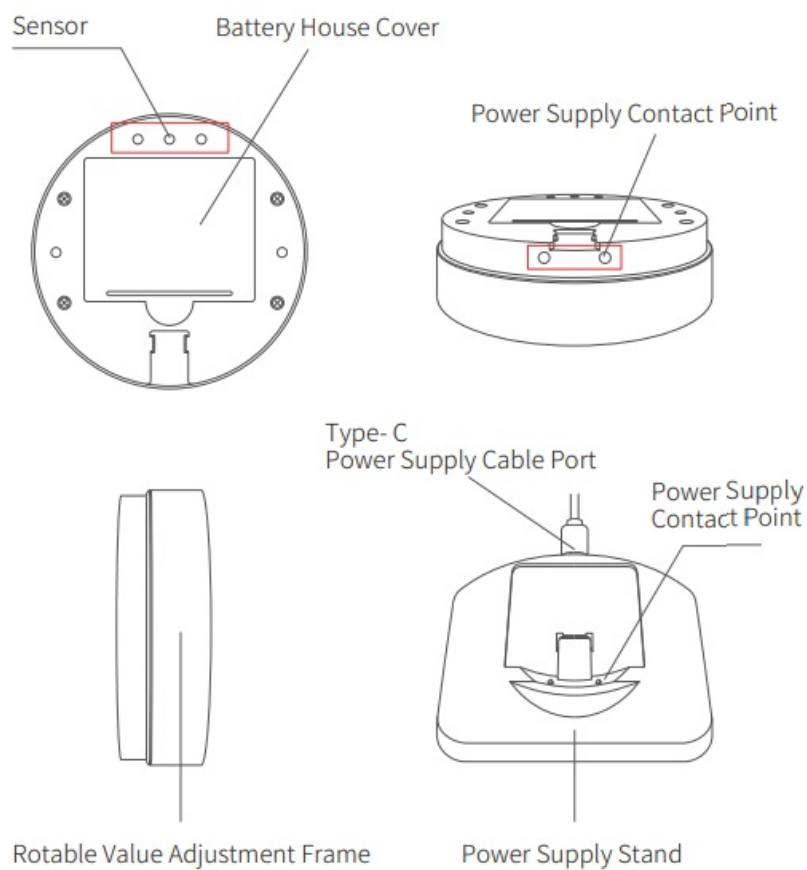
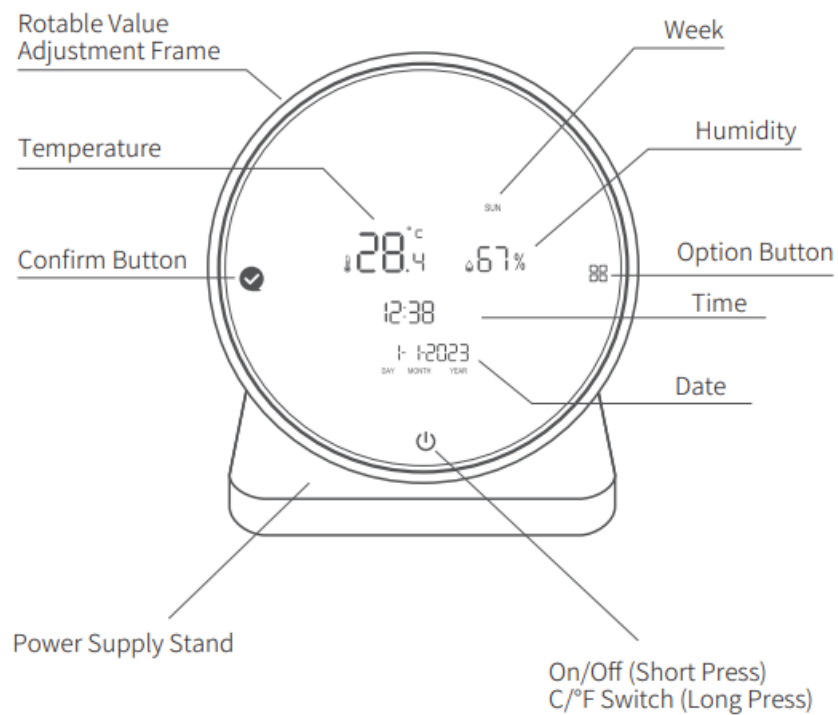

Pair The Network

1. Turn off the humidity and temperature sensor via press the on/off button.
2. Long press the on/off button for 5 seconds till the wifi icon on the screen fast flash.

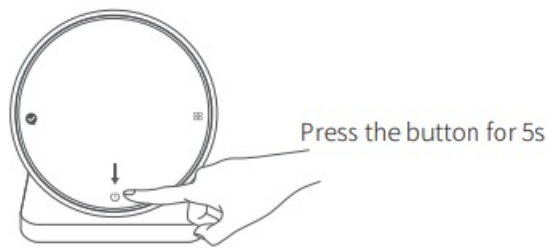

3. Turn on bluetooth of phone, and open smart life / Tuya Smart APP on your phone .
4. Click + icon on the right up corner of the app main interface.
5. Product icon will jump out, press add.
6. Input 2.4G wifi network and pass word, start paring.
7. Paring successfully, and start your smart life.

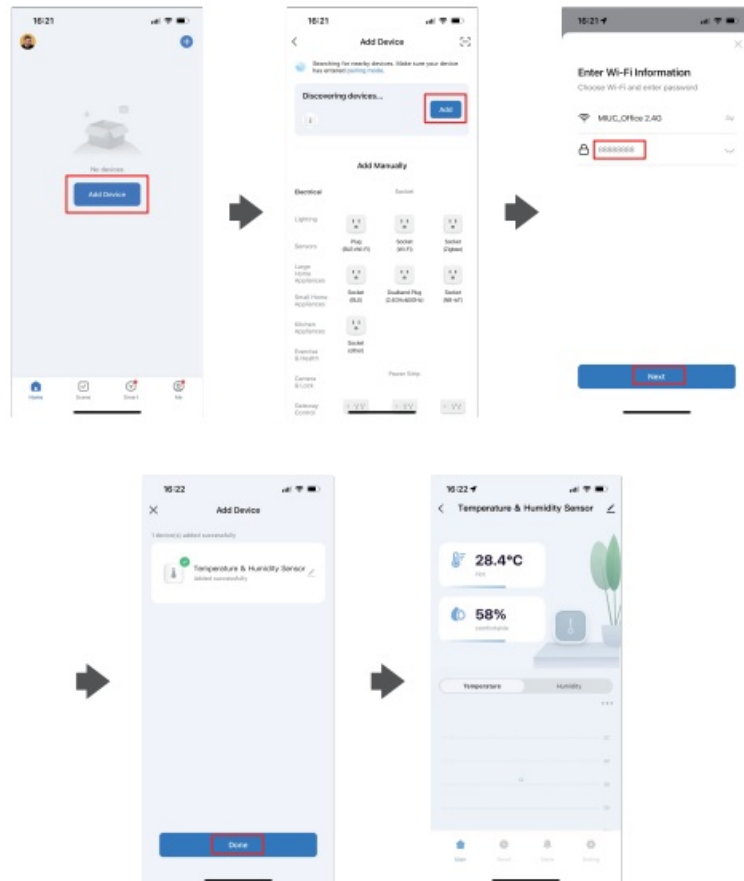

Display Brightness Adjustment

Turn on and rotate the frame

left :
reduce the brightness

right :
increase the brightness



Temperature and Humidity Calibration

1. Short press the option key 1 time to adjust the temperature value.
2. Short press the option key 2 time to adjust the humidity value.
3. Rotate the increase or decrease the value .
4. Short press the confirm button to make confirmation.



Temperature Adjustment Accuracy: 0.1°C



Humidity Adjustment Accuracy: 1%RH

Clock Setting

1. Short press the option key 3 time to adjust the hour.
2. Short press the option key 4 time to adjust minute.
3. Short press the option key 5 time to adjust year.
4. Short press the option key 6 time to adjust month.
5. Short press the option key 7 time to adjust day.
6. Rotate to adjust the value.
7. Short press confirm key to make confirmation.

Alarm Clock Setting

1. Short press the option key 8 time to setting alarm clock.
2. Rotate to adjust time of alarm and turn on/off clock . (In Total 2 clock for option)

Countdown Timer Setting

1. Long press confirmation key get into Stop Watch function. Short press option key to choose between hour, minute and second.

2. Rotate to adjust the value
3. Short press confirm key to confirmation.
4. After alarm time reached, device will release voice of beep.

Stop Watch Setting

1. Long press option button key get into stop watch function.
2. Short press confirm key to start the timer.
3. Short press confirm key to stop the timer.

IR Remote Setting

1. Tap “Temperature & Humidity Sensor”, then click “+”, elect the device and its brand you need control.
2. you can click “Quick Match” or “ Manual Mode” to match the buttons, please match at least 3 buttons to check if the device reacts properly, if yes, then match completed, you can control the device.
3. If you added the same device type with the same brand in one room, please edit the device with different names to avoid control confusion.



DIY Learning Function

1. If you can not find the brand of the device in the brand list, you can choose “DIY” to learn the buttons of other brands’ remote control, so you can also control the device.



Notes:

1. It only support 38KHz frequency, if the IR remote unable to receive commands from the IR device, it is likely that the frequency of IR device does not match, unable to study commands.
2. DIY does not support voice control.

App Download

1. Scan the QR code to download Tuya Smart APP/ Smart Life App, or you can also search keyword “Tuya Smart” and “Smart Life” at App IOS APP /Android APP Store or Google play to download App.



<https://smartapp.tuya.com/tuyasmart>



<http://e.tuya.com/smartlife>

Scan to download
Tuya Smart APP/ Smart Life App

AVATTO

Documents / Resources



[Avatto WHS20S Wi-Fi Temperature & Humidity Sensor](#) [pdf] User Manual

WHS20S Wi-Fi Temperature Humidity Sensor, WHS20S, Wi-Fi Temperature Humidity Sensor, Temperature Humidity Sensor, Humidity Sensor, Sensor

References

- [User Manual](#)

[Manuals+.](#) [Privacy Policy](#)

This website is an independent publication and is neither affiliated with nor endorsed by any of the trademark owners. The "Bluetooth®" word mark and logos are registered trademarks owned by Bluetooth SIG, Inc. The "Wi-Fi®" word mark and logos are registered trademarks owned by the Wi-Fi Alliance. Any use of these marks on this website does not imply any affiliation with or endorsement.