



avatar AvaCube Smart Home Hub with Alexa Built-in User Manual

[Home](#) » [AVATAR](#) » avatar AvaCube Smart Home Hub with Alexa Built-in User Manual



AvaCube Smart Home Hub with Alexa Built-in User Manual

Contents [[hide](#)]

- [1 Product Introduction](#)
- [2 Packing List](#)
- [3 Operating Instructions](#)
- [4 LED indicator](#)
- [5 Initial Setup](#)
- [6 Smart interaction](#)
- [7 Specifications](#)
- [8 Documents / Resources](#)
 - [8.1 References](#)
- [9 Related Posts](#)

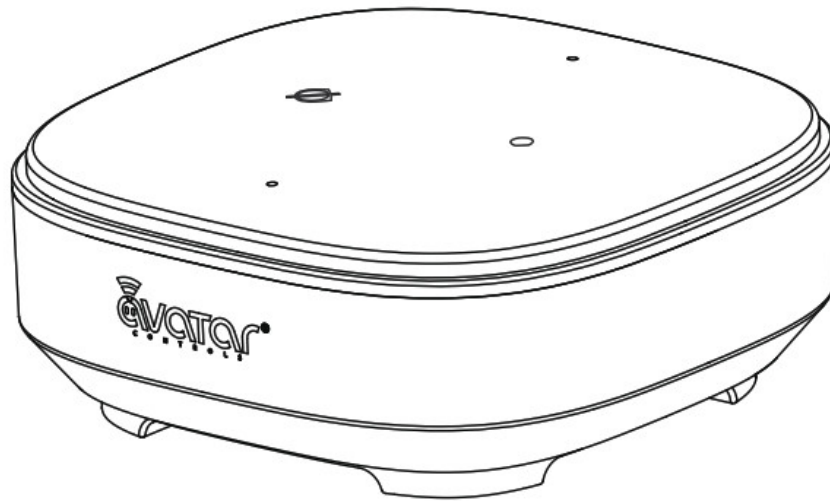

Product Introduction

AvaCube is the Alexa-enabled voice control & AI speaker that is integrated with the IR hub. AvaCube has an independent voice feature, which enables direct dialogue and control between people and devices, and is also compatible with Alexa smart devices.

AvaCube can wake up via Amazon Alexa voice control, and also streamline your morning and bedtime routines. Through powerful built-in Alexa function, you can use voice commands to get a weather report, listen to the news, set up alarms, control your smart devices and etc.

The AvaCube is an IR (Infrared) hub to easily control your home IR appliances like fans, air conditioners, TVs, and set-top boxes. It comes with a massive IR library of mainstream household devices and a comprehensive 360° signal coverage. In addition, it also includes a DIY learning mode that can connect to any new device.



Smart Home



Event Planner



Audio Content



Entertainment

Packing List

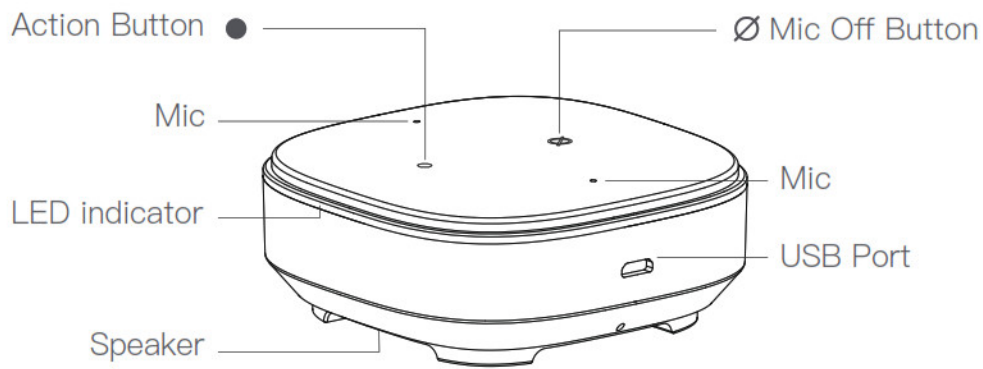

AvaCube Hub

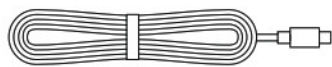

USB Charging Cord

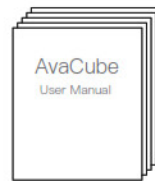

User Manual

Operating Instructions

Button	Short Press	Long Press (6 seconds)
Ø	Mic Off Button	/
•	Action Button	Restore factory settings

When the AvaCube is plugged in for the first time, the button temporarily has no function since it is waiting to connect to the network.

LED indicator

Color	Display	Status
Yellowish-green	Ring breathing light	Configuring Network
Blue	Ring light	Awake State
Red	Ring light	Mic Off/ Network failure

Initial Setup

1. Plugin your AvaCube

Plugin the included USB charging cord into the AvaCube and plug the adapter into a power outlet. A Yellowish-green light will slowly flash (detection state) as it connects to the WiFi network.

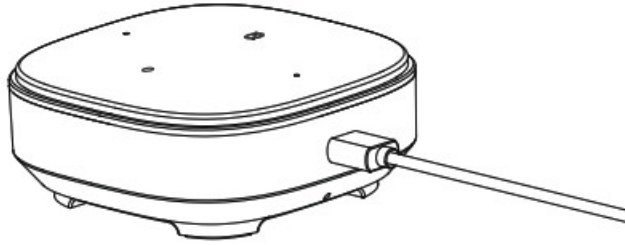

2. **Install the APP**

Scan the following QR code on your phone, or go to the Google Play Store or the Apple store to download and install the AvatarControls APP.



<https://smartapp.tuya.com/avatarsmarthome>

3. **Login to your account**

Open AvatarControls APP, follow the guide to log in/register APP account.



4. Connecting to the internet and your Amazon account Add device in the APP, select the category "Other", select add "Smart Speaker". Bluetooth will search the device automatically. Enter your WiFi password to configure the network as prompted. After the network configuration is complete, click "Done" and sign in to the Amazon account for platform authorization. Click "Allow" after authentication is completed. Open AvatarControls APP to confirm success, you will hear a "Dong" voice prompt, the indicator light goes out, indicating that the network has been successfully configured. Click on the upper right corner "Done" to finish. The device will play "Now your device is connected to the internet."

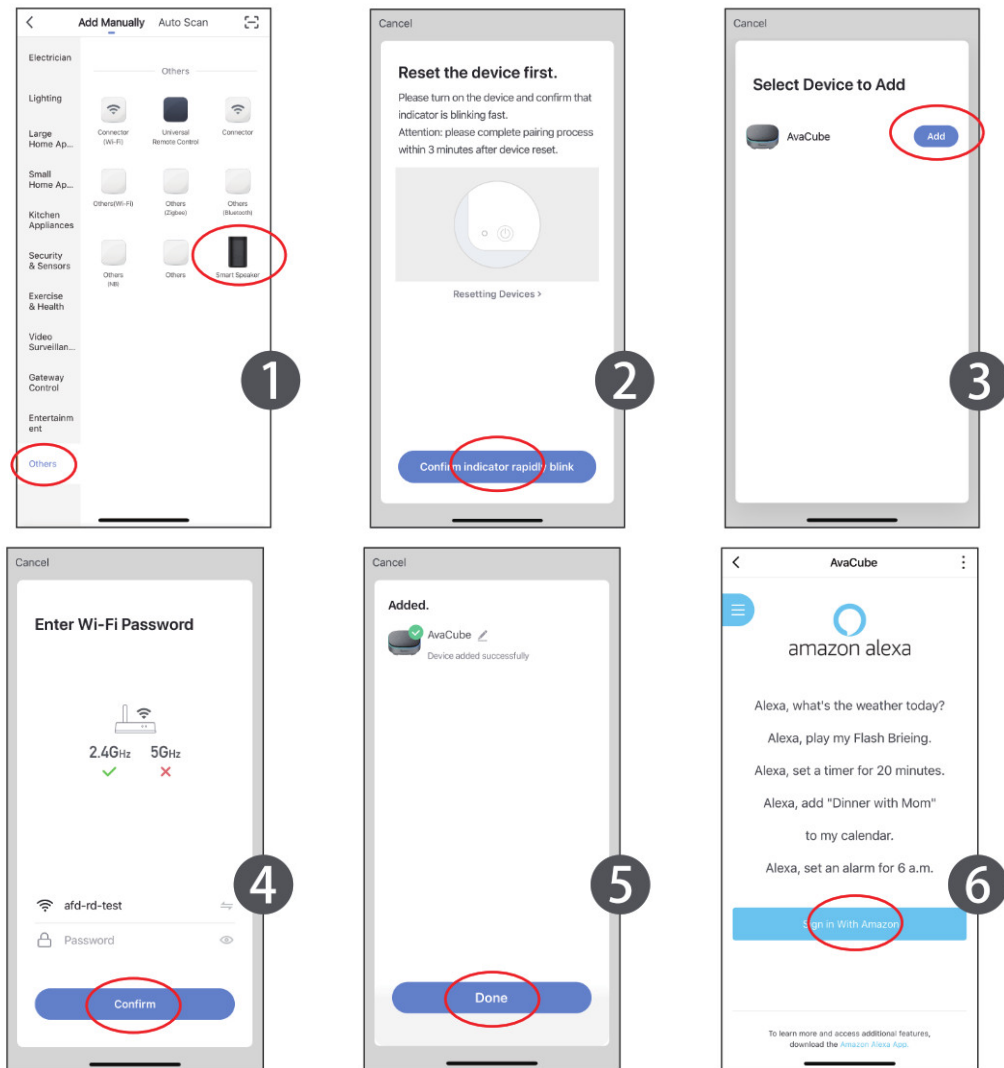

5. Connecting to Alexa

Return to the Home of the APP, select the “Me” option in the bottom right corner. Select “More Service”, then under the Third-party Access Service select “Alexa”. Sign in to your Amazon account to connect to Alexa. The APP will show “Already linked with Amazon Alexa” after a successful connection to Alexa.

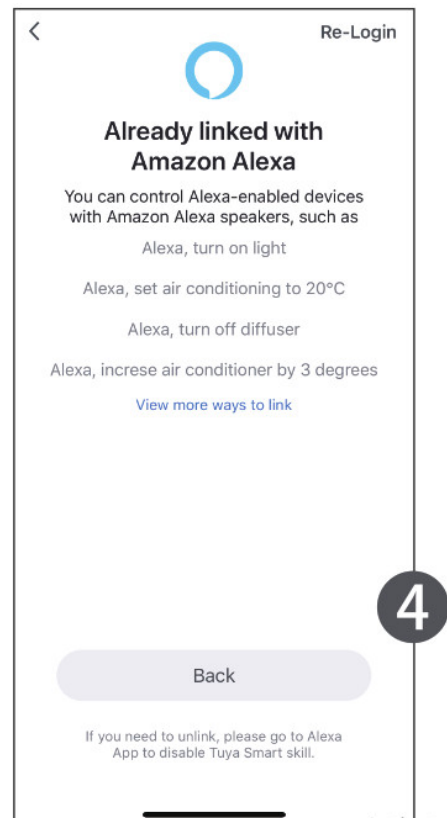
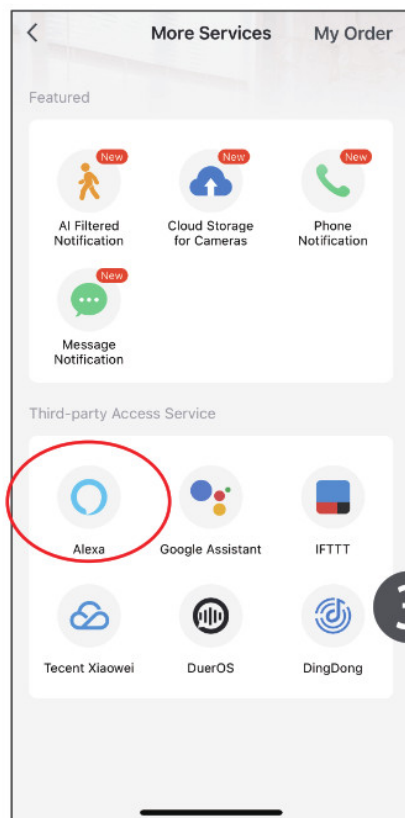
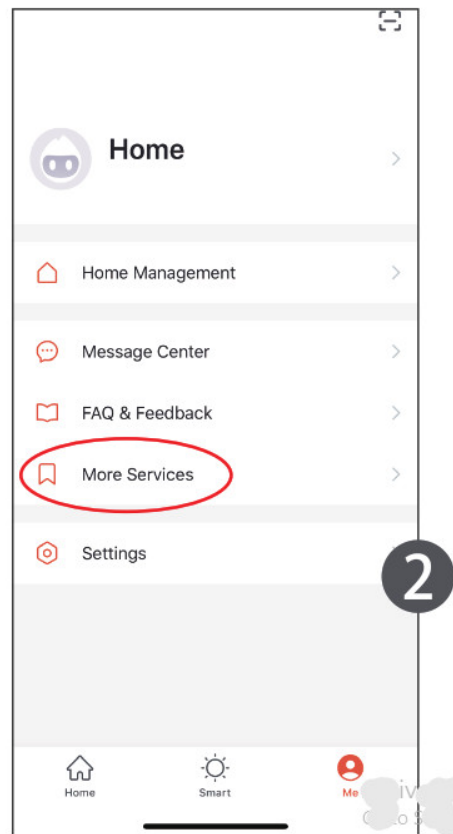
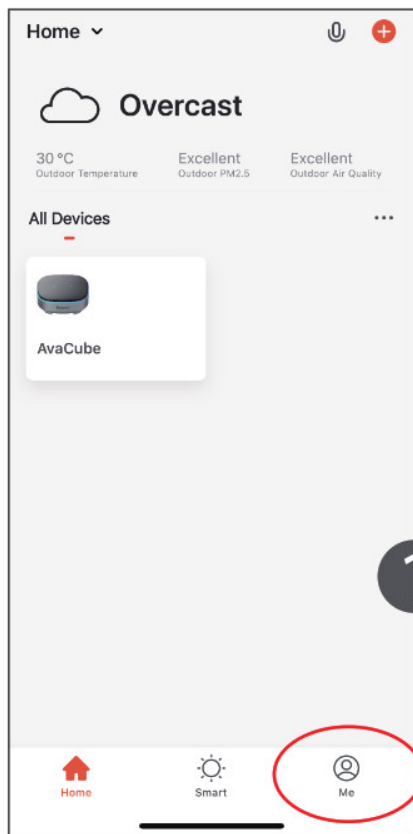

6. Add an Infrared device

Select "AvaCube". Select the blue icon in the upper left corner to expand, then select "IR Device", select "add" to add an IR device. Select device type from all supported IR device types. Choose your infrared device brand and follow the instructions to configure the remote control. Press "OK" after the remote control match is completed. Now you can control your device with the AvaCube.

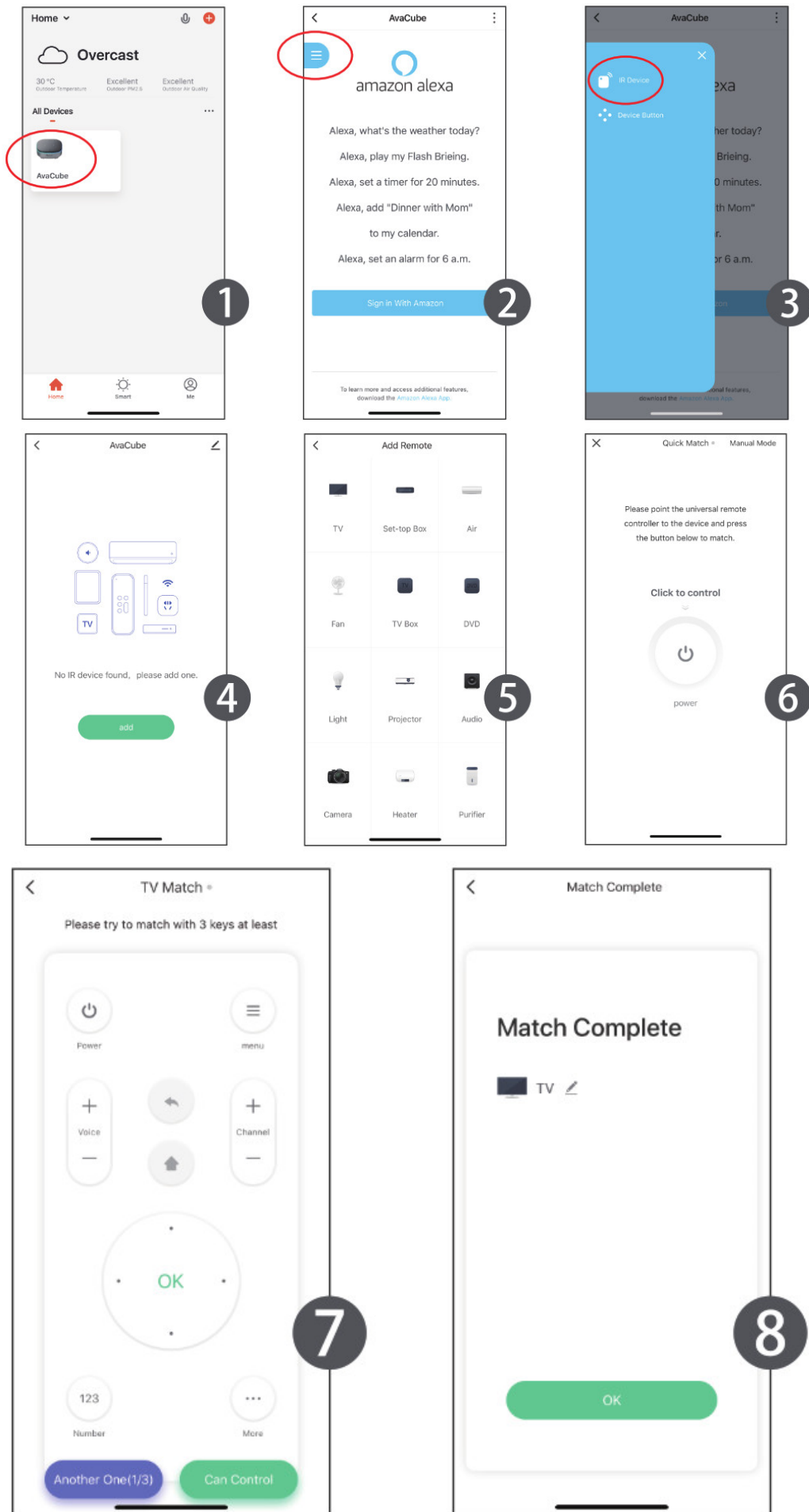

Tips

1. Device location services and Bluetooth on your phone need to be turned on during the network configuration.
2. Please use 2.4G WiFi to configure the device, 5G WiFi is not supported yet.
3. If the device is not in configuration mode, press and holds the Action button (•) to reconfigure.
4. All controlled sub-device names can be customized.
5. Amazon account authorization and settings only need to be performed once.

Smart interaction

1. Smart home control

AvaCube seamlessly integrates with Tuya IoT products. Over 90,000 products powered by tuya can be controlled including TVs, air conditioners, set-top boxes, fans, IPTV boxes, smart plugs, smart switches, smart lights, smart purifiers, and more. Just say “Alexa”, “Turn on TV”, “Turn on socket”, “Play music”, etc.

2. Multi-scenario control

You can set up different scene modes on the APP, multi-scenario the feature can control multiple scenes by a one-click trigger, so you can create your routines to select these scenes in the Amazon Alexa App.

For example:

You can say “Alexa, I’m back home” to AvaCube when you get home at night, and the AvaCube will execute a customized home mode. You can say “Alexa, good morning” to AvaCube when you wake up in the morning, the AvaCube will execute a customized wake-up mode.

3. Event Planner

Alexa set the alarm for 7 a.m.

Alexa set the timer for 45 minutes.

Alexa, what’s on my calendar tomorrow?

Alexa, when is my next meeting?

4. Audio Content

Alexa, play the book The Room Where It Happened.

Alexa, read my audiobook.

Alexa, play my Coldplay station from Pandora.

Alexa, play the program Radiolab.

5. Recreation and Entertainment

Alexa, can you tell me a “yo mama” joke?

Alexa, when do the Seattle Seahawks play next?

Alexa, what do you want to be when you grow up?

Alexa, will it rain tomorrow?

Alexa, what’s your favorite color?

Specifications

Size: 86*86*35.5mm

Weight: 160g

Power adapter: 5V/1A

WiFi network: 802.11 b/g/n

Bluetooth: Bluetooth V4.2

Infrared emission distance: 8 meters
(limited by environmental conditions)

Shenzhen Avatar Controls Co., Ltd.
5th Floor, Building A, Dunfa Industrial Park,
Hangcheng Avenue, Gushu Community,
Xixiang Street, Baoan District, Shenzhen China
service@avatarcontrols.com
<https://www.avatarcontrols.com>

Documents / Resources

	avatar AvaCube Smart Home Hub with Alexa Built-in [pdf] User Manual AvaCube Smart Home Hub, Smart Home Hub with Alexa Built-in
---	---

References

-  [Avatar Controls AvaCube Smart Home Hub with Alexa Built-in](#)