

AVAPOW
AVAPOW A9 Car
Jump Starter



AVAPOW A9 Car Jump Starter User Manual

[Home](#) » [AVAPOW](#) » AVAPOW A9 Car Jump Starter User Manual 

Contents

- 1 AVAPOW A9 Car Jump Starter
- 2 What's in the box
- 3 Specifications
- 4 Product diagrams
- 5 Accessories
- 6 Charge the Jump Starter battery
- 7 LED Display
- 8 How to Jump Start Your Vehicle
- 9 Operating instructions
- 10 Jumper Clamp Indicator Instruction
- 11 How to charge a mobile phone or digital products
- 12 Operating instructions
- 13 LED flashlight
- 14 Documents / Resources
 - 14.1 References

AVAPOW

AVAPOW A9 Car Jump Starter



- 2023.11.07
- A9
- 95*140mm
- 128g

Friendly Tips

- Please read carefully the instruction manual so that you can be familiar with the product more conveniently and quickly! Please use the product correctly based on the instruction manual.
- Perhaps there is small difference between the picture and the actual product, so please turn to the actual product for detailed information.

What's in the box

- AVAPOW jump starter x1
- Intelligent battery clamps with starter cable x1
- High-quality type-C charging cable x1
- User-friendly manual x1

Specifications

- Model number A 9
- Capacity 29.6Wh
- EC5 output 12V/1500A maximum starting power (max.)
- USB output 5V/3A, 9V/2A, 12V/1.5A
- Type-C input 5V/2A, 9V/2A
- Charging time 2.5-4 hours
- LED light power White: 1W

- Working temperature -20°C --+60°C I -4° F --+140° F
- Dimension (LxWxH) 180*92*48.5mm

Product diagrams

1. Power button
2. Output: 5V/3A, 9V/2A, 12V/1.5A
3. Type-C input: 5V/2A, 9V/2A
4. LED display
5. EC5 jump start output
6. LED light
7. Light button

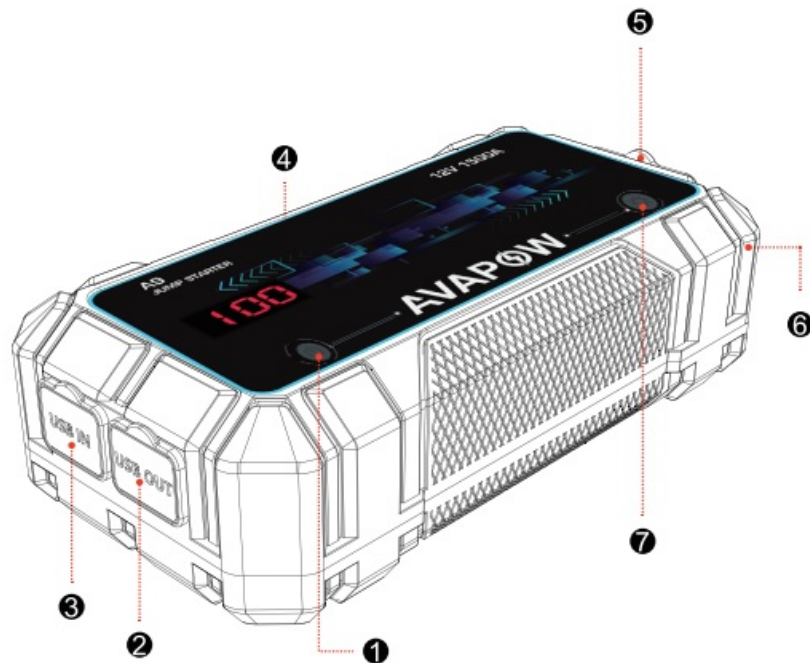

Accessories



Intelligent battery clamps with starter cable



High quality type-C charging cable

Charge the Jump Starter battery

Charging with an AC adapter (Note: AC adapter sold separately in-store).

1. Connect the battery input with a Type-C cable.
2. Connect the Type-C cable to AC adapter.
3. Plug the AC adapter into a power source.

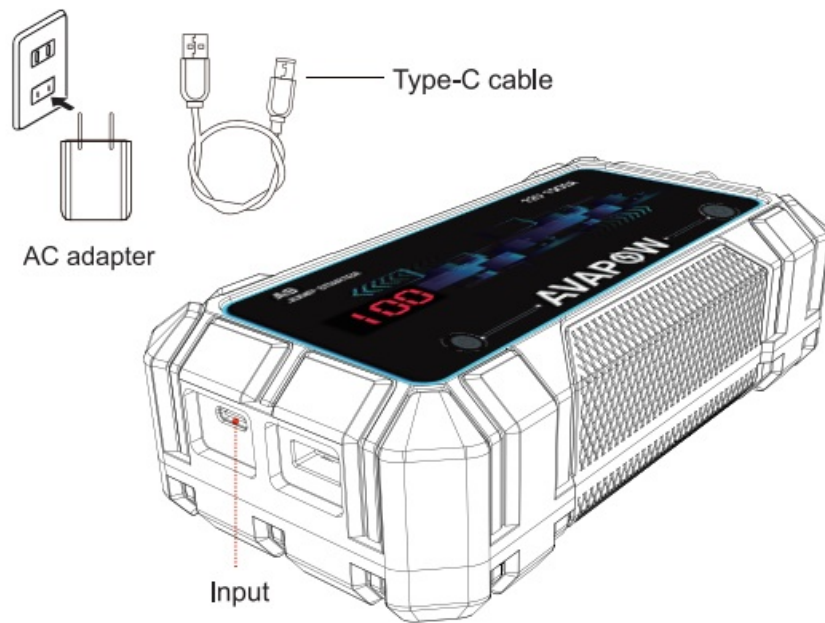

LED Display

Press the power button, the LED display shows as follows:



How to Jump Start Your Vehicle



This unit is designed for jump-starting 12V car batteries only and rated for gasoline engines up to 7 liters and diesel engines up to 4 liters. Do not attempt to jump start vehicles with a higher battery rating, or different voltage. If the vehicle isn't started immediately, please wait for 1 minute to allow device to cool down. Do not try to restart the vehicle after three consecutive attempts as this may damage the unit. Check your vehicle for other possible reasons why it can't be restarted.

Operating instructions

- **First Step:**

Press the power button to turn on it, then plug jumper cable into EC5 port, the red and green lights flash alternately.

- **Second Step:**

Connect the jumper clamp to car battery, red clamp to positive, black clamp to negative pole of car battery.

- **Third Step:**

When the green light is always on, turn on the car engine to start car.

- **Fourth Step:**

Pull the plug of battery terminal from jump starter and remove clamps from auto battery.

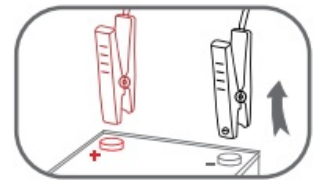
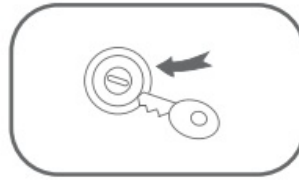
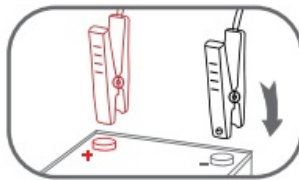
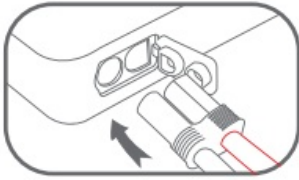

Jumper Clamp Indicator Instruction

Jumper Clamp Indicator Instruction		
Item	Technical parameters	Instruction
Standby indication	support	When the clamp is in standby state, the red and green lights flash alternately.
Work instructions	support	When the clamp is in the conduction working state, the green light is always on.
Input high voltage protection	17.50V±0.5V	When the clamp is in standby mode, and the voltage at the ECS terminal is higher than this value, the protection will be triggered, and the red light will always be on, and the protection will be automatically released after the fault is eliminated.
Input low voltage protection	14.0V±0.4V	When the clamp is in standby mode, and the voltage of the ECS terminal is lower than this value, the protection will be triggered, and the red light will always be on, and the protection will be automatically released after the fault is eliminated.
High temperature protection	support	When the detection temperature of the clamp is 80°C±10°C , the output is automatically disconnected, and the red light is always on, and the buzzer does not sound; when the temperature of the clamp is lower than the protection value, the protection is automatically released.
Reverse polarity protection	support	When the wire clip is reversely connected to the car battery that is higher than 1.0V, the protection will be triggered, the red light will always be on, and the buzzer will continue to beep, beep, beep for a short time, and the protection will be automatically released after the fault is eliminated.

Jumper Clamp Indicator Instruction		
Item	Technical parameters	Instruction
Anti charge protection	support	When the protection is triggered, the output is automatically disconnected, and the red and green lights flash alternately; the protection can be automatically released after the fault is eliminated .
Start overrun protection	support	During the conduction process, the clamp detects that the voltage of the start port is lower than 7.0V and lasts for 0.5s, then automatically disconnects the output, the red light is always on, and the buzzer does not sound; it needs to be powered on again to release the protection .
Boot timeout protection	support	<p>1. After the car is correctly connected, it has not been started. The output will be automatically disconnected after the clamp is turned on for 30 seconds, and the red light is always on. It needs to be powered on again to release the protection.</p> <p>2. The voltage at the start port of the wire clip detection drops by 3.0 V±0.2V, and it is judged to start the car. At this time, the wire clip continues to conduct for 5 seconds and then disconnects the output. The red light is always on, and it needs to be powered on again to release the protection.</p>
Short circuit protection	support	In the standby state, when the red/black clips are short-circuited, there will be no sparks and no damage. When the protection is triggered, the red light will always be on and the buzzer will sound for a long time.

Jumper Clamp Indicator Instruction		
Item	Technical parameters	Instruction
Relay sticking alarm	support	After the relay of the wire clip is stuck, when the power is turned on again, an alarm will be triggered, the red light will be on, and the buzzer will continue to beep quickly and briefly.
Clip off detection	support	If the red and black clips of the cable clamp fall off when starting the car, it will automatically return to the standby state after about 2.5 seconds.

How to charge a mobile phone or digital products



With powerful capacity and USB Quick Charger(5V/3A,9V/2A, 12V/1.5A),it can full charge your smart phones and tablets up to 75% faster than a standard charger.

Operating instructions

• First step:

Press the power button, then check the battery shown on the LED display

• Second step:

Plug the USB port of the charging cable into the product USB

• Third step:

Insert the other side into the input port of the mobile phone

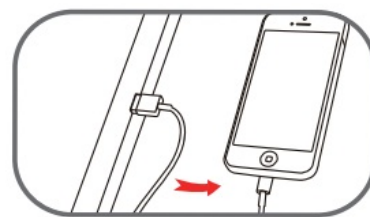
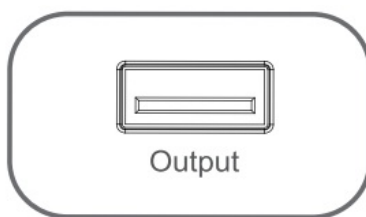
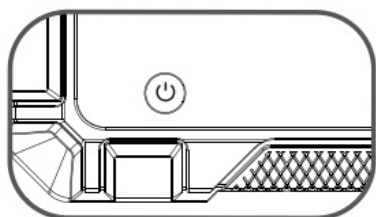

LED flashlight



Press the power button then short press the light button to turn on the flashlight. The battery capacity indicator lights up. Short press the light button again to scroll through the lighting, Strobe, SOS. Short press again to turn off the flashlight. The flashlight offers more than 35 hours of continuous use when fully charged.

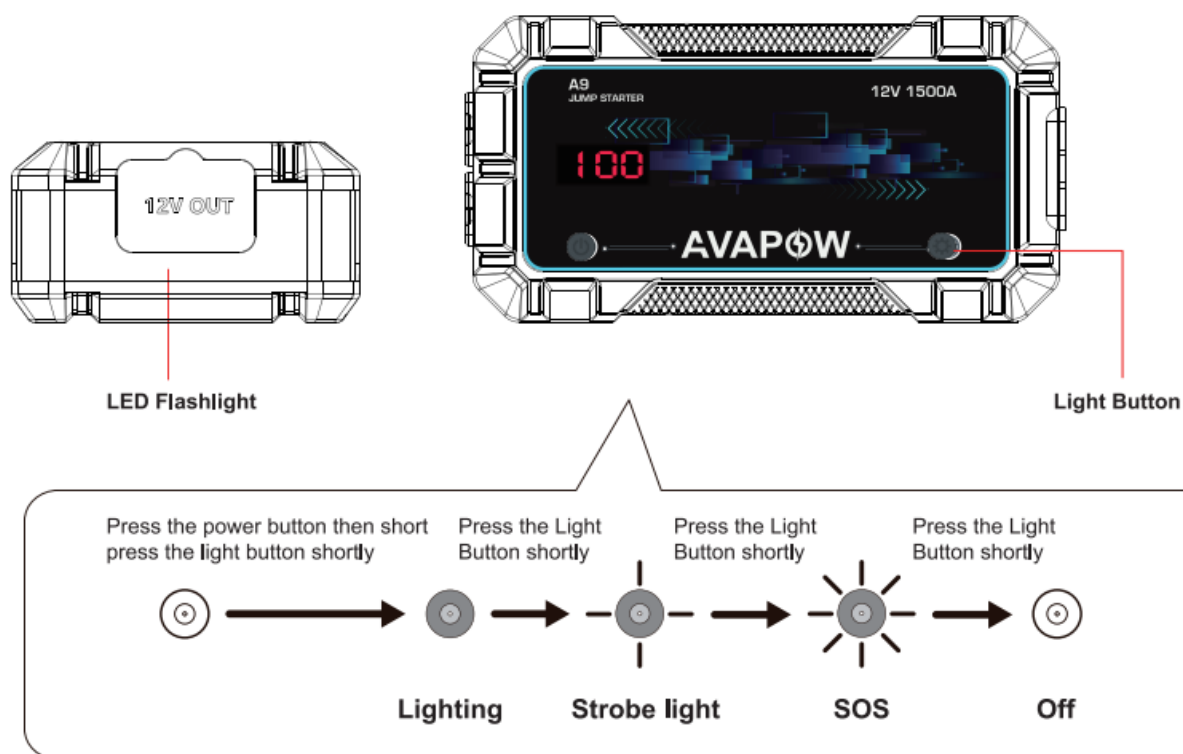

Safety Warning

1. Never short-circuit the jump starter by connecting the Red and Black clamps.
2. Do not disassemble the jump starter.
3. If you find swelling, leakage or odor, please stop using the jump starter immediately.
4. Please use this starter at normal temperature and keep away from humid, hot and fireplaces.
5. Do not start the vehicle continuously. There should be at least 30 seconds to 1 minute between two starts.
6. When the battery power is less than 10%, do not use the jump starter otherwise the device will be damaged.
7. Before first use please charge it for 3 hours or more.
8. If the positive clamp of the starting power was incorrectly connected to the negative poles of the car battery, the product comes with relevant protective measures to avoid personal injury and property damage.

Note:

- For the first use, please make sure to fully charge before use.
- In normal use, please confirm that the unit has at least 50% power before use.

Warranty Exemption

1. The product has been incorrectly operated or damaged due to the following irresistible reasons (such as flood, fire, earthquake, lightning, etc).
2. The product has been repaired, disassembled or modified by non-manufacturer or non-manufacturer authorized technicians.
3. The problem caused by wrong charger does not match the product.
4. Beyond the product warranty period{24-month}.

Documents / Resources

<table><tr><td></td><td>2023.11.07</td></tr><tr><td>A9</td><td></td></tr><tr><td>95*140mm</td><td></td></tr><tr><td>12kg</td><td></td></tr><tr><td></td><td></td></tr><tr><td></td><td></td></tr></table>		2023.11.07	A9		95*140mm		12kg						<p>AVAPOW A9 Car Jump Starter [pdf] User Manual</p> <p>A9 Car Jump Starter, A9, Car Jump Starter, Jump Starter, Starter</p>
	2023.11.07												
A9													
95*140mm													
12kg													

References

- [User Manual](#)

Manuals+, Privacy Policy

This website is an independent publication and is neither affiliated with nor endorsed by any of the trademark owners. The "Bluetooth®" word mark and logos are registered trademarks owned by Bluetooth SIG, Inc. The "Wi-Fi®" word mark and logos are registered trademarks owned by the Wi-Fi Alliance. Any use of these marks on this website does not imply any affiliation with or endorsement.