



AVA Flex Indoor Security Camera User Manual

[Home](#) » [AVA](#) » AVA Flex Indoor Security Camera User Manual 

Contents

- [1 AVA Flex Indoor Security Camera](#)
- [2 Important warnings](#)
- [3 Safety instructions](#)
- [4 Box Content](#)
- [5 Cable routing alternatives](#)
- [6 Installing the bracket](#)
- [7 Federal Communication Commission Interference Statement](#)
- [8 Industry Canada statement](#)
- [9 Documents / Resources](#)
- [10 Related Posts](#)



AVA Flex Indoor Security Camera



Important warnings

- Avoid exposing the camera to shocks, high pressure or temperatures above 40oC.
- Avoid placing the camera near fans, ventilation or other noise sources. This will degrade audio performance.
- Avoid placing the camera near fans, ventilation, or other heat sources. This will degrade sensor performance.
- Avoid scratching or leaving fingerprints on the lens, this degrades image quality. If possible, keep the protective plastic on the lens cover during installation.
- Do not clean the camera with harsh detergents, gasoline or chemicals such as Acetone.
- Do not try to repair the unit yourself. Refer all servicing of the camera to Ava or contact a reseller.

Safety instructions

- Prolonged use of the white LEDs may affect sensor readings.
- This product should be supplied by a Power over Ethernet (PoE) Power Sourcing Equipment (PSE) compliant with IEEE 802.3af or USB-C power source rated 5V 1.5A. The power supply should be UL-listed and marked “Limited Power Source” or “LPS”.
- The camera and the PoE PSE must be installed within the same building, as described by Environment A of the IEEE 802.3af standard. The PoE PSE must be properly grounded.

Box Content

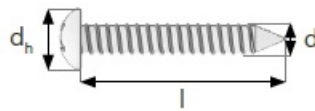
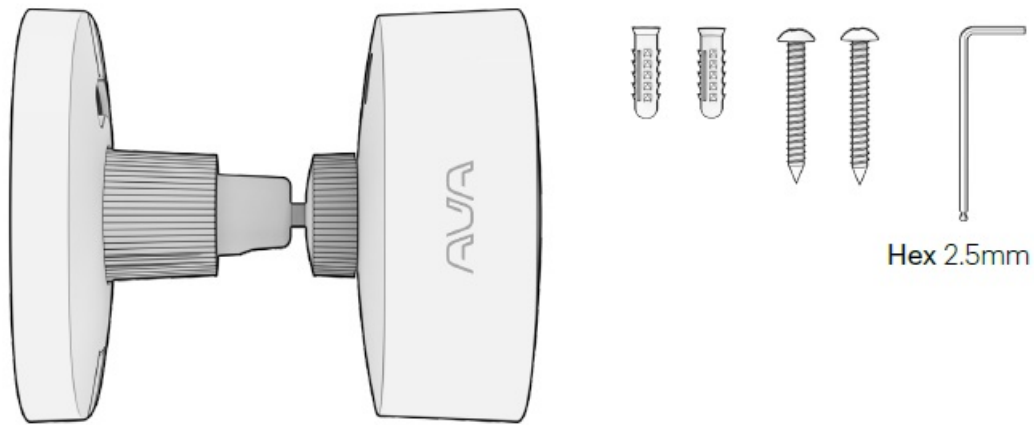

Screw dimensions

$d_h = 9.4 \text{ mm}$

$l = 32 \text{ mm}$

$d = 4 \text{ mm}$

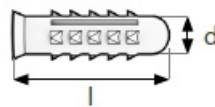

Anchor dimensions

$l = 25 \text{ mm}$

$d = \text{Ø}6\text{mm} / \frac{1}{4}''$

Required

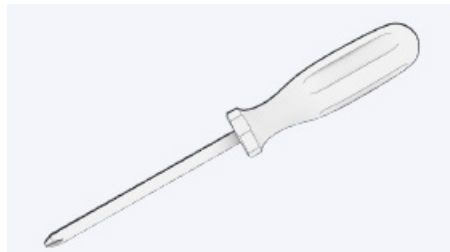

- PH2 screw drive



- Drill with 6mm (1/4") drill bit"

Cable routing alternatives

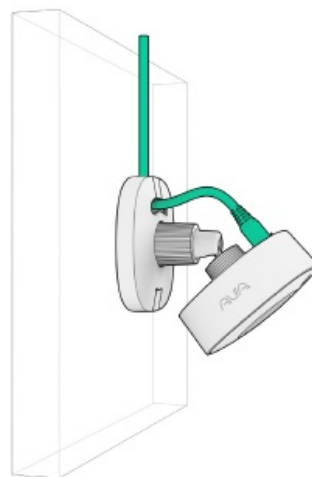
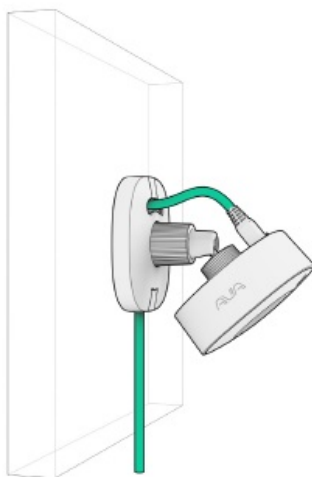
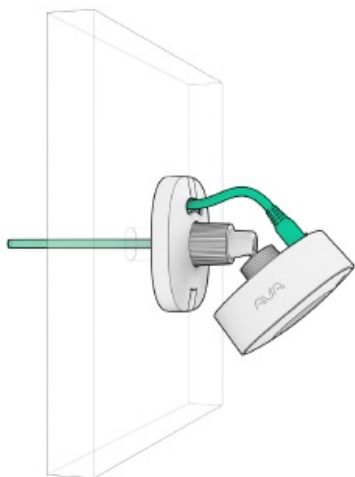

Installing the bracket

1



2

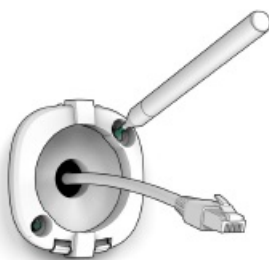

3

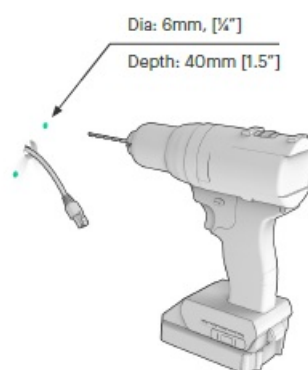

- Through the wall / ceiling cable
- Side entry cable

4A

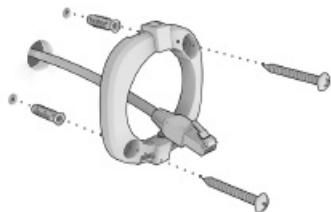

4B

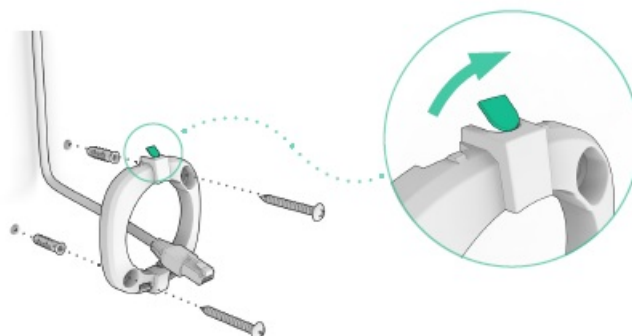

Attaching the camera and connecting the ethernet cable

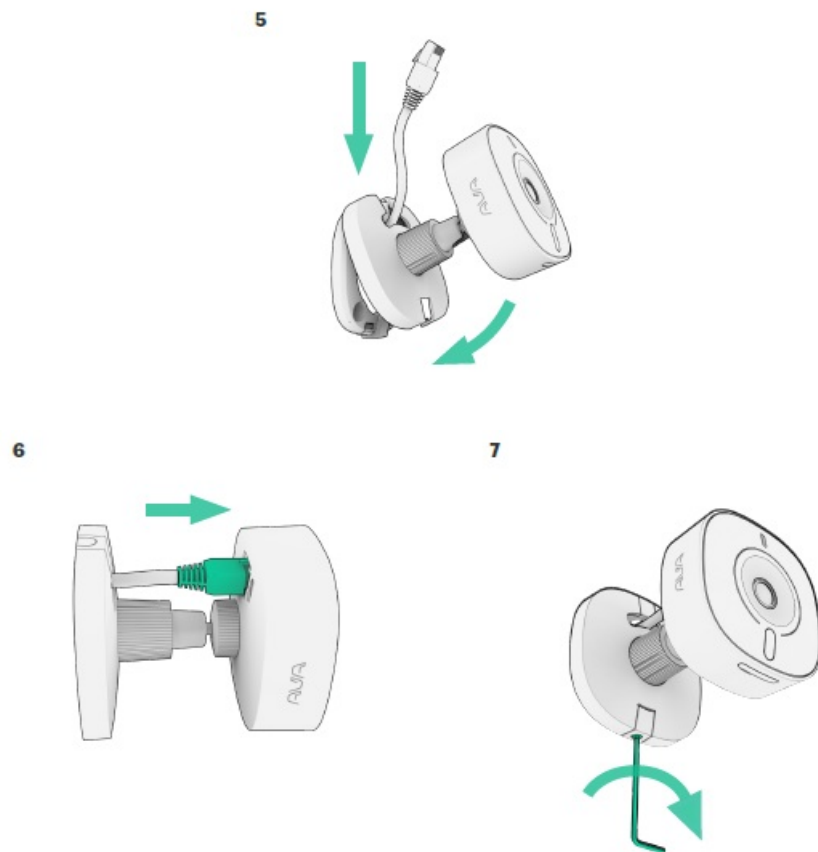

WARNING

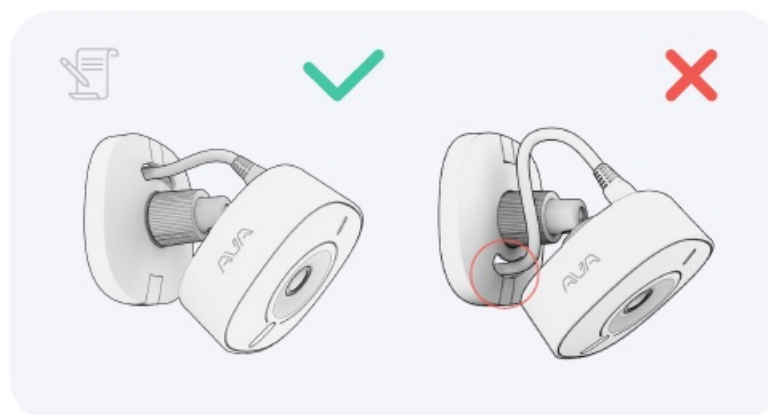

Adjusting the ball joint and video stream

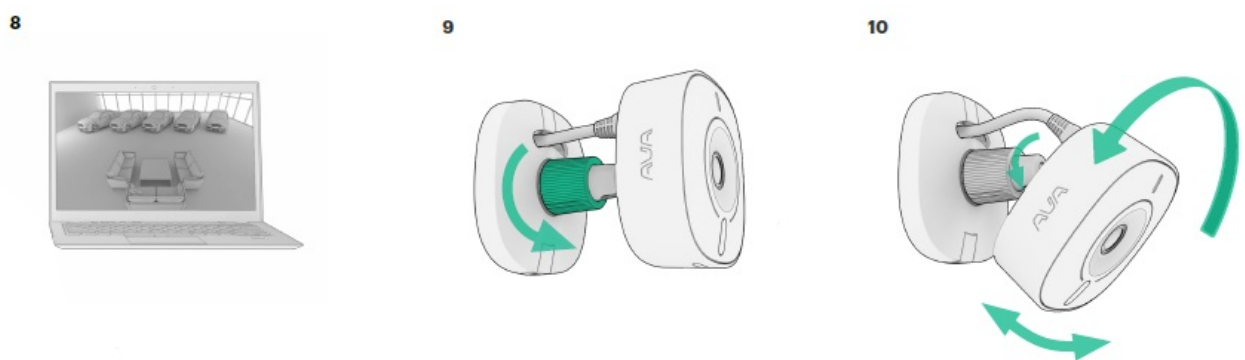

- Adjust the image orientation in Ava Aware.



Federal Communication Commission Interference Statement

This device complies with Part 15 of the FCC Rules. Operation is subject to the following two conditions

1. This device may not cause harmful interference.
2. this device must accept any interference received, including interference that may cause undesired operation.

NOTE: This equipment has been tested and found to comply with the limits for a Class A digital device, pursuant to part 15 of the FCC Rules. These limits are designed to provide reasonable protection against harmful interference when the equipment is operated in a commercial environment. This equipment generates, uses, and can radiate radio frequency energy and, if not installed and used in accordance with the instruction manual, may cause harmful interference to radio communications. Operation of this equipment in a residential area is likely to cause harmful interference in which case the user will be required to correct the interference at his own expense.

FCC Caution: Any changes or modifications not expressly approved by the party responsible for compliance could void the user's authority to operate this equipment. This transmitter must not be co-located or operating in conjunction with any other antenna or transmitter.

Radiation Exposure Statement: This equipment complies with FCC radiation exposure limits set forth for an uncontrolled environment. This equipment should be installed and operated with a minimum distance 20cm between the radiator & your body.

Industry Canada statement

This device complies with ISSED's license-exempt RSSs. Operation is subject to the following two conditions: (1) This device may not cause harmful interference, and (2) this device must accept any interference received, including interference that may cause undesired operation.

Caution: the device for operation in the band 5150-5250 MHz is only for indoor use to reduce the potential for harmful interference to co-channel mobile satellite systems.

Radiation Exposure Statement: This equipment complies with ISSED radiation exposure limits set forth for an uncontrolled environment. This equipment should be installed and operated with greater than 20cm between the radiator & your body.

Documents / Resources

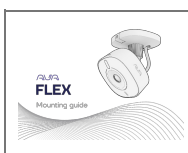

[AVA Flex Indoor Security Camera](#) [pdf] User Manual
 AVAF7D, 2A84E-AVAF7D, 2A84EAVAF7D, Flex Indoor Security Camera, Flex, Indoor Security Camera, Security Camera, Camera

