



AUTOSLIDE AutoPlus Gateway User Guide

[Home](#) » [AUTOSLIDE](#) » AUTOSLIDE AutoPlus Gateway User Guide 

Contents

- [1 AUTOSLIDE AutoPlus Gateway](#)
- [2 Product Information](#)
- [3 Product Usage Instructions](#)
- [4 Requirements](#)
- [5 SETUP](#)
- [6 Using Instructions](#)
- [7 Reset the AutoPlus](#)
- [8 Documents / Resources](#)
 - [8.1 References](#)
- [9 Related Posts](#)

AUTOSLIDE™

AUTOSLIDE AutoPlus Gateway



Product Information

The AutoPlus is a smart device that allows you to control your doors remotely using the Autoslide app. It requires an internet connection, a router with an available ethernet port, and an active Autoslide owner account for AutoSlide, MultiDrive, or AutoSwing. The AutoPlus has LED lights on its front panel that indicate its status. The LED Logo Indicator chart on page 2 of the user manual provides information on the different light colors and their meanings.

Product Usage Instructions

1. Connect the antenna to the back of the AutoPlus and tighten it by turning clockwise. Position the antenna in a straight up position.
2. Plug one end of the Ethernet cord into your router and connect the other end to the back of the AutoPlus.
3. Connect the power cable to the AutoPlus and plug the power adapter into a working outlet.
4. Compare the lights on the AutoPlus to the LED Logo Indicator chart to ensure they are functioning properly.
5. Complete the AutoPlus setup by following the "Pair a Device" instructions in the Autoslide app.
6. After configuration, control your doors with the Autoslide app.

To test the Autoslide app, follow these steps:

1. Open the app.
2. Select your device.
3. Press "Inside" to activate a door opening.

If you need to reset the AutoPlus Gateway, gently insert a paper clip into the pinhole on the back of the unit. This will change the LED status to blue and then back to white. The LED will briefly flash amber while the AutoPlus is resetting and rebooting.

Note: If the LED status is magenta, it means the AutoPlus is searching for a Smart Lock. If it is amber and fading in and out, it indicates that a firmware download is in progress. If it is amber and rapidly blinking, it means the firmware is being updated.

Requirements

- Internet Service.
- Router with available ethernet port.
- Active Autoslide owner account for AutoSlide, MultiDrive, or AutoSwing.

SETUP

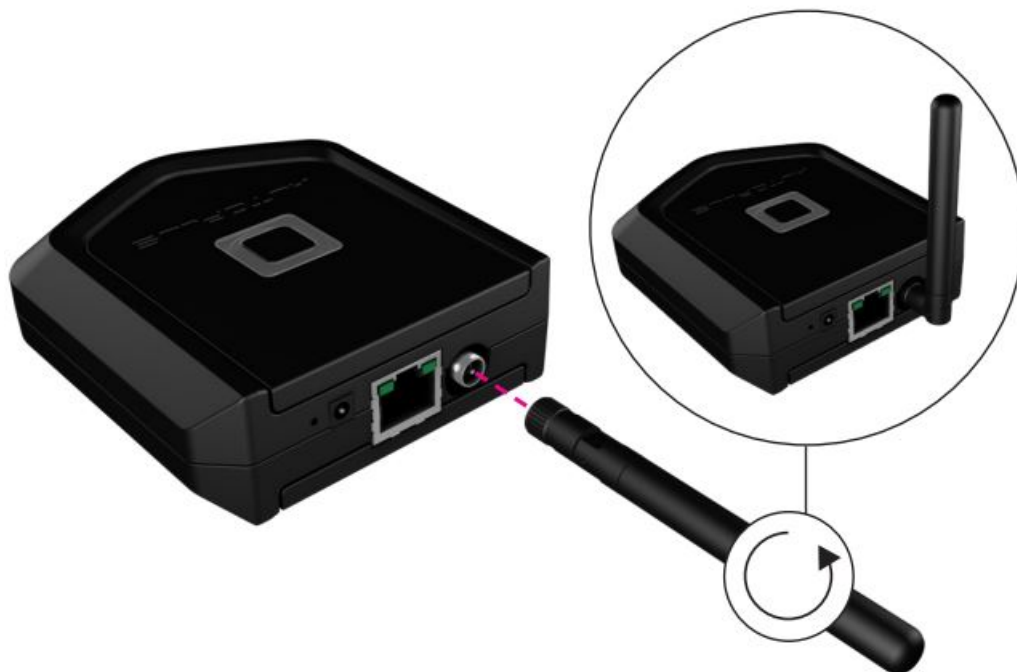

1. Connect the antenna to the back of the AutoPlus and tighten by turning clockwise. Position the antenna to a straight up position.



2. Plug the Ethernet cord into your router and connect the other end to the back of the AutoPlus.



3. Connect the power cable to the AutoPlus and plug the power adapter into a working outlet.



4. Compare the lights on the AutoPlus to the LED Logo Indicator chart on page 2 to ensure they are functioning properly.
5. Complete your AutoPlus setup by following the “Pair a Device” instructions in the Autoslide app. Check these before beginning the pairing process for AutoPlus:
 - An AutoSlide, MultiDrive, or AutoSwing is installed and paired successfully to your phone as the owner.
 - Latest version of the AutoSlide app is downloaded and installed on your phone.
 - AutoPlus is connected to the router and a live internet connection.



6. After configuration, control your doors with the Autoslide app.
 - To test the Autoslide app, open the app, select your device, and press Inside to activate a door opening.

Using Instructions

- **Color:** Meaning
- **White (solid):** Starting up
- **White (fade in and out):** Ready to pair
- **Blue:** Normal operation

- **Amber (blinking):** Factory reset
- **Red:** Not connected to internet
- **Magenta:** Searching for Smart Lock
- **Amber (fade in, fade out):** Firmware download in progress
- **Amber (rapid blinking):** Updating firmware

Reset the AutoPlus



- Reset your AutoPlus Gateway by gently inserting a paperclip into the pinhole on the back of the unit. This will change the LED status to blue and then back to white.
- The LED will briefly flash amber while the AutoPlus is resetting and rebooting.

Documents / Resources

	<p>AUTOSLIDE AutoPlus Gateway [pdf] User Guide AutoPlus Gateway, AutoPlus, Gateway</p>
--	--

References

- [Autoslide – Autoslide – Automatic Sliding Doors for homes](#)

