



# automatic TECHNOLOGY GDO-12 Hiro High Rolling Door Opener User Guide

[Home](#) » [automatic TECHNOLOGY](#) » automatic TECHNOLOGY GDO-12 Hiro High Rolling Door Opener User Guide 

## Contents

- [1 automatic TECHNOLOGY GDO-12 Hiro High Rolling Door Opener](#)
- [2 User Operating Controls](#)
- [3 Manual Door Operation](#)
- [4 Coding a Remote Control](#)
- [5 Smart Phone Control \(Requires Smart Hub\)](#)
- [6 Troubleshooting](#)
- [7 Caring for your Opener](#)
- [8 Need a Service Call?](#)
- [9 Documents / Resources](#)
  - [9.1 References](#)
- [10 Related Posts](#)

automatic  
TECHNOLOGY

automatic TECHNOLOGY GDO-12 Hiro High Rolling Door Opener



## User Operating Controls

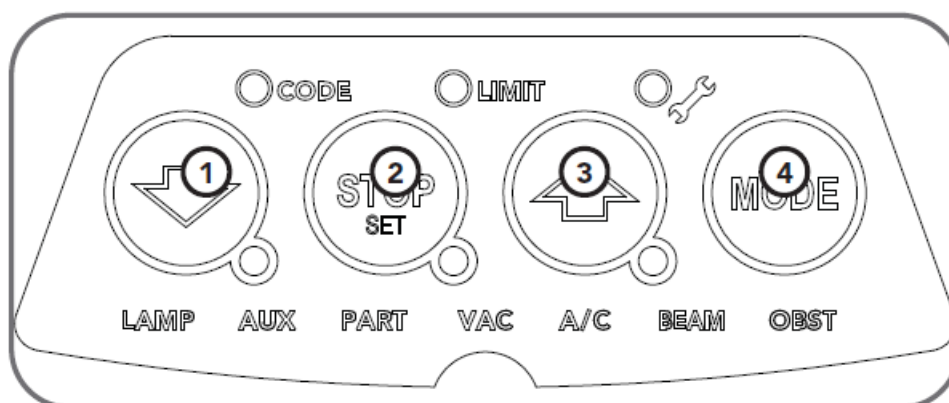

Button	Function
01	Close
02	Stop / Set Button
03	Open
04	Mode

## Manual Door Operation

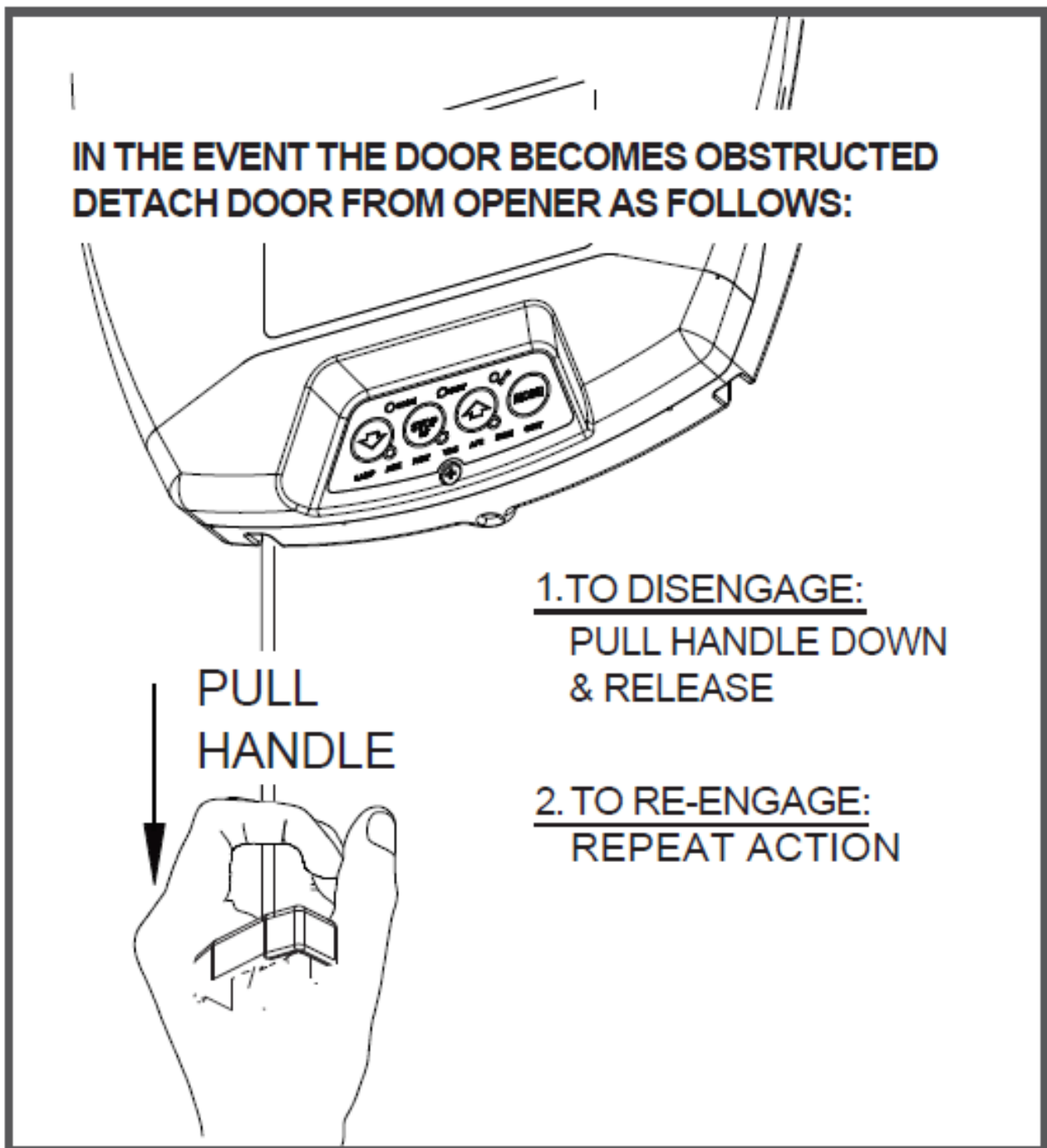

### To Disengage the Opener:

1. It is recommended to do so with the door in the closed position.
2. Pull the manual release cord towards the door, until you hear a click.

3. Move the door manually.

**CAUTION:** When the opener is manually disengaged, the door is no longer locked. To lock the door manually, re-engage the opener after the door is closed.

### **To Re-Engage the Opener:**

1. Check the door has not been locked by a locking device.
2. Pull the manual release cord away from the door, until you hear a click.
3. The door will now operate from the opener.

**WARNING!** Please test the manual release mechanism to ensure that the manual release is easy to operate. No more than 20kg of force should be required to disengage the door using the manual release cord. If excessive force is required, contact your dealer.

## **Coding a Remote Control**

### **Storing the Remote Control Code:**

The GDO-12 HiRoTM can store up to sixty four (64) transmitters in its memory.

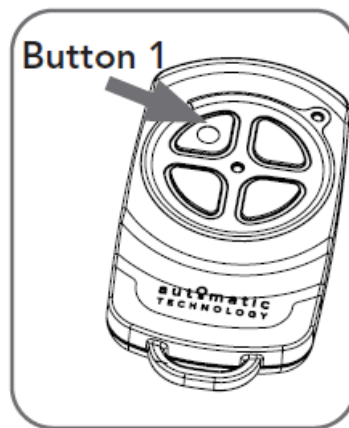

1. Press the MODE button to highlight the CODE LED.
2. Press OPEN or CLOSE button until BLUE CLOSE, RED STOP/SET and GREEN OPEN LEDs are on.
3. Press and hold the STOP / SET button to enter the code set procedure.
4. Press the remote control button you wish to use to operate the door opener (e.g. button 1) and hold for 2 seconds then release.
5. Press the same remote control button again and hold for seconds, then release.
6. Release the STOP / SET button.

### **Battery Replacement:**

**Battery Type: 1 x CR2032.**

1. To test the battery is working, press and hold a remote button. Check Light Status table to determine if battery needs replacing.

Light Status	Battery Status
Solid	OK
Flashing	Replace
No light	Replace

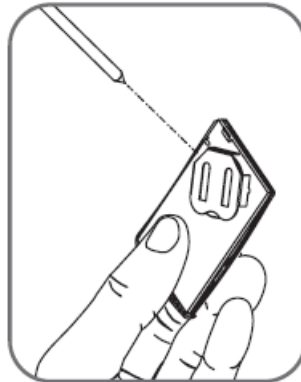

2. Use finger nails to separate the remote casing to expose circuit board.
3. Use a non-metallic object to push the battery down through the side opening to remove the battery.

**WARNING!**

The battery is hazardous and must be kept out of reach of children. The battery can cause severe or fatal injuries within 2 hours or less if swallowed or placed inside any part of the body. If you suspect the battery has been swallowed or placed inside any part of the body, SEEK IMMEDIATE medical attention.

## Smart Phone Control (Requires Smart Hub)

### Connecting to WiFi:

The Smart Phone Control works via your home's WiFi network. Initial set up involves linking your phone app, smart hub and opener to your home network.

1. Download the ATA App.
2. Ensure the WiFi router is within range of the Smart hub.
3. Connect the Smart Hub to power.
4. Locate the registration card for the opener.
5. Go to phone settings, then WiFi and select (ATA000000).
6. Open App and tap on Start.
7. Select setup a new Smart Hub.
8. Follow on screen instruction in the ATA App.
9. Upon completion, test the opener operation through the ATA App.



## Troubleshooting

5.0 Troubleshooting		
Symptom	Possible cause	Remedy
The opener does not work from the remote	The opener does not have power	Plug a device of similar voltage (e.g. a hairdryer) into the power point and check that it is OK
	The battery in the remote control is flat	Replace the battery
	The remote button is not programmed to operate the door.	Code in the remote control button
One remote works but the other/s do not	Faulty remote control Flat battery	Replace remote control Check battery status and replace battery
The motor is running but the door remains stationary	The opener is disengaged	Re-engage the opener
The remote	Variations are normal	Make sure you can see the door when
range varies or is restricted	depending on conditions e.g. temperature or external interference	you use the remote control.
The door reverses for no apparent reason	This may occur occasionally from environmental conditions such as areas that are windy, dusty or have extreme temperature changes.	Put the door into manual (section 2, take note of the CAUTION) and contact 1300 133 944.
The Open LED	Opener is overloaded	Discontinue use and contact
and Close LED		1300 133 944 for support.

are flashing		
alternatively		
The Open LED continues to flash	Door obstructed when opening	Clear away any obstructions and test door opens correctly. (If door is damaged, contact a door professional).
The Close LED continues to flash	Limits may be cleared	Remove all power sources. Wait (10-15 secs), then reconnect power. If Blue LED is flashing, limits are not set. contact 1300 133 944 for support.

## Caring for your Opener

Preventative servicing of your garage door and opener, is important. Your garage door is made up of numerous moving parts designed to lift and lower your door safely and efficiently.

Ongoing preventative servicing ensures that your door continues to function within factory specifications, greatly reduces the risk of failure and repair bills down the track and ensures you maintain your Warranty.

Refer to your Owners Opener Handbook for your service schedule.

### TIP

Refer to the installation manual for monthly testing procedures in Section 6.6 to ensure garage door is fit for use.

## Need a Service Call?

If the opener needs a service please call the dealer who installed the garage door opener (their contact details are usually on a sticker on the back of your garage door).



Scan: for installation manual

For product assistance, general enquiry or more information, please visit:

[ata-aust.com.au](http://ata-aust.com.au)

or call 1300 133 944.

## Documents / Resources

	<a href="#">automatic TECHNOLOGY GDO-12 Hiro High Rolling Door Opener</a> [pdf] User Guide GDO-12 Hiro, High Rolling Door Opener, GDO-12 Hiro High Rolling Door Opener, 87806, 1604 41_01
---	---

## References

-  [Automatic Garage Door Openers and Gate Openers - Repairs - ATA](#)

Manuals+.