



AUTOMATE Push 15 Remote User Guide

[Home](#) » [AUTOMATE](#) » AUTOMATE Push 15 Remote User Guide 

Contents

- [1 AUTOMATE Push 15 Remote](#)
- [2 SAFETY](#)
- [3 FCC & ISED STATEMENT](#)
- [4 ASSEMBLY](#)
- [5 BATTERY MANAGEMENT](#)
- [6 BUTTON OVERVIEW](#)
- [7 WALL MOUNTING](#)
- [8 P1 LOCATIONS](#)
- [9 HOW TO CHARGE LI-ION ZERO WIRE-FREE MOTOR](#)
- [10 REPLACE BATTERY](#)
- [11 INSTALLER](#)
- [12 MOTOR RESET PROCEDURE](#)
- [13 User Guide](#)
- [14 Documents / Resources](#)
- [15 Related Posts](#)

AUTOMATE™

AUTOMATE Push 15 Remote



SAFETY

WARNING: Important safety instructions to be read before installation and use.

Incorrect installation or use can lead to serious injury and will void the manufacturer's liability and warranty. It is important for the safety of persons to follow the enclosed instructions.

Save these instructions for future reference.

- Do not expose to water, moisture, humid and damp environments or extreme temperatures.
- Persons (including children) with reduced physical, sensory or mental capabilities, or lack of experience and knowledge, should not be allowed to use this product.
- Use or modification outside the scope of this instruction manual will void the warranty.
- Installation and programming to be performed by a suitably qualified installer.
- Follow installation instructions.
- For use with motorized shading devices.
- Frequently inspect for improper operation.
- Do not use if repair or adjustment is necessary.
- Keep clear when in operation.
- Replace the battery with correctly specified type.

WARNING: Do not ingest battery, Chemical Burn Hazard.

This product contains a coin/button cell battery. If the coin/button cell battery is swallowed, it can cause severe internal burns in just 2 hours and can lead to death.

Keep new and used batteries away from children. If the battery compartment does not close securely, stop using the product and keep it away from children.

If you think batteries might have been swallowed or placed inside any part of the body, seek immediate medical attention.

FCC & ISED STATEMENT

This device complies with part 15 of the FCC Rules. Operation is subject to the following two conditions:

- (1) This device may not cause harmful interference, and
- (2) this device must accept any interference received, including interference that may cause undesired operation.

Caution: Changes or modifications to this unit not expressly approved by the party responsible for compliance could void the user's authority to operate the equipment.

This device contains licence-exempt transmitter(s)/receivers that comply with Innovation, Science and Economic Development Canada's licence-exempt RSS(s). Operation is subject to the following two conditions:

- (1) This device may not cause interference.
- (2) This device must accept any interference, including interference that may cause undesired operation of the device.

NOTE: This equipment has been tested and found to comply with the limits for a Class B digital device, pursuant to part 15 of the FCC Rules. These limits are designed to provide reasonable protection against harmful interference in a residential installation. This equipment generates, uses and can radiate radio frequency energy and, if not installed and used in accordance with the instructions, may cause harmful interference to radio communications. However, there is no guarantee that interference will not occur in a particular installation. If this equipment does cause harmful interference to radio or television reception, which can be determined by turning the equipment off and on, the user is encouraged to try to correct the interference by one or more of the following measures:

- Reorient or relocate the receiving antenna.
- Increase the separation between the equipment and receiver.
- Connect the equipment into an outlet on a circuit different from that to which the receiver is connected.
- Consult the dealer or an experienced radio/TV technician for help.

ASSEMBLY

Please refer to separate Rollease Acmeda System Assembly Manual for full assembly instructions relevant to the hardware system being used.

BATTERY MANAGEMENT

For battery motors;
Prevent discharging the battery completely
for extended periods, recharge as soon as
the battery is discharged

CHARGING NOTES

Charge your motor for 6-8 hours, depending
on the motor model, as per motor instructions

During operation, if the battery is low, the motor will beep 10 times to prompt the user it needs charging.

BUTTON OVERVIEW

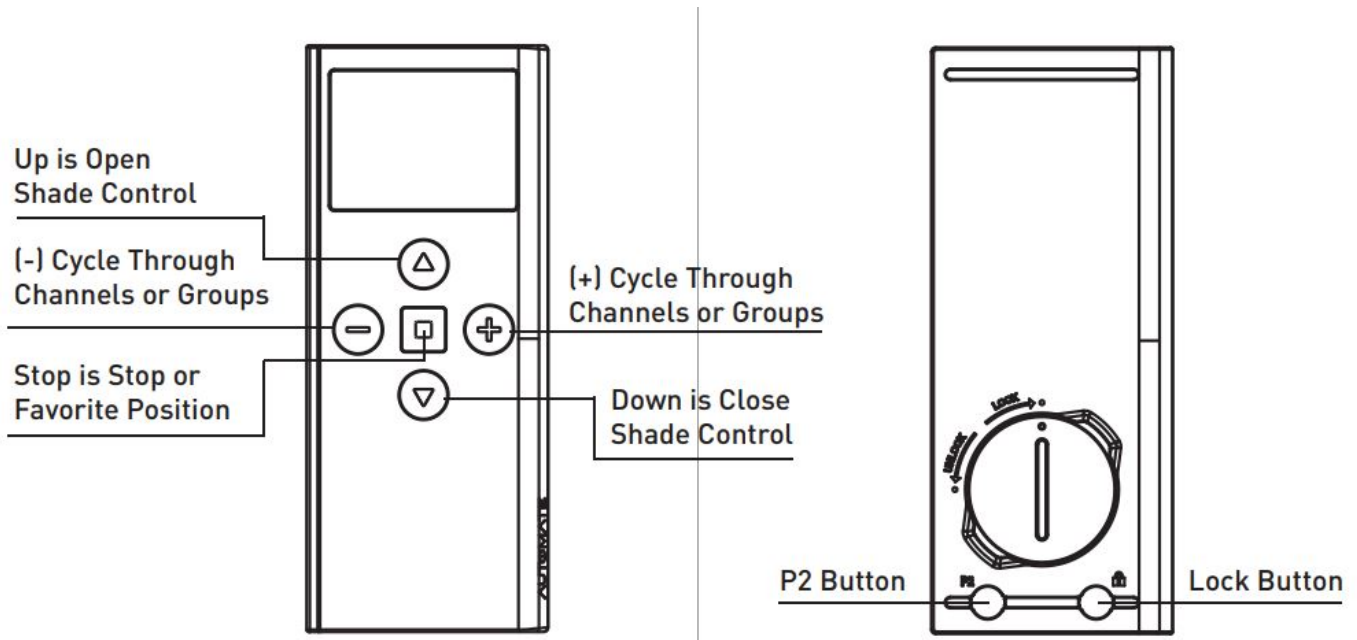

WALL MOUNTING

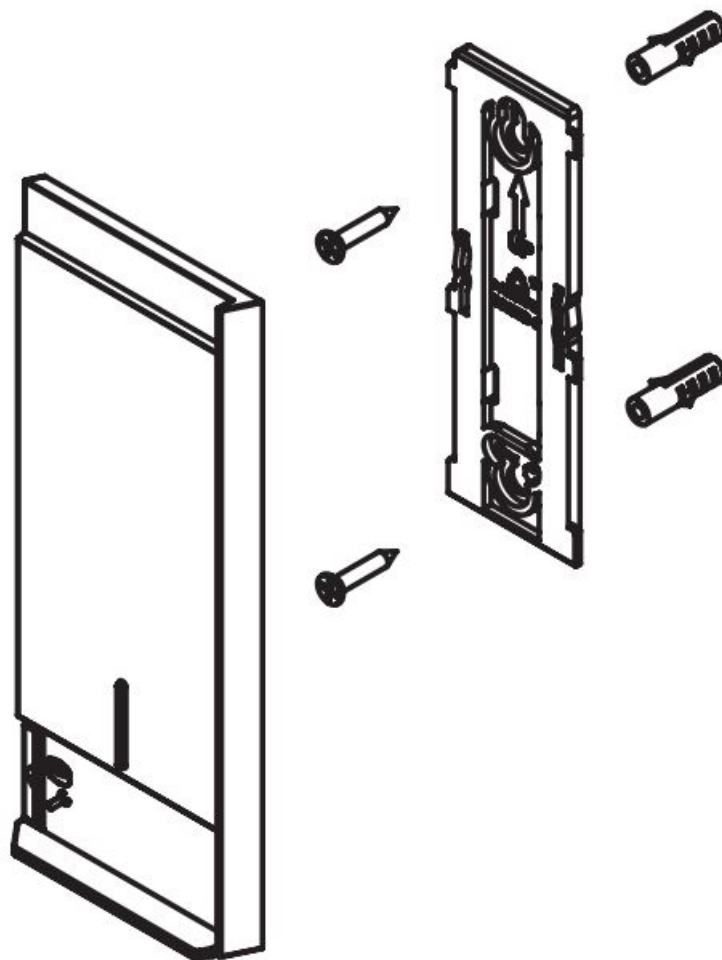

Use supplied fasteners and anchors to attach the base to wall.

P1 LOCATIONS

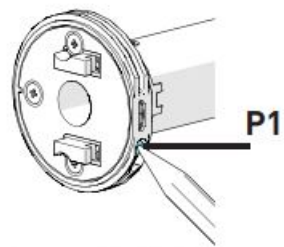

Internal Tubular

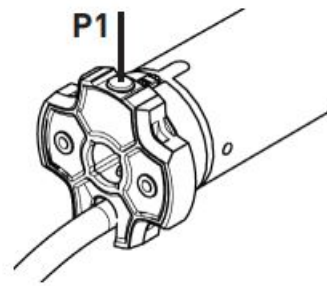

Large Tubular

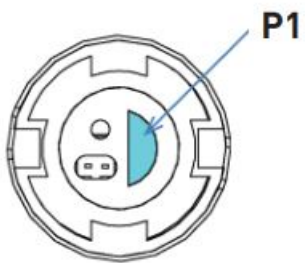

0.6 Cord Lift

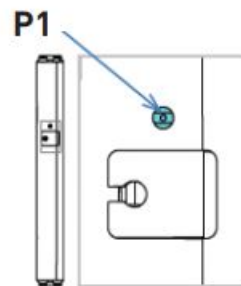

0.8 Cord Lift

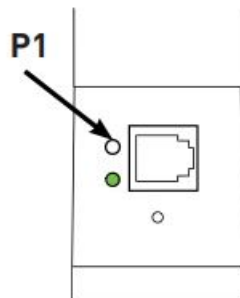

Curtain

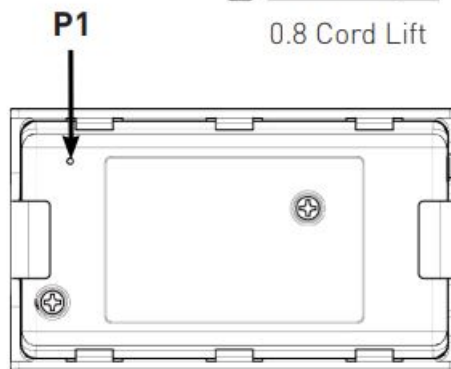

Tilt Motor

HOW TO CHARGE LI-ION ZERO WIRE-FREE MOTOR



- **STEP 1**

Rotate cover cap to expose motorhead

- **STEP 2**

Find the nearest power source and plug in charger [use an extension cord if required!]

- **STEP 3**

Plug micro USB end into the motor

- Observe the green light flashing and charge until the green light goes solid green
- Please note this may take up to eight hours depending on how flat your battery is
- Any mobile phone charger can also be used to charge your molar

- **STEP 4**

Unplug and return cover cap to conceal motor head

REPLACE BATTERY

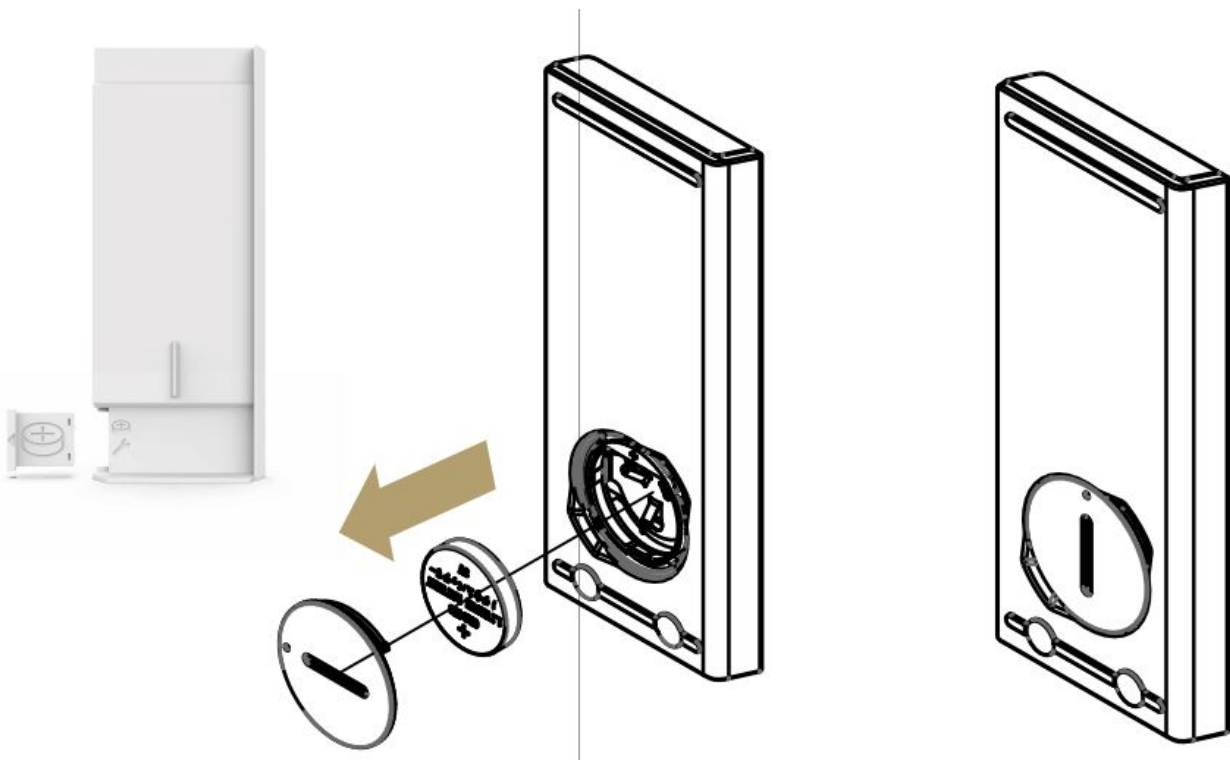

- Twist the battery cover with coin/ to I provided in the cradle, to Unlock and replace the battery negative side racing up.
- Replace the cover by turning the cover to the locked position

INSTALLER

ON REMOTE

- STEP 1.

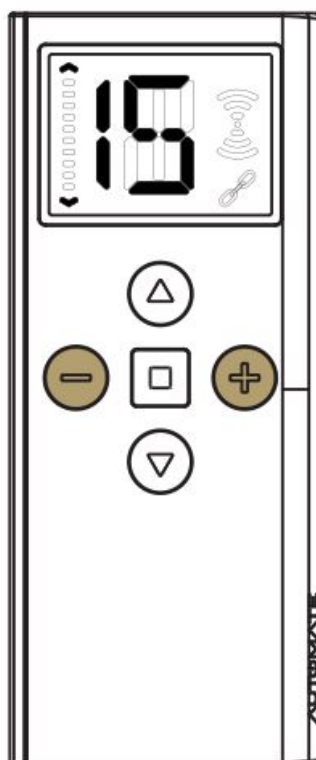

Select the desired channel you wish to program scrolling using the + or – Buttons

- STEP 2.

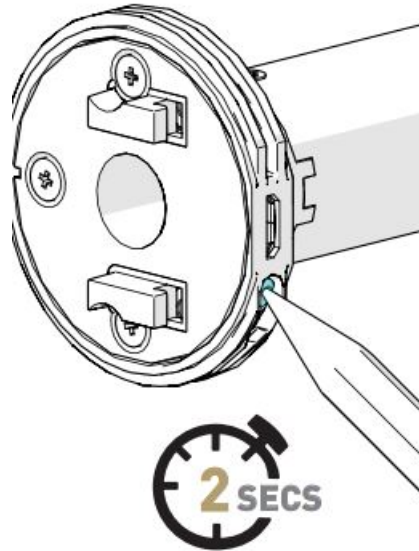

* Internal Tubular pictured. Refer to “P1 Locations” for specific devices

Press the P1 button on the motor for 2 Seconds until the motor responds as below



Within 4 seconds hold the stop button on the remote for 3 seconds.

The motor will respond with Jog and Beep



CHECK DIRECTION

- STEP 3

Press up or down to check the motor direction. If correct skip to step 5.

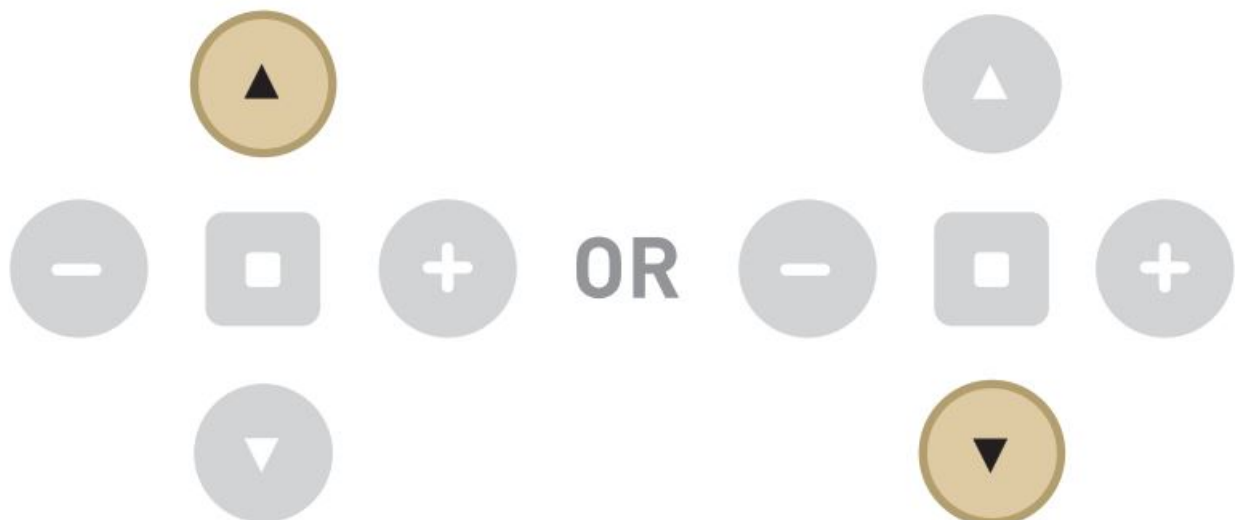

CHANGE DIRECTION

- STEP 4

If the shade direction needs to be reversed; press and hold the up & down arrow together for 5 seconds until the motor Jogs.

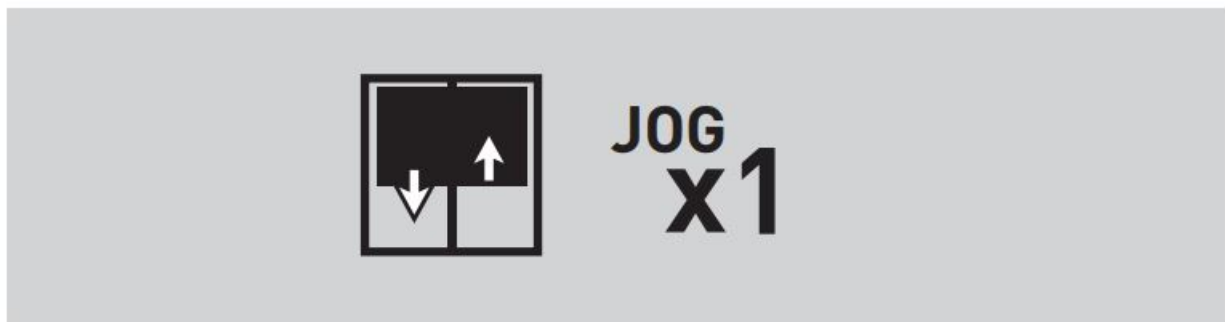
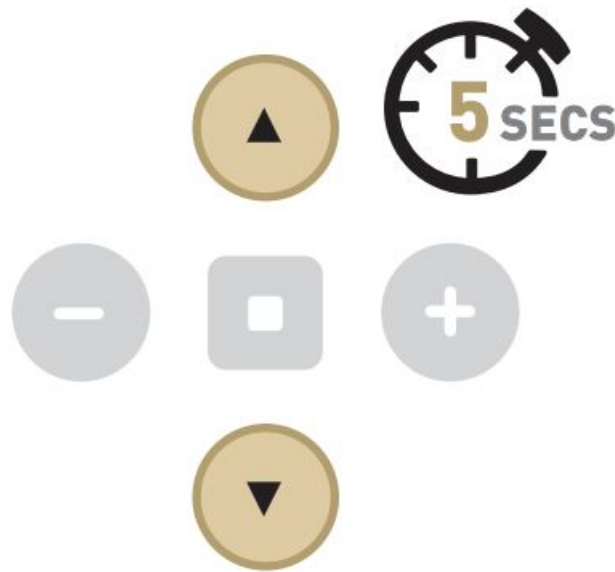

Reversing motor direction using this method is only possible during initial set-up.

SET TOP LIMIT

- STEP 5

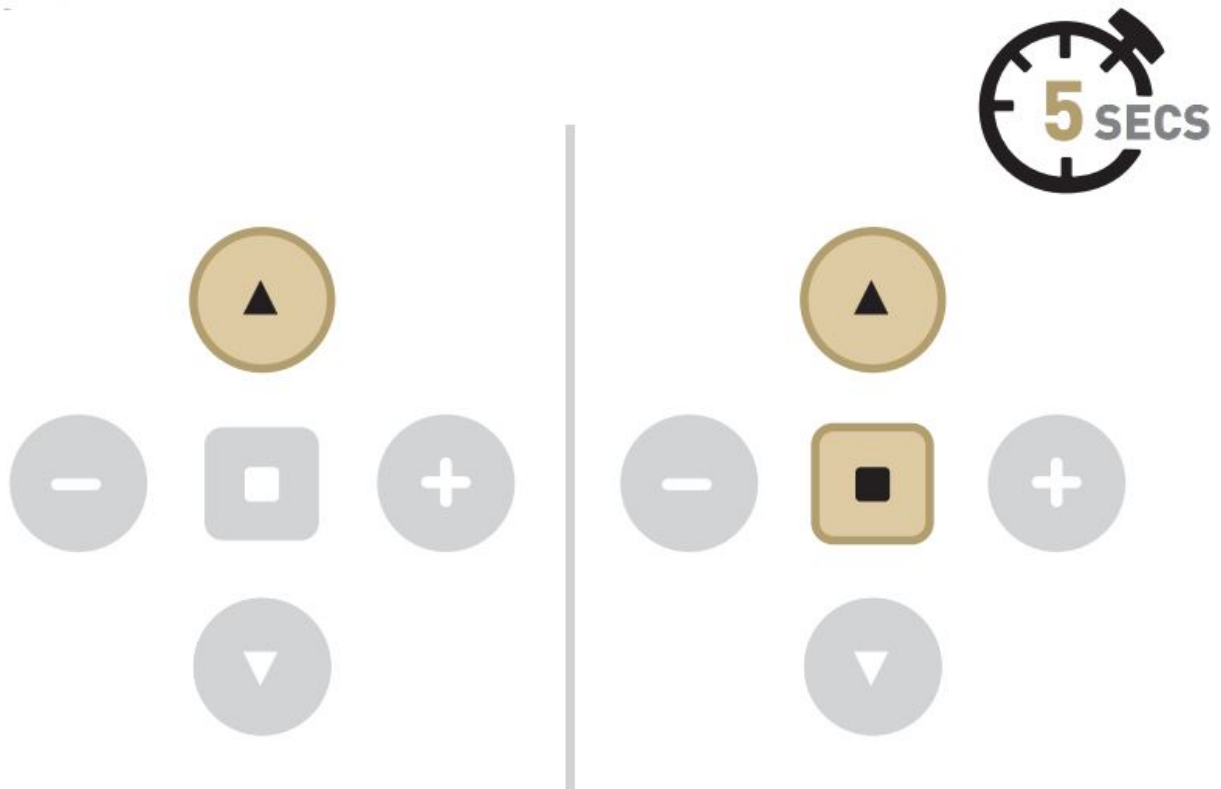

Move shade to desired top limit by pressing the up arrow repeatedly. Then press and hold up & stop together for 5 sec to save limit. Tap the arrow several times or hold down if needed: press arrow to stop.



• STEP 6

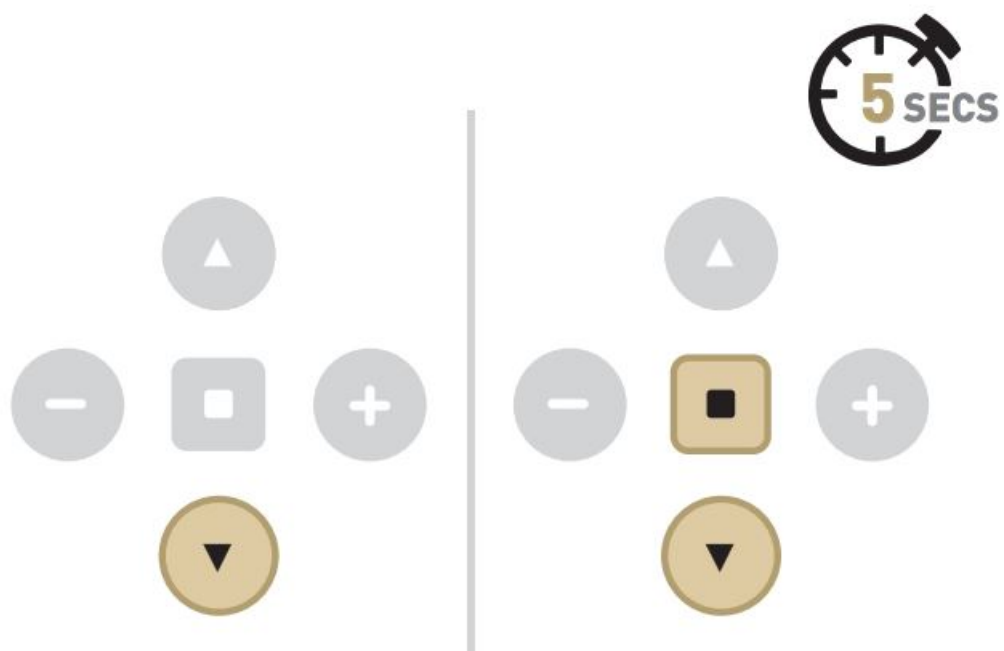

Move shade to desired bottom limit by pressing the down arrow repeatedly Then press and hold down & stop together for 5 sec to save limit

Tap the arrow several times or hold down if needed; press arrow to stop.



SAVE LIMIT

- STEP7

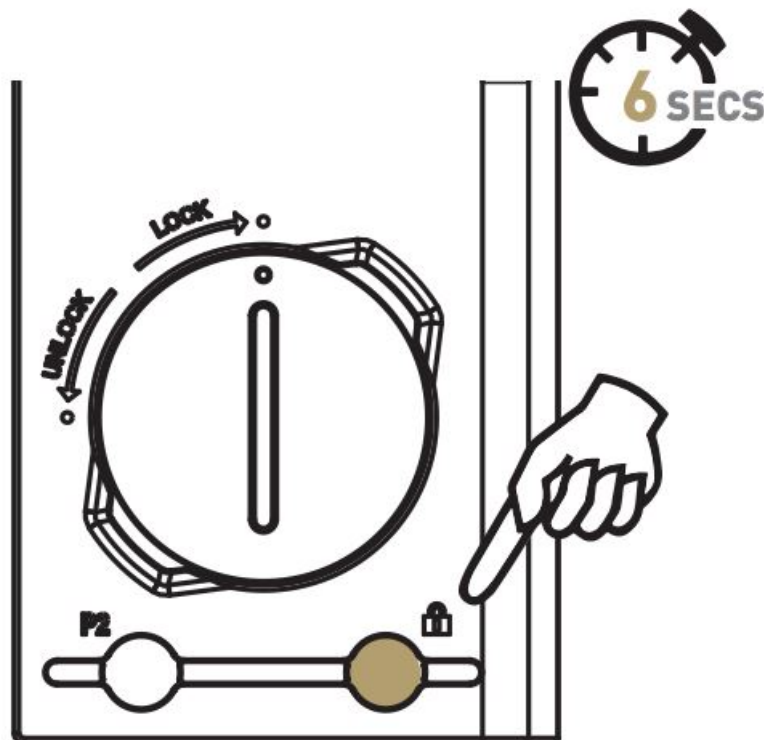

Repeat steps 1-6 for other motors Once complete Press and hold the Lock button for 6 seconds while looking at the LED. and hold until L displayed.

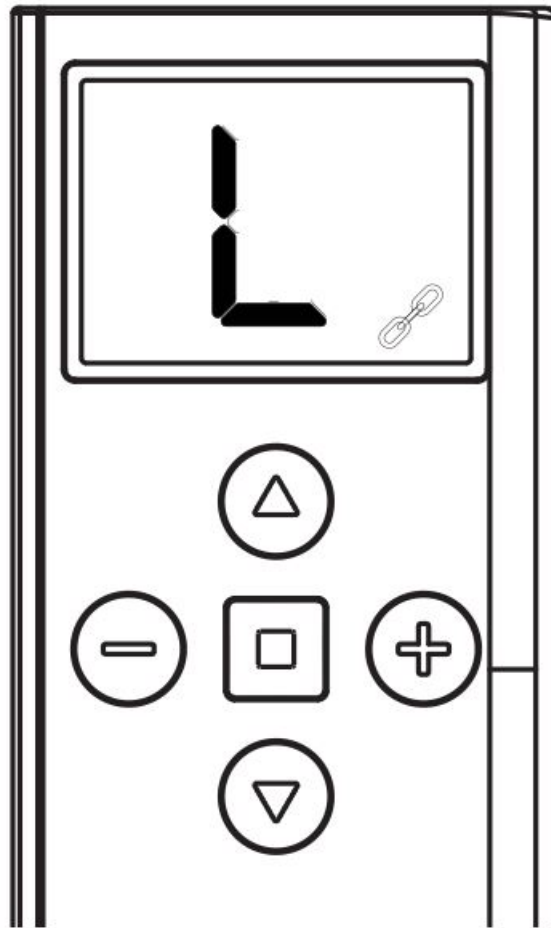

MOTOR RESET PROCEDURE

FACTORY RESET

To reset all settings in the motor press and hold the P1 Button for 14 seconds, you should see 4 independent jogs followed by 4x Beeps at the end.

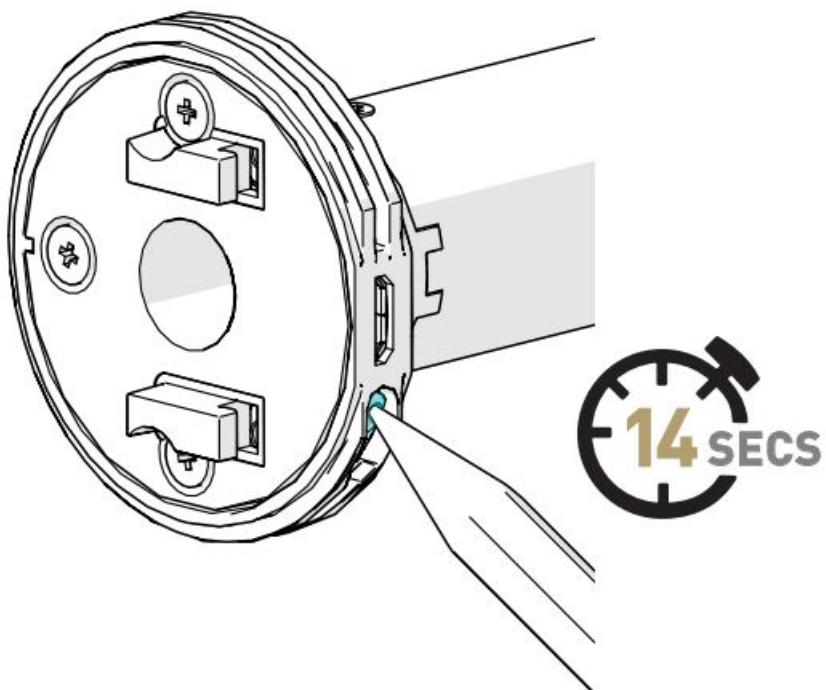

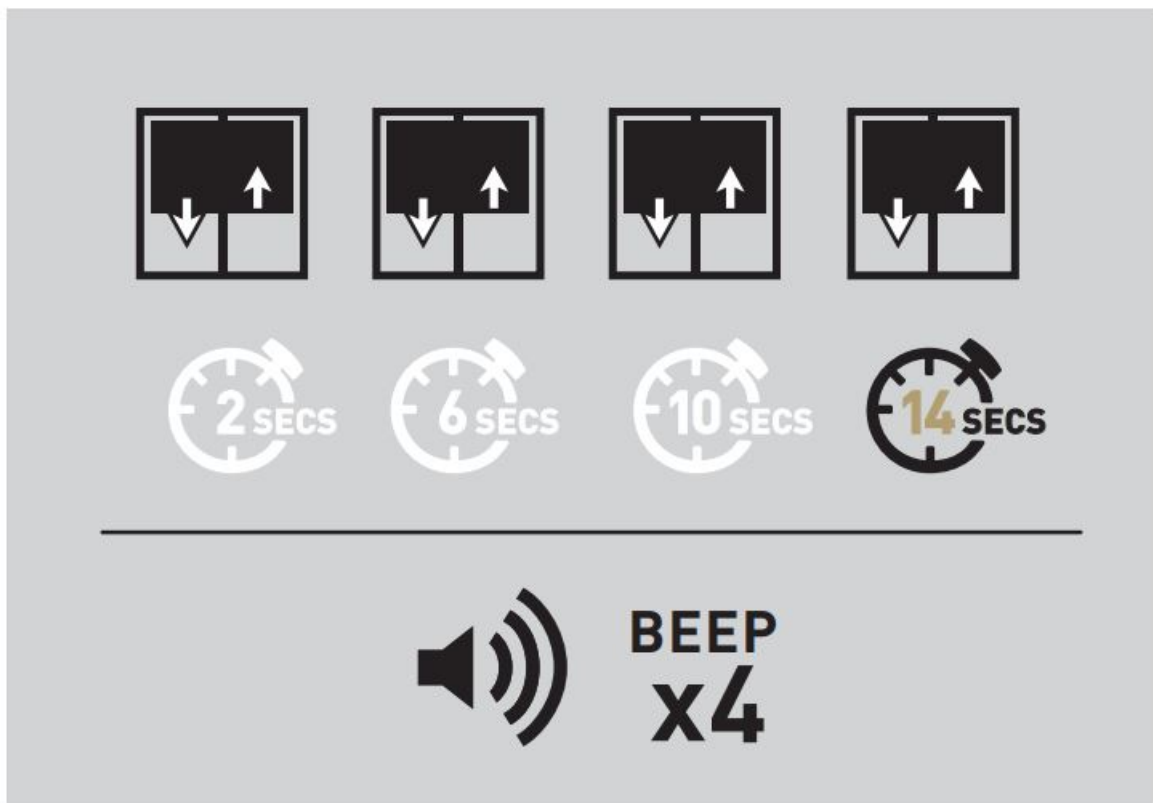

User Guide

GROUP CHANNEL PROGRAMMING MODE

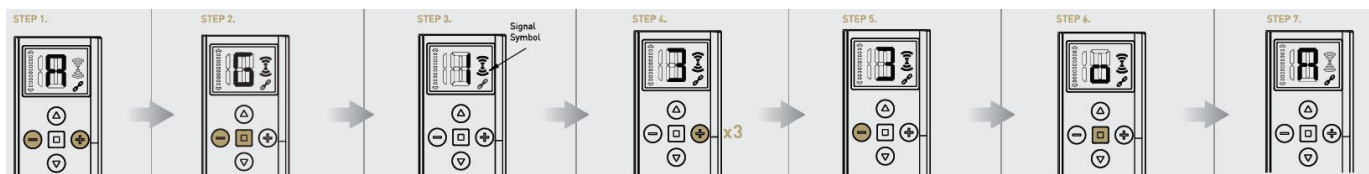

1. Select a Group Channel to program A-E
2. Hold 1-1 and STOP buttons for 4 seconds, during this time "G" will be displayed. Select a Group Channel to program A-E [If no buttons are pressed for 90 seconds the remote will exit out of this mode]
3. Remote is now in Group Channel Programming Mode. Signal Symbol will be shown and Individual Channel 1 will be displayed
4. Use [+I] button to cycle to desired Individual Channel you want to add to that group [Channel 3 used as an example)
Note: Only 1+1 button can be used to cycle through channels
5. Use [-I] button to toggle on/off the inclusion into the Group Channel Note: Group Channel Indicator will be shown to indicate Channel is added)
6. Once desired Individual Channels have been added, press the STOP button to confirm changes. The screen above will be shown for 4 seconds
7. The remote has now returned to Normal Mode. The Group Channel is ready to use

GROUP CHANNEL VIEW ODE

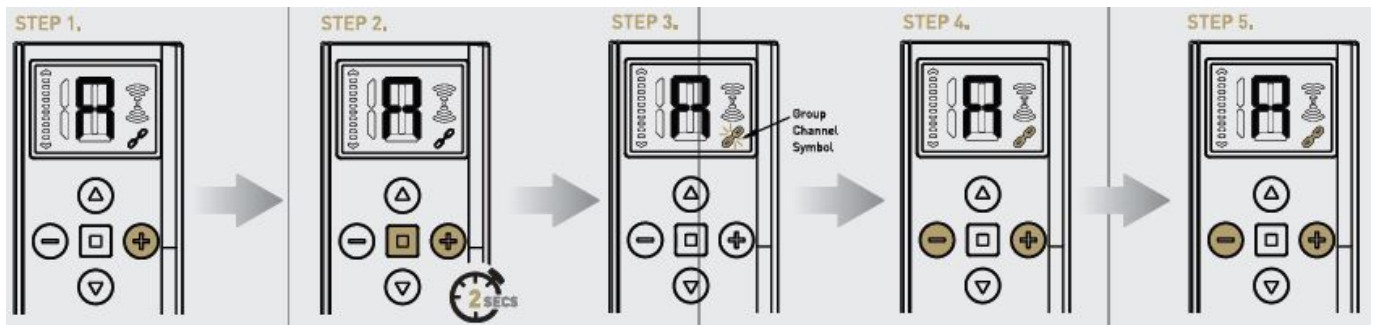

1. Cycle past Channel 1-15 and Select a Group Channel A-E to view
2. Once you on the Groups Channels that you would like to view Hold [+I and STOP buttons for 2 seconds
3. Remote is now in Gro p Channel Viewing Mode. Linked Symbol will flash hand added Individual Channels will be displayed
4. Use [+I and [-I buttons to scroll included channels.
5. Use [+I and [-I buttons to scroll included channels

LEVELING CONTROL FUNCTION

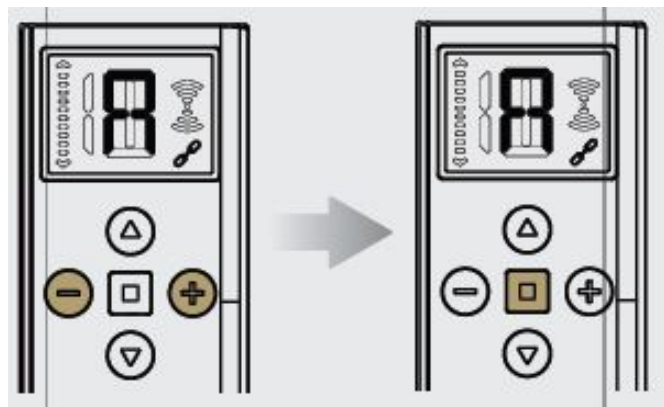

- Sele t the desired Channel or G up you would like to control.
- Double Tap the stop Button not the Level Control Bar Now Press up or down to set the desired shade percentage. after 2 seconds the shade/swill move to that percentage.

CHANNEL OR GROU SELECTION

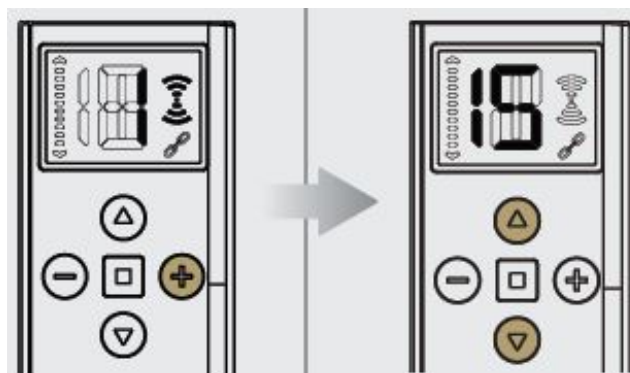

- Press I+I to Cycle through Channels or groups.
- Once you selected the desired channel or group press Up and Down Buttons to send open or close commands

HIDE GROUPS

1.

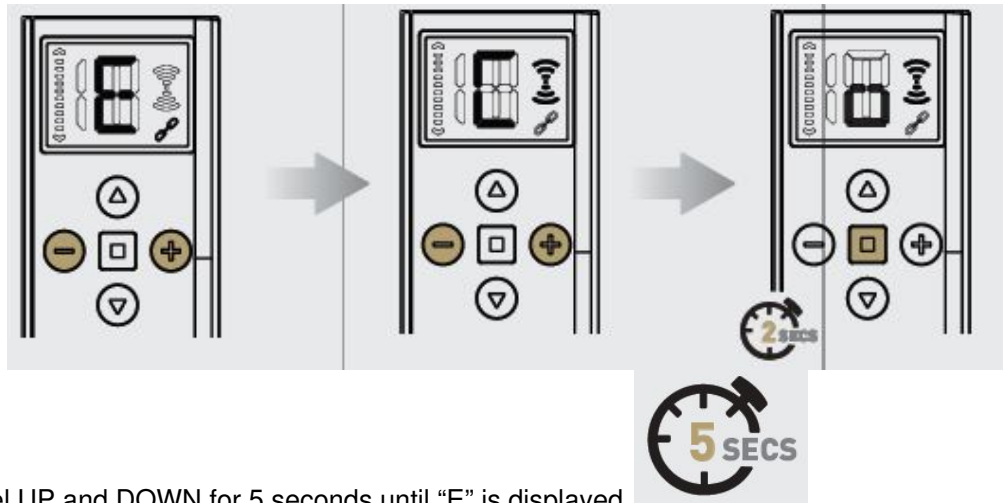

Hold Channel UP and DOWN for 5 seconds until “E” is displayed.

2. Select+ or – and scroll through all channels that you want to hide
3. Press and hold STOP to confirm. The letter ··o· will be displayed.

HIDE CHANNELS

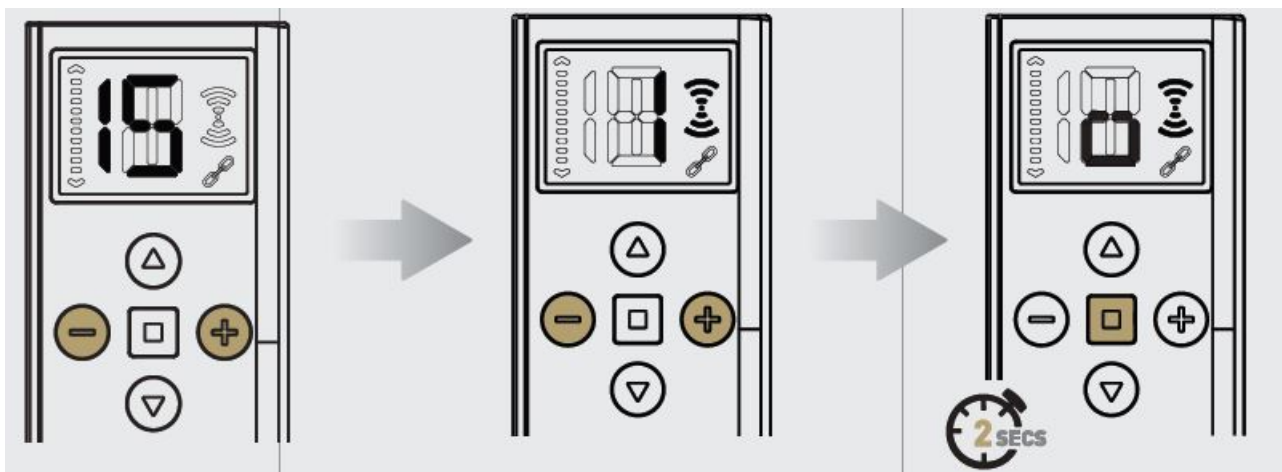

1. Hold Channel UP and DOWN for 5 seconds until 15 is displayed.
2. Select+ or – and scroll through all channels that you want to hide
3. Press and hold STOP to confirm. The letter “a” will be displayed.

DISABLE LIMIT SETTING

This mode is intended to be used after all shade programming is completed. User mode will prevent accidental or unintended changing of limits.

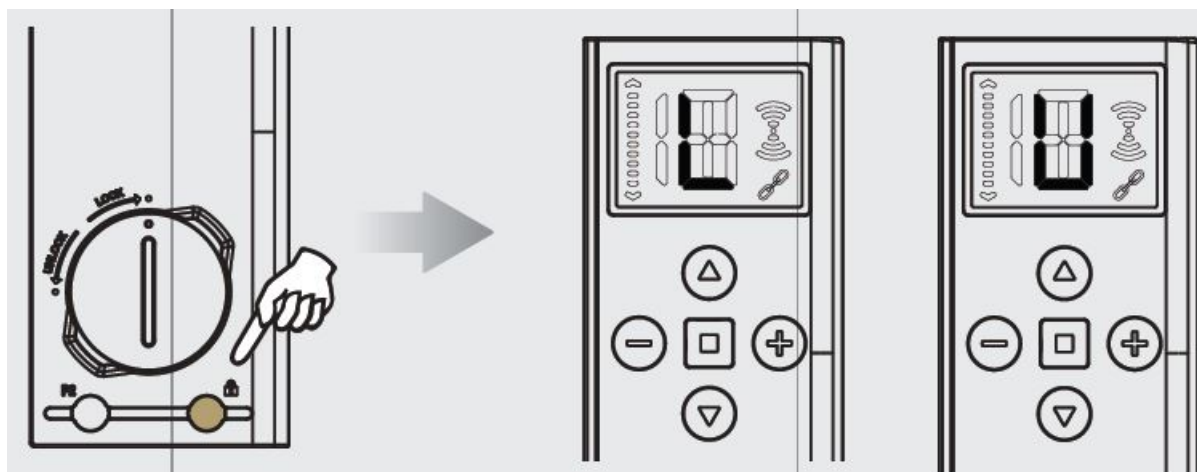

1. Push switch to lock or unlocked position .

SET A FAVORITE POSITION

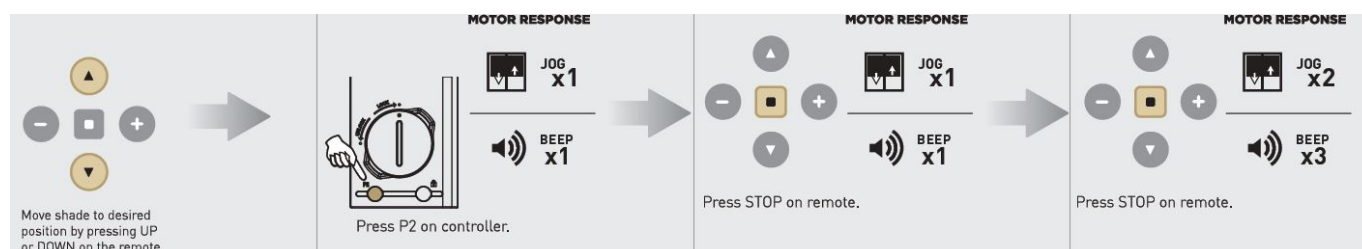

ADD OR DELETE CONTROLLER OR CHANNEL

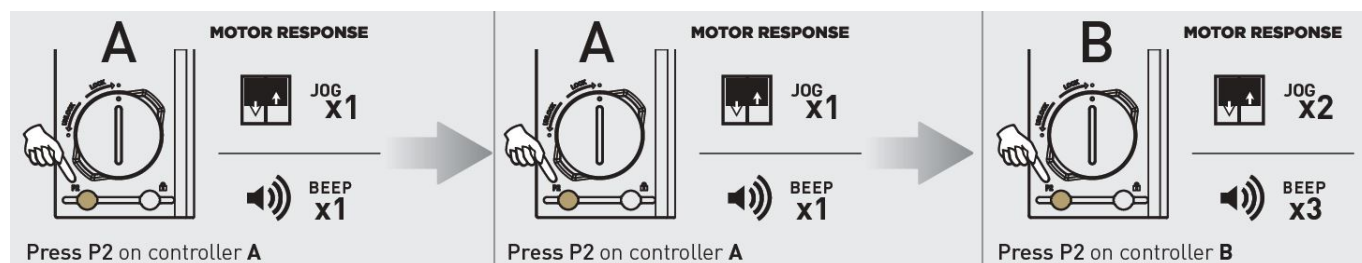

Documents / Resources

[AUTOMATE Push 15 Remote](#) [pdf] User Guide
MT020101008, 2AGGZMT020101008, Push 15 Remote