



# AUTO-VOX 304-SL1PRO001 Solar Powered Wireless Reversing Camera Kit User Manual

[Home](#) » [AUTO-VOX](#) » **AUTO-VOX 304-SL1PRO001 Solar Powered Wireless Reversing Camera Kit User Manual**



## Contents

- [1 AUTO-VOX 304-SL1PRO001 Solar Powered Wireless Reversing Camera Kit User Manual](#)
- [2 Introduction](#)
- [3 Package Contents](#)
- [4 Pre-Installation Note](#)
- [5 Charge the Backup Camera](#)
- [6 Note:](#)
- [7 Installation](#)
- [8 Install the Monitor 1. ~ w IS @](#)
- [9 Operational Instructions](#)
- [10 Battery Condition Indicator](#)
- [11 Troubleshooting](#)
- [12 Specifications](#)
- [13 Care and Maintenance](#)
- [14 Warranty and Service](#)
- [15 Read More About This Manual & Download PDF:](#)
- [16 Documents / Resources](#)
  - [16.1 References](#)

# AUTO-VOX 304-SL1PRO001 Solar Powered Wireless Reversing Camera Kit User Manual



## Introduction

Thank you for purchasing this solar digital wireless backup camera kit. Please read all of the installation instructions carefully before installing the product. Improper installation will void the manufacturer's warranty. The installation instructions do not apply to all types of vehicles, and are written as guidelines to assist in installing the backup camera kit.

## Package Contents

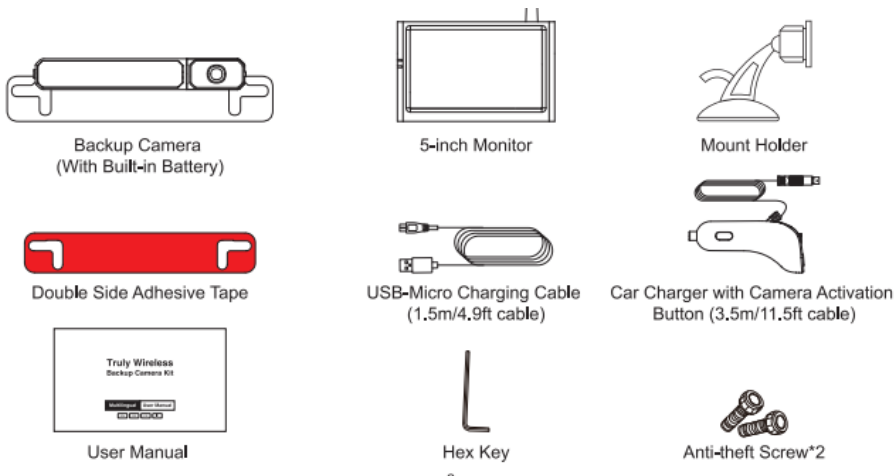

## Pre-Installation Note

Test the System Before installing your backup camera, test all the components to ensure proper functionality. (The backup camera is pre-paired with the monitor.) 1. Supply power to the monitor. If the indicator light is lit, the monitor is on and functioning. 2. Turn on the power button of the solar rear camera. If the indicator light lights up, the backup camera is functioning. The monitor will display the image. 3. Press the activation button on the car charger or any buttons on the monitor, the indicator light on the monitor will flash twice, then the monitor will display the image of the camera. If not, refer to the "Troubleshooting". Note: By default, the monitor will stop displaying the image and go into standby mode after 90 seconds.

## Charge the Backup Camera

Fully charge the camera using the supplied USB cable before you install it on your vehicle. It takes 4 hours to fully

charge. When the camera is charged, the red indicator light s lit, After fully charged, the red indicator light turns green. Note: Please use a standard USB charger with a rated output of 1500mA or higher.

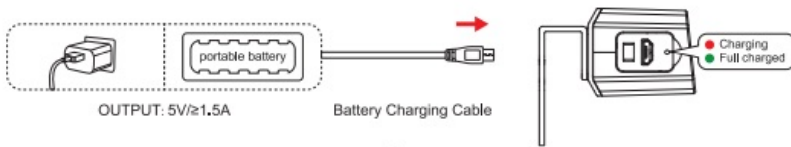

### Note:

1. If the camera is not used for more than half a month, please press the power button on the camera to turn off the camera. This can make the camera last longer.
2. The backup camera can work continuously for about 7.5 hours after 100% charge. When a low battery icon appears on the monitor, charge the camera promptly to maintain functionality. (Operating times are for reference only and actual times depend on individual operating conditions.)
3. If you use a power bank or a jump starter to charge the camera, please make sure that its battery capacity is no less than 4000mAh for 100% charge.
4. If the product has been installed, we would like to suggest that charging the camera by a power bank via USB cable and no need to remove it from the vehicle. Or you can remove the camera for charging by following these instructions:



### Installation

Install the Backup Camera 1. Remove the license plate from your vehicle. 2. Tear off the sticker on the double sided tape and stick it on the front of the camera bracket



. Tear off the sticker on the other side and stick it on the license plate. Then fix the license plate back to the car. If you install the camera on the bottom of the license plate, please go to the setting menu and adjust the image up and down correctly to avoid image inversion.



Adjust the Camera Angle The camera can be rotated up and down by 70°.



## Install the Monitor 1. ~ w IS @

The mount holder should be installed on the windshield or a flat surface of the dashboard. If it is installed on a bumpy surface, it may not be secure.

Ensure that the mounting location does not impair the visibility of the driver.

. Clean and dry the area of the windshield or the dashboard before installing the mount holder. Press the suction cup against the mounting surface and push the suction cup lock lever down to lock the suction cup in place.

. Slide the monitor onto the bracket. The angle of the monitor can be adjusted by loosening the rotary knob.

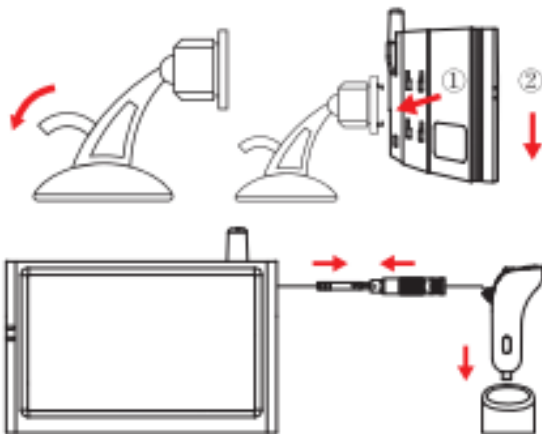

6. Insert the monitor car charger into a 12V DC power supply. Note: 1. In order to ensure good electrical contact, the monitor cable must be fully inserted into the car charger cable, leaving no gap. 2. If necessary, bundle the additional wires with a cable tie.

## Operational Instructions

Monitor Operations A: Forward/Increase. M: Menu/Return/Confirm. ¥: Back/Decrease.

Menu Settings 1) Press (M) to access menu mode. 2) Press (A) or (¥) to advance the following menu items: Pair: pair the monitor with the backup camera. BIC control: adjust the monitor brightness and contrast. M/U control: switch to Mirror/Normal/Up/Down image. Reversing time: set the duration of reversing display time, 45s, 60s, 90s, 120s. Guide line: activate or deactivate guide line. Reset: return to factory settings.

3) Press (M) to confirm the settings and exit the menu Note: Please press (M) to confirm each setting. Otherwise, the setting is invalid.

Basic Functions 1. Pair the Camera Note: Please ensure that you select "Pair" before turning on the camera, or the pairing will fail. «





The pairing timeout is the default 30 seconds. If the pairing is not completed in 30 seconds, the pairing screen will close automatically and the monitor will enter standby mode. Follow the steps below to pair the camera again. If the pairing fails after several attempts, please contact customer support for assistance. 1) Press (M) to enter the menu setting, press A or ¥ to select "Pair" and press (M) to confirm. Then a cycle symbol is on the monitor and the indicator light on the left side of the monitor will flash 2) Press the power button on the camera to turn on the camera. Long press the button again for 5-8 seconds until its red indicator light flashes, and the pairing will proceed automatically. If paired successfully, the screen will automatically display rear view image, and the red

indicator on the camera will remain on.

2. Choose the Sizes of Guidelines 1) Set the guideline “ON” on the menu. 2) Enter into non-menu mode, long press (M) for about 3 seconds until the guidelines flicker. 3) Press A or ¥ to choose from 6 different sizes of guidelines, and press (M) to confirm.

## Battery Condition Indicator

Indication of Battery Power (The parameters are tested under 25°C. Low temperature may drastically decrease the performance of the built-in battery. The battery icon is located in the upper right corner of the display, representing the current power level of the built-in battery.)

Battery power status	Relative power	Estimated duration	Note
	≈100%	≈75 days	Fully charged
	≈70%	≈45 days	----
	≈40%	≈20 days	----
	≈20%	≈10 days	Need to charge

Prerequisite: The following data are based on the fully charged camera at different temperatures on a cycle of 45 seconds/time and 3 times per day.

Temperature(°F/°C)	140°F/60°C	113°F/45°C	77°F/25°C	0°F/0°C	14°F/-10°C	-4°F/-20°C	-22°F/-30°C
Battery Working Days	≈75 days	≈74 days	≈73 days	≈57 days	≈50 days	≈20 days	≈0 days
Battery Performance(%)	100%	99%	98%	86%	77%	44%	0%

Note: The table is for reference only. The specific battery performance will vary according to local temperature and actual use.

## Troubleshooting

1. The red light of the camera keeps flashing while charging. Possible cause: The power adapter can't supply enough current. Solution: Use another power adapter that has 5V/1.5A output.
2. The monitor doesn't work even though the camera battery is fully charged (the green light stays on). Possible cause: The camera doesn't turn on/the camera is unpaired. Solution: Please press the power button to turn on the camera again.

If it doesn't work, please follow the steps below to pair the monitor with the camera, Step 1: Press (M) to enter the menu setting, press A or ¥ to select “Pair” and press (M) to confirm. Then a cycle symbol is on the monitor and the indicator light on the left side of the monitor will flash. Step 2: Press the power button on the camera to turn on the camera. Long press the button again for 5-8 seconds until its red indicator light flashes, and the pairing will proceed automatically. If paired successfully, the screen will automatically display rear view image, and the red indicator on the camera will remain on. Note: The pairing timeout is the default 30s. If the pairing does not finish within 30s, the pairing screen will close automatically, and then the monitor enters standby mode. If it happens, please follow the steps above to pair the camera again.

## Specifications

<b>Camera</b>			
<b>Operating Voltage</b>	DC 3.4-4.2V	<b>Operating Current</b>	Max 420mA
<b>Operating Temperature</b>	-4° to 149°F (-20° to 65°C)	<b>Vertical View Angle</b>	50°±5°
<b>Horizontal View Angle</b>	110°±5°	<b>Minimal Illumination</b>	0.1Lux
<b>Battery Capacity</b>	3300mAh	<b>USB Charge Current</b>	1000mA
<b>Monitor</b>			
<b>Screen Size</b>	5-inch		
<b>Operating Voltage</b>	DC12V	<b>Operating Current</b>	Max 250mA
<b>Operating Temperature</b>	-4° to 149°F (-20° to 65°C)	<b>Operating Frequency</b>	2.4GHz ISM

## Care and Maintenance

For maintaining its condition and performance, please follow the guidelines below. « Avoid storing the backup camera system in a moist, extreme high or low temperature environment.

© Do not immerse or allow liquids to enter the monitor.

- Gently clean the backup camera kit with a soft, moist cloth. Do not allow residue or liquid to enter any part of the equipment, otherwise it may cause short circuit and other conditions.
- Do not use the high-pressure water gun to spray the camera, which may damage the camera. Note: Before cleaning the monitor, please make sure to cut off the car charging source. Never use benzene, thinner or cleaners to clean the system.

## Warranty and Service

You (as the end-user) receive a 12 months guarantee from the date of purchase. If you are not satisfied with your purchase for any quality problem, you should return the item in its original condition within 30 days of receipt and we will gladly provide a refund, replacement, or an exchange. We do not accept damaged, broken, disassembled or modified items. Damage includes: stains, tears, chips, scratches, strong odors, cracks, or any other defects after use. If you are in receipt of the item for more than 30 days, we will not refund. In 1 year warranty, If you find any defects on your new product, we will repair or replace it, and won't charge you for related parts or labour (Only for the product repair or replacement, not including the installation, disassembly or re-installation fee or the cost of damaging any equipment or vehicle).

To qualify for the warranty policy, you must « All repairs must be performed by AUTO-VOX. All warranty claims must be accompanied by receipts or proof of purchase. « Products are purchased through authorized channels

- The equipment shall not be altered or damaged by negligence, accident, improper operation, or when installing, using, maintaining without following the manual. Parts that require replacement due to normal wear and tear are not covered by the warranty.
- If we repair or replace a product, the repaired or replaced product shall be warranted for the remaining time of the original warranty period.

For speedy processing of your warranty claim you will need: Copy of the receipt showing the purchase date. » Reason for the claim (description of the defect). For more information or support, you can get the customer service support on [www.auto-vox.com](http://www.auto-vox.com). Or send an e-mail at [service@auto-vox.com](mailto:service@auto-vox.com). We will reply to you within 24 hours in the working days.

***Read More About This Manual & Download PDF:***

Documents / Resources

	<a href="#">AUTO-VOX 304-SL1PRO001 Solar Powered Wireless Reversing Camera Kit</a> [pdf] User Manual 304-SL1PRO001, 304-SL1PRO001 Solar Powered Wireless Reversing Camera Kit, Solar Powered Wireless Reversing Camera Kit, Powered Wireless Reversing Camera Kit, Wireless Reversing Camera Kit, Reversing Camera Kit, Camera Kit, Kit
-----------------------------------------------------------------------------------	--------------------------------------------------------------------------------------------------------------------------------------------------------------------------------------------------------------------------------------------------------------------------------------------------------------------------------------------

References

- [User Manual](#)