



# AUTEL MaxiIM IM608 Pro II Proven Key Programmer User Guide

[Home](#) » [AUTEL](#) » AUTEL MaxiIM IM608 Pro II Proven Key Programmer User Guide 

## Contents

- [1 AUTEL MaxiIM IM608 Pro II Proven Key Programmer](#)
- [2 OVERVIEW](#)
- [3 Safety Information](#)
- [4 FCC](#)
- [5 Getting Started](#)
- [6 Immobilizer Function](#)
- [7 Wireless Data Printing](#)
- [8 Documents / Resources](#)
  - [8.1 References](#)
- [9 Related Posts](#)

# AUTEL®

## AUTEL MaxiIM IM608 Pro II Proven Key Programmer



## OVERVIEW

### MaxiIM IM608 Pro II

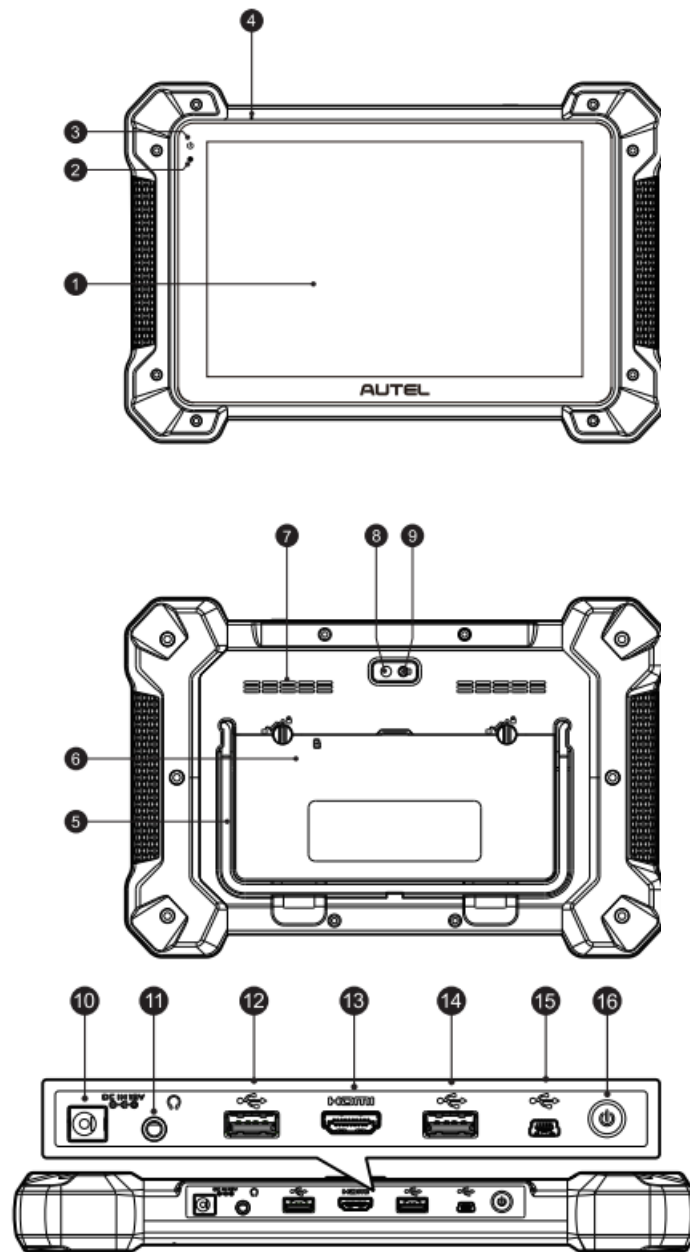

1. 10.1-inch LCD Capacitive Touchscreen
2. Ambient Light Sensor – detects ambient brightness.
3. Power LED – indicates battery level & charging or system status.
4. Microphone
5. Collapsible Stand – extends from the back to allow hands-free viewing of the tablet.
6. Built-in Battery
7. Loudspeaker
8. Camera Lens
9. Camera Flash
10. DC Power Supply Input Port
11. Headphone Jack
12. USB Port
13. HDMI {high-definition multimedia interface} Port
14. USB Port
15. Mini USB Port
16. Lock/Power Button – turns the device on & off with a long press, or locks the screen with a short press.

## MaxiFlash JVCI

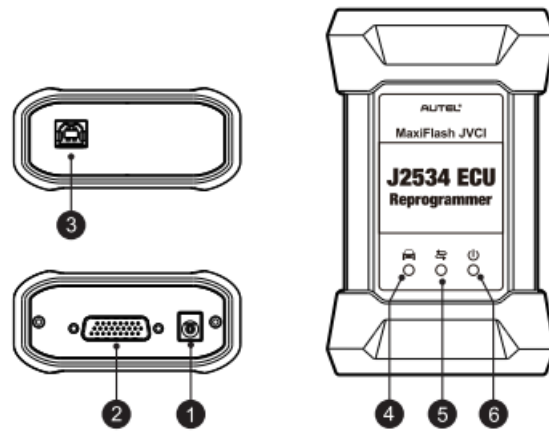

1. Power Port – connects the device and the power source with the adapter.
2. Vehicle Connector – connects the device to the vehicle's DLC via a standard high-density DB-26 MVI – OBDII cable.
3. USB Port
4. Vehicle LED
5. Connection LED
6. Power LED

## XP400 Pro

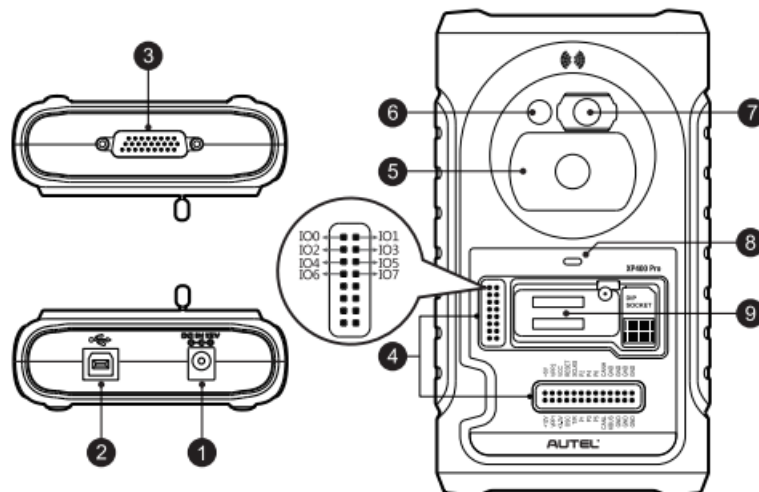

1. DC Port – provides 12V DC power supply.
2. USB Port – provides data communication and a 5V DC power supply.
3. DB 26-Pin Port – connects with the Mercedes Benz infrared collector, ECU cable, MCU cable, and MC9S12 cable.
4. Cross Signal Pins – hold the MCU spare cable or DIY signal interface.
5. Vehicle Key Slot – holds the vehicle key.
6. Transponder Slot – holds the transponder.
7. Mercedes Infrared Key Slot- holds the Mercedes infrared key.
8. Status LED – indicates the current operating status.
9. Power LED

9. EEPROM Component Transponder Slot – holds the EEPROM plug-in transponder or EEPROM socket.

## **Safety Information**

- For your own safety and the safety of others, and to prevent damage to the device and vehicles upon which it is used, it is important that the safety instructions presented throughout this manual be read and understood by all persons operating or coming into contact with the device.
- There are various procedures, techniques, tools, and parts for servicing vehicles, as well as in the skill of the person doing the work. Because of the vast number of test applications and variations in the products that can be tested with this equipment, we cannot possibly anticipate or provide advice or safety messages to cover every circumstance. It is the automotive technician's responsibility to be knowledgeable of the system being tested. It is crucial to use proper service methods and test procedures. It is essential to perform tests in an appropriate and acceptable manner that does not endanger your safety, the safety of others in the work area, the device being used, or the vehicle being tested.
- Before using the device, always refer to and follow the safety messages and applicable test procedures provided by the manufacturer of the vehicle or equipment being tested. Use the device only as described in this manual. Read, understand, and follow all safety messages and instructions in this manual.

### **Safety Messages**

Safety messages are provided to help prevent personal injury and equipment damage. All safety messages are introduced by a signal word indicating the hazard level.

#### **DANGER**

Indicates an imminently hazardous situation which, if not avoided, will result in death or serious injury to the operator or to bystanders.

#### **WARNING**

Indicates a potentially hazardous situation which, if not avoided, could result in death or serious injury to the operator or to bystanders.

### **Safety Instructions**

The safety messages herein cover situations Autel is aware of. Autel cannot know, evaluate or advise you as to all of the possible hazards. You must be certain that any condition or service procedure encountered does not jeopardize your personal safety.

#### **DANGER**

When an engine is operating, keep the service area WELL VENTILATED or attach a building exhaust removal system to the engine exhaust system. Engines produce carbon monoxide, an odorless, poisonous gas that causes slower reaction time and can lead to serious personal injury or loss of life.

### **SAFETY WARNINGS**

- Always perform automotive testing in a safe environment.
- Wear safety eye protection that meets ANSI standards.
- Keep clothing, hair, hands, tools, test equipment, etc. away from all moving or hot engine parts.
- Operate the vehicle in a well-ventilated work area, for exhaust gases are poisonous.
- Put the transmission in PARK (for automatic transmission) or NEUTRAL (for manual transmission) and make sure the parking brake is engaged.

- Put blocks in front of the drive wheels and never leave the vehicle unattended while testing.
- Be extra cautious when working around the ignition coil, distributor cap, ignition wires, and spark plugs. These components create hazardous voltages when the engine is running.
- Keep a fire extinguisher suitable for gasoline, chemical, and electrical fires nearby.
- Do not connect or disconnect any test equipment while the ignition is on or the engine is running.
- Keep the test equipment dry, clean, and free from oil, water, or grease. Use a mild detergent on a clean cloth to clean the outside of the equipment as necessary.
- Do not drive the vehicle and operate the test equipment at the same time. Any distraction may cause an accident.
- Refer to the service manual for the vehicle being serviced and adhere to all diagnostic procedures and precautions. Failure to do so may result in personal injury or damage to the test equipment.
- To avoid damaging the test equipment or generating false data, make sure the vehicle battery is fully charged and the connection to the vehicle DLC is clean and secure.
- Do not place the test equipment on the distributor of the vehicle. Strong electromagnetic interference can damage the equipment.

## **FCC**

### **COMPLIANCE**

This device complies with Part 15 of the FCC rules and Industry Canada's license-exempt RSSs. Operation is subject to the following two conditions:

1. This device may not cause harmful interference.
2. This device must accept any interference received, including interference that may cause undesired operation.

Cet appareil est conforme aux CNR exempts de licence d'Industrie Canada. Son fonctionnement est soumis aux deux conditions suivantes:

1. Ce dispositif ne peut causer des interférences; et
2. Ce dispositif doit accepter toute interférence, y compris les interférences qui peuvent causer un mauvais fonctionnement de l'appareil.

### **WARNING**

Changes or modifications not expressly approved by the party responsible for compliance could void the user's authority to operate the equipment.

### **NOTE**

This equipment has been tested and found to comply with the limits for a Class B digital device, pursuant to Part 15 of the FCC Rules. These limits are designed to provide reasonable protection against harmful interference in a residential installation.

This equipment generates uses and can radiate radio frequency energy and, if not installed and used in accordance with the instructions, may cause harmful interference to radio communications. However, there is no guarantee that interference will not occur in a particular installation. If this equipment does cause harmful interference to radio or television reception, which can be determined by turning the equipment off and on, the user is encouraged to try to correct the interference by one or more of the following measures: I. Reorient or relocate the receiving antenna. II. Increase the separation between the equipment and the receiver. III. Connect the equipment to an outlet on a circuit different from that to which the receiver is connected. IV. Consult the dealer

or an experienced radio/TV technician for help.

## **SAR**

The radiated output power of this device is below the FCC radio frequency exposure limits. Nevertheless, the device should be used in such a manner that the potential for human contact is minimized during normal operation.

The exposure standard for wireless devices employs a unit of measurement known as the Specific Absorption Rate or SAR. The SAR limit set by the FCC is 1.6 W/kg. Tests for SAR are conducted using standard operating positions accepted by the FCC with the device transmitting at its highest certified power level in all tested frequency bands.

- Although the SAR is determined at the highest certified power level, the actual SAR level of the device while operating can be well below the maximum value. This is because the device is designed to operate at multiple power levels so as to use only the power required to reach the network. To avoid the possibility of exceeding the FCC radio frequency exposure limits, human proximity to the antenna should be minimized.

## **RF WARNING STATEMENT**

- The device has been evaluated to meet general RF exposure requirements. The device can be used in portable exposure conditions without restriction.
- The term "IC" before the radio certification number only signifies that IC technical specifications were met.

## **RoHS COMPLIANCE**

- This device is declared to be in compliance with the European RoHS Directive 2011/65/EU.

## **CE COMPLIANCE**

- This product is declared to conform to the essential requirements of the following Directives and carries the CE mark accordingly:
- EMC Directive 2014/30/EU
- R&TTE Directive 1999/5/EC
- Low Voltage Directive 2014/35/EU

## **Getting Started**

**IMPORTANT:** Before operating or maintaining this unit, please read the quick guide and user manual carefully, pay extra attention to the safety warnings and precautions. Use this unit correctly and properly. Failure to do so may cause damage and/or personal injury and will void the product warranty.



- Scan the QR Code to visit our website at <http://pro.autel.com>.
- Create an Autel ID and register the product with the device's SN and password.

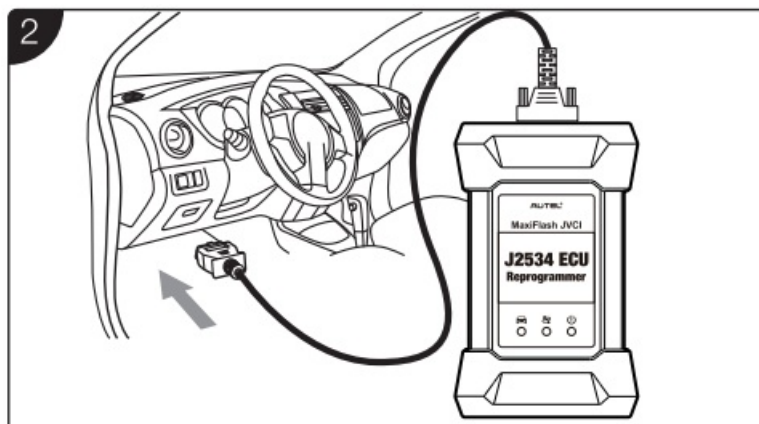

- Connect the VCI with the vehicle's DLC, which is generally located under the vehicle dash.

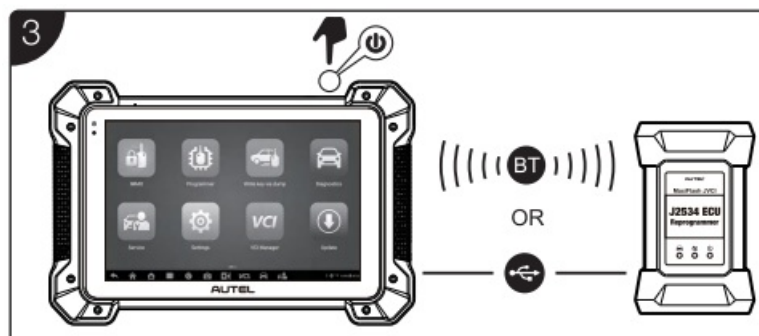

- Long press the Lock/Power button to turn on the key programming tool.
- Pair up the key programming tool with the VCI device via Bluetooth or the included USB cable (2m) to establish a communication link and your key programming tool is now ready for use.



- Software Update: connect the key programming tool to the Internet and tap Update in the MaxiIM Job Menu to view all the available updates.

## Immobilizer Function

This function requires a connection between the vehicle, the MaxiIM IM608 Pro II tablet and the XP400 Pro.

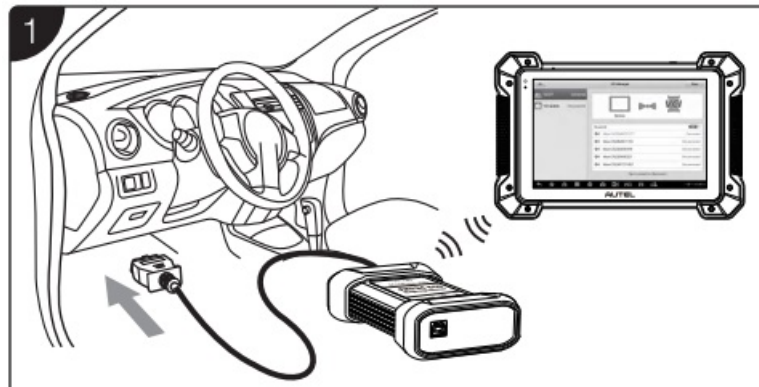

- Pair up the MaxiIM IM608 Pro II tablet with the VCI device via Bluetooth to establish a communication link with the vehicle.

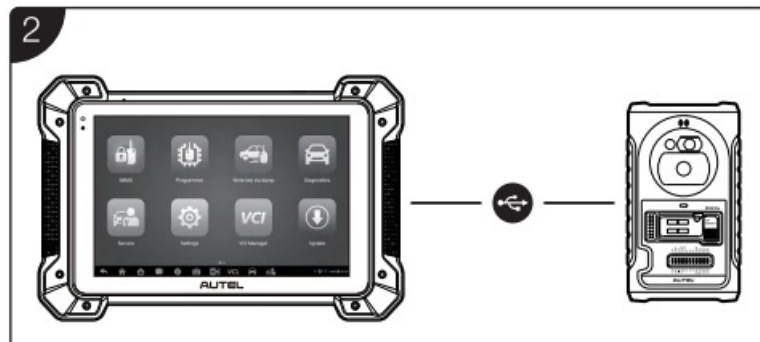

- Connect the tablet and the XP400 Pro with the included APC001 (USB cable).

## Programming Function

This function requires a connection between the MaxiIM IM608 Pro II tablet and the XP400 Pro.

## Wireless Data Printing

### Print via PC



Please download the Maxi PC Suite from [www.autel.com](http://www.autel.com) >Support> Downloads > Autel Update Tools, and install it to Windows-based PC.

**IMPORTANT:** Make sure the tool and the PC are on the same network (Wi-Fi or hard-wired) as the printer.

- Launch the PC Link application on the PC and click the MaxiSys Printer tab.
- Click Test Print to make sure the printer is working successfully.
- Tap Print on the toolbar of the tool. A temporary document will be created and sent to the PC.
  - If the Auto Print option in the MaxiSys Printer is selected, the MaxiSys Printer will print the received document automatically.
  - If the Auto Print option is not selected, click Open PDF File to view all the temporary files. Select the files you want to print and click Print.



## Documents / Resources

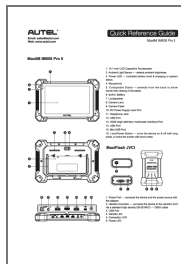

[AUTEL MaxiIM IM608 Pro II Proven Key Programmer](#) [pdf] User Guide  
MaxiIM IM608 Pro II Proven Key Programmer, MaxiIM IM608 Pro II, Proven Key Programmer,  
Key Programmer, Programmer

## References

- [User Manual](#)