



AURA Grille Installation Guide

[Home](#) » [Aura](#) » AURA Grille Installation Guide 

AURA™ GRILLE

INSTALLATION GUIDE

Contents

[1 MAIN COMPONENTS](#)

[1.1 V1.2.022021](#)

[2 INSTALLATION](#)

[3 INSTALLATION](#)

[3.1 | STEP 2](#)

[3.2 | STEP 3](#)

[4 | AUX WIRING FOR A DOME/DOOR LIGHT](#)

[5 | OPTIONAL UPGRADE](#)

[6 | DISCLAIMER](#)

[7 | NEED SUPPORT?](#)

[8 Documents / Resources](#)

[8.1 References](#)

[9 Related Posts](#)

MAIN COMPONENTS

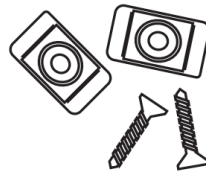

12" LIGHT STRIPS

MOUNTING KIT



AURA CONTROL BOX

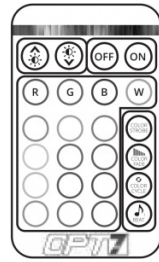

REMOTE

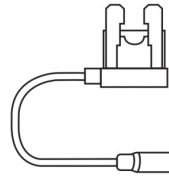

FUSE TAPS

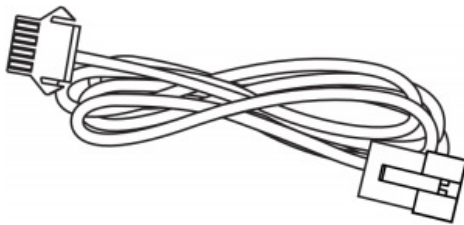

EXTENSION WIRES

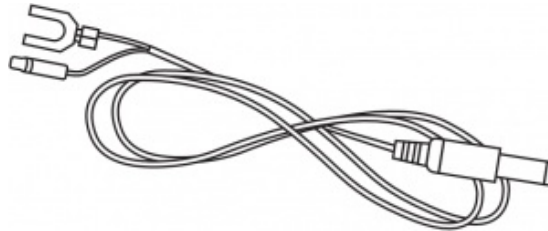

POWER HARNESS

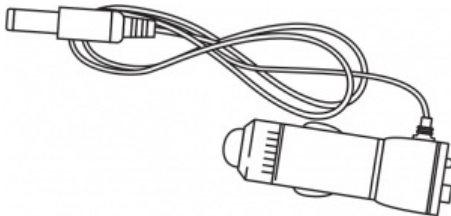

CIGARETTE LIGHTER POWER ADAPTER

V1.2.022021

OPT7®

INSTALLATION

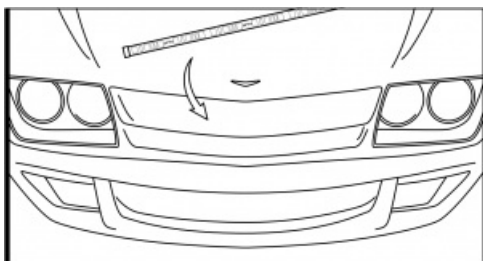

| STEP 1

Decide where to locate the light strips and ensure wiring has enough length for control box to be installed in desired location.

As shown below, connect all light pods to the control box with the included extension cables.

AUXILIARY WIRE EXTENSION WIRE

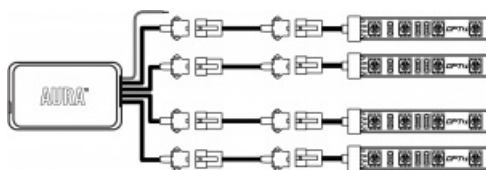

Once connected, plug the control box Cigarette Power Adapter into an available 12 volt charging port.

12 VOLT CHARGING PORT CIGARETTE POWER ADAPTER

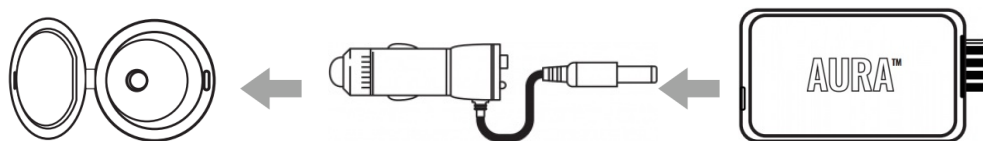

or, connect the positive wire to the fuse tap and connector the open negative wire to a ground (any metal surface). Then plug the fuse tap into the 10 amp switched fuse.

POWER SOURCE FUSE TAP POWER HARNESS

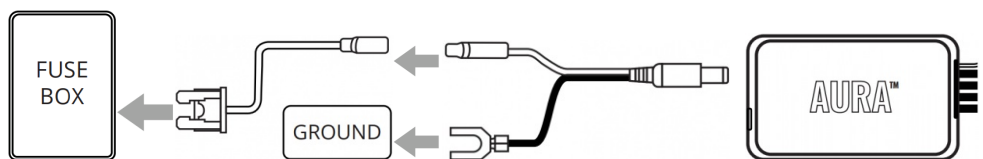

OPT7

INSTALLATION

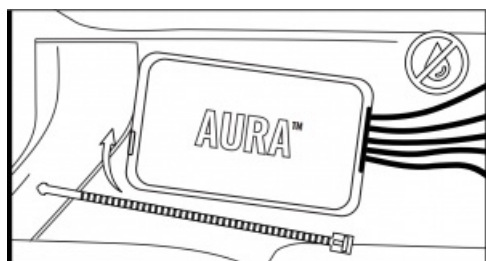

| STEP 2

Secure Control box in desired location with Velcro or zipties.

*** CONTROL BOX NOT WATERPROOF** Ensure the control box is safely and securely hidden from exposing elements of moisture.

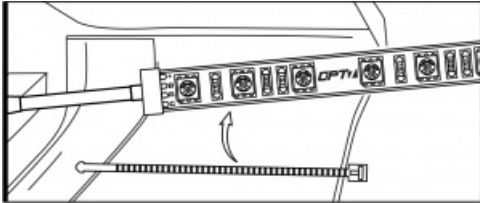

| STEP 3

Secure the light strips using the zip ties to tie all the wiring away from the moving components.

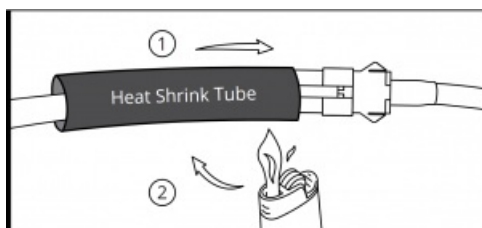

Heat Shrink Tube

*** IMPORTANT:** The LED connectors are not waterproof. You will need to use heat shrink tube (not included) or electrical tape around the LED connectors to ensure the longevity of the lighting kit.

| **STEP 4** Using the included E-Z Remote, select your desired color or pattern.

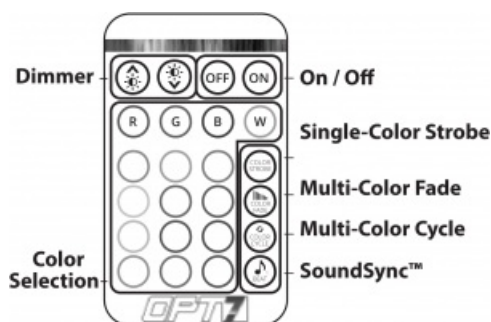

Dimmer, Color Selection, On/Off, Single-Color Strobe, Multi-Color Fade, Multi-Color Cycle, Sound Sync

Dimmer

Color Selection

On/Off

Single-Color Strobe

Press multiple times to change color Adjust speed with “Dimmer” buttons

Multi-Color Fade

Adjust speed with “Dimmer” buttons

Multi-Color Cycle

Adjust speed with “Dimmer” buttons

SoundSync™

Press multiple times to change color To adjust the sensitivity, please visit www.OPT-7.com



| AUX WIRING FOR A DOME/DOOR LIGHT

NOTE: This feature activates white light only.

In order to activate Door Assist Sync, you need to connect the aux wiring of Aura control box to the positive and negative wiring of dome or door light.

| OPTIONAL UPGRADE

Upgrade your Aura Original Control Box to the Aura Pro Bluetooth Control Box. All new AURA Pro Bluetooth is App enabled by a smartphone controller (iOS & Android Compatible).

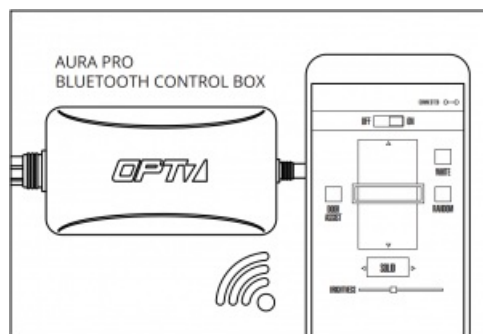

AURA PRO BLUETOOTH CONTROL BOX

| DISCLAIMER

OPT7 Lighting is not liable for damages or personal injuries while installing this product. The Installation Guide is intended as assistance to reduce setup time. OPT7 Lighting assumes no responsibility for improper installation. If you are unfamiliar with your vehicle or inexperienced with aftermarket upgrades, please seek professional assistance.

| NEED SUPPORT?

Scan for tutorial videos, troubleshooting tips, and more.



Documents / Resources

	<p>AURA Grille [pdf] Installation Guide Grille</p>
---	--

References

- [7 OPT7 - LED & HID Lighting for Cars, Trucks & Motorcycles](#)