



AULA F99 PRO RGB Gasket Mechanical Keyboard



AULA F99 PRO RGB Gasket Mechanical Keyboard Instruction Manual

[Home](#) » [AULA](#) » AULA F99 PRO RGB Gasket Mechanical Keyboard Instruction Manual 

Contents

- [1 AULA F99 PRO RGB Gasket Mechanical Keyboard](#)
- [2 BT Connection Instructions](#)
- [3 Operating system mode switching](#)
- [4 Dual mode switching](#)
- [5 Shortcut Key Description](#)
- [6 Current status indicator light description](#)
- [7 Charging instructions](#)
- [8 Product parameters](#)
- [9 Documents / Resources](#)
 - [9.1 References](#)
- [10 Related Posts](#)



AULA F99 PRO RGB Gasket Mechanical Keyboard



Keyboard Function Description

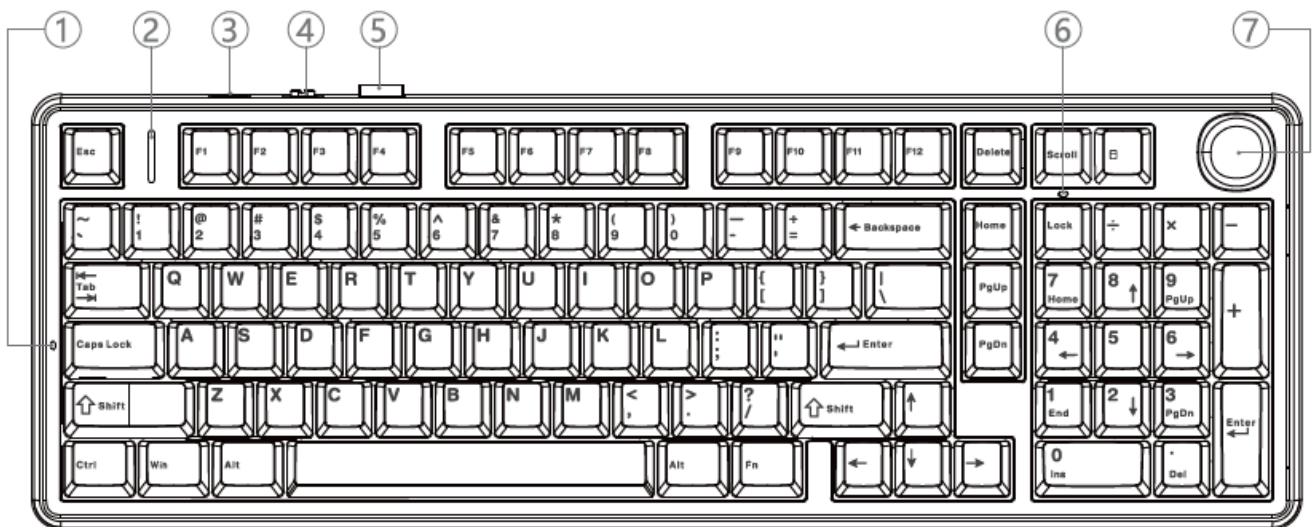

1. CAP capitalization indicator light
2. RGB atmosphere light bar/ battery indicator light
3. Type-C interface
4. Mode switching switch 2.4G/wired/BT
5. USB receiver
6. NUM indicator light
7. Knob mode key (office mode/game mode)
 - Fashionable appearance design, 99 key layout with knob, Gasket structure, PCB single key slotting, delicate and soft touch.
 - The keycaps and mechanical switches can be plugged in and out, and users can also purchase various brands of switches and personalized keycaps on the market for free DIY.
 - The keyboard is made of solid materials and has a responsive keyboard.
 - Two stage tripod with independent storage receiver.
 - Humanized keyboard design, combined with Fn to add a series of commonly used shortcut function keys.
 - Keyboard return rate: wired mode 1000Hz, 2.4G mode 1000Hz, BT mode 125Hz.

Wired mode/ON/OFF

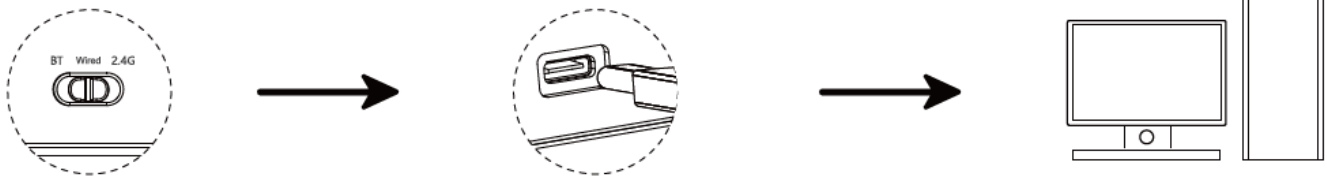

1. Switch to wired mode
2. Insert one end of the standard USB cable Type-C into the corresponding port on the keyboard
3. Insert one end of the cable USB head into the computer USB port

Power on/off instructions

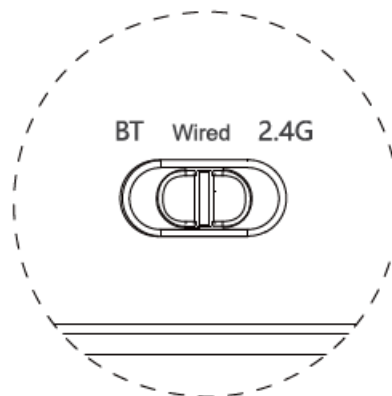

- Turn the switch to wired (without USB power), the keyboard will shut down, and the built-in battery will stop supplying power to the keyboard.

2.4G Connection Instructions

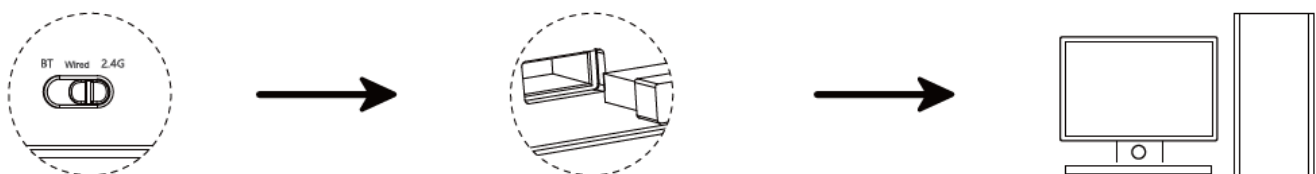

1. Switch to [2.4G] mode
2. Remove the USB receiver from the slot in the upper left corner of the keyboard
3. Plug into the computer USB port to use

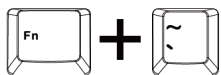

Quick 2.4G code pairing with combination keys

- Manual code pairing: Press and hold the combination key “FN+~” for about 3 seconds, and the blue light will flash quickly to enter the code pairing state. At this time, insert the receiver into the computer USB port, and the blue light will light up for 2 seconds.

The 2.4G connection is successful. At this point, the coding is complete.

Attention: When connecting to 2.4G, search first before inserting the receiver. The default factory code has been

matched.

BT Connection Instructions

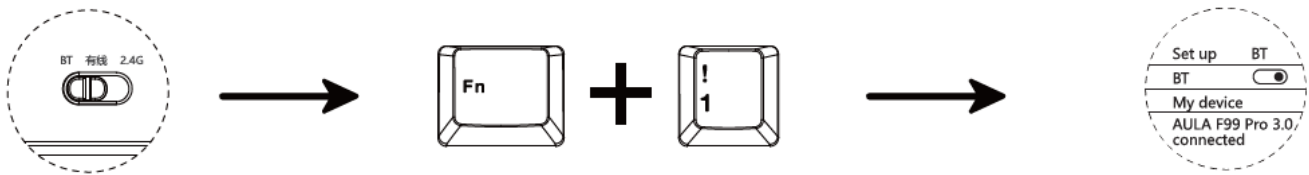

1. Switch to BT mode
2. Press the combination key to switch to BT1, hold for about 3 seconds until the blue light flashes quickly to enter pairing
3. Search for pairing name [AULA-F99Pro 3.0] or [AULA-F99Pro 5.0]. After successfully connecting, the blue light will turn on for 2 seconds and then turn off

Quick device switching with combination keys:

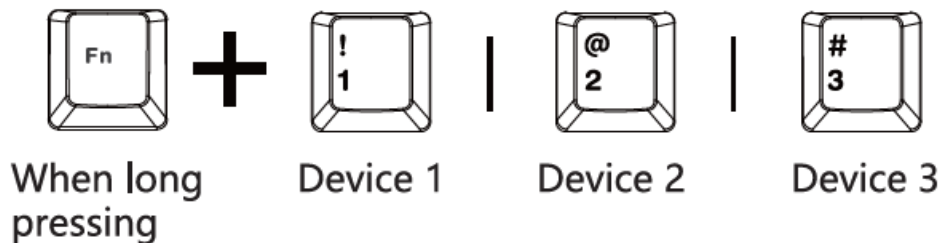

- Long press and hold the Fn+ numbers 1, 2, or 3 for 3 seconds, and the blue light will flash quickly, indicating that the keyboard has entered pairing or search mode, and can be paired and connected in the device. In reconnection mode, the blue light will flash slowly.
- Press Fn + number keys 1, 2, or 3 to switch devices.
- Check the keyboard power and connect to Bluetooth to display it on the computer.

Backlight effect adjustment



FN+\ key combination to switch 16 light effects

Backlight effect shortcut key adjustment

Fn +		Light mode switching
		Light color switching
		Increased brightness of lighting

Fn +		Reduced brightness of lighting
		Reduced light effect speed
		Light effect speed increases

- In combination with the driver's RGB lighting effect with music rhythm, there are 10 lighting modes to choose from under this lighting effect.

Atmosphere light strip adjustment

Fn +	Right Shift	Switch RGB ambient light bar mode	Fn +	B	Switch RGB ambient light bar/battery mode
	? /	Switching RGB ambient light bar colors		>	Loop switching RGB ambient light bar speed
	Right Alt	RGB ambient light bar brightness cycle		.	

Operating system mode switching

- Fn +WIN=Lock/Unlock WIN Window Key (In the WIN system, the indicator light remains on when the WIN key is locked, and the WIN key cannot be used).
- After switching to Mac/IOS system, the left WIN/left ALT position switches (without locking WIN).

Fn +	Q	Android system	Fn +	E	MAC system
	W	Windows system		R	IOS system

Dual mode switching

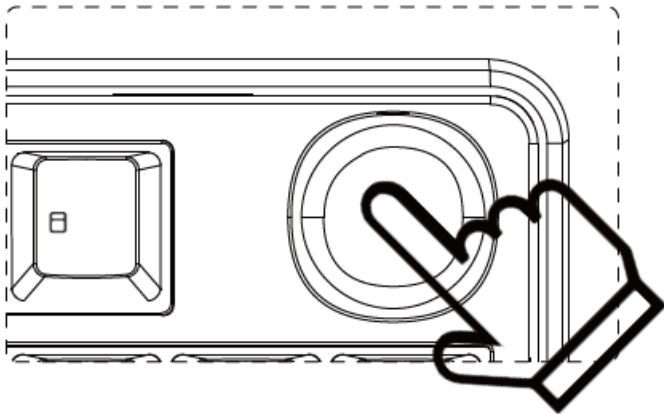

Long press the mode key to switch between game/office modes, and the CAP and WIN key lights will flash when switching.

- Game mode (switch to game mode with CAP and WIN keys flashing green light)

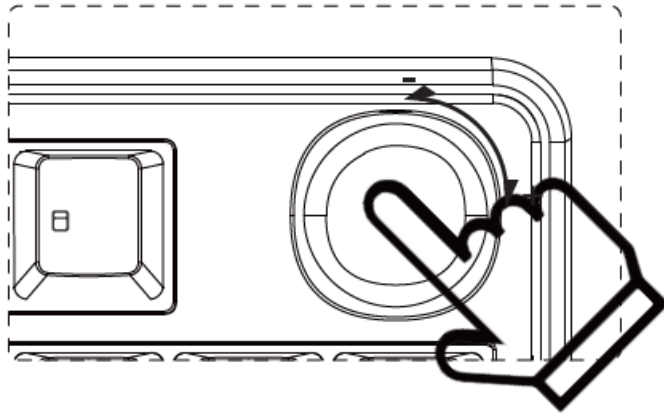

Short press the mode key to cycle through 16 RGB lighting effects Knob clockwise (Light brightness+) Knob counterclockwise (Light brightness-)

- Office mode (switch to office mode with CAP and WIN keys flashing blue light)

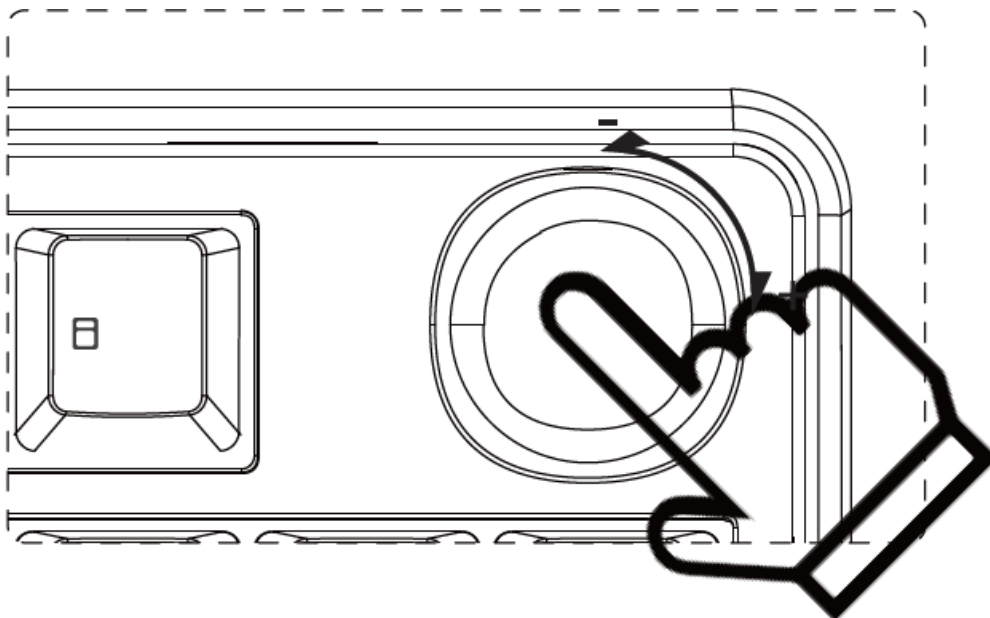

Short press mode key= multimedia function (mute)
Knob clockwise= multimedia function (Volume+)
Knob counterclockwise=multimedia function (Volume-)

Shortcut Key Description

The switch in the upper left corner must be switched to the corresponding mode FN+`~/1/2/3 in order to press and hold the code matching function					
FN+	ESC	Long press for 3 seconds to restore factory settings	FN+	DEL	INS
	WIN	Lock WIN key, WIN key cannot be used when locked		Scroll	PRTSC
	1	BT device 1#		Calculator	PAUSE
	2	BT device 2#		HOME	END
	3	BT device 3#			

- Press FN+ESC to restore the factory default lighting mode, and the previously connected BT device will not be cleared when saved.

FN +Q=Android system (Q key red light flashing for 3 seconds), F zone single press function and F zone FN combination function.

Key position	Single press	Fn combination
F1	Screen brightness-	F1
F2	Screen brightness+	F2
F3	Convert Window	F3
F4	Return to desktop	F4
F5	Light brightness -	F5
F6	Light brightness +	F6

Key position	Single press	Fn combination
F7	Previous song	F7
F8	Play/pause	F8
F9	Next song	F9
F10	Mute	F10
F11	Volume -	F11
F12	Volume +	F12

FN+W=Windows system (W key flashes red for 3 seconds), F zone single press function and F zone FN combination function.

Key position	Single press	Fn combination
F1	F1	Homepage
F2	F2	Mail
F3	F3	Convert Window
F4	F4	Open Resource Manager
F5	F5	Light brightness -
F6	F6	Light brightness +

Key position	Single press	Fn combination
F7	F7	Previous song
F8	F8	Play/pause
F9	F9	Next song
F10	F10	mute
F11	F11	Volume -
F12	F12	Volume +

FN+E=Mac system (E key red light flashing for 3 seconds), F zone single press function and F zone FN combination function.

Key position	Single press	Fn combination
F1	Screen brightness-	F1
F2	Screen brightness+	F2
F3	Convert Window	F3
F4	Return to desktop	F4
F5	Light brightness -	F5
F6	Light brightness +	F6

Key position	Single press	Fn combination
F7	Previous song	F7
F8	Play/pause	F8
F9	Next song	F9
F10	Mute	F10
F11	Volume -	F11
F12	Volume +	F12

FN+R=IOS system (R key red light flashing for 3 seconds), F zone single press function and F zone FN combination function.

Key position	Single press	Fn combination
F1	Screen brightness-	F1
F2	Screen brightness+	F2
F3		F3
F4	Return to desktop	F4
F5	Light brightness -	F5
F6	Light brightness +	F6

Key position	Single press	Fn combination
F7	Previous song	F7
F8	Play/pause	F8
F9	Next song	F9
F10	Mute	F10
F11	Volume -	F11
F12	Volume +	F12

Current status indicator light description

Press and hold FN to view:

Current connection mode (2.4G, BT, wired); Current BT channel (channels 1, 2, 3)

Current system mode (Android, Windows, Mac, iOS)

The corresponding buttons above will light up, release to restore the light effect.

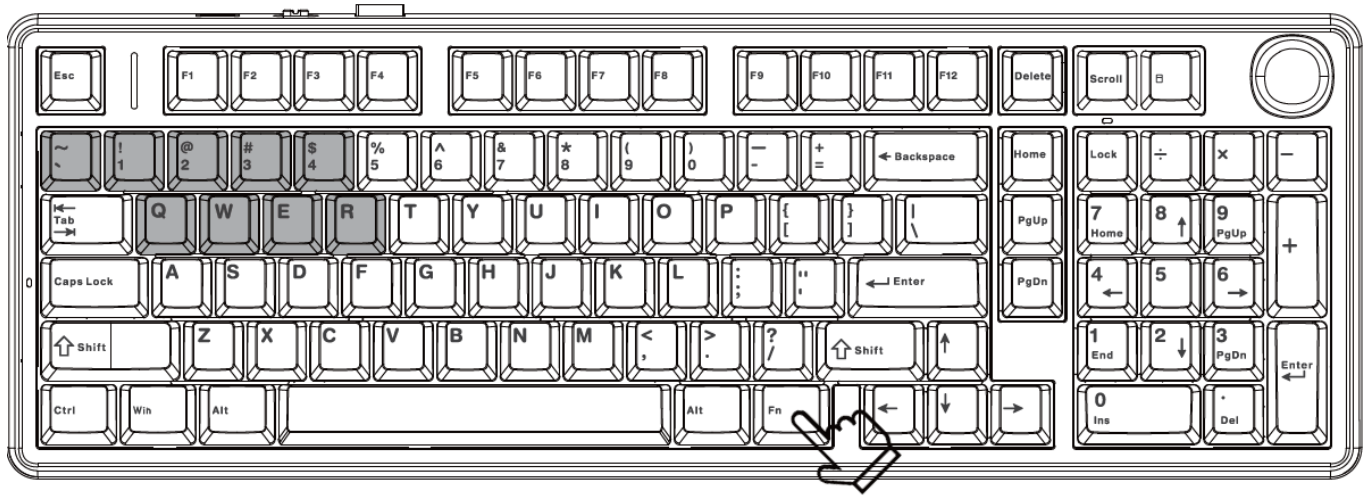

- 2.4G mode indicator light=" ~ " key
- BT channel indicator light="1,2,3" key
- System mode indicator light= "Q, W, E, R" key
- Wired mode indicator light="4" key

Intelligent Sleep Mode Description

- In BT/2.4G mode, without any operation for one minute, it automatically enters power-saving mode (with lights turned off). Click the button to wake up the keyboard.

Charging instructions

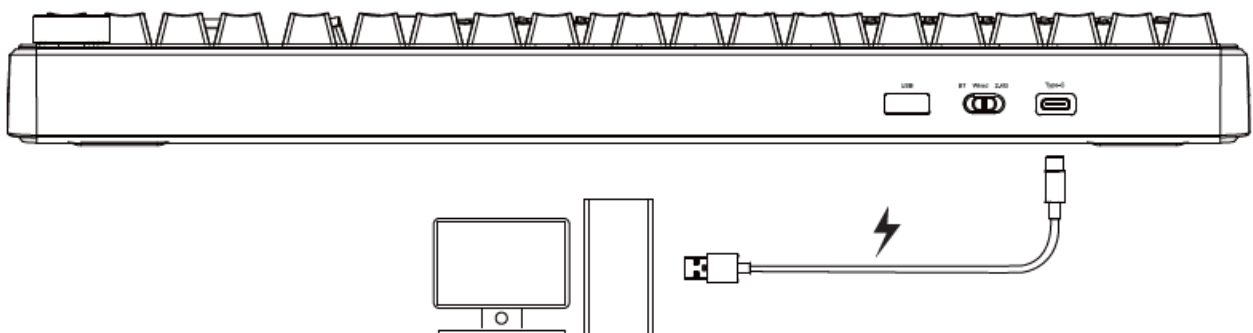

- Connect the keyboard to the computer through the equipped USB cable to charge the keyboard. During charging, the RGB ambient light strip displays a flowing light, full of bright green color.
- In 2.4G/BT mode (without USB inserted), the RGB ambient light bar can display keyboard battery level through FN+B, with full battery displayed in green. As the battery level decreases, the green color gradually decreases, and low battery indicated in red.

- Type-C connectivity is more reliable and performance is more stable.

Charging instructions

1. It is recommended to use only the computer USB port to charge the keyboard.
2. Do not use fast-charging cell phone chargers to charge the keyboard.
3. Do not use inferior non-standard power adapter to charge the keyboard
4. Do not use over-voltage and over-current power adapter to charge the keyboard.
5. Please keep away from high temperature equipment when charging
6. Please turn off the power switch if it is not used for a long time.

The above charging instructions also apply to other devices with charging function (keyboard/mouse/headphones/speakers, etc.)

Product parameters

- Number of keys: 99
- Total stroke of buttons: 4.0mm
- FN key multifunctional
- Product size: 406.76×139.31 ×43.28±0.1mm
- Product weight: approximately 1205g (excluding wire/receiver)
Approximately 1254g (including wire/receiver)
- Charging voltage/current: DC 5V  1250mA
- Rated voltage: DC 3.7V (fully charged with 4.2V)
- Rated current: 250mA @ 3.7V (default light effect)/20 mA (turn off all lights)
- Battery life: approximately 32 hours (default light effect)/ approximately 400 hours (all lights off)
- Battery capacity: 8000mAh (2x4000mAh) rechargeable lithium battery
- Charging interface: Type-C interface
- Computer system requirements:
- Wired/2.4G mode: Windows ALL operating system WIN XP, WIN7, WIN8, WIN10 (drivers may be required in Win95, Win98 systems).
- Wired mode/2.4G receiver: configured with USB 1.1 or higher ports.
- BT mode: Device name "AULA-F99Pro 3.0" WIN7 and below systems.
- BT mode: Device name "AULA-F99Pro 5.0" WIN8, WIN10 and above systems.
- BT mode: MAC computer with BT3.0, BLE4.0, BLE5.0 and above hardware, Android phone or tablet, IOS phone or tablet.

Hardware connection

The wired USB/2.4G receiver supports hot swapping (plug and play).



Dongguan Suoai Electronics CO., LTD

www.aulastar.com

SOAI Industry Park, Huayu Street Changlong

Village Huangjiang Town Dongguan City

Guangdong Province

Execution Standard:GB/T 4943.1-2022

Made in China

Documents / Resources

A vertical thumbnail image showing the first page of the instruction manual for the AULA F99 PRO RGB Gasket Mechanical Keyboard. The page features the AULA logo at the top, followed by the product name in both Chinese and English. Below this, there are several sections of text and images, including a diagram of the keyboard and a list of features. The page is numbered '1' at the bottom.

[AULA F99 PRO RGB Gasket Mechanical Keyboard](#) [pdf] Instruction Manual
F99_PRO, F3287, F99 PRO RGB Gasket Mechanical Keyboard, F99 PRO RGB, Gasket Mechanical Keyboard, Mechanical Keyboard

References

- [User Manual](#)

Manuals+ Privacy Policy

This website is an independent publication and is neither affiliated with nor endorsed by any of the trademark owners. The "Bluetooth®" word mark and logos are registered trademarks owned by Bluetooth SIG, Inc. The "Wi-Fi®" word mark and logos are registered trademarks owned by the Wi-Fi Alliance. Any use of these marks on this website does not imply any affiliation with or endorsement.