

AULA F75 Three Module Wired+2.4G+Bluetooth Mechanical Keyboard



AULA F75 Three Module Wired+2.4G+Bluetooth Mechanical Keyboard User Manual

[Home](#) » [AULA](#) » AULA F75 Three Module Wired+2.4G+Bluetooth Mechanical Keyboard User Manual 

Contents

- 1 AULA F75 Three Module Wired+2.4G+Bluetooth Mechanical Keyboard
- 2 Keyboard Function Description
- 3 Wired Mode/Keyboard ON/OFF
- 4 Connection Instruction
- 5 Bluetooth Connection Instruction
- 6 Backlight Effect Adjustment
- 7 Operating System Mode Switching
- 8 Shortcut Key Description
- 9 Multifunctional roller adjustment instructions
- 10 Description of Smart Sleep Mode
- 11 Charging Instructions
- 12 Description of warranty matters
- 13 User warranty card
- 14 Documents / Resources
 - 14.1 References



AULA F75 Three Module Wired+2.4G+Bluetooth Mechanical Keyboard



Keyboard Function Description



1. CAP indication
2. Type-C interface
3. Toggle switch (Toggle left to 2.4G wired/OFF, right switch to BT)
4. USB receiver
5. Charging indicator
6. Multi-function wheel

- Stylish appearance design, 80-key layout, Gasket structure, delicate and soft feel.
- Hot-swappable base, switches and keycaps can be replaced. Users can buy switches and personalized keycaps of various brands on the market to DIY freely.
- The keyboard is made of solid materials and the keys are responsive.
- Two-level kickstand, hidden independent space to storage USB receiver.
- A series of convenient FN+ key combinations

- Keyboard return rate: wired mode 1000Hz, 2.4G mode 1000Hz, Bluetooth mode 125Hz.
- Three-mode Connection: 2.4GHz/Bluetooth 5.0/USB C wired. All keys anti-ghosting.

Wired Mode/Keyboard ON/OFF

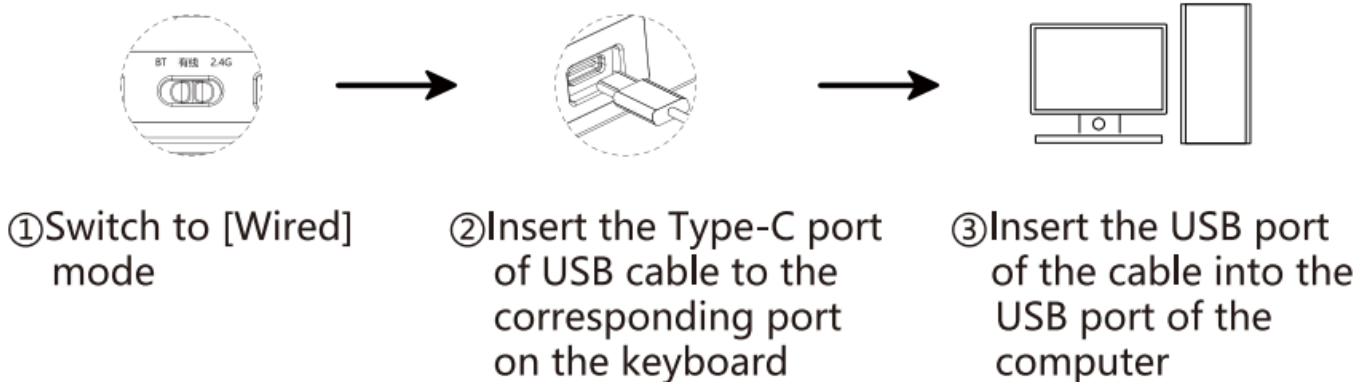

Keyboard ON/OFF Instruction

Turn the switch to wired (no USB power supply), the keyboard will be turned off, and the built-in battery will stop supplying power to the keyboard.

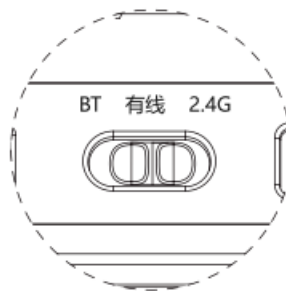

Connection Instruction

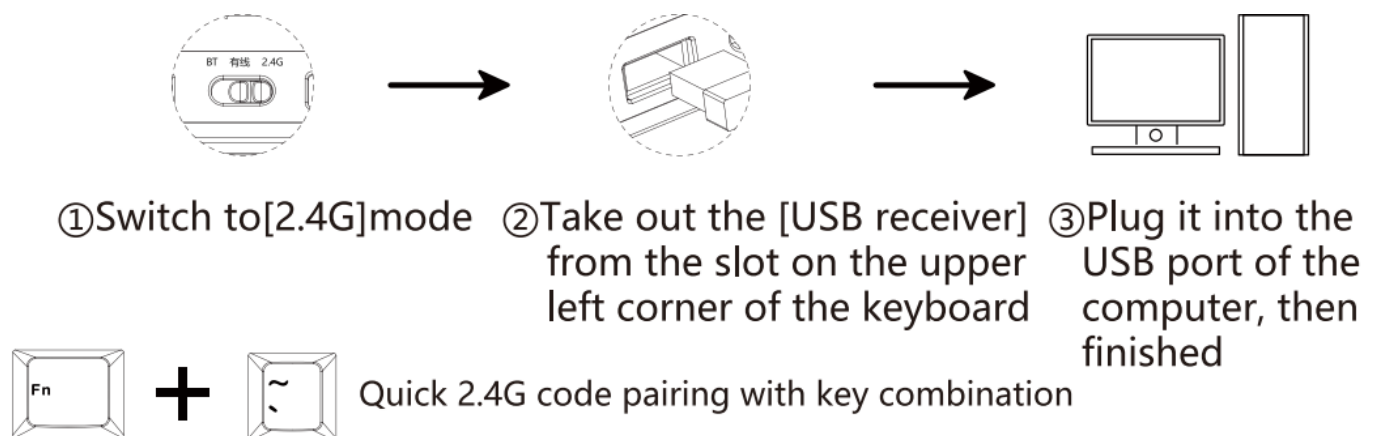

- Manual code pairing: Press and hold the combination key “FN+~” for about 3 seconds, the blue light flashes quickly to enter the code pairing state, at this time, insert the receiver into the computer USB port, the blue light of the ‘~’ key is on for 2 seconds, and the 2.4G connection is successful.
- Note: When manually checking the code, it is necessary to place the keyboard close to the receiver. When checking 2.4G codes, first put the keyboard into the code checking state before inserting the receiver into the computer.

Bluetooth Connection Instruction

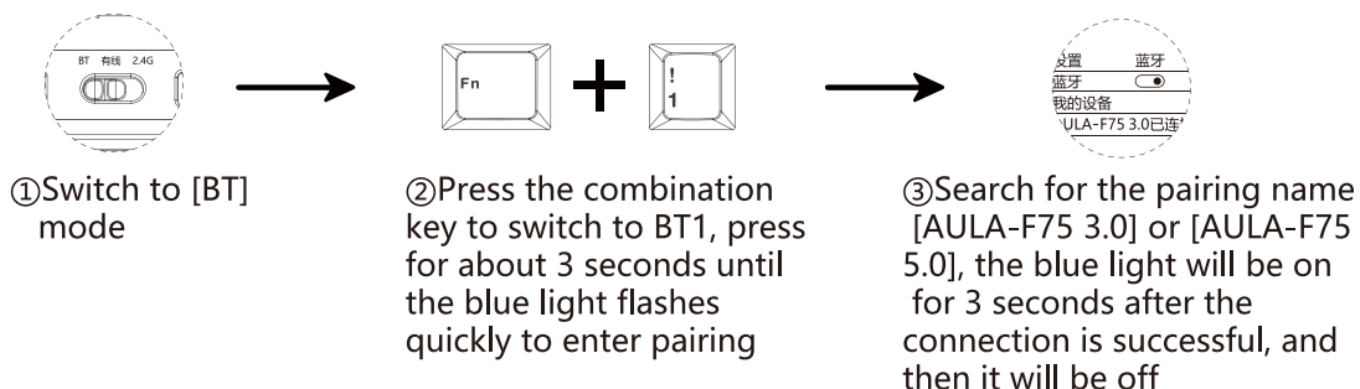

Key Combination for Fast Device Switching

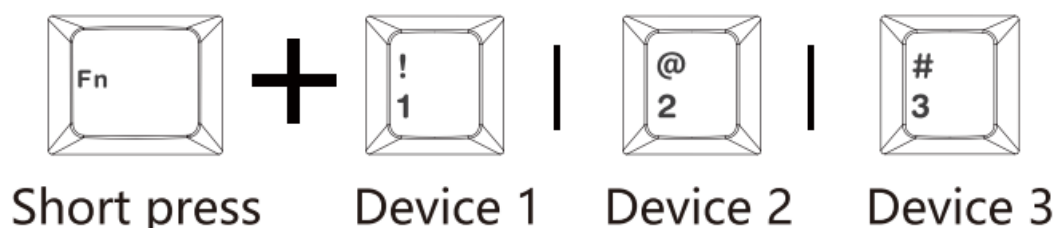







- Short press the combination key Fn + number 1, 2 or 3, the blue light flashes quickly, indicating that the keyboard enters the pairing or search mode. In the reconnection state, the blue light is on for 3s.
- Press Fn + number key 1, 2, or 3 to switch devices.
- Check the battery level of the keyboard, and it can be displayed on the computer when connected to Bluetooth.

Backlight Effect Adjustment

FN+ Combination keys and scroll wheel keys to switch 16 RGB light effects and turn off a total of 17 light effects:				
wave	Follow wave	Sine wave	rotating windmill	colorful waterfall
flowers bloom	customize	Turn Off	Constant light	breathing
dream rainbow	burst	raindrops	Rainbow Wheel	ripple spread
No trace of snow	River			

With the driver, there is a music rhythm RGB lighting effect, under this lighting effect, there are 10 lighting effect modes to choose from

Shortcut Keys for Backlight Effects Adjustment

FN +		Toggle light mode
		Switch light color
		Light brightness +
		Light brightness -
		Light speed -
		Light speed +

Operating System Mode Switching

- Fn+ WIN=Lock/unlock WIN (The white indicator light is on when the WIN key is locked. The WIN key cannot be used in this state.)
- After switching to the Mac system, the left WIN/left ALT key function is interchangeable (WIN key is not locked)

FN +	Q	Android system
	W	Windows system
	E	MAC system

Shortcut Key Description

FN+	ESC	Long press for 3 seconds to restore factory settings	FN+	I	SCRLK
	、~	Long press for 3 seconds to 2.4G pair code		O	PAUSE
	1	Bluetooth device 1#		DEL	INS
	2	Bluetooth device 2#		END	HOME
	3	Bluetooth device 3#		left shift	Adjustment of charging indicator light effect
	WIN	Lock the WIN key, the WIN key cannot be used when locked		B	Power display
	U	PRTSC			

- Press FN+ESC to restore the factory default lighting mode, and the original connected Bluetooth device will not be cleared.
- In 2.4G/Bluetooth mode, press and hold FN+B to check the battery level. When fully charged, the number keys 1 to 0 will all light up in green. The green light gradually decreases as the battery consumption decreases, and when the battery is low, the red light turns on. Release to restore the light effect.

FN +Q=Android system (the red light of Q key flashes for 3s) F area single press function and F area FN combined function.

Key position	single press	Fn combination
F1	Screen brightness-	F1
F2	Screen brightness+	F2
F3	Switch window	F3
F4	Main screen	F4
F5	Light brightness-	F5
F6	Light brightness+	F6

Key position	single press	Fn combination
F7	Previous song	F7
F8	Play/pause	F8
F9	Next song	F9
F10	Mute	F10
F11	Volume -	F11
F12	Volume +	F12

FN +W=Windows system (the red light of W key flashes for 3s),F area single press function and F area FN combined function.

Key position	single press	Fn combination
F1	F1	Homepage
F2	F2	Mail
F3	F3	Switch window
F4	F4	Open Explorer
F5	F5	Light brightness-
F6	F6	Light brightness+

Key position	single press	Fn combination
F7	F7	Previous song
F8	F8	Play/pause
F9	F9	Next song
F10	F10	Mute
F11	F11	Volume -
F12	F12	Volume +

FN+E= Mac system (the red light of the E key flashes for 3s), F area single press function and F area FN combined function.

Key position	single press	Fn combination
F1	Screen brightness-	F1
F2	Screen brightness+	F2
F3	Switch window	F3
F4	Main screen	F4
F5	Light brightness-	F5
F6	Light brightness+	F6

Key position	single press	Fn combination
F7	Previous song	F7
F8	Play/pause	F8
F9	Next song	F9
F10	Mute	F10
F11	Volume -	F11
F12	Volume +	F12

Multifunctional roller adjustment instructions

Dual mode switching: Long press the mode button to switch between game and office modes.

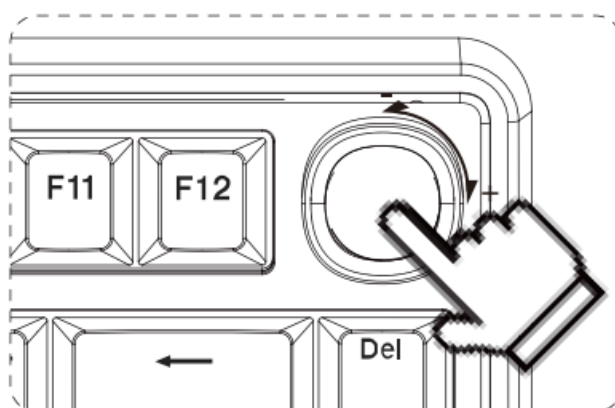

Game mode (WIN key & CAPS key, green light flashes 3 times)

- Short press the mode button to cycle through 16 lighting effects
- Knob clockwise (light brightness +)
- Knob counterclockwise (light brightness -)

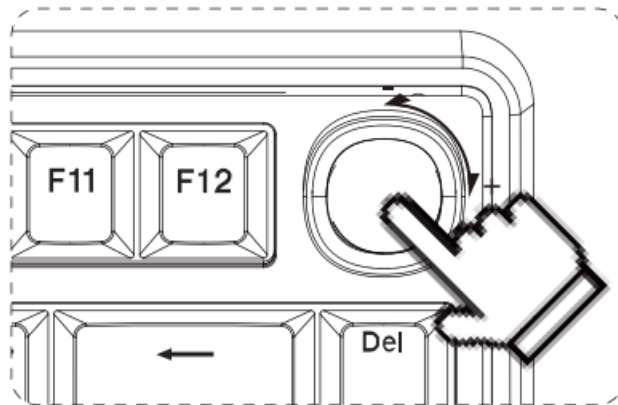

Office mode (WIN key & CAPS key, the blue light flashes 3 times)

- Short press the mode button = multimedia function (mute)
- Knob clockwise = multimedia function (volume +)
- Knob counterclockwise = multimedia function (volume -)

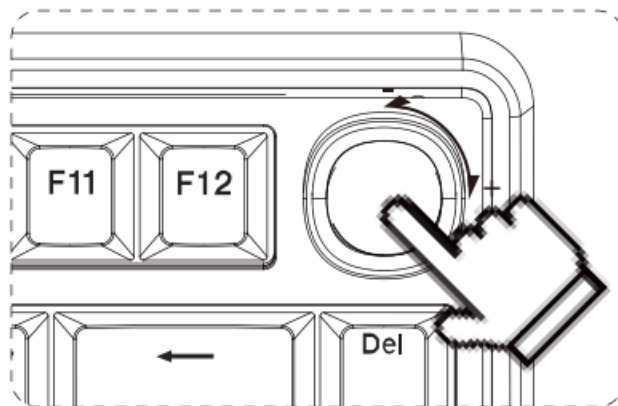

Current Status Indicator Description

- Press and hold FN to view:
- Current connection mode (2.4G, Bluetooth, wired); Current Bluetooth channel (channel 1, 2, 3)
- Current system mode (Android, WIN, Mac)
- The above corresponding buttons will light up, release the button to restore the light effect.

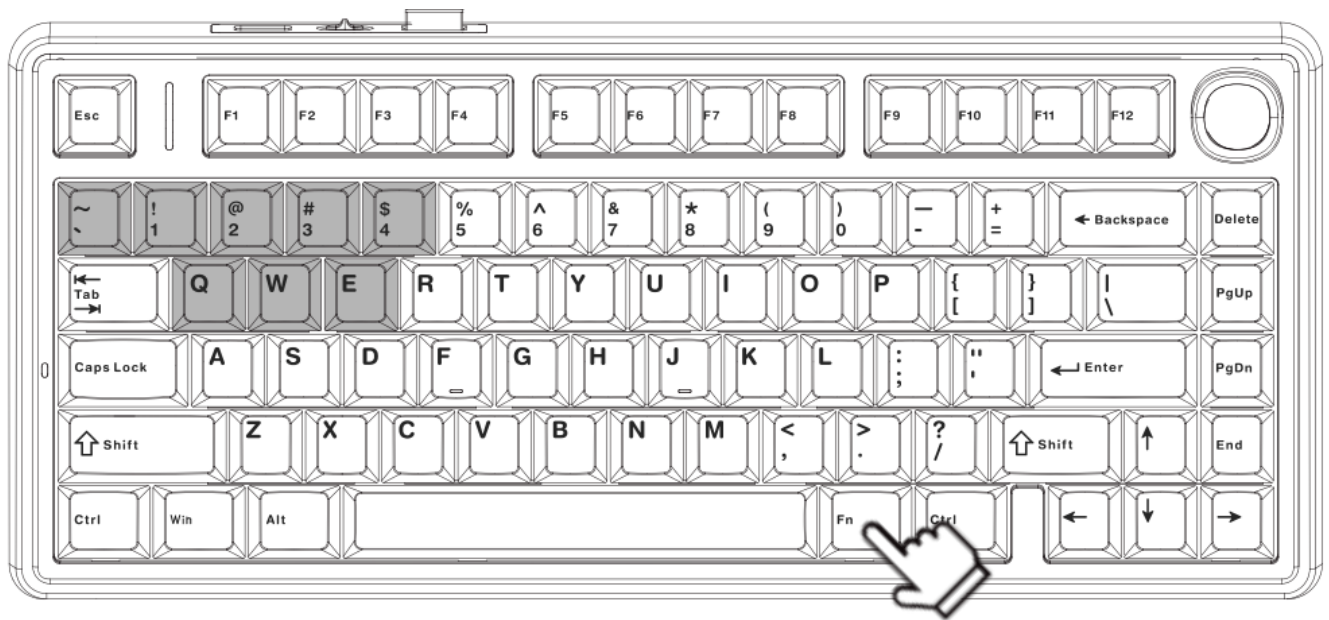

- 2.4G mode indicator = “~” key
- Wired mode indicator = “4” key
- Bluetooth channel indicator = “1,2,3” key
- System mode indicator = “Q, W, E,” key



Description of Smart Sleep Mode

In Bluetooth/2.4G mode, it will automatically enter power saving mode without any operation for one minute, and click the button to wake up the keyboard.

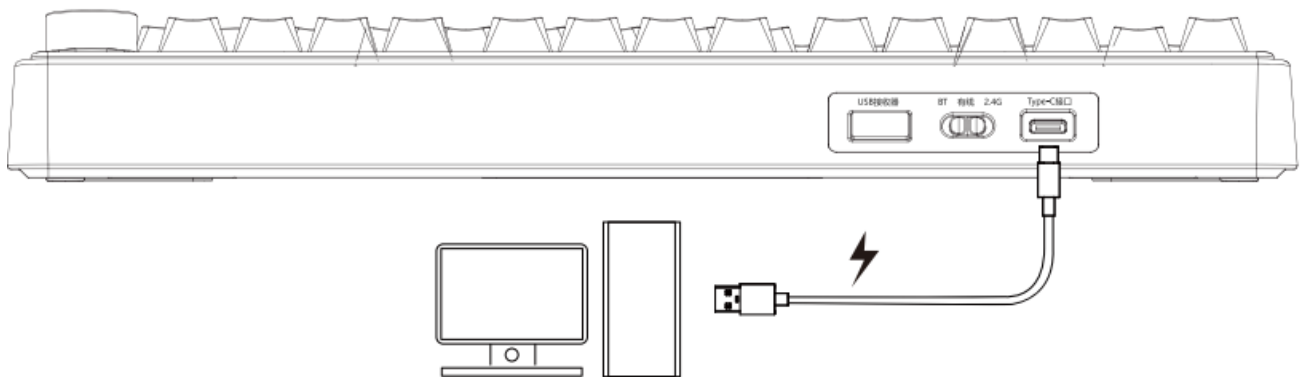
Charging Instructions



- Connect the keyboard to the computer through the provided USB cable to charge the keyboard. During charging, the charging indicator bar is running. The indicator light is always on after fully charged.
- Type-C connectivity is more reliable and performance is more stable.

  <p>Charging instructions</p>	<ol style="list-style-type: none"> 1. It is recommended to use only the computer USB port to charge the keyboard. 2. Do not use fast-charging cell phone chargers to charge the keyboard. 3. Do not use inferior non-standard power adapter to charge the keyboard. 4. Do not use over-voltage and over-current power adapter to charge the keyboard. 5. Please keep away from high temperature equipment when charging 6. Please turn off the power switch if it is not used for a long time. <p>The above charging instructions also apply to other devices with charging function (keyboard/mouse/headphones/speakers, etc.)</p>
---	--

Product Parameters

- Number of keys: 80 keys
- Total travel of keys: 4.0mm
- Multi-function FN+ keys
- Product size: 322.7 (L) x143.2 (W) x43.1 (H) ≤1mm
- Product weight: about 975g (excluding wire/receiver)
- About 1023g (including wire/receiver)
- Charging voltage/current: DC 5V  700mA
- Rated voltage: DC 3.7V (fully charged state: 4.2V)
- Rated current: 230mA @3.7V (default light effect) 15 mA (turn off all lights)
- Battery life: about 17.5 hours (default lighting effect) about 266.5 hours (turn off all lights)
- Battery capacity: 4000mAh rechargeable lithium battery
- Charging interface: Type-C interface
- Computer System Requirements:
 - Wired/2.4G mode: Windows ALL operating system WIN XP, WIN7, WIN8, WIN10 (Driver may be required under Win95 and Win98 systems).
 - Wired mode/2.4G receiver: equipped with USB 1.1 or above port.
- Bluetooth mode “device name: AULA-F75 3.0 KB” WIN7 and below systems.
- Bluetooth mode “device name: AULA-F75 5.0 KB” WIN8, WIN10 and above systems.
- Bluetooth mode: MAC computer, Android phone or tablet, IOS phone or tablet with Bluetooth BT3.0, BLE4.0, BLE5.0 and above hardware.
- Hardware connection
 - Wired USB/2.4G receiver, support hot swap (plug and play).

Description of warranty matters

Dear Customer:

Thank you for purchasing AULA series products! This warranty card is the proof of AULA products, which is kept by the user, with this warranty card you will enjoy the after-sales service provided by AULA.

This warranty card is a copy of each product and will not be replaced if lost, so please keep it in a safe place.

With this card you will enjoy the following rights and services:

1. Return service: within seven days from the date of sale of the product, the product quality problems, according

to the provisions of the national “three packages”, in the case of the product appearance and packaging intact, the product will be returned to the seller or tarantula designated places, with the purchase of the valid certificate, return the product you paid for the purchase price.

2. Warranty service: If the product performance failure is detected by AULA after-sales service center within 12 months from the date of purchase, you can enjoy the maintenance service free of charge.

The following situations do not belong to the free service scope:

1. Exceeding the specified warranty period;
2. Cannot show the valid warranty certificate or the original serial number label has been altered, replaced, torn and other phenomena;
3. There is no serial number on the product or the product model on the warranty certificate does not match the product in kind;
4. Failure and damage caused by abnormal use, maintenance and storage;
5. Failure or damage caused by repair, change or disassembly of the product by non-authorized maintenance personnel of our company;
6. Failure or damage caused by accidents or other force majeure;
7. Services and additional accessories or gifts outside the product promised by the sales staff are not included in the scope of this warranty service;
8. Failure or damage caused by unstable power supply or voltage.

User warranty card

sales record:

user information	User (name/unit)			
	Phone/E-mail			
	Correspondence address and zip code			
Sales Information	sales unit			
	Sales Unit Address			
	contact number		zip code	
	Product Model			
	Seller's seal		Date of sale	

Repair Record:

Repair Date	Repair Unit	Telephone number	Address

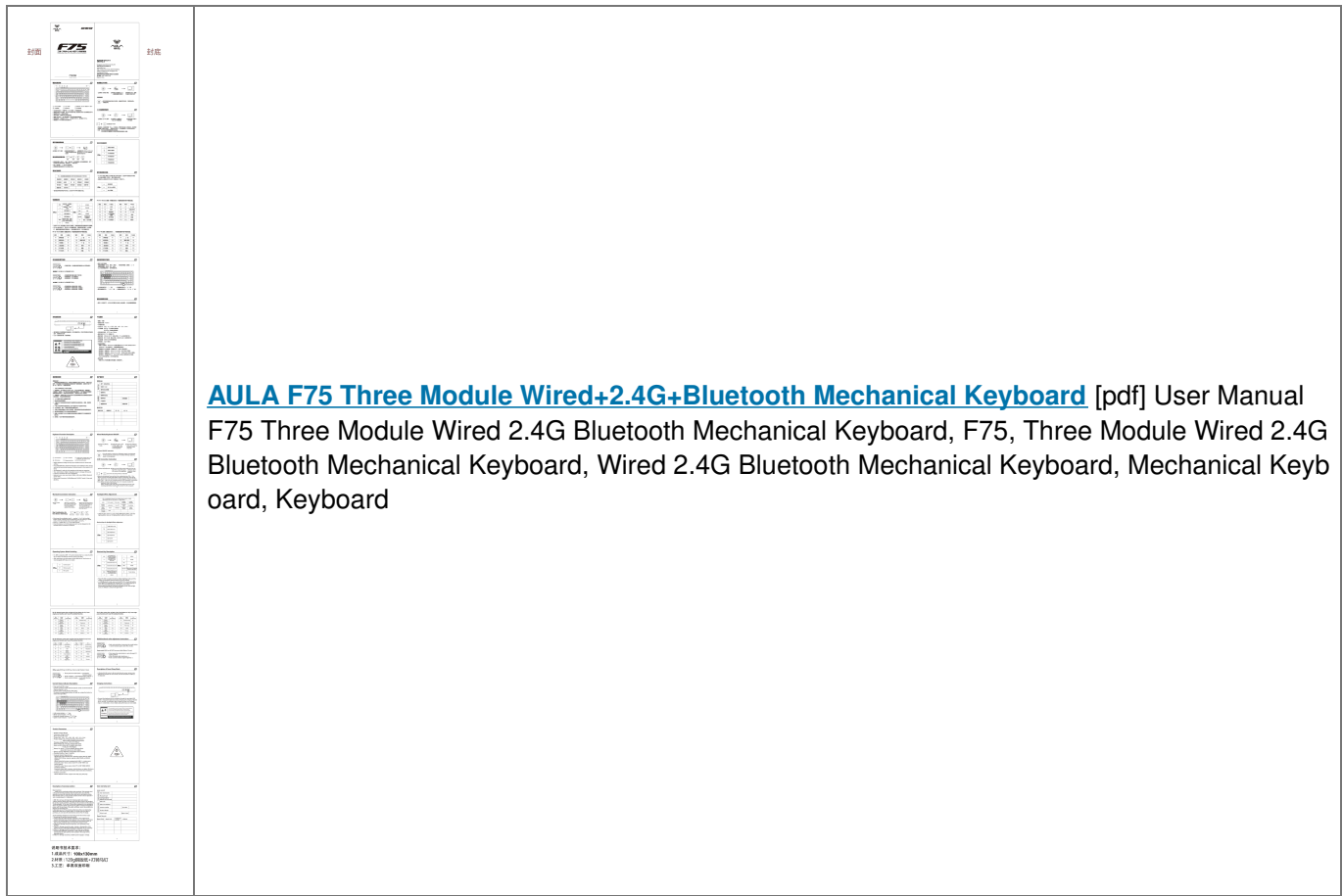

[AULA F75 Three Module Wired+2.4G+Bluetooth Mechanical Keyboard \[pdf\]](#) User Manual
F75 Three Module Wired 2.4G Bluetooth Mechanical Keyboard, F75, Three Module Wired 2.4G Bluetooth Mechanical Keyboard, Wired 2.4G Bluetooth Mechanical Keyboard, Mechanical Keyboard, Keyboard

References

- [User Manual](#)

Manuals+, Privacy Policy

This website is an independent publication and is neither affiliated with nor endorsed by any of the trademark owners. The "Bluetooth®" word mark and logos are registered trademarks owned by Bluetooth SIG, Inc. The "Wi-Fi®" word mark and logos are registered trademarks owned by the Wi-Fi Alliance. Any use of these marks on this website does not imply any affiliation with or endorsement.