



AUGEX B0BKPxRMS4 PS4 Ymir Wireless Controller User Manual

[Home](#) » [AUGEX](#) » AUGEX B0BKPxRMS4 PS4 Ymir Wireless Controller User Manual 



Ymir Wireless Controller
for PS4
User Manual



Contents

- [1 B0BKPXRMS4 PS4 Ymir Wireless Controller](#)
- [2 Specifications](#)
- [3 Ymir Device Layout](#)
- [4 Connection](#)
- [5 Turbo Setting](#)
- [6 Programming Setting](#)
- [7 Cancel Programming](#)
- [8 FQA](#)
- [9 Documents / Resources](#)

B0BKPXRMS4 PS4 Ymir Wireless Controller

Before Use

- Please charge the controller for more than 3 hours before first time using.
- Please carefully read this manual and keep it for future reference.
- Please update your system to the latest version anytime.

Specifications

Product name	Ymir P4 controller
Input power rating	DC 3.7 V, 1200 mAh
Battery type	Built-in rechargeable lithium-Ion battery
Bluetooth	4.0 version wireless connection
Wireless distance	10m / 33 feet
Operating temperature	5°C-35°C
Mass	Approx., 221g
Size	Approx., 4.2*6.1*2.2in
Function	mapping,turbo,touchpad, speaker, double shock, headset jackshare, 3-axis gyroscope 3-axis acceleration sensor

Packing List

- Ymir Wireless Controller for P4
- 1 * 0.8m USB-C Cable (data transfer)
- 1 * Manual Book

Ymir Device Layout

Front

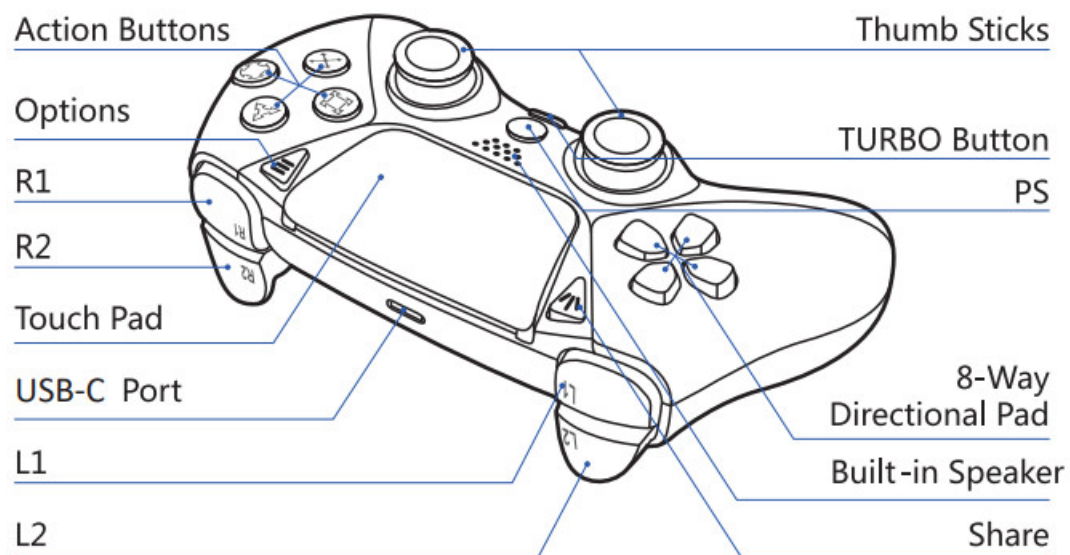

Back

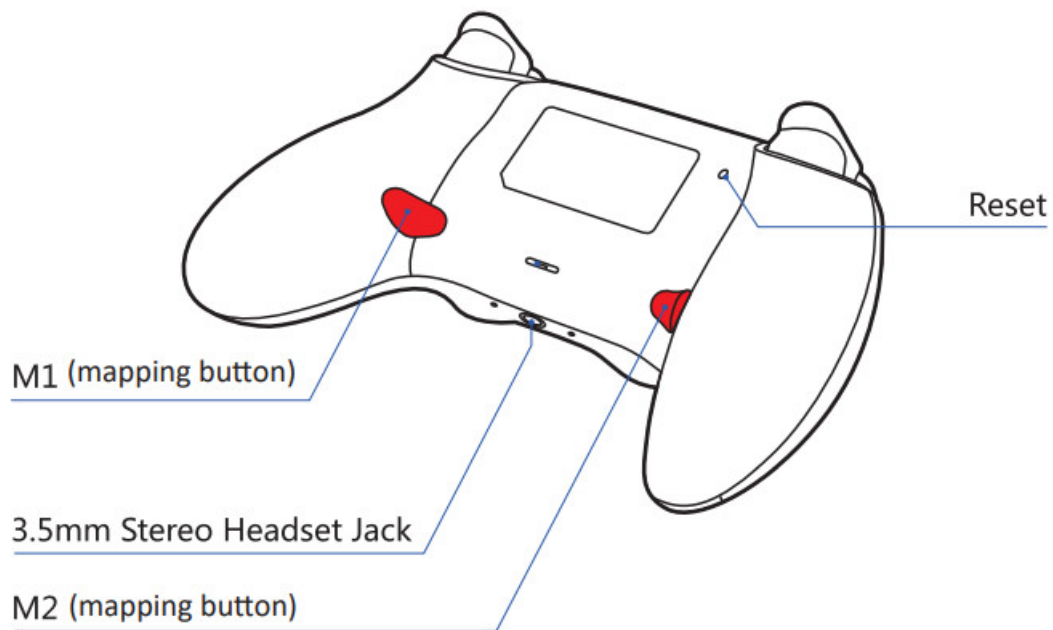

Connection

Item	Description
Connection mode	<ul style="list-style-type: none"> • Bluetooth wireless connection • Type-C USB cable connection
Connect with – PS4 / Pro – PS4 Slim /Edition – PS5 (only play ps4 games on PS5)	<ul style="list-style-type: none"> • For the first time: Step 1: Turn on the PS4/5 console, plug the controller to the console with included USB cable. Step 2: Press the “PS” button to start connect. Step 3: After the connection succeed, unplug the USB cable and the controller would be connected to the console wirelessly. • Re-connect: Press the “PS” button to turn on your controller, it will reconnect to console automatically. Notice: Only can play PS4 games on PS5 console.
Connect with – Steam – Windows PC 7/10 or above – Mac OS – iOS 13 or above – Android 8.0 or above	Step 1: Turn on the Bluetooth device in PC, TV, Android , iOS, Mac OS or steam you want to connect. Step 2: Press the “Share” & “PS” buttons of the controller at the same time for 10s, the RGB light will flash in WHITE . Step 3: Pair the device called “Wireless Controller” or “DUALSHOCK 4 Wireless Controller”.

Turbo Setting

How to set up turbo?

Long press the “Turbo” + target function button over 5s, when the RGB flashes in WHITE 8 times, the turbo setting succeed.

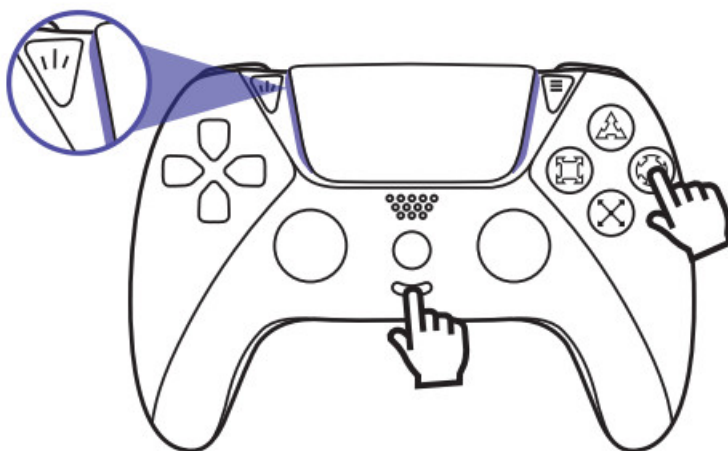

How to cancel the turbo ?

Long press the “Turbo” + target function button again over 5s, and the RGB flashes in WHITE 8 times, the turbo setting cancelled.



How to set up turbo speed?

50Hz: Turbo +↑
(The fastest speed)

25Hz: Turbo +→

12.5Hz: Turbo +↓

6.25Hz: Turbo +←
(The slowest speed)



RGB flashes in blue



RGB flashes in green



RGB flashes in red

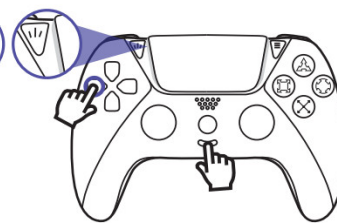

RGB flashes in white

Notice: please make sure you have opened the turbo function before you set up turbo speed.

Programming Setting

Step1: Long-press the Turbo and either the M1 or M2 button for 5s, and the RGB lighting around the Touch Pad will flash GREEN 2 times, which means the controller enter into the mapping model.

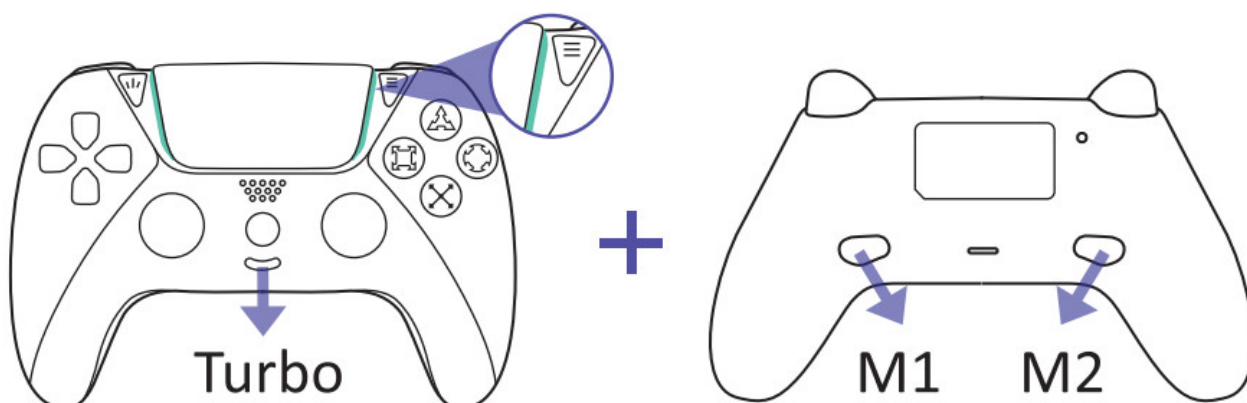

Step 2: Press the function button you want to map.



Step 3: Then press Turbo to confirm, RGB flashes in RED 2 times and setting succeeded.

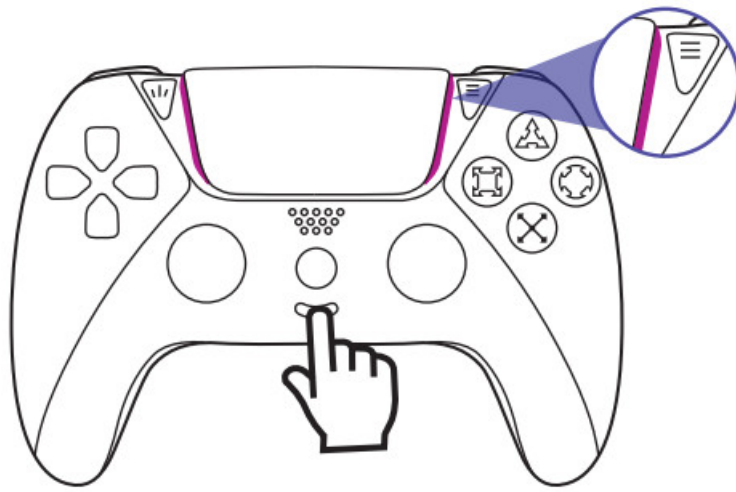

Cancel Programming

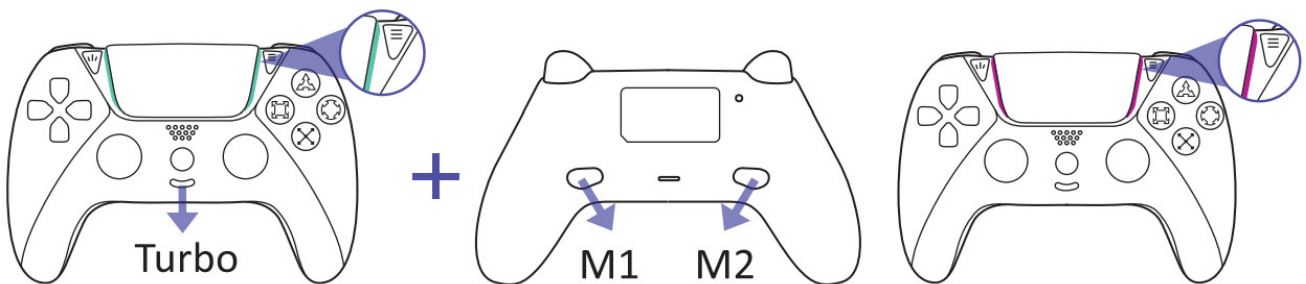

Long press the Turbo + M1/M2 button for 5s, the RGB flashes in GREEN 2 times. After RGB green flashes, waiting for 5s, the RGB will flash in red 8 times, which means canceling the mapping succeeds.

Press One Button to Cancel Setting

Long press the "Turbo" Button for 8s, the RGB flashes in WHITE 8 times, it could cancel all the turbo and mapping setting.

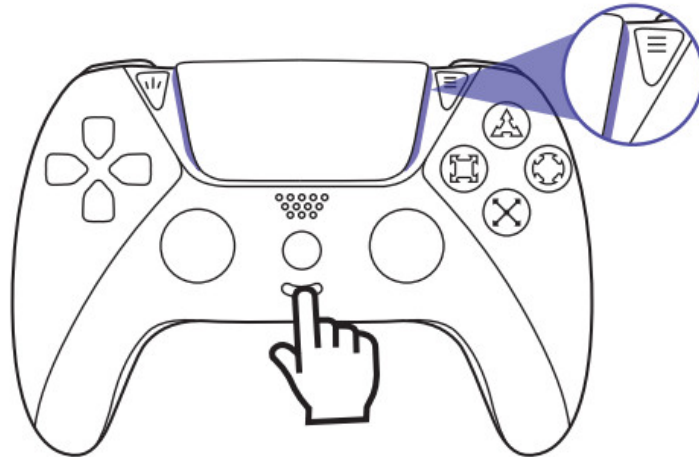

How to Reset the Ymir Controller?

1. The first way to reset in the Playstation.

For a soft reset, use a working controller to go to the PlayStation Dashboard, select "Settings," select "Devices," and then select "Bluetooth Devices." Highlight the controller you want to reset, press the "Options" button, then select "Forget Device."

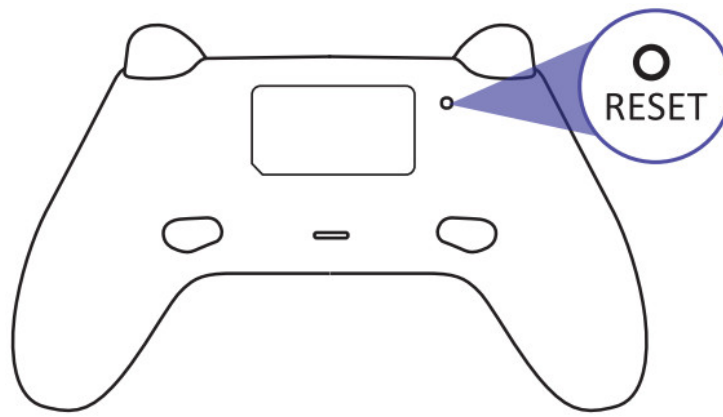

2. The second way is use a pin to press the “reset” button on the back of Ymir controller.

FQA

Programable Button



The following 12 buttons can be programmed:

Programming Memory

The programming settings will remain when you turn off controller or console.

Charging Your Controller

With the system turned on or in reset mode, connect your controller using the USB cable.

Audio Setting

You can connect any standard wired headphones with a 3.5mm adapter to your controller. You may need to navigate to your console settings to make sure the system will process audio through your device.

When Not In Use

When the controller is not used for an extend period of time, it is recommend that you fully charge it at least once a year in order to maintain its functionality.



Documents / Resources

<div><div>Ymir Wireless Controller for PS4</div><div></div><div>User Manual</div></div>	<div><div>AUGEX B0BKPXRMS4 PS4 Ymir Wireless Controller [pdf] User Manual</div><div>B0BKPXRMS4 PS4 Ymir Wireless Controller, B0BKPXRMS4, PS4 Ymir Wireless Controller, Wi reless Controller, Controller</div></div>
--	---