



audioengine HD6 Powered Stereo Speakers with Bluetooth User Manual

[Home](#) » [audioengine](#) » audioengine HD6 Powered Stereo Speakers with Bluetooth User Manual 

audioengine HD6 Powered Stereo Speakers with Bluetooth User Manual



Welcome to the Audioengine family and congratulations on your purchase of the Audioengine® HD6 Premium Powered Speaker System!

The Audioengine team is dedicated to bringing you the highest-quality listening experience possible and the Audioengine HD6 was designed with the same attention to detail and operational simplicity as all other Audioengine products.

As with our other past efforts we thank our customers, distributors and resellers for all the inspiration to create another great product.

What's in the box

- HD6 powered (left) speaker
- HD6 passive (right) speaker
- Magnetic speaker grills
- Remote control
- Speaker wire (16AWG), 3.75 meters (~12.3ft)
- Power cable
- Mini-jack audio cable, 2 meters (~6.5 feet)
- RCA audio cable, 2 meters (~6.5 feet)
- Microfiber speaker bags
- Microfiber cable bag
- Quickstart guide

Features

- Built-in analog power amplifiers
- Wireless Bluetooth® with aptX®, extended range, and 24-bit upsampling DAC 24-bit digital optical TOSLINK input
- Dual analog inputs and variable audio output
- Hand-built cabinets and high-quality connectors
- Custom Kevlar woofers and silk tweeters
- Remote control
- Detachable magnetic grills

Safety Instructions

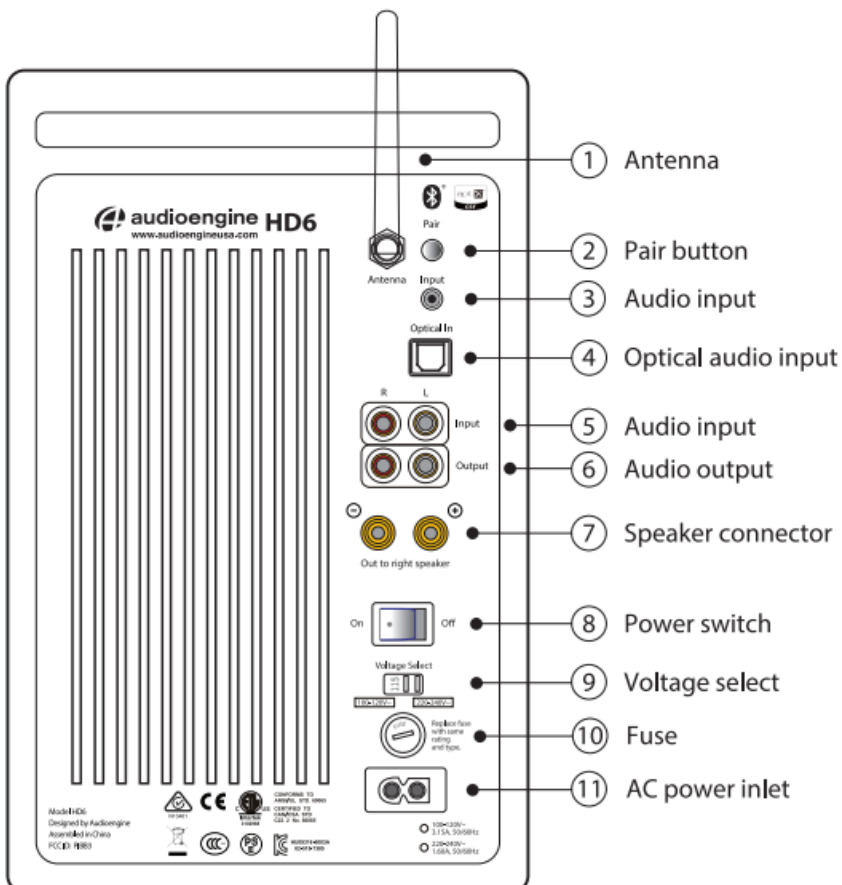

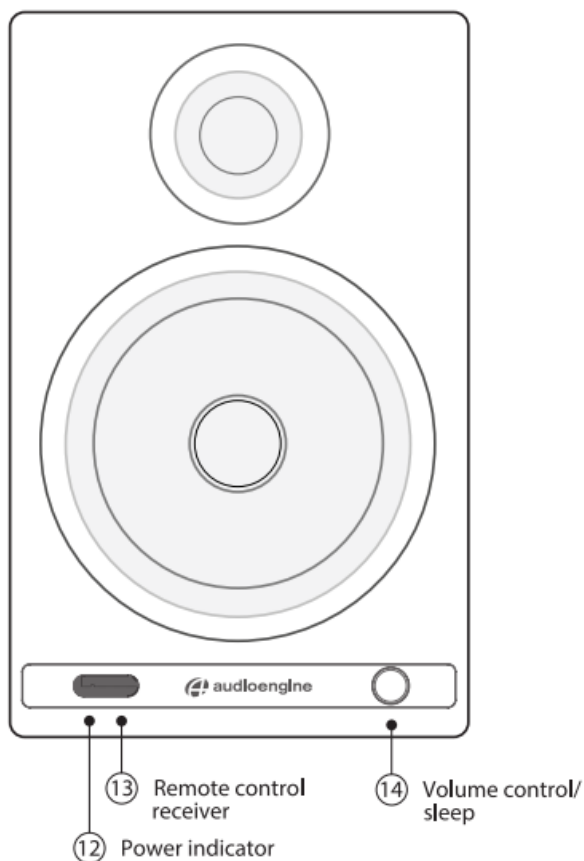

1. Please read these instructions before using this product.
2. Keep these instructions for future reference.
3. Heed all warnings on the product and in this guide.
4. Follow all instructions.
5. Do not use this apparatus near water or moisture.
6. Clean only with a dry cloth and as directed by the manufacturer.
7. Do not block any ventilation openings. Install in accordance with the manufacturer's instructions,
8. Do not install near any heat sources, such as radiators, heat registers, stoves or other apparatus that produce heat.
9. Do not defeat the safety purpose of the polarized or grounding-type plug. A polarized plug has two blades with one wider than the other. A grounding-type plug has two blades and a third grounding prong. The wider blade or third prong are provided for your safety.
10. Protect the power cord from being walked on or pinched, particularly at plugs, convenience receptacles, and the point where they exit from the apparatus.
11. Use only attachments or accessories specified by the manufacturer.
12. Use only with the cart, stand, tripod, bracket or table specified by the manufacturer or sold with the apparatus. When a cart is used, use caution when moving the cart/apparatus combination to avoid injury from tip-over.
13. Unplug this apparatus during lightning storms or when unused for long periods of time to prevent damage to this product.
14. Refer all servicing to qualified service personnel. Servicing is required when the apparatus has been damaged in any way such as power supply cord or plug is damaged, liquid has been spilled or objects have fallen into the apparatus, the apparatus has been exposed to rain or moisture, does not operate normally, or has been dropped.

**CAUTION**

RISK OF ELECTRICAL SHOCK DO NOT OPEN



CAUTION: TO REDUCE THE RISK OF ELECTRIC SHOCK, DO NOT REMOVE COVER (OR BACK.) NO USER-SERVICABLE PARTS INSIDE. REFER SERVICING TO QUALIFIED PERSONNEL

Quick Setup

1. Connect the speaker wire from the HD6 left (powered) speaker to the right (passive) speaker.
2. Connect the wireless antenna to the HD6 rear panel.
3. Connect the power cable to the HD6 rear panel and plug the other end into an AC power outlet.

Wireless connection

4. Turn on the HD6 power switch located on the rear panel. HD6 will automatically go into Bluetooth “pair mode” and the Pair button on the HD6 rear panel should start flashing.
5. On your device (phone, tablet, laptop, etc), turn on Bluetooth and go to Bluetooth preferences.
6. Select Audioengine HD6” to pair and connect. The Pair indicator on the HD6 rear panel should be solid.
Play your music and adjust volume levels on HD6 and your device.
7. To add additional devices put HD6 back into pair mode by disconnecting HD6 from your device or by pressing and holding the Pair button on the HD6 rear panel until the pair indicator starts flashing. HD6 can wirelessly connect to only one device at a time, however it will remember up to six different devices.

Wired connection

8. Connect one of the included audio cables to your music player (phone, tablet, computer, TV, etc.) and the other end to an input on the HD6 rear panel.
9. Play your music and adjust the volume on the speakers and your device to the desired listening levels.

Inputs and volume settings

Multiple sources and devices may be connected to the speakers at the same time and all inputs are open and active so it's easy to switch between your tablet, phone, TV, or any other device.

To adjust the volume, we recommend you first set a level on the HD6 and then use the volume control directly on your device to adjust the overall level. Volume settings are flexible and there is no right or wrong so feel free to experiment to find settings that work for you.

Optical input

The Toslink digital optical input on the HD6 rear panel can accept PCM stereo streams from any optical source, such as a TV, computer, Apple TV, media server, DVD/Blu-ray player, CD player, or any other product with an optical output.

The HD6 includes built-in power amplifiers so do not connect the HD6 speaker terminals directly to the speaker outputs of a stereo receiver or amplifier.

Break-in period

Your HD6 speakers will sound great right out of the box and will sound even better over time. However, it's best to give them 40 to 50 hours break-in time before doing any critical listening.

Cleaning

We don't recommend using any solvents or cleaners on Audioengine cabinets or speakers. Just wipe down with a soft, dry cloth.

For additional setup instructions and troubleshooting tips, go to: audioengineusa.com

Remote Control

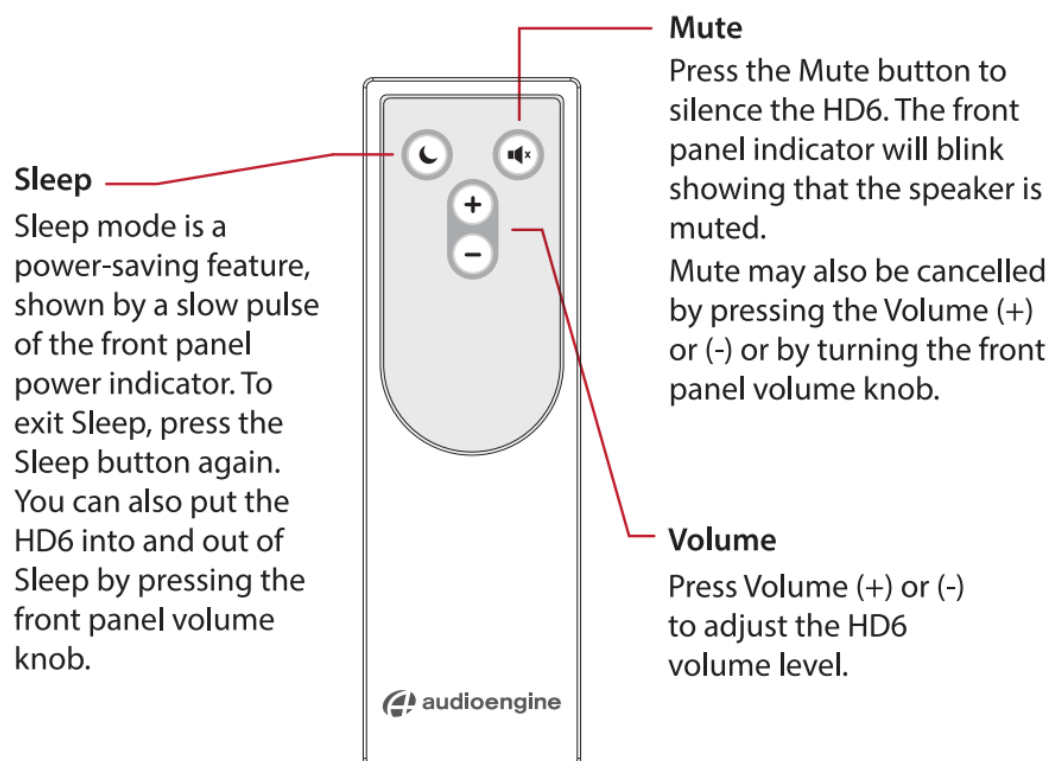

Replacing the battery

If the remote control isn't working or is slow to respond, the battery may need to be replaced. To access the battery, insert a paper clip into the hole on the back of the remote.

Other Features

Variable output

The HD6 includes a variable full-range preamp audio output so you can connect a subwoofer, other Audioengine powered speakers or an Audioengine wireless adapter to stream music to other systems around your house. This output is variable (adjustable) so the volume level of the output can be controlled from the HD6 front panel or remote control.

Stand mounting

Threaded 1/4"x 20 brass inserts are included on the bottom of each speaker cabinet to provide the ability to attach the speakers to floor stands. These inserts, however, are not designed to support the full weight of the speakers and therefore should not be used with single-point wall or ceiling mounts.

Important safety note: It is the customer's responsibility to check with the speaker stand manufacturer to determine whether that specific stand is capable of handling the weight and proportions of these speakers in a safe and stable manner. The customer is also responsible for proper selection of mounting hardware not included with the speaker and for proper assembly. Audioengine disclaims any liability for the selection of suitable floor stands and/or correct hardware between the selected stand and these speakers.

Product technical specifications

For HD6 specifications, additional setup instructions and other product information go to: audioengineusa.com

Contact support

If you have any questions, contact us via email: support@audioengineusa.com or call toll-free in the United States: (877) 853-4447

Speaker Placement

Although your HD6 speakers are very forgiving with regards to placement, it's true that proper speaker location can have an impact on sound quality. There seem to be different theories on correct speaker placement but rooms and tastes are different so it's difficult to recommend a perfect setup. We do suggest you feel free to experiment to see what works for you.

As a general rule of thumb for the best soundstage and imaging, the speakers should be equidistant from side walls and a different distance from rear walls. Tweeters should be at about eye-level in your most frequent listening location and for the best bass response we recommend at least 6 inches of clearance between the rear of the speakers and the wall behind them.

Here are a few more suggestions, assuming you have some flexibility regarding where you place your speakers. No need for concern if your situation and listening environment dictate the speakers' position.

Both speakers should be equidistant from your primary listening position.

Placing the speakers at least 6 feet (1.8m) apart usually provides the best imaging.

Try to keep the speakers near the front edge of shelves or cabinets.

Allow at least 6 inches of clearance between the rear of the speakers and the wall or surface behind them.

If you need to turn the speakers on their sides, position the tweeters toward the outside.

If used on a desktop for computer speakers, it's best if they are placed on a solid surface.

Warranty Information

All Audioengine products have a 3-year Limited Warranty on parts and labor from date of purchase. The Limited Warranty applies only to Audioengine products purchased in the United States. Your warranty is automatic, so there is no need to register. For Limited Warranty coverage elsewhere, please contact the Audioengine dealer, reseller, or distributor in your country or region.

What is covered

All defective parts or faulty workmanship.

What is not covered

The Audioengine Limited Warranty does not cover damage caused by accident, misuse, abuse, neglect, excessive moisture, lightning, power surges, other acts of nature, unauthorized product modification or repairs, or failure to follow the instructions outlined in this guide.

What we will do

We will repair or replace any defective parts, at our option, within a reasonable amount of time and free of charge any time during the warranty period. After service, we will be responsible for shipping the product back to you at our expense.

What we ask from you

You will be responsible for shipping charges to Audioengine or to an authorized dealer. We recommend you keep the original shipping materials to prevent shipping damage if service is needed. Audioengine cannot be responsible for any damages incurred during shipping due to poor packing, so please pack well and make sure to insure your shipment.

How to obtain Audioengine warranty service

If you have any questions about your warranty coverage or feel you may need service, email the Audioengine US Service Center: support@audioengineusa.com or call toll-free in the US: (877) 853-4447

We will do everything we can to answer your questions and resolve any issues as quickly as possible.

Exclusive remedy

This Limited Warranty is fully transferable provided the current owner furnishes the proof of purchase and that the serial number on the product is intact. THE MAXIMUM LIABILITY OF AUDIOENGINE SHALL NOT EXCEED THE ACTUAL PURCHASE PRICE PAID BY YOU FOR THE PRODUCT. IN NO EVENT SHALL AUDIOENGINE BE LIABLE FOR SPECIAL, INCIDENTAL, CONSEQUENTIAL OR INDIRECT DAMAGES.

Product returns and refunds

We sincerely hope you get as much enjoyment from our products as we've had creating them. However, should you have an issue or are not satisfied with any Audioengine product for any reason contact the reseller where you purchased your product or email us directly: support@audioengineusa.com or call toll-free if in the US: (877) 853-4447

About Audioengine

Audioengine designs and builds innovative audio products with all your music in mind. Great sound, simple but elegant designs, high quality materials, and truly useful features are what Audioengine is about. We sincerely hope you get as much enjoyment from our products as we've had creating them!

FCC Part 15 Notice

This device complies with Part 15 of the FCC Rules. Operation is subject to the following two conditions:

1. This device may not cause harmful interference.
2. This device must accept any interference received, including interference that may cause undesired operation.

Changes or modifications not expressly approved by the party responsible for compliance could void the

user's authority to operate the equipment.

This equipment has been tested and found to comply with the limits for a Class B digital device, pursuant to Part 15 of the FCC Rules. These limits are designed to provide reasonable protection against harmful interference in a residential installation.

This equipment generates, uses, and can radiate radio frequency energy and, if not installed and used in accordance with the instructions, may cause harmful interference to radio communications. However, there is no guarantee that interference will not occur in a particular installation. If this equipment does cause harmful interference to radio or television reception, which can be determined by turning the equipment off and on, the user is encouraged to try to correct the interference by one or more of the following measures:

- Reorient or relocate the receiving antenna.
- Increase the separation between the equipment and receiver.
- Connect the equipment into an outlet on a circuit different from that to which the receiver is connected.

- Consult the dealer or an experienced technician for help.

FCC Radiation Exposure Statement

This equipment complies with FCC radiation exposure limits set forth for an uncontrolled environment. This equipment should be installed and operated with minimum distance 20cm between the radiator & your body.

Information for Users on Disposal of Old Equipment

[European Union]

This symbol indicates that the electrical and electronic equipment should not be disposed as general household waste at its end-of-life. Instead, the product should be handed over to the applicable collection point for the recycling in accordance with your national legislation.

By disposing of this product correctly, you will help to conserve the environment and human health that could otherwise be caused by inappropriate waste handling of this product. For more information about collection point and recycling of this product, please contact your house- hold waste disposal service or the shop where you purchased the product. Penalties may be applicable for incorrect disposal of this waste, in accordance with national legislation.

[Other Countries outside the European Union]

If you wish to dispose of this product, please do so in accordance with applicable national legislation or other rules in your country for the treatment of old electrical and electronic equipment.

©2015 Audioengine. All Rights Reserved.

Audioengine and Audioengine HD6 are trademarks of Audioengine.

The Bluetooth name and the Bluetooth trademarks are owned by Bluetooth SIG, Inc. and are used by Audioengine under license.

The aptX mark and logos are registered trademarks of CSR plc.

The Bluetooth word mark and logos are registered trademarks owned by Bluetooth SIG, Inc



Contents

[1 Documents / Resources](#)

[1.1 References](#) **[2 Related Posts](#)**



[audioengine HD6 Powered Stereo Speakers with Bluetooth](#) [pdf] User Manual
HD6 Powered Stereo Speakers with Bluetooth, HD6, Powered Stereo Speakers with Bluetooth,
Stereo Speakers with Bluetooth, Speakers with Bluetooth, Bluetooth

References

-  [Manual-Hub.com - Free PDF manuals!](#)
- [User Manual](#)

[Manuals+](#), [Privacy Policy](#)

This website is an independent publication and is neither affiliated with nor endorsed by any of the trademark owners. The "Bluetooth®" word mark and logos are registered trademarks owned by Bluetooth SIG, Inc. The "Wi-Fi®" word mark and logos are registered trademarks owned by the Wi-Fi Alliance. Any use of these marks on this website does not imply any affiliation with or endorsement.