



## audio-technica Wireless speaker Installation Guide

[Home](#) » [Audio-Technica](#) » audio-technica Wireless speaker Installation Guide 

### audio-technica Wireless speaker Installation Guide



#### Contents

- [1 Part names and functions](#)
- [2 Charging the battery](#)
- [3 Pairing](#)
- [4 Help](#)
- [5 Communication specifications](#)
- [6 Documents / Resources](#)
  - [6.1 References](#)
- [7 Related Posts](#)

## Part names and functions

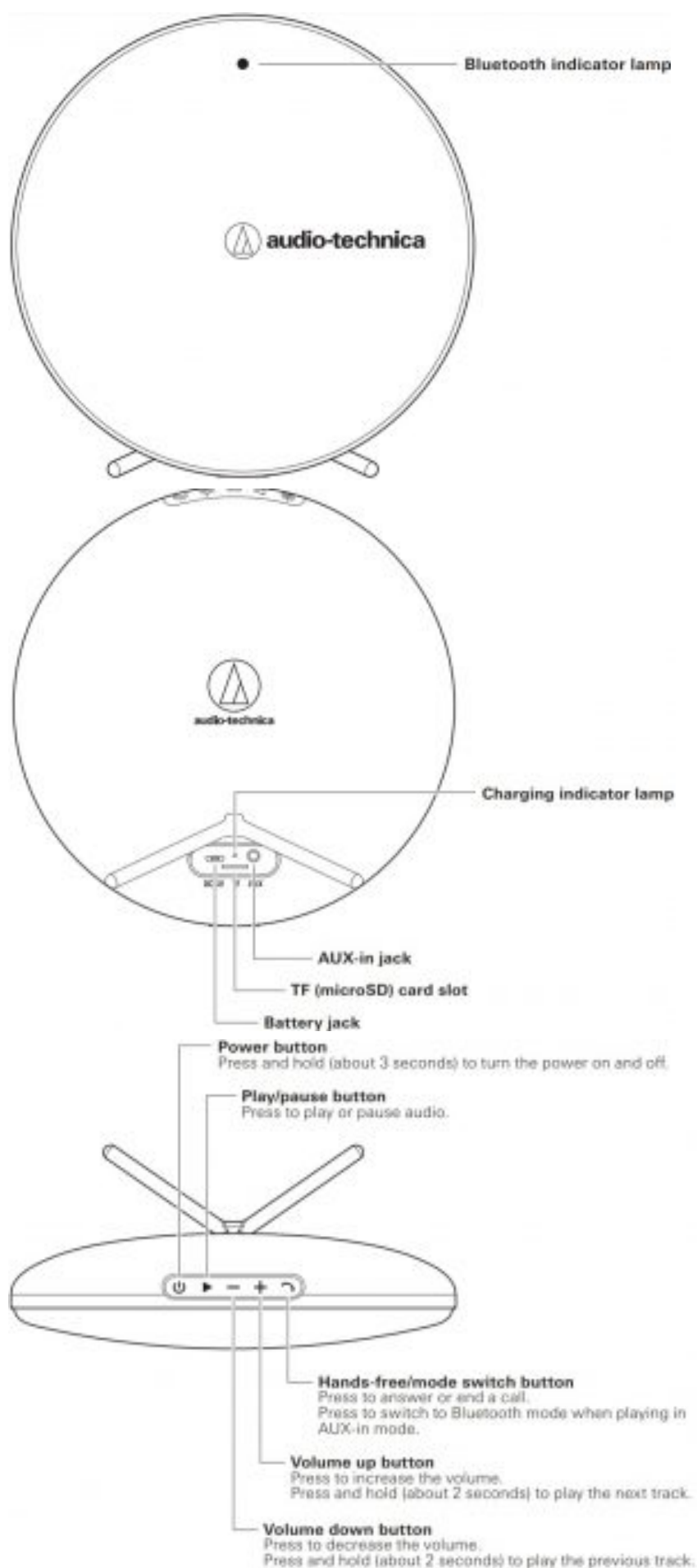

## Charging the battery

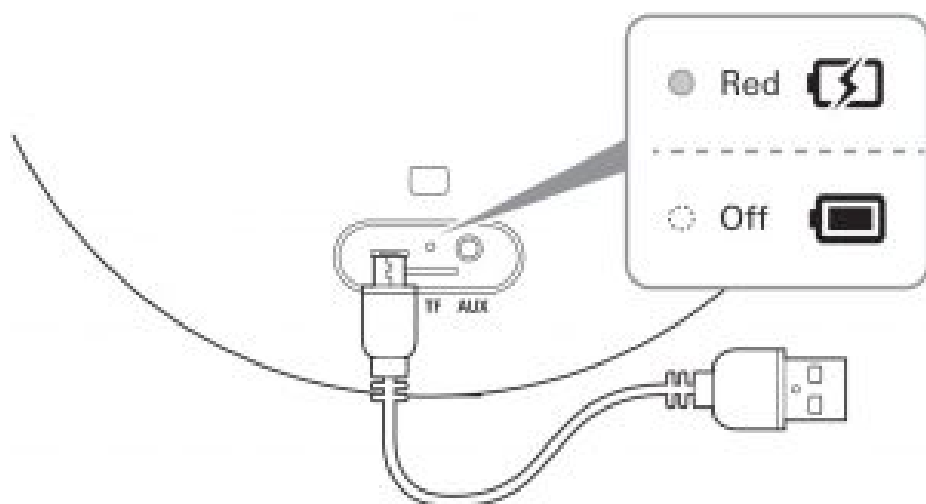

## Pairing

1

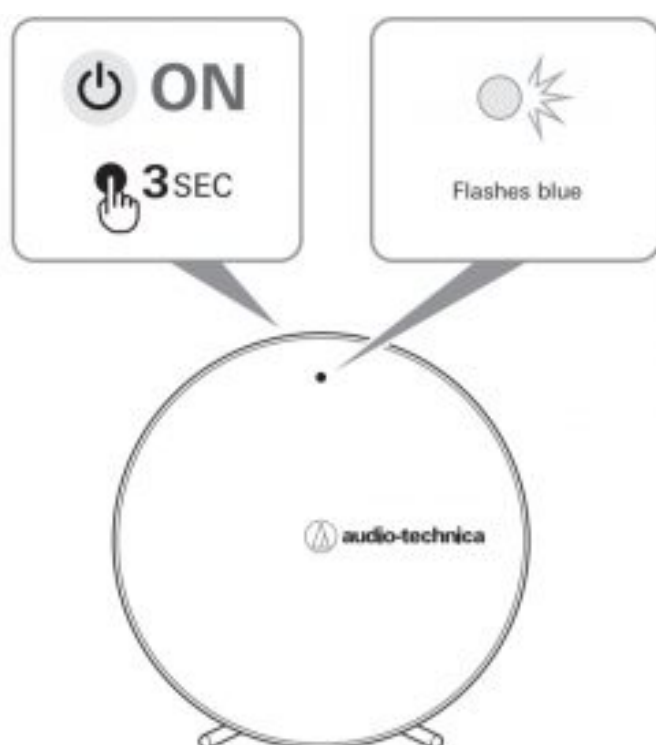

2

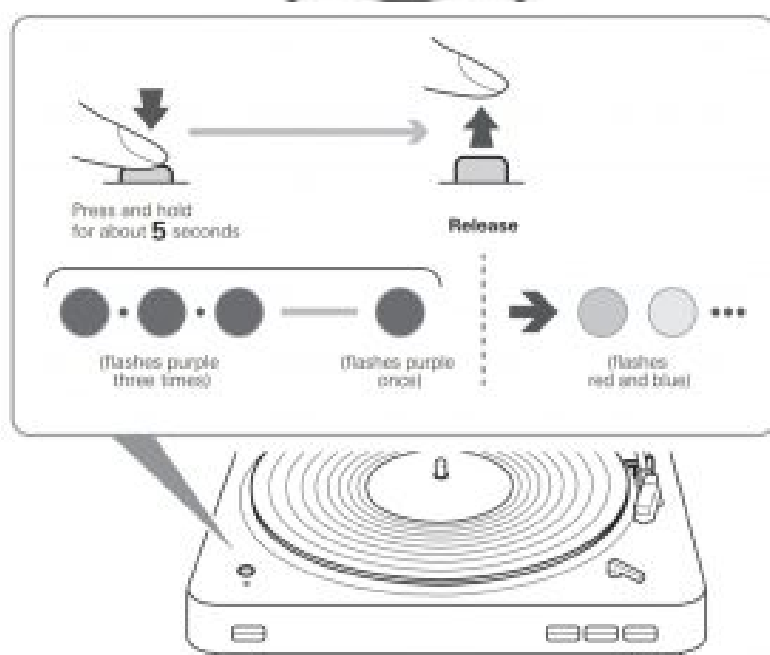

3

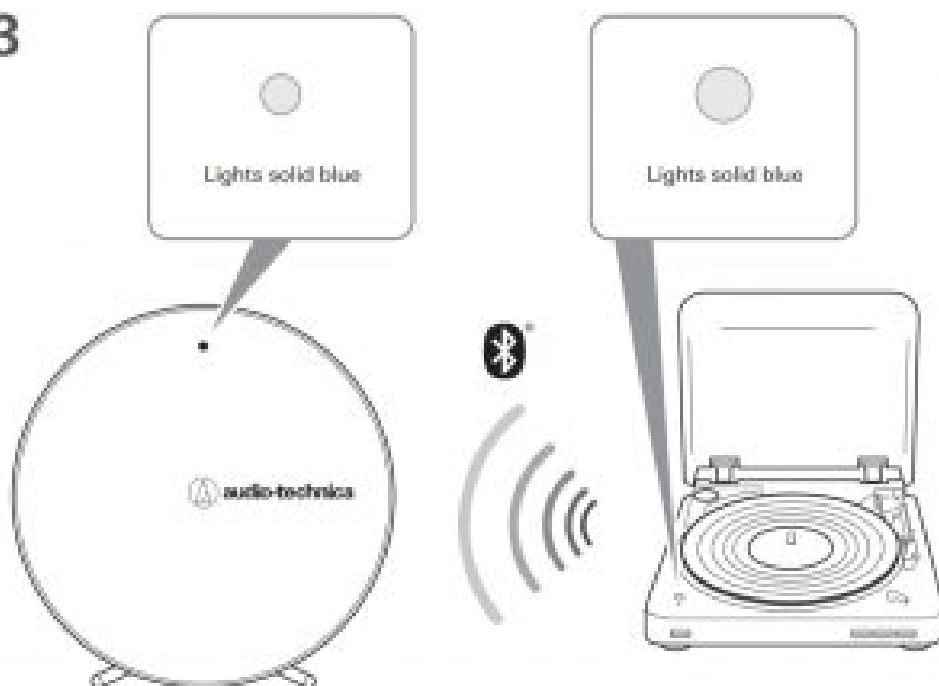

- The wireless turntable stays in the pairing mode for 30 seconds. If pairing is not properly completed, follow the above steps again from the beginning.
- If both devices are paired and lights are solid blue but no audio is heard, press the play/pause button on either device to activate audio.

## Help

For more information on how to use this product, visit the Audio-Technica website at the URL listed below and contained in the QR code.



<http://www.audio-technica.com/>

The Bluetooth® word mark and logos are owned by Bluetooth SIG, Inc. and any use of such marks by Audio-Technica Corporation is under license. All other trademarks are property of their respective owners.

## Communication specifications

RF output	1.3 mW EIRP
Frequency band	2.402 GHz – 2.480 GHz
Modulation type	GFSK, Pi/4DPSK, 8DPSK

### **Battery Caution:**

Do not use a leaking battery. If battery leakage occurs, avoid contact with skin. If contact occurs, immediately wash thoroughly with soap and water. If battery leakage comes into contact with your eyes, immediately flush with water and seek medical attention.

### **For customers in the USA FCC Notice**

#### **Warning**

This device complies with Part 15 of the FCC Rules. Operation is subject to the following two conditions:

1. This device may not cause harmful interference, and
2. this device must accept any interference received, including interference that may cause undesired operation.

#### **Caution**

You are cautioned that any changes or modifications not expressly approved in this manual could void your authority to operate this equipment.

**Note:** This equipment has been tested and found to comply with the limits for a Class B digital device, pursuant to part 15 of the FCC Rules. These limits are designed to provide reasonable protection against harmful interference in a residential installation. This equipment generates, uses and can radiate radio frequency energy and, if not installed and used in accordance with the instructions, may cause harmful interference to radio communications. However, there is no guarantee that interference will not occur in a particular installation. If this equipment does cause harmful interference to radio or television reception, which can be determined by turning the equipment off and on, the user is encouraged to try to correct the interference by one or more of the following measures:

- Reorient or relocate the receiving antenna.
- Increase the separation between the equipment and receiver.
- Connect the equipment to an outlet on a circuit different from that to which the receiver is connected.
- Consult the dealer or an experienced radio/TV technician for help.

### **RF Exposure Statement**

This transmitter must not be co-located or operated in conjunction with any other antenna or transmitter used in other systems.

This device comply with FCC radiation exposure limits set forth for an uncontrolled environment and meets the FCC radio frequency (RF) Exposure Guidelines. This equipment has very low levels of RF energy that it deemed to comply without maximum permissive exposure evaluation (MPE). But it is desirable that it should be installed and operated keeping the radiator at least 20cm or more away from person's body.

## For customers in Canada

### IC statement

CAN ICES-3 (B)/NMB-3(B)

This device complies with INDUSTRY CANADA R.S.S. 247. Operation is subject to the following conditions:

1. This device may not cause harmful interference, and
2. this device must accept any interference received, including interference which may cause undesired operation.

Under Industry Canada regulations, this radio transmitter may only operate using an antenna of a type and maximum (or lesser) gain approved for the transmitter by Industry Canada. To reduce potential radio interference to other users, the antenna type and its gain should be so chosen that the equivalent isotropically radiated power (e.i.r.p.) is not more than that necessary for successful communication.

This device complies with RSS-102 radiation exposure limits set forth for an uncontrolled environment

### Audio-Technica Corporation



2-46-1 Nishi-naruse, Machida, Tokyo 194-8666, Japan

<http://www.audio-technica.co.jp/>

### Documents / Resources

	<a href="#">audio-technica Wireless speaker</a> [pdf] Installation Guide Wireless speaker, AT-SP60BT
---	---

### References

-  [Audio-Technica Corporation](#)
-  [Audio-Technica Corporation | Headphones, Microphones & Turntables](#)