



audio-technica ES945O/XLR Omnidirectional Condenser Boundary Microphone User Guide

[Home](#) » [Audio-Technica](#) » audio-technica ES945O/XLR Omnidirectional Condenser Boundary Microphone User Guide 

audio-technica ES945O/XLR Omnidirectional Condenser Boundary Microphone User Guide



Contents

- [1 Included accessories](#)
- [2 How to Mount the product](#)
- [3 Top view](#)
- [4 Safety precautions](#)
- [5 Cautions for the product](#)
- [6 Notes on use](#)
- [7 About splash-proof performance](#)
- [8 Documents / Resources](#)
- [9 Related Posts](#)

Included accessories

- Rubber isolators



- Nut



How to Mount the product

Table/ceiling hole size (actual size)

- When using isolators

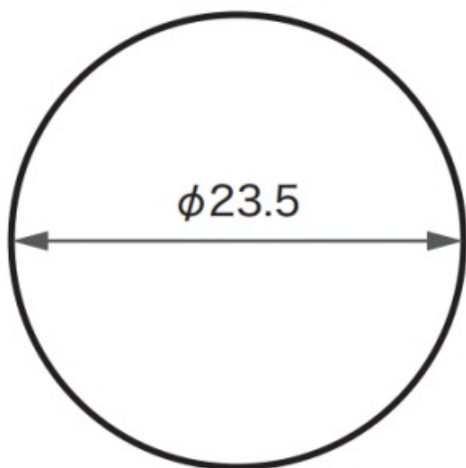

- When not using isolators

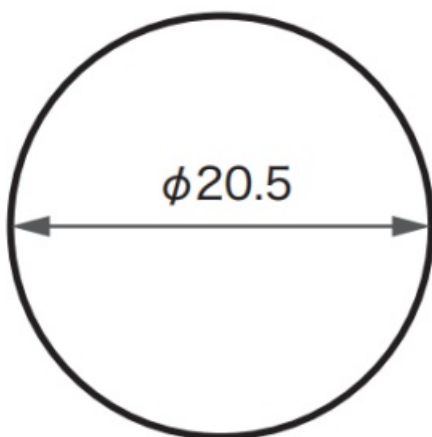

Example: Mounting on a table

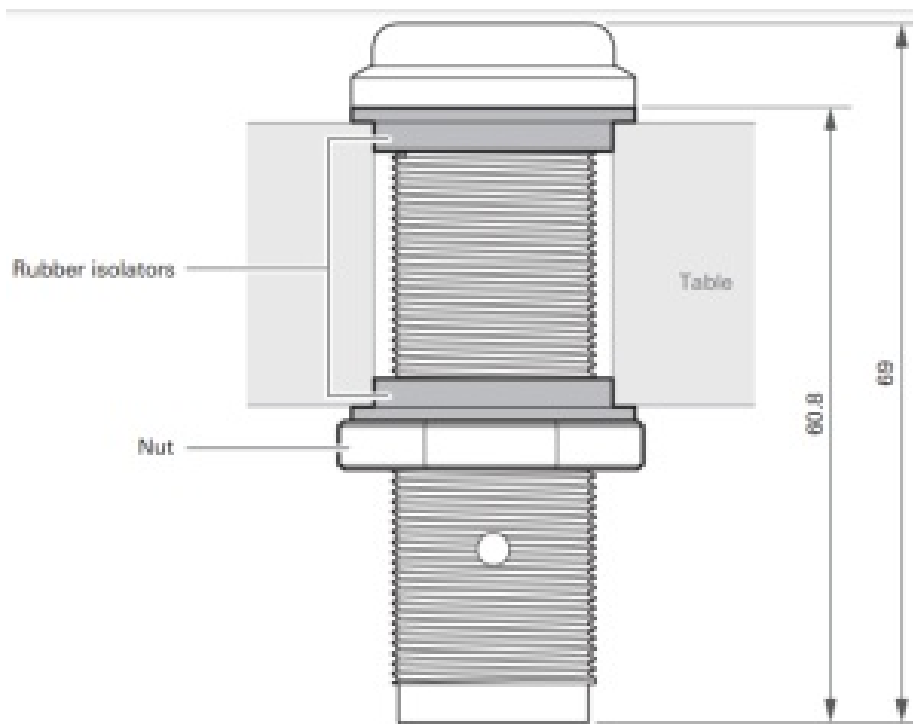

Top view

- ES945O/XLR
ES945WO/XLR

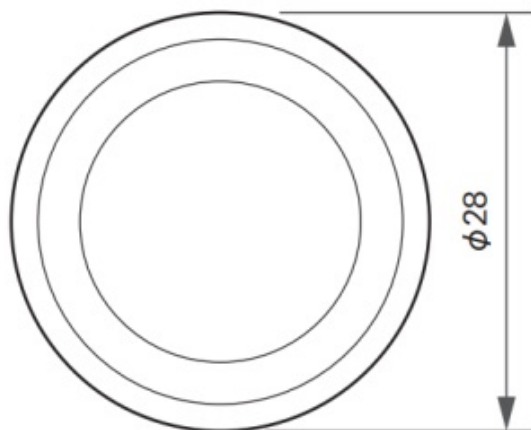

- ES947C/XLR
ES947WC/XLR

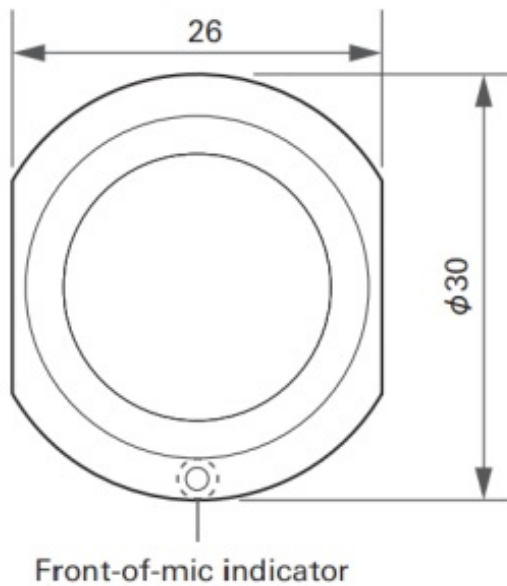

Thank you for purchasing this product. Before using the product, read through the user manual to ensure that you will use the product correctly. Please keep this manual for future reference.

Safety precautions

Although this product was designed to be used safely, failing to use it correctly may result in an accident. To ensure safety, observe all warnings and cautions while using the product.

Cautions for the product

- Do not subject the product to strong impact to avoid malfunction.
- Do not disassemble, modify or attempt to repair the product.
- Do not handle the product with wet hands to avoid electric shock or injury.
- Do not store the product under direct sunlight, near heating devices or in a hot, humid or dusty place.

Notes on use

- Do not swing or pull with the cable connected to the microphone to prevent the microphone from becoming disconnected or damaged.
- Do not wind the cable around the rack or allow the cable to become pinched.
- The microphone should be placed on a flat, unobstructed mounting surface.
- Placing any object on a surface (such as a conference table) before its finish is fully cured may result in damage to the finish.

About splash-proof performance

- The splash-proof specification of this product applies only to the head of the microphone.
- Although the product has splash-proof capabilities equivalent to IPX4, the screw part and the connector part of the product are not splash-proof.
- If the product is not installed properly, the splash-proof effect will not function properly. Firmly attach the product to the ceiling/table using the included rubber isolators.

- The splash-proof performance is designed to protect the product if it gets wet from rain, etc. (equivalent to IPX4). JIS/IEC protection grade IPX4 means that the product is protected against exposure to flying water from all directions.
- The product cannot be used underwater.
- The product cannot be used in hot and humid places, such as bathrooms.
- The product is not waterproof. Putting a large amount of water on the product or submerging the product in water may cause damage.
- The product may not function properly if it becomes wet. Wipe the surface of the product with a dry cloth to remove any moisture, and allow the product to dry thoroughly before use.

Documents / Resources

	<p>audio-technica ES945O/XLR Omnidirectional Condenser Boundary Microphone [pdf] Use r Guide ES945O XLR, ES945WO XLR, ES945OXLR Omnidirectional Condenser Boundary Microphone, Omnidirectional Condenser Boundary Microphone, Condenser Boundary Microphone, Microphone</p>
---	---

Manuals+.