



audio pro C20 Multi Talented Wireless Speaker User Manual

[Home](#) » [audio pro](#) » audio pro C20 Multi Talented Wireless Speaker User Manual 

Contents

- 1 [audio pro C20 Multi Talented Wireless Speaker](#)
- 2 [IMPORTANT SAFETY INSTRUCTIONS](#)
- 3 [CONTROLLER](#)
- 4 [CONNECTING TO THE NETWORK](#)
- 5 [1. C ONNECT TO POWER](#)
- 6 [MAKING A PRESET](#)
- 7 [RESTREAMING](#)
- 8 [PLAY SPOTIFY](#)
- 9 [AIRPLAY](#)
- 10 [BLUETOOTH](#)
- 11 [PLAYING FROM CONNECTED DEVICES](#)
- 12 [SPECIFICATIONS](#)
- 13 [Specifications:](#)
- 14 [Frequently Asked Questions \(FAQ\):](#)
 - 14.1 [Q: Can I use the Audio Pro C20 without a WiFi network?](#)
 - 14.2 [Q: What streaming services are compatible with the Audio Pro C20?](#)
 - 14.3 [Q: How do I reset the Audio Pro C20?](#)
- 15 [Documents / Resources](#)
 - 15.1 [References](#)
- 16 [Related Posts](#)

audio pro C20 Multi Talented Wireless Speaker

USER MANUAL

MODEL: C20 BLACK

Welcome to Wireless HiFi with Audio Pro C20 Noir. The Audio Pro wireless HiFi products allow you to enjoy your favorite audio in a multiroom setup throughout your home. Our WiFi products utilize Audio Pro wireless technology, Google Cast, AirPlay 2, Spotify Connect, and Tidal Connect. You can explore and play audio from streaming services and your music library using your WiFi network and smartphone apps. If you don't have a WiFi network, you can also use Bluetooth or connect your audio equipment via cable while experiencing the legendary Audio Pro sound quality.

Audio Pro wireless HiFi products lets you enjoy your favourite audio in a multiroom setup everywhere around your home.

Our WiFi products uses Audio Pro wireless technology, Google Cast, AirPlay2, Spotify Connect and Tidal Connect

By utilizing your WiFi network & smartphone apps you can explore and play audio from streaming services and your own music library.

If you don't have a WiFi network, you can use Bluetooth or connect your audio equipment via cable.

The legendary Audio Pro sound quality is included.

The Spotify Software is subject to third party licenses found here

www.spotify.com/connect/third-party-licenses.



Google, Google Play, Chromecast and other related marks are trademarks of Google LLC. Chromecast built-in may require subscription(s). The Google Assistant requires an internet connection and is not available in certain countries and languages. Availability and react of certain features and services are device, service, and network-dependent and may not be available in all areas. Controlling certain devices in your home requires compatible smart devices. Subscriptions for services and applications may be required and additional terms, conditions and/or charges may apply. The Android robot is created and shared by Google and used according to the Creative Commons 3.0 Attribution License.

The Bluetooth® word mark and logos are registered trademarks owned by Bluetooth SIG, Inc. and any use of such marks by AUDIO PRO AB, is under license. Other trademarks and trade names are those of thier respective owners.



© Apple, the Apple logo, AirPlay, iPad, iPhone, and iPod touch are trademarks of Apple Inc., registered in the U.S. and other countries. App Store is a service mark of Apple Inc.

© Audio Pro AB, Sweden. All rights reserved.

Trademarks are the property of Audio Pro AB, Sweden.

Audio Pro AB, Garnisonsgatan 52 SE-254 66 Helsingborg, Sweden

Audio Pro®, the Audio Pro logotype, the 'a' symbol, and ace-bass® are all registered trademarks of Audio Pro AB, Sweden. All rights reserved. Audio Pro follows a policy of continuous advancement in development.

Specifications may be changed without notice.

All other products and services mentioned may be trademarks or service marks of their respective owners.

This document contains information that is subject to change without notice.

IMPORTANT SAFETY INSTRUCTIONS

1. Read these instructions.
2. Save these instructions.
3. Respect all warnings
4. Follow all instructions.
5. Do not use the product near water.
6. Clean only with a dry cloth.
7. Operating temperature (°C) 5–40
Humidity (%) no condensation 30–90
8. Do not block ventilation openings. Follow the manufacturer's instructions when installing the product.
9. Minimum distance around the appliance for sufficient ventilation,
10 cm.
10. Ventilation must not be obstructed by covering
the ventilation openings with objects such as newspapers, tablecloths, curtains, etc.
11. Do not install the product near any heat sources such as radiators, heat registers, stoves, or other heat-producing equipment (e.g. amplifiers).
12. Protect the power cord from being walked on or pinched, particularly at plugs, convenience receptacles, and the point where they exit from the product.
13. Use only those attachments and accessories that are
the manufacturer recommends.
14. Unplug the product from the mains during thunderstorms or when
the product is not used for a long period of time.
15. All servicing should be carried out by specially trained service personnel. Servicing is required when the
product has been damaged.
Examples include damage to the power cord or plug, liquid has been
spilled or objects have fallen into the product, the product has been exposed
to rain or moisture, does not operate normally, or has been dropped.
16. Damage requiring service:
Unplug the product from the wall outlet and refer servicing to qualified service personnel under any of the following
conditions:
 - A. If the power cord or plug is damaged,
 - B. If liquid has been spilled or foreign objects have fallen into the product,
 - C. If the product is exposed to rain or water,
 - D. If the product does not operate normally when used in accordance with
the instructions. Adjust only those controls that are covered by the instructions. Improper adjustment of other
controls may result in damage, often requiring extensive work by a trained service person to restore the equipment
to normal operation.
 - E. If the product has been dropped or damaged in any way, and
 - F. If the product exhibits a distinct change in performance, this indicates a need for service.
17. Introduction of objects and liquid:
Never push objects of any kind into the product through openings as they may touch dangerous voltage points or
short out parts that could result in a fire or electric shock.

The product must not be exposed to dripping or splashing.

No objects filled with liquids, such as flower vases, may be placed on the apparatus. No naked flames, such as lighted candles, etc. may ever be placed on the apparatus.

18. Ensure that there is sufficient ventilation if you install the product in enclosed spaces, such as bookshelves or racks. Leave a distance of 20 cm above and on both sides of the product and 10 cm behind it. The rear edge of the shelf or board closest to the product should be pulled forward so that there is a gap of approximately 10 cm to the rear. This creates an exhaust-like channel where heated air can flow upwards.

19. The power adapter and power cord for this product are intended for indoor use only.

20. Use only the supplied power cord/adapter.

CONTROLLER

On/Standby

Power On/Standby Mode

On/Standby

On/standby

Source selection
Select audio source
Select source
Select audio source

Bluetooth pair
Bluetooth Par
Coppia Bluetooth
Pairing with Bluetooth

Volume control
Volume control
Volume control
Volume

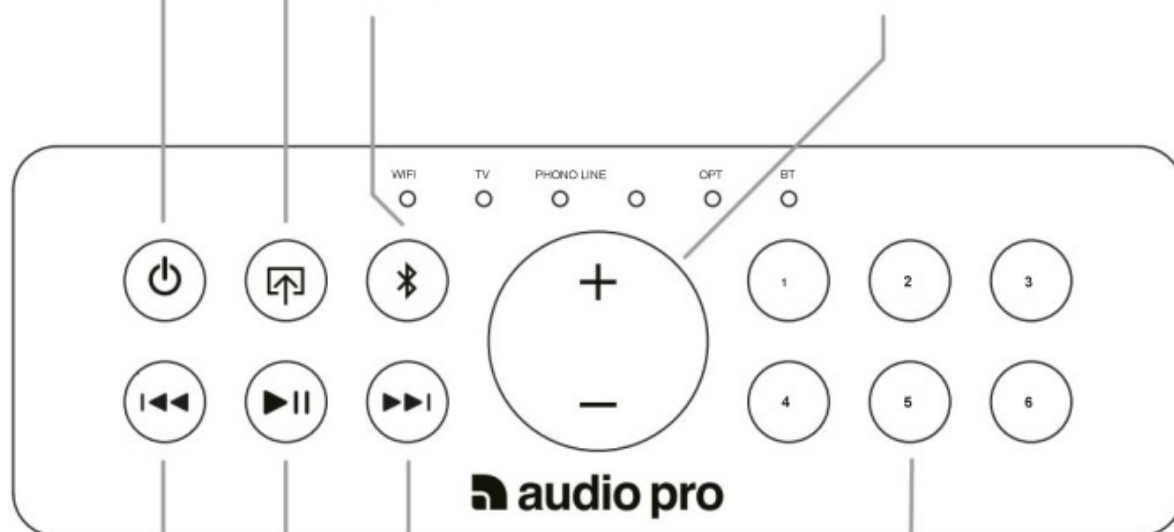

Following
Following
Next
Next

Wi-Fi Presets
Presets
Wi-Fi Presets
Wi-Fi presets

Lecture/Pause
Play/Pause
Play/Pause
Play/Pause

Previous

Previous

Previous

Previous



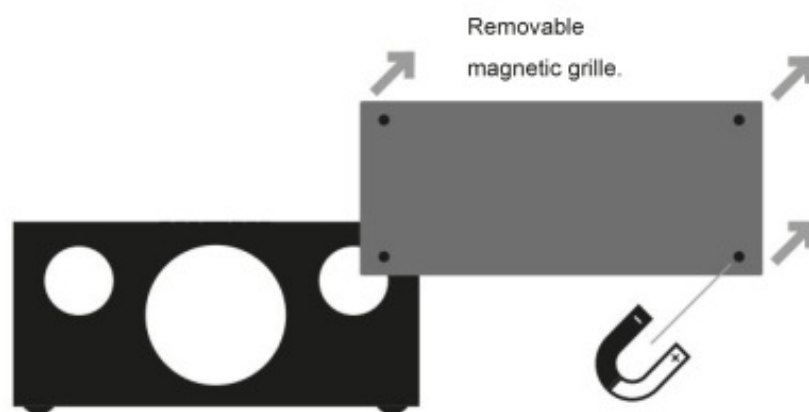
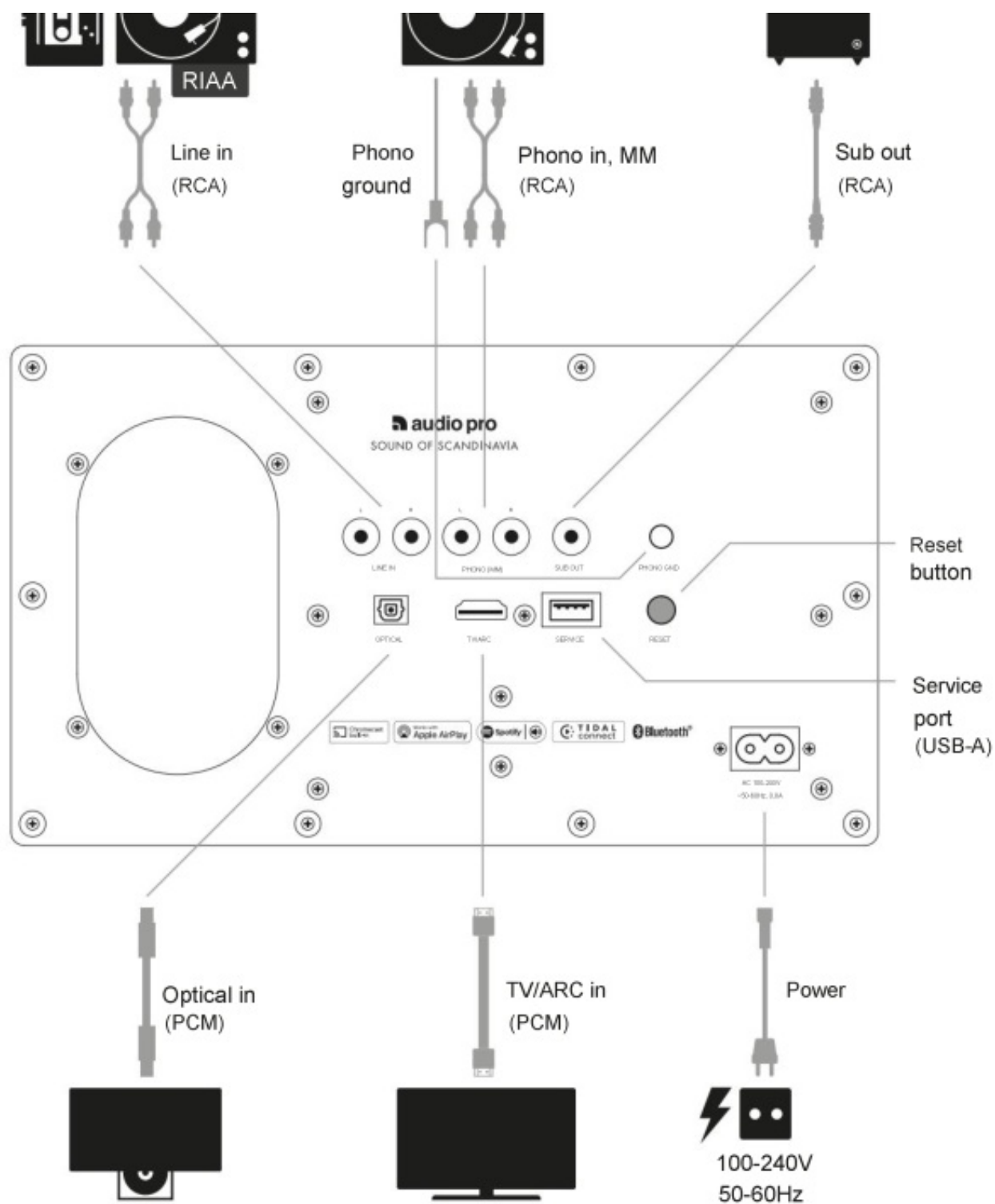

NETWORK:

Your network must have a broadband connection

- Internet connection, as the Audio Pro sound system is designed for free software updates.
- Audio Pro speakers communicate over 2.4GHz / 5GHz in networks that support 802.11 a/b/g/n/ac wireless technology.

ROUTER

- High-speed ADSL/cable modem, or broadband fiber is necessary for proper playback from internet-based music services.
- Different routers have different performance. It is best to use a premium router for good performance.

CONNECTING TO THE NETWORK

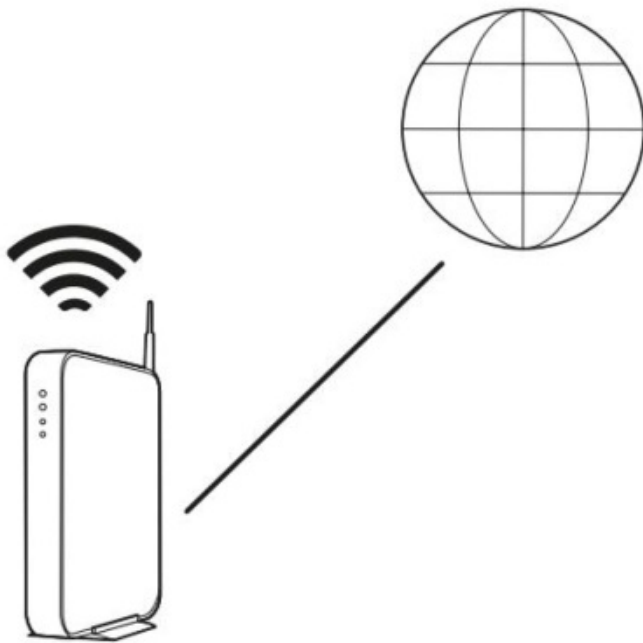

Wireless router with an internet connection.

Wireless router with internet connection.

Router wireless con Internet connection.

A wireless router with Internet access.



iOS or Android device connected to your network.

iOS or Android device connected to your network.

iOS or Android device connected to the network.

An iOS or Android device connected to your network.

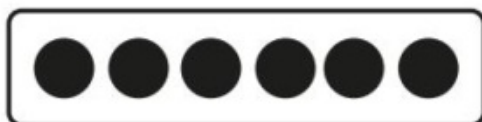

Your wifi password

Your wifi password

Your wifi password

Your Wifi password

1. C ONNECT TO POWER

OPTICAL

TUNING

SERVICE

RESET

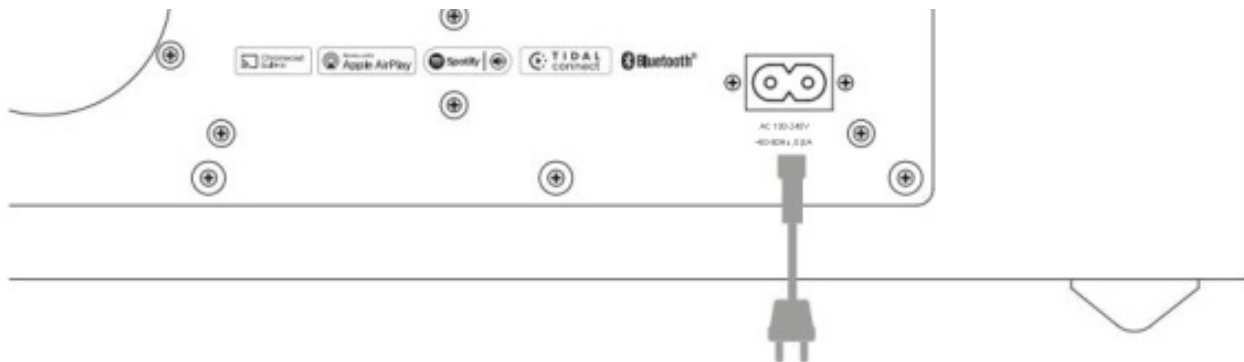

100-240V
50-60Hz



30-60 s



2.

**PRODUCT
INFO.**

**CUSTOMER
SUPPORT.**

MANUALS.



Scan the QR code.

MAKING A PRESET

1. ON THE SPEAKER | ON THE SPEAKER | ON THE SPEAKER
AM SPEAKER | CREATE A PRESET

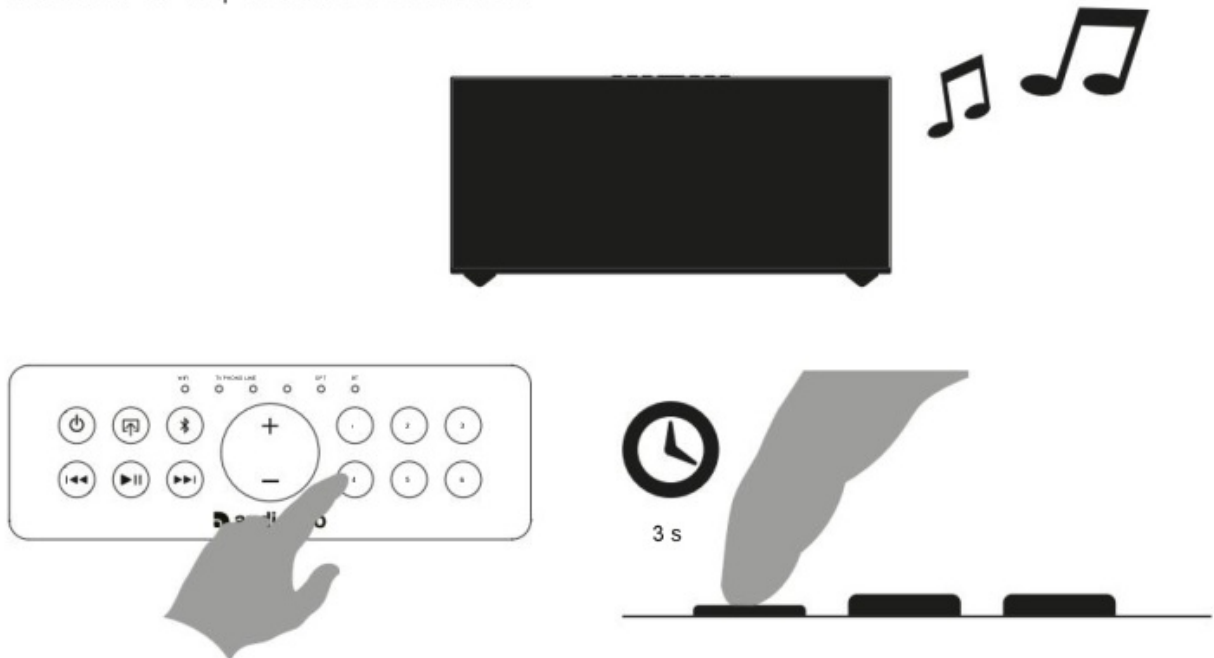

2. IN THE APPLICATION || IN THE APPLICATION APP | BEDROOM



RESTREAMING

Audio from connected devices can be played to multiple speakers. The selected speaker must be the master in the group.

Connected devices sound can be played to more speakers wirelessly. Choose master speaker in group to play.

The sound from connected devices can be played wirelessly on additional speakers. Select the master speaker in the group for playback.

Sound from connected devices can be played wirelessly through multiple speakers. Choose the master speaker in the group you want to play on.

PLAY SPOTIFY

Use your phone, tablet or computer as a remote control for Spotify. Go to spotify.com/connect to find out how

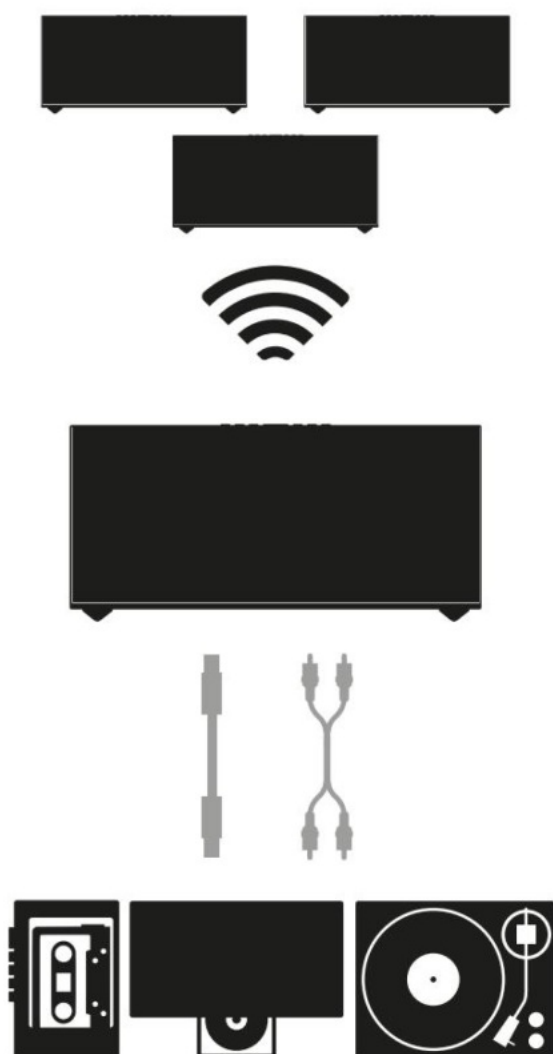

Choose the connected input source.

Select the connected input source.

Select the connected input source.

Select the connected input source.

SELECT SOURCE IN APP / ON SPEAKER

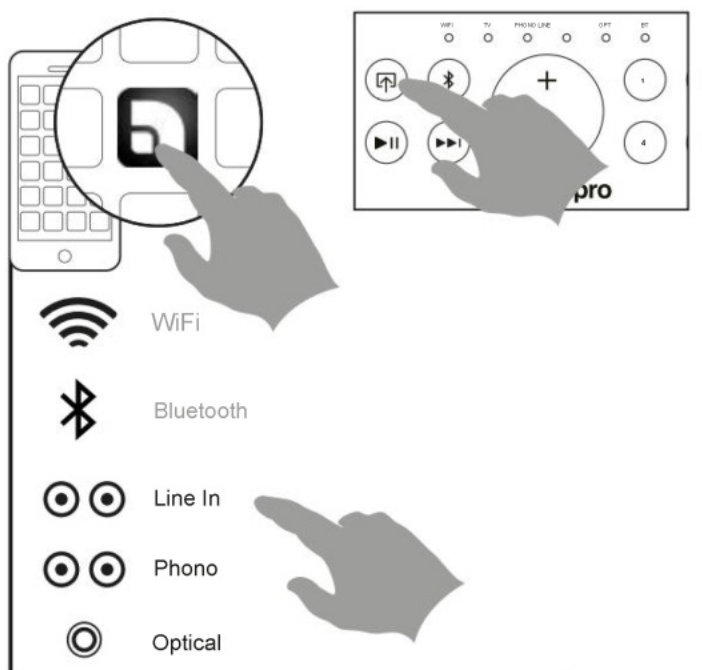

AIRPLAY

Tap AirPlay/Chromecast and select a speaker



**PRODUCT
INFO.**

**CUSTOMER
SUPPORT.**

MANUALS.



Scan the QR code.
(audiopro.com/info)

BLUETOOTH

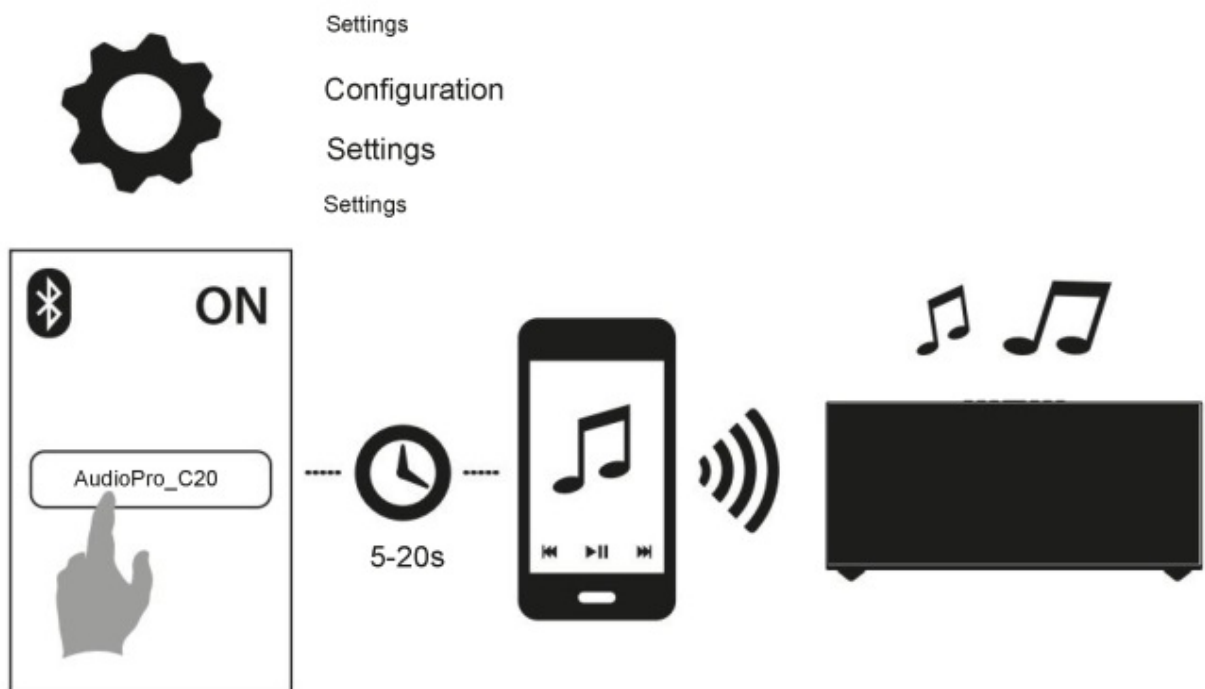
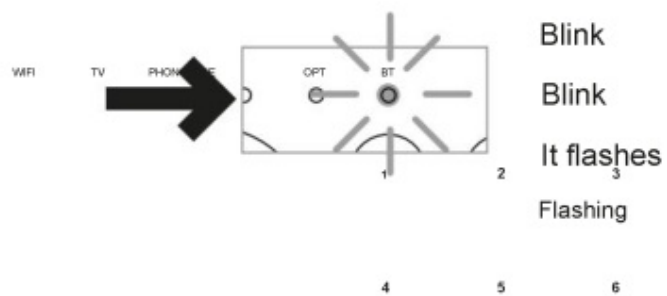

PLAYING FROM CONNECTED DEVICES

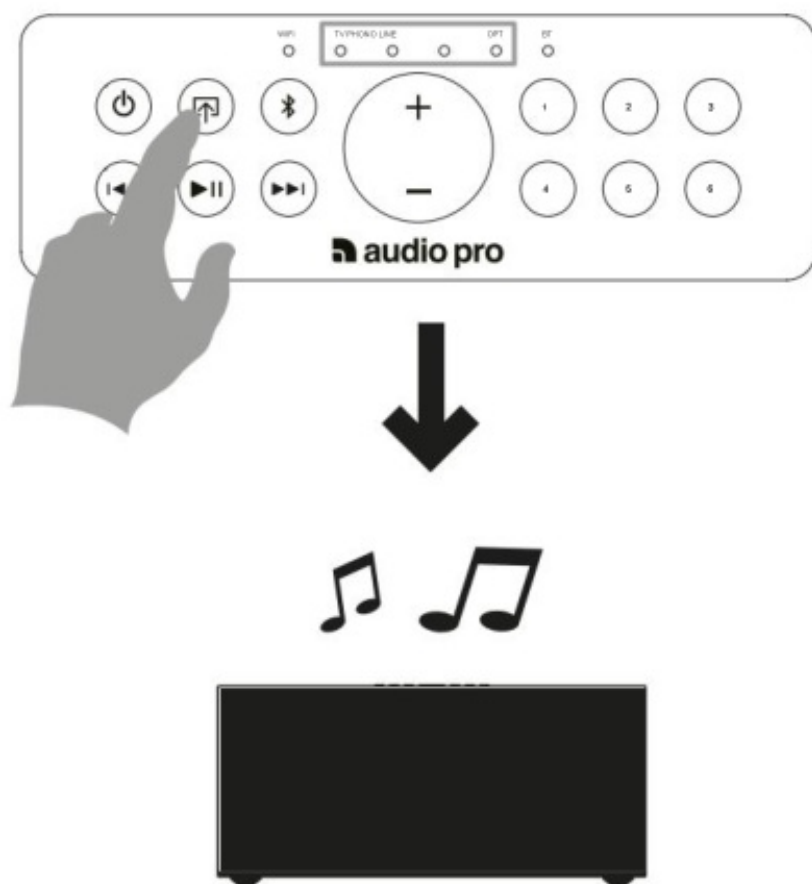
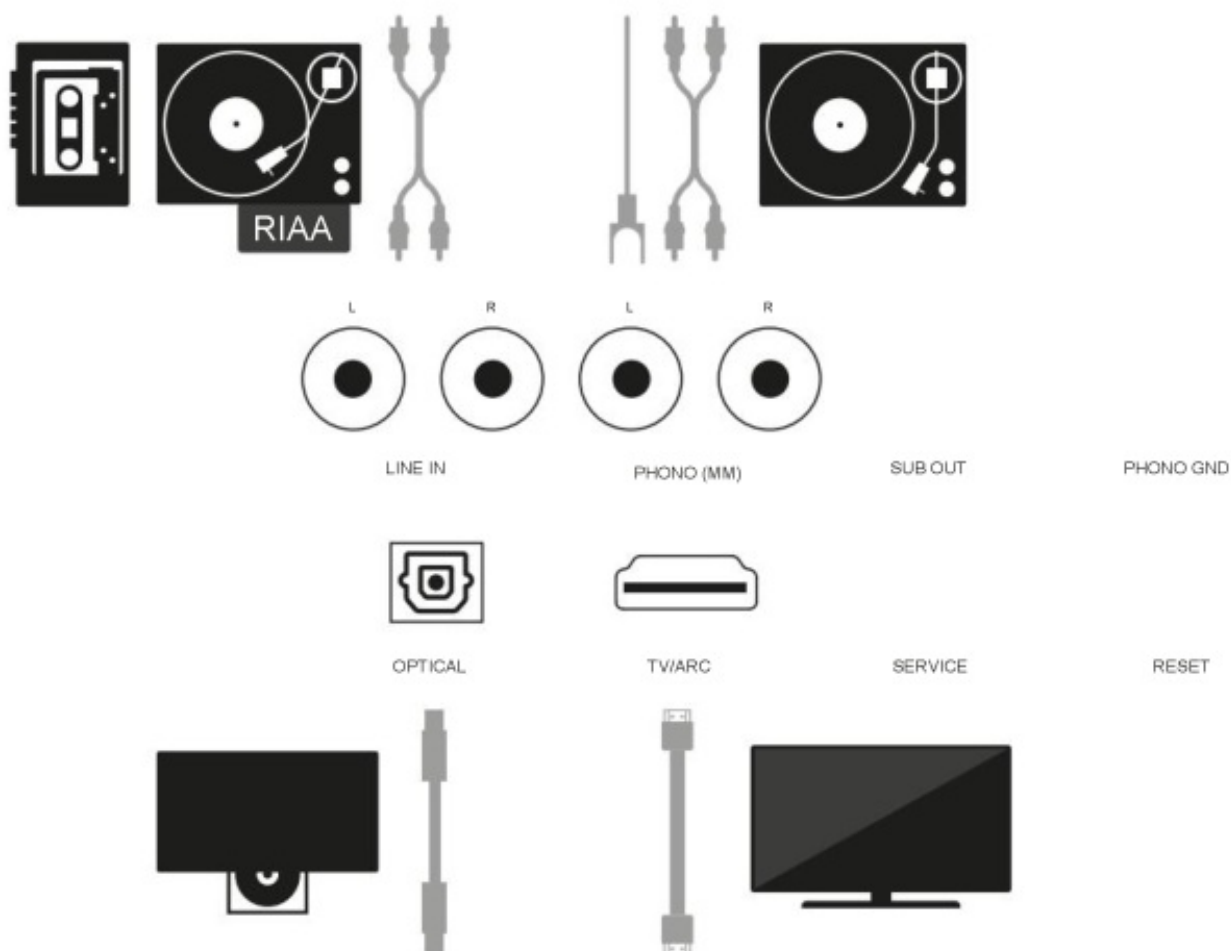

SPECIFICATIONS

Type: Active stereo speaker with bass reflex

Amplifier: Digital Class D, 2x30W + 130W

Diskant: 2 x 1"

Woofer: 1 x 6.5"

Frequency range: 41-23,500Hz (\pm 6dB)

Crossover frequency: 2,200Hz

Dimensioner HxBxD: 196 x 410 x 220 mm

Inputs: 'MFi, Bluetooth 5.0, Line in, Phono MM, Optical (PCM), ARCfTV

Outputs: Sub output

Network: 802.11 a/b/g/n/ac, 2.4GHz/5GHz

Supported audio formats: MP3, WMA, MC, FLAC, Apple Lossless

Power consumption STBY/ON: 1.6W/10.2W (standby activated after >20 minutes of inactivity)



NOTE: The lightning flash with arrowhead symbol, within an equilateral triangle, is intended to alert the user to the presence of uninsulated "dangerous voltage" within the product's enclosure that may be of sufficient magnitude to constitute a risk of electric shock to persons

NOTE: The exclamation point within an equilateral triangle is intended to alert the user to the presence of important operating and maintenance (servicing) instructions in the literature accompanying the appliance.



(AC symbol, alternating current) next device, the disconnect device shall remain readily operable. The socket-out –

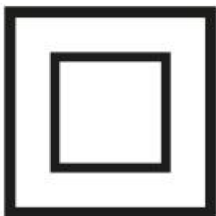

The mains plug is used as a switch –

The on/off switch should be easy to use.

The socket should be installed close to the equipment and easily accessible.

Specifications:

- Model: C20
 - Power: AC 100-240 V ~50-60 Hz, 0.8 A
 - Connectivity: WiFi, Bluetooth, Cable
 - Wireless Technologies: Google Cast, AirPlay 2, Spotify Connect, Tidal Connect
-

Frequently Asked Questions (FAQ):

Q: Can I use the Audio Pro C20 without a WiFi network?

A: Yes, you can use Bluetooth or cable connections to enjoy audio playback even without a WiFi network.

Q: What streaming services are compatible with the Audio Pro C20?

A: The C20 supports streaming services like Spotify Connect and Tidal Connect along with Google Cast and AirPlay 2 for seamless audio streaming.



Q: How do I reset the Audio Pro C20?

A: Locate the reset button on the device or refer to the user manual for detailed reset instructions.

Documents / Resources

	<p>audio pro C20 Multi Talented Wireless Speaker [pdf] User Manual C20 Multi Talented Wireless Speaker, C20, Multi Talented Wireless Speaker, Talented Wireless Speaker, Wireless Speaker</p>
---	---

References

-  [Getting started](#)
-  [Spotify - Connect](#)
-  [Third Party Licenses | Spotify for Developers](#)
- [User Manual](#)

[Manuals+](#), [Privacy Policy](#)

This website is an independent publication and is neither affiliated with nor endorsed by any of the trademark owners. The "Bluetooth®" word mark and logos are registered trademarks owned by Bluetooth SIG, Inc. The "Wi-Fi®" word mark and logos are registered trademarks owned by the Wi-Fi Alliance. Any use of these marks on this website does not imply any affiliation with or endorsement.