



AUDIO ARRAY AM-W11 Wireless Mic Instructions

[Home](#) » [AUDIO ARRAY](#) » AUDIO ARRAY AM-W11 Wireless Mic Instructions 

Contents

1

AUDIO ARRAY AM-W11 Wireless Mic

2

PACKAGE LIST

3

FUNCTION

4

INSTRUCTIONS

4.1

Operating

5

SPECIFICATIONS

6

Documents / Resources

6.1

References



AUDIO ARRAY AM-W11 Wireless Mic



PACKAGE LIST

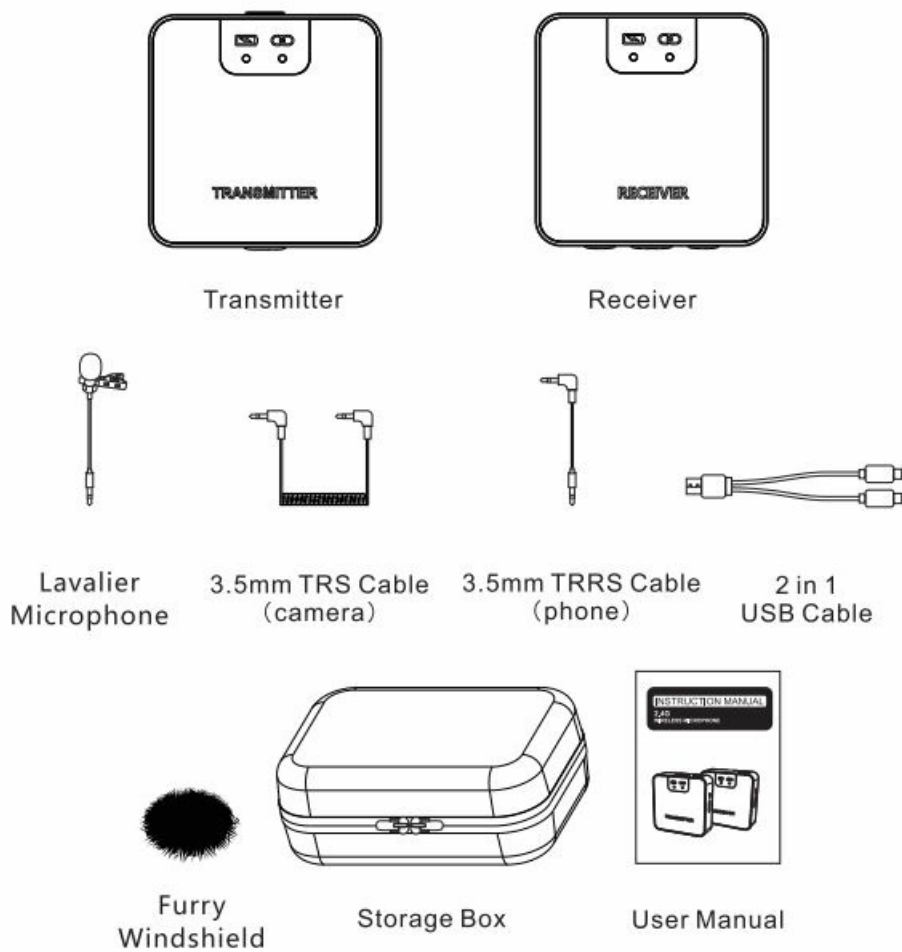

FUNCTION

TRANSMITTER

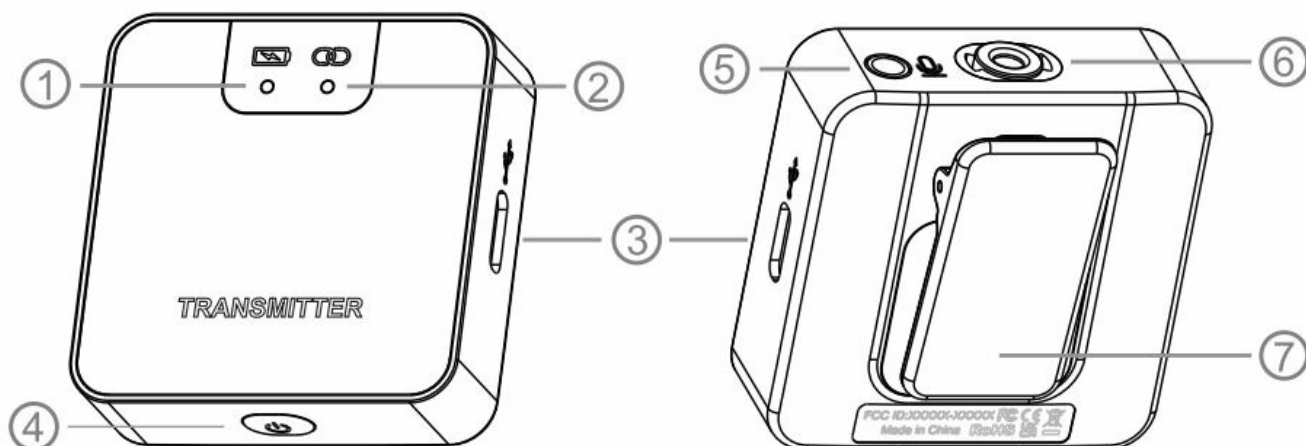

1. Power Indicator
2. Pair Indicator
3. USB-C Charging Port
4. Power Button/Pair Button
5. Mic Jack

- 6. Built-in Mic
- 7. Clip

RECEIVER

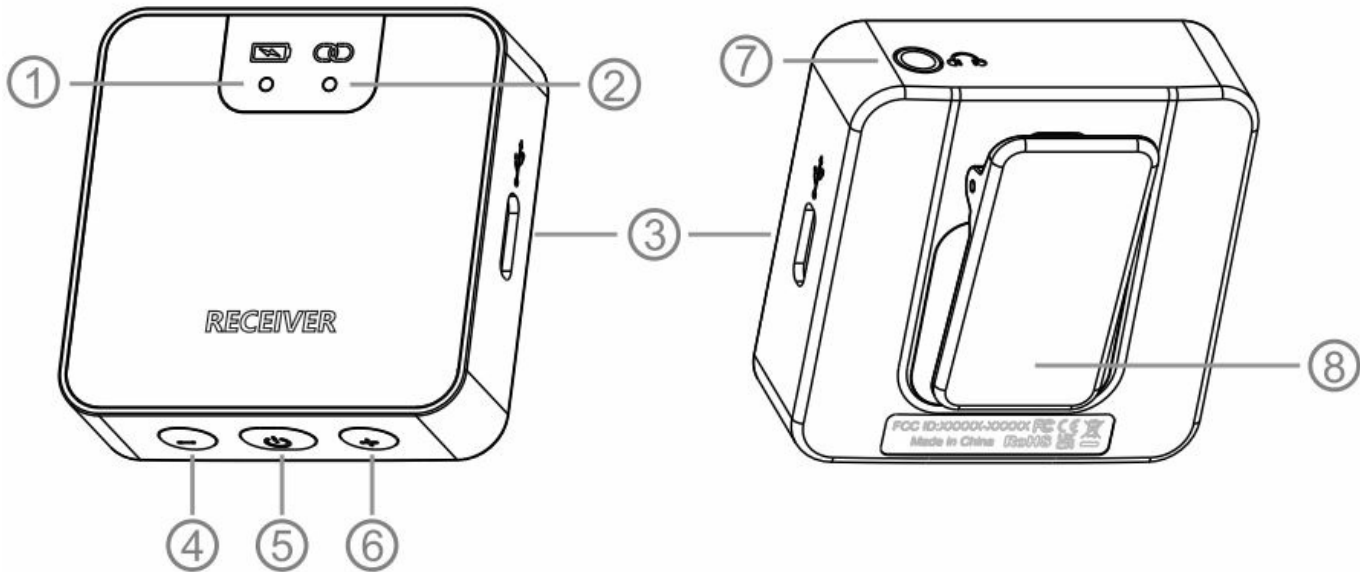

- 1. Power Indicator
- 2. Pair Indicator
- 3. USB-C Charging Port
- 4. Vol-
- 5. Power Button/Pair Button
- 6. Vol+
- 7. Headphone Output
- 8. Clip

INSTRUCTIONS

Indicator

Status	Power Indicator(red)	Pair Indicator(blue)
Flash slowly	Low power	Power on
Flash quickly	/	In pairing
Quick flash 3 times, then off	Power off	/
Keep on and solid	Charging(on) Full Charge(off)	Complete pairing
Pair indicator of receiver flashes 3 times quickly	/	Adjust the volume to maximum or minimum volume

Operating

Power

Hold down the power button for 2 seconds to turn off the machine.

Pair

Automatically pairing when power on. To pair manually, please make sure both the receiver and transmitter are off power. In the meantime, hold down both the power button and volume(-) button of the RX receiver for 3 seconds to turn it on for pairing. Then, turn on the transmitter and it will pair automatically.

Install

The Transmitter can be clipped to your clothes. And the Receiver can be clipped to a camera/phone.

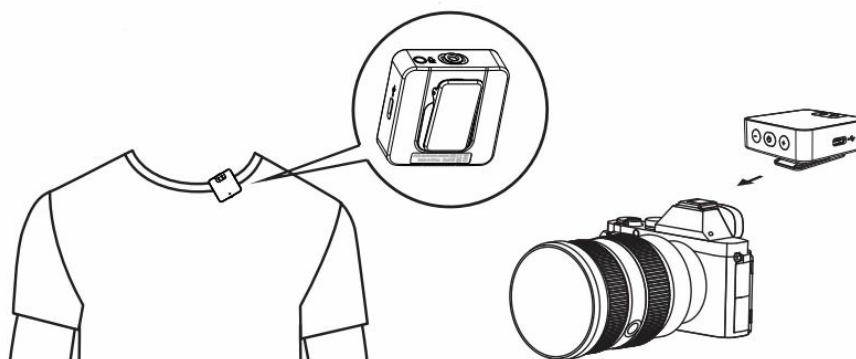

Connect

The receiver can output the audio to your device via 3.5mm TRS cable(camera) or 3.5mm TRRS cable(phone). Please choose the correct cable according to your device.

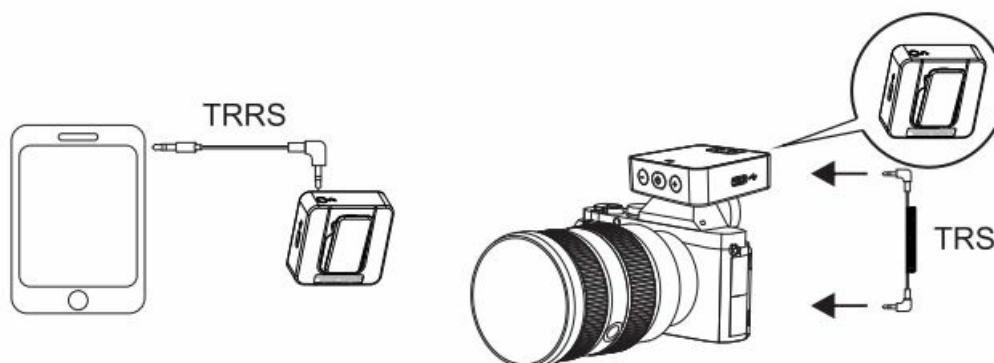

Record

The Transmitter can record your voice via the built-in mic (equipped with a Furry Windshield) or the extra Lavalier Microphone.

SPECIFICATIONS

Transmitter

Wireless Transmission:	Digital 2.4GHz
Frequency:	2400-2483.5MHz
Working Distance:	70m(LOS)
Latency:	12.5ms
Audio Input Electronic Level:	1V(0dBV)
Output Power:	< 10mW
Power Required:	USB 5V
Battery Type:	Built-in Lithium Battery
Charging Time:	1.5h
Working Time:	4h

Receiver

Wireless Transmission:	Digital 2.4GHz
Frequency:	2400-2483.5MHz
Working Distance:	70m(LOS)
Latency:	12.5ms
RF Sensitive:	-85dB
Level:	4 Adjust Levels
Power Required:	USB 5V
Battery Type:	Built-in Lithium Battery
Charging Time:	1.5h
Working Time:	4h

Microphone

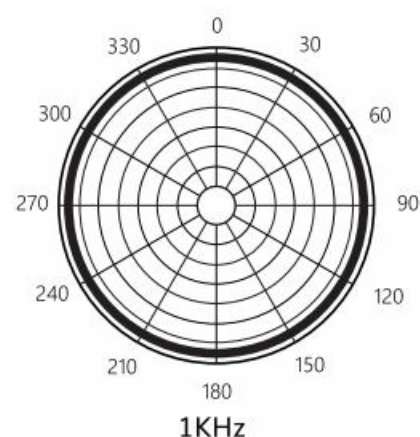
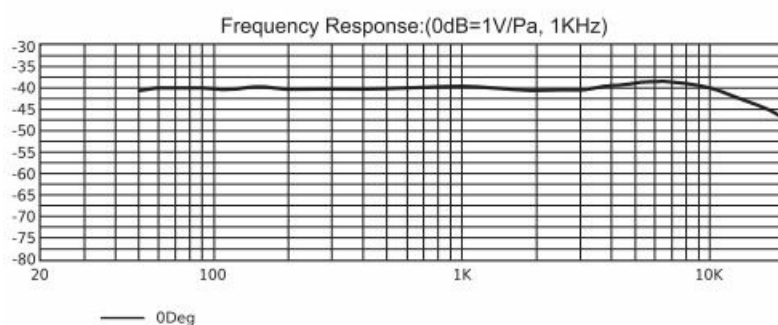

Type:	Built-in/External Lavalier Microphone
Sound Track:	Mono
Polar Pattern:	Omni-directional
Frequency Range:	50Hz-20KHz
Sensitive:	-40±2dB, (0dB=1V/Pa, at 1KHz)
Max SPL:	110dB

Documents / Resources

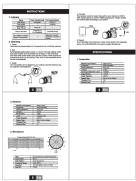
	<p>AUDIO ARRAY AM-W11 Wireless Mic [pdf] Instructions AM-W11 Wireless Mic, AM-W11, Wireless Mic, Mic</p>
---	--

References

- [User Manual](#)