



# ATUVOS AT2301 Bluetooth Tracker Key Finder User Manual

[Home](#) » [ATUVOS](#) » ATUVOS AT2301 Bluetooth Tracker Key Finder User Manual 

## Contents

- [1 ATUVOS AT2301 Bluetooth Tracker Key Finder](#)
- [2 Specifications](#)
- [3 Product Information](#)
- [4 Functions](#)
- [5 Product Usage Instructions](#)
- [6 Battery Replacement](#)
- [7 Troubleshooting](#)
- [8 FCC Statement](#)
- [9 Documents / Resources](#)
  - [9.1 References](#)
- [10 Related Posts](#)

# ATUVOS

## ATUVOS AT2301 Bluetooth Tracker Key Finder



## Specifications

- **Dimensions:** 34.21\*34.21\*10.70 mm

- **Weight:** 11 g
- **Range:** Up to 200 ft (60 m)
- **Battery:** CR2032 Coin Cell Battery, DC 3V
- **Frequency:** 2402~2480 MHz
- **Working Temperature:** 0~40°C(0~104°F)
- **Transmit Power:** 8 dBm
- **Connectivity:** Bluetooth
- **Compatibility:** iOS Devices
- **Firmware Update:** Find My app
- **Voice Control:** Siri

## Product Information

The ATUVOS Tag (Model: AT2301) is a tracking device that helps you find your lost items. It utilizes the Find My network, connecting to hundreds of millions of Apple devices worldwide, to track your items even when they are outside the 60-meter Bluetooth range. The tag is compatible with the Apple Find My app and offers long-distance tracking while ensuring your privacy is protected.

### Introduction

The ATUVOS Tag works with Apple Find My to help you keep track of your stuff even further away. This tag is water-resistant, NFC-capable, and has a replaceable battery that lasts up to one year. The compact design makes it easy to attach to your important things such as keys, bags, and suitcases. A simple setup can pair this item tracker with the Find My app on your Apple devices to track down your nearby items by playing a sound. The anonymous and encrypted Find My network also ensures your privacy and safety.

### Included in the Box

- 1 ATUVOS Tag
- 1 User Manual

Item	Quantity
ATUVOS Tag	1
User Manual	1

**Note:** To use the Apple Find My app or the Find Items app on Apple Watch to locate this item, the latest version of iOS, iPadOS, macOS, or watchOS is recommended.

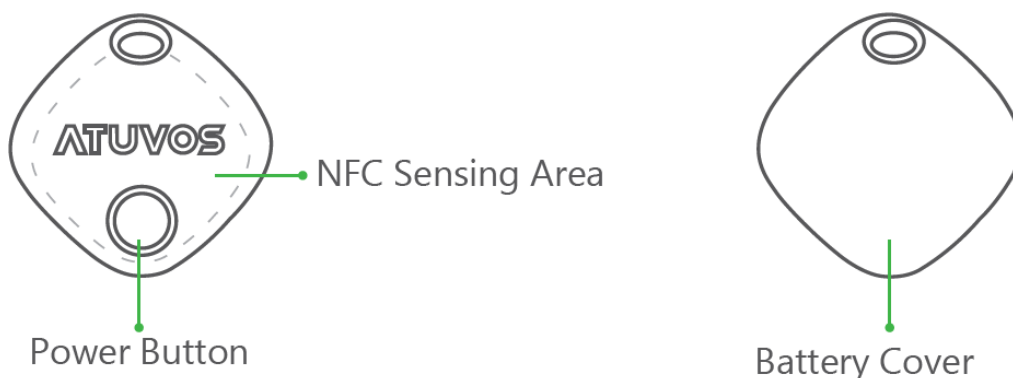

## Controls and Status

Power Button	Status	Buzzer
Quick Press	Power On	Two Short Beeps
Long Press for 3 Seconds	Power Off	Long Beep
Long Press for 10 Seconds	Reset*	Two Long Beeps with a 7-second Interval

- This will restore the tag to factory settings and clear all the connection data. You must remove the item from the Find My app and add it back before using it again.

## Functions

### Long-distance Tracking

If your item is lost outside the 60-metre Bluetooth range, the Find My network connecting hundreds of millions of Apple devices worldwide will help track your item. All the while, your privacy is protected at every step of the way.

### Left-behind Alerts

If your item is left behind and disconnects from the Bluetooth of your Apple device, the Apple Find My app will instantly send you notifications without additional fees.

### Discourage Unwanted Tracking

If someone's tag lands on your items, your Apple device will automatically detect that tag and send you an alert to prevent unwanted tracking. If you still can't find it, the tag will make a sound to let you know.

### NFC Sensing

This tag is NFC-enabled. If someone finds your lost item tracker, he can get your contact information by tapping the tag with an NFC-capable device, which will help you find your belongings back.

## Product Usage Instructions

### Pairing with Find My App

1. Turn on the Bluetooth on your iOS device and ensure it is running the latest version of iOS.

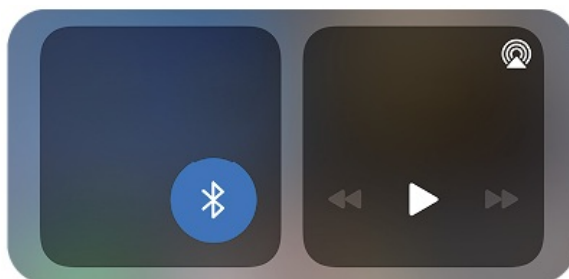

2. Quickly press the power button on the tag to turn it on and place it near your iOS device.



3. Open the Find My app and tap on “Items”. Then, tap on “Add Item”. Select “Other Supported Item” and follow the in-app instructions to complete the pairing.

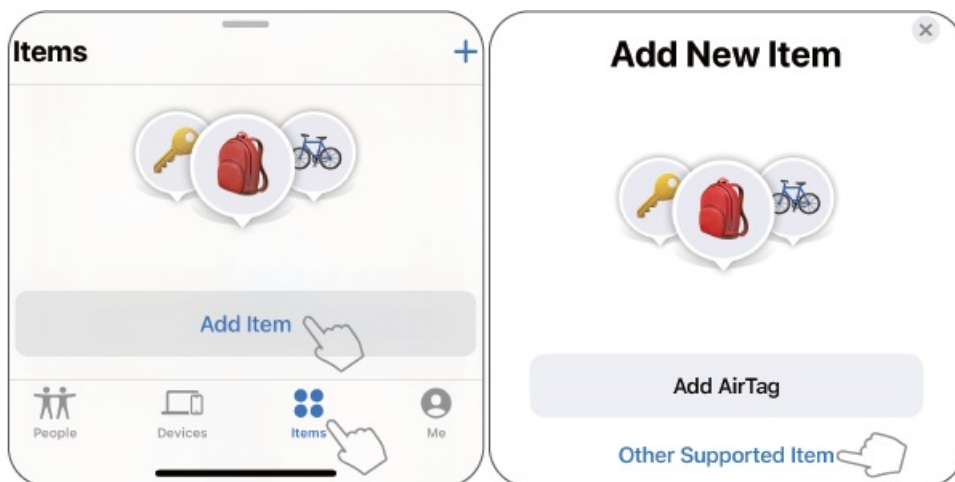
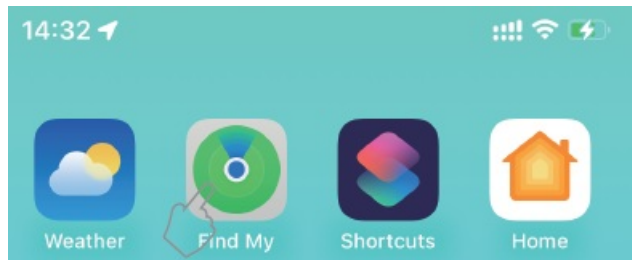

4. For subsequent pairing with other items, tap on “+” and select “Add Other Item” to pair.

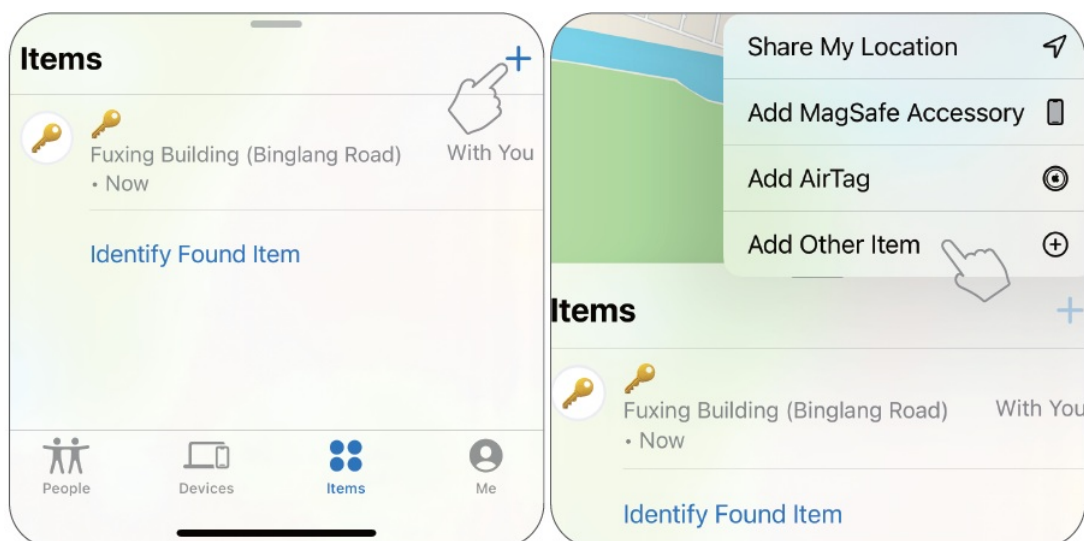

**Note:** It is recommended to update the firmware whenever an update is available in the Find My app to ensure the best user experience.

- To ensure the best user experience, please update the firmware whenever the update is available in Find My app.

## Battery Replacement

The ATUVOS Tag comes with a replaceable battery that lasts up to 1 year.

**If the battery runs down, follow these steps to replace it:**

1. Use your fingernail or a small tool to open the battery cover by inserting it into the gap.

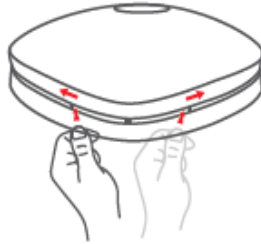

2. Remove the old battery using a paperclip and replace it with a new CR2032 battery, ensuring the positive terminal is facing up.

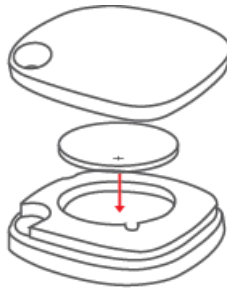

3. Close the battery cover by aligning the hole.

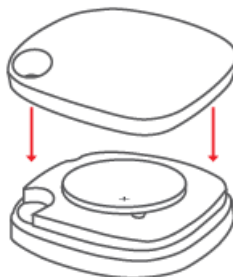

**Warning:** Keep the battery out of reach of children and pets as it can be dangerous if chewed on or swallowed. If you need to discard the tag, remove the battery first. Dispose of the old battery at a battery recycling container.

- Use batteries of the same type (CR2032) for replacement. Otherwise, it might cause damage.
- If you must discard the tag, take the battery out first.
- The old battery needs to be disposed of at a battery recycling container.

## Troubleshooting

### 1. Fail to add ATUVOS Tag to the Find My app:

- Make sure the tag is powered on and near the device.
- Ensure your iOS device is running the latest version and Bluetooth is enabled.
- Check if the tag has been paired with the Find My app on any other iOS device.

- If the above steps fail, long press the tag's power button for 10 seconds to reset it, and then try again.

## **2. ATUVOS Tag cannot function well:**

- Check if the battery level is low. If so, replace it with a new CR2032 battery.

If you have any further questions, please contact us: [support@atuvos.com](mailto:support@atuvos.com).

## **FAQ**

If you have any further questions, please contact us at [support@atuvos.com](mailto:support@atuvos.com).

## **FCC Statement**

The licensed transmitter/receiver contained in this device is compliant with Innovation, Science and Economic Development Canada's RNC for licensed radio devices.

### **The operation is permitted under two conditions:**

1. this device may not cause harmful interference
2. this device must accept any interference received, including interference that may cause undesired operation.

**Note:** This equipment has been tested and found to comply with the limits for a Class B digital device, pursuant to part 15 of the FCC Rules. These limits are designed to provide reasonable protection against harmful interference in a residential installation. This equipment generates uses and can radiate radio frequency energy and, if not installed and used in accordance with the instructions, may cause harmful interference to radio communications. However, there is no guarantee that interference will not occur in particular installation. If this equipment does cause harmful interference to radio or television reception, which can be determined by turning the equipment off and on, the user is encouraged to try to correct the interference by one or more of the following measures:

- Reorient or relocate the receiving antenna.
- Increase the separation between the equipment and receiver.
- Connect the equipment into an outlet on a circuit different from that to which the receiver is connected.
- Consult the dealer or an experienced radio/TV technician for help. Changes or modifications not expressly approved by the party responsible for compliance could void the user's authority to operate the equipment.

## **FCC Radiation Exposure Statement**

This device complies with FCC RF radiation exposure limits set forth for an uncontrolled environment. This transmitter must not be co-located or operating in conjunction with any other antenna or transmitter.

## **IC**

The licensed transmitter/receiver contained in this device is compliant with Innovation, Science and Economic Development Canada's RNC for licensed radio devices.

### **The operation is permitted under two conditions:**

1. The device must not cause interference;
2. The device must accept any radio interference, even if the interference is likely to compromise its operation.

## **RF Exhibition Statement:**

The equipment complies with the IC radiation exposure limit established for an uncontrolled environment. This equipment must be installed and used with a minimum distance of 5 mm between the radiator and your body.

**CE Statement**

Hereby, Comet Innovation Limited declares that this device is in compliance with the essential requirements and other relevant provisions of Directive 2014/53/EU.

**Technical Description**

- **Bluetooth Frequency Range:** 2402 – 2480 MHz
- **Bluetooth Transmit Power:** 8 dBm EIRP

**Legal Notice**

Use of the Works with Apple badge means that a product has been designed to work specifically with the technology identified in the badge and has been certified by the product manufacturer to meet Apple Find My network product specifications and requirements. Apple is not responsible for the operation of this device or use of this product or its compliance with safety and regulatory standards.

**Credit Lines**

Apple, Apple Find My, Apple Watch, Find My, iPhone, iPad, iPadOS, Mac, macOS and watchOS are trademarks of Apple Inc., registered in the U.S. and other countries. IOS is a trademark or registered trademark of Cisco in the U.S. and other countries and is used under license.

---

**Documents / Resources**

	<a href="#">ATUVOS AT2301 Bluetooth Tracker Key Finder</a> [pdf] User Manual AT2301 Bluetooth Tracker Key Finder, AT2301, Bluetooth Tracker Key Finder, Tracker Key Find er, Key Finder, Finder
---	---

**References**

- [User Manual](#)