



ATUMTEK ATSS175 Selfie Stick Tripod with Wireless Remote Shutter User Manual

[Home](#) » [ATUMTEK](#) » ATUMTEK ATSS175 Selfie Stick Tripod with Wireless Remote Shutter User Manual 

ATUMTEK ATSS175 Selfie Stick Tripod with Wireless Remote Shutter User Manual



Contents

- [1 Product Line Graph](#)
- [2 Product Introduction](#)
- [3 Wireless Remote Shutter Instructions](#)
- [4 About Android System Phones Connection](#)
- [5 Step 1 Open and Adjust Selfie Stick Tripod](#)
- [6 Step 2 Attach the Device on & Rotate Phone Holder](#)
- [7 Step 3 Release Devices and Close Tripod](#)
- [8 Documents / Resources](#)
 - [8.1 References](#)
- [9 Related Posts](#)

Product Line Graph

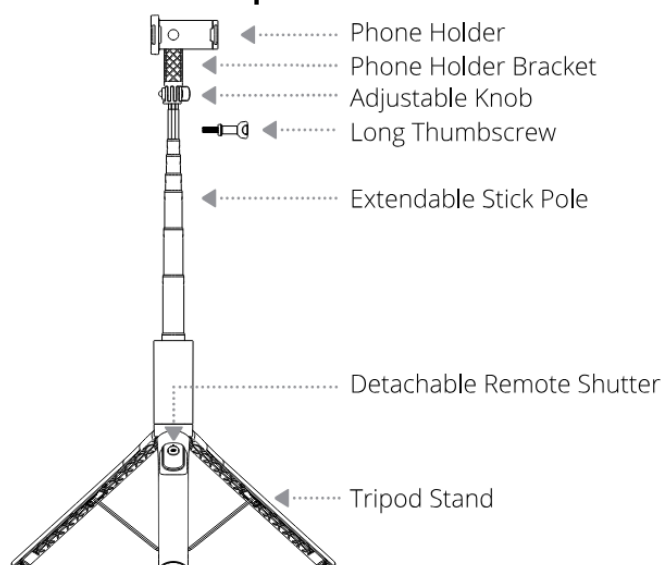

Product Introduction

Material	Plastic & Aluminum Alloy
Weight	Approx. 11,12
Folded Size	14 133 inches
Selfie Stick Mode Length	63.0 Inches
Tripod Made Height	63.4 inches
Phone Halder So	from 2.2 inches to 3.7 inches
Wireless Remote Shutter Distance	<10mm (33)
Replaceable Cell Battery Model	CR1632 Ultrium Battery 3V 120A (Enables to take aro und 15000 pictures
Compatible Devices	fit iOS 5.0 and above Android 4 and allover devices

Wireless Remote Shutter Instructions

Please pull out the insulating sheet when using the remote for the first time.

1. Turn On/Off:

Press and hold the remote button for 3 seconds to turn the remote on or off. The green indicator light flashes slowly when the remote is on and not connected. If there's no connection for 10 minutes, the remote will shut down.

2. Connect via Phone Bluetooth:

Turn on the remote shutter and go to your phone's Bluetooth settings. Search for and connect to "ATUMTEK" Bluetooth name. Once fully connected, the remote indicator light will turn off. If you have multiple ATUMTEK remotes, make sure to clear other devices and then rename the remotes to distinguish between them. After first time connected with phone device, remote will auto connect with same device the next time when you open remote and phone Bluetooth Remote light will be off after auto-connected.

3. Taking Pictures and Videos with the Remote Shutter:

After remote connected with phone Bluetooth, please open your phone camera and click the remote button once to take a picture. Remote light flashes when clicking. To take a video, select the video option manually and then click remote button once to start recording. Finally press the button again to stop recording.

Note: The remote cannot control phone apps like Instagram, TikTok, Snapchat. If there is no cycling for 10 minutes, the remote will shut down.

4. Low Battery:

Remote could not open when it is at low battery.

5. Take Out & Replacing Cell Battery:

Please slide down and take out the remote from tripod, then open remote back cover to replace with a new cell battery and lock the cover. Finally push remote upward to put it back. Please use tool to loosely tighten the screw on back cover. Tool is not included in the package.



Slide down
to take remote out



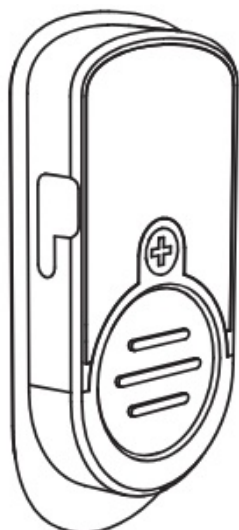
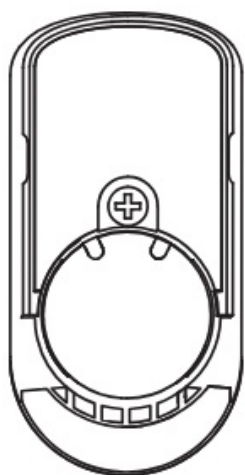

Push upward
to put it back in

About Android System Phones Connection

Some Andruse phones use phone solum button to control camera of zaom Plevese reset on phone camera semings, find volume key function see the volume key function to shutter (s not select zoom or fimus)



Step 1 Open and Adjust Selfie Stick Tripod

Selfie Stick Mode

Pull out the phone holder, then extend the selfie stick pole and adjust height to use as selfie stick mode.

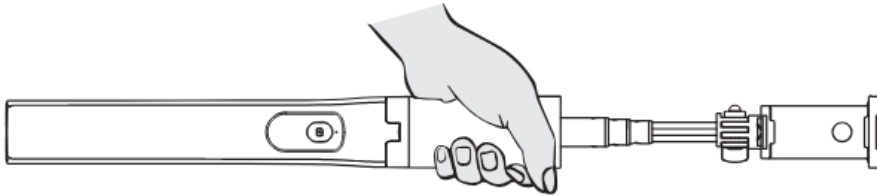

Tripod Mode

First, slightly unlock the 3 legs on the bottom, Then pull out the the phone holder and hold the pole to pull the whole extendable pole out, the tripod will fully open automatically. This is similar to an umbrella structure, (Be careful not to pinch your fingers.) Finally, adjust the extendable pole height to find best shooting position.

WRONG: Please do not pull the 3 legs directly to open the tripod

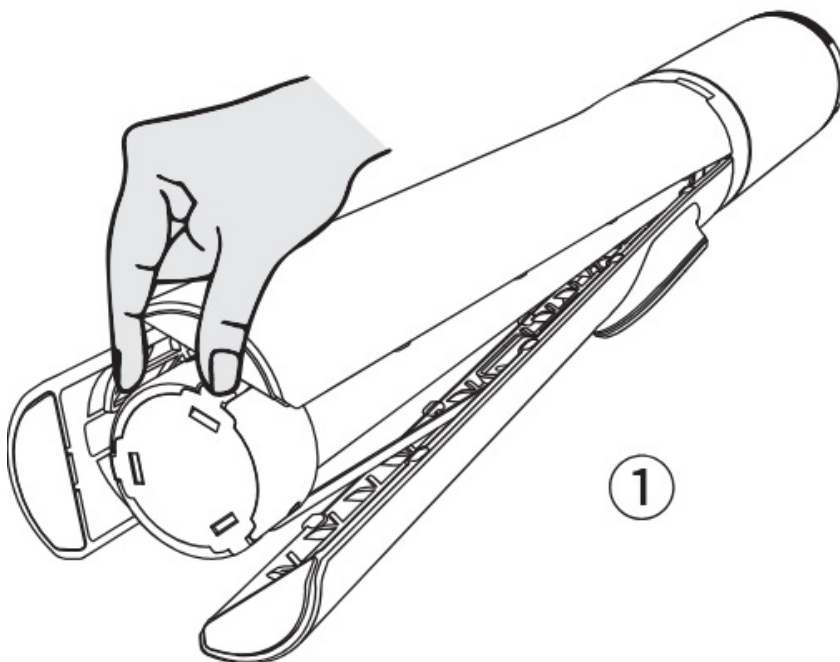

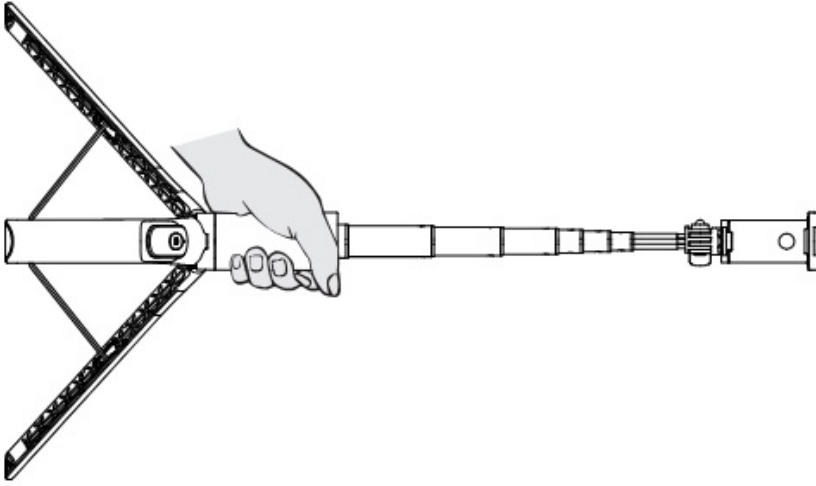
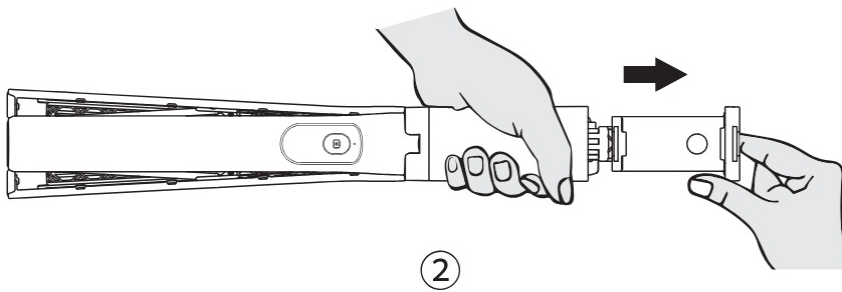

Step 2 Attach the Device on & Rotate Phone Holder

Using the phone, to stretch the phone holder to a suitable length easily, then release it in order to put the phone inside phone holder. Please avoid getting the phone buttons stuck

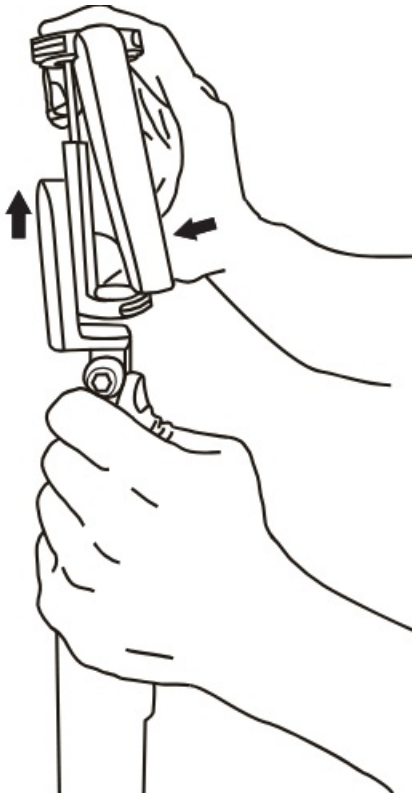



Attach other devices on phone holder through the 2 cold shoe mount. Then loosen the knob to rotate the phone holder freely knob to find best shooting angles, finally fasten the knob. Phone should be mounted at the top of the holder to ensure that large phones won't obstruct the rotation of phone holder.

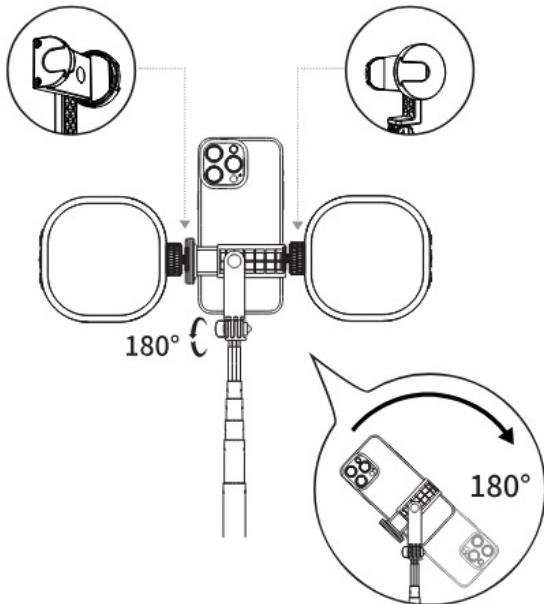

For GoPro/Mini Sport Camera Devices

GoPro adapter or sport camera adapter is not included inside package. Loosen the knob to remove phone holder bracket first, then using the long thumbscrew to install GoPro Adapter on. Finally to fasten the long screw bolt to lock device on.

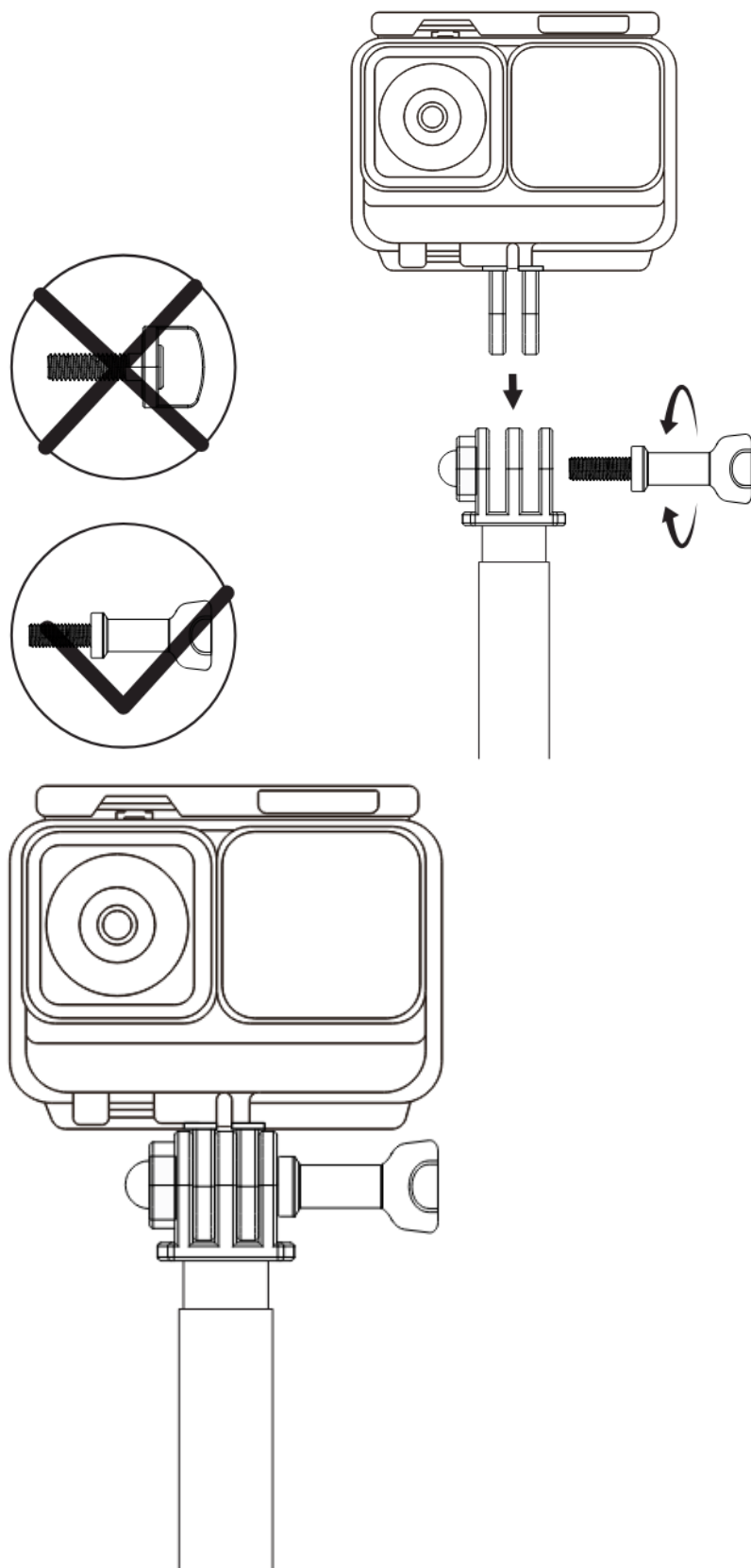

Step 3 Release Devices and Close Tripod

First remove devices from cold shoe mount. Then using the phone, to stretch the phone holder to a suitable length easily, then release it in order to take out the phone. Finally push the extendable pole back to close the tripod.

WRONG: Please do not pull the 3 legs directly to open the tripod.

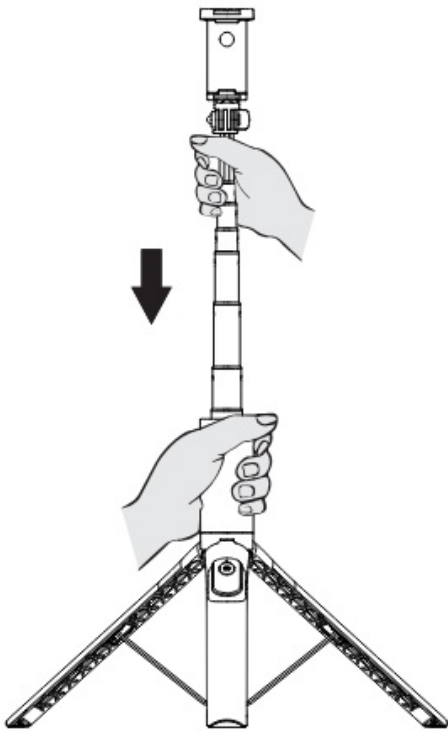
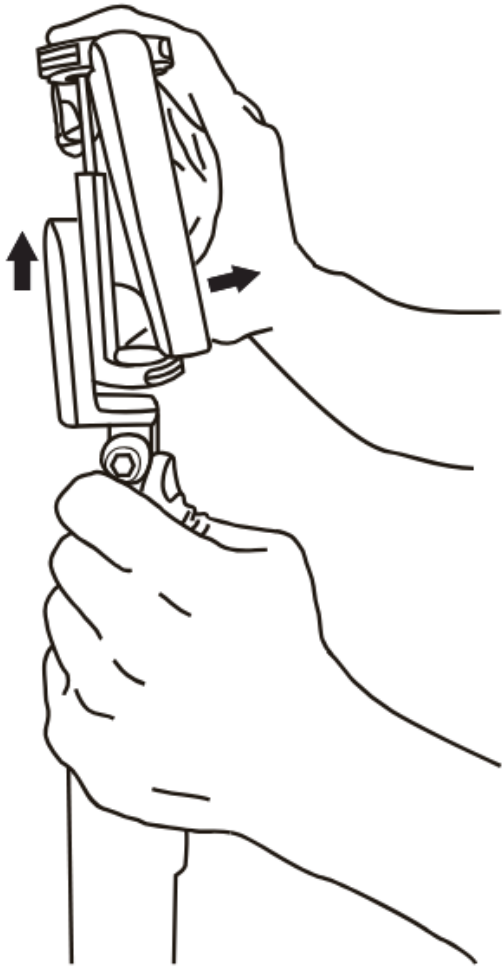

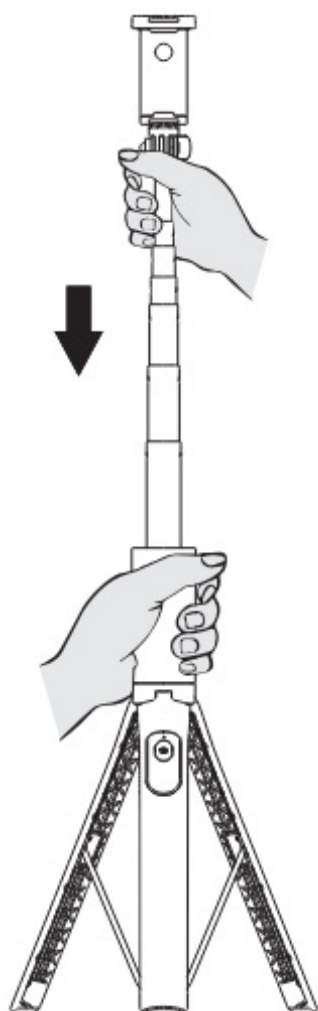

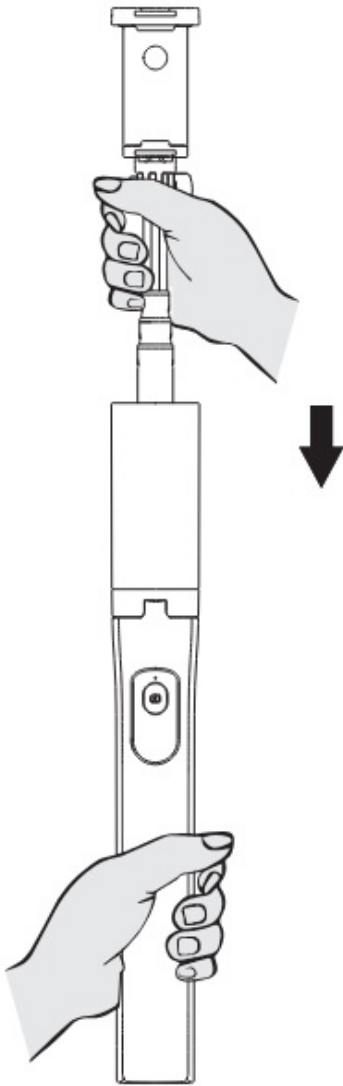

FCC Statement

Changes or modifications not expressly approved by the party responsible for compliance could void the user's authority to operate the equipment

This device complies with part 15 of the FCC Rules. Operation is subject to the following two conditions: (1) This device may not cause harmful interference, and (2) this device must accept any interference received, including interference that may cause undesired operation

Note: This equipment has been tested and found to comply with the limits for a Class B digital device, pursuant to

Part 15 of the FCC Rules. These limits are designed to provide reasonable protection against harmful interference in a residential installation. This equipment generates, uses, and can radiate radio frequency energy, and if not installed and used in accordance with the instructions, may cause harmful interference to radio communications. However, there is no guarantee that interference will not occur in a particular installation. If this equipment does cause harmful interference to radio or television reception, which can be determined by turning the equipment off and on, the user is encouraged to try to correct the interference by one or more of the following measures

- Reorient or relocate the receiving antenna
- Increase the separation between the equipment and receiver.
- Connect the equipment into an outlet on a circuit different from that to which the receiver is connected
- Consult the dealer or an experienced radio/TV technician for help.

IC Warning

This device complies with Industry Canada licence-exempt RSS standard(s) Operation is subject to the following two conditions
(1) this device may not cause interference, and
(2) this device must accept any interference, including interference that may cause undesired operation of the device.

The device has been evaluated to meet general RF exposure requirement. The device can be used in portable exposure condition without restriction.



Documents / Resources

	ATUMTEK ATSS175 Selfie Stick Tripod with Wireless Remote Shutter [pdf] User Manual ATSS175 Selfie Stick Tripod with Wireless Remote Shutter, ATSS175, Selfie Stick Tripod with Wireless Remote Shutter, Stick Tripod with Wireless Remote Shutter, Tripod with Wireless Remote Shutter, Wireless Remote Shutter, Remote Shutter, Shutter
--	---

References

- [User Manual](#)

[Manuals+.](#) [Privacy Policy](#)

This website is an independent publication and is neither affiliated with nor endorsed by any of the trademark owners. The "Bluetooth®" word mark and logos are registered trademarks owned by Bluetooth SIG, Inc. The "Wi-Fi®" word mark and logos are registered trademarks owned by the Wi-Fi Alliance. Any use of these marks on this website does not imply any affiliation with or endorsement.