



ATOMSTACK X20 PRO R30 V2 Laser Module Instruction Manual

[Home](#) » [ATOMSTACK](#) » ATOMSTACK X20 PRO R30 V2 Laser Module Instruction Manual 

ATOMSTACK X20 PRO R30 V2 Laser Module



Contents

- [1 Important Information](#)
- [2 Cautions](#)
- [3 Disclaimer](#)
- [4 Packing List](#)
- [5 Installation Guide](#)
- [6 Installation Method Of IKIER K1 Machine](#)
- [7 Cable Installation For X30 Machines](#)
- [8 Cable Installation For K1 Machines](#)
- [9 Lightburn Engraving Parameter](#)
- [10 After-sales and Warranty Policies](#)
- [11 Customer Service](#)
- [12 Documents / Resources](#)
 - [12.1 References](#)
- [13 Related Posts](#)

Important Information

Note: The picture is for reference only, the actual product shall prevail.
For more information, please scan the QR code.



Cautions

1. This product is an integral part of the laser engraving machine system, and must be installed on the laser engraving machine for use. And the product belongs to the class 4 laser products, the laser system itself must meet the requirements of the latest version of IEC 60825-1, otherwise the product will not be used.
2. Do not look directly at the laser beam to avoid skin exposure to type 4 beams, especially in close proximity. Youth under the age of 18 must have parental supervision during use. Do not touch the laser when it is at work.
3. High-intensity laser beams produce extremely high temperatures and a lot of heat, and carving may burn the substrate. Certain materials may catch fire during engraving, producing gas and smoke. Do not leave the machine unattended while the laser is powered on.
4. When using a laser for engraving, the material produces smoke, steam, particles, and toxic substances in plastic and other combustible materials. These smoke or air pollutants can be harmful to your health.
5. Before using the laser for engraving, make sure that there are no flammable and explosive substances in the carving area and always place available fire extinguishers nearby to ensure safety.
6. Do not power on before the laser being installed to the engraving machine.
7. Please avoid machine vibration, machine vibration will cause the optical path to be inaccurate, resulting in dangerous drift beam.
8. It is recommended to use at an ambient temperature of 20°C-30°C, lower or higher than the recommended temperature will make the laser work unstable.

Disclaimer

1. The product is a laser module, please scan the home page QR code for complete installation manual along with the latest instructions and warnings. Shenzhen At omstack Technology Co., Ltd.(ATOM STACK) reserves the right to update this disclaimer and installation guide.
2. Be sure to read this document carefully before using the product to understand your legal rights,

responsibilities, and safety instructions; otherwise, it may cause property losses, safety accidents, and personal safety hazards.

Once you use this product, you will be deemed to have understood and accepted all the terms and contents of this document. Users promise to be responsible for their actions and all the consequences arising therefrom.

The user agrees to use the product only for lawful purposes and agrees to the full terms and contents of this document and any relevant policies or guidelines that ATOMSTACK may have in place.

3. You understand and agree that ATOMSTACK may not be able to provide you with the cause of the damage or accident and provide you with ATOMSTACK's after-sales service unless you provide the original engraving file, the configuration parameters of the engraving software used, operating system information, video of the engraving process, and the operational steps before the problem or failure occurs.
4. ATOMSTACK is not responsible for any and all losses caused by their failure to use the products in accordance with this manual.
5. ATOMSTACK has the ultimate right to interpret the document in compliance with the law. ATOMSTACK reserves the right to update, modify, or terminate the terms without notice.

Packing List

- Laser module

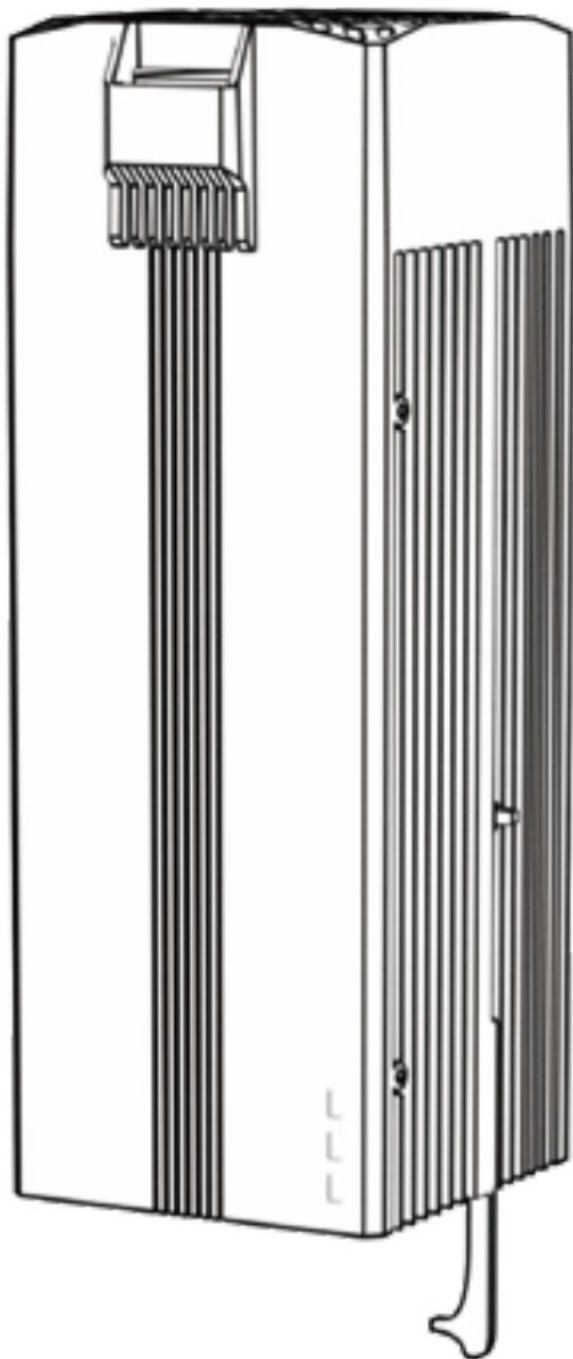

- Connect board

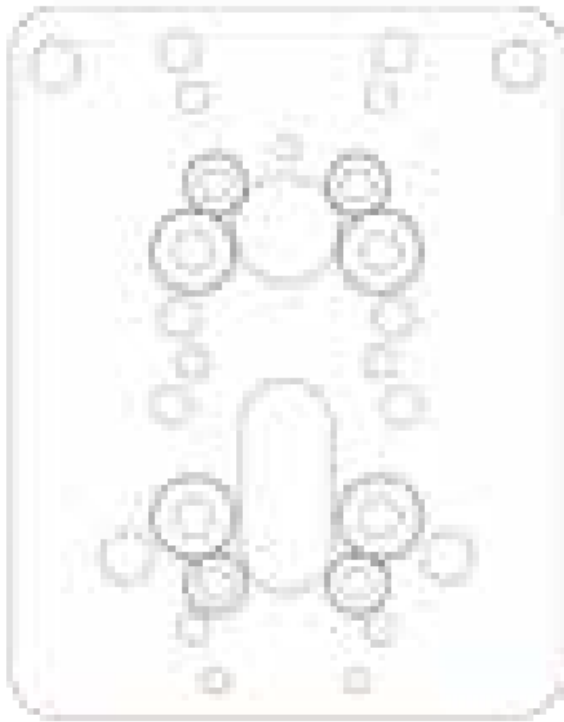

- Slider

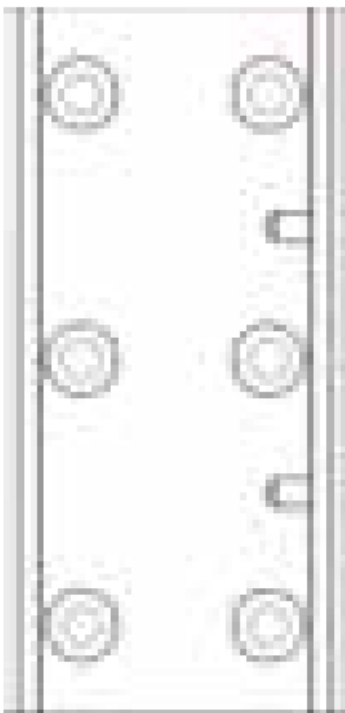

- Circuit board



- Power adaptor

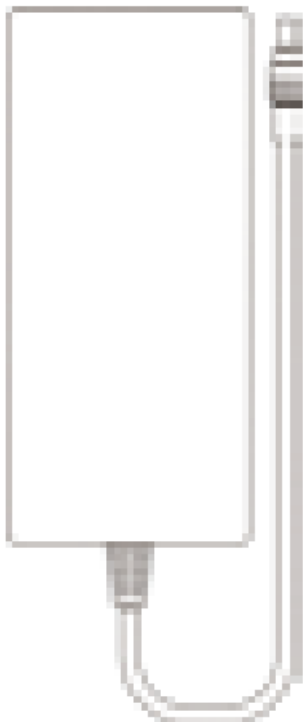

- Power cable

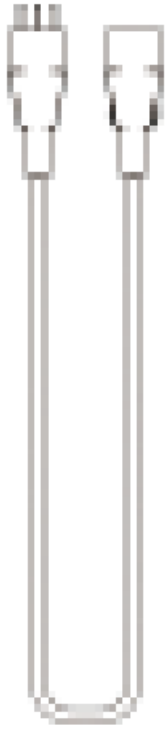

- Connect cable 1



- (M4*6)4PCS



- (M4*4)4PCS

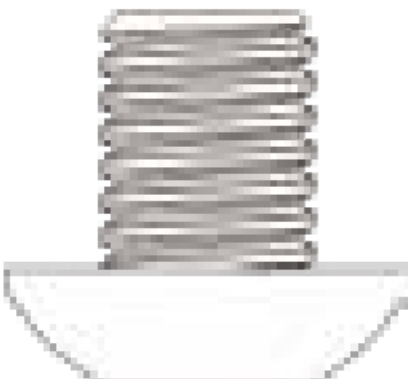

- (M5*6)6PCS

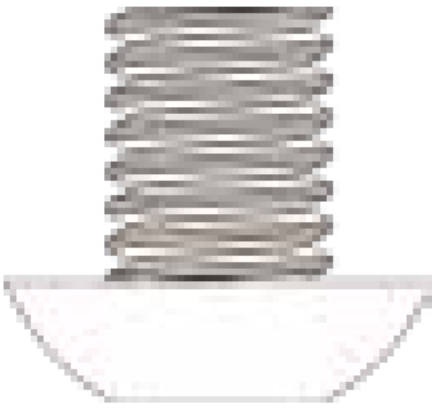

- (M5*8)4PCS



- (M3*6)4PCS



- (M3*8)3PCS

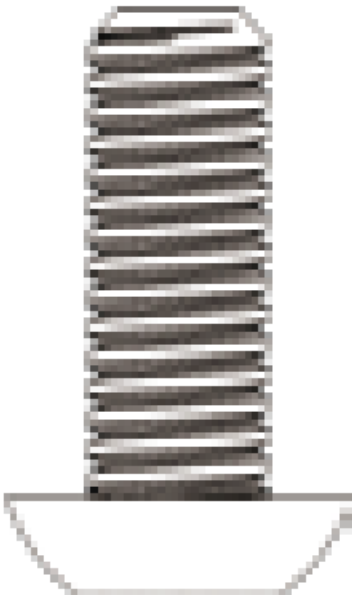

- Connect cable 2



- (Handle) 2PCS

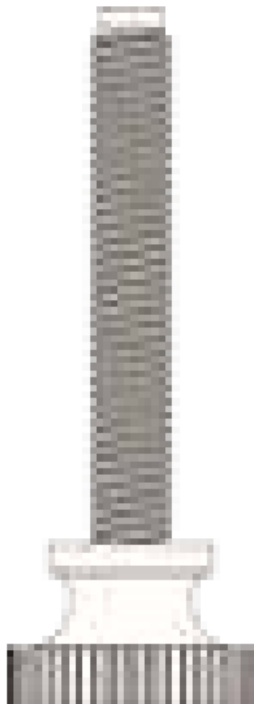

- H3 wrench



- H2.5 wrench



- H2 wrench



- Installation Manual



- Extension cord



Installation Guide

Step 1: Install the connect board on the X-axis of the machine as the following instructions.

● Red screw hole/ (M4*6)4Pcs
X20 PRO / S20 PRO/ A20 PRO/ A20
X30 Pro / S30 Pro / A30 Pro

● Blue screw hole/ (MS*6)4PCS
AS 10W / AS 20W / AS 30W / AS PRO

● Green screw hole/ (MS*8)4PCS
AS M30 / AS M40 / AS PRO + / X7
X7 PRO/ A10 / A10 PRO/ S10 PRO

The remaining screw holes are applied to the other laser engraving machines.

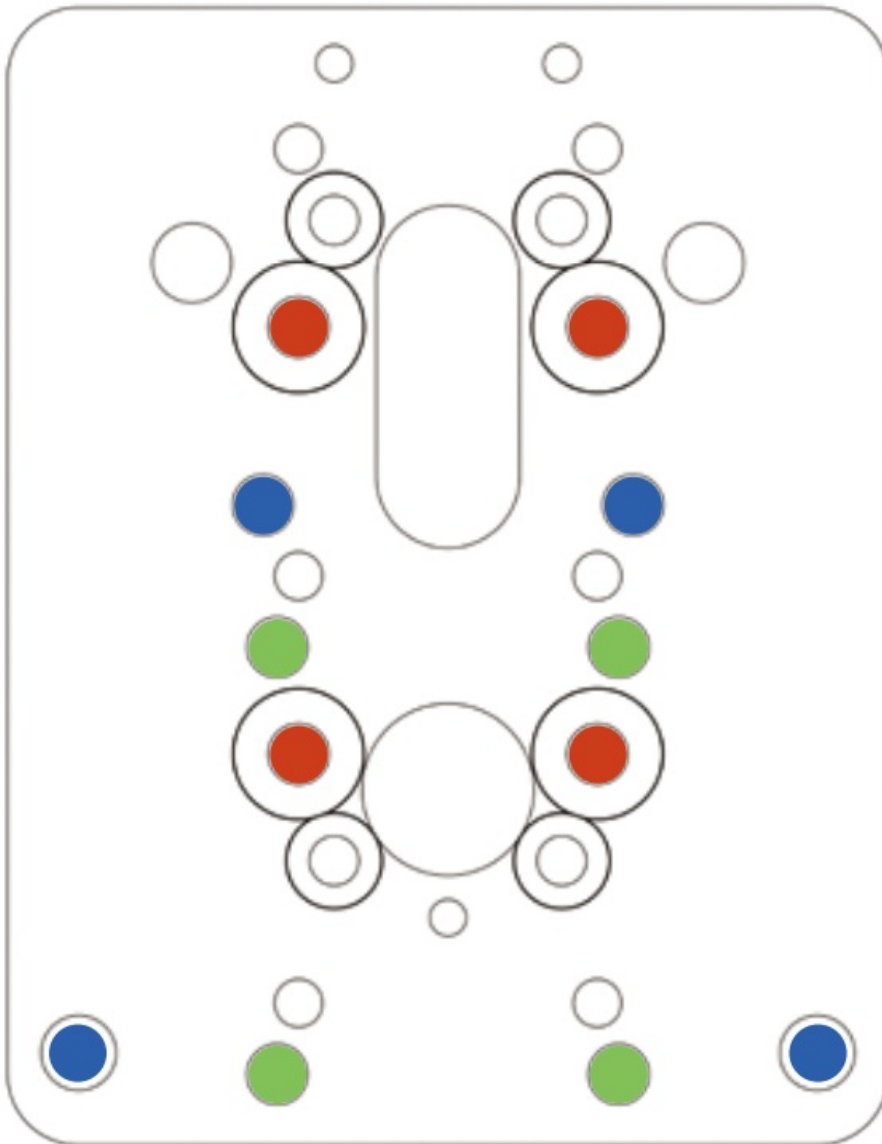

Step 2: Assemble the slider on the connect board (M4 * 4 Round) 4PCS.

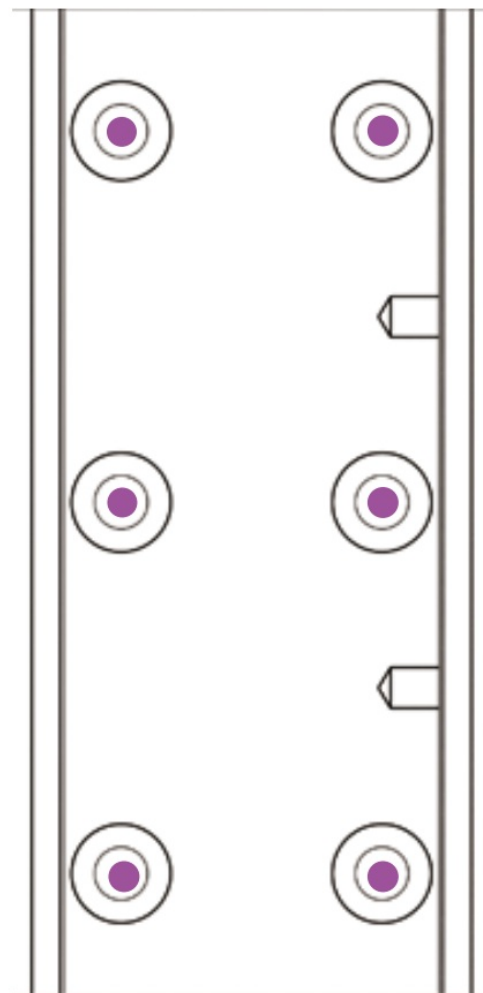
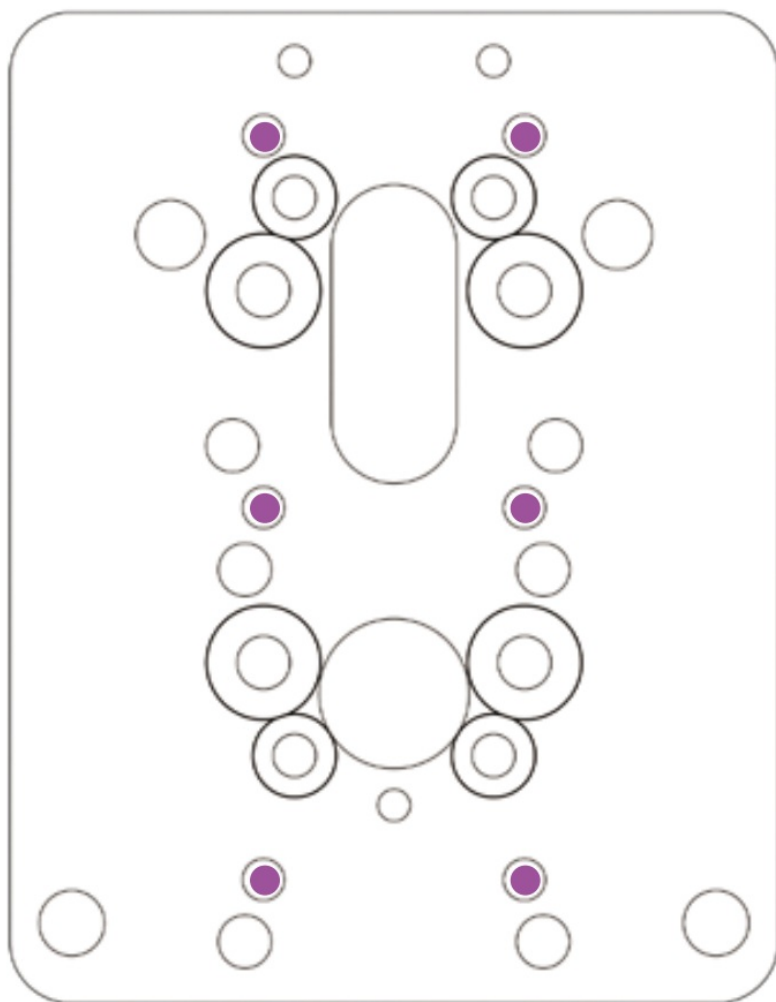

● Red screw hole / (M4*6)4Pcs
X20 PRO / S20 PRO / A20 PRO / A20
X30 Pro / S30 Pro / A30 Pro

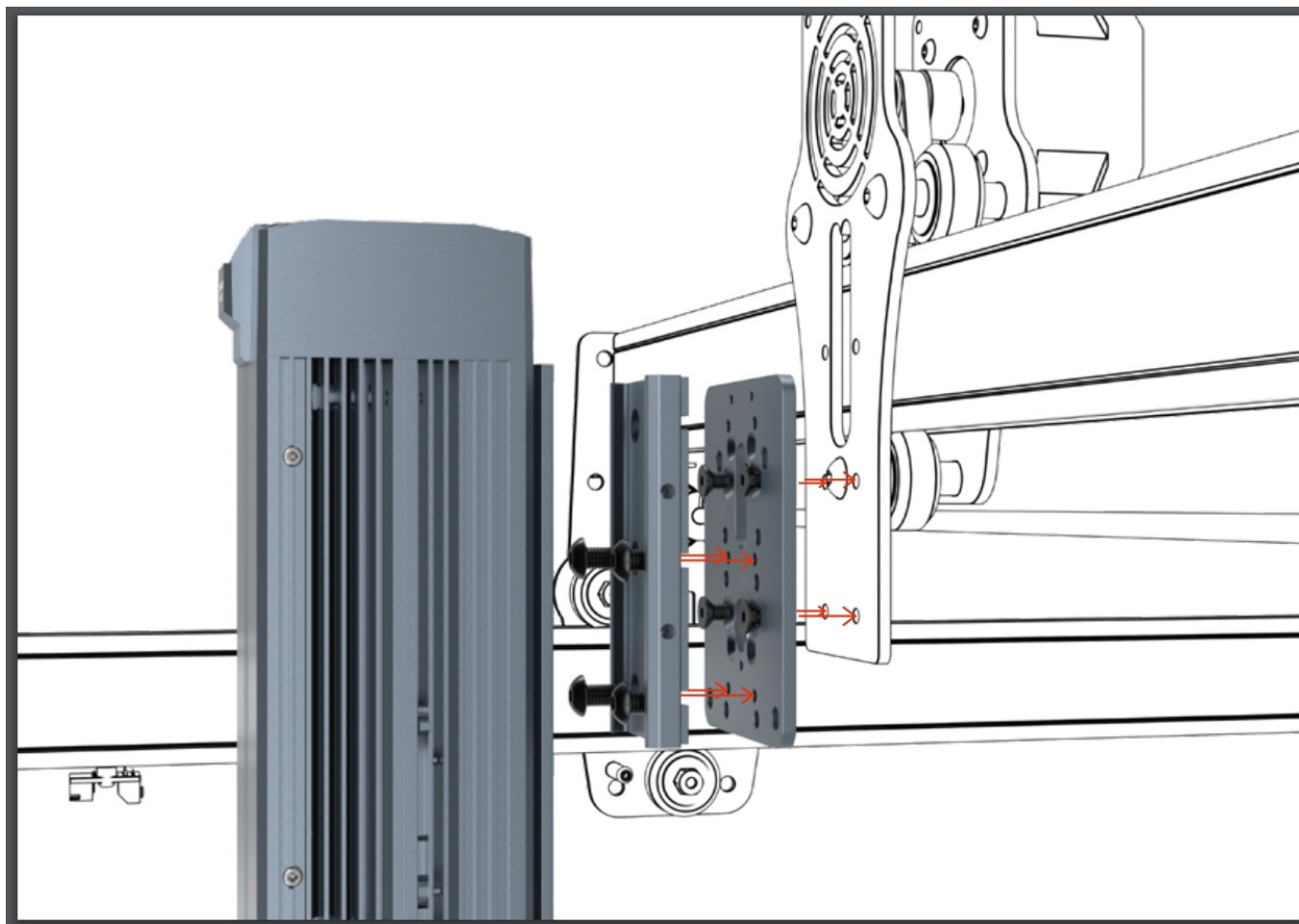

● Blue screw hole/ (MS*6)4Pcs
AS 10W / AS 20W / AS 30W / AS PRO

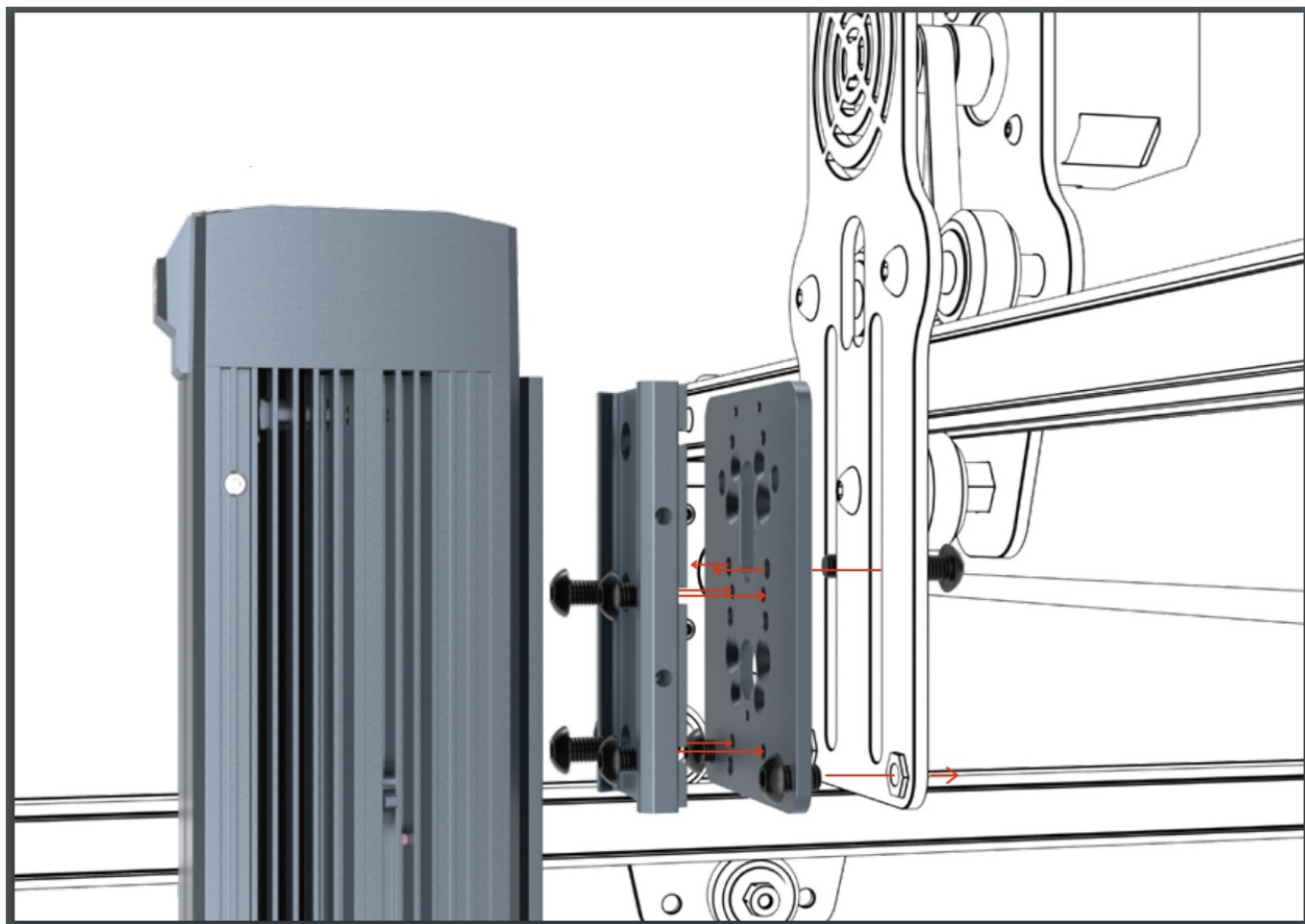

● Green screw hole/ (MS*8)4PCS
AS M30 / AS M40 I AS PRO + / X7
X7 PRO/ A10 / A10 PRO/ S10 PRO

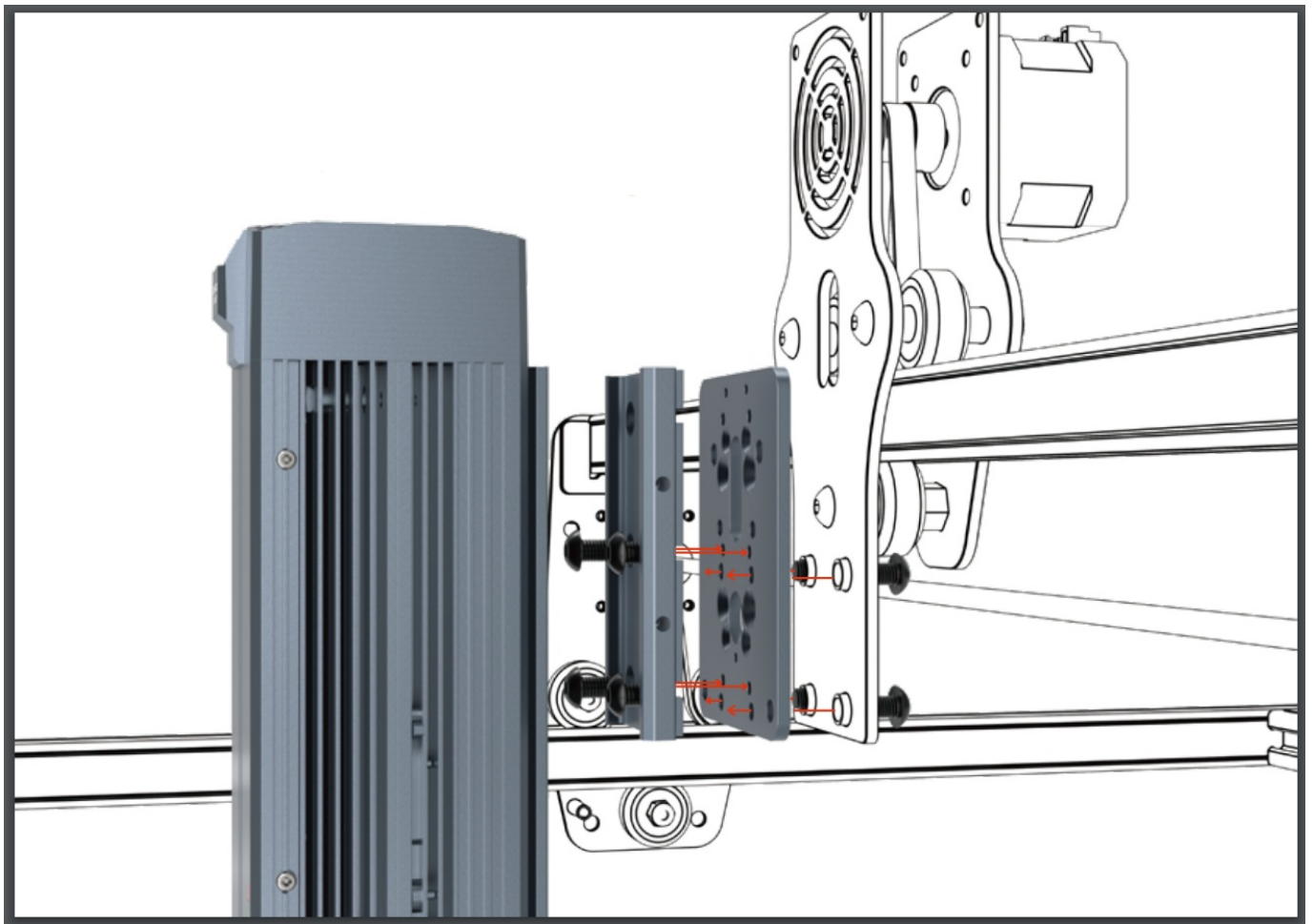

Step 3: Install the handle 2PCS

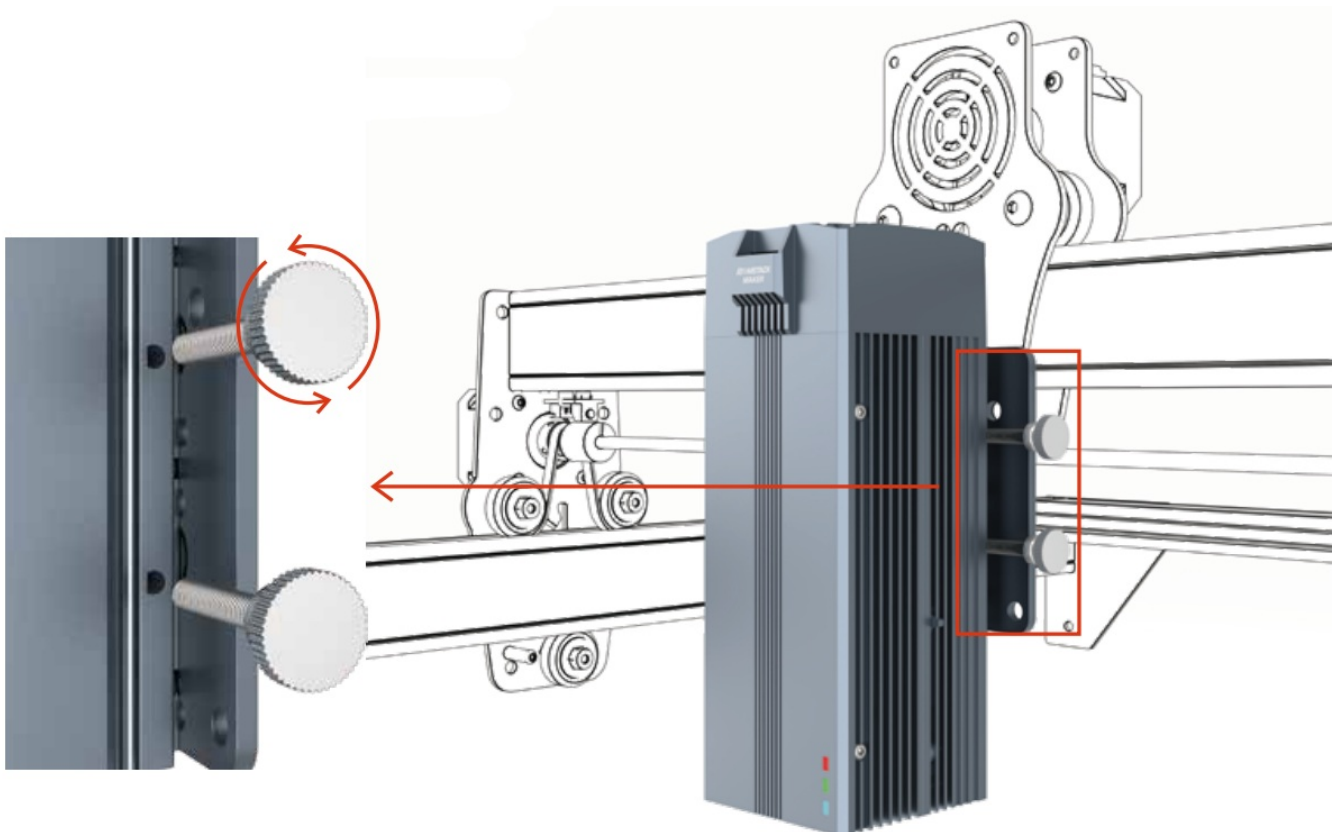

1. Use the connecting wire 2 in the package to connect the R30 laser module to the circuit board

2. Connect the power adapter to the circuit board and turn on the power
3. Pull out the cable connecting the laser module on the original machine and connect it into the circuit board (pay attention to distinguish between 3pin and 4pin)

Installation Method Of IKIER K1 Machine

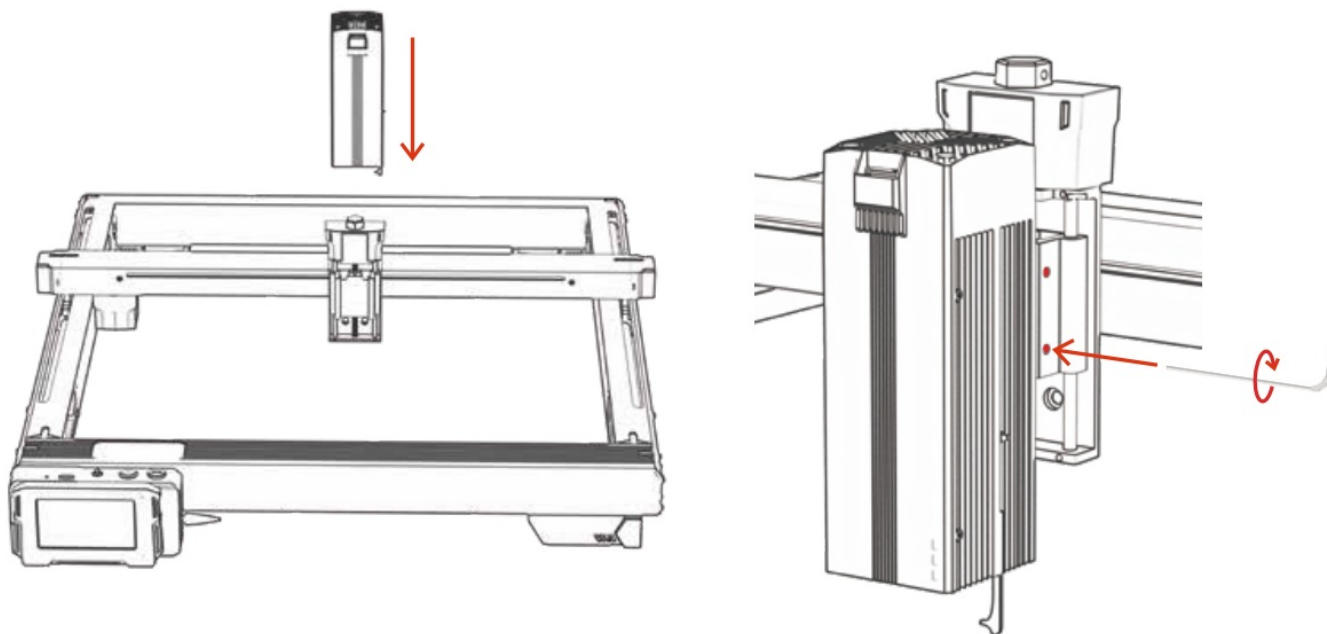

Step 4: Connect to the circuit board

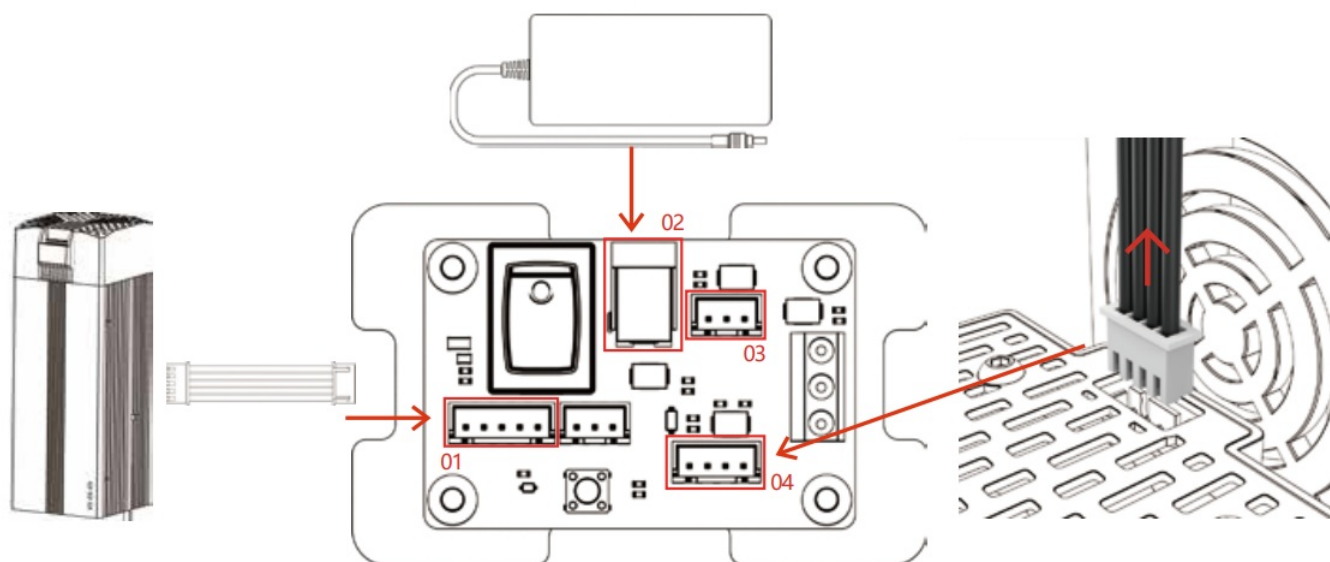

1. Find the laser module adapter cable 1 in the package
2. Pull out the laser module cable of the original machine
3. Connect the adapter cable 1 with the laser module cable of the original machine
4. Connection between the adapter cable 1 and the R30 laser module

Cable Installation For X30 Machines

(note that the R30 module is powered by DC24V, and there is a 24V power adapter in the package)

1. Pull out the laser module cable of the original machine
2. Replace the laser head of K1
3. Extension cords from the hookup list
4. Insert the extension cable into the laser head

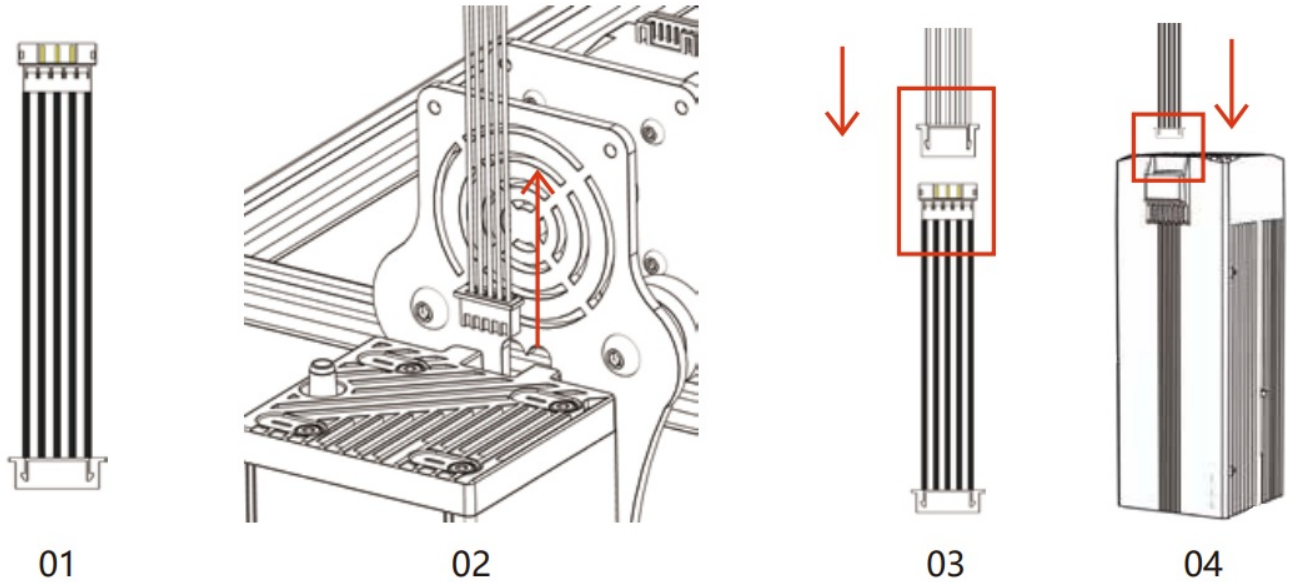

Cable Installation For K1 Machines

(note that the R30 module is powered by DC24V, and there is a 24V power adapter in the package)

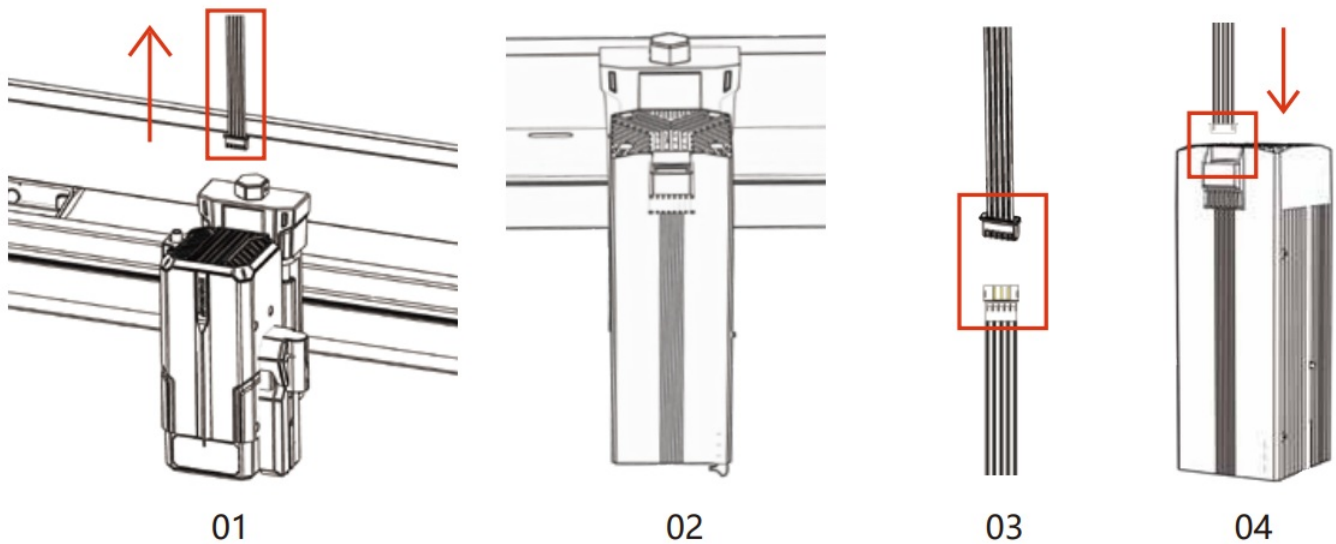

1. Pull out the laser module cable of the original machine
2. Replace the laser head of K1
3. Extension cords from the hookup list
4. Insert the extension cable into the laser head

Step 5: Indicator light status

1. The red indicator light is on: laser over-temperature protection prompt
2. The green indicator light is on: it lights up when the laser is powered on
3. The blue indicator light is on: it lights up when the laser is engraving



Step 5: Adjust the focal length

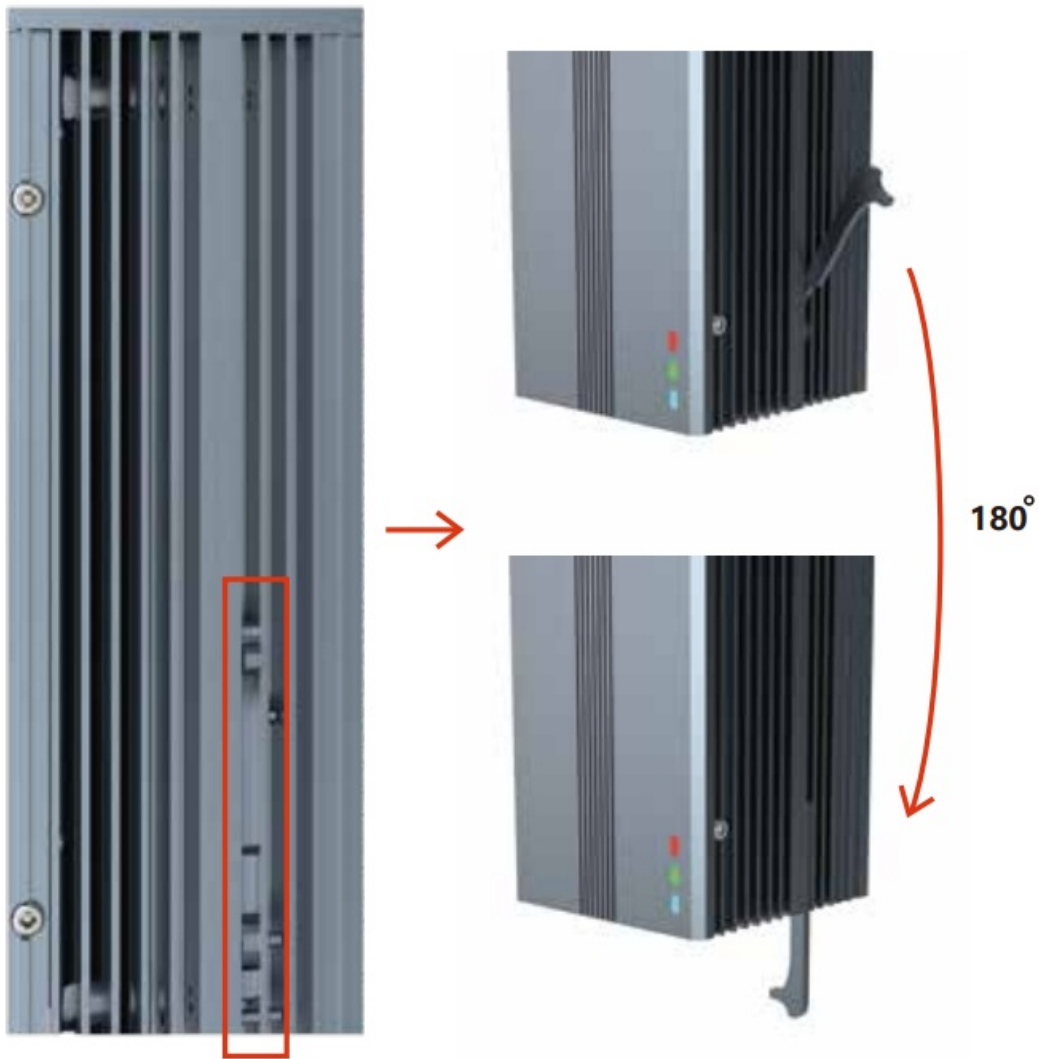

1. Ensure that the tested object is placed flat before focusing (including the test platform and the material itself)
2. Put down the focus pole so that the focus pole just contact to the carved object to determine the focal length
3. Tighten the handle to lock the laser
4. Take back the fixed focus pole
5. Fix focus completed
6. Engraving parameters refer to the parameter table.

Lightburn Egnraving Parameter

Material	Engraving				
	Quality	Speed (mm/ m in)	Max-Power	Image Mode	Needs to be blackened
Copper	0.01	500	100%	Threshold	NO
Iron	0.01	2000	100%	Threshold	NO
Natural color alumina	0.01	600	100%	Filled	NO
Coated alumina	0.01	5000	100%	Threshold	NO
Brushed Stainless Steel	0.01	1000	100%	Threshold	NO
Mirror Stainless Steel	0.01	1000	100%	Filled	NO
painted furniture	0.01	5000	100%	Jarvis	NO
ABS	0.01	4500	25%	Threshold	NO

Material	Engraving				
	Quality	Speed (mm / min)	Max-Power	Image Mode	Needs to be blackened
Plastic	0.01	3000	80%	Threshold	NO
Leather	0.01	4000	100%	Threshold	NO
Acrylic	0.01	6000	100%	Threshold	NO
Rubber	0.01	1000	100%	Threshold	NO
Oil painting paper	0.02	2000	100%	Threshold	NO
Rock	0.01	1000	100%	Filled	NO

Remark:

The parameter table is only for the most widely used materials. Customers may need to try other uncommon materials by themselves, or they can contact us to apply for testing.

LaserGRBL Engraving Parameter

Material	Engraving				
	Quality	Speed (mm/ m in)	Max-Power	Image Mode	Needs to be blackened
Copper	100	500	1000	Threshold	NO
Iron	100	2000	1000	Threshold	NO
Natural color alumina	100	600	1000	Filled	NO
Coated alumina	100	5000	1000	Threshold	NO
Brushed Stainless Steel	100	1000	1000	Threshold	NO
Mirror Stainless Steel	100	1000	1000	Filled	NO
painted furniture	100	5000	1000	Jarvis	NO
ABS	100	4500	250	Threshold	NO

Material	Engraving				
	Quality	Speed (mm/ m in)	Max-Power	Image Mode	Needs to be blackened
Plastic	100	3000	800	Threshold	NO
Leather	100	4000	1000	Threshold	NO
Acrylic	100	6000	1000	Threshold	NO
Rubber	100	1000	1000	Threshold	NO
Oil painting paper	50	2000	1000	Threshold	NO
Rock	20	1000	1000	Threshold	NO

After-sales and Warranty Policies

1. All ATOMSTACK R30 laser modules are protected by the following specific warranty terms. All laser module products are only guaranteed to the original purchaser that, when purchased through an ATOMSTACK authorized seller, there are no manufacturer defects or faults for one (1) years from the date of purchase and lifelong technical support. ATOMSTACK will request proof of purchase and date of purchase upon the claim.
2. ATOMSTACK R30 laser modules can enjoy an extended warranty at an extra charge. Please keep checking with ATOMSTACK customer service staff.

3. ATOMSTACK R30 Laser module warranty is limited to defects, faults or failure of the product, based on the manufacturer's defects. No compensation shall be awarded for any improper use, lack of maintenance, incorrect or inadequate power supply, and similar failure unrelated to the manufacturer's defect.
4. ATOMSTACK will not be responsible for the failure, operation or use of the product.
5. Warranty will cover the repair or replacement of related equipment with new or renovated equipment during the warranty period, or in some cases replacing parts of the same model, at the Atomstack's discretion.
6. Within the ATOMSTACK clause, separate parts can be supplied to the customer instead of replacing the entire unit. Such conditions may include, but may not be limited to, electronic board, adapters, screws or any other item that ATOMSTACK considers more suitable for separate supply.
7. The terms and conditions of the ATOMSTACK warranty are subject to change with out notice. Be sure to check the ATOMSTACK warranty terms before you purchase.

Customer Service

For detailed warranty policy, please visit our official website at:

www.atomstack.net

For technical support and service, please email:

support@atomstack.net

Manufacturer:

Shenzhen AtomStack Technologies Co., Ltd.

Address:

202, Building 1, Mingliang Technology Park, No. 88 Zhuguang
North Road, Taoyuan Street, Nanshan District, Shenzhen,
Guangdong, China

Scanner APPLICATION:

QR code reader/ Barcode scanner or any APP with scanner.



Documents / Resources

	<p>ATOMSTACK X20 PRO R30 V2 Laser Module [pdf] Instruction Manual X20 PRO R30 V2 Laser Module, X20 PRO, R30 V2 Laser Module, V2 Laser Module, Laser Module, Module</p>
---	---

References

- **[A Atomstack Official Store - Laser Engraving Machine](#)**
- **[User Manual](#)**

[Manuals+](#), [Privacy Policy](#)

This website is an independent publication and is neither affiliated with nor endorsed by any of the trademark owners. The "Bluetooth®" word mark and logos are registered trademarks owned by Bluetooth SIG, Inc. The "Wi-Fi®" word mark and logos are registered trademarks owned by the Wi-Fi Alliance. Any use of these marks on this website does not imply any affiliation with or endorsement.