



Atoms Labs AWS43R KIT CONTENT User Guide

[Home](#) » [Atoms Labs](#) » Atoms Labs AWS43R KIT CONTENT User Guide 

Contents





- 1 Atoms Labs AWS43R KIT CONTENT
- 2 Kit Contents
- 3 PRODUCT OVERVIEW
- 4 INSTALLING YOUR DEVICES
- 5 Wireless Connection
- 6 Wired Connection
- 7 Pair the camera to NVR
- 8 Live View
- 9 APP SETUP
- 10 FCC Statment
- 11 Documents / Resources
- 12 Related Posts



Atoms Labs AWS43R KIT CONTENT

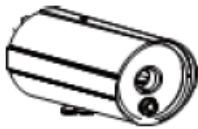
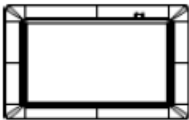

Kit Contents

<p>Digital Wireless Outdoor Camera</p> 	<p>Digital Wireless Receiver</p> 	<p>Screw Pack (For Camera)</p> 
<p>Camera / Receiver Adaptor</p> 	<p>Ethernet Cable</p> 	<p>Camera / Receiver Antenna</p> 

PRODUCT OVERVIEW

Wireless Digital Monitor

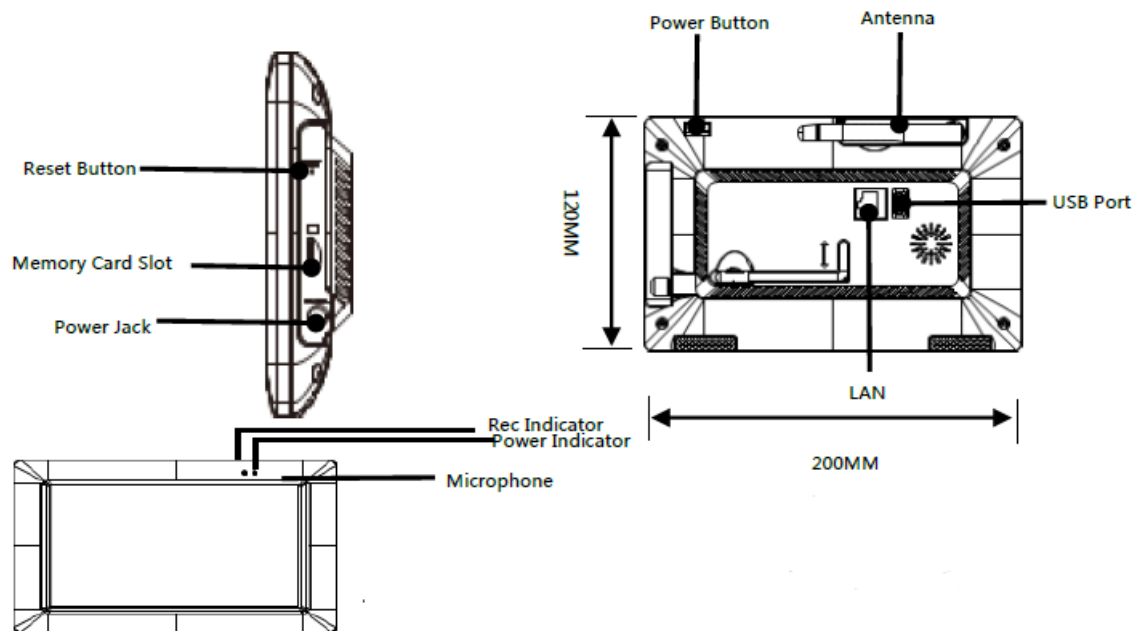

Power Jack: DC 12V/1A

Memory Card Slot: Max. 128G

(Memory card cannot be inserted or removed without switching off the device. Otherwise, it will lead to system crash)

USB Port: Support USB flash drive upgrade and mouse

Wireless Digital Outdoor Camera



INSTALLING YOUR DEVICES

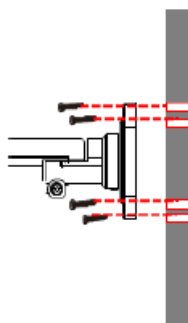

1. Screw the antenna to the camera
2. Locate a suitable location to mount the camera
3. Secure the camera stand to a stable surface, ceiling or wall using three screws.

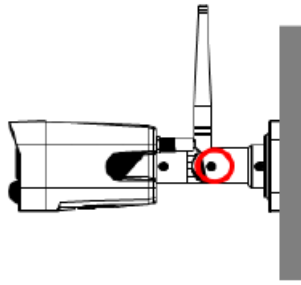

4. Loosen the thumb screw of the camera stand and secure the camera body to the bracket. Make sure the camera is in an upright position (relative to your viewing environment).

Wireless Connection

1. Power on the camera (Red LED quick flash)
2. Click the and enter into main menu
3. Choose the System Setup and go into wireless setup

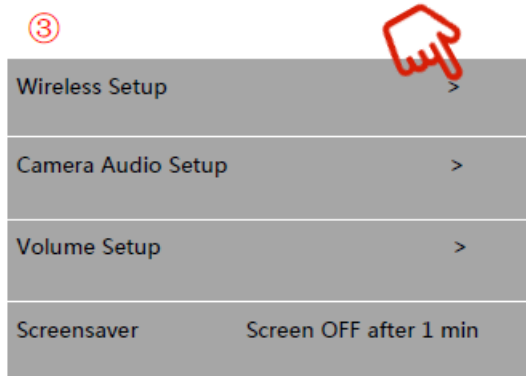
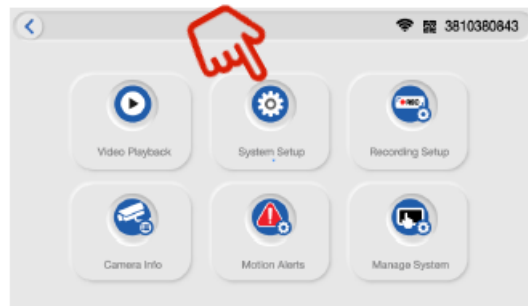
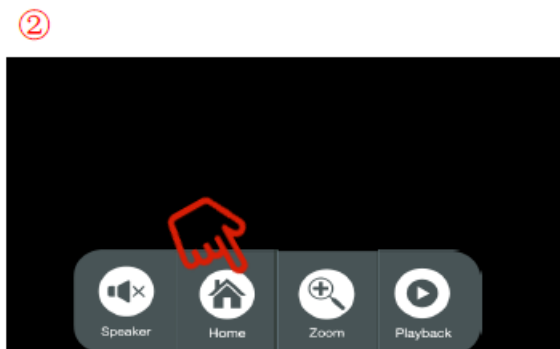
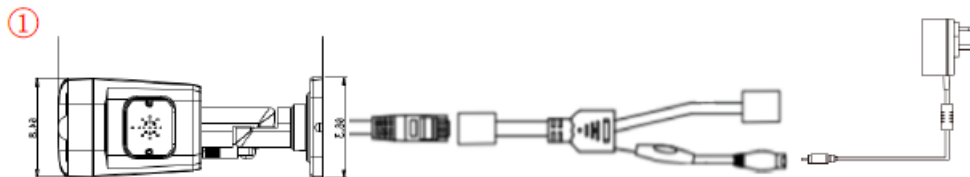

- ① Power on the camera (Red LED quick flash)
- ② Click the  and enter into main menu
- ③ Choose the System Setup and go into wireless setup

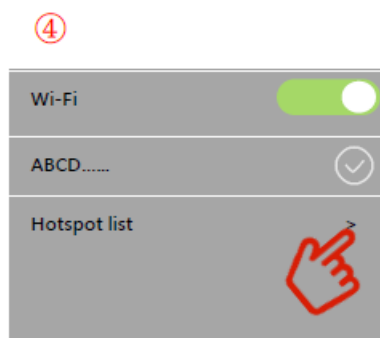

→ Enable/Disable Wi-Fi function

→  Indicates the Wi-Fi connection is successfully

→ There is available Wi-Fi routers in the drop-down list. Choose the appropriate Wi-Fi router and enter the Wi-Fi router password if necessary

- Enable/Disable Wi-Fi function
- Indicates the Wi-Fi connection is successfully
- There is available Wi-Fi routers in the drop-down list. Choose the appropriate Wi-Fi router and enter the Wi-Fi router password if necessary

Wired Connection

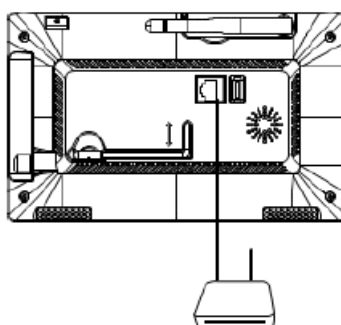

Connect the Monitor to the router by Ethernet cable

Pair the camera to NVR

This section allows you to add the camera, if you have purchased addition cameras or change original camera channel.

Notes: Before leaving factory, the camera has been matched with monitor, the image will come out when the kit is powered.

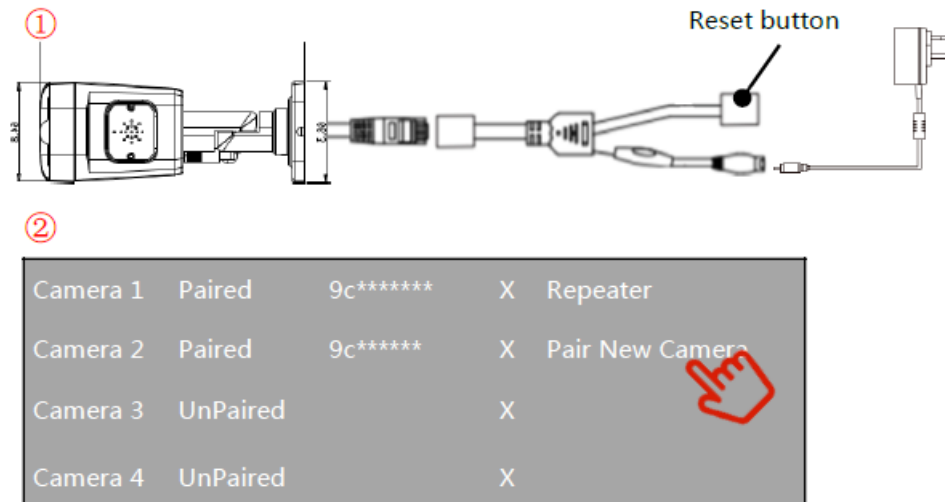

1. Power on the cameras and monitor and press reset button
2. Enter the Camera Info in the Main Page
3. Tap the match code and camera would be paired with Monitor Automatically.
 1. **Tips:1** If the camera still does not match the code after the code has timed out, click “pair new camera” again to try again.
 2. If you need to replace a new camera, please click “X” to delete the channel and then click on the code to match.
 3. The Red LED will always on which indicate the camera have been paired successfully.

Live View

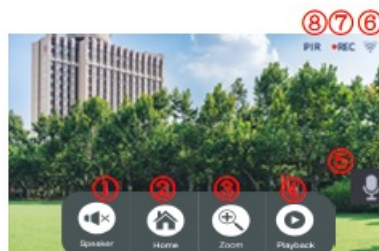
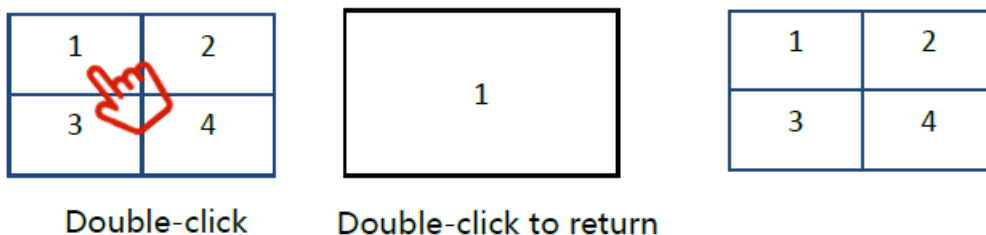

1. Speaker
2. Home
3. Zoom

4. Playback
5. Speaker
6. Wi-Fi signal
7. Recording
8. PIR

APP SETUP

The NVR system allows you to remotely access the live video from your iPhone, iPad or Android mobile device.

1. Download APP

Download and install “N connect”APP into your device

2. Camera Connection

1. Click the to add smart device
2. Choose New Device
3. Scan the Cloud ID from the QR code in Monitor's Manager System

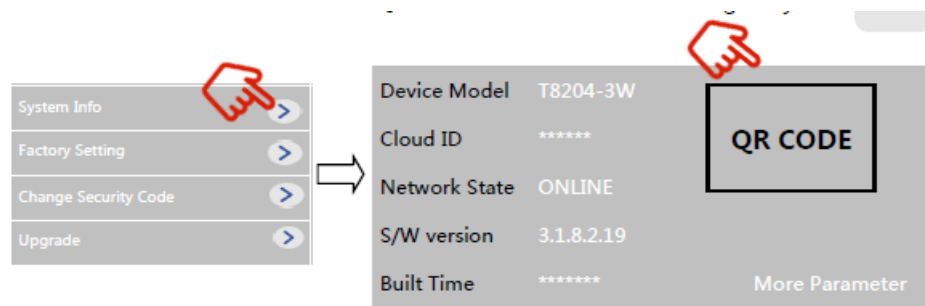

4. For your privacy and security, change the default password to your private password
5. The live view would show successfully in the list

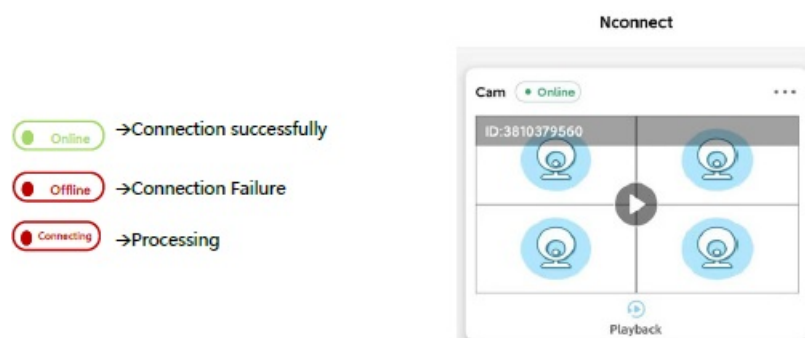

Any changes or modifications not expressly approved by the party responsible for compliance could void the user's authority to operate the equipment.

FCC Statment

Note: This equipment has been tested and found to comply with the limits for a Class B digital device, pursuant to part 15 of the FCC Rules. These limits are designed to provide reasonable protection against harmful interference in a residential installation. This equipment generates uses and can radiate radio frequency energy and, if not installed and used in accordance with the instructions, may cause harmful interference to radio communications. However, there is no guarantee that interference will not occur in a particular installation. If this equipment does cause harmful interference to radio or television reception, which can be determined by turning the equipment off and on, the user is encouraged to try to correct the interference by one or more of the following measures:

- Reorient or relocate the receiving antenna.
- Increase the separation between the equipment and receiver.
- Connect the equipment into an outlet on a circuit different from that to which the receiver is connected.
- Consult the dealer or an experienced radio/TV technician for help.

This equipment complies with FCC radiation exposure limits set forth for an uncontrolled environment. This equipment should be installed and operated with minimum distance 20cm between the radiator & your body. This device complies with part 15 of the FCC Rules. Operation is subject to the following two conditions:

1. This device may not cause harmful interference, and
2. this device must accept any interference received, including interference that may cause undesired operation.

Documents / Resources

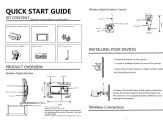
	<p>Atoms Labs AWS43R KIT CONTENT [pdf] User Guide AWS43R KIT CONTENT, KIT CONTENT, CONTENT</p>
---	--