



# ATOMRC Mobula Fixed-Wing FPV Aircraft RC Airplane User Manual

[Home](#) » [ATOMRC](#) » ATOMRC Mobula Fixed-Wing FPV Aircraft RC Airplane User Manual 



**Mobula Fixed-Wing FPV Aircraft RC Airplane  
User Manual**

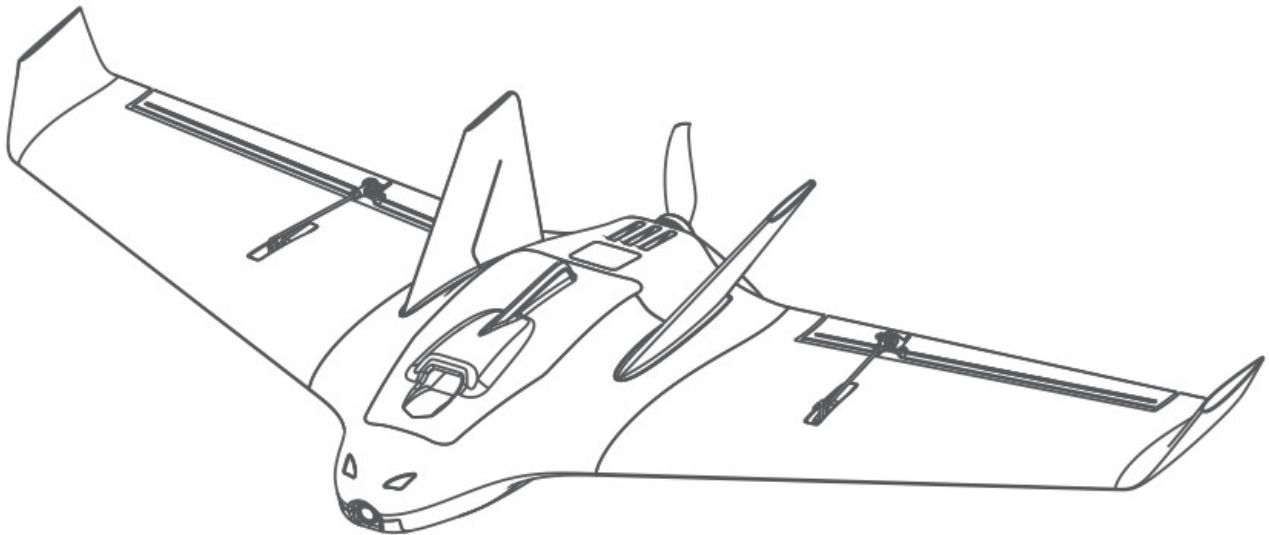

## Contents

- [1 Introduction](#)
- [2 Specifications](#)
- [3 Version Description](#)
- [4 KIT Contents](#)
- [5 Installation](#)
- [6 Tx500 VTX User manual](#)
- [7 VTX Wiring](#)
- [8 Tips](#)
- [9 Documents / Resources](#)
  - [9.1 References](#)
- [10 Related Posts](#)

## Introduction

The Mobula 650 is a compact design FPV delta wing, designed for FPV, the 650mm wingspan makes the wing very swift for low attitude FPV, and the EPP material makes the wing durable when crashing. With a large fuselage, users can easily install the electronics.

## Specifications

Wingspan	650mm
Length	300mm
WingArea	8d
Material	EPP
Recommend Motor	2004 2700KV
Recommend ESC	30A 2~4S
Recommend Propeller	4023
Servo	9g Servo*2Pcs
Recommend Battery	4S 850mAh Lipo

## Version Description

Packing List/t4M-S			
Version /ii&Z	KIT LITE	PNP	FPV
Description	Un-assembled KIT ( User needs to glue the plane)	Assembled KIT	PNP version of the plane
	Wood Plate. g&	2004 2700KV MOTOR	FOXEEER Razer NANO
	Batthead Push Rods	Ks 30A ESC ( [flout 2-45 But it is 9.13A BE C )	ATOMIC TX500 VTX
	BatteryStrap	9g Servo' 2	5.8G 2dB Antenna
		4023 Prop	

## KIT Contents

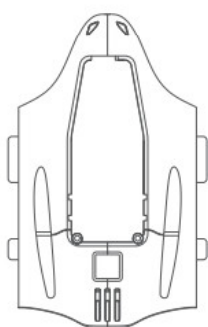

A

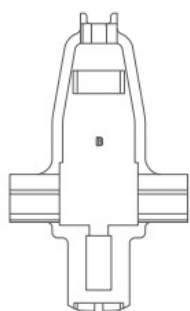

B

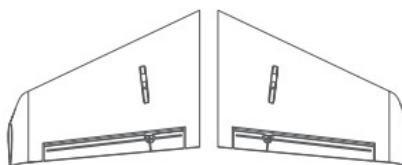

C

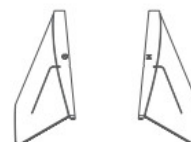

D



E



F



G



H

A Upper Fuselage	B Bottom Fuselage	B Bottom Fuselage
D V Tail	E Hatch	F GPS Hatch
G Blocker for V Tail	H Camera Hatch	

## Installation

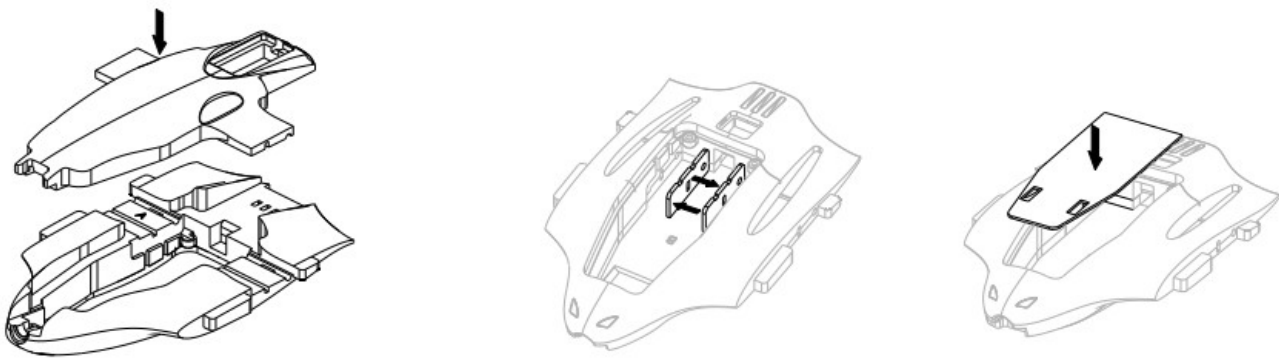

Glue the upper and lower fuselage, then glue the side and bottom plate.

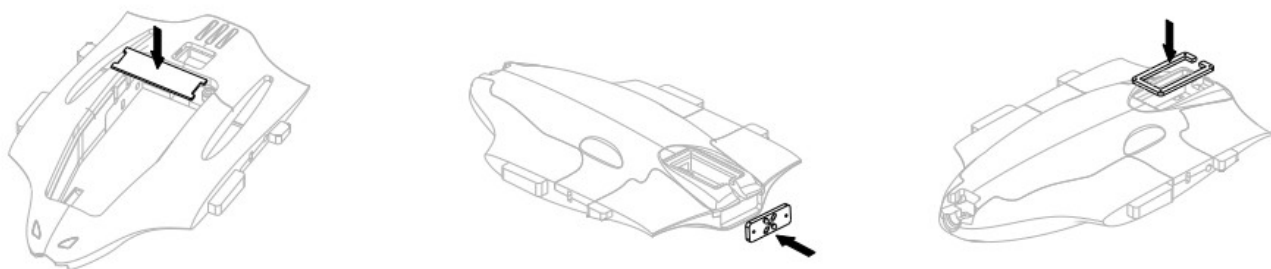

Glue the upper plate in the fuselage, then glue the ESC and Motor mount plate.

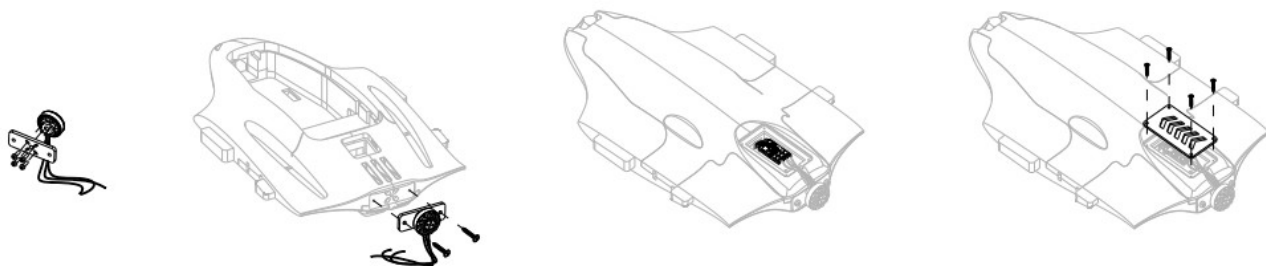

Install the Motor and ESC.



Glue the V tail.

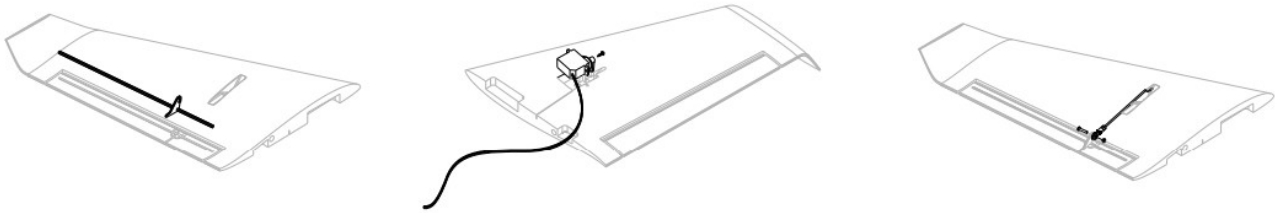

Glue the control horn, then glue the servo, install the push rod.

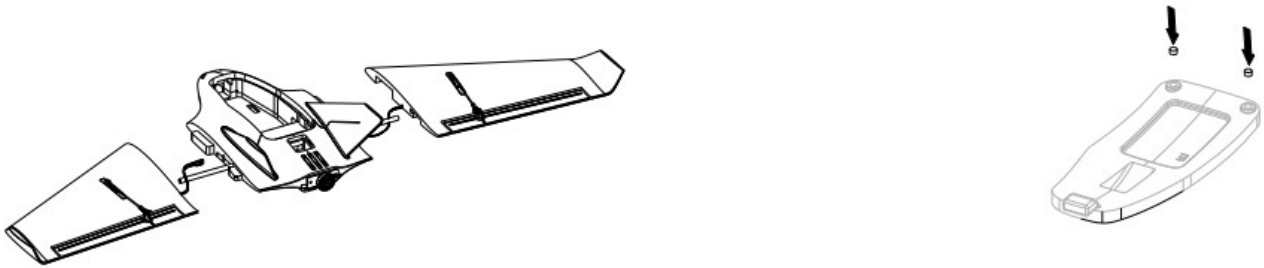

Glue wing , then glue the release hock and magnet on the fuselage cover.

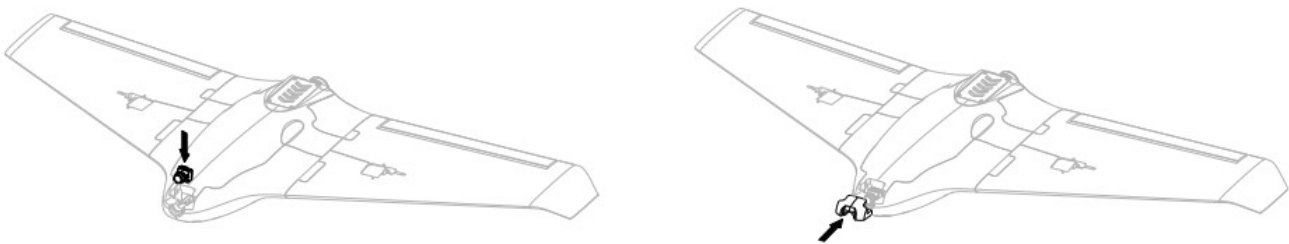

Install the camera, then glue the nose.

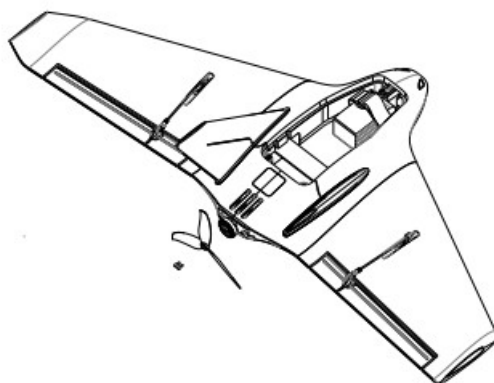

Install the Propeller, battery, and receiver.

**Tx500 VTX User manual**

Band	Channel							
	1	2	3	4	5	6	7	8
Band A	5865	5845	5825	5805	5785	5765	5745	5725
Band B	5733	5752	5771	5790	5809	5828	5847	5866
Band E	5705	5685	5665	5645	5885	5905	5925	5945
Airwave/FS	5740	5760	5780	5800	5820	5840	5860	5880
Race Band	5658	5695	5732	5769	5806	5843	5880	5917
L Band	5362	5399	5436	5473	5510	5547	5584	5621

## VTX Specs

Voltage input: 2~6S Lipo

Frequency: 5.3~5.9Ghz

Power: 100/200/500mw Switchable

Power consumption: 9V 1.1A

## VTX Setting

1. Hold the button 3 seconds into setting mode. In setting mode. short press the button to change the band.
2. Then hold the button 3 seconds into CH setting mode, and short press the button to change CH.
3. Hold the button 3 seconds to get into Power setting mode, there is a short bar on the LED, short press to switch power, 1 bar means 100mW, 2 bar means 200mW, 3 bar means 500mW.

## VTX Wiring

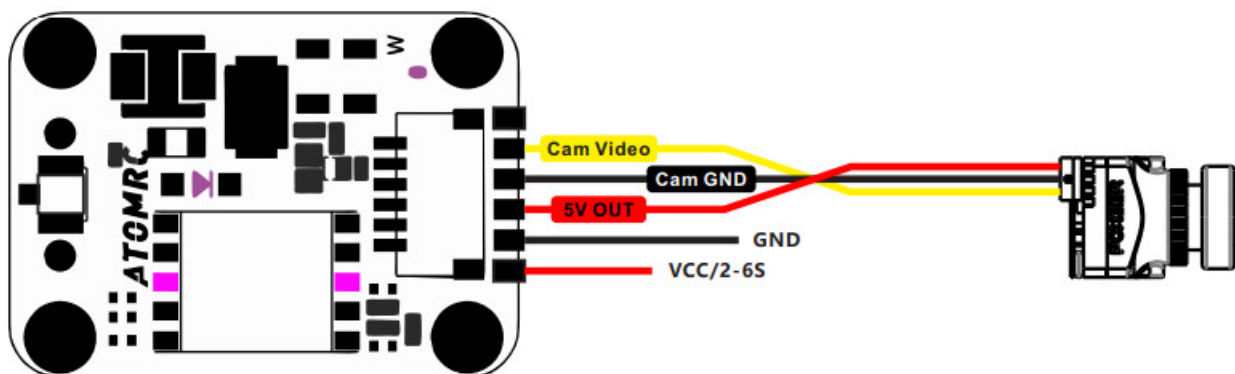

## Tips

This product is not toy, adult supervision is required for those under 14 years old!

**⚠ WARNING**  
**CHOKING HAZARD**  
Small parts - not for children  
under 3 years old



**14+**

The CG is very important for mobile CG is marked on the bottom of the wing.  
Check the CG carefully before flight.

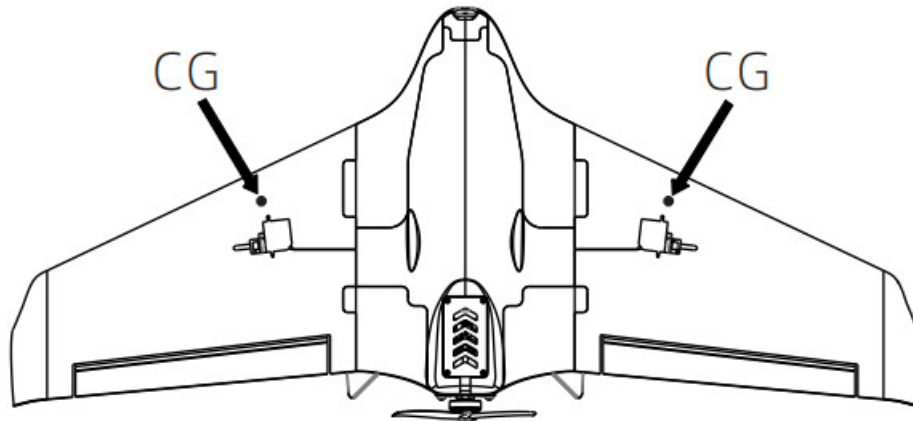

The wing already has an upward design, so no need adjust the elevons upward.



Please download the latest user manual at



[www.atomrc.com/pages/download](http://www.atomrc.com/pages/download)

Documents / Resources

<div> User Manual Mobula 遥控机</div> <div></div>	<p><a href="#">ATOMRC Mobula Fixed-Wing FPV Aircraft RC Airplane</a> [pdf] User Manual Mobula, Fixed-Wing FPV Aircraft RC Airplane, FPV Aircraft RC Airplane, Aircraft RC Airplane, R C Airplane, Mobula, Airplane</p>
--	--

References

- [Download – ATOMRC](#)