

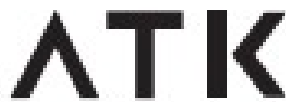

# ATK F1 Series Dual Mode Wired Mouse User Guide

[Home](#) » [ATK](#) » ATK F1 Series Dual Mode Wired Mouse User Guide 



## Series Dual Mode Wired Mouse User Guide

### Contents

- [1 Introduction](#)
- [2 Quick Start](#)
  - [2.1 DPI Set](#)
  - [2.2 Polling Rate Set](#)
  - [2.3 Battery Indication](#)
- [3 Documents / Resources](#)
  - [3.1 References](#)

## Introduction

1. Type-C Port
2. Left Mouse Button
3. Right Mouse Button
4. Scroll Wheel

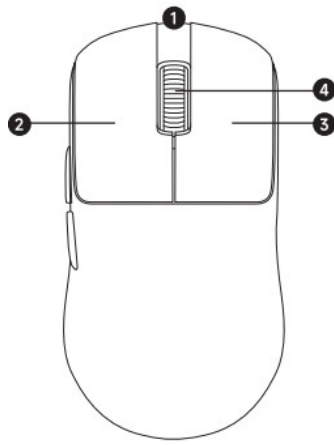

- 5. Indicato
- 6. Forward Button
- 7. Back Button

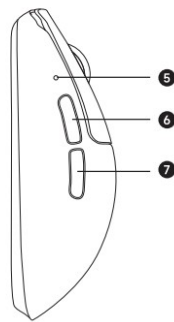

- 8. Feet
- 9. Optical Sensor
- 10. DPI Button
- 11. Power Switch

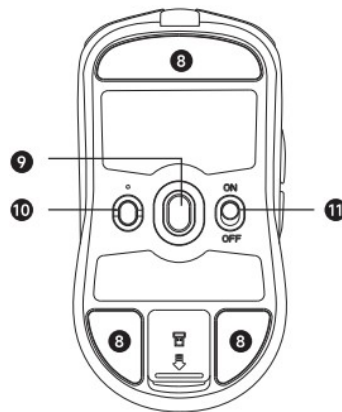

## Quick Start

1. Charge I Wired Mode

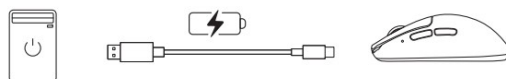

2. Wireless Mode

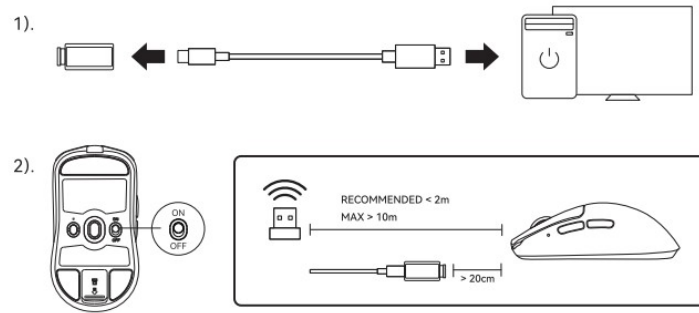

## DPI Set

Press the DPI button to quickly switch the DPI. The free drive provides the following DPI set and status indications



The DPI can be set between 50 to 26000 DPI by software.

## Polling Rate Set

Set the rate by software

## Battery Indication

1. Blinking In Red: 100/oBattery, please charge
2. Blinking In Yellow: Charging
3. Staying in Green: Charging completed



Removal Instruction for Battery Recycling

### FCC Warning Statement

Changes or modifications not expressly approved by the party responsible for compliance could void the user's authority to operate the equipment. This equipment has been tested and found to comply with the limits for a Class B digital device, pursuant to Part 15 of the FCC Rules. These limits are designed to provide reasonable protection against harmful interference in a residential installation. This equipment generates uses and can radiate radio frequency energy and, if not installed and used in accordance with the instructions, may cause harmful interference to radio communications. However, there is no guarantee that interference will not occur in a particular installation. If this equipment does cause harmful interference to radio or television reception, which can be determined by turning the equipment off and on, the user is encouraged to try to correct the interference by one or more of the following measures:

- Reorient or relocate the receiving antenna.
- Increase the separation between the equipment and receiver.
- Connect the equipment into an outlet on a circuit different from that to which the receiver is connected.
- Consult the dealer or an experienced radio/TV technician for help.

This device complies with part 15 of the FCC Rules. Operation is subject to the following two conditions:

1. This device may not cause harmful interference, and
2. this device must accept any interference received, including interference that may cause undesired operation.

FCC RF Radiation Exposure Statement:

1. This Transmitter must not be co-located or operating in conjunction with any other antenna or transmitter.
2. This equipment complies with RF radiation exposure limits set forth for an uncontrolled environment.

This equipment should be installed and operated with minimum distance 5mm between the radiator and your body.

### Software Download

[WWW.ATK.PRO](http://WWW.ATK.PRO)

As the product s constantly upgraded,  
you can scan the code to see the atest manual



<https://cdn.vxe.com/instructions/atk-%E8%A3%82%E7%A9%BA-f1/atk-f1.pdf>

## Documents / Resources

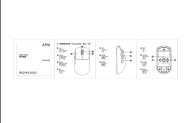
	<p><b><a href="#">ATK F1 Series Dual Mode Wired Mouse</a></b> [pdf] User Guide 2BE9P-ATKF1PROMAX, 2BE9PATKF1PROMAX, F1 Series Dual Mode Wired Mouse, F1 Series, Dual Mode Wired Mouse, Mode Wired Mouse, Wired Mouse, Mouse</p>
---	---

## References

- [User Manual](#)

[Manuals+](#), [Privacy Policy](#)

This website is an independent publication and is neither affiliated with nor endorsed by any of the trademark owners. The "Bluetooth®" word mark and logos are registered trademarks owned by Bluetooth SIG, Inc. The "Wi-Fi®" word mark and logos are registered trademarks owned by the Wi-Fi Alliance. Any use of these marks on this website does not imply any affiliation with or endorsement.