



ATEN VS92DP VanCryst 2-Port True 4K DisplayPort MST Hub User Guide

[Home](#) » [Aten](#) » ATEN VS92DP VanCryst 2-Port True 4K DisplayPort MST Hub User Guide 

ATEN VS92DP VanCryst 2-Port True 4K DisplayPort MST Hub User Guide



Contents

- [1 Hardware Review](#)
- [2 Package Contents](#)
- [3 Hardware Installation](#)
- [4 Customer Support](#)
- [5 Documents / Resources](#)
- [6 Related Posts](#)

Hardware Review

Front View

1. DisplayPort Output Port 1

2. DisplayPort Output 1 LED
3. DisplayPort Output 2 LED
4. DisplayPort Output Port 2

Rear View

1. USB Micro-B Power Port
2. Power LED
3. DisplayPort Input Port
4. Link LED

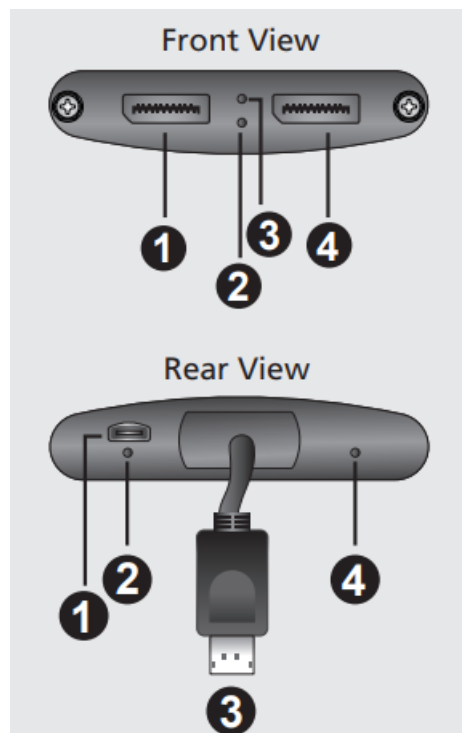

Package Contents

- 1 VS92DP 2-Port True 4K DisplayPort MST Hub
- 1 USB Type-A to USB Micro-B Cable
- 1 User Instructions

Hardware Installation

1. Connect a computer / laptop to the DisplayPort Input Connector on the VS92DP.
2. Connect two monitors to the DisplayPort Output Port 1 & 2.
3. Plug one end of the supplied USB Type-A to USB Micro-B Cable into VS92DP's USB Micro-B Power Port; plug the other end to a USB Type-A port of a computer / laptop / power adapter.

Mirror Mode

The VS92DP splits the same content on both monitors.

Extended Mode

The VS92DP displays independent contents on both monitors.

Video Wall Mode

The VS92DP displays one content by joining both monitors together as one display

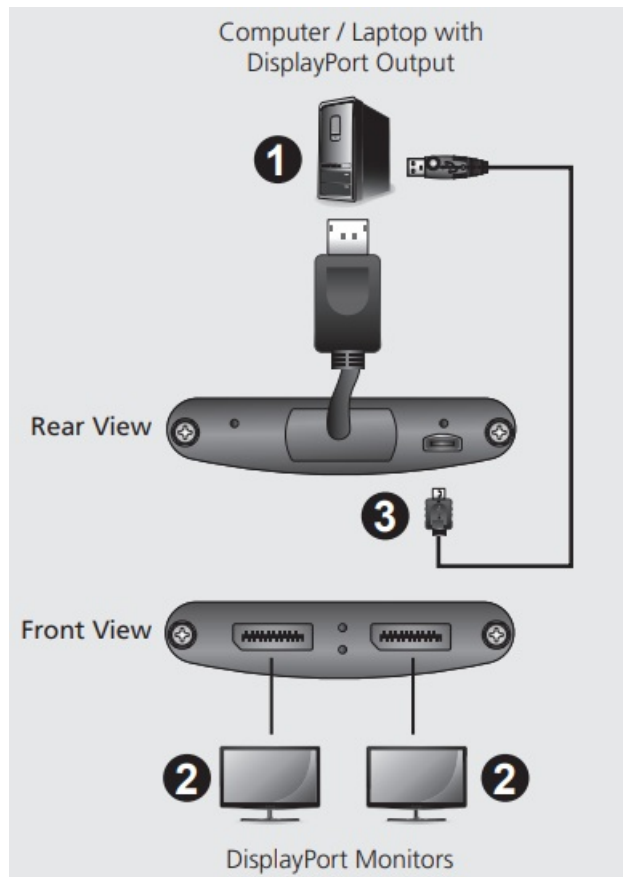

Consideration

1. It is limited to two displays under mirror mode using Windows Display Utility and NVIDIA Utility.
2. It requires either an AMD Eyefinity, Intel, or NVIDIA Surround technology graphics adapter under Video Wall mode (e.g., Panoramic).
3. Intel CPUs with HD Graphics are limited to three external monitors altogether.
4. A DisplayPort v1.2 output or later is recommended to enable full functionality. If the source DisplayPort output doesn't support DP 1.2, the MST function is disabled and becomes a Splitter, mirroring your video source across all displays.
5. Total bandwidth is 21.6Gbps.

Resolution	% of total bandwidth (21.6Gbps)
3840x2160@30Hz	40%
1920x1200@60Hz	30%
1920x1080@60Hz	22%

Note: The total combined bandwidth among all connected displays cannot exceed 21.6Gbps.

6. Supports UHD video resolutions up to 3840 x 2160 @30Hz, and 7.1ch surround audio to deliver high quality video and audio.
7. Existing video card can be used to minimize the use of the system resources.

Compatible Device

1. Systems with an available DisplayPort (DisplayPort v1.2 or later is recommended)
2. Compatible OS: Windows 10 / 8.1 / 8 / 7
3. MacOS does NOT support MST technology and will only mirror each display

Customer Support

Support and Documentation Notice

All information, documentation, firmware, software utilities, and specifications contained in this package are subject to change without prior notification by the manufacturer.

To reduce the environmental impact of our products, ATEN documentation and software can be found online at <http://www.aten.com/download/>

Technical Support

www.aten.com/support

Scan for more information



Documents / Resources

	<p>ATEN VS92DP VanCryst 2-Port True 4K DisplayPort MST Hub [pdf] User Guide VS92DP, VanCryst 2-Port True 4K DisplayPort MST Hub, VS92DP VanCryst 2-Port True 4K DisplayPort MST Hub</p>
---	---