



# ATEN KE6900AiT Altusen DVI-I Single Display KVM over IP Transmitter with Internet Access User Guide

[Home](#) » [Aten](#) » ATEN KE6900AiT Altusen DVI-I Single Display KVM over IP Transmitter with Internet Access User Guide 

ATEN KE6900AiT Altusen DVI-I Single Display KVM over IP Transmitter with Internet Access User Guide



## Contents

- [1 Package Contents](#)
- [2 Hardware Overview](#)
- [3 Installation](#)
- [4 Support and Documentation](#)
- [Notice](#)
- [5 Documents / Resources](#)
- [6 Related Posts](#)

## Package Contents

- KE6900AiT DVI-I Single Display KVM over IP Transmitter with Internet Access / KE6940AiT DVI-I Dual Display KVM over IP Transmitter with Internet Access
- power adapter
- KVM cable (DVI-D, USB Type-B, audio)
- DVI-D cable (KE6940AiT only)
- foot pad set (4 pcs)
- mounting kit

- user instructions

## Hardware Overview

- KE6940AiT Front View

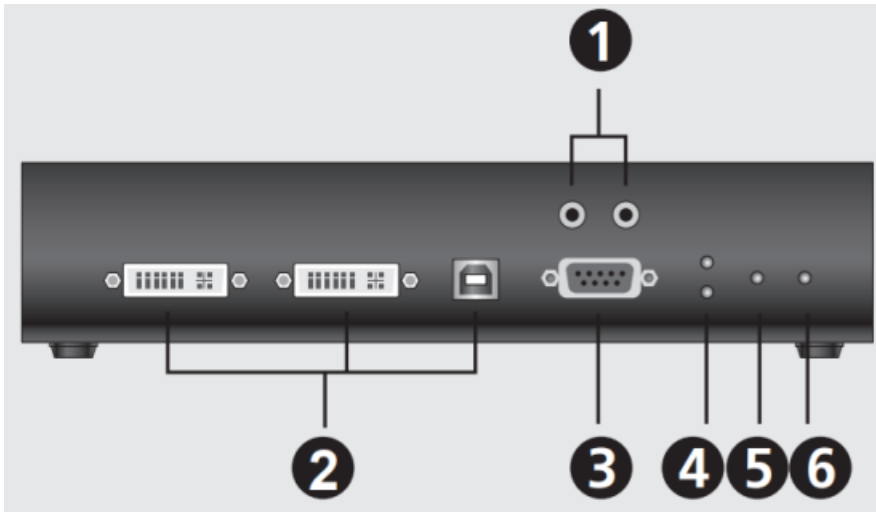

- KE6940AiT Rear View

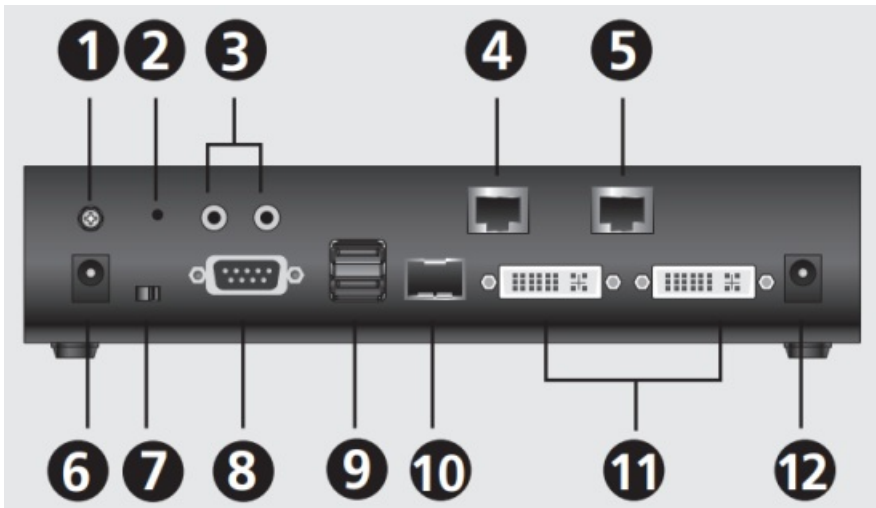

### KE6900AiT / KE6940AiT Front View

1. audio ports
2. KVM ports
3. RS-232 port
4. remote / local LED
5. LAN LED
6. power LED

### KE6900AiT / KE6940AiT Rear View

1. grounding terminal
2. reset button
3. audio ports
4. LAN port

5. Internet port
6. power jack
7. function switch
8. RS-232 port
9. USB Type-A ports (console)
10. SFP slot (for LAN)
11. DVI-I output (console)
12. power jack

**Note:** The front and rear of KE6900AiT are the same as KE6940AiT except that KE6900AiT has 1 DVI-I port instead of 2

## Installation

### • Bracket Attachment

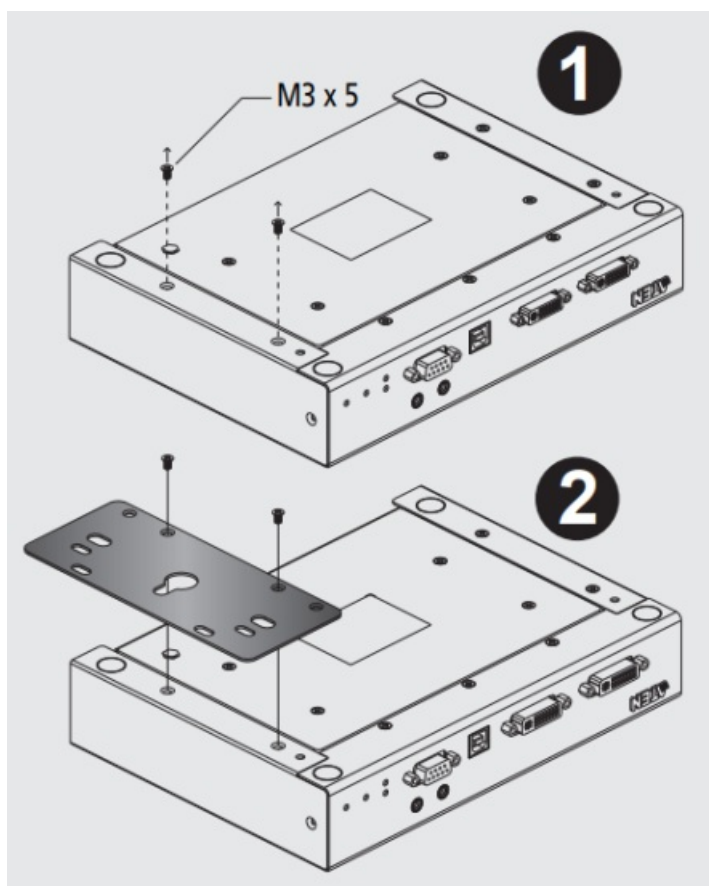

1. Unscrew the screws from the side of the unit as shown.
2. Use the screws from step 1 to secure the mounting bracket to the bottom of the unit as shown

### • Rack Mount

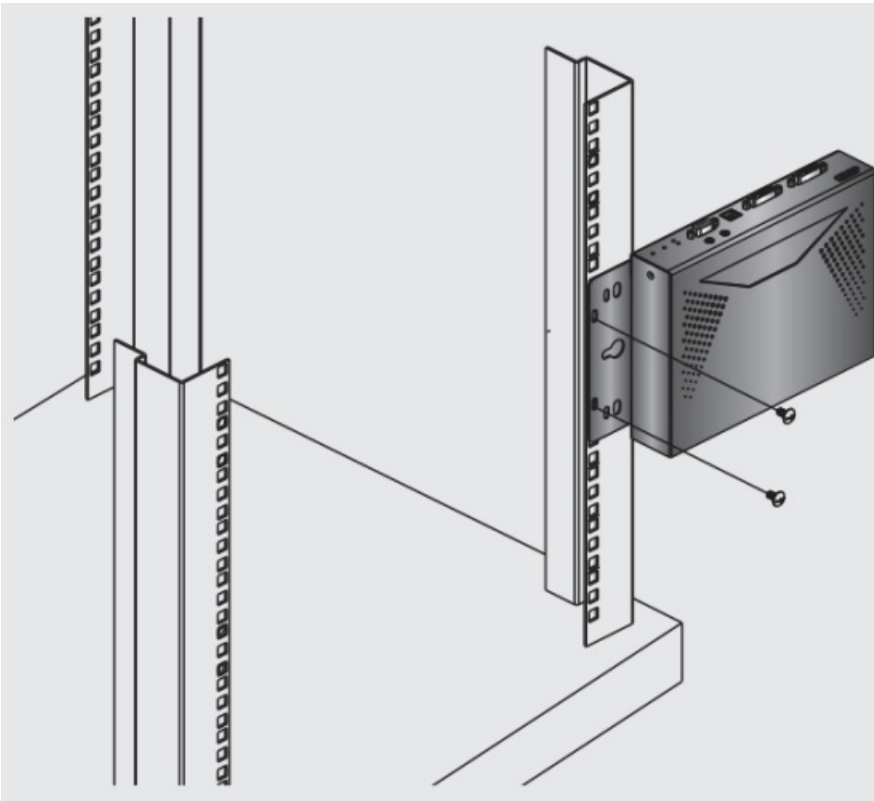

Secure the unit by screwing the bracket onto a convenient location on the rack.

- **Wall Mount**

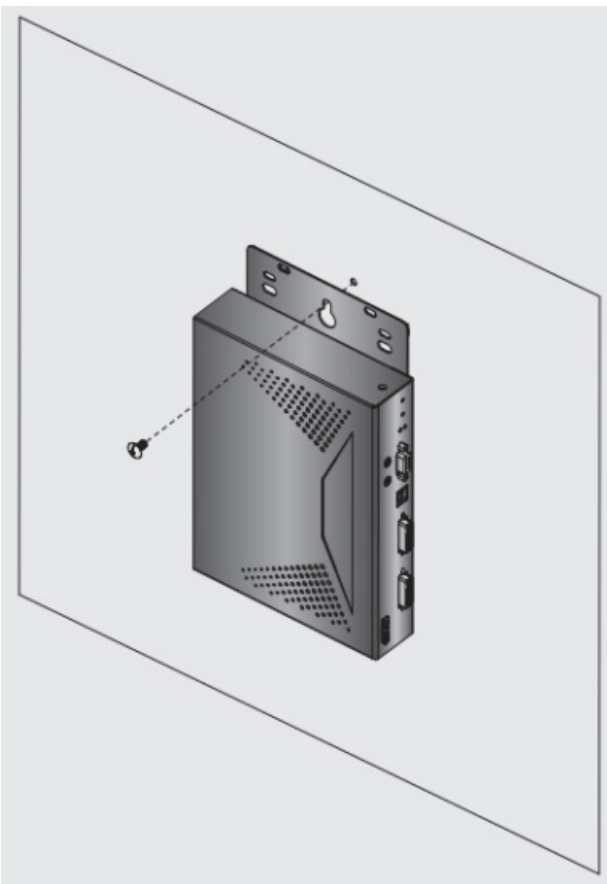

Use the center hole to screw the bracket to a secure wall surface.

- **Point-to-Point Installation**

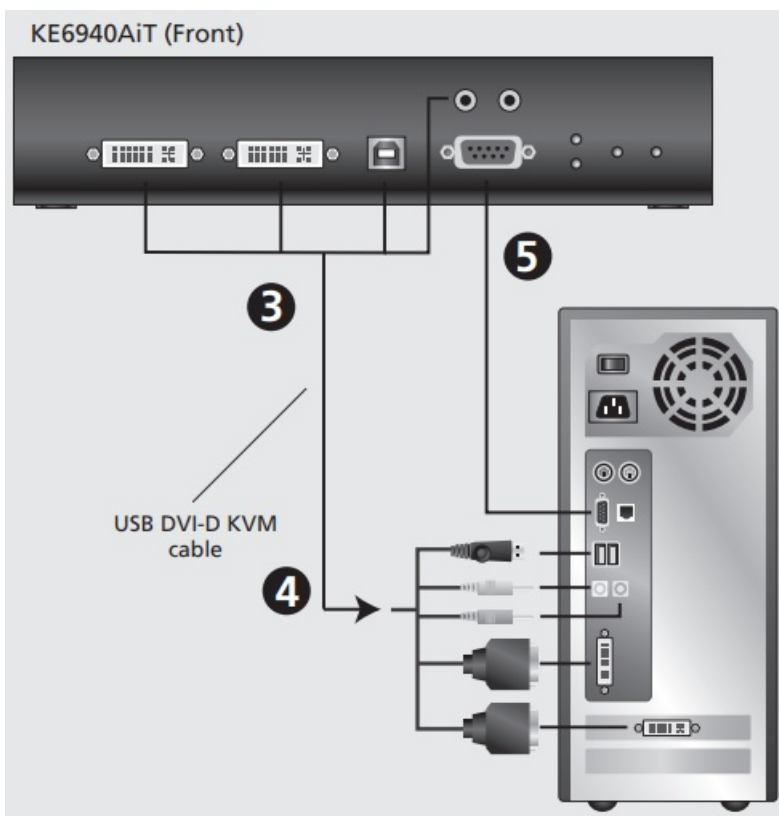
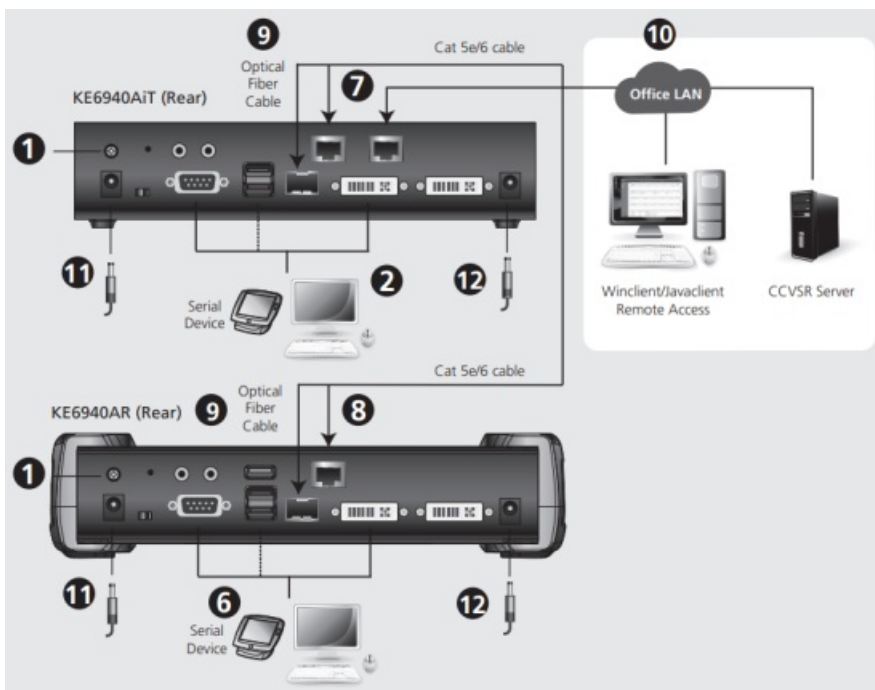

1. Use a grounding wire to connect the unit's grounding terminal to a suitable grounded object.
2. Plug the mouse, keyboard, DVI monitor(s), and serial devices into the unit's console ports.
3. Connect the KVM cable (DVI-D, USB Type-B, audio) and the DVI-D cable (KE6940AiT only) provided into the KVM ports on the front of the unit.
4. Connect the other end of the KVM cable (DVI-D, USB, audio) and the DVI-D cable (KE6940AiT only) into the keyboard, video, mouse, speaker, and microphone ports on the computer.
5. For control of serial devices, connect the RS-232 port on the front of the transmitter to a serial port on the computer.
6. Plug the mouse, keyboard, DVI monitor(s), and serial devices into the console ports of the receiver (KE6940AR is used as an example).
7. Connect a Cat 5e/6 cable to the transmitter's LAN port.

8. Connect the other end of the Cat 5e/6 cable to the receiver's LAN port.
9. (Optional) Instead of connecting through the LAN ports, you can choose to connect the extenders through their SFP slots. To do so, plug SFP modules into the transmitter and receiver's SFP slots, then connect each end of a Gigabit Ethernet (GbE) optical fiber between them.  
**Note:** The SFP module 2A-136G / 2A-137G is sold separately. Contact your ATEN dealer for product information.
10. To allow remote access to the unit's web interface or for CCVSR recording, use an Ethernet cable to connect its Internet port to the network.
11. Plug the power adapters into AC power sources with their power cords and plug the other ends into the transmitter and receiver's power jacks, respectively
12. (Optional) For power redundancy, connect another power adapter (available for purchase separately), connected to an AC power source, to the power jack of each transmitter/receiver.
13. Power on the computer.

## OSD Options

Both the transmitter and receiver units can be configured from the OSD menu on the receiver. For OSD configuration, refer to the KE user manual (downloadable at [www.aten.com](http://www.aten.com)).

## Support and Documentation Notice

All information, documentation, firmware, software utilities, and specifications contained in this package are subject to change without prior notification by the manufacturer.

To reduce the environmental impact of our products, ATEN documentation and software can be found online at <http://www.aten.com/download/>

Technical Support  
[www.aten.com/support](http://www.aten.com/support)

## Scan for more information

- ATEN Website



- User Manual



## Documents / Resources



[ATEN KE6900AiT Altusen DVI-I Single Display KVM over IP Transmitter with Internet Access](#) [pdf] User Guide  
KE6900AiT, KE6940AiT, Altusen DVI-I Single Display KVM over IP Transmitter with Internet Access