



ATEN CS62US 2-Port USB KVM Switch User Guide

[Home](#) » [Aten](#) » ATEN CS62US 2-Port USB KVM Switch User Guide 



CS62US 2-Port USB KVM Switch User Guide

Contents

- [1 Package Contents](#)
- [2 Hardware Review](#)
- [3 KVM Cable Connectors](#)
- [4 Hardware Installation](#)
- [5 Requirements](#)
- [6 Operation](#)
- [7 Specifications](#)
- [8 EMC Information](#)
- [9 Documents / Resources](#)
 - [9.1 References](#)
- [10 Related Posts](#)

Package Contents

- 1 CS62U/CS62US 2-Port USB KVM Switch
- 2 Hotkey Stickers
- 1 User Instructions

Hardware Review

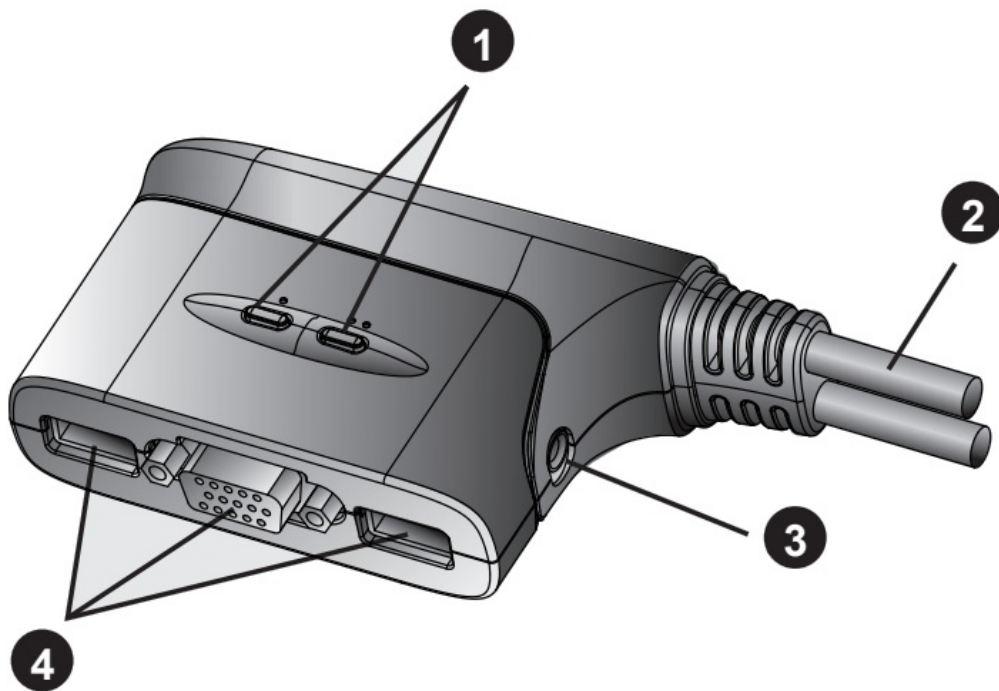

KVM Cable Connectors

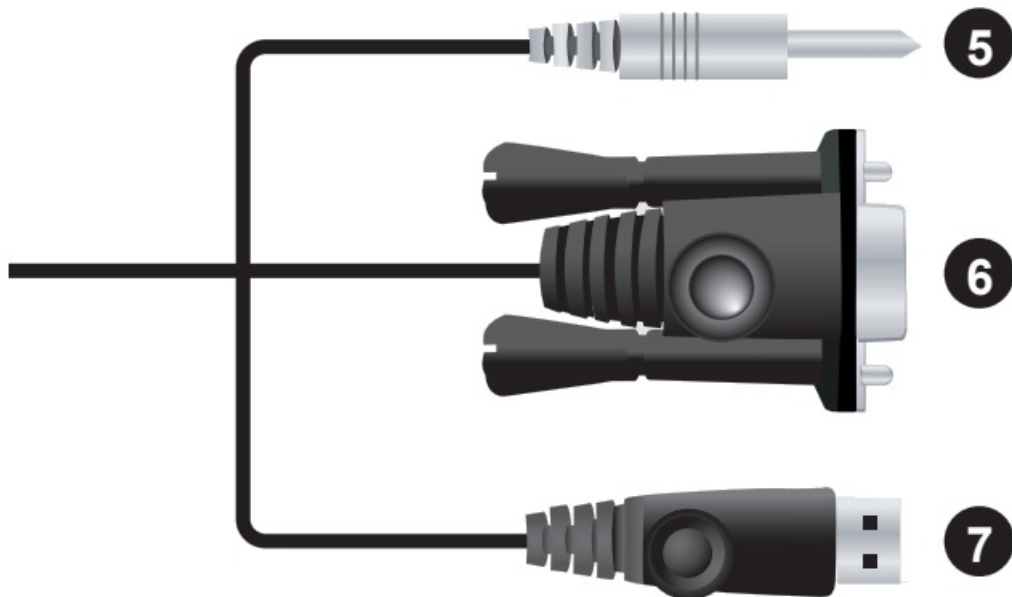

Hardware Installation

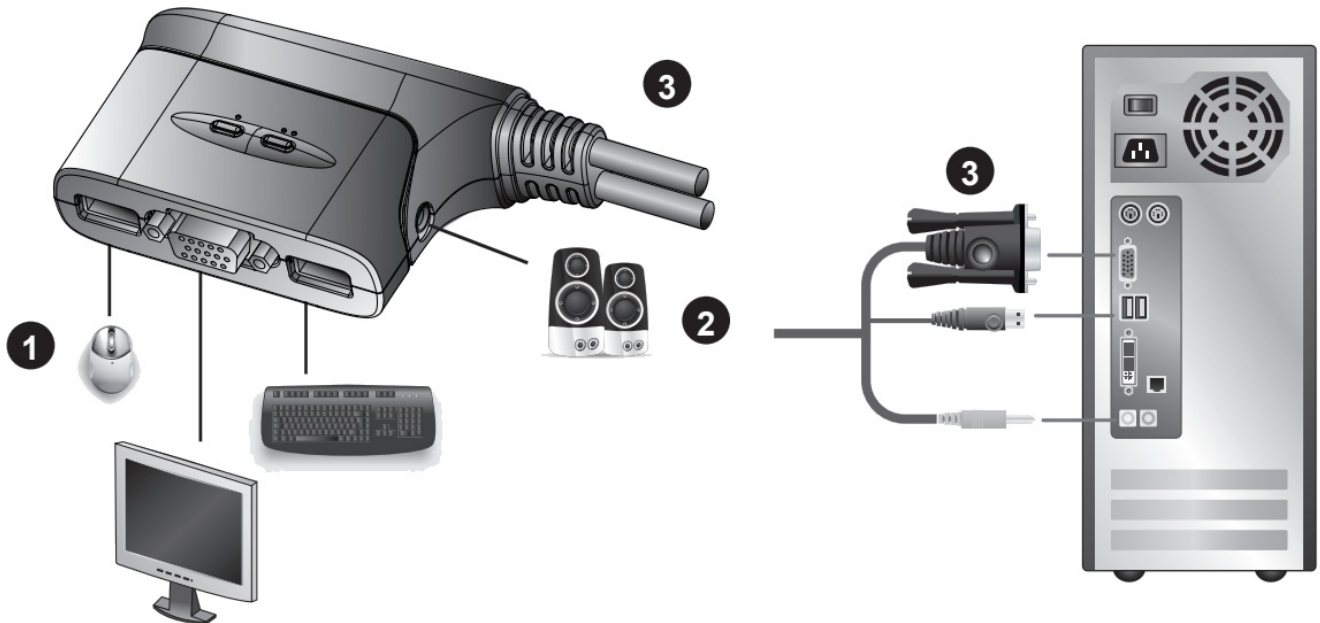

Requirements

Console

- A VGA, SVGA, or multisync monitor capable of the highest resolution that you will be using on any computer in the installation
- A USB Keyboard and a USB Mouse
- Speakers (optional)

Computers

The following equipment must be installed on each computer that is to be connected to the system:

- A VGA, SVGA, or multisync video port
- USB Type A port
- Speaker port (optional)

Hardware Review A KVM Cable Connectors B

1. Port LEDs
2. KVM Cables
3. Speaker Jack
4. Console Ports
5. Speaker Plug
6. Video Connector
7. USB Keyboard/Mouse connector

Hardware Installation C Important

1. Make sure that the power to any device that you connect to the installation has been turned off. You must unplug the power cords of any computers that have the Keyboard Power On function.
2. Make sure that all devices you will be installing are properly grounded. Setting up the CS62U / CS62US USB KVM Switch is quick and easy. Refer to the installation diagrams:

1. Plug your USB keyboard, USB mouse, and monitor into their ports on the CS62U / CS62US. These are located on the side of the CS62U/CS62US.

Note: When using a wireless keyboard and mouse combo, the dongle must plug into the CS62U / CS62US's keyboard port in order for the hotkeys to function.

2. Plug your speakers into the speaker jack.
3. Plug the USB, video, and audio connectors of the attached KVM cables into their respective ports on the computers you are installing.
4. Power on the computers.

Note: The CS62U / CS62US's power on default is to link to the first computer that is powered on.

Operation

Port Switching

All port switching operations begin by tapping the Scroll Lock key twice. See the following table for full details.

Hotkey	Action
[Scroll Lock] [Scroll Lock]	Toggles the KVM and Audio focus between the two ports.

Note: If using the Scroll Lock key conflicts with other programs running on the computer, the Ctrl key can be used instead.

Invoking Hotkey Setting Mode (HSM)

All hotkey operations begin by holding the Num Lock key, pressing and releasing the Minus key, then releasing the Num Lock key. See the the following tables for full details.

Note: If using [Num Lock] [-] conflicts with other programs, [Ctrl] [F12] can be used instead.

Auto Scanning

Model	Hotkey	Action
CS62US	[Num Lock] [-] [a]	Starts Auto Scan. The KVM focus cycles from port to port at 5-second intervals.

Note: To exit Auto Scan, press [Esc] or [Spacebar]. Auto Scanning stops when you exit Auto Scan mode.

Mouse Port Selection

Simply double-click the scroll wheel on your USB mouse to switch between ports. The mouse port-switching function allows you to toggle back and forth between the ports.

Note:

1. This feature is only supported by USB 3-key scroll wheel mice.
2. The default setting is OFF.
3. This feature is only supported when mouse emulation is enabled.

Hotkey Summary Table

Combination			Function
[Num Lock] [-] +	[H]		Toggles between the default [Num Lock] [-] and alternate [Ctrl][F12] HSM invocation keys.
	[T]		Toggles between the default [Scroll Lock] [Scroll Lock] and alternate [Ctrl][Ctrl] port switching keys.
	[F2]		Activates Mac keyboard mapping.
	[F3]		Activates Sun keyboard mapping.
	[F10]		Auto detects keyboard operating platform.
	[F4]		Lists current switch settings via the paste function of a text editor.
	[F5]		Performs a USB keyboard and mouse reset.
	[F6][nn] [Enter]		Sets the keyboard language layout. Note: nn is a two-digit number that represents one of the following keyboard language codes: US English 33; French 08; Japanese 15.
	[R]	[Enter]	Resets hotkeys to the default setting.
	[M]		Enables/Disables mouse emulation.
	[N]		Enables/disables keyboard emulation
	[W]		Enables/Disable mouse port-switching
[Esc]]	or [Space Bar]		Quits hotkey setting mode.

Note: When keyboard emulation is off, the [m], [w], [F2], [F3], [F10], [F4], [F5], and [F6] hotkeys are disabled. To use the USB mouse port as a USB hub, you must first disable mouse emulation mode

Specifications

Function			CS62U	I CS62US
Computer Connections			2	
Port Selection			Hotkeys, Mouse	
Connectors	Console Ports	Keyboard	1 x USB Type A Female (White)	
		Video	1 x HDB-15 Female (Blue)	
		Mouse	1 x USB Type A Female (White)	
		Speakers	1 x Mini Stereo Jack Female (Green)	
	KVM Ports	Keyboard / Mouse	2 x USB Type A Male (Black)	
		Video	2 x HDB-15 Male (Blue)	
		Speakers	2 x Mini Stereo Plug Male (Green)	
LEDs		Selected		2 (Green)
Cable Length		Computers		1.8 m (6ft)0.9 m (3ft)
Emulation		Keyboard / Mouse		USB
Video			2048 x 1536; DDC2B	
Scan Interval			5 seconds	
Environment	Operating Temp.		0-50°C	
	Storage Temp.		-20-60°C	
	Humidity		0-80% RH, Non-condensing	
Physical Properties	Housing		Plastic	
	Weight		0.40 kg	I 0.29 kg
	Dimensions (LxWx H)		8.10 x 6.90 x 2.60 cm	

Support and Documentation Notice

All information, documentation, firmware, software utilities, and specifications contained in this package are subject to change without prior notification by the manufacturer.

To reduce the environmental impact of our products, ATEN documentation and software can be found online at

<http://www.aten.com/download/>

Technical Support

www.aten.com/support



https://www.aten.com/products/productItem.php?model_no=CS62US

EMC Information

FEDERAL COMMUNICATIONS COMMISSION INTERFERENCE STATEMENT: This equipment has been tested and found to comply with the limits for a Class B digital service, pursuant to Part 15 of the FCC rules. These limits are designed to provide reasonable protection against harmful interference in a residential installation. Any changes or modifications made to this equipment may void the user's authority to operate this equipment. This equipment generates, uses, and can radiate radio frequency energy. If not installed and used in accordance with the instructions, may cause harmful interference to radio communications. However, there is no guarantee that interference will not occur in a particular installation. If this equipment does cause harmful interference to radio or television reception, which can be determined by turning the equipment off and on, the user is encouraged to try to correct the interference by one or more of the following measures:

- Reorient or relocate the receiving antenna;
- Increase the separation between the equipment and receiver;
- Connect the equipment into an outlet on a circuit different from that to which the receiver is connected;
- Consult the dealer/an experienced radio/television technician for help.

FCC Caution: Any changes or modifications not expressly approved by the party responsible for compliance could void the user's authority to operate this equipment.

This device complies with Part 15 of the FCC Rules. Operation is subject to the following two conditions: (1) this device may not cause harmful interference, and (2) this device must accept any interference received, including interference that may cause undesired operation.

© Copyright 2018 ATEN® International Co., Ltd.

ATEN and the ATEN logo are trademarks of ATEN International Co., Ltd. All rights reserved. All other trademarks are the property of their respective owners.

Part No. PAPE-1285-E04G

Printing Date: 11/2018



Documents / Resources

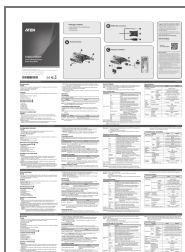

[ATEN CS62US 2-Port USB KVM Switch](#) [pdf] User Guide

CS62U, CS62US, CS62US 2-Port USB KVM Switch, CS62US, 2-Port USB KVM Switch, USB KVM Switch, KVM Switch, Switch

References

- [ATEN - Simply Better Connections | ATEN U.S.A.](#)
- [Downloads | ATEN Corporate Headquarters](#)