



ATEN CS52A 2 Port Hybrid KVM Switch with Audio User Guide

[Home](#) » [Aten](#) » ATEN CS52A 2 Port Hybrid KVM Switch with Audio User Guide 

ATEN CS52A 2 Port Hybrid KVM Switch with Audio



Contents

- 1 Online Registration
- 2 Technical Phone Support
- 3 Components
- 4 CS52A Installation Diagram
- 5 Requirements
- 6 Installation B
- 7 Manual Port Selection
- 8 Hotkey Port Selection
- 9 Hotkey Summary Table
- 10 Scan Interval Table
- 11 Troubleshooting
 - 11.1 New Keyboard Functions Not Working?
- 12 Specifications
- 13 Documents / Resources
 - 13.1 References
- 14 Related Posts

Online Registration

International:

<http://support.aten.com>

North America:

http://www.aten-usa.com/product_registration

Technical Phone Support

International:

886-2-86926959

North America:

1-888-999-ATEN (**ATEN TECH**)

1-732-356-1703 (**ATEN NJ**)

Components

1. Port Selection Switch
2. Port 1 LED
3. Port 2 LED
4. Console Cable
5. KVM Cables
6. Remote Selection Switch Jack

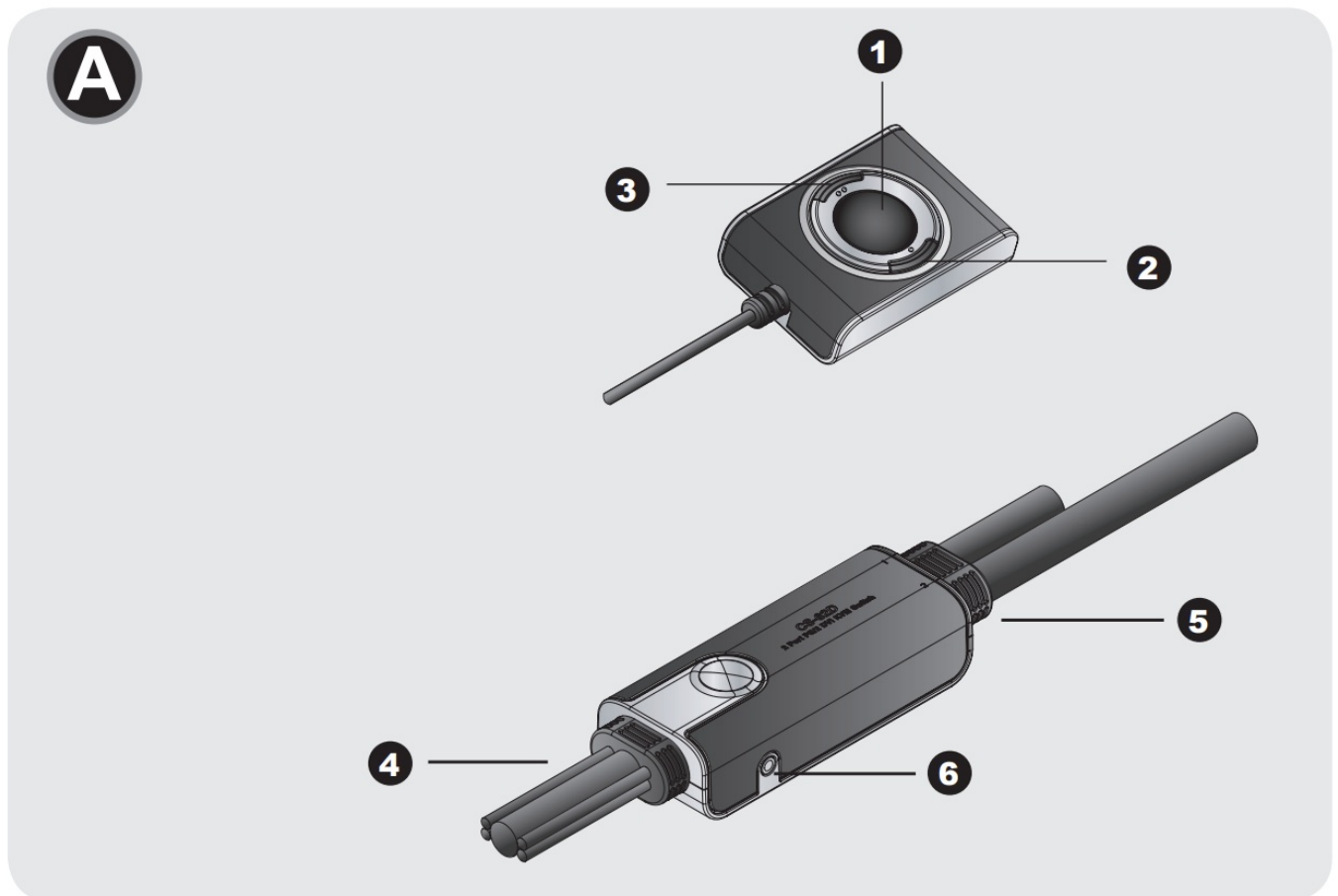

CS52A Installation Diagram

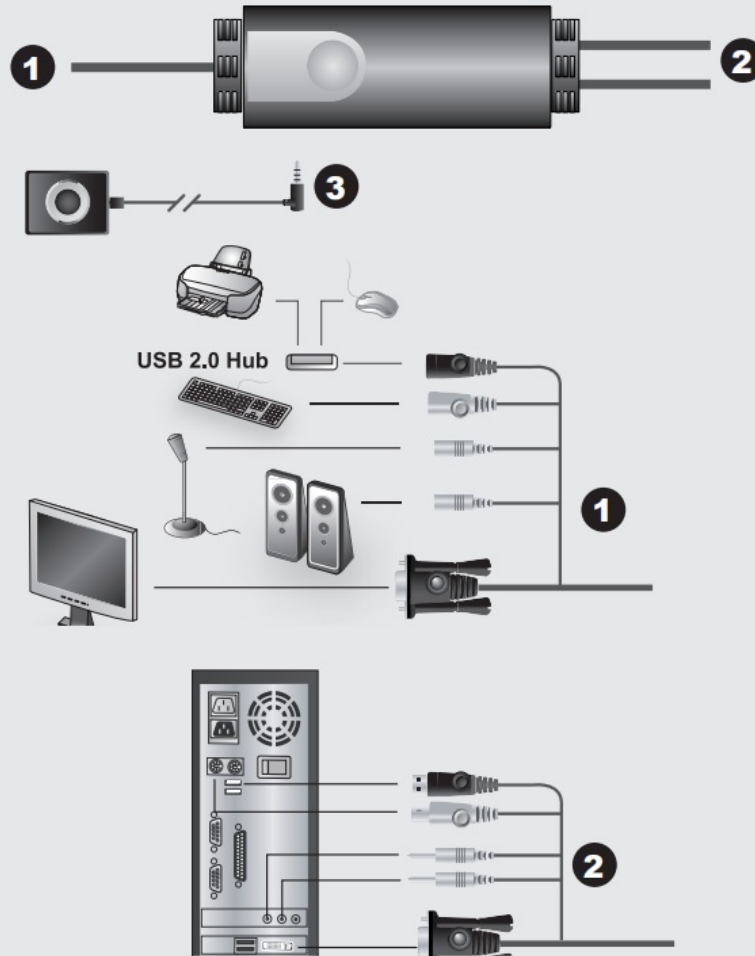
B

To prevent damage to your installation from power surges or static electricity, it is important that all connected devices are properly grounded.

CS52A 2-Port Hybrid KVM Switch with Audio

Requirements

Console

- A VGA, SVGA, XGA, or MultiSync monitor capable of the highest resolution that you will be using on any computer in the installation
- A PS/2 style keyboard
- A USB style mouse
- Speakers and microphone (optional)

Computers

The following equipment must be installed on each computer that is to be connected to the system:

- A VGA video port
- A 6-pin mini-DIN (PS/2 style) keyboard port and a USB Type A port
- Speakers and microphone ports (optional)

Installation

Make sure power to all computers being installed has been turned off !

1. Plug your keyboard, monitor, mouse, microphone, and speakers into the appropriate connectors at the end of the console cable. The ports are color coded and labeled with an identifying icon.

Note: Plug the keyboard in before plugging in the mouse.

Note: The mouse connector (black) is actually a USB 2.0 port, and can accept any USB compatible peripheral. You can even connect a hub to install multiple USB devices. This may require an additional power adapter.

2. Plug the keyboard, monitor, mouse, microphone, and speaker connectors of the KVM cables into their respective ports on the computers you are installing.
3. If you choose to use the Port Selection Switch, plug its cable into the port selection switch jack, located on the right side of the unit.

Note: The switch can be operated with hotkeys alone, so connecting the port selection switch is optional.

4. Turn on the power to the computers.

Note: By default the switch links to the first computer that is turned

Manual Port Selection

Press the port selection button to toggle the KVM and Audio focus between the two computers. The port's Port LED lights to indicate that its corresponding port has the focus.

Note: Do not switch ports while a USB device (printer, external drive, etc..) is in process. Switching ports will terminate the operation. For independent USB switching, please see the USB KVMP switches on our website.

Hotkey Port Selection

All hotkey port switches begin with tapping the Scroll Lock key twice. The tables below describe the actions that each hotkey operation performs.

Note: The default hotkey invocation key is the Scroll Lock key, but you can choose the Ctrl key instead.

Hotkey Summary Table

Hotkey	Action
[Scroll Lock] [Scroll Lock] [Enter]	Toggles the KVM and Audio focus between the two ports. Note: If the KVM and Audio focus are on different ports, only the KVM focus switches.
[Scroll Lock] [Scroll Lock] [k] [Enter]	Only toggles the KVM focus.
[Scroll Lock] [Scroll Lock] [s] [Enter]	Only toggles the audio focus.
[Scroll Lock] [Scroll Lock] [a] [Enter] [n]	Starts Auto Scan. The KVM focus cycles from port to port at n second intervals. Note: The n stands for the number of seconds that the focus dwells on a port before switching to the other one. Replace the n with a number between 1 and 4 when entering this hotkey combination. (See the table, below.)

Scan Interval Table

n	Secs.
1	3 secs.
2	5 secs. (default)
3	10 secs.
4	20 secs.

Troubleshooting

New Keyboard Functions Not Working?

You plugged in a new keyboard while the computers were running, so the operating system failed to initialize the new keyboard functions. Restart the computers so that the operating system can recognize the new functions.

Specifications

Function	Specification
Computer Connections	2

Port Selection			Hotkey, Pushbutton
Connectors	Console Ports	Keyboard	1 x 6-pin Mini-DIN Female (Purple)
		Video	1 x HDB-15 Female (Blue)
		Mouse	1 x USB Type A Female (Black)
		Speaker	1 x Mini Stereo Jack Female (Green)
		Microphone	1 x Mini Stereo Jack Female (Pink)
	KVM Ports	Keyboard	2 x 6-pin Mini-DIN Male (Purple)
		Video	2 x HDB-15 Male (Blue)
		Mouse	2 x USB Type A Male (Black)
		Speaker	2 x Mini Stereo plug Male (Green)
		Microphone	2 x Mini Stereo plug Male (Pink)
	Remote Switch		1 x Mini Stereo Jack
Switches	Port		1 x Pushbutton
LEDs	Selected		2 (Green)
	Console		0.15m

Cable Length	Computers	0.6m, 1.2m
Emulation	Keyboard	PS/2
Video		2048 x 1536 @ 75 Hz; DDC2B
Scan Interval		3, 5, 10, 20 Seconds
Environment	Operating Temp.	0 – 50°C
	Storage Temp.	-20 – 60°C
	Humidity	0 – 80% RH, Non-condensing
Physical Properties	Housing	Plastic
	Weight	0.41 kg
	Dimension (L x W x H)	8.45 x 3.40 x 2.13 cm

© Copyright 2019 ATEN® International Co., Ltd.

ATEN and the ATEN logo are trademarks of ATEN International Co., Ltd. All rights reserved. All other trademarks are the property of their respective owners.

This product is RoHS compliant.

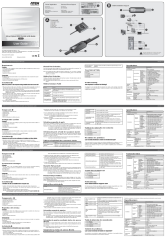

	<p>ATEN CS52A 2 Port Hybrid KVM Switch with Audio [pdf] User Guide</p> <p>CS52A 2 Port Hybrid KVM Switch with Audio, CS52A, 2 Port Hybrid KVM Switch with Audio, 2 Port Hybrid KVM Switch, KVM Switch with Audio</p>
---	--

References

-  [ATEN - Simply Better Connections | ATEN U.S.A.](#)