



ATEN CL3108 8/16-Port Short Depth PS/2-USB VGA Single Rail WideScreen LCD KVM Switch User Guide

[Home](#) » [Aten](#) » ATEN CL3108 8/16-Port Short Depth PS/2-USB VGA Single Rail WideScreen LCD KVM Switch User Guide 



CL3108 / CL3116 8/16-Port Short Depth PS/2-USB VGA Single Rail WideScreen LCD KVM Switch Quick Start Guide

© Copyright 2021 ATEN®
International Co., Ltd.

ATEN and the ATEN logo are registered trademarks of ATEN International Co., Ltd. All rights reserved. All other trademarks are the property of their respective owners.

Part No. PAPE-1223-R10G Released: 03/2021



Contents

- [1 Package Contents](#)
- [2 Hardware Review](#)
- [3 Hardware Installation](#)
- [4 Operation](#)
- [5 Documents / Resources](#)
- [6 Related Posts](#)

Package Contents

- 1 CL3108 / CL3116 LCD KVM Switch with Standard Rack Mounting Kit
- 2 custom KVM cables (VGA, USB; 1.8m/6ft)
- 1 firmware upgrade cable
- 1 power cord
- 1 user instructions

Hardware Review

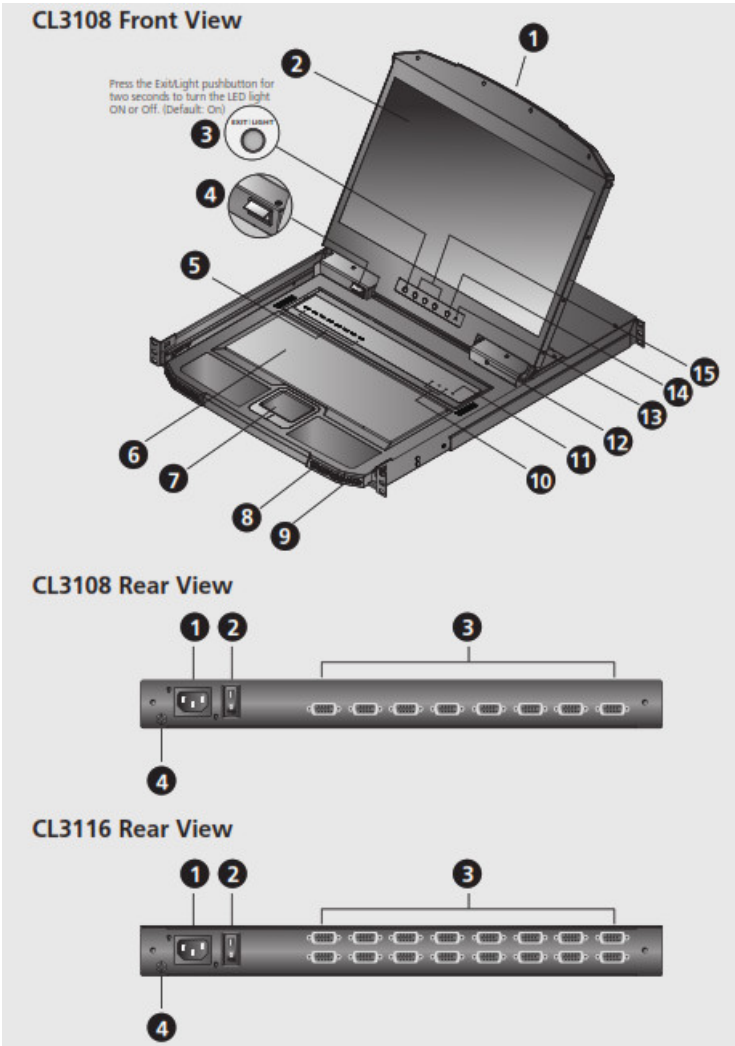

Front View

<ul style="list-style-type: none"> 1. handle 2. LCD display 3. LED illumination light pushbutton 4. LED illumination light 5. port selection pushbutton / LEDs (8 for CL3108, 16 for CL3116) 6. keyboard 7. touchpad 	<ul style="list-style-type: none"> 8. external mouse port 9. power LED 10. lock LEDs 11. reset button 12. firmware upgrade port 13. firmware upgrade switch 14. LCD on/off button 15. LCD controls
---	--

CL3108 Rear View

1. power socket
2. power switch

3. KVM port section
4. grounding terminal

CL3116 Rear View

1. power socket
2. power switch

3. KVM port section
4. grounding terminal

Hardware Installation

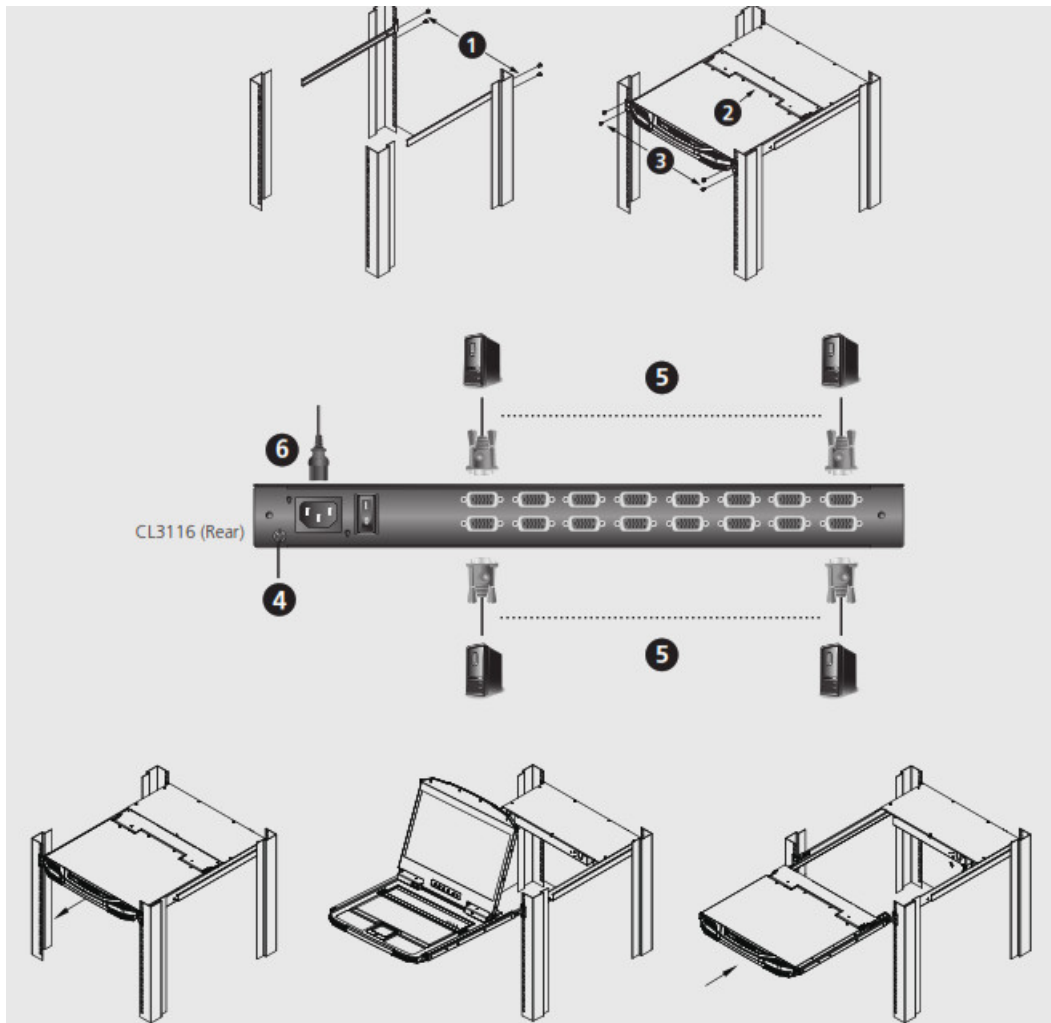

A standard rack mounting kit is provided with your CL3108 / CL3116 and can be mounted in 1U of rack space.

1. Attach the left and right mounting brackets to the back of the rack, installing four screws in the tabs to secure them in place.
2. Two people insert the CL3108 / CL3116, by sliding its left and right sidebars into the mounting brackets.
3. While one person and the brackets hold the weight of the CL3108 / CL3116, have a second person install four screws in the front tabs to secure the module to the front of the rack.
Note: Allow at least 5.1 cm on each side for proper ventilation, and at least 12.7 cm at the back for the power cord and cable clearance.
4. Ground the CL3108 / CL3116 by connecting one end of a grounding wire to the grounding terminal and the other end to a suitable grounded object.

5. Connect any available KVM port to a computer's keyboard, video, and mouse ports using the custom KVM cable sets.
6. Plug the power cord into the CL3108 / CL3116 power socket and into an AC power source.

Operation

Opening the Console

Pull-on the release bar on the upper handle. Slide the console module out until it clicks in place, and then raise the LCD module lid.

Closing the Console

To close the console, lower the LCD module until it lies flat, and slide the full console in.

OSD Functions

OSD functions are used to configure and control the OSD. For example, you can rapidly switch to any port, scan selected ports, limit the list you wish to view, designate a port as a quick viewport, create or edit a port name, or make OSD setting adjustments.

To access an OSD function:

1. Press the dedicated invocation key (KVM OSD) on the keyboard to invoke the OSD. This is the default setting.
2. In the submenus, make your choice either by double-clicking it, or moving the highlight bar to the choice and pressing [Enter].
3. Press [Esc] to return to the previous menu level.

Hotkey

To invoke Hotkey Setting Mode to do the following:

Number Lock and Minus Keys [Num Lock] + [-]

1. Hold down the [Num Lock] key.
2. Press and release the [-] key.
3. Release the [Num Lock] key.

Press [Esc] to exit Hotkey mode.

HSM Summary Table.

Key	Function
[number], [Enter]	Switches access to the port corresponding to the entered number. [number] = 01-08 (CL3108) or 01-16 (CL3116).
[F1]	Enables Windows keyboard emulation (default)
[F2]	Enables Mac keyboard emulation.
[F3]	Enables Sun keyboard emulation.
[H] / [h]	Changes Invoke Hotkey Mode to [Num Lock] + [-] (default) or [Ctrl] + [F12].
[F5]	Resets (USB) keyboard and/or mouse.
[T] / [t]	Changes Activate OSD Mode to [Ctrl] [Ctrl]

Support and Documentation Notice

All information, documentation, firmware, software utilities, and specifications contained in this package are subject to change without prior notification by the manufacturer.

To reduce the environmental impact of our products, ATEN documentation and software can be found online at <http://www.aten.com/download/>

Technical Support

www.aten.com/support

Scan for more information



http://www.aten.com/products/productItem.php?model_no=cl3108

http://www.aten.com/ext_libraries/manuals.php?n=cl3108-cl3116

Documents / Resources



[ATEN CL3108 8/16-Port Short Depth PS/2-USB VGA Single Rail WideScreen LCD KVM Switch \[pdf\] User Guide](#)

CL3108, CL3116, CL3108 8 16-Port Short Depth PS 2-USB VGA Single Rail WideScreen LCD KVM Switch, 8 16-Port Short Depth PS 2-USB VGA Single Rail WideScreen LCD KVM Switch